

### Property Identification

Site Address: 812 BEACH CT	Parcel ID: 2415-601-0019-000-1	Account #: 24543	Sec/Town/Range: 15/35S/40E
Map ID: 24/15N	Zoning: SF Interme	Use Type: 0800	Jurisdiction: Fort Pierce

### Ownership

812 Beach Court LLC  
812 Beach CT  
Fort Pierce, FL 34950

### Legal Description

PINEWOOD S/D BLK 4 N 20 FT OF LOT 6, ALL LOT 14 AND S 40 FT OF LOT 15 (OR 4116-770)

### Current Values

Just/Market:	\$211,500	Assessed:	\$151,241	Year	Just/Market	Assessed	Exemptions	Taxable
Exemptions:	\$0	Taxable:	\$151,241	2024	\$211,500	\$151,241	\$0	\$151,241
				2023	\$169,700	\$137,492	\$0	\$137,492
				2022	\$158,900	\$124,993	\$0	\$124,993

### Historical Values 3-year

### Sale History

Date	Book/Page	Sale Code	Deed	Grantor	Price
04-02-2018	4116 / 0770	0137	SPWD	Usdan (TR) Vikki	\$95,000
01-03-2018	4083 / 0440	0118	CertTtle	Phillius Magdalene	\$67,700
10-20-2016	3928 / 0084	0001	WD	Usdan Realty Inc	\$77,000

### Primary Building Information

Finished Area of this building: 3,132 SF  
Gross Sketched Area: 4,615 SF

#### Exterior Data

View:	Roof Cover: Fibrglss Shg	Roof Structure: Gable	Building Type: MFH
Year Built: 1947	Frame:	Grade: MFAQ	Effective Year: 1947
Primary Wall: CB Stucco	Story Height: 1 Story	No. Units: 2	Secondary Wall: Wood/Sheath

#### Interior Data

Bedrooms: 0	A/C %: 100%	Electric: AVERAGE	Primary Int Wall:
Full Baths: 5	Heated %: 100%	Heat Type: FrcdHotAir	Avg Hgt/Floor: 0
Half Baths: 0	Sprinkled %: N/A%	Heat Fuel: ELEC	Primary Floors: Tile-Ceramic

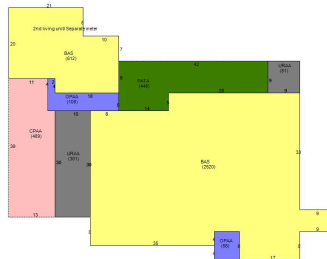

### Total Areas

Finished/Under Air (SF):	3,132
Gross Sketched Area (SF):	4,615
Land Size (acres):	0.34
Land Size (SF):	14,615
Total Building Count:	1

### Special Features and Yard Items

Type	Qty	Units	Year Blt
Driv-Concret	1	1020	1947