

Michelle Franklin, CFA -- Saint Lucie County Property Appraiser -- All rights reserved -- 11/13/2024, 12:22 PM

Property Identification

Site Address: 209 Parcel ID: 2422-504-0105- Account #: 30020 Sec/Town/Range:
 GARDENIA AVE 000-5 22/35S/40E
 Map ID: 24/22N Zoning: SF Moderat Use Type: 0100 Jurisdiction: Fort Pierce

Ownership

LAUDERDALE HOMES LLC
 3101 N Federal HWY # 606
 Fort Lauderdale, FL 33306-1018

Legal Description

SUNSET PARK BLK 8 LOT 4

Current Values

Just/Market: \$140,200 Assessed: \$140,200
 Exemptions: \$0 Taxable: \$140,200

Historical Values 3-year

Year	Just/Market	Assessed	Exemptions	Taxable
2024	\$140,200	\$140,200	\$0	\$140,200
2023	\$155,400	\$155,400	\$0	\$155,400
2022	\$122,900	\$122,900	\$0	\$122,900

Sale History

Date	Book/Page	Sale Code	Deed	Grantor	Price
04-01-2022	4946 / 0361	0130	WD	SF HOME BUYERS LLC	\$100
04-16-2021	4597 / 0997	0001	WD	Thurston Brent	\$100,000
10-15-2008	3029 / 0203	XX01	SPWD	Wells Fargo Bank NA (TR)	\$45,000

Primary Building Information

Finished Area of this building: 1,116 SF
 Gross Sketched Area: 2,004 SF

Exterior Data

View: Roof Cover: Fibrglss Shg Roof Structure: Gable Building Type: SFAV
 Year Built: 1959 Frame: Grade: SFAV-Fair Effective Year: 1959
 Primary Wall: Conc Block Story Height: 1 Story No. Units: 1 Secondary Wall: Wood/Sheath

Interior Data

Bedrooms: 3 A/C %: 100% Electric: AVERAGE Primary Int Wall:
 Full Baths: 1 Heated %: 100% Heat Type: FredHotAir Avg Hgt/Floor: 0
 Half Baths: 0 Sprinkled %: N/A% Heat Fuel: ELEC Primary Floors: Carpet

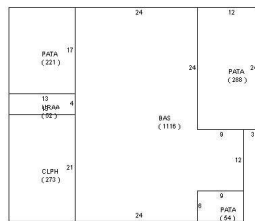

Total Areas

Finished/Under Air (SF):	1,116
Gross Sketched Area (SF):	2,004
Land Size (acres):	0.16
Land Size (SF):	7,020
Total Building Count:	1

Special Features and Yard Items

Type	Qty	Units	Year Blt
Driv-Concret	1	600	1959
CHAINLINK 4'	1	270	1977

All information is believed to be correct at this time, but is subject to change and is provided without any warranty.
 © Copyright 2024 Saint Lucie County Property Appraiser. All rights reserved.