

**1 CONCRETE CURB DETAIL**  
SCALE: N.T.S.

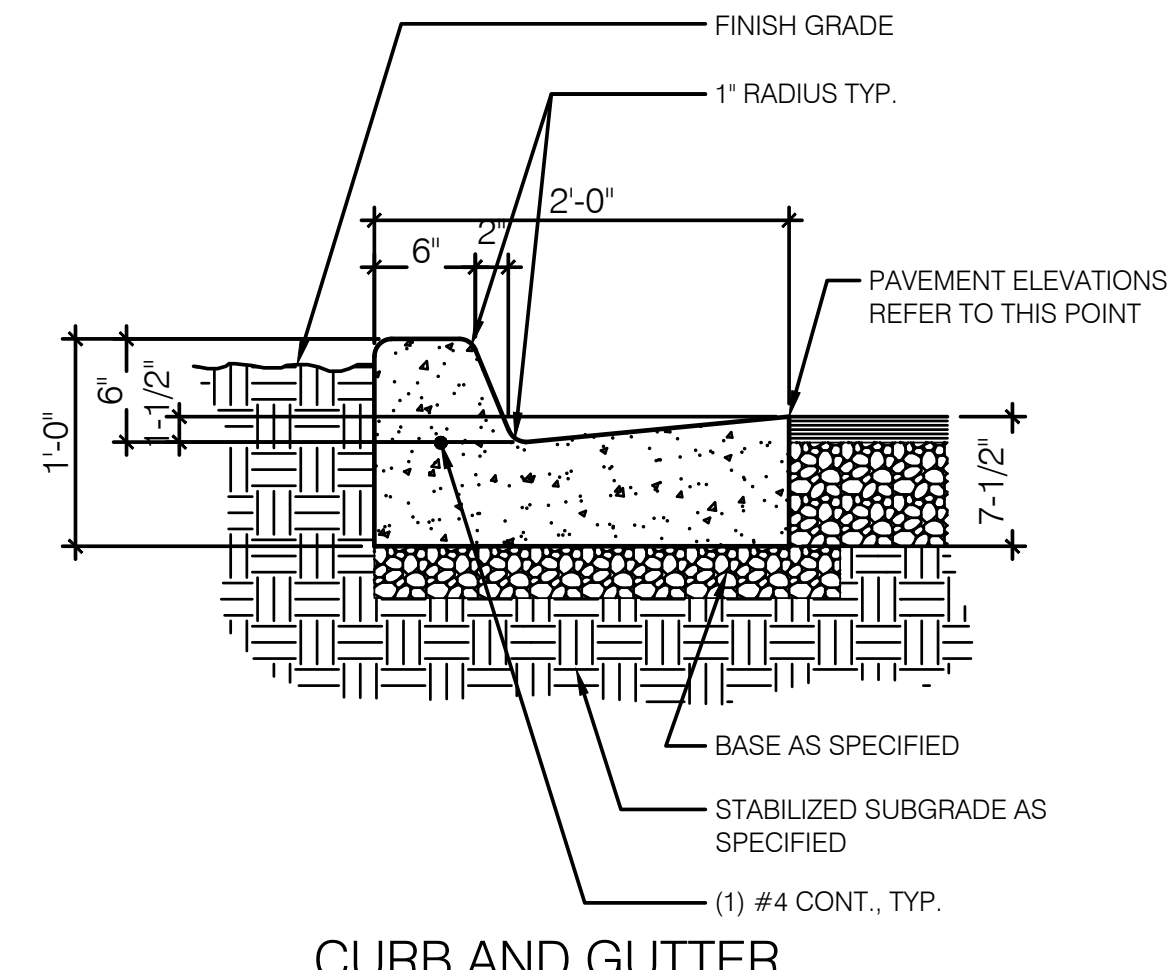

**CURB AND GUTTER**

**2 CURB AND GUTTER DETAIL**  
SCALE: N.T.S.

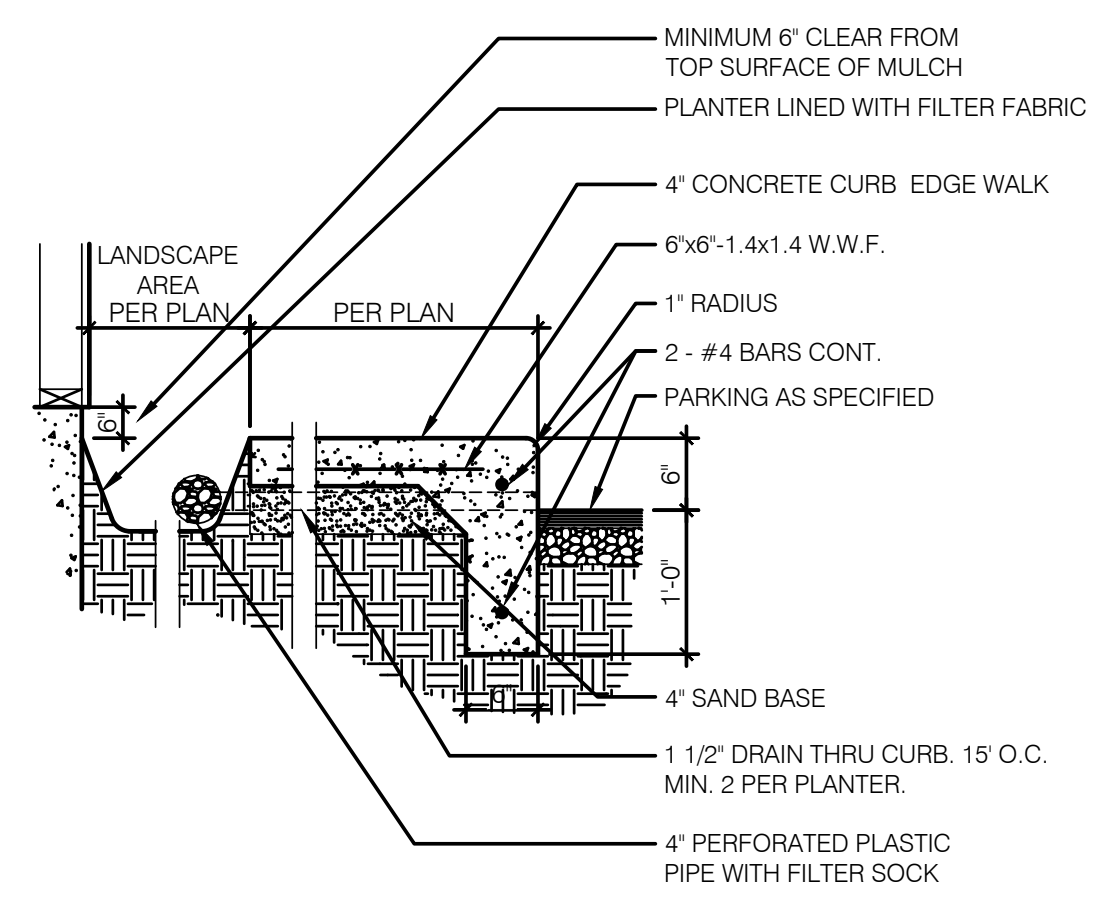

**3 CONCRETE SIDEWALK DETAIL**  
SCALE: N.T.S.

ZONING: SF MODERAT  
PARCEL ID: 2408-507-0019-000-0

ZONING: GENERAL CO  
PARCEL ID: 2408-507-0002-000-8

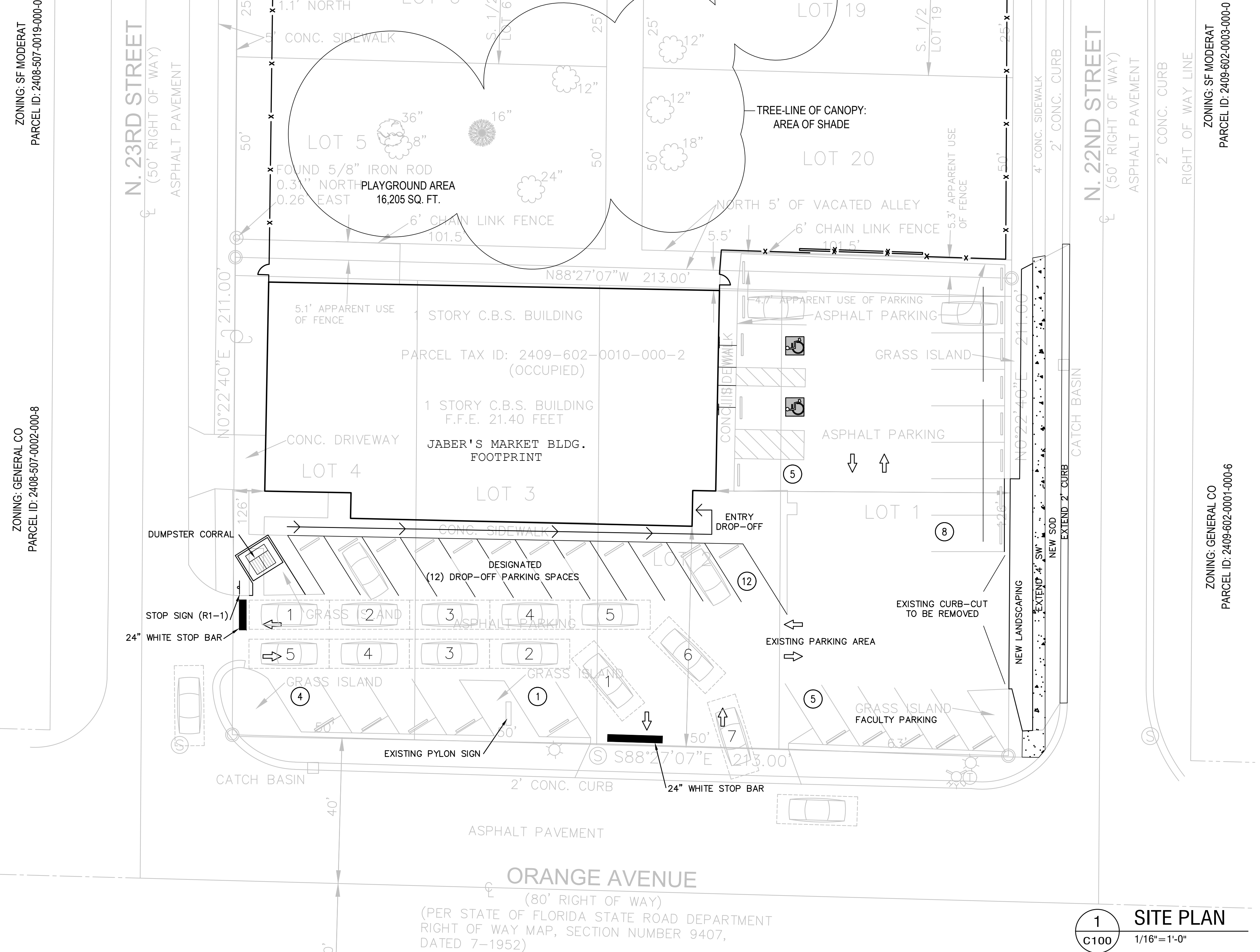

This item has been digitally signed and sealed by Harold Daniel Hutter III on the date adjacent to the seal.

Printed copies of this document are not considered signed and sealed and the signature must be verified on any electronic copies.



**1 SITE PLAN**  
C100 1/16"=1'-0"

ARCHITECT ENGINEER  
**LIS**  
CA NO. 6853 LB1057  
2372 West State Road, #26  
Suite 200  
Palm Bay, FL 32909  
Phone: (321) 244-0402  
Facsimile: (321) 244-9419

CLIENT NAME  
**JABERS MARKET, LLC**  
ANKUR SHAH  
930-3 MALABAR ROAD SE  
PALM BAY, FL 32907

PROJECT NAME  
**NEW ELITE ACADEMY**  
CONDITIONAL USE FOR A DAYCARE  
2210 Orange Ave  
FL 32909, FL 34950

SEAL  
HAROLD DANIEL HUTTER III  
FL LIC. AR88913

RELEASE	DATE

PROJECT NO. 2024-109

ISSUE DATE 07-29-24

DRAWN \_\_\_\_\_ CHECKED \_\_\_\_\_

SHEET NO.  
**C100**

LIS EXPRESSLY RESERVES ITS COPYRIGHT AND ALL OTHER PROPERTY RIGHTS TO THESE DOCUMENTS AND THEIR DESIGN. HENCE, THEY ARE NOT TO BE REPRODUCED.