

**KEY MAP**

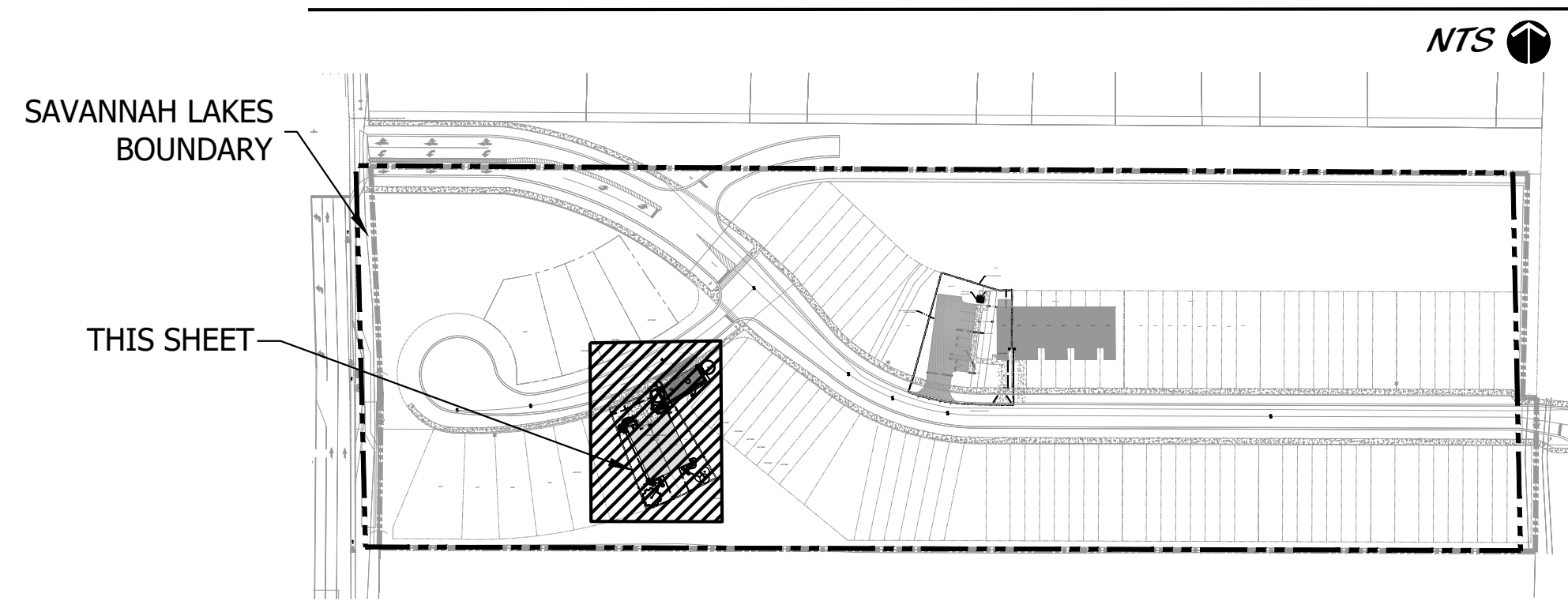

**PLANT SCHEDULE**

CODE	QTY	BOTANICAL NAME	COMMON NAME	CONTAINER	CALIPER	SIZE	NATIVE	REMARKS
<b>TREES</b>								
AM	1	ADONIDIA MERRILLII	CHRISTMAS PALM	NA	NA	6' CT	N	FULL CANOPY, SINGLE TRUNK, FL#1
CE	2	CONOCARPUS ERECTUS	GREEN BUTTONWOOD	65 GAL	2" DBH	12'-14' HT, 4'-6" SPRD	Y	FULL CANOPY
QV	1	QUERCUS VIRGINIANA	SOUTHERN LIVE OAK	65 GAL	2" CAL	12'-14' HT, 6'-8" SPD	Y	FULL CANOPY, FL#1
SS	3	SABAL PALMETTO	CABBAGE PALM	NA	NA	14' CT	Y	FULL AND THICK, SLICK TRUNK, FL#1
TR	1	THRINAX RADIATA	FLORIDA THATCH PALM	NA	NA	6' CT	Y	FULL CANOPY, SLICK TRUNK
<b>SHRUBS</b>								
CM3	15	CARISSA MACROCARPA	NATEL PLUM	3 GAL	3' X 3'	2' OC	N	FULL AND THICK
CI	10	CHRYSOBALANUS ICACO 'RED TIP'	RED TIP COCO PLUM	3 GAL	2' X 2'	2' OC	Y	FULL & THICK
CLG3	32	CLUSIA GUTTIFERA	SMALL LEAF CLUSIA	3 GAL	3' X 3'	3' OC	N	FULL & THICK
HC	6	HAMELIA PATENS 'COMPACTA'	DWARF FIREBUSH	3 GAL	3' X 3'	2' OC	Y	FULL AND THICK
SE	6	SCHEFFLERA ARBORICOLA 'DAZZLE'	DAZZLE SCHEFFLERA	3 GAL	3' X 3'	2' OC	N	FULL AND THICK
TD	3	TRIPSACUM DACTYLOIDES NANA	DWARF FAKAHATCHEE GRASS	1GAL	2' X 2'	1' OC	Y	FULL AND THICK
<b>GROUND COVERS</b>								
ID	18	ILEX VOMITORIA 'SHILLINGS DWARF'	SHILLINGS DWARF YAUPON HOLLY	1 GAL	1.5' X 1.5'	1.5' OC		FULL AND THICK
ZF	8	ZAMIA FLORIDANA	FLORIDA COONTIE	1 GAL	1.5' X 1.5'	1.5' OC	Y	FULL AND THICK

**MODEL ROW  
LANDSCAPE PLAN**

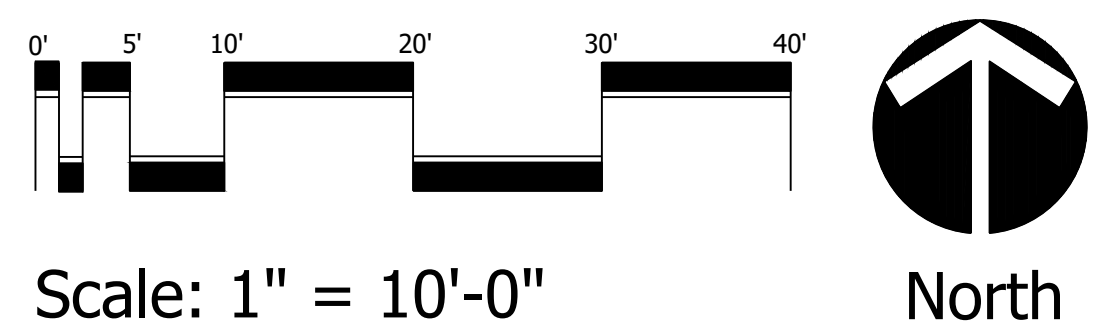

**Cotleur & Hearing**  
Landscape Architects  
Land Planners  
Environmental Consultants  
1934 Commerce Lane  
Suite 1  
Jupiter, Florida 33458  
www.cotleurhearing.com  
Lic# LC-C000239

**SAVANNAH LAKES**

Ft. Pierce, Florida

DESIGNED	VEJ/MJM
DRAWN	VEJ/MJM
APPROVED	LAH
JOB NUMBER	24-0401
DATE	08-04-25
REVISIONS	

**PLANTING DETAILS**

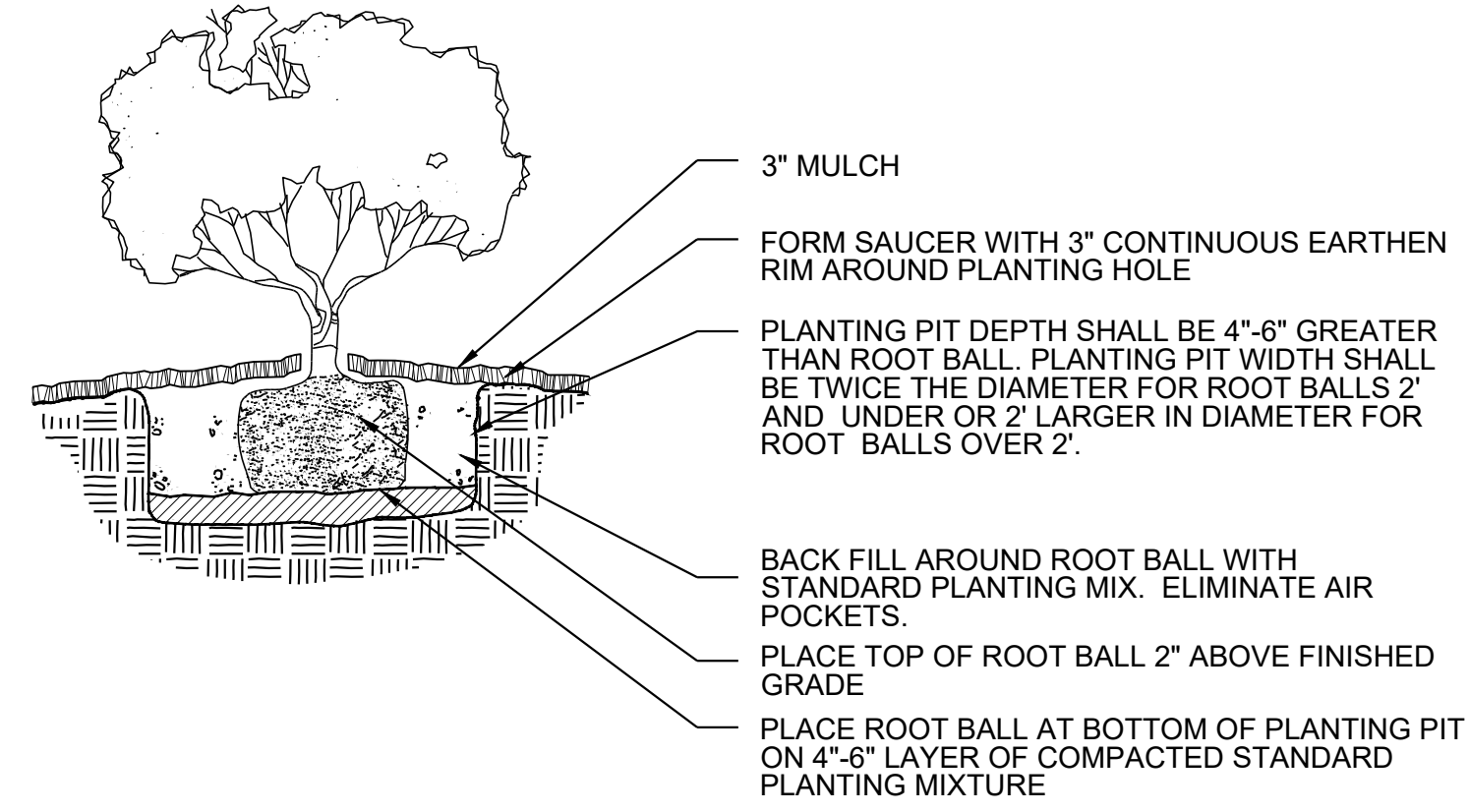

**SHRUB/GROUNDCOVER PLANTING DETAIL**

NTS

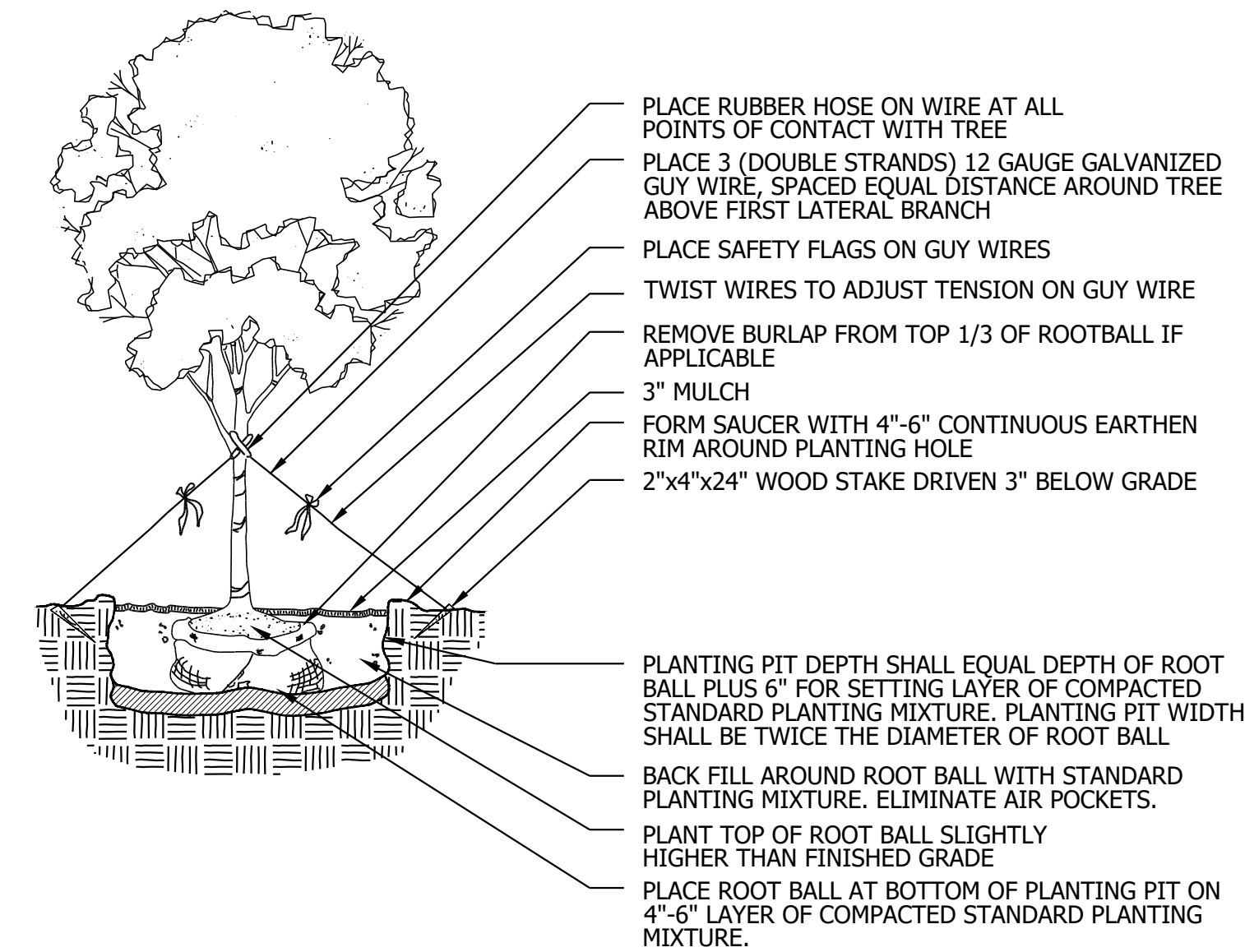

**LARGE TREE PLANTING DETAIL**

NTS

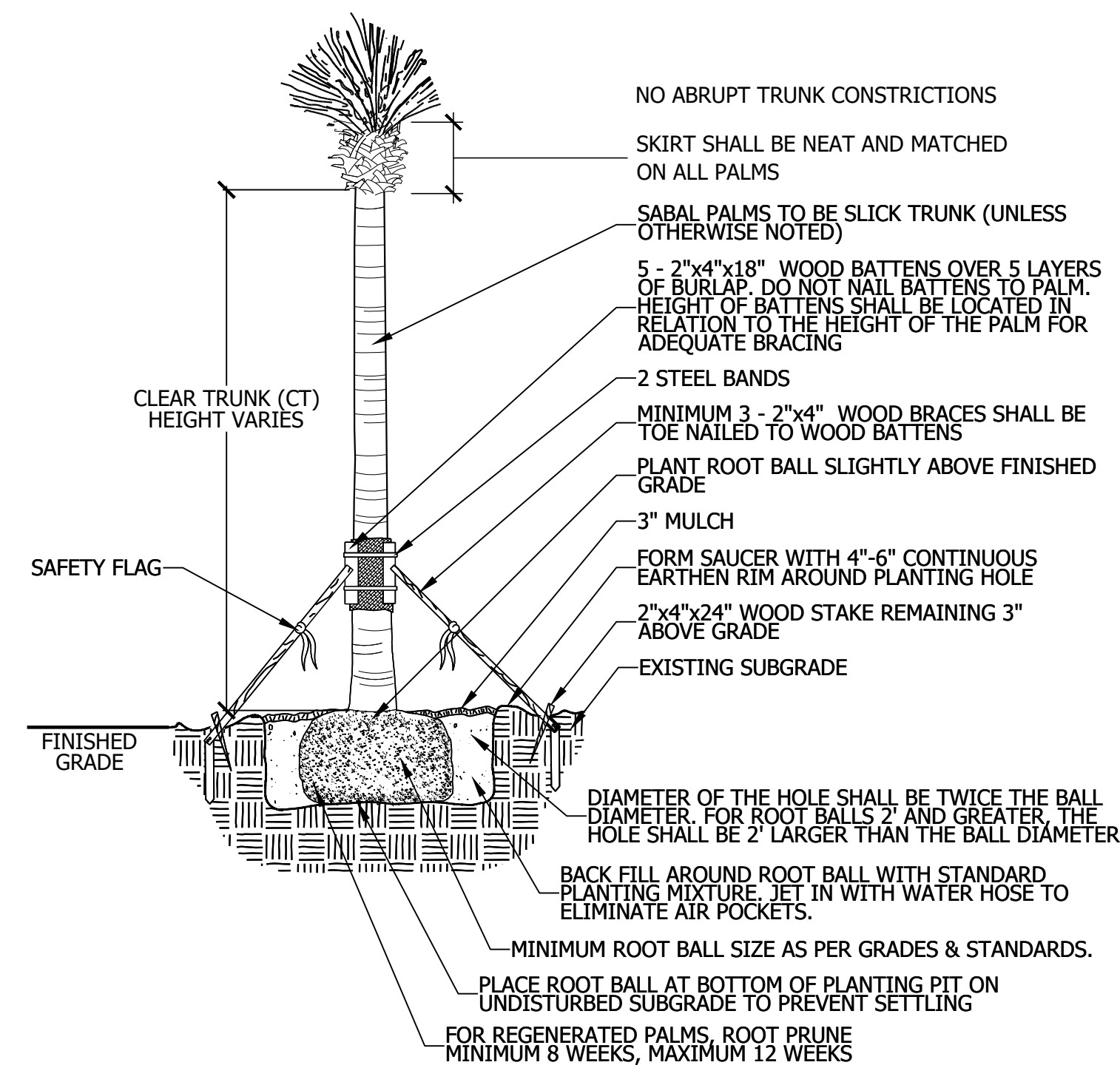

**PALM PLANTING DETAIL**

NTS

**LANDSCAPE NOTES**

ALL PLANT MATERIAL SHALL BE FLORIDA NUMBER 1 OR BETTER AS DEFINED BY THE DIVISION OF PLANT INDUSTRY 'FLORIDA GRADES AND STANDARDS' LATEST EDITION.

ALL LANDSCAPE SHALL CONFORM TO THE REQUIREMENTS OF FT. PIERCE LAND DEVELOPMENT REGULATIONS. FT. PIERCE LANDSCAPE CODE (LDRs) SHALL GOVERN IN THE EVENT OF A CONFLICT.

VEGETATION REMOVAL PERMITS ARE REQUIRED PRIOR TO REMOVING, CLEARING OR STRIPPING ANY VEGETATION FROM THE PROPERTY. AT THE TIME OF BUILDING PERMIT, THE APPLICANT SHALL EXECUTE HOLD HARMLESS AGREEMENTS WITH ALL APPLICABLE UTILITIES FOR LANDSCAPING WITHIN UTILITY EASEMENTS.

THE LANDSCAPE CONTRACTOR SHALL NOT MAKE ANY SUBSTITUTIONS AND/ OR CHANGES WITHOUT THE AUTHORIZATION OF FT. PIERCE, THE OWNER AND THE LANDSCAPE ARCHITECT.

THE LANDSCAPE CONTRACTOR SHALL REVIEW THE PROJECT DRAINAGE AND UTILITY PLANS PRIOR TO CONSTRUCTION AND AVOID ALL CONFLICTS. THE LANDSCAPE CONTRACTOR SHALL VERIFY THE LOCATION OF ALL UNDERGROUND UTILITIES PRIOR TO COMMENCING WORK. THE LANDSCAPE CONTRACTOR SHALL BE RESPONSIBLE FOR ALL PERMITS.

THE CONTRACTOR SHALL COORDINATE THE PLANTING AND TRIMMING OF STREET TREES TO ENSURE FULL VISIBILITY TO TRAFFIC CONTROL AND SAFETY SIGNAGE

TREES SHALL BE POSITIONED TO AVOID CONFLICTS WITH SIGNAGE AND SITE LIGHTING. LARGER TREES WILL BE PROVIDED AT INTERSECTIONS WHERE DEEMED NECESSARY.

ALL VEGETATION SHALL BE SELECTED AND POSITIONED SO THAT IT DOES NOT PRESENT OBSTRUCTIONS TO THE LINE OF SIGHT AT INTERSECTIONS PURSUANT TO SECTION 27-1262(a)(9)(c) OF FT. PIERCE CODE.

ALL ABOVE GROUND UTILITIES I.E. TRANSFORMERS, SWITCH BOXES, AC CONDENSERS AND ALIKE SHALL BE FULLY SCREENED FROM VIEW ON THREE SIDES WITH LANDSCAPING. THE LANDSCAPING SHALL TO THE TALLEST POINT OF SAID EQUIPMENT AT TIME OF PLANTING.

ALL TREES SHALL BE LOCATED WITHIN A MULCH PLANTING BED WITH A MINIMUM OF TWO (2) FEET OF CLEARANCE TO THE EDGE OF THE BED. SOD AND IRRIGATION SHALL BE INSTALLED IN ANY ADJACENT RIGHT OF WAY BETWEEN THE SIDEWALK AND THE CURB.

ALL SOD SHALL BE STENOTAPHRUM SECONDATUS FLORITAM-PALMETTO (ST. AUGUSTINE SOD).

TREES WITHIN PLANTING ISLANDS LESS THAN FIVE (5) FEET IN WIDTH SHALL BE LOCATED TO AVOID CONFLICTS WITH THE OVERHANG OF VEHICLES.

TYPE D RAISED CONCRETE CURBING SHALL BE PROVIDED AROUND ALL PLANTING ISLANDS WITHIN VEHICULAR USE AREAS.

TREES AT ENTRANCE WAYS AND WITHIN SIGHT TRIANGLES SHALL BE TRIMMED IN SUCH A FASHION TO MINIMIZE SITE VISIBILITY CONFLICTS. CLEAR VISIBILITY SHALL BE MAINTAINED BETWEEN 30 INCHES AND 7 FEET. TEN FOOT BY THIRTY FOOT SIGHT VISIBILITY TRIANGLES SHALL BE PROVIDED AT THE INTERSECTIONS WITH THE PUBLIC RIGHT OF WAY. IN ADDITION ALL LANDSCAPING SHALL CONFORM TO THE REQUIREMENTS OF FDOT INDEX 546.

EARTH BERMS SHALL NOT EXCEED A 3:1 SLOPE 4:1 SLOPES OR GREATER ARE PREFERABLE.

ALL TREES PLANTED UNDER OR ADJACENT TO FPL POWER LINES WILL COMPLY WITH THE FPL RIGHT TREE IN THE RIGHT PLACE GUIDELINES (REV 5/95)

PERIMETER TREES AT THE TIME OF PLANTING SHALL BE SPACED IN A WAY THAT COMPLEMENTS THE SPACING OF ANY EXISTING TREES ON ADJACENT DEVELOPED AREAS.

ALL LANDSCAPE ISLANDS AND BEDS SHALL BE FREE FROM SHELL ROCK AND CONSTRUCTION DEBRIS, EXCAVATED TO A DEPTH OF 30 INCHES OR TO CLEAN NATIVE SOILS AND FILLED WITH THE SPECIFIED BACKFILL MIXTURE.

ALL LANDSCAPE ISLANDS SHALL INCORPORATE THE INSTALLATION OF MOUNDING OF NATIVE SOILS A MINIMUM OF SIX INCHES (6") ABOVE THE TOP OF CURB.

19.5" 'BIO BARRIER' ROOT BARRIER SHALL BE PROVIDED FOR SHADE TREES PLANTED WITHIN SIX (6') FEET OF PUBLIC CURBS, SIDEWALKS OR PUBLIC RIGHT OF WAYS. ALL ROOT BARRIER SHALL BE INSTALLED IN ACCORDANCE WITH THE MANUFACTURES RECOMMENDATIONS. THE TOTAL LENGTH OF THE ROOT BARRIERS SHALL BE 20' ADJACENT TO THE SIDEWALK AND 20' ADJACENT TO THE CURB.

ALL AREAS SHALL BE FULLY IRRIGATED BY AUTOMATIC MEANS IN ACCORDANCE WITH THE REQUIREMENTS OF FT. PIERCE. THE IRRIGATION WATER SOURCE SHALL BE WELL WATER FOR COMMON AREAS AND POTABLE WATER AROUND THE BUILDING FOUNDATION.

CATCH BASINS AND DRAINAGE SHALL NOT BE LOCATED WITHIN REQUIRED PERIMETER BUFFERS OR PRESERVE AREAS.

THE IRRIGATION SYSTEM SHALL BE DESIGNED TO PROVIDE 100% OVERLAP COVERAGE TO ALL LANDSCAPE AND SOD AREAS.

THE IRRIGATION SYSTEM SHALL BE EQUIPPED WITH A RAIN SENSOR/CUT OFF SWITCH IN ACCORDANCE WITH STATE AND LOCAL REQUIREMENTS.

EXISTING TREES AND VEGETATION TO REMAIN SHALL BE STAKED AND BARRICADED PRIOR TO ANY LAND CLEARING. TREES TO BE RELOCATED SHALL BE ROOT PRUNED AND PROTECTED DURING CONSTRUCTION.

ALL TREES PROPOSED TO BE PRESERVED ON SITE SHALL BE PROTECTED IN ACCORDANCE WITH THE PROCEDURES OUTLINED IN DIVISION IV., VEGETATION REMOVAL REQUIREMENTS IN THE FT. PIERCE CODE PRIOR TO THE ISSUANCE OF A C.O.

ANY AREA DESIGNATED WITH EXISTING VEGETATION TO REMAIN THAT IS DISTURBED DURING CONSTRUCTION WILL BE RESTORED WITH NATIVE PLANTINGS.

EXISTING TREES PRESERVED OR RELOCATED ON SITE SHALL BE PRUNED ACCORDING TO ANSI A300 STANDARDS OR BY AN ISA CERTIFIED ARBORIST.

ALL EXISTING LANDSCAPING AND TREES TO REMAIN SHALL BE BARRICADED WITH ORANGE CONSTRUCTION BARRICADE. THE BARRICADE SHALL BE INSTALLED AT THE DRIP LINE OF THE TREE/PALM OR AT THE EDGE OF THE SHRUB MASS. BARRICADES SHALL REMAIN IN PLACE THROUGHOUT THE DURATION OF CONSTRUCTION.

EXISTING, SUITABLE NATIVE VEGETATION LOCATED WITHIN THE PROPOSED DEVELOPMENT AREAS SHALL BE RELOCATED TO SUPPLEMENT THE LANDSCAPING. NATIVE VEGETATION SHALL BE RELOCATED BY TREE SPADE OR CRANE. PRIOR TO THE CLEARING OF THE SITE THE APPLICANT SHALL IDENTIFY ALL NATIVE VEGETATION TO BE RELOCATED.

RELOCATION METHODOLOGY: EXISTING NATIVE VEGETATION DETERMINED TO BE SUITABLE FOR RELOCATION SHALL BE RELOCATED TO TARGET AREAS USING HYDROLOGIC TREE SPADES. THE SIZE OF SPADE SHALL VARY FROM 90" TO 45" DEPENDING ON THE SIZE AND TYPE OF VEGETATION TO BE MOVED. THE APPLICANT SHALL IDENTIFY PRIOR TO THE CLEARING OF THE SITE ALL EXISTING NATIVE VEGETATION TO BE RELOCATED. FOLLOWING RELOCATION, VEGETATION SHALL BE WATERED DAILY.

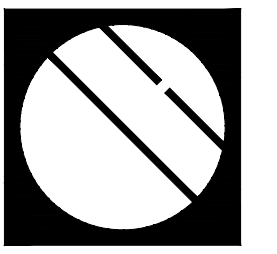

**Cotleur & Hearing**

Landscape Architects  
Land Planners  
Environmental Consultants  
1934 Commerce Lane  
Suite 1  
Jupiter, Florida 33458

www.cotleurhearing.com  
Lic# LC-C000239

**SAVANNAH LAKES**

Ft. Pierce, Florida

DESIGNED	VEJ/MJM
DRAWN	VEJ/MJM
APPROVED	LAH
JOB NUMBER	24-0406
DATE	08-04-25
REVISIONS	

**LANDSCAPE DETAILS**

SHEET 2 OF 2

© COTLEUR & HEARING, INC.  
These drawings are the property of the architect and are not to be used for extensions or on other projects except by agreement in writing with the architect. Immediately report any discrepancies to the architect.