

Schedule	Symbol	Label	Image	QTY	Manufacturer	Catalog	Description	Number	Lamp	Output	LLF	Input	Polar Plot
A	⤴	A		9	Lithonia Lighting	DSX1 LED P8 40K 80CRI T3M	D-Series Size 1 Area Luminaire P8 Performance Package 4000K CCT 80 CRI Type 3 Medium	1	25719	1	215.77		
B	⤴	B		18	Lithonia Lighting	DSXW1 P6 40K 80CRI T3M	7000 4000K 80CRI Type 3 Medium	1	6454	1	48.25		
C	⤴	C		1	Lithonia Lighting	DSX1 LED P8 40K 80CRI T3M	D-Series Size 1 Area Luminaire P8 Performance Package 4000K CCT 80 CRI Type 3 Medium	1	25719	1	431.54		
D	⤴	D		2	Lithonia Lighting	DSX1 LED P8 40K 80CRI T3M	D-Series Size 1 Area Luminaire P8 Performance Package 4000K CCT 80 CRI Type 3 Medium	1	25719	1	647.31		
E	⤴	E		1	Lithonia Lighting	DSX1 LED P8 40K 80CRI T3M	D-Series Size 1 Area Luminaire P8 Performance Package 4000K CCT 80 CRI Type 3 Medium	1	25719	1	863.08		

TYPE	MANUFACTURER	CATALOG NUMBER	VA	TEMP	VOLTS	LUMENS	MOUNT	REMARKS
S1	LITHONIA	DSXW1-LED-200-100-40K-T3M-MVOLT-F-P8-DBVD	74 VA	4000K	120/277	7973	WALL	DECORATIVE WALL PACK WITH PHOTOCELL
A3	LITHONIA	DSX1-LED-P8-40K-T3M-MVOLT-MOUNTING-FINISH	207 VA	4000K	120/277	24288	26 POLE	PARKING/SITE LIGHTING TYPE 3 DISTRIBUTION

Description	Symbol	Avg	Max	Min	Max/Min	Avg/Min
Calc Zone #2	+	5.1 fc	26.6 fc	0.1 fc	266.0:1	51.0:1

D-Series Size 1 Legacy LED Area Luminaire

Specifications
 EPA: 1.01 ft
 Length: 33"
 Width: 13"
 Height H1: 7.10"
 Height H2: 3.10"
 Weight (max): 27.85 lbs

Introduction
 The modern styling of the D-Series is striking yet understated, making a bold, progressive statement even as it blends seamlessly with its environment. The D-Series distills the benefits of the latest in LED technology into a high performance, high efficacy, long-life luminaire.

The outstanding photometric performance results in sites with excellent uniformity, greater pole spacing and lower power density. It is ideal for replacing up to 750W metal halide in pedestrian and area lighting applications with typical energy savings of 65% and expected service life of over 100,000 hours.

Series	LEDs	Color Temperature	Distribution	Voltage	Mounting
DSX1LED	F1	30K	3000K	F16	Spot/Recess*
	F1	40K	4000K	F16	Spot/Recess*
	F1	50K	5000K	F16	Spot/Recess*

Mounting Option	Finish	Mounting	Accessories
Shipped installed	RR	High Bay, recessed in ceiling, 8-12' mounting height, luminaire enclosed in a 6" R	0000
Shipped separately	RR	High Bay, recessed in ceiling, 8-12' mounting height, luminaire enclosed in a 6" R	0000

One Lithonia Way • Conyers, Georgia 30621 • Phone: 1-800-765-5876 (5766) • Fax: 770-932-3100
 © 2013 Lithonia Lighting Inc. All rights reserved.

SSA Square Straight Aluminum Pole No Arm — 4-Bolt Base

Specifications
 Pole Cap - Aluminum
 Pole Diameter - 4" (4" NPT)
 Pole Material - 6061-T6 Aluminum
 Pole Finish - Clear Anodized

Base Style
 4-Bolt Cast Aluminum
 Base Diameter - 4" (4" NPT)
 Base Material - 6061-T6 Aluminum
 Base Finish - Clear Anodized

Handhole
 4" x 8" Butt Square
 2" x 4" Handhole with square top
 5/8" Aluminum Door and two (2) Stainless Steel Self-Closing Latching Screws A Grounding Provision incorporating a 1/4" x 3/8" GND Grounding Provision is provided outside the handhole.

Anchor
 4" x 8" Butt Square
 2" x 4" Handhole with square top
 5/8" Aluminum Door and two (2) Stainless Steel Self-Closing Latching Screws A Grounding Provision incorporating a 1/4" x 3/8" GND Grounding Provision is provided outside the handhole.

Vibration Damper
 A damper is recommended for use in all areas where the pole is exposed to wind. A 1/2" x 1/2" x 1/2" Vibration Damper will be provided. Customer specification of the damper is available.

Mounting Destination
 Side Wall Mount
 For Side Wall Mount applications, specify luminaire size, quantity and location. A luminaire safety bracket must be supplied at time of order.

Notes
 1. Customized mounting for poles in all areas. And included First Made Vibration Damper will be provided. Customer specification of the damper is available.

D-Series Size 1 LED Wall Luminaire

Specifications
 Luminaire: 15.34" (394mm) H x 12.8" (325mm) W
 Depth: 10" (254mm)
 Height: 6.38" (162mm)

Back Box (BBW, E20WC)
 BBW: 15.34" (394mm) H x 12.8" (325mm) W
 E20WC: 10" (254mm) H x 12.8" (325mm) W

Introduction
 The D-Series Wall Luminaire is a stylish, fully integrated LED solution for building-mount applications. It features a sleek, modern design and is carefully engineered to provide long-lasting, energy-efficient lighting with a variety of optical and control options for customized performance. With an expected service life of over 20 years of nighttime use and significant energy savings, the D-Series Wall is a reliable, low-maintenance lighting solution that produces sites that are exceptionally illuminated.

Series	Luminaire Package	LED	Color	Temp	Volts	Mounting	Control System
DSX1LED	F1	200 Lumens	27K	2700K	120/277	Spot/Recess*	0000
	F1	200 Lumens	30K	3000K	120/277	Spot/Recess*	0000
	F1	200 Lumens	40K	4000K	120/277	Spot/Recess*	0000
	F1	200 Lumens	50K	5000K	120/277	Spot/Recess*	0000
	F1	200 Lumens	50K	5000K	120/277	Spot/Recess*	0000
	F1	200 Lumens	50K	5000K	120/277	Spot/Recess*	0000

Mounting Option	Finish	Mounting	Accessories
Shipped installed	RR	High Bay, recessed in ceiling, 8-12' mounting height, luminaire enclosed in a 6" R	0000
Shipped separately	RR	High Bay, recessed in ceiling, 8-12' mounting height, luminaire enclosed in a 6" R	0000

One Lithonia Way • Conyers, Georgia 30621 • Phone: 1-800-765-5876 (5766) • Fax: 770-932-3100
 © 2013 Lithonia Lighting Inc. All rights reserved.

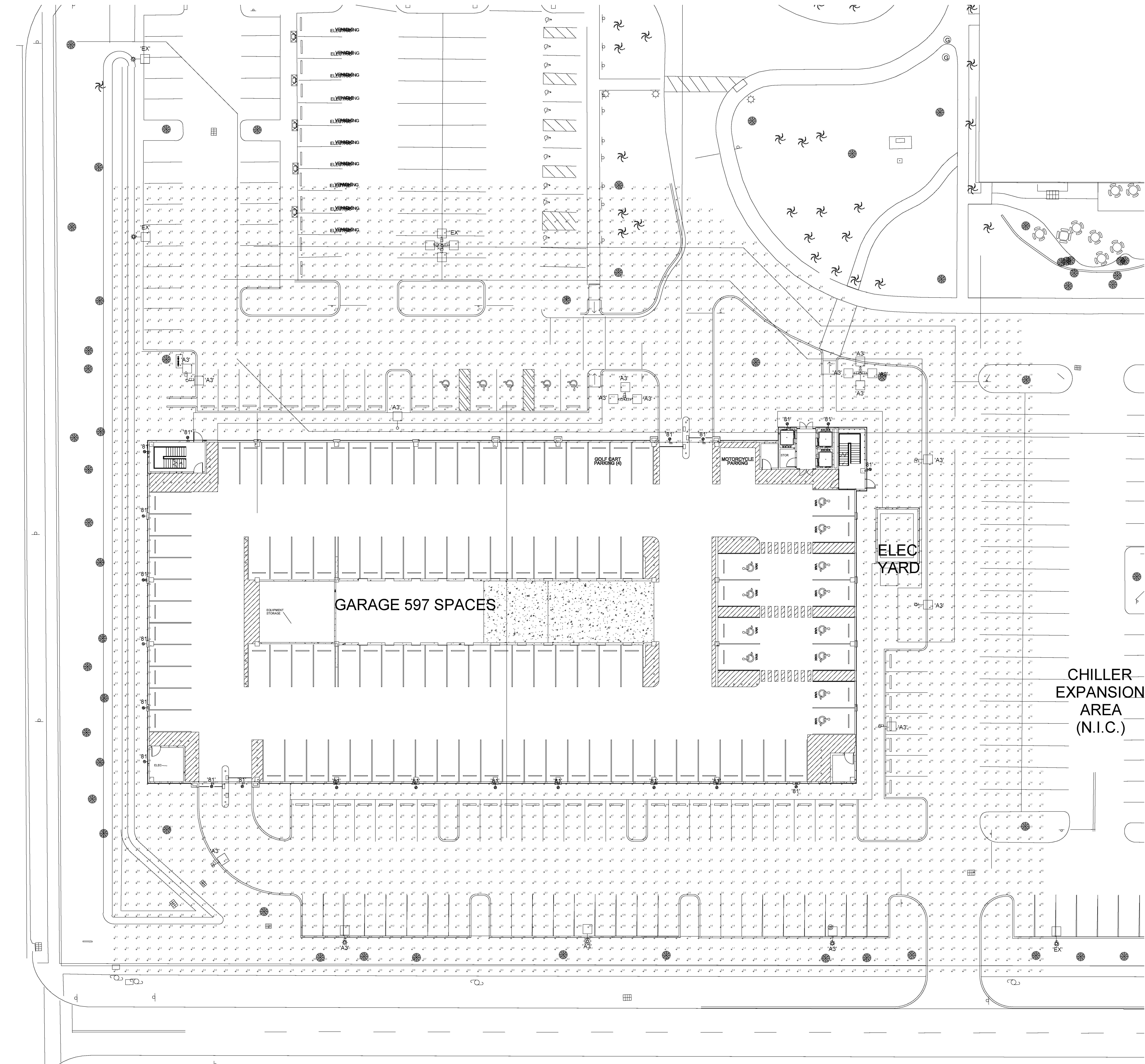

ELECTRICAL - SITE PHOTOMETRIC PLAN

FOR PERMIT - NOT FOR CONSTRUCTION

GENERAL CONTRACTOR

REVISIONS

DATE: 05/16/2013

DESIGN SOLUTIONS

HCA FLORIDA LAWNWOOD PARKING GARAGE

1700 S. 23RD STREET FORT PIERCE, FL 34960

M/P & CONSULTANT

STRUCTURAL CONSULTANT

CIVIL CONSULTANT

VENDOR INFORMATION

HCA HEALTHCARE HCA DESIGN MANAGER: RYAN ROHE HCA CONSTRUCTION MANAGER: GREG ATANSON

ELECTRICAL - SITE PHOTOMETRIC PLAN

ES.02