

MATCHLINE SEE SHEET 7

MATCHLINE SEE SHEET 1

**PH-II BLDG
530,230 SF
30 KSF OFFICE
500 KSF WAREHOUSE**

**PARCEL II
26.36 AC**

MATCHLINE SEE SHEET 3

LOCATION MAP

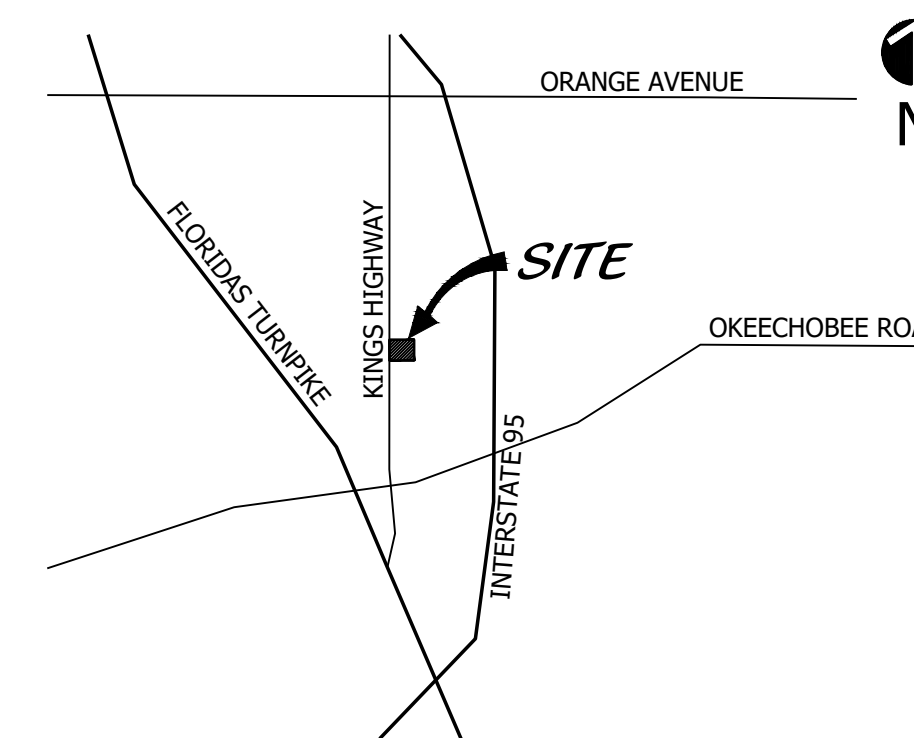

SHEET LAYOUT MAP

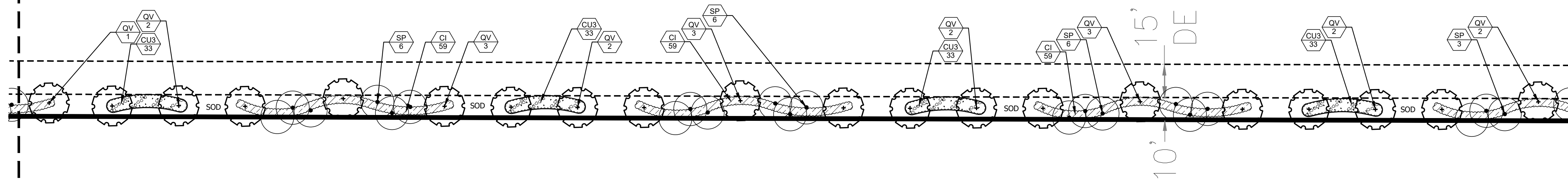
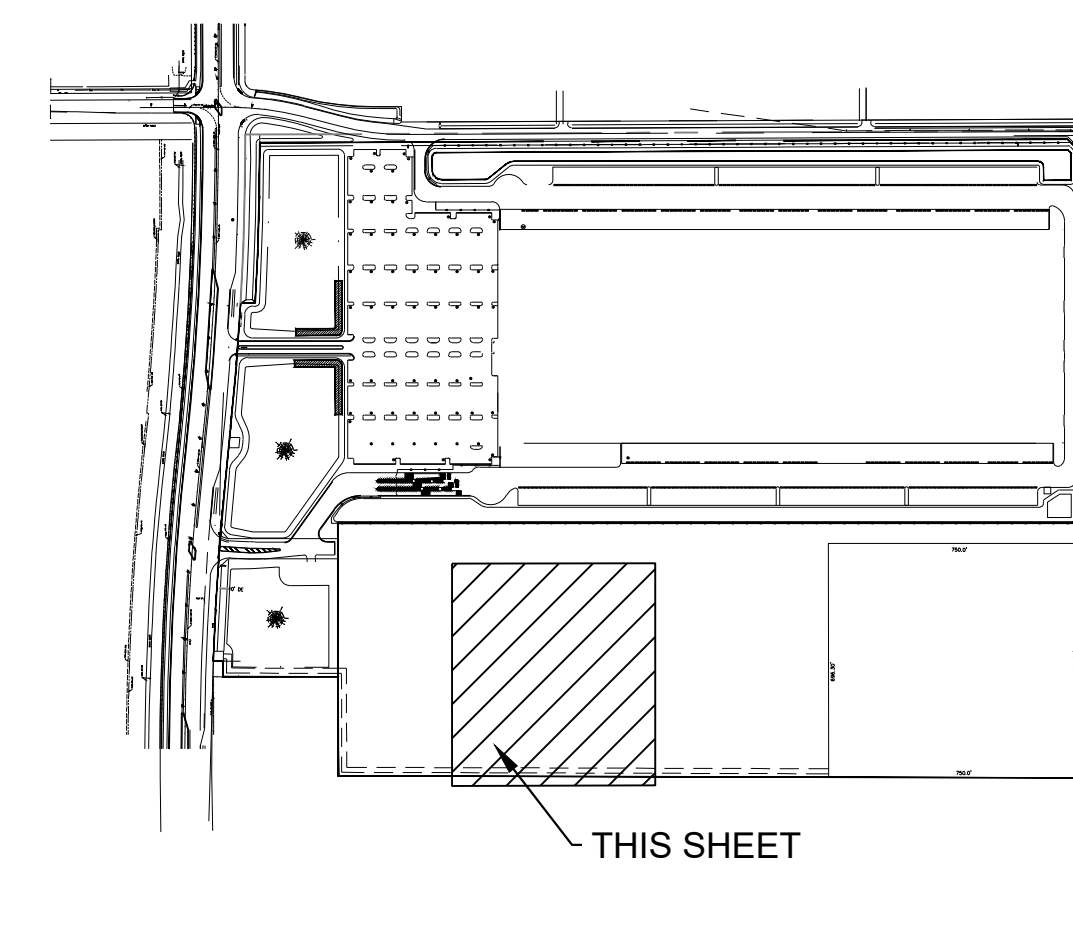

Landscape Plan

48 HOURS BEFORE DIGGING
CALL TOLL FREE
811
SUNSHINE STATE ONE CALL
OF FLORIDA, INC.

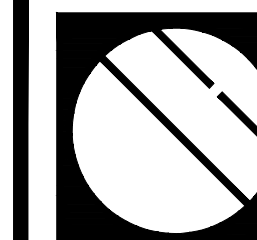
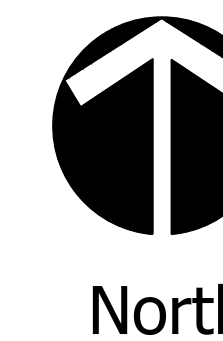

Cotleur & Hearing

Landscape Architects
Land Planners
Environmental Consultants
1934 Commerce Lane
Suite 1
Jupiter, Florida 33458
561.747.6336 · Fax 747.1377
www.cotleurhearing.com
Lic# LC-26000535

King's Highway Commerce Park
Landscape Plan
City of Fort Pierce, Florida

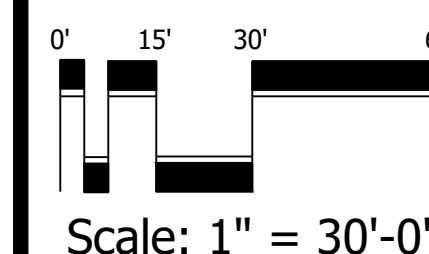

Scale: 1" = 30'-0"

DESIGNED	GB
DRAWN	WM
APPROVED	GB
JOB NUMBER	25-1202
DATE	12/23/25
REVISIONS	

December 15, 2025 12:48:03 p.m.
Drawing: 24-1112 LP.DWG

SHEET **2** OF **13**

© COTLEUR & HEARING, INC.
These drawings are the property of the architect and are not to be used for extensions or on other projects except by agreement in writing with the architect. Immediately report any discrepancies to the architect.

MATCHLINE SEE SHEET 11

PARCEL III
69.19 AC

PROPOSED BUILDING
1,070,080 SF

MATCHLINE SEE SHEET 7

MATCHLINE SEE SHEET 5

LOCATION MAP

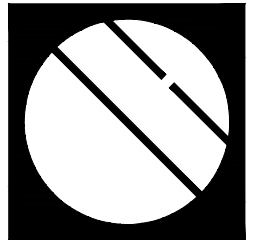
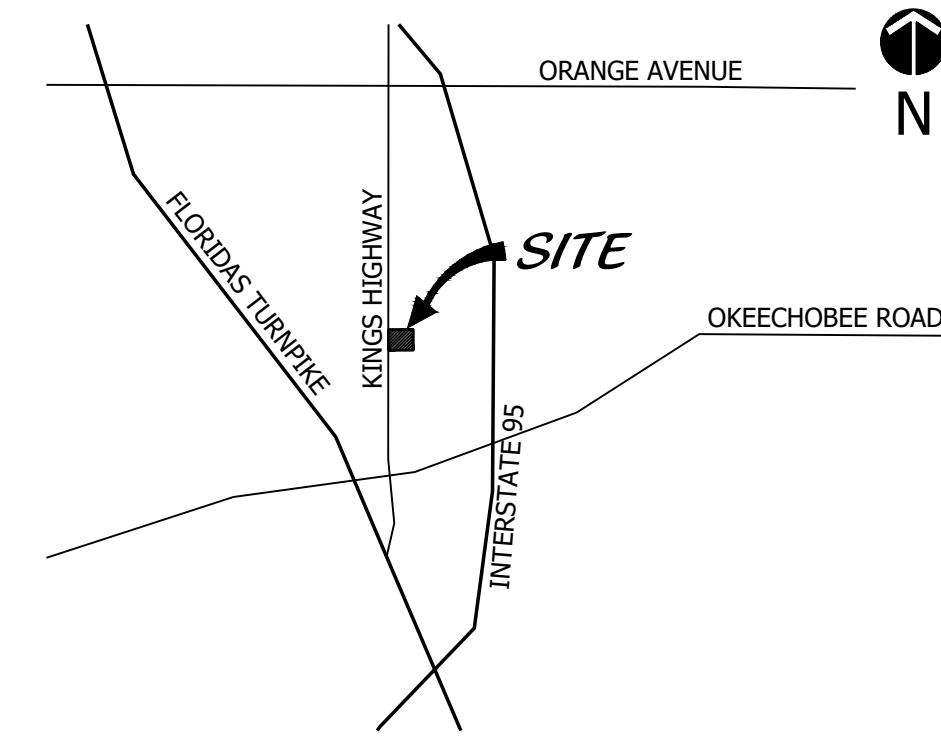

Cotleur & Hearing

Landscape Architects
Land Planners
Environmental Consultants
1934 Commerce Lane
Suite 1
Jupiter, Florida 33458
561.747.6336 · Fax 747.1377
www.cotleurhearing.com
Lic# LC-26000535

King's Highway Commerce Park
Landscape Plan
City of Fort Pierce, Florida

SHEET LAYOUT MAP

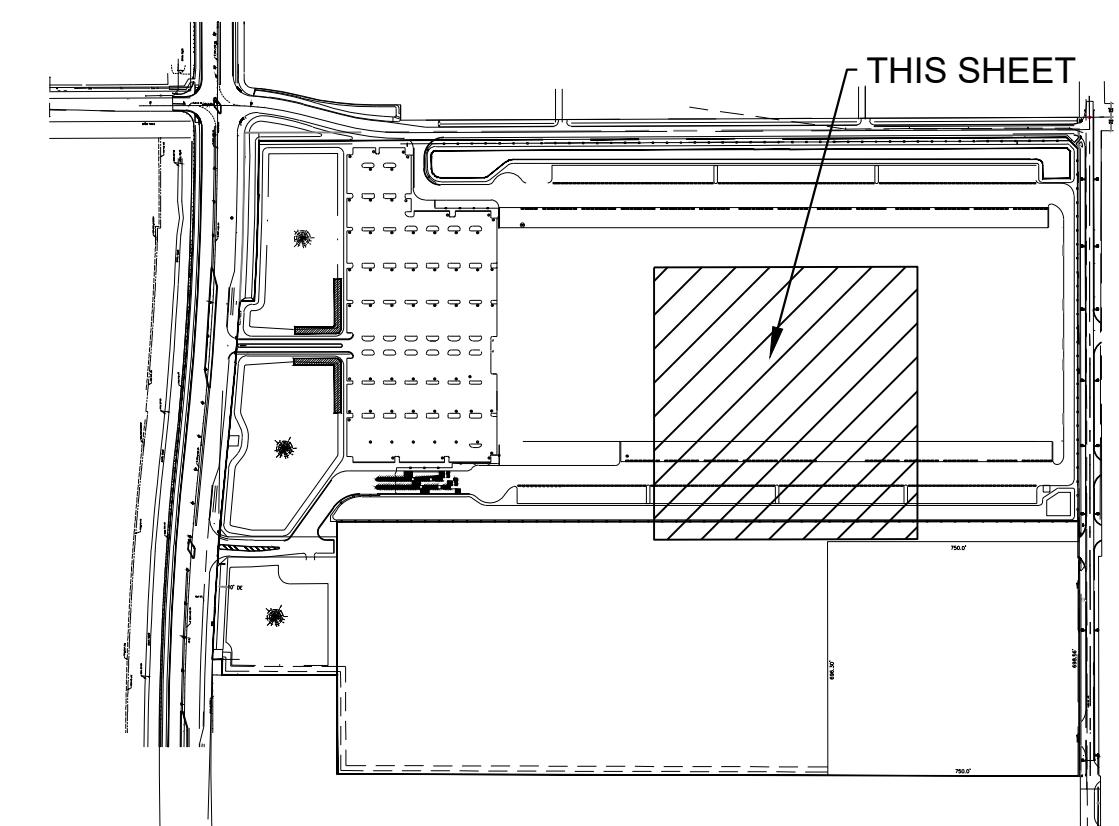

Landscape Plan

48 HOURS BEFORE DIGGING
CALL TOLL FREE
811
SUNSHINE STATE ONE CALL
OF FLORIDA, INC.



0' 15' 30' 60'
Scale: 1" = 30'-0"

DESIGNED	GB
DRAWN	WM
APPROVED	GB
JOB NUMBER	25-1202
DATE	12/23/25
REVISIONS	

December 15, 2025 12:48:03 p.m.
Drawing: 24-1112 LP.DWG

SHEET **6** OF **13**
© COTLEUR & HEARING, INC.
These drawings are the property of the architect and are not to be used for extensions or on other projects except by agreement in writing with the architect. Immediately report any discrepancies to the architect.

DRY DET-2 2.52 AC

TOP OF DETENTION, TYP.

MATCHLINE SEE SHEET 3

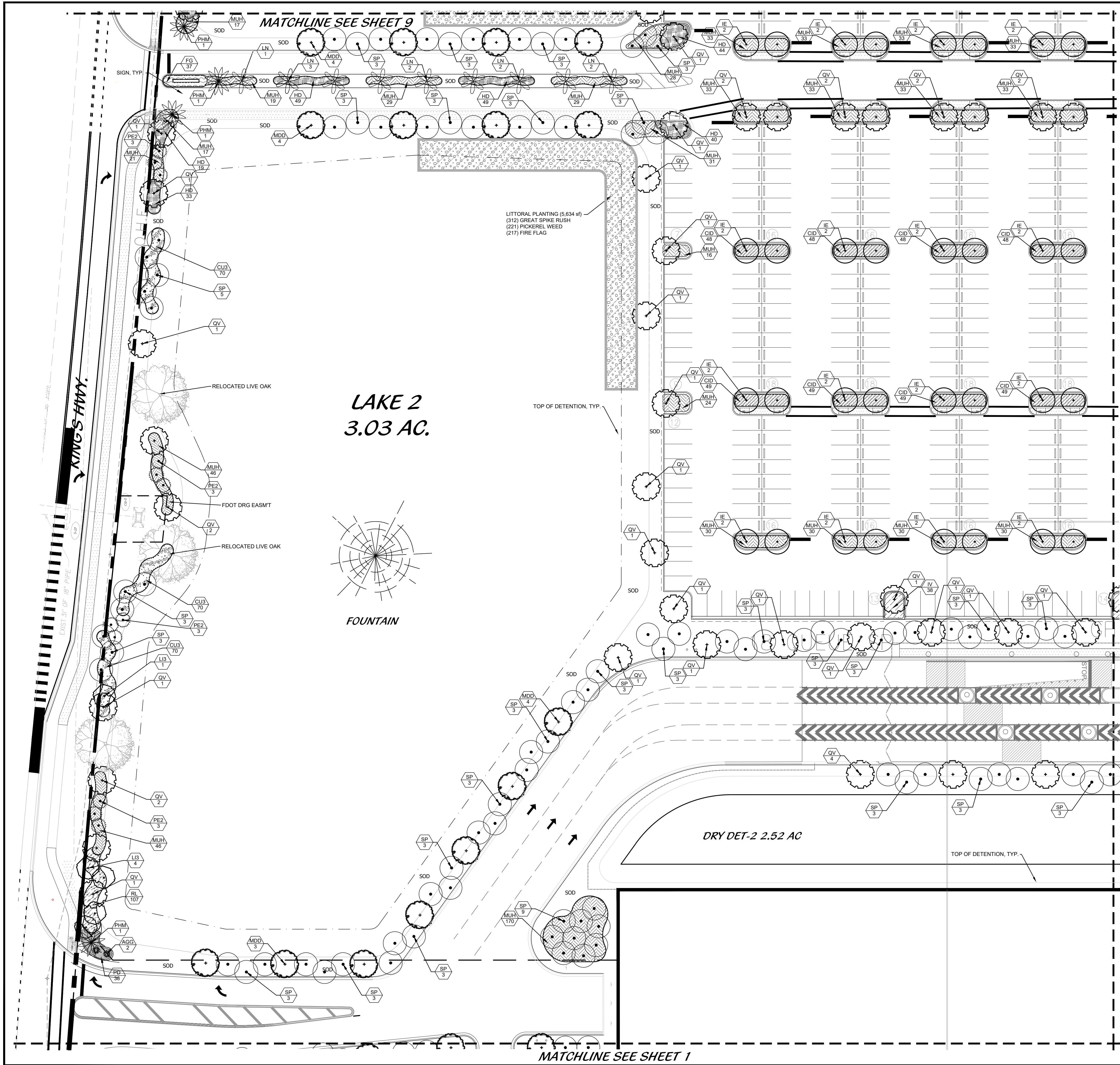

LOCATION MAP

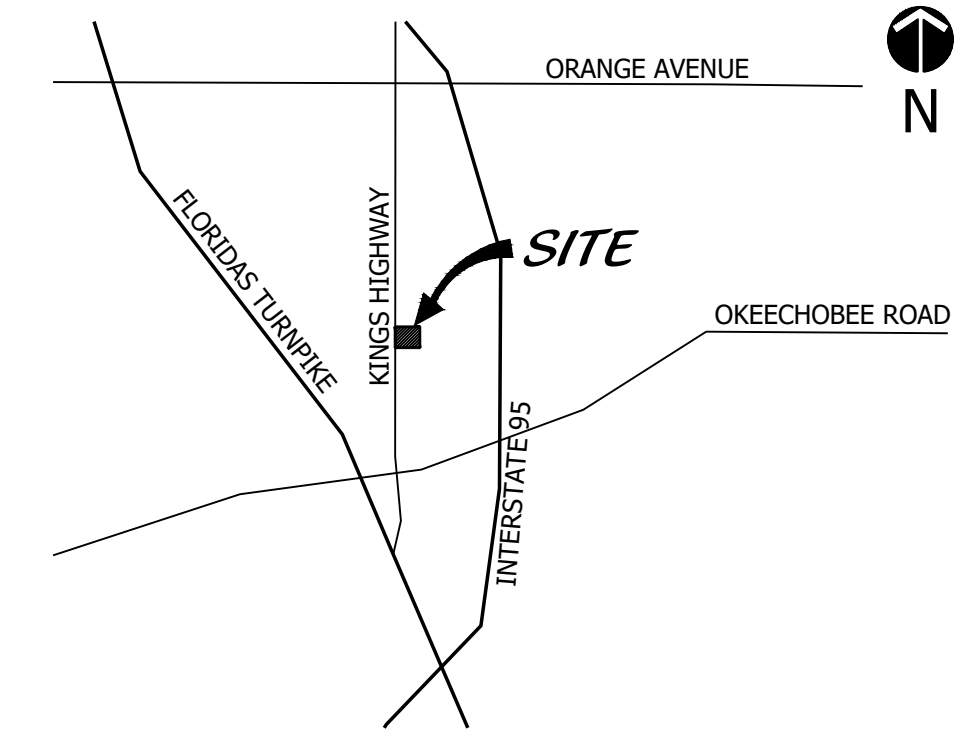

SHEET LAYOUT MAP

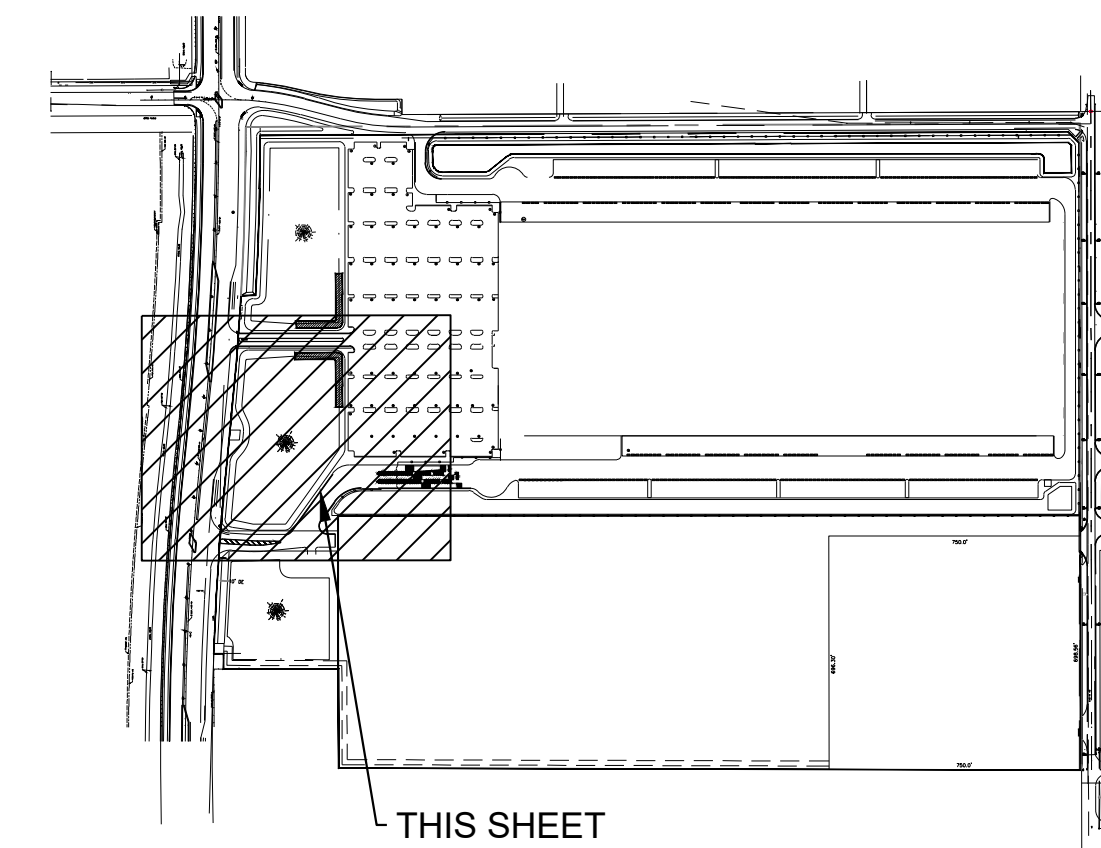

Landscape Plan

48 HOURS BEFORE DIGGING
CALL TOLL FREE
811
SUNSHINE STATE ONE CALL
OF FLORIDA, INC.

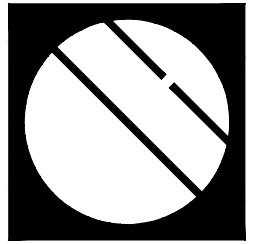

Cotleur & Hearing

Landscape Architects
Land Planners
Environmental Consultants
1934 Commerce Lane
Suite 1
Jupiter, Florida 33458
561.747.6336 · Fax 747.1377
www.cotleurhearing.com
Lic# LC-26000535

King's Highway Commerce Park
Landscape Plan
City of Fort Pierce, Florida

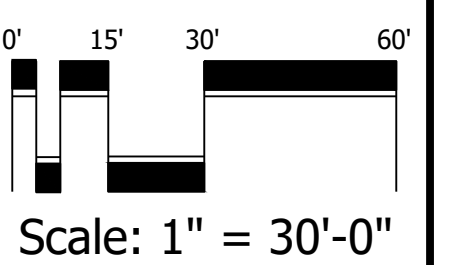

DESIGNED	GB
DRAWN	WM
APPROVED	GB
JOB NUMBER	25-1202
DATE	12/23/25
REVISIONS	

December 15, 2025 12:48:03 p.m.
Drawing: 24-1112 LP.DWG

SHEET **8** OF 13

© COTLEUR & HEARING, INC.
These drawings are the property of the architect and are not to be used for extensions or on other projects except by agreement in writing with the architect. Immediately report any discrepancies to the architect.

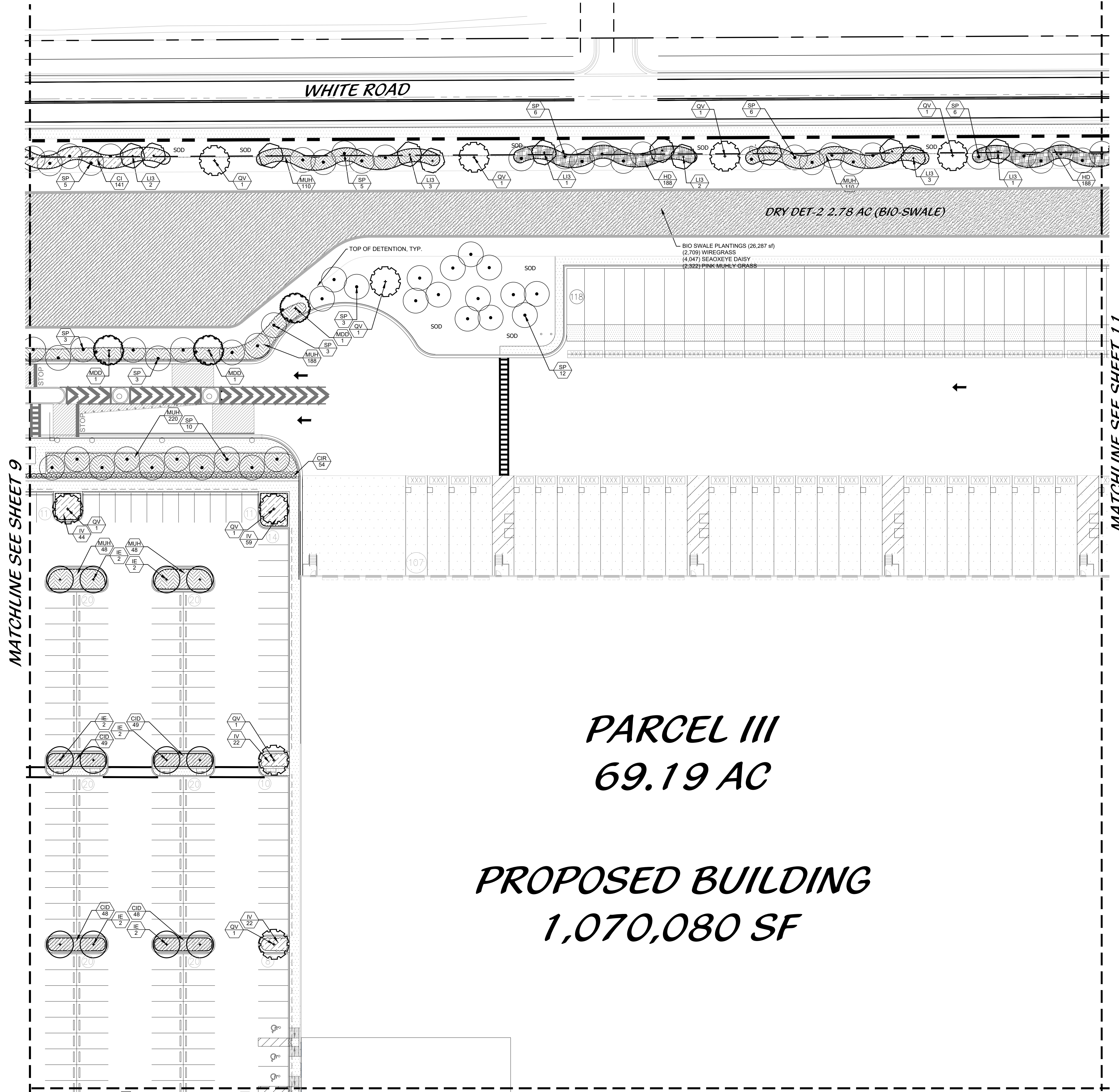

LOCATION MAP

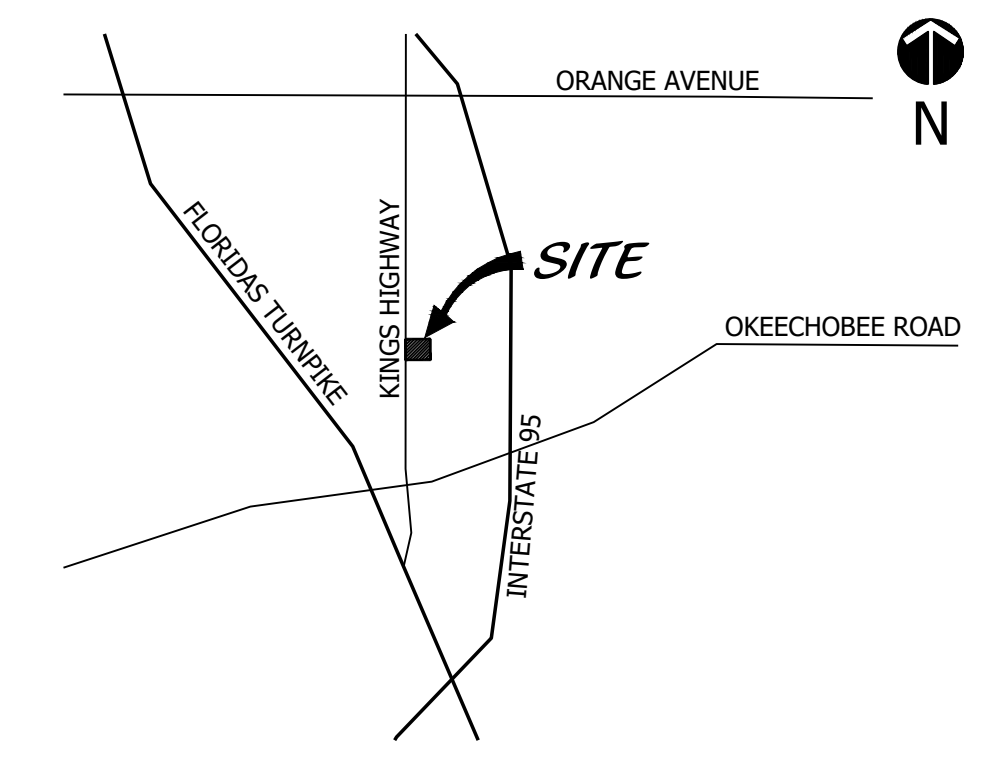

MATCHLINE SEE SHEET 9

MATCHLINE SEE SHEET 11

MATCHLINE SEE SHEET 7

PARCEL III
69.19 AC

PROPOSED BUILDING
1,070,080 SF

SHEET LAYOUT MAP

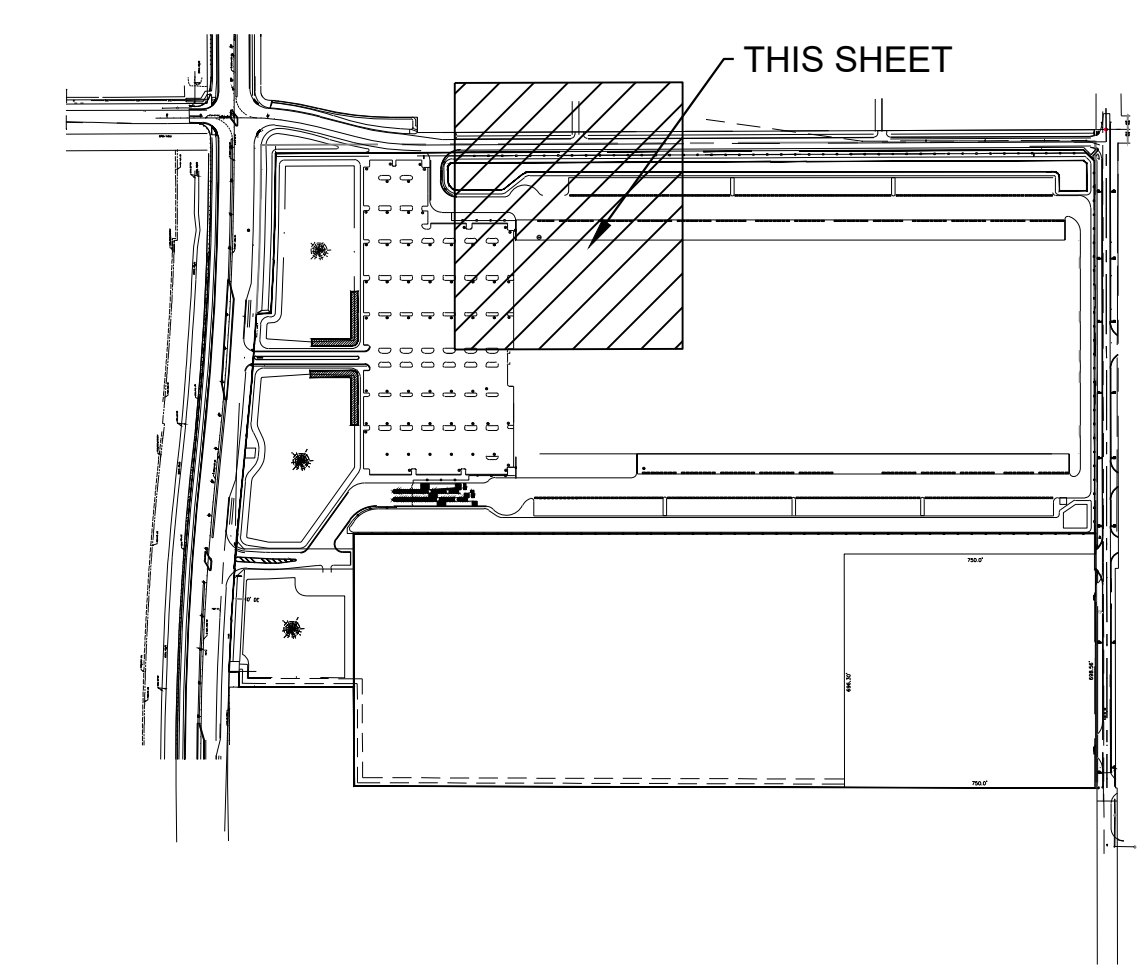

Landscape Plan

48 HOURS BEFORE DIGGING
CALL TOLL FREE
811
SUNSHINE STATE ONE CALL
OF FLORIDA, INC.

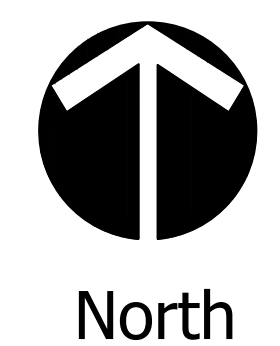

Cotleur & Hearing
Landscape Architects
Land Planners
Environmental Consultants
1934 Commerce Lane
Suite 1
Jupiter, Florida 33458
561.747.6336 · Fax 747.1377
www.cotleurhearing.com
Lic# LC-26000535

King's Highway Commerce Park
Landscape Plan
City of Fort Pierce, Florida

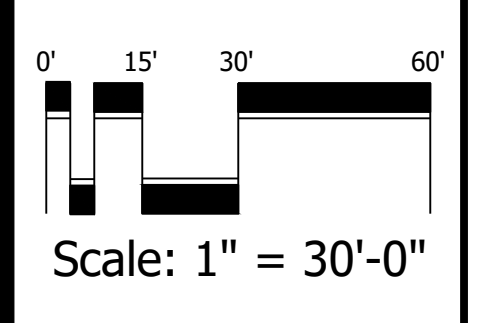

DESIGNED	GB
DRAWN	WM
APPROVED	GB
JOB NUMBER	25-1202
DATE	12/23/25
REVISIONS	

December 15, 2025 12:48:03 p.m.
Drawing: 24-1112 LP.DWG

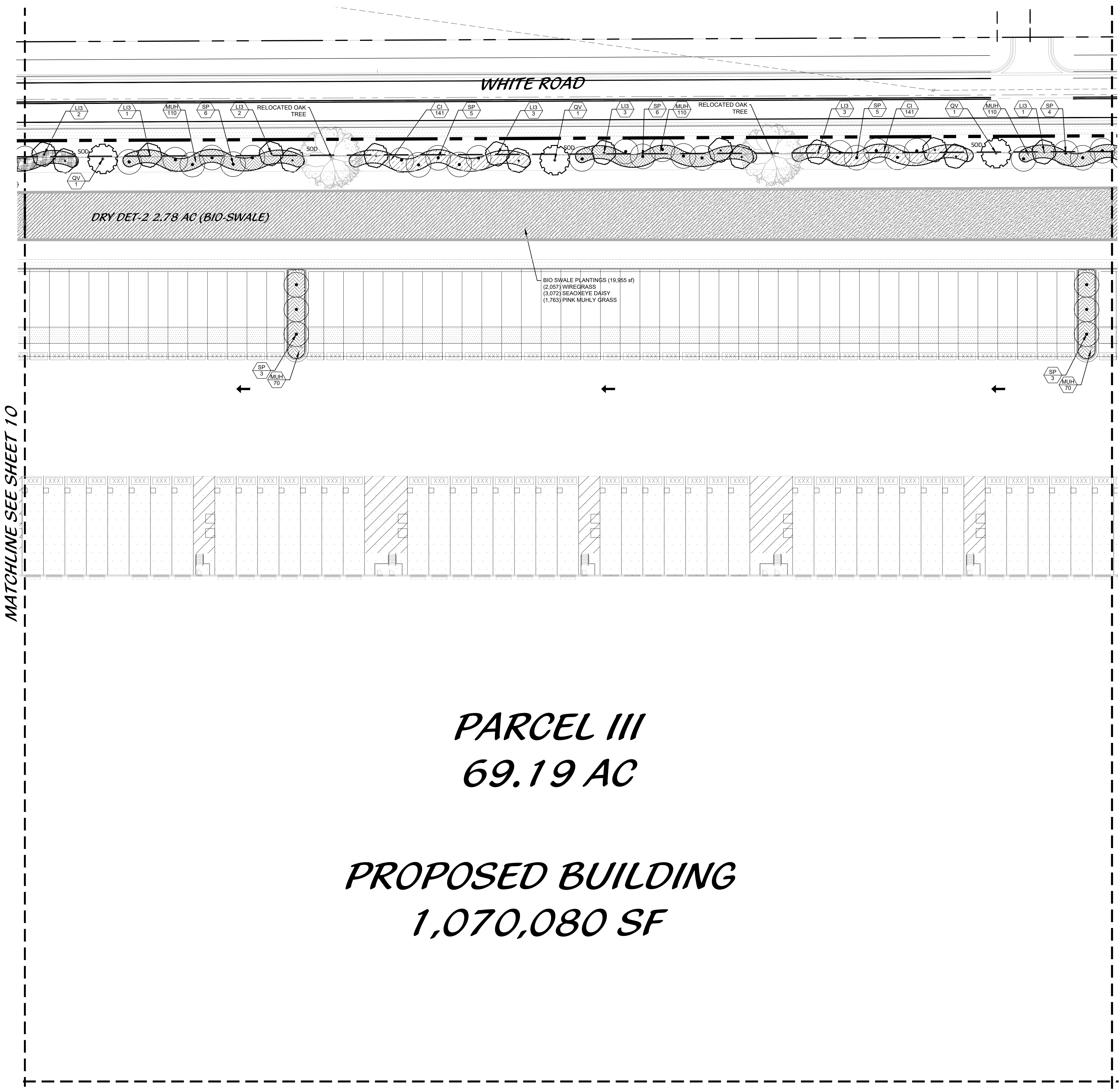

**PARCEL III
69.19 AC**

**PROPOSED BUILDING
1,070,080 SF**

MATCHLINE SEE SHEET 6

LOCATION MAP

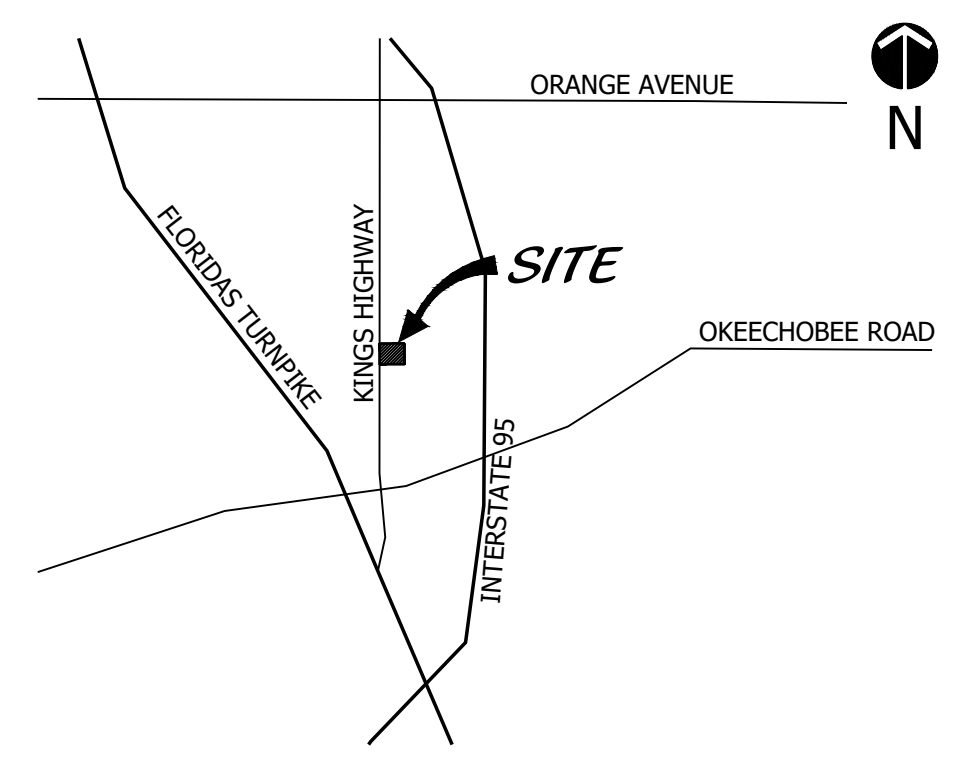

Cotleur & Hearing
 Landscape Architects
 Land Planners
 Environmental Consultants
 1934 Commerce Lane
 Suite 1
 Jupiter, Florida 33458
 561.747.6336 · Fax 747.1377
 www.cotleurhearing.com
 Lic# LC-26000535

King's Highway Commerce Park
Landscape Plan
 City of Fort Pierce, Florida

SHEET LAYOUT MAP

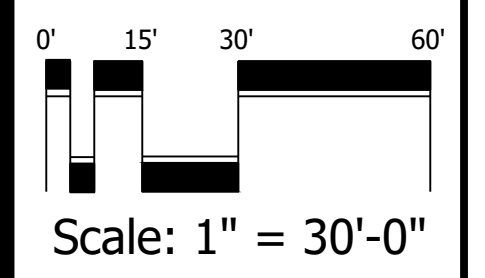
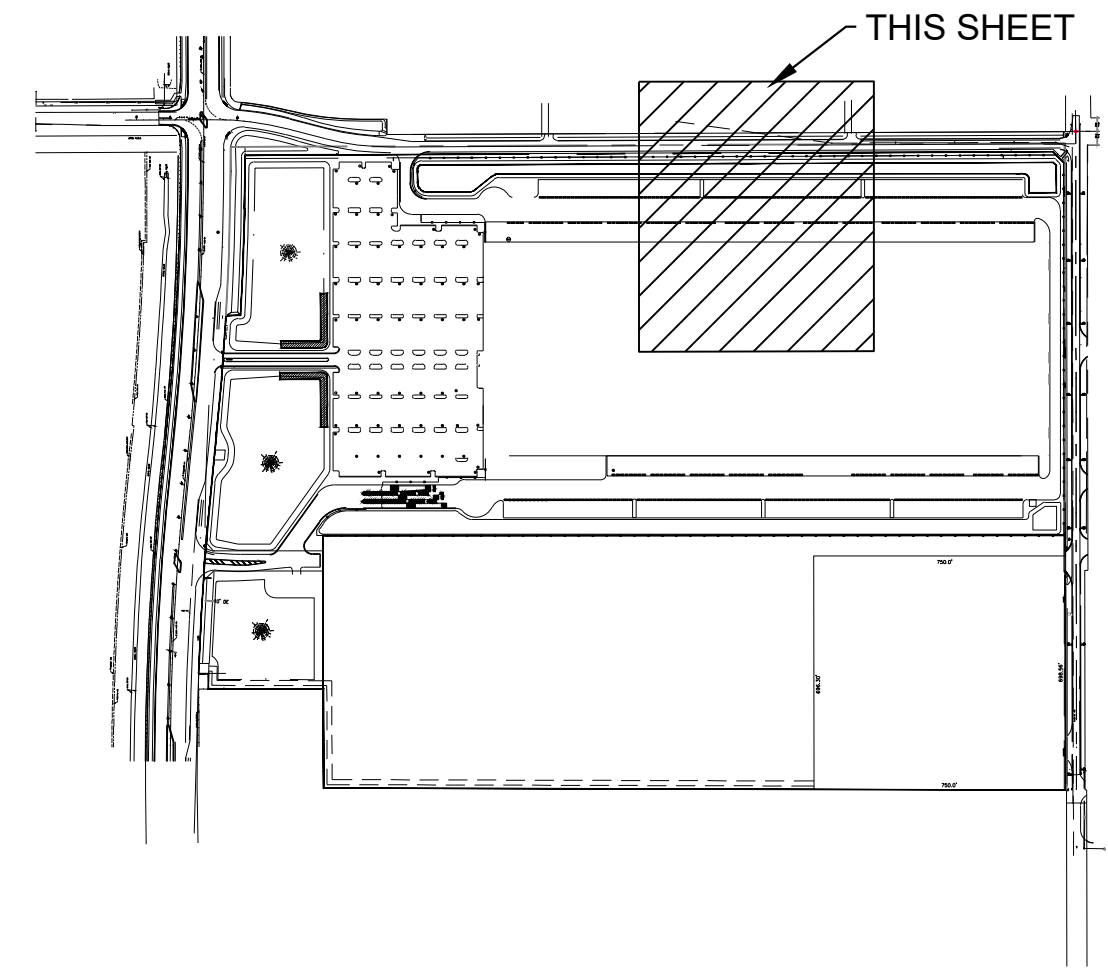

Landscape Plan

48 HOURS BEFORE DIGGING
 CALL TOLL FREE
811
 SUNSHINE STATE ONE CALL
 OF FLORIDA, INC.



DESIGNED	GB
DRAWN	WM
APPROVED	GB
JOB NUMBER	25-1202
DATE	12/23/25
REVISIONS	

December 15, 2025 12:48:03 p.m.
 Drawing: 24-1112 LP.DWG

LANDSCAPE NOTES

ALL PLANT MATERIAL SHALL BE FLORIDA NUMBER 1 OR BETTER AS DEFINED BY THE DIVISION OF PLANT INDUSTRY FLORIDA GRADES AND STANDARDS' LATEST EDITION.

ALL LANDSCAPE SHALL CONFORM TO THE REQUIREMENTS OF THE TOWN OF JUPITER LAND DEVELOPMENT REGULATIONS. THE TOWN OF JUPITER LANDSCAPE CODE (LDC) SHALL GOVERN IN THE EVENT OF A CONFLICT.

VEGETATION REMOVAL PERMITS ARE REQUIRED PRIOR TO REMOVING, CLEARING OR STRIPPING ANY VEGETATION FROM THE PROPERTY.

AT THE TIME OF BUILDING PERMIT, THE APPLICANT SHALL EXECUTE HOLD HARMLESS AGREEMENTS WITH ALL APPLICABLE UTILITIES FOR LANDSCAPING WITHIN UTILITY EASEMENTS.

THE LANDSCAPE CONTRACTOR SHALL NOT MAKE ANY SUBSTITUTIONS AND/OR CHANGES WITHOUT THE AUTHORIZATION OF TOWN OF JUPITER, THE OWNER, AND THE LANDSCAPE ARCHITECT.

THE LANDSCAPE CONTRACTOR SHALL REVIEW THE PROJECT DRAINAGE AND UTILITY PLANS PRIOR TO CONSTRUCTION AND AVOID ALL CONFLICTS. THE LANDSCAPE CONTRACTOR SHALL VERIFY THE LOCATION OF ALL UNDERGROUND UTILITIES PRIOR TO COMMENCING WORK.

THE LANDSCAPE CONTRACTOR SHALL BE RESPONSIBLE FOR ALL PERMITS.

THE CONTRACTOR SHALL COORDINATE THE PLANTING AND TRIMMING OF STREET TREES TO ENSURE FULL VISIBILITY TO TRAFFIC CONTROL AND SAFETY SIGNAGE

TREES SHALL BE POSITIONED TO AVOID CONFLICTS WITH SIGNAGE AND SITE LIGHTING. LARGER TREES WILL BE PROVIDED AT INTERSECTIONS WHERE DEEMED NECESSARY.

ALL VEGETATION SHALL BE SELECTED AND POSITIONED SO THAT IT DOES NOT PRESENT OBSTRUCTIONS TO THE LINE OF SIGHT AT INTERSECTIONS PURSUANT TO SECTION 27-1262(a)(9)(c) OF THE TOWN OF JUPITER CODE.

ALL ABOVE GROUND UTILITIES I.E. TRANSFORMERS, SWITCH BOXES, AC CONDENSERS AND ALIKE SHALL BE FULLY SCREENED FROM VIEW ON THREE SIDES WITH LANDSCAPING. THE LANDSCAPING SHALL TO THE TALLEST FOOT OF SAID EQUIPMENT AT TIME OF FINISHING.

ALL TREES SHALL BE LOCATED WITHIN A MULCH PLANTING BED WITH A MINIMUM OF TWO (2) FEET OF CLEARANCE TO THE EDGE OF THE BED.

SOD AND IRRIGATION SHALL BE INSTALLED IN ANY ADJACENT RIGHT OF WAY BETWEEN THE SIDEWALK AND THE CURB. ALL SOD SHALL BE STENOPOPHRUM SECONDIATUM FLORITAM PALMETTO (ST. AUGUSTINE SOD).

TREES WITHIN PLANTING ISLANDS LESS THAN FIVE (5) FEET IN WIDTH SHALL BE LOCATED TO AVOID CONFLICTS WITH OVERHANGS OF ADJACENT DEVELOPED AREAS.

TYPE D RAISED CONCRETE CURBING SHALL BE PROVIDED AROUND ALL PLANTING ISLANDS WITHIN VEHICULAR USE AREAS.

TREES AT ENTRANCE WAYS AND WITHIN SIGHT TRIANGLES SHALL BE TRIMMED IN SUCH A FASHION TO MINIMIZE SITE VISIBILITY CONFLICTS. CLEAR VISIBILITY SHALL BE MAINTAINED BETWEEN 20 INCHES AND 7 FEET. TEN FOOT BY THIRTY FOOT SIGHT VISIBILITY TRIANGLES SHALL BE PROVIDED AT ALL INTERSECTIONS WITH THE PUBLIC RIGHT OF WAY. IN ADDITION ALL LANDSCAPING SHALL CONFORM TO THE REQUIREMENTS OF FOOT INDEX 546.

EARTH BERMS SHALL NOT EXCEED A 3:1 SLOPE 4:1 SLOPES OR GREATER ARE PREFERABLE.

ALL TREES PLANTED UNDER OR ADJACENT TO FPL POWER LINES WILL COMPLY WITH THE FPL RIGHT TREE IN THE RIGHT PLACE GUIDELINES (REV 5/95)

PERIMETER TREES AT THE TIME OF PLANTING SHALL BE SPACED IN A WAY THAT COMPLEMENTS THE SPACING OF ANY EXISTING TREES ON ADJACENT DEVELOPED AREAS.

ALL LANDSCAPE ISLANDS AND BEDS SHALL BE FREE FROM SHELL ROCK AND CONSTRUCTION DEBRIS. EXCAVATED TO A DEPTH OF 30 INCHES OR TO CLEAN NATIVE SOILS AND FILLED WITH THE SPECIFIED BACKFILL MIXTURE.

ALL LANDSCAPE ISLANDS SHALL INCORPORATE THE INSTALLATION OF MOUNDING OF NATIVE SOILS A MINIMUM OF SIX INCHES (6") ABOVE THE TOP OF CURB.

19.5" BIO BARRIER ROOT BARRIER SHALL BE PROVIDED FOR SHADE TREES PLANTED WITHIN SIX (6) FEET OF PUBLIC CURBS, SIDEWALKS OR PUBLIC RIGHT OF WAYS. ALL ROOT BARRIER SHALL BE INSTALLED IN ACCORDANCE WITH THE MANUFACTURER'S RECOMMENDATIONS. THE TOTAL LENGTH OF THE ROOT BARRIERS SHALL BE 20' ADJACENT TO THE SIDEWALK AND 20' ADJACENT TO THE CURB.

ALL AREAS SHALL BE FULLY IRRIGATED IN ACCORDANCE WITH THE REQUIREMENTS OF THE TOWN OF JUPITER. THE IRRIGATION WATER SOURCE SHALL BE WELL WATER FOR COMMON AREAS AND POTABLE WATER AROUND THE BUILDING FOUNDATION.

CATCH BASINS AND DRAINAGE SHALL NOT BE LOCATED WITH IN REQUIRED PERIMETER BUFFERS OR PRESERVE AREAS.

THE IRRIGATION SYSTEM SHALL BE DESIGNED TO PROVIDE 100% OVERLAP COVERAGE TO ALL LANDSCAPE AND SOD AREAS.

THE IRRIGATION SYSTEM SHALL BE EQUIPPED WITH A RAIN SENSOR/CUT OFF SWITCH IN ACCORDANCE WITH STATE AND LOCAL REQUIREMENTS.

EXISTING TREES AND VEGETATION TO REMAIN SHALL BE STAKED AND BARRICADED PRIOR TO ANY LAND CLEARING. TREES TO BE RELOCATED SHALL BE ROOT PRUNED AND PROTECTED DURING CONSTRUCTION.

ALL TREES PROPOSED TO BE PRESERVED ON SITE SHALL BE PROTECTED IN ACCORDANCE WITH THE PROCEDURES OUTLINED IN DIVISION IV., VEGETATION REMOVAL REQUIREMENTS IN THE TOWN OF JUPITER CODE PRIOR TO THE ISSUANCE OF A C.O.

ANY AREA DESIGNATED WITH EXISTING VEGETATION TO REMAIN THAT IS DISTURBED DURING CONSTRUCTION WILL BE RESTORED WITH NATIVE PLANTINGS.

EXISTING TREES PRESERVED OR RELOCATED ON SITE SHALL BE PRUNED ACCORDING TO ANSI A300 STANDARDS OR BY AN ISA CERTIFIED ARBORIST.

ALL EXISTING LANDSCAPING AND TREES TO REMAIN SHALL BE BARRICADED WITH ORANGE CONSTRUCTION BARRICADE. THE BARRICADE SHALL BE INSTALLED AT THE DRIP LINE OF THE TREE/PALM OR AT THE EDGE OF THE SHRUB MASS.

BARRICADES SHALL REMAIN IN PLACE THROUGHOUT THE DURATION OF CONSTRUCTION.

EXISTING, SUITABLE NATIVE VEGETATION LOCATED WITHIN THE PROPOSED DEVELOPMENT AREAS SHALL BE RELOCATED TO SUPPLEMENT THE LANDSCAPING. NATIVE VEGETATION SHALL BE RELOCATED BY TREE SPADE OR CRANE. PRIOR TO THE CLEARING OF THE SITE THE APPLICANT SHALL IDENTIFY ALL NATIVE VEGETATION TO BE RELOCATED.

RELOCATION METHODOLOGY: EXISTING NATIVE VEGETATION DETERMINED TO BE SUITABLE FOR RELOCATION SHALL BE RELOCATED TO TARGET AREAS USING HYDROLOGIC TREE SPADES. THE SIZE OF SPADE SHALL VARY FROM 90" TO 45" DEPENDING ON THE SIZE AND TYPE OF VEGETATION TO BE MOVED. THE APPLICANT SHALL IDENTIFY PRIOR TO THE CLEARING OF THE SITE ALL EXISTING NATIVE VEGETATION TO BE RELOCATED. FOLLOWING RELOCATION, VEGETATION SHALL BE WATERED DAILY FOR A PERIOD NOT LESS THAN 90 DAYS AFTER WHICH IT SHALL BE WATERED ON AN AS NEEDED BASIS TO INSURE SURVIVAL. AT A MINIMUM THE APPLICANT SHALL INSURE 60% SURVIVAL FOR ALL RELOCATED PLANT MATERIAL.

PLANT SCHEDULE

CODE	QTY	BOTANICAL NAME	COMMON NAME	CONTAINER	CALIPER	SIZE	NATIVE	DROUGHT TOL.	REMARKS
TREES									
IE	93	ILEX X ATTENUATA 'EAGLESTON'	EAGLESTON HOLLY	30 GAL	2" CAL	12' HT X 5' SPRD	Y		FULL CANOPY, 5' CT. SOUTH GROWN, MATCHED, FLORIDA FANCY
L13	58	LAGERSTROEMIA INDICA 'MUSKOGEE'	CRAPE MYRTLE	65 GAL. MIN.	2.5" CAL.	12' O.A.X 5' SPRD	N	N	FULL & THICK CANOPY, FLORIDA FANCY, 5' C.T.
MDD	24	MAGNOLIA GRANDIFLORA 'D.D. BLANCHARD'	SOUTHERN MAGNOLIA	65 GAL	3" CAL	14' HT X 5'-6" SPRD	Y		FULL CANOPY, SOUTH GROWN, MATCHING,FF
PE2	87	PINUS ELLIOTTII 'DENSATA'	SLASH PINE	N.A.	2.5" CAL	10-12' OA	Y		FULL CANOPY; PLANTED IN PRESERVE
QV	222	QUERCUS VIRGINIANA	LIVE OAK	30 GAL. OR F.G.	2" CAL. MIN	12' HT. X 5' SPRD.	Y		FULL CANOPY, 4' CT MIN.
QV18	1	QUERCUS VIRGINIANA 'CATHEDRAL'	CATHEDRAL LIVE OAK	FIELD GROWN	6" CAL	18' HT X 10' SPRD	Y	Y	SINGLE, STRAIGHT TRUNK. FULL CANOPY, SYMMETRICAL. 6' CT MIN.
PALM TREES									
CH1	12	CHAMAEROPS HUMILIS ~	EUROPEAN FAN PALM	FIELD GROWN	N.A.	5'-6' O.A.	N		3 STEMS MIN., 2' STEM FOOTAGE PER TRUNK; LIMB UP 2' - FULL & THICK, MATCHED.
LN	10	LIVISTONA NITIDA ^	NITIDA PALM	FIELD GROWN	N.A.	14'-16' OA			FULL CANOPY, DIAMOND CUT, FLORIDA FANCY.
PHM	7	PHOENIX DACTYLIFERA 'MEDJOOL'	MEDJOOL DATE PALM	FIELD GROWN	N.A.	10'-12' WD.	N		STRAIGHT TRUNK, FULL CANOPY, DIAMOND CUT. HT.
SPC	5	SABAL PALMETTO	CABBAGE PALM	FIELD GROWN	N.A.	14', 18', 22' CT., STGG.			SLICK, CURVED TRUNK, STAGGER HEIGHTS IN CLUSTERS
SP	481	SABAL PALMETTO	CABBAGE PALM	N.A.	N.A.	14', 18', 22' STGG.	Y		RELOCATED FROM ON SITE
SHRUBS									
AGG	5	AGAVE AMERICANA 'GAINESVILLE BLUE'	GAINESVILLE BLUE AGAVE	30 GAL	4'-5" O.A. X 3'-4' SPRD.	A.S.	N		FULL & THICK
CIR	85	CHRYSOBALANUS ICACO 'RED TIP'	RED TIP COCOPLUM	7 GAL	3' X 3'	3' O.C.	Y		FULL
CLD15	278	CLUSIA GUTTIFERA	CLUSIA	15 GAL	6' HT. X 3' SPRD.	3' O.C.	N		FULL & THICK
PM15	67	PODOCARPUS MAKII~	PODOCARPUS	15 GAL	5' O.A., 2' SPRD	2' O.C.	N		FULL & THICK
GROUND COVERS									
CI	1,496	CHRYSOBALANUS ICACO	COCOPLUM	3 GAL	18" X18"	30" OC	Y		FULL & THICK
CID	1,572	CHRYSOBALANUS ICACO 'HORIZONTAL'	DWARF COCOPLUM	3 GAL	12" X 12"	24" O.C.	Y		FULL & THICK, NOT STRETCHED, FF
CJ3	1,113	COCOLOBIA UVIFERA	SEA GRAPE	3 GAL	24" X 24"	24" O.C.	Y		FULL & THICK
ER	14	EUPHORBIA MILLII 'ROSY'	CROWN OF THORNS	3 GAL	12" X 12"	24" O.C.	N		FULL AND THICK
FG	189	FICUS MACROPHYLLA 'GREEN ISLAND'	GREEN ISLAND FICUS	3 GAL	15" X 15"	24" O.C.	N		FULL & THICK
HD	2,296	HAMELIA PATENS 'COMPACTA'	DWARF FIREBUSH	3 GAL	18" X 18"	24" O.C.	Y		FULL & THICK, FLORIDA NATIVE VARIETY
HS	20	HIBISCUS 'SEMINOLE PINK'	SEMINOLE PINK HIBISCUS	7 GAL	24" X 24"	2.5" OC	N		FULL & THICK
IV	570	ILEX VOMITORIA 'SHILLINGS DWARF'	DWARF YAUPON HOLLY	3 GAL	15" X 15"	24" O.C.	Y		FULL & THICK
MUH	4,578	MUHLENBERGIA CAPILLARIS	PINK MUHLY GRASS	3 GAL	24" X 24"	30" OC	Y		FULL & THICK
PD	125	PODOCARPUS MACROPHYLLUS 'DWARF PRINGLES' ~	DWARF PODOCARPUS	3 GAL	15" X 15"	18" O.C.	Y		FULL & THICK
RL	146	RONDELETIA LEUCOPHYLLA	PANAMA ROSE	3 GAL	18" X 18"	24" O.C.	N		FULL & THICK
TF	249	TRIPSACUM FLORIDANA	DWARF FAKAHATCHEE GRASS	3 GAL	24" X 24"	30" OC	Y		FULL & THICK

LANDSCAPE SPECIFICATIONS

1. GENERAL LANDSCAPE REQUIREMENTS

LANDSCAPE CONTRACT WORK INCLUDES, BUT IS NOT LIMITED TO, SOIL PREPARATION, FINE OR FINISH GRADING, FURNISHING AND INSTALLING PLANT MATERIAL, WATERING, STAKING, GUYING AND MULCHING.

PLANT SIZE AND QUALITY

TREES, PALMS, SHRUBS, GROUNDCOVERS: PLANT SPECIES AND SHALL CONFORM TO THOSE INDICATED ON THE DRAWINGS. NOMENCLATURE SHALL CONFORM TO STANDARD PLANT NAMES, 1942 EDITION. ALL NURSERY STOCK SHALL BE IN ACCORDANCE WITH GRADES AND STANDARDS FOR NURSERY PLANTS PARTS 1 & II, LATEST EDITION PUBLISHED BY THE FLORIDA DEPARTMENT OF AGRICULTURE AND CONSUMER SERVICES, UNLESS SPECIFIED OTHERWISE. ALL PLANTS SHALL BE FLORIDA GRADE NUMBER 1 OR BETTER AS DETERMINED BY THE FLORIDA DIVISION OF PLANT INDUSTRY.

ALL CONTAINER GROWN MATERIAL SHALL BE HEALTHY, VIGOROUS, WELL-ROOTED PLANTS AND ESTABLISHED IN THE CONTAINER IN WHICH THEY ARE SOLD. THE PLANTS SHALL HAVE TOPS OF GOOD QUALITY AND BE IN A HEALTHY GROWING CONDITION.

AN ESTABLISHED CONTAINER GROWN PLANT SHALL BE TRANSPORTED INTO A CONTAINER AND GROWN IN THAT CONTAINER SUFFICIENTLY LONG ENOUGH FOR THE NEW FIBER ROOTS TO HAVE DEVELOPED SO THAT THE ROOT MASS WILL RETAIN ITS SHAPE AND HOLD TOGETHER WHEN REMOVED FROM THE CONTAINER.

STANDARD PLANTING MIXTURE SHALL BE ONE (1) PART RECYCLED ORGANIC MATERIAL ADDED TO THREE (3) PARTS EXISTING NATIVE SOIL.

REPLACEMENT SOIL SHALL BE USED AS SPECIFIED TO REPLACE EXISTING SOILS THAT ARE DETERMINED BY THE LANDSCAPE ARCHITECT TO BE UNSUITABLE FOR PLANTING. IE. ROAD BASE, PAVEMENT, ETC. REPLACEMENT SOIL MIX SHALL CONTAIN 60% SAND AND 40% MUCK. SAND SHALL BE 100% CLEAN NATIVE SAND SCREENED TO 1/4" AND MUCK SHALL BE 100% CLEAN ORGANIC NATIVE MUCK SCREENED TO 1/2". ALL SOIL SHALL BE MIXED PRIOR TO FILLING OF ANY PIT.

MULCH SHALL BE SHREDED MELALEUCA, EUCALYPTUS OR GRADE "A" RECYCLED. ALL MULCH IS TO BE APPLIED TO A DEPTH OF 3", EXCEPT AS OTHERWISE NOTED.

FERTILIZER IN BACKFILL MIXTURE FOR ALL PLANTS SHALL CONSIST OF MILORGANITE ACTIVATED SLUDGE MIXED WITH THE BACKFILL AT A RATE OF NOT LESS THAN 50 LBS. PER CUBIC YARD.

FERTILIZER FOR TREES AND SHRUBS MAY BE TABLET FORM OR GRANULAR. GRANULAR FERTILIZER SHALL BE UNIFORM IN COMPOSITION, DRY AND FREE-FLOWING. THIS FERTILIZER SHALL BE DELIVERED TO THE SITE IN THE ORIGINAL UNOPENED BAGS, EACH BEARING THE MANUFACTURER'S STATEMENT OF ANALYSIS, AND SHALL MEET THE FOLLOWING REQUIREMENTS: 16% NITROGEN, 7% PHOSPHORUS, 12% POTASSIUM OR EQUAL (AGRIFORM OR EQUAL). IN 21 GRAM SIZE SHALL MEET THE FOLLOWING REQUIREMENTS: 20% NITROGEN, 10% PHOSPHORUS AND 5% POTASSIUM.

FERTILIZER WILL BE APPLIED AT THE FOLLOWING RATES:

PLANT SIZE	16-7-12	AGRIFORM TABLETS (21 GRAM)
1 GAL.	1/4 LB.	1
3 GAL.	1/3 LB.	3
7-15 GAL.	1/2 LB.	6
1'-6" CALIPER	2 LBS./1" CALIPER	2 PER 1" CALIPER
6" AND LARGER	3 LBS./1" CALIPER	2 PER 1" CALIPER

"FLORIDA EAST COAST PALM SPECIAL" SHALL BE APPLIED TO ALL PALMS AT INSTALLATION AT A RATE OF 1/2 LB. PER INCH OF TRUNK UNLESS OTHERWISE SPECIFIED.

FIELD GROWN TREES AND PALMS PREVIOUSLY ROOT PRUNED SHALL OBTAIN A ROOT BALL WITH SUFFICIENT ROOTS FOR CONTINUED GROWTH WITHOUT RESULTING SHOCK.

CONTRACTOR SHALL NOT MARK OR SCAR TRUNK IN ANY FASHION.

PLANTS SHALL BE WATERED AS NECESSARY OR WITHIN 24 HOURS AFTER NOTIFICATION BY THE LANDSCAPE ARCHITECT.

THE LOCATIONS OF PLANTS, AS SHOWN IN THESE PLANS, ARE APPROXIMATE. THE FINAL LOCATIONS MAY BE ADJUSTED TO ACCOMMODATE UNFORESEEN FIELD CONDITIONS. MAJOR ADJUSTMENTS TO THE LAYOUT ARE TO BE APPROVED BY THE LANDSCAPE ARCHITECT.

ALL PLASTIC FABRIC SHALL BE REMOVED FROM PLANT MATERIAL AT TIME OF INSTALLATION.

ALL TREES MUST BE STAKED AS SHOWN ON THE PLANTING DETAILS WITHIN 24 HOURS OF PLANTING. STAKES TO REMAIN FOR A MINIMUM OF 9 MONTHS, BUT NO LONGER THAN 18 MONTHS. CONTRACTOR IS RESPONSIBLE FOR MAINTENANCE AND REMOVAL OF THE STAKES.

ALL TREES MUST BE PRUNED AS PER LANDSCAPE ARCHITECT'S DIRECTION. SABAL PALMS MAY BE HURRICANE CUT.

ALL SHRUBS, TREES AND GROUND COVER WILL HAVE IMPROVED SOIL AS PER PLANTING SOIL NOTES. THE SOILS SHALL BE PLACED IN THE HOLE DURING PLANTING. TOP DRESSING ONLY IS NOT ACCEPTABLE.

DO NOT ALLOW AIR POCKETS TO FORM WHEN BACKFILLING. ALL TREES SHALL BE SPIKED IN UTILIZING WATER AND A TREE BAR.

THE LANDSCAPE CONTRACTOR SHALL WATER, MULCH, WEED, PRUNE, AND OTHERWISE MAINTAIN ALL PLANTS, INCLUDING SOD, UNTIL COMPLETION OF CONTRACT OR ACCEPTANCE BY LANDSCAPE ARCHITECT. SETTLED PLANTS SHALL BE RESET TO PROPER GRADE, PLANTING SAUCERS RESTORED, AND DEFECTIVE WORK CORRECTED.

THE LANDSCAPE CONTRACTOR SHALL AT ALL TIMES KEEP THE PREMISES FREE FROM ACCUMULATION OF WASTE MATERIALS OR DEBRIS CAUSED BY HIS CREWS DURING THE PERFORMANCE OF THE WORK.

UPON COMPLETION OF THE WORK, THE CONTRACTOR SHALL PROMPTLY REMOVE ALL WASTE MATERIALS, DEBRIS, UNUSED PLANT MATERIAL, EMPTY PLANT CONTAINERS AND ALL EQUIPMENT FROM THE PROJECT SITE.

UPON COMPLETION OF THE WORK, THE LANDSCAPE CONTRACTOR SHALL NOTIFY THE LANDSCAPE ARCHITECT AND REQUEST A FINAL INSPECTION. ANY ITEMS THAT ARE JUDGED INCOMPLETE OR UNACCEPTABLE BY THE LANDSCAPE ARCHITECT OR OWNER'S REPRESENTATIVE SHALL BE CORRECTED BY THE LANDSCAPE CONTRACTOR WITHIN 14 DAYS.

ALL LABOR AND MATERIAL FOR SOIL AMENDMENTS AND FERTILIZER THAT IS REQUIRED TO INSURE THE SUCCESSFUL ESTABLISHMENT AND SURVIVAL OF THE PROPOSED VEGETATION, AS WELL AS ALL THE COST FOR THE REMOVAL OF UNSUITABLE OR EXCESS BACKFILL MATERIAL, SHALL BE INCLUDED IN THE CONTRACTOR'S BID TO PERFORM THE WORK REPRESENTED IN THIS PLAN SET.

PLANTING DETAILS

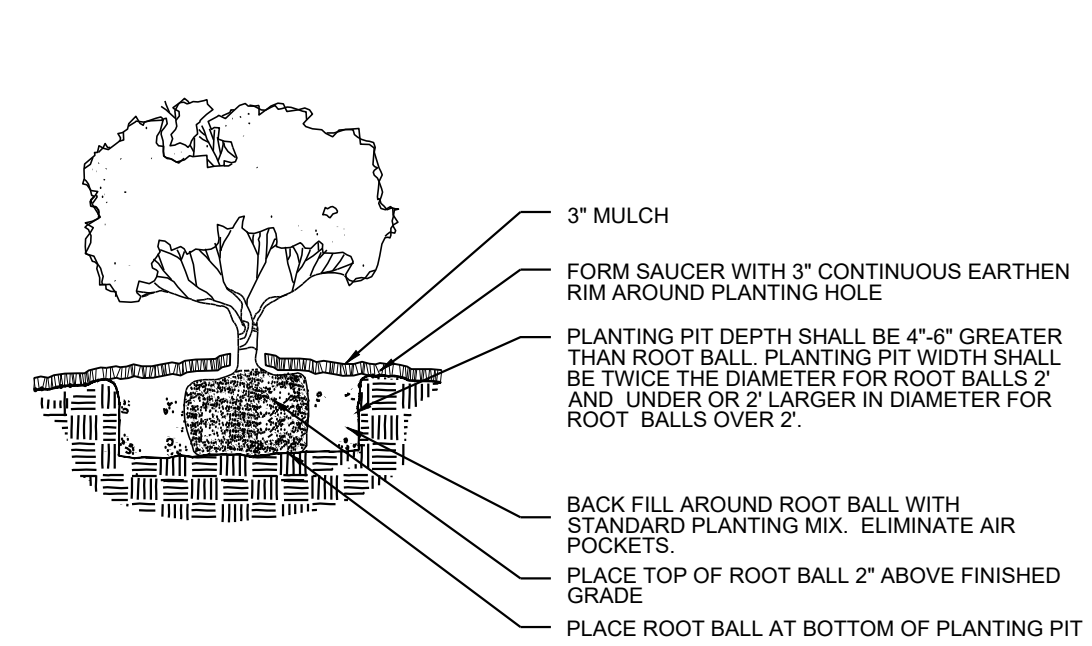

SHRUB/GROUNDCOVER PLANTING DETAIL

NTS

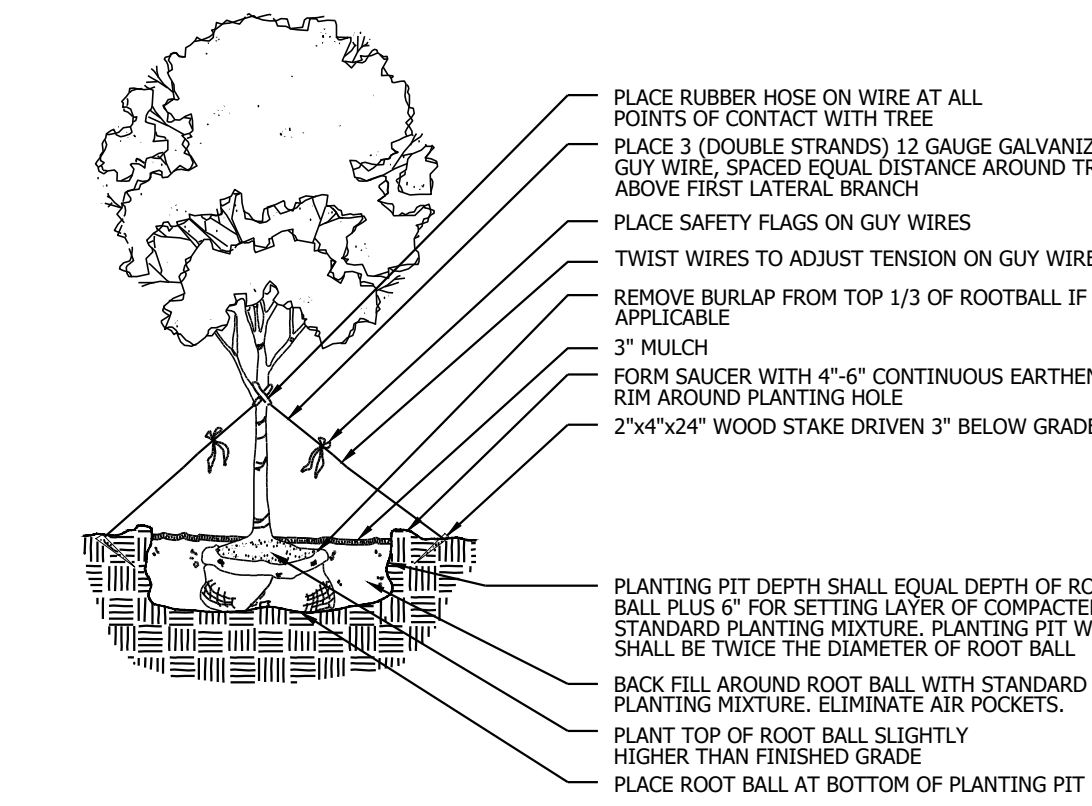

LARGE TREE PLANTING DETAIL

NTS

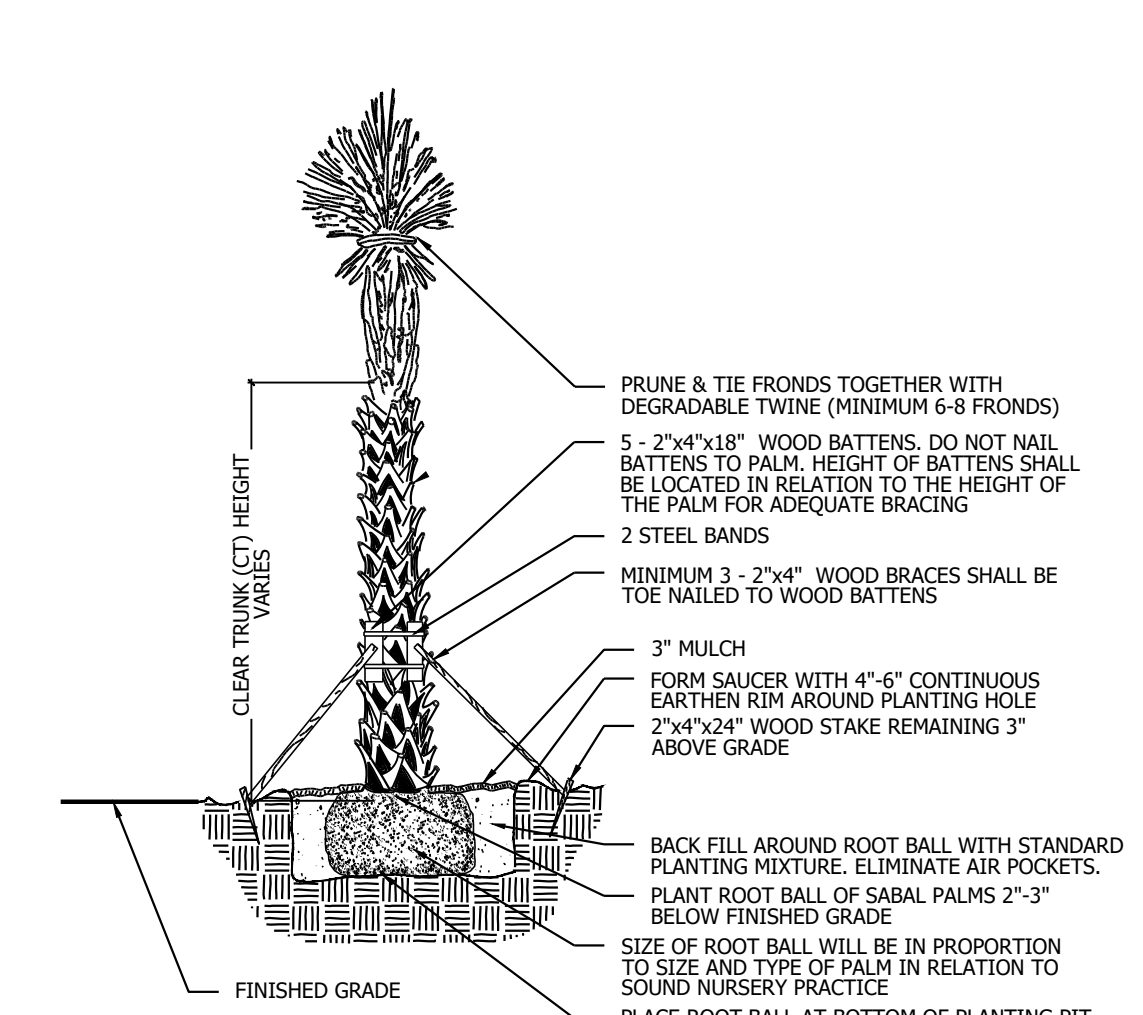

PALM PLANTING DETAIL

NTS

Cotleur & Hearing
Landscape Architects
Land Planners
Environmental Consultants
1934 Commerce Lane
Suite 1
Jupiter, Florida 33458
561.747.6336 · Fax 747.1377
www.cotleurhearing.com
Lic# LC-26000535

King's Highway Commerce Park
Landscape Plan
City of Fort Pierce, Florida



48 HOURS BEFORE DIGGING
CALL TOLL FREE
811
SUNSHINE STATE ONE CALL
OF FLORIDA, INC.

Landscape Details

December 15, 2025 12:48:03 p.m.
Drawing: 24-1112 LP.DWG