

Filed and recorded July 1, 1924.
Plat Book 4, page 58, St. Lucie County Records.

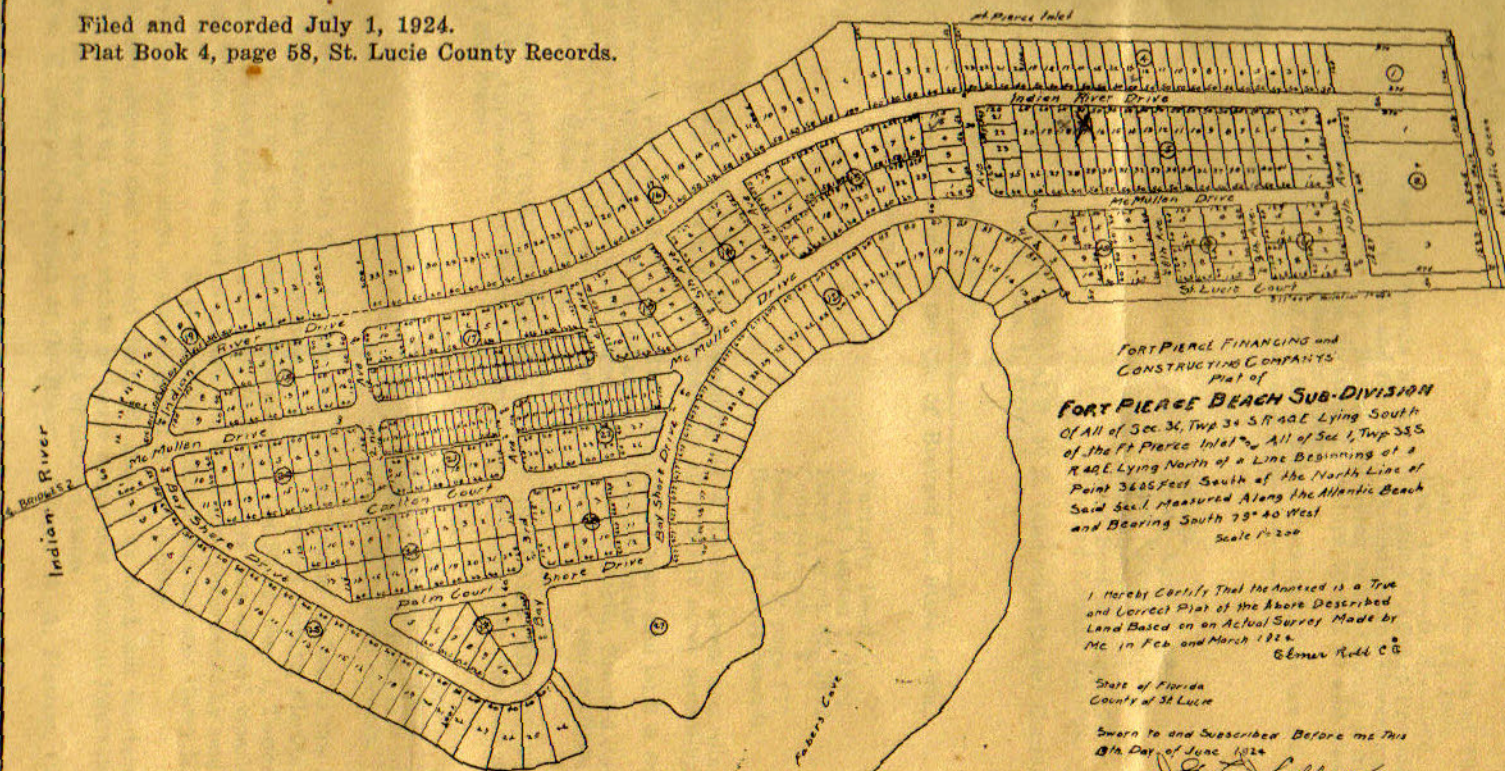

FORT PIERCE FINANCING and
CONSTRUCTING COMPANYS
Plat of
FORT PIERCE BEACH SUB-DIVISION
Of All of Sec 36, Twp 34 S R 30 E Lying South
of the Ft Pierce Inlet, All of Sec 1, Twp 35 S
R 30 E Lying North of a Line Beginning of a
Point 3685 Feet South of the North Line of
Said Sec 1 Measured Along the Atlantic Beach
and Bearing South 79° 40 West
Scale 1"=200

I Herely Certify That the Attached is a True
and Correct Plat of the Above Described
Land Based on an Actual Survey Made by
Me in Feb and March 1924.
G. E. Miller, C. E.

State of Florida
County of St. Lucie

Sworn to and Subscribed Before me this
8th Day of June 1924

G. E. Miller
Notary Public, State of Florida
My Commission Expires Oct 1, 1927