

AN230A-10-1-1--
crocfers

Recorded by:
City Clerk, City of Glendale
5850 West Glendale Avenue
Glendale, Arizona 85301

**RECORDATION FOR THE PURPOSE OF CORRECTION
BY
THE CITY OF GLENDALE**

Annexation Petition

The attached RE-RECORDING of this Annexation Petition SUPERCEDES the previously recorded document contained in the Official Records of Maricopa County Recorder, Stephen Richer, Reference Number 20211110787, recorded on 10/14/21. The document is being re-recorded because the previous version was not able to go before the City Council Public Hearing within the last 10 days of the 30-day waiting period.

Dated: November 1, 2021

When recorded, mail to:
City Clerk, City of Glendale
5850 West Glendale Avenue
Glendale, Arizona 85301

**ANNEXATION PETITION
OF
THE CITY OF GLENDALE**

**A Portion of Section 1 of Township 2 North, Range 2 West of the
Gila and Salt River Base and Meridian,
Maricopa County, Arizona,**

South of the Southeast Corner of Northern Avenue and Cotton Lane

Blank Petition Recorded on: October 14, 2021

Exhibit "A"

THAT PORTION OF THE WEST HALF OF SECTION 1, TOWNSHIP 2 NORTH, RANGE 2 WEST OF THE GILA AND SALT RIVER BASE AND MERIDIAN, MARICOPA COUNTY, ARIZONA, DESCRIBED AS FOLLOWS:

COMMENCING AT THE WEST QUARTER CORNER OF SAID SECTION 1, MARKED BY A BRASS CAP IN HANDHOLE STAMPED "MARICOPA COUNTY DEPARTMENT OF TRANSPORTATION S2 S1 1/4 2015," FROM WHICH THE NORTHWEST CORNER OF SAID SECTION 1, MARKED BY A BRASS CAP IN HANDHOLE STAMPED "MARICOPA COUNTY HIGHWAY DEPARTMENT," BEARS NORTH 00°00'00" EAST, FOR A DISTANCE OF 2619.04 FEET;

THENCE NORTH 00°00'00" EAST, ALONG THE WEST LINE OF THE NORTHWEST QUARTER OF SAID SECTION 1, FOR A DISTANCE OF 1213.10 FEET;

THENCE SOUTH 89°42'43" EAST, FOR A DISTANCE OF 65.00 FEET TO A POINT ON A LINE THAT IS PARALLEL WITH AND 65.00 FEET EAST OF THE WEST LINE OF SAID NORTHWEST QUARTER OF SAID SECTION 1, SAID POINT ALSO BEING THE **POINT OF BEGINNING**;

THENCE, CONTINUING SOUTH 89°42'43" EAST, FOR A DISTANCE OF 2183.99 FEET TO THE NORTHWEST CORNER OF A PARCEL DESCRIBED IN THE SPECIAL WARRANTY DEED RECORDED IN DOCUMENT NO. 2005-1958074 OF OFFICIAL RECORDS, MARICOPA COUNTY, ARIZONA;

THENCE SOUTH 04°12'55" EAST, ALONG THE WEST LINE OF SAID PARCEL, FOR A DISTANCE OF 84.77 FEET TO THE SOUTHWEST CORNER THEREOF;

THENCE SOUTH 89°42'43" EAST, ALONG THE SOUTH LINE OF SAID PARCEL, FOR A DISTANCE OF 71.00 FEET TO THE SOUTHEAST CORNER THEREOF;

THENCE NORTH 04°12'55" WEST, ALONG THE EAST LINE OF SAID PARCEL, FOR A DISTANCE OF 84.77 FEET TO THE NORTHEAST CORNER THEREOF;

THENCE SOUTH 89°42'43" EAST, FOR A DISTANCE OF 39.12 FEET TO A POINT ON THE WESTERLY RIGHT OF WAY LINE OF THE BOB STUMP MEMORIAL HIGHWAY, STATE ROUTE 303, PER ARIZONA DEPARTMENT OF TRANSPORTATION PROJECT NO. 303L MA 007 H7138 02R NEW RIGHT OF WAY LINE;

THE FOLLOWING TWO COURSES ARE ALONG SAID RIGHT OF WAY LINE: THENCE

SOUTH 00°57'56" EAST, FOR A DISTANCE OF 797.28 FEET;

THENCE SOUTH 00°20'56" WEST, FOR A DISTANCE OF 262.09 FEET TO THE NORTHEAST CORNER OF THAT CERTAIN PARCEL DESCRIBED IN SPECIAL WARRANTY DEED RECORDED IN DOCUMENT NO. 2005- 1958074 OF OFFICIAL RECORDS, MARICOPA COUNTY, ARIZONA;

THENCE SOUTH 87°40'36" WEST, ALONG THE NORTH LINE OF SAID PARCEL, FOR A DISTANCE OF 71.00 FEET TO THE NORTHWEST CORNER THEREOF;

THENCE SOUTH 00°20'53" WEST, ALONG THE WEST LINE OF SAID PARCEL, FOR A DISTANCE OF 84.60 FEET TO THE SOUTHWEST CORNER THEREOF;

THENCE SOUTH 87°40'23" WEST, FOR A DISTANCE OF 2236.30 FEET TO A POINT ON A LINE THAT IS PARALLEL WITH AND 65.00 FEET EAST OF THE WEST LINE OF SAID SOUTHWEST QUARTER OF SAID SECTION 1;

THENCE NORTH 00°00'09" EAST, ALONG SAID PARALLEL LINE, FOR A DISTANCE OF 36.28 FEET TO A POINT ON A LINE THAT IS PARALLEL WITH AND 65.00 FEET EAST OF THE WEST LINE OF SAID NORTHWEST QUARTER OF SAID SECTION 1;

THENCE NORTH 00°00'00" EAST, ALONG SAID PARALLEL LINE, FOR A DISTANCE OF 1212.78 FEET TO THE **POINT OF BEGINNING.**

SAID PARCEL CONTAINS 2,742,930 SQUARE FEET, OR 62.969 ACRES, MORE OR LESS.

Exhibit "B"

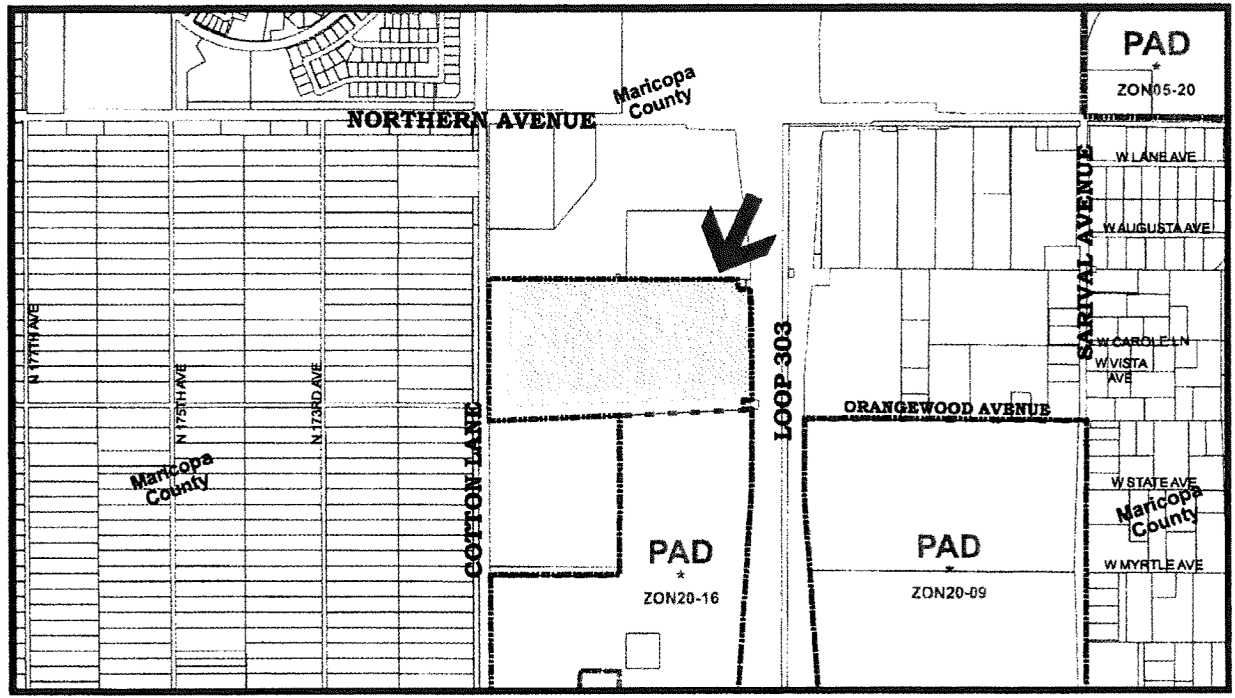

AFFIDAVIT

STATE OF ARIZONA)
) SS.
County of Maricopa)

ANNEXATION AREA NO. 230

Christina Lavella (planner name), being first duly sworn, upon oath
deposes and says:

1. I am the/a _____ (position title) for the City of Glendale, Arizona. I am preparing this affidavit based on information in the files of the City.
2. No part of the area shown on the attached map and described in the attached annexation petition and legal description, as proposed to be annexed into the City of Glendale, to the best of the City of Glendale's information, knowledge and belief, is already subject to an earlier filing for annexation by any other municipality.
3. This affidavit has been prepared to comply with the requirements of A.R.S. 9-471(A) (6).

FURTHER YOUR AFFIANT SAYETH NOT

[Handwritten Signature]
NAME IN CAPS HERE

SUBSCRIBED AND SWORN to before me this 14th day of October, 2021.

My Commission Expires:

7-31-23

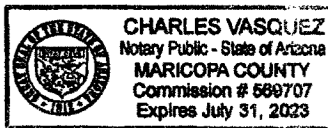

[Handwritten Signature]
Notary Public

When recorded, mail to:
City Clerk, City of Glendale
5850 West Glendale Avenue
Glendale, Arizona 85301

**ANNEXATION PETITION
OF
THE CITY OF GLENDALE**

**A Portion of Section 1 of Township 2 North, Range 2 West of the
Gila and Salt River Base and Meridian,
Maricopa County, Arizona,**

South of the Southeast Corner of Northern Avenue and Cotton Lane

Blank Petition Recorded on: November 1, 2021

AFFIDAVIT

STATE OF ARIZONA)
) SS.
County of Maricopa)

ANNEXATION AREA NO. 230

Christina LaVelle being first duly sworn, upon oath deposes and says:

1. I am the/a Planner for the City of Glendale, Arizona. I am preparing this affidavit based on information in the files of the City.
2. No part of the area shown on the attached map and described in the attached annexation petition and legal description, as proposed to be annexed into the City of Glendale, to the best of the City of Glendale's information, knowledge and belief, is already subject to an earlier filing for annexation by any other municipality.
3. This affidavit has been prepared to comply with the requirements of A.R.S. 9-471(A) (6).

FURTHER YOUR AFFIANT SAYETH NOT

CHRISTINA LAVELLE

SUBSCRIBED AND SWORN to before me this 1st day of November 2021.

Notary Public 

My Commission Expires:

07-03-22

