

BAPAN243-6-1-1--  
Garcia

When recorded, mail to:  
City Clerk, City of Glendale  
5850 West Glendale Avenue  
Glendale, Arizona 85301

---

**ANNEXATION PETITION  
OF  
THE CITY OF GLENDALE**

THAT PORTION OF THE SOUTHWEST QUARTER OF SECTION 30,  
TOGETHER WITH THAT PORTION OF THE SOUTHEAST QUARTER OF  
SECTION 25, TOWNSHIP 3 NORTH, RANGE 2 WEST TOWNSHIP 3 NORTH,  
RANGE 1 WEST OF THE GILA AND SALT RIVER BASE AND MERIDIAN,  
MARICOPA COUNTY, ARIZONA

Parkway 303 East Annexation (AN-243)

Blank Petition Recorded on: October 3, 2022



## Exhibit "A"

THAT PORTION OF THE SOUTHWEST QUARTER OF SECTION 30, TOGETHER WITH THAT PORTION OF THE SOUTHEAST QUARTER OF SECTION 25, TOWNSHIP 3 NORTH, RANGE 2 WEST TOWNSHIP 3 NORTH, RANGE 1 WEST OF THE GILA AND SALT RIVER BASE AND MERIDIAN, MARICOPA COUNTY, ARIZONA, MORE PARTICULARLY DESCRIBED AS FOLLOWS:

BEGINNING AT THE CENTER OF SECTION 30, MARKED BY A REBAR WITH NO CAP FROM WHICH THE SOUTH QUARTER CORNER OF SAID SECTION 30, MARKED BY AN ALUMINUM CAP FLUSH STAMPED "MARICOPA COUNTY T3N, R1W S30 1/4 S31," BEARS SOUTH 00°03'18" EAST, AS MEASURED AND RECORDED IN CORRECTIVE SPECIAL WARRANTY DEED IN INSTRUMENT NO. 20190983423, OF OFFICIAL RECORDS, MARICOPA COUNTY, ARIZONA, FOR A DISTANCE OF 2637.33 FEET;  
 THENCE SOUTH 00°03'18" EAST, ALONG THE EAST LINE OF THE SOUTHWEST QUARTER OF SAID SECTION 30, FOR A DISTANCE OF 2504.31 FEET TO A POINT ON THE NORTH RIGHT OF WAY LINE OF THE ATCHISON, TOPEKA & SANTA FE RAILROAD;  
 THENCE NORTH 89°02'28" WEST, ALONG SAID NORTH RIGHT OF WAY LINE, FOR A DISTANCE OF 2206.64 FEET TO A POINT ON A LINE THAT IS 33.00 EAST OF AND PARALLEL WITH THE WEST LINE OF THE SOUTHWEST QUARTER OF SAID SECTION 30;  
 THENCE NORTH 0°15'51" EAST, ALONG SAID PARALLEL LINE, FOR A DISTANCE OF 2505.82 FEET TO A POINT ON THE NORTH LINE OF THE SOUTHWEST QUARTER OF SAID SECTION 30;  
 THENCE SOUTH 88°59'47" EAST, ALONG SAID NORTH LINE, FOR A DISTANCE OF 2192.70 FEET TO THE POINT OF BEGINNING.

SAID PARCEL CONTAINS 5,509,686 SQUARE FEET, OR 126.485 ACRES, MORE OR LESS.

TOGETHER WITH THE FOLLOWING DESCRIPTION:

COMMENCING AT THE SOUTH QUARTER CORNER OF SAID SECTION 25, MARKED BY A BRASS CAP FLUSH STAMPED "ARIZONA DEPT. OF TRANSPORTATION 2013 RLS 29131," FROM WHICH THE SOUTHEAST CORNER OF SAID SECTION 25, MARKED BY A FOUND ALUMINUM CAP FLUSH STAMPED "MARICOPA COUNTY T3N, R2W S 30 1/4 S31" BEARS SOUTH 89°43'12" EAST, FOR A DISTANCE OF 2632.72 FEET;  
 THENCE SOUTH 89°43'12" EAST, ALONG THE SOUTH LINE OF THE SOUTHEAST QUARTER OF SAID SECTION 25, FOR A DISTANCE OF 420.29 FEET TO A POINT ON THE EAST RIGHT OF WAY LINE OF STATE ROUTE 303;  
 THE FOLLOWING FIVE COURSES ARE ALONG SAID EAST RIGHT OF WAY LINE:  
 THENCE NORTH 24°31'30" WEST, FOR A DISTANCE OF 146.47 FEET TO AN ALUMINUM CAP FLUSH STAMPED "ARIZONA DEPT. OF TRANSPORTATION LS 21782", SAID POINT BEING THE POINT OF BEGINNING;  
 THENCE NORTH 00°02'46" EAST, FOR A DISTANCE OF 582.01 FEET TO AN ALUMINUM CAP FLUSH STAMPED "ARIZONA DEPT. OF TRANSPORTATION LS 21782 2016";

THENCE NORTH 06°47'22" WEST, FOR A DISTANCE OF 702.71 FEET TO AN ALUMINUM CAP FLUSH STAMPED "ARIZONA DEPT. OF TRANSPORTATION LS 21782";  
THENCE NORTH 01°40'50" WEST, FOR A DISTANCE OF 483.19 FEET TO AN ALUMINUM CAP FLUSH STAMPED "ARIZONA DEPT. OF TRANSPORTATION LS 21782";  
THENCE NORTH 00°23'43" EAST, FOR A DISTANCE OF 742.47 FEET TO A POINT ON THE NORTH LINE OF THE SOUTHEAST QUARTER OF SAID SECTION 25, SAID POINT MARKED BY AN ALUMINUM CAP FLUSH STAMPED "ARIZONA DEPT. OF TRANSPORTATION LS 21782";  
THENCE SOUTH 89°44'51" EAST, ALONG SAID NORTH LINE, FOR A DISTANCE OF 2344.03 TO A POINT ON A LINE THAT IS 33.00 WEST OF AND PARALLEL WITH THE EAST LINE OF THE SOUTHEAST QUARTER OF SAID SECTION 25;  
THENCE SOUTH 00°15'51" WEST, ALONG SAID PARALLEL LINE, FOR A DISTANCE OF 875.00 FEET;  
THENCE NORTH 89°44'51" WEST, FOR A DISTANCE OF 44.00 FEET TO A POINT ON A LINE THAT IS 77.000 WEST OF AND PARALLEL WITH THE EAST LINE OF THE SOUTHEAST QUARTER OF SAID SECTION 25;  
THENCE SOUTH 00°15'51" WEST, ALONG SAID PARALLEL LINE, FOR A DISTANCE OF 862.08 FEET;  
THENCE NORTH 89°44'51" WEST, FOR A DISTANCE OF 40.00 FEET TO A POINT ON A LINE THAT IS 117.00 WEST OF AND PARALLEL WITH THE EAST LINE OF THE SOUTHEAST QUARTER OF SAID SECTION 25;  
THENCE SOUTH 00°15'51" WEST, ALONG SAID PARALLEL LINE, FOR A DISTANCE OF 768.72 FEET TO A POINT ON THE NORTH RIGHT OF WAY LINE OF THE ATCHISON, TOPEKA & SANTA FE RAILROAD;  
THENCE NORTH 89°43'15" WEST, ALONG SAID NORTH RIGHT OF WAY LINE, FOR A DISTANCE OF 2156.82 FEET TO THE POINT OF BEGINNING.

SAID PARCEL CONTAINS 5,667,722 SQUARE FEET, OR 130.113 ACRES, MORE OR LESS.

EXHIBIT B

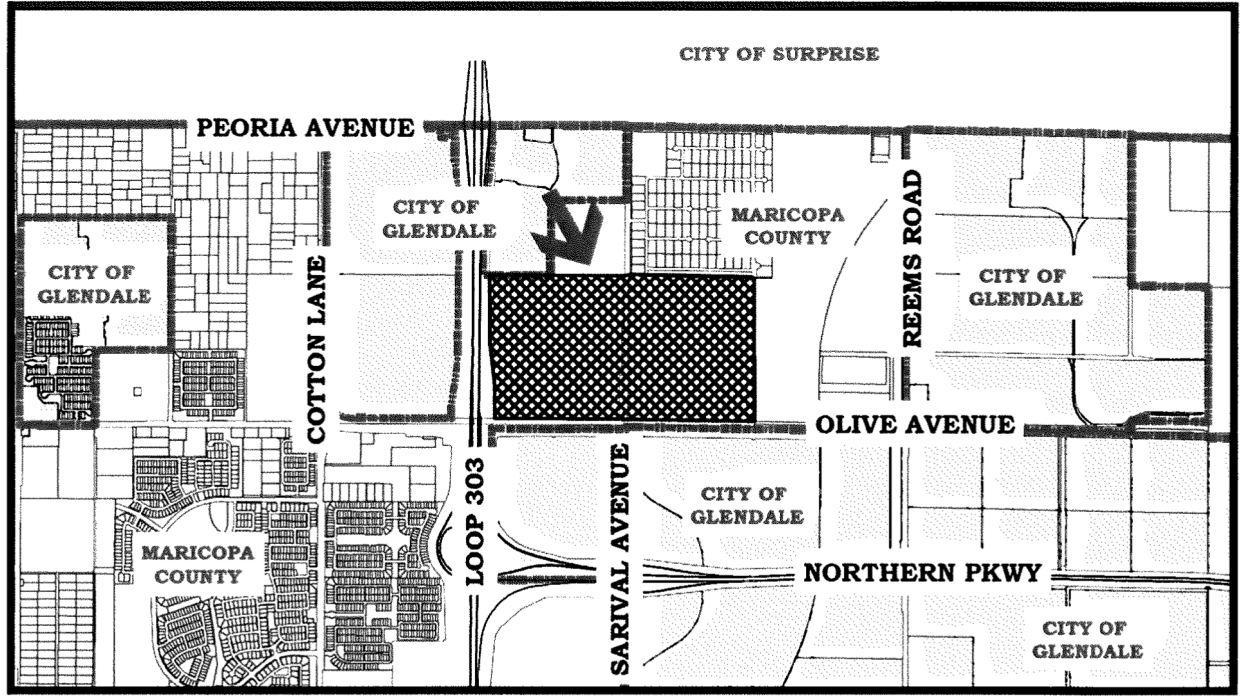

AFFIDAVIT

STATE OF ARIZONA        )  
  ) SS.  
County of Maricopa        )

ANNEXATION AREA NO. 243

Edward Vigil, being first duly sworn, upon oath deposes and says:

1. I am a Senior Planner for the City of Glendale, Arizona. I am preparing this affidavit based on information in the files of the City.
2. No part of the area shown on the attached map and described in the attached annexation petition and legal description, as proposed to be annexed into the City of Glendale, to the best of the City of Glendale's information, knowledge and belief, is already subject to an earlier filing for annexation by any other municipality.
3. This affidavit has been prepared to comply with the requirements of A.R.S. 9-471(A) (6).

FURTHER YOUR AFFIANT SAYETH NOT

Edward Vigil   
NAME IN CAPS HERE

SUBSCRIBED AND SWORN to before me this 3rd day of October, 2022.

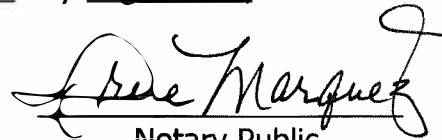
  
Notary Public

My Commission Expires:

07-03-26

