



# DCRP- Community Engagement Update

City Council Workshop

April 11, 2023

Presenters: Eddie Garcia, Diane Jacobs (Holly Street Studio)



# Community Engagement

## MURPHY PARK - WHAT WE HEARD

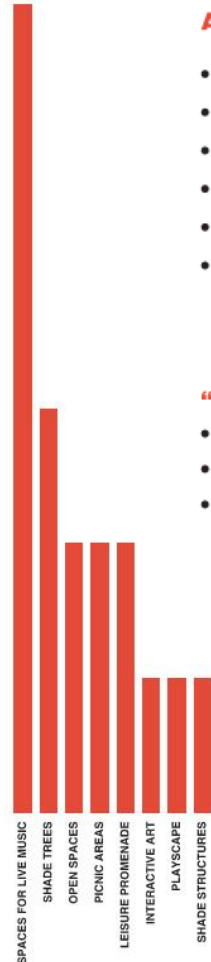

### AMENITIES REQUESTED:

- PUBLIC SPACES
- MEETING ROOMS
- CONNECTION TO SERVICES
- COMPUTER ZONES
- BETTER TECHNOLOGY
- OPEN VIEWS

### “WE LOVE...”

- TREES AND GREEN SPACES
- GATHERINGS
- BELONGING

### DESIGN NEEDED:

- RESTROOMS
- PUBLIC ART
- SUSTAINABLE SOLUTIONS
- BENCHES & MURALS
- CULTURALLY REPRESENTATIVE DESIGN
- MORE TREES
- WORKING WATER FEATURE
- PARK CONNECTION TO BUILDING
- CONSISTENCY
- MODERN UPGRADES

### ELEMENTS

### “ON THE OPENING DAY WE EXPECT...”

- FRESH NEW LOOK
- VIVID LIGHTS
- MUSIC AND FESTIVALS
- THINKING OUTSIDE THE BOX

### “CIVIC SPACES SHOULD BE...”

- MODERN AND HISTORIC
- CLEAN CIVIC PRIDE
- FLEXIBLE AND FORMAL
- GREEN SPACES

### SYMBOLS TO RESIDENTS & VISITORS

- PRIDE
- TOWN SQUARE
- COMMUNITY
- MODERN AND WELCOMING

# October 26, 2022



# Community Engagement- Forum Format



October 26, 2022

# Communication

## **DOWNTOWN CAMPUS REINVESTMENT PROJECT COMMUNITY ENGAGEMENT PUBLIC OPEN HOUSE**

*Wednesday, March 29 / 5:30 – 7:30 p.m.*

- City Hall Council Chambers (5850 W. Glendale Ave, Glendale, AZ 85301)
  - Heroes Park Library (6075 N. 83rd Ave, Glendale, AZ 85303)
  - Foothills Recreation Center (5600 W. Union Hills Dr, Glendale, AZ 85308)
- Also Streaming Live on Facebook and YouTube

*Please drop in at any of the three locations between 5:30 – 7:30 p.m.  
to learn about the*

### **MURPHY PARK SCHEMATICS**



More information at [www.GlendaleAZ.com/DCRP](http://www.GlendaleAZ.com/DCRP)



# Open House Format



# Open House Format



\*Approx. count (excludes COG staff and Design Team)



# March 15 – Building and Campus

BEFORE



AFTER



Main Promenade Connects to City

Integrated Civic Campus

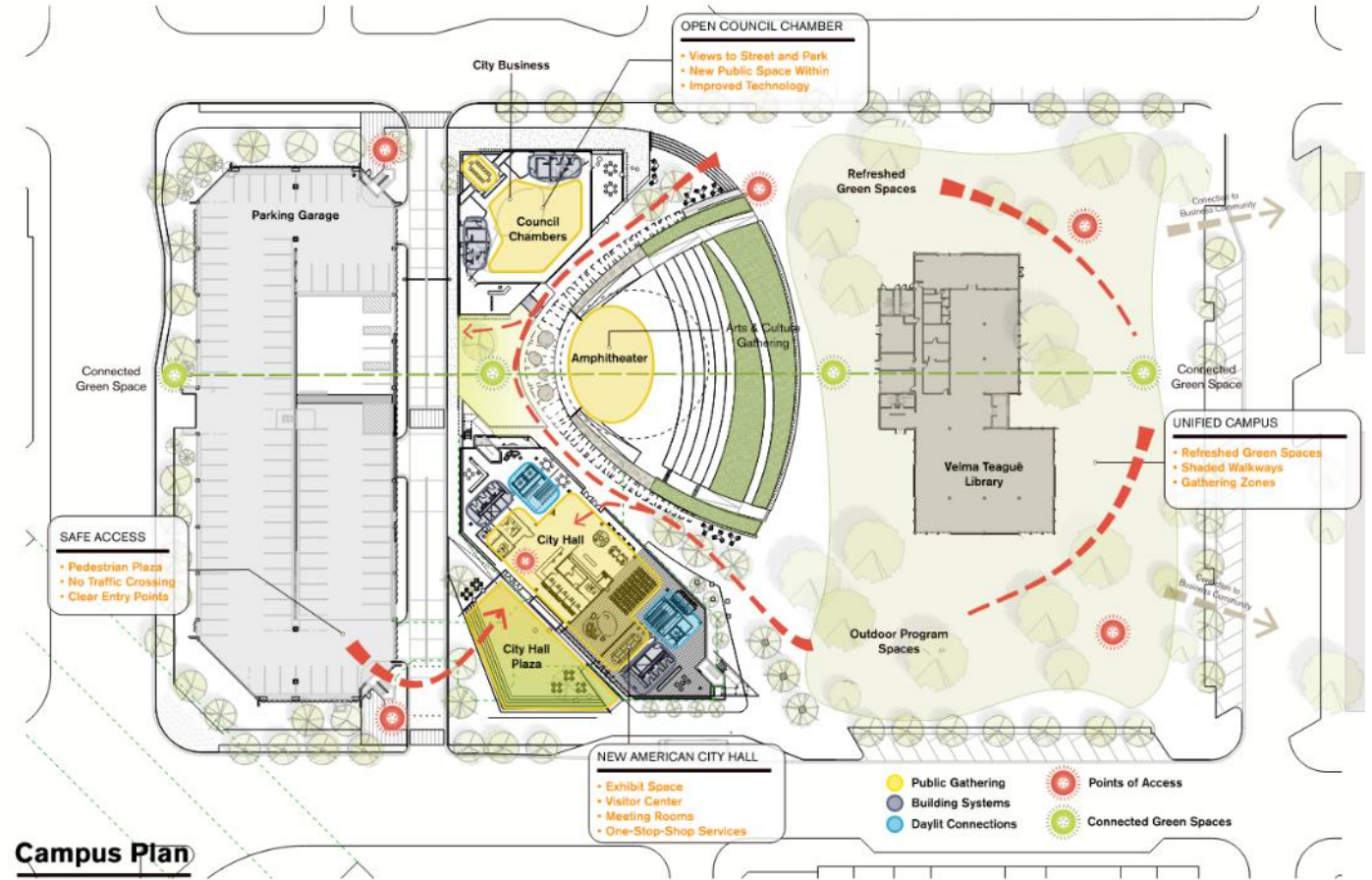

### Campus Plan





# March 15-Building and Campus





# March 15-What We Heard

## Identity

- Important to have an “identity”; “iconic” element
- Exterior materials should feel like Arizona
- Less glazing on the South Side

## Public Spaces

- Open offices at City Hall are better for light and flexibility
- Huge disconnect between city & public today; bring public to the building
- People need to know what services are available, city needs to do better in bringing them to the public
- Lounge space/seating – open spaces
- Signage wayfinding
- Likes open stairwells & access to daylight
- Concern about no elevator in the parking garage – ADA parking/people walking up and down the stairs



# March 15-What We Heard

## Campus Plan

- Other venues for music, new amphitheater?
- Make a park that attracts people all day (splash pad)
- Bigger park space: library needs to go
- Favorite tree at NW corner – better park layout for vendors, wide walkways to access
- How does this project support more use of the Civic Center?
- Need more functions at the park; bring people downtown
- Park irrigation – keep trees healthy
- Remove/relocate library (to CH?) and take back more park
- Bring library function into building – why spend \$70M on just city functions?
- Concerned about irrigation and water



# March 29-Murphy Park



1 Heroes Library



17 Council Chambers



6 FRAC

\*Approx. count (excludes COG staff and Design Team)



# March 29 – Murphy Park

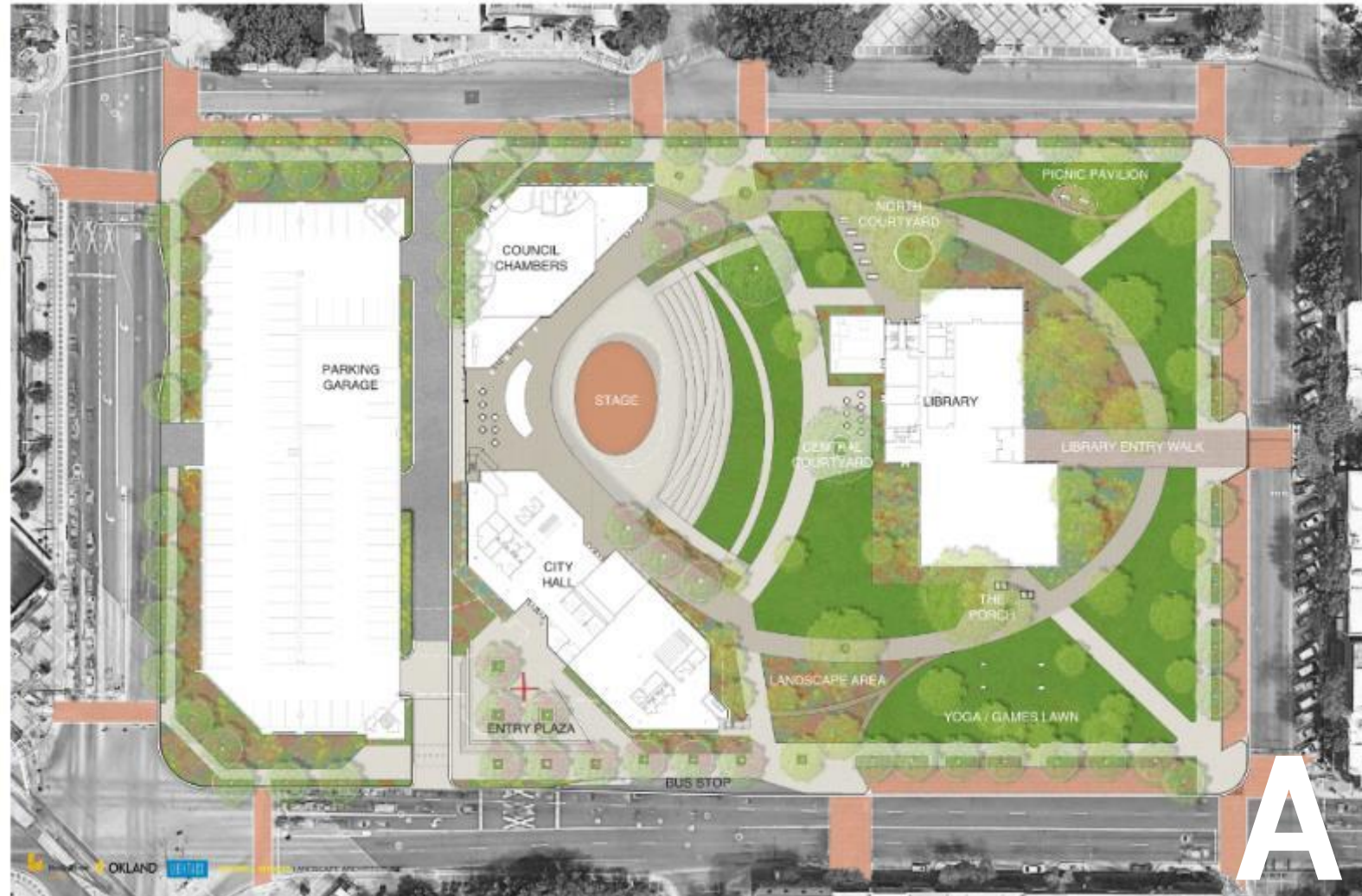
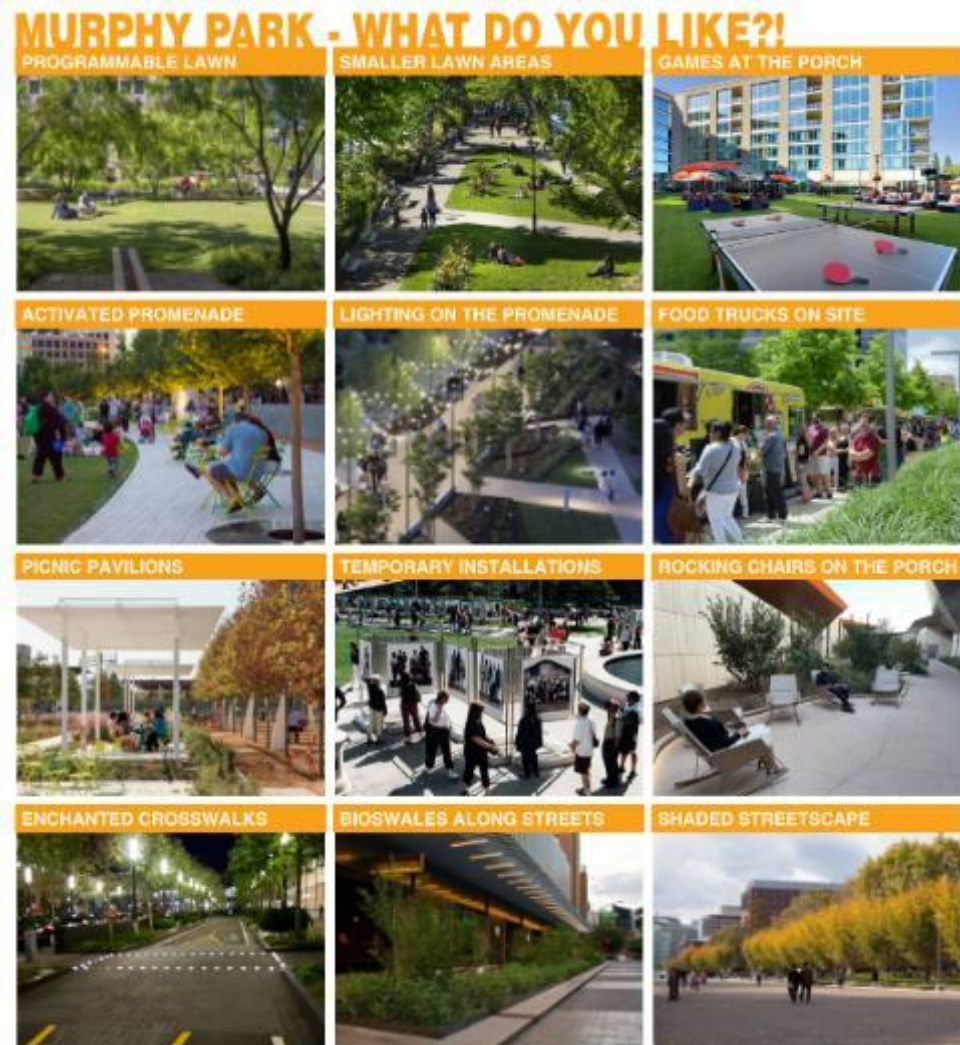

A



# March 29- What We Heard

## Encouraged by:

- Open area on 1st level of city hall
- Number of public restrooms
- The walking paths
- “Keep the existing trees”
- The swales
- Combo of turf and organic
- Lighting on the promenade
- Shaded streetscape
- Programmable lawn
- Enchanted crosswalks
- Smaller lawn area
- Bioswales along the street

## Consider Options:

- Location of library
- Rather have library in the city hall or civic annex
- Use same ADA ramp as pictured in Scheme B
- Would like to see more café seating
- Space for farmer’s market
- Art and community spaces inspired by Glendale’s multicultural identity
- Wants an iconic structure/art piece/architecture
- Make this park a destination
- Move library to City Hall
- Wants space for outdoor exercise
- More eateries/restaurants



# March 29 – Murphy Park

## MURPHY PARK - WHAT DO YOU LIKE?!

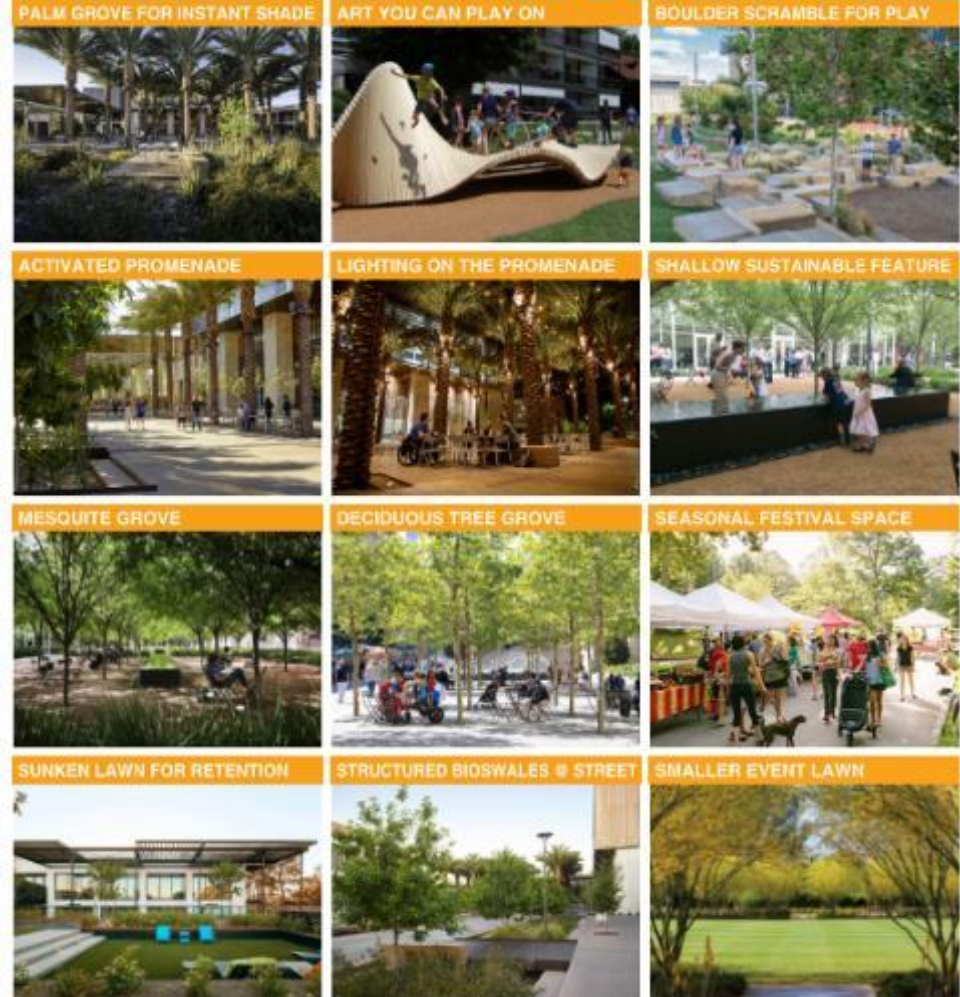

B



# March 29- What We Heard

## Encouraged by:

- Café seating
- Lights along the promenade
- “I like this drawing the best”
- The amount of greenery
- “Represents the color and creativity of Glendale”
- The idea of the ramp “slope from street”
- Shading from trees
- Festive space
- Palm Grove over the Mesquite Grove
- Water feature in mesquite grove
- Sunken lawn
- Can be a rentable venue space for weddings
- Art you can play on
- Reuse recycled building materials
- Shallow sustainable architecture

## Consider Options:

- Show more positive foot traffic
- Reduce niches for homeless encampments
- Boulder scramble location
- Mesquite grove location
- “Library not well utilized, better if it’s gone”
- “Remove library... move to City Hall or Civic Center”
- See more color
- More room for community spaces
- Suggested a community media center
- More Ethnic diversity of Glendale to show through colorful community spaces that people may assemble and be heard





# March 29- What We Heard

## Encouraged by:

- Openness of the environment
- The Shape- Especially the lawn
- Perfect amount of lawn space
- Shaded streets and structures
- Inclusion of flood irrigation
- Programmable packets
- Temporary installations that may invite people outside of Glendale
- Likes current / existing park elements
- Clocks, lamps, etc.
- Lighting on the promenade
- Programmable lawn
- Picnic pavilions
- Enhanced crosswalks

## Consider Options:

- Library -wants it to be either moved or removed
- Library to be bigger & with more hours
- More vendor space
- Rip rap rather than gravel
- Cameras installed to fight crime
- More lawn space, less vegetation
- MORE vegetation
- More inclusion of Glendale history
- Lamps, clocks, etc.
- Don't modernize park too much
- Needs something iconic to identify space as Glendale City Hall and Murphy Park
- More multicultural art
- To represent Glendale's ethnic diversity and history



# Website-Media/Comments

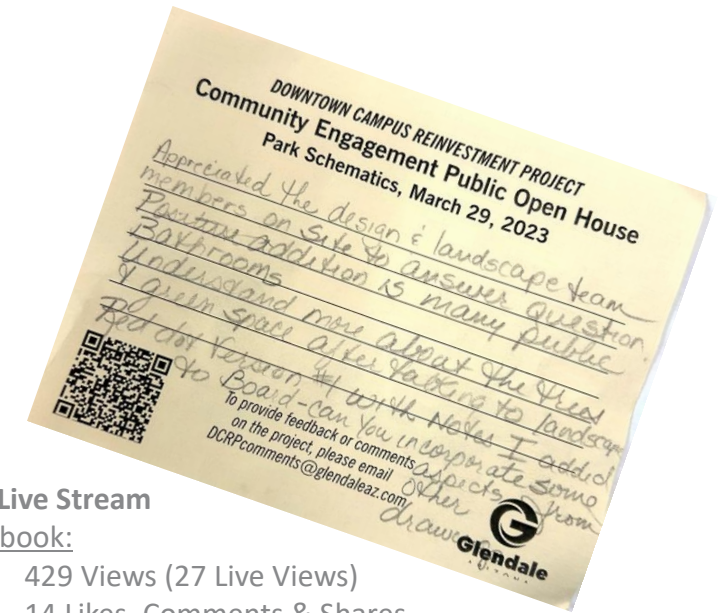

### 3/29/23 Live Stream

- Facebook:
  - 429 Views (27 Live Views)
  - 14 Likes, Comments & Shares
- YouTube:
  - 39 Views (3 Live Views)

### 3/15/23 Live Stream:

- Facebook:
  - 606 Views (35 Live Views)
  - 4 Likes, Comments & Shares
- YouTube:
  - 190 Views

# Stats



# Summary

---

- Consistency with October 26<sup>th</sup> Comments
- Optimize Shade opportunities (Structural, Pavilions, and Trees)
- Sustainable Principles (Water, Vegetation, Retainage, Flood Prevention)
- Security + Safety on Campus (Lighting Promenades)
- More Community Space (Glendale's Cultural Diversity and History)
- Public Art –Gallery in City Hall and in Murphy Park
- Programmable lawn spaces (Farmers Market, Seasonal Events)
- Future of the Velma Teague Library?

**Overall excitement for this project to activate downtown**



# Next Steps

---

- Council Work Shop for Schematic Design - (Prior to Summer Break)
- Next Community Engagement Meeting - (Summer 2023)