

ORDINANCE NO. O23-41

AN ORDINANCE OF THE COUNCIL OF THE CITY OF GLENDALE, MARICOPA COUNTY, ARIZONA, EXTENDING AND INCREASING THE CORPORATE LIMITS OF THE CITY OF GLENDALE, MARICOPA COUNTY, STATE OF ARIZONA, PURSUANT TO THE PROVISIONS OF TITLE 9, CHAPTER 4, SECTION 9-471, ARIZONA REVISED STATUTES AND ITS AMENDMENTS, BY ANNEXING CERTAIN TERRITORY LOCATED ON REEMS ROAD BETWEEN MYRTLE AVENUE AND ORANGEWOOD AVENUE IN THE CITY OF GLENDALE CONSISTING OF 1.00 ACRES TO BE KNOWN AS ANNEXATION AREA NO. 255; PROVIDING FOR AN EFFECTIVE DATE; AND ORDERING THAT A CERTIFIED COPY OF THIS ORDINANCE IS RECORDED.

WHEREAS, the City of Glendale and Maricopa County have entered into an Intergovernmental Agreement C-64-22-100-X-00 (IGA) for the exchange of roadways; and

WHEREAS, per the IGA, the City of Glendale is to annex portions of Reems Road right-of-way; and

WHEREAS, A.R.S. § 9-471(O) provides a method for the annexation of county right-of-way or roadway with no taxable real property included in the annexation area.

BE IT ORDAINED BY THE COUNCIL OF THE CITY OF GLENDALE as follows:

SECTION 1. The corporate limits of the City of Glendale are extended and increased, pursuant to the provisions of Title 9, Chapter 4, Section 9-471, Arizona Revised Statutes, by annexing certain territory contiguous to the existing city limits of the City of Glendale to be known as “Annexation Area No. AN-255”, and legally described in Exhibit A attached to this ordinance.

SECTION 2. A copy of this ordinance together with an accurate map of the territory annexed into the City of Glendale, attached as Exhibit A, shall be filed with the Maricopa County Board of Supervisors with a request that the Board of Supervisors set a hearing date as set forth in A.R.S. § 9-471(O).

SECTION 3. This ordinance becomes effective at the time the Maricopa County Board of Supervisors orders the annexation and it is certified by the Clerk of the Board and the order is filed for record in the Maricopa County Recorder’s Office.

SECTION 4. The City Clerk is accordingly instructed and authorized to forward a certified copy of this ordinance for recording to the Maricopa County Recorder’s Office.

PASSED, ADOPTED AND APPROVED by the Mayor and Council of the City of Glendale, Maricopa County, Arizona, this 10th day of October, 2023.

Mayor Jerry P. Weiers

ATTEST:

Julie K. Bower, City Clerk (SEAL)

APPROVED AS TO FORM:

Michael D. Bailey, City Attorney

REVIEWED BY:

Kevin R. Phelps, City Manager

EXHIBIT "A"
LEGAL DESCRIPTION
FOR
ANNEXATION
REEMS ROAD BETWEEN MYRTLE AVENUE AND ORANGEWOOD AVENUE

A PARCEL OF LAND SITUATED IN A PART OF THE SOUTHEAST QUARTER OF SECTION 6, TOWNSHIP 2 NORTH, RANGE 1 WEST OF THE GILA AND SALT RIVER MERIDIAN, MARICOPA COUNTY, ARIZONA, MORE PARTICULARLY DESCRIBED AS FOLLOWS:

BEGINNING AT THE EAST QUARTER CORNER OF SAID SECTION 6, FROM WHICH THE SOUTHEAST CORNER OF SAID SECTION 6, BEARS SOUTH 03 DEGREES 10 MINUTES 21 SECONDS EAST, A DISTANCE OF 2641.35 FEET;

THENCE UPON AND WITH THE EAST LINE OF THE SOUTHEAST QUARTER OF SAID SECTION 6, SAID LINE ALSO BEING THE WEST LINE OF THE CITY OF GLENDALE (COG) ANNEXATION AREA NO. 220, SOUTH 03 DEGREES 10 MINUTES 21 SECONDS EAST, A DISTANCE OF 1320.74 FEET TO THE SOUTHEAST CORNER OF THE NORTHEAST QUARTER OF THE SOUTHEAST QUARTER OF SAID SECTION 6;

THENCE UPON AND WITH THE NORTH LINE OF COG ANNEXATION AREA NO. 226, SOUTH 89 DEGREES 56 MINUTES 52 SECONDS WEST, A DISTANCE OF 33.05 FEET TO A LINE PARALLEL TO AND 33.00 FEET WEST OF AFORESAID EAST LINE;

THENCE UPON AND WITH SAID WEST PARALLEL LINE, NORTH 03 DEGREES 10 MINUTES 21 SECONDS WEST, A DISTANCE OF 1320.80 FEET TO THE NORTH LINE OF THE AFORESAID SOUTHEAST QUARTER OF SECTION 6, ALSO BEING THE SOUTH LINE OF COG ANNEXATION AREA NO. 228;

THENCE UPON AND WITH SAID SOUTH LINE, SOUTH 89 DEGREES 56 MINUTES 47 SECONDS EAST, A DISTANCE OF 33.05 FEET TO THE POINT OF BEGINNING AND CONTAINING A COMPUTED AREA OF 43,585 SQUARE FEET OR 1.001 ACRES OF LAND, MORE OR LESS.

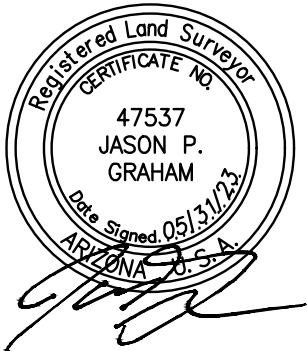

THIS IS NOT A PROPERTY
BOUNDARY SURVEY.

CITY OF GLENDALE
ANNEXATION AREA #228

MARICPOA COUNTY ALUMINUM
CAP STAMPED RLS 36563
E 1/4 COR SEC 6, T2N, R1W
POINT OF BEGINNING



NTS

PARCEL AREA:
43,585 SF OR
1.001 ACRES

ANNEXATION

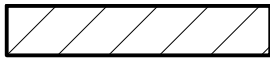

W ORANGEWOOD
AVE

78'

EXST
R/W

33'

EXST
R/W

SE 1/4
SECTION 6
T2N, R1W

SW 1/4
SECTION 5
T2N, R1W

N REEMS ROAD

N03°10'21"W 1320.80'

S03°10'21"E 2641.35' 1320.74'

S03°01'21"E 2641.35'
BASIS OF BEARINGS

CITY OF GLENDALE
ANNEXATION AREA #220

LINE DATA TABLE		
LINE	BEARING	DISTANCE
L1	S89°56'52"W	33.05'
L2	S89°56'47"E	33.05'

W MYRTLE AVE

CITY OF GLENDALE
ANNEXATION AREA #226

SE COR, NE 1/4, SE 1/4,
SEC 6, T2N, R1W

L1

MARICPOA COUNTY BRASS CAP
STAMPED RLS 36563
SE COR SEC 6, T2N, R1W

EXHIBIT "A"

REEMS RD BETWEEN MYRTLE AVE
AND ORANGEWOOD AVE

A PART OF THE SE 1/4 SECTION 6, T2N,
R1W, GILA & SALT RIVER MERIDIAN,
MARICOPA COUNTY, ARIZONA

DIBBLE



Dibble Project No
1020065.02

DATE: MAY 2023

DRN: BAR CHK: CSD

PAGE 2