



Sunrise Montessori School and Childcare Conditional Use Permit CUP23-13

Planning Commission Hearing – June 22, 2023

**Matthew Taylor
Senior Planner**





Request

Planning Commission approval of Sunrise Montessori School and Childcare with stipulations.

Applicant / Owner:

Mary Ellen Cooper, Sunrise Montessori School /
Dove of the Desert United Methodist Church

Vicinity Map

SEC OF
NORTH 73RD
AVENUE &
WEST
BEARDSLEY
ROAD

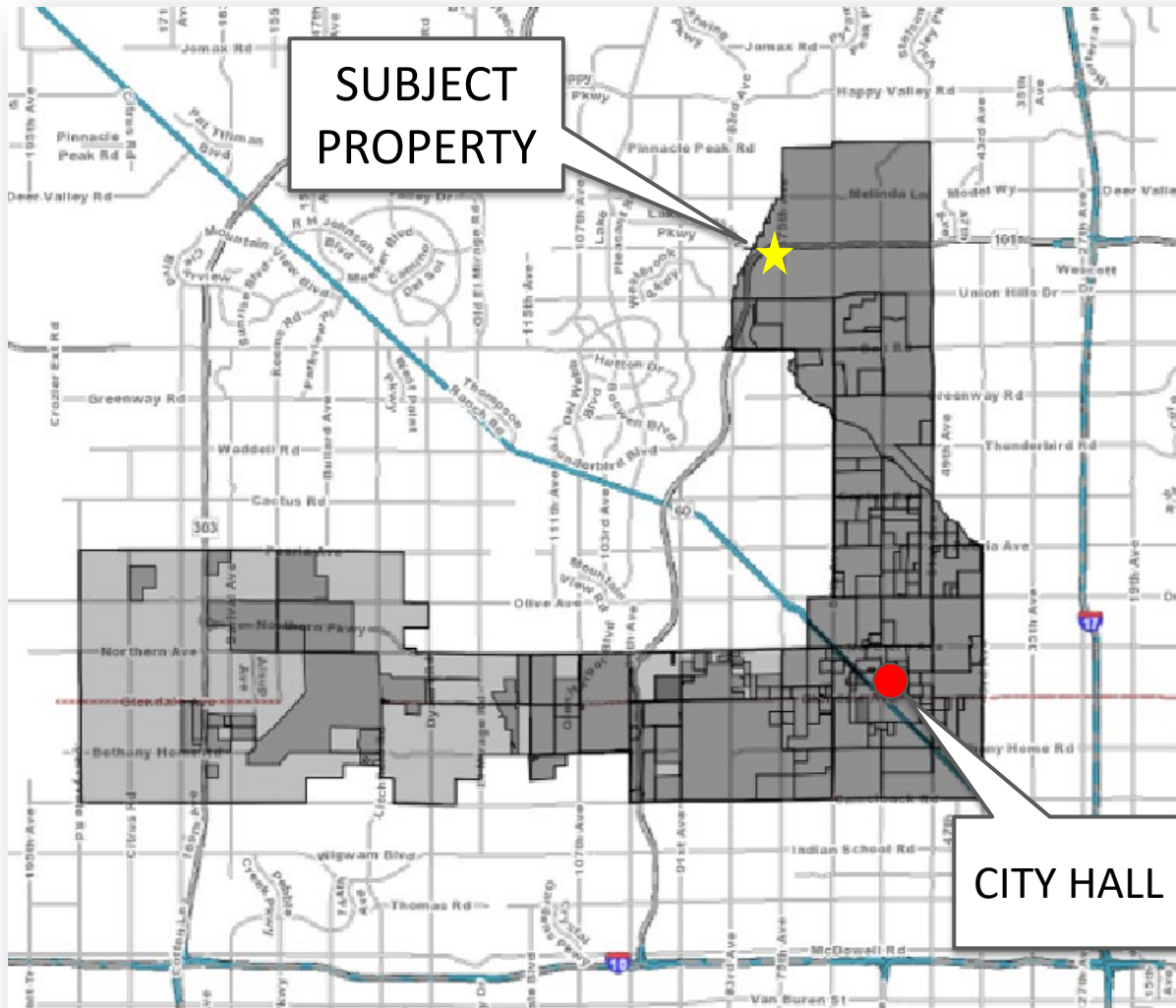

Aerial Map

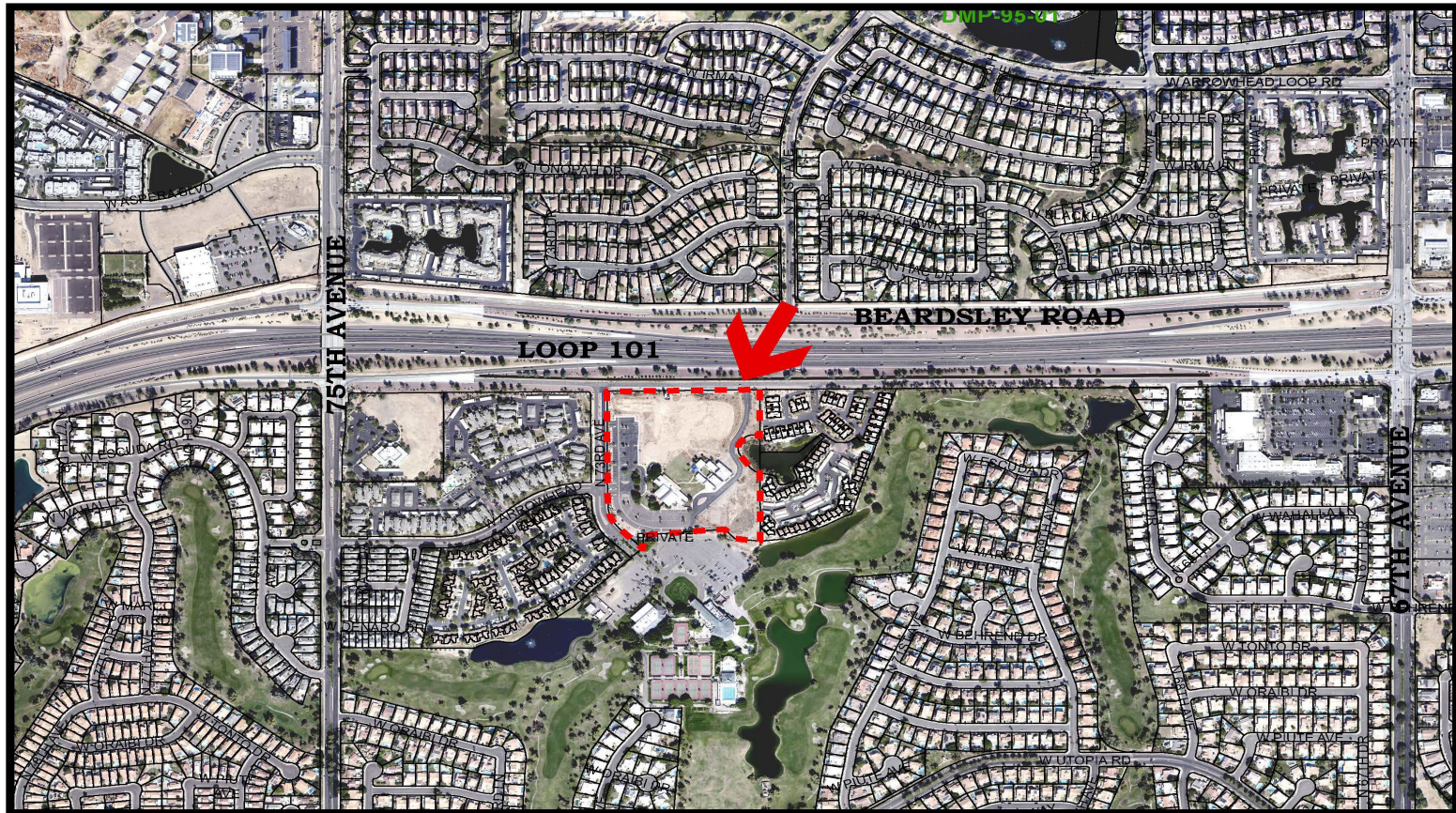

Aerial Date: October 2021



Project Details





Project Details

- Zoning and General Plan
- Property Information
- Project Summary



Public Involvement

- Neighborhood notice May 11th
- Hearing notices May 26th
- *Arizona Republic* May 31st
- Property posting June 1st

Applicant and staff received one comment in support



Findings & Analysis

- General Plan consistency
- Not detrimental to health, safety, or general welfare; no adverse effects on surrounding neighborhood when consideration is given to the character and size of the use and hours of operation



Findings & Analysis

- Adequate size and shape, zoning district requirements are met
- Adequate access to public streets, safe and efficient on-site circulation
- Stipulations to mitigate anticipated detrimental effects



Recommendation

Staff recommends approval of CUP23-13 subject to the following stipulation:

Development shall be in substantial conformance with the project narrative date stamped May 18, 2023, and site plan date stamped May 31, 2023.



Sunrise Montessori School and Childcare Conditional Use Permit CUP23-13

Planning Commission Hearing – June 22, 2023

**Matthew Taylor
Senior Planner**

