

<input type="checkbox"/>	Failed
<input checked="" type="checkbox"/>	Conditionally Approved
<input type="checkbox"/>	Approved
CUP24-05 Conditionally Approved Site Plan	

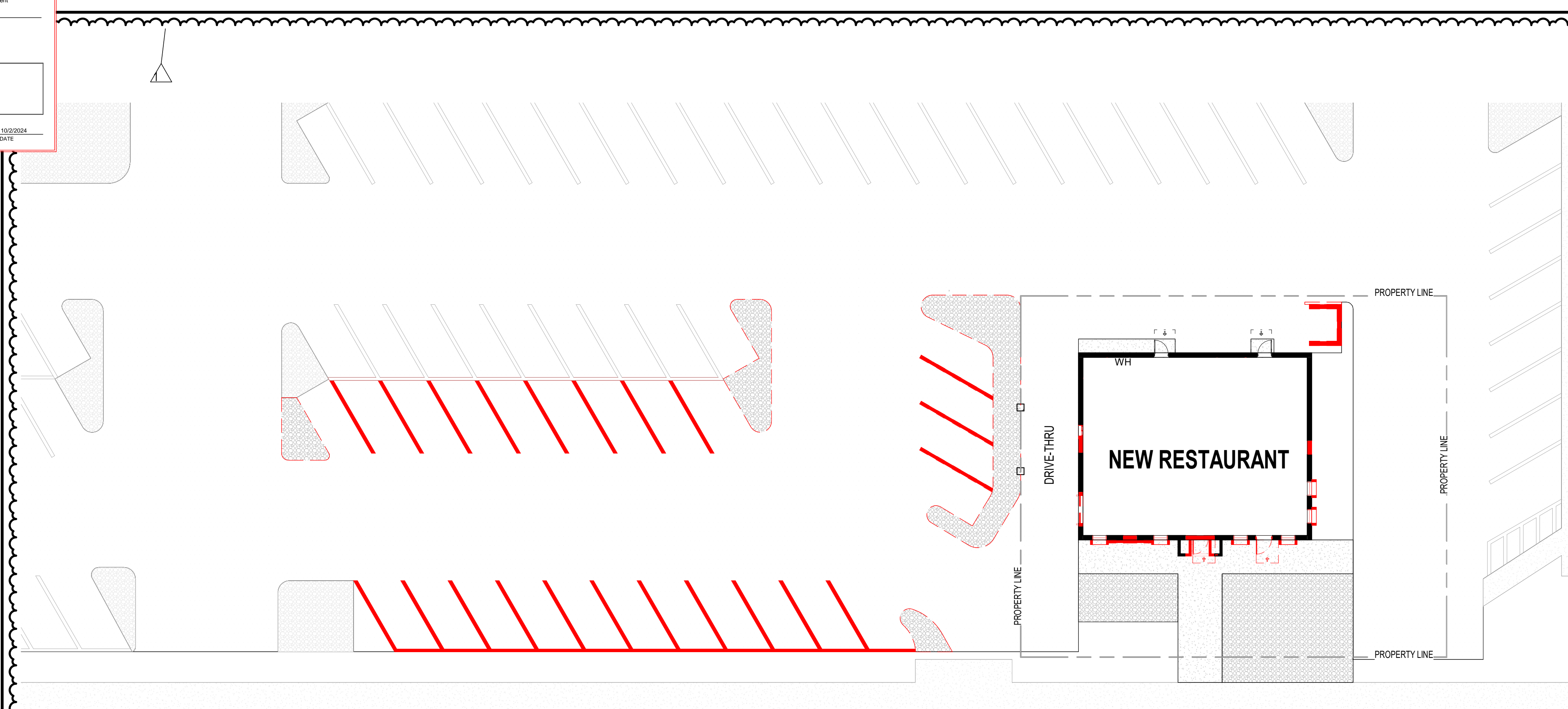

2 SITE PLAN - DEMO
1/16" = 1'-0"

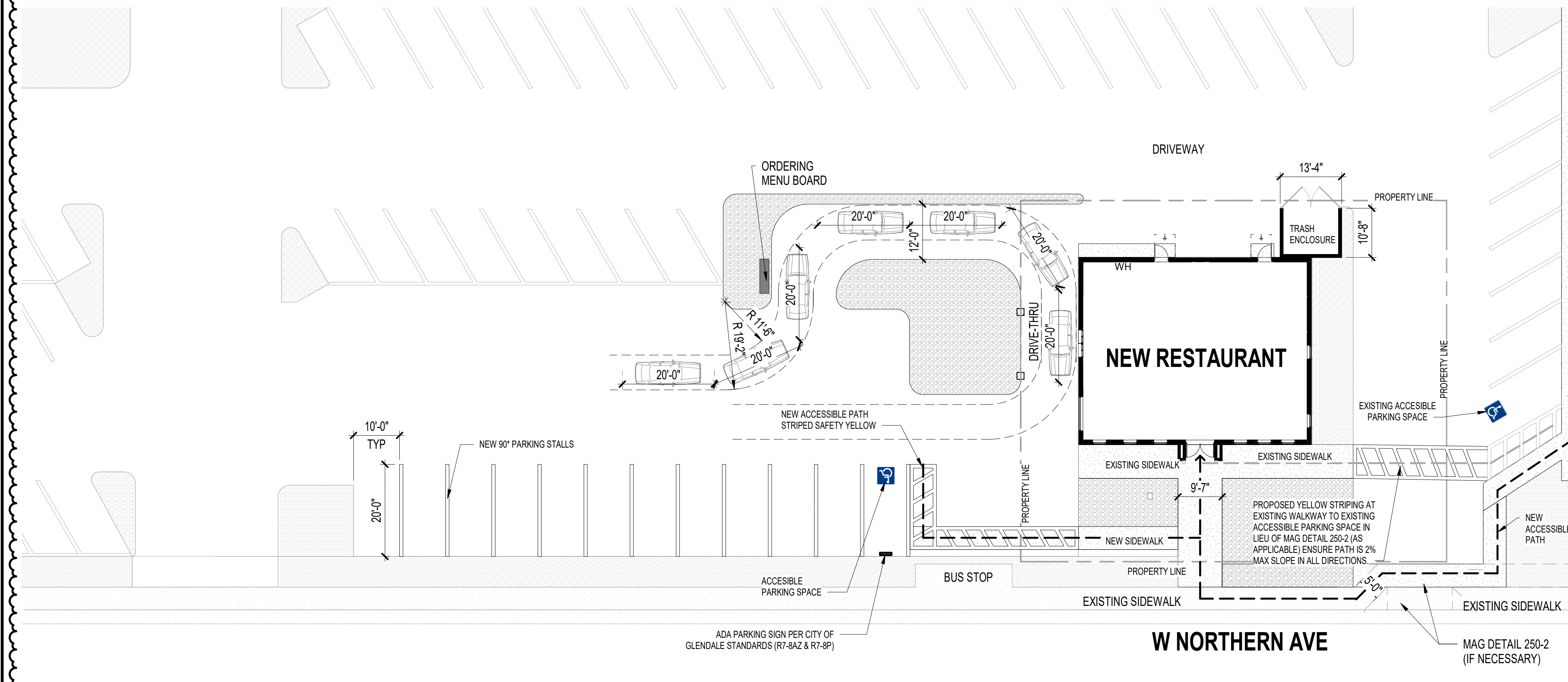

1 SITE PLAN
1/16" = 1'-0"

LEGEND (FLOOR PLAN):

- WALL/DOOR/WINDOW SHOWN AS RED COLOR ARE DEMOLISHED
- WALL/DOOR/WINDOW SHOWN AS GRAY COLOR ARE EXISTING
- WALL/DOOR/WINDOW SHOWN AS GRAY COLOR ARE NEW DESIGN

GENERAL NOTES (SITE):

- A. REFER TO CIVIL DRAWINGS FOR HARD SURFACE IMPROVEMENTS.
- B. REFER TO AND COORDINATE WITH CIVIL, LANDSCAPE, STRUCTURAL, MECHANICAL AND ELECTRICAL DRAWINGS FOR ADDITIONAL SITE INFORMATION NOT SHOWN ON THIS DRAWING



3 RESERVED PARKING SIGN
NTS

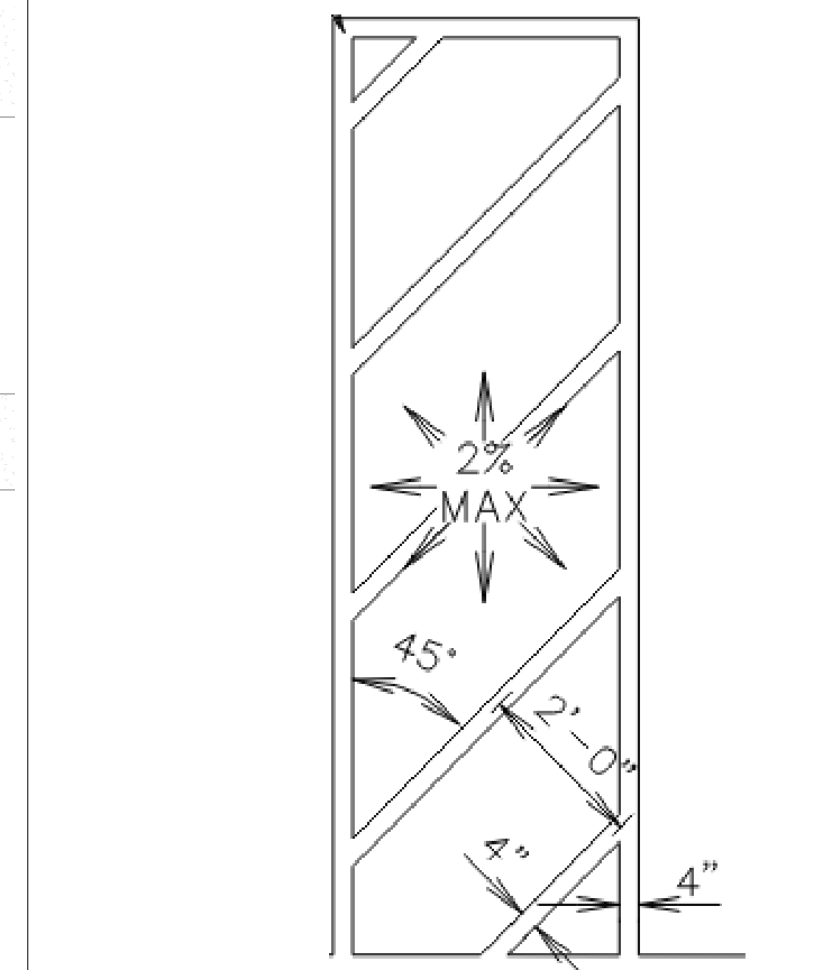

6 PARKING STALL DETAIL
NTS

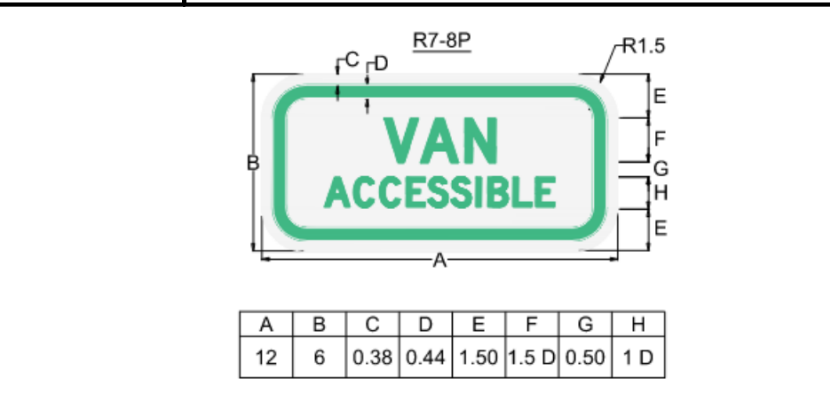

4 VAN ACCESSIBLE SIGN
NTS



5 ACCESSIBLE SIGN
NTS

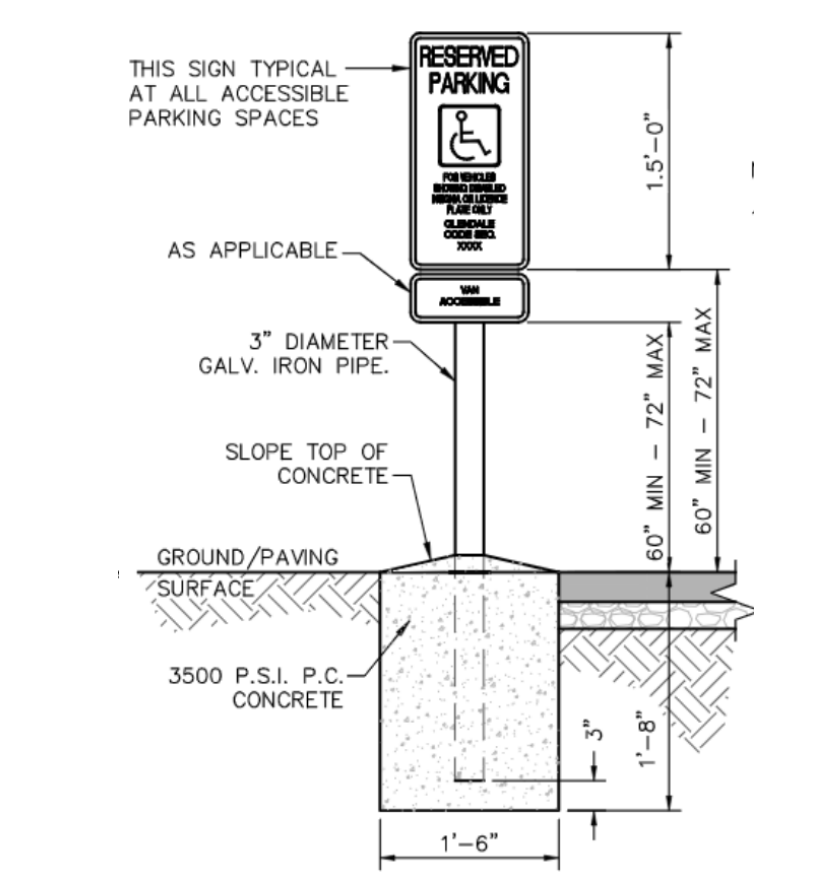

7 PARKING SIGN DETAIL
NTS

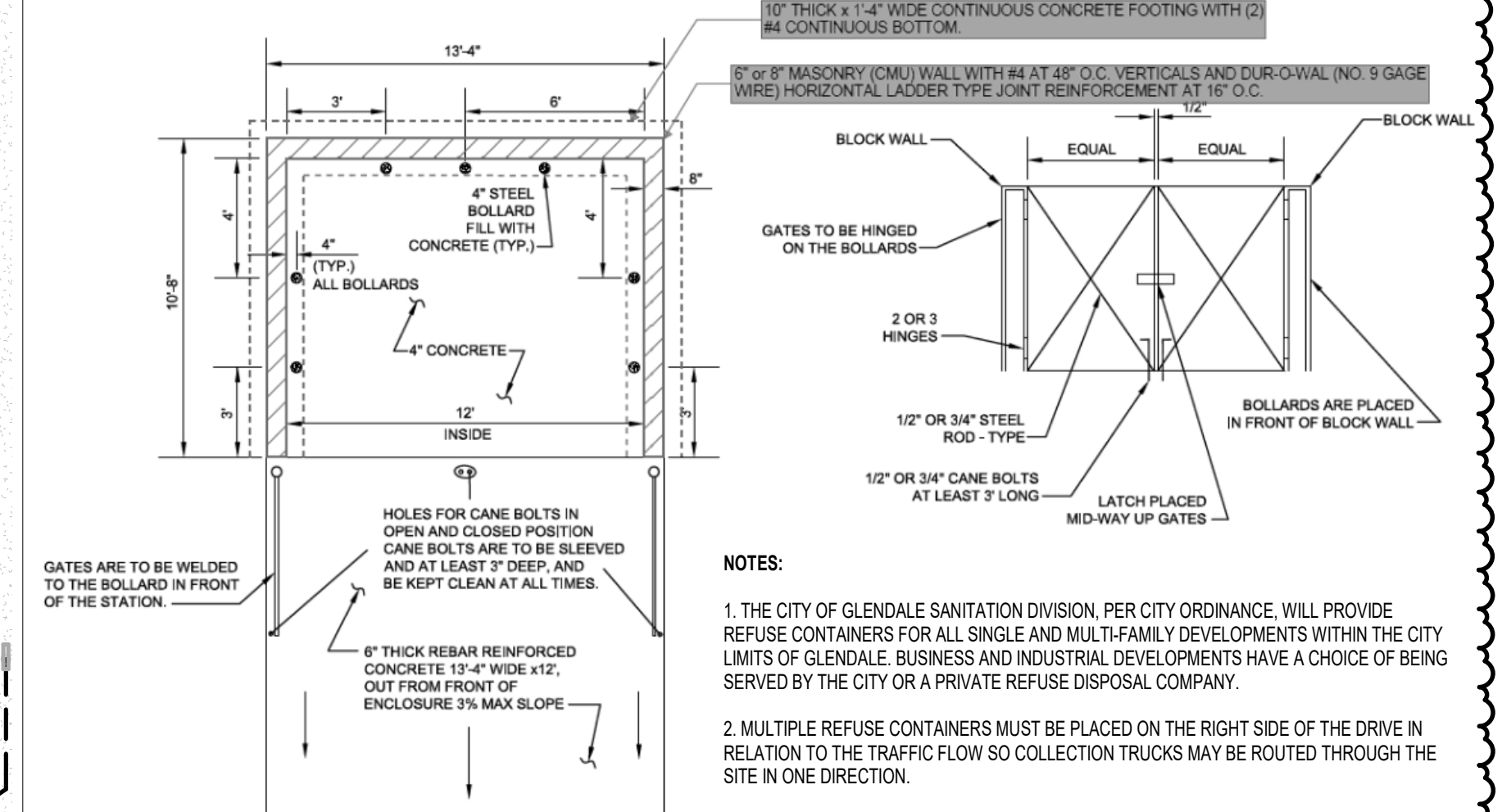

- NOTES:**
1. THE CITY OF GLENDALE SANITATION DIVISION, PER CITY ORDINANCE, WILL PROVIDE REFUSE CONTAINERS FOR ALL SINGLE AND MULTI-FAMILY DEVELOPMENTS WITHIN THE CITY LIMITS OF GLENDALE. BUSINESS AND INDUSTRIAL DEVELOPMENTS HAVE A CHOICE OF BEING SERVED BY THE CITY OR A PRIVATE REFUSE DISPOSAL COMPANY.
 2. MULTIPLE REFUSE CONTAINERS MUST BE PLACED ON THE RIGHT SIDE OF THE DRIVE IN RELATION TO THE TRAFFIC FLOW SO COLLECTION TRUCKS MAY BE ROUTED THROUGH THE SITE IN ONE DIRECTION.
 3. ENCLOSURES IN INDUSTRIAL AREAS SHALL BE PLACED IN THE BACK OF THE LOT IN LINE WITH THE DRIVE THRU SO THE DRIVER CAN HAVE A DIRECT APPROACH TO THE REFUSE BIN, SERVICE IT, AND EXIT THE FACILITY.
 4. THE ENCLOSURE SHOULD NOT BE PLACED AT THE END OF A DEAD END STREET UNLESS THERE IS A TURNING RADIUS OF 52.5 FEET.
 5. THE ENCLOSURE SHALL BE FREE OF ANY OVERHEAD OBSTRUCTIONS WHICH MAY INTERFERE IN THE SERVICING OF THE CONTAINER.
 6. GATE ARE REQUIRED ON ALL ENCLOSURES FOR COMMERCIAL PROJECTS IN LOCATIONS VISIBLE TO THE PUBLIC. THE GATES MUST CLEAR THE DRIVEWAY AND BE ABLE TO BE LOCKED IN AN OPEN POSITION AT OR PAST 90 DEGREES SO AS NOT TO INTERFERE WITH THE OPERATION OF THE COLLECTION TRUCK.
 7. CONCRETE - MINIMUM PROPERTIES:
 - SPECIFIED 28-DAY COMPRESSIVE STRENGTH = $F_c = 2,500$ PSI
 - MAXIMUM SLUMP AT POINT OF PLACEMENT = 4-1/2"
 8. MASONRY - MINIMUM PROPERTIES:
 - HOLLOW CORE MASONRY UNITS SHALL CONFORM TO ASTM C90, MEDIUM WEIGHT, GRADE N, $F_m = 1,500$ PSI, RUNNING BOND
 - MORTAR = 1,800 PSI (TYPE S)
 - GROUT = 2,000 PSI (MECHANICALLY VIBRATE GROUT IMMEDIATELY AFTER POURING)
 9. STEEL - MINIMUM PROPERTIES:
 - ALL REINFORCING PER CRSI SPECIFICATIONS AND HANDBOOK AND ASTM A615 ($F_y = 40$ PSI), PROVIDE MINIMUM 3" CLEARANCE FROM THE BOTTOM OF THE FOOTING.
 - 24" MIN LAP SPLICE FOR #4 REBAR IN CONCRETE AND MASONRY

8 REFUSE COLLECTION ENCLOSURE DETAIL G-934
NTS

NO.	REVISION	DATE
1	1st City Comment	2024

DATE: 05/13/2024

SHEET TITLE:
ARCHITECTURAL
OVERALL SITE PLAN &
DEMO SITE PLAN

SHEET NUMBER:
A1.1