

ORDINANCE NO. 026-09

AN ORDINANCE OF THE COUNCIL OF THE CITY OF GLENDALE, MARICOPA COUNTY, ARIZONA, REZONING 9.4 ACRES LOCATED AT THE NORTHWEST CORNER OF REEMS ROAD AND MYRTLE AVENUE FROM RR-45 (RURAL RESIDENCE-45) TO PAD (PLANNED AREA DEVELOPMENT) FOR A DEVELOPMENT PLAN ENTITLED “REEMS & MYRTLE”; AMENDING THE ZONING MAP; PROVIDING FOR AN EFFECTIVE DATE; AND ORDERING THAT A CERTIFIED COPY OF THIS ORDINANCE IS RECORDED.

WHEREAS, due and proper notice of such public hearing was given in the time, form, substance and manner provided by law, including publication of such notice in *The Arizona Republic* on January 1, 2026; and

WHEREAS, the City of Glendale Planning Commission held a public hearing on January 22, 2026, in zoning case ZON25-07 in the manner prescribed by law for the purpose of rezoning property located at the northwest corner of Reems Road and Myrtle Avenue from RR-45 (Rural Residence-45) to PAD (Planned Area Development); and

WHEREAS, the City has considered the individual property rights and personal liberties of the residents of the city before adopting this zoning ordinance; and

WHEREAS, the City of Glendale Planning Commission recommended to the mayor and the council the zoning of property as described above and the mayor and the council desire to approve such recommendation to rezone the property described on Exhibit A to PAD (Planned Area Development) in accordance with the development plan currently on file with the planning division as of the date of this ordinance.

BE IT ORDAINED BY THE COUNCIL OF THE CITY OF GLENDALE as follows:

SECTION 1. That a parcel of land in Glendale, Maricopa County, Arizona located at the northwest corner of Reems Road and Myrtle Avenue and more accurately described in Exhibit A to this ordinance, is conditionally rezoned from RR-45 (Rural Residence-45) to PAD (Planned Area Development).

SECTION 2. That the rezoning provided for is conditioned and subject to the following:

1. Development shall be in substantial conformance with the Reems & Myrtle PAD Narrative, final date stamped November 10, 2025.

SECTION 3. The City of Glendale Zoning Map is amended by this ordinance to reflect the change in districts referred to and the property described in Section 1 above as shown in Exhibit B.

SECTION 4. This Ordinance becomes effective at the time and in the manner prescribed by law.

SECTION 5. The City Clerk is instructed and authorized to forward a certified copy of this ordinance for recording to the Maricopa County Recorder's Office.

PASSED, ADOPTED AND APPROVED by the Mayor and Council of the City of Glendale, Maricopa County, Arizona, this 24th day of February, 2026.

Mayor Jerry P. Weiers

ATTEST:

Julie K. Bower, City Clerk (SEAL)

APPROVED AS TO FORM:

Michael D. Bailey, City Attorney

REVIEWED BY:

Patrick S. Banger, City Manager

EXHIBIT "A"

**REEMS AND MYRTLE
ANNEXATION
LEGAL DESCRIPTION**

A parcel of land situate within a portion of the Southeast Quarter of Section 6, Township 2 North, Range 1 West of the Gila and Salt River Meridian, Maricopa County, Arizona, more particularly described as follows:

COMMENCING at the Southeast corner of said Section 6, monumented by a Maricopa County brass cap in hand hole from which the East Quarter Corner of said Section 6 monumented by a Maricopa County brass cap in hand hole bears North 03°10'18" West, 2641.25' as the Basis of Bearing.

THENCE North 03°10'18" West, 1,320.56 feet to a found pk nail accepted as the centerline intersection of Myrtle Avenue and Reems Road;

THENCE South 89°56'51" West, 33.05 feet to a line 33.00 feet westerly of and parallel with the easterly line of the Southeast Quarter of said Section 6 and the **POINT OF BEGINNING**;

THENCE South 89°57'11" West, 470.46 feet;

THENCE North 03°08'41" West, 880.44 feet;

THENCE North 89°57'33" East, 470.03 feet to a line 33.00 feet westerly of and parallel with the easterly line of the Southeast Quarter of said Section 6;

THENCE South 03°10'12" East along said parallel line, 880.37 feet to the **POINT OF BEGINNING**.

The above described parcel contains 413,399 square feet or 9.4903 acres more or less and being subject to any easements, restrictions, rights-of-way of record or otherwise.

The description shown hereon is not to be used to violate any subdivision regulation of the state, county and/or municipality or any land division restrictions.

Prepared by: Colliers Engineering and Design
2141 E. Highland Avenue, Suite 250
Phoenix, AZ 85016 Project No.2683

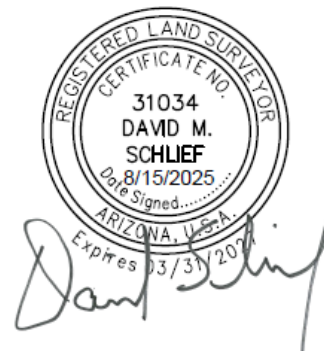

August 15, 2025
U:\2600\2683\SURVEY\DOCS\LEGAL\2683 REEMS AND MYRTLE ANNEXATION LEGAL.docx

EXHIBIT "B"

