

WR# 23052885

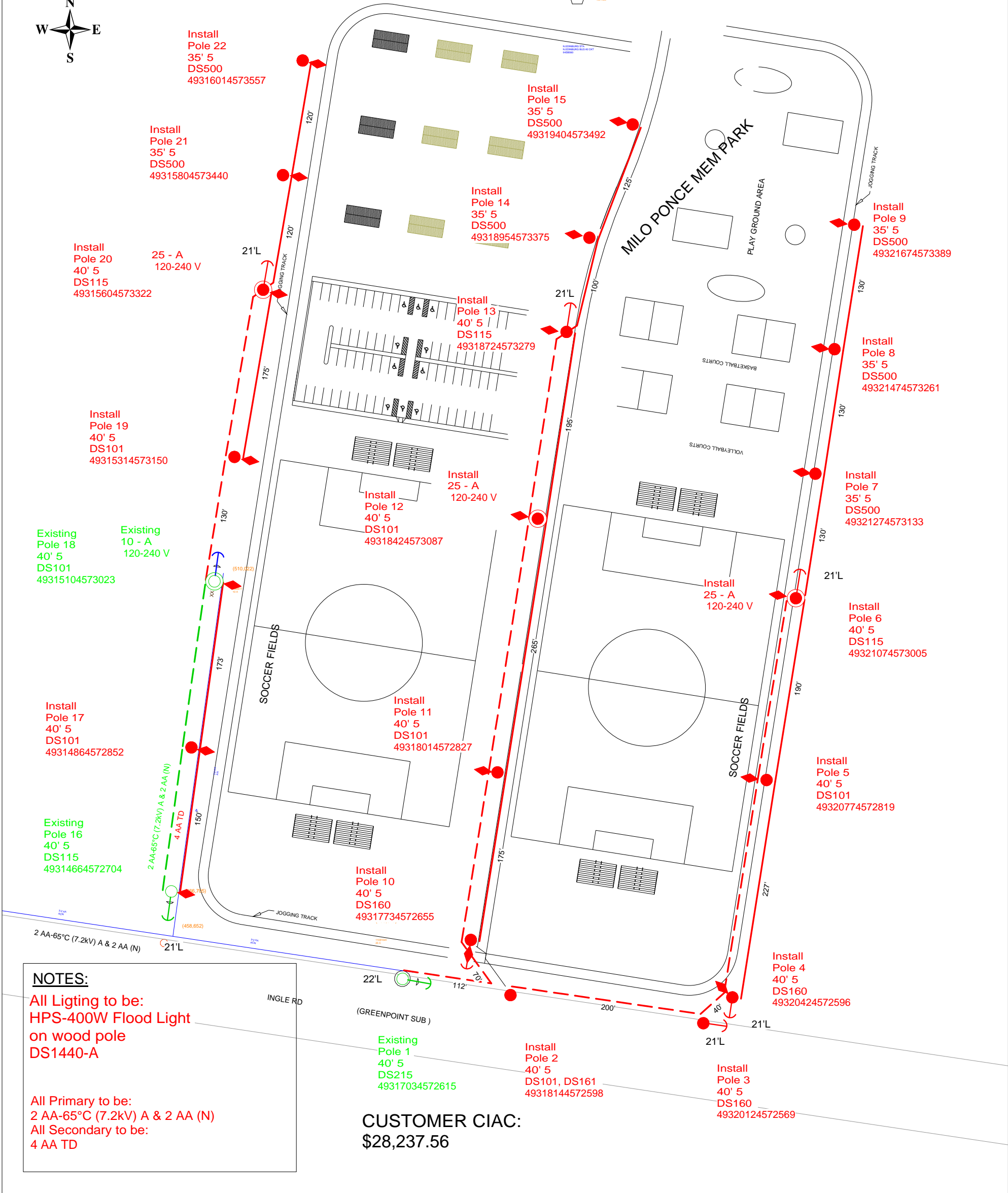

NOTES:
 All Lighting to be:
 HPS-400W Flood Light
 on wood pole
 DS1440-A

 All Primary to be:
 2 AA-65°C (7.2kV) A & 2 AA (N)
 All Secondary to be:
 4 AA TD

CUSTOMER CIAC:
 \$28,237.56

An LD-Pro® Worksketch

Date Requested: 2/14/2008	Bucket Truck?: Y
Date Required: 3/7/2008	Truck to Site?: Y

Job Name: Edinburg-Milo Ponce Mem Park Ingle Rd 4 WD?: N

Location: Ingle Rd east of Doolittle Road County: HIDALGO

Division: CP District: Edinburg Crew HQ: Pharr Const 1 Station No.: Circuit No.: 560

W/R#: 23052885 WO#: DCP0151386 Sta/Circuit Name: N Edinburg

JU Proposal(s): EDN100039 Not Staked Not Cleared Voltage: Map: Milo Ponce Mem

R/W#: CUSTOMER SERVICE-CI-NEW SERVICE Phases: Quad:

Install Flood lights for New Park Date: 2/20/2008 Print #: Scale: 1" = 100'

Drawn By: Y. Perez Page: 1 of 1

PLEASE >> Please remit To:

DETACH >> AEP-Texas Central Co. Company No: 211
 Rosie Underwood Contract No: DWMS00000076585
 5700 N. Cage Blvd. Customer No: 11109771
 STUB >> Pharr, TX 78577-7921 Date: 2/21/2008
 Include WR# 23052885 on Check Amount Due: 28,237.56

AND >> Bill To:

RETURN >> Hidalgo County Precinct No. 4
 2812 S BUSINESS 281

WITH >> Edinburg, TX 78539

PAYMENT >> Amount Remitted: _____

Contract No: DWMS00000076585
 Date: 2/21/2008

PRO FORMA

Customer No: 11109771
 Purchase Order: 23052885

Description	Quantity	UOM	Init Amt	Net Amount
Install Overhead Electrical Facilities & Lighting	1.0	EA	28,237.56	28,237.56
			Amount Due:	<u>28,237.56</u>

AEP Texas Central Company

**Contribution-In-Aid-Of-Construction Agreement
For Electric Distribution Service**

Hidalgo County Precinct No. 4
Service: Ingle Rd. east of Doolittle Rd
EDINBURG, TX

Mailing: 2812 S BUSINESS 281
Edinburg, TX 78539

Contract #: DWMS00000076585 Work Request #: 23052885
Date: 2/21/2008

The Customer has requested the installation of electric distribution facilities (hereinafter referred to as "Basic Service") as follows: Install Overhead Electrical Facilities & Lighting

Additionally, the Customer has requested Premium Service as follows:

AEP Texas Central Company (hereinafter referred to as "Company") agrees to Install Overhead Electrical Facilities & Lighting

Customer agrees to Pay company stated amount, provide access to property, and complete easement for electrical facilities.

In accordance with the Company's terms and conditions as filed with the Public Utilities Commission of Texas the Customer agrees to pay AEP Texas Central Company a nonrefundable payment as follows.

1. \$28,237.56 is the total up-front Contribution-In-Aid-Of-Construction.

All facilities installed by the Company will be and remain property of the Company. The Company expressly retains the right to use said lines and equipment for any purpose which Company deems advisable, including the distribution of electric service to other customers.

It is understood and agreed that the Company will not begin facilities construction until all Contribution-In-Aid-Of-Construction costs for Basic and Premium Services outlined above are received by the Company.

It is understood and agreed that this agreement, and particularly the amounts of the Contribution-In-Aid-Of-Construction contained herein, are based on the specifics of the Customer's request for distribution electric facilities.

Other utilities may have lines and/or equipment that utilize American Electric Power's pole or other facilities. American Electric Power is not responsible for the installation, relocation or removal of lines and/or equipment owned by other utilities at this location. Each utility is responsible for its own equipment and the time it takes to install, remove or relocate it. Any fees charged by other utilities are the responsibility of the customer, not American Electric Power. The customer is responsible for contacting the other utilities and making arrangements with them for any work that must be done to facilitate this contract.

If the Customer's request for facilities is altered or the Customer requests a delay or otherwise is unable to take service by 02/21/2008, the Company reserves the right to adjust the amount of the Contribution-In-Aid-Construction to reflect either the alteration in requested facilities or the delay in service, or both. All dates for commencement and completion of construction are estimates only and do not represent guaranteed dates.

Nothing herein contained shall be construed as a waiver or relinquishment by Company or any right it has or may hereafter have to discontinue service for or on account of default in the payment of any bill owing or to become owing thereunder or for any reason or cause stated in the Company's Tariff.

The quoted price will be valid until 05/21/2008

By signing and returning this Agreement, Customer agrees to accept the above described terms and conditions.

Customer
By _____
Signature: _____
Title: _____
Date: _____

Company
By _____
Signature: _____
Title: _____
Date: _____