

# HIDALGO COUNTY PRECINCT No. 2 SOUTH TOWER ESTATES IMPROVEMENTS 2009

SAN DIEGO DRIVE  
SAN BERNARDINO DRIVE  
SAN VICENTE DRIVE  
SANTA BARBARA DRIVE  
SANTA CRUZ DRIVE

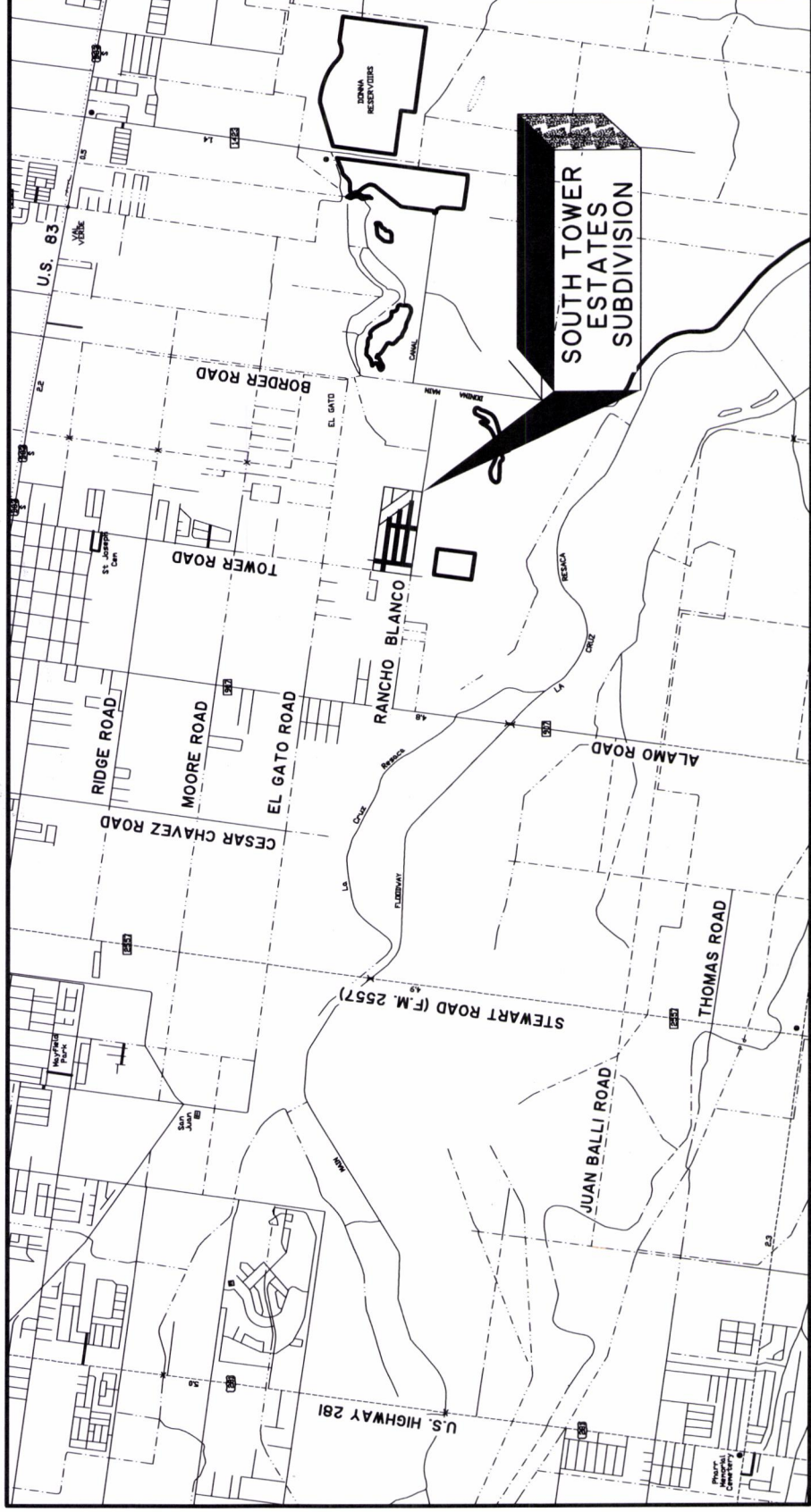

SCALE IN MILES  
0 0.5 1 2  
DESIGN SPEED:  
SPEED = 45 MPH

## HIDALGO COUNTY OFFICIALS

COUNTY JUDGE	JUAN D. SALINAS III
COMMISSIONER PRECINCT NO. 1	SYLVIA HANDY
COMMISSIONER PRECINCT NO. 2	HECTOR "TITO" PALACIOS
COMMISSIONER PRECINCT NO. 3	JOE FLORES
COMMISSIONER PRECINCT NO. 4	OSCAR GARZA, JR.



**R. Gutierrez**  
**Engineering**  
**Corporation**  
Professional Engineers & Land Surveyors  
130 E. PARK AVENUE • PHARR, TEXAS 78577  
(TEL) 956 782-2557 • (FAX) 956 782-2558



THE SEAL APPEARING ON THIS DOCUMENT WAS AUTHORIZED BY RAMIRO GUTIERREZ, P.E. 65948  
DATE: 1-14-09  
ALTERATION OF A SEALED DOCUMENT WITHOUT PROPER NOTIFICATION TO THE ENGINEER IS UNLAWFUL UNDER THE TEXAS ENGINEERING PRACTICE LAW.