



COUNTY COMMISSIONER PRECINCT 3  
County of Hidalgo

*OK  
Please process  
ASAP*

Joe M. Flores  
County Commissioner Pct. No. 3

October 7, 2009

Ms. Diana R. Serna, Director  
Urban County Program  
C/o Monica Luna, Coordinator  
1916 Tesoro Blvd.  
Pharr, Texas 78577

Ms. Serna:

Please allow this letter to serve as a request to amend the engineering contract with Ricardo Hinojosa Engineering. The contract should be amended to include much needed turning lanes on the 2 Mile Line 492 to Abram Road project.

Attached please find documents from the engineer indicating the turning lanes as well as the cost estimate for his services.

If additional information is needed, please do not hesitate to contact my office at (956)585-4509.

Sincerely,

A handwritten signature in cursive script that reads "Joe M. Flores".

Joe M. Flores, Commissioner  
Hidalgo County Precinct #3

Office: (956) 585-4509 • Fax: (956) 205-7009  
724 N. Breyfogle • Mission, Texas 78574

*RECEIVED*  
*OCT 7 2009*  
*[Signature]*



Commissioner Joe Flores  
Hidalgo County Precinct 3  
724 North Breyfogle  
Mission, TX 78572  
Ph: (956) 585-4509  
Fx: (956) 585-2375

RE: 2 Mile Road Improvements from FM 492 to Abram Road

Commissioner Flores,

As requested, attached is the estimated cost for construction of turning lanes along 2 Mile Road between FM 492 and Abram Road. The Engineering Fee to prepare the documents for the additional services will be \$1,661.40. If there are any questions regarding this matter please call our office.

Sincerely,

Ricardo Hinojosa, P.E.  
Hinojosa Engineering, Inc.



Engineers Estimate of Probable Cost  
Mile 2 Road from Abram Rd. to FM 492

Date: October 6, 2009

ITEM NO.	ITEM DESCRIPTION	ESTIMATED QUANTITY	UNIT	UNIT PRICE		UNIT TOTAL
<b>ESTIMATED COSTS FOR CONSTRUCTION OF TURNING LANES</b>						
<b>Paving Improvements</b>						
1	1 1/2" H.M.A.C. Type "D"	810	SY	\$7.00	=	\$5,670.00
2	8" Compacted Flexible Base	965	SY	\$8.00	=	\$7,720.00
3	8" Compacted Subgrade	965	SY	\$3.50	=	\$3,377.50
<b>Miscellaneous</b>						
1	Guard Rail	100	LF	\$40.00	=	\$4,000.00
<b>Total</b>						<b>\$20,767.50</b>
<b>Engineering Fee (8%)</b>						<b>\$1,661.40</b>

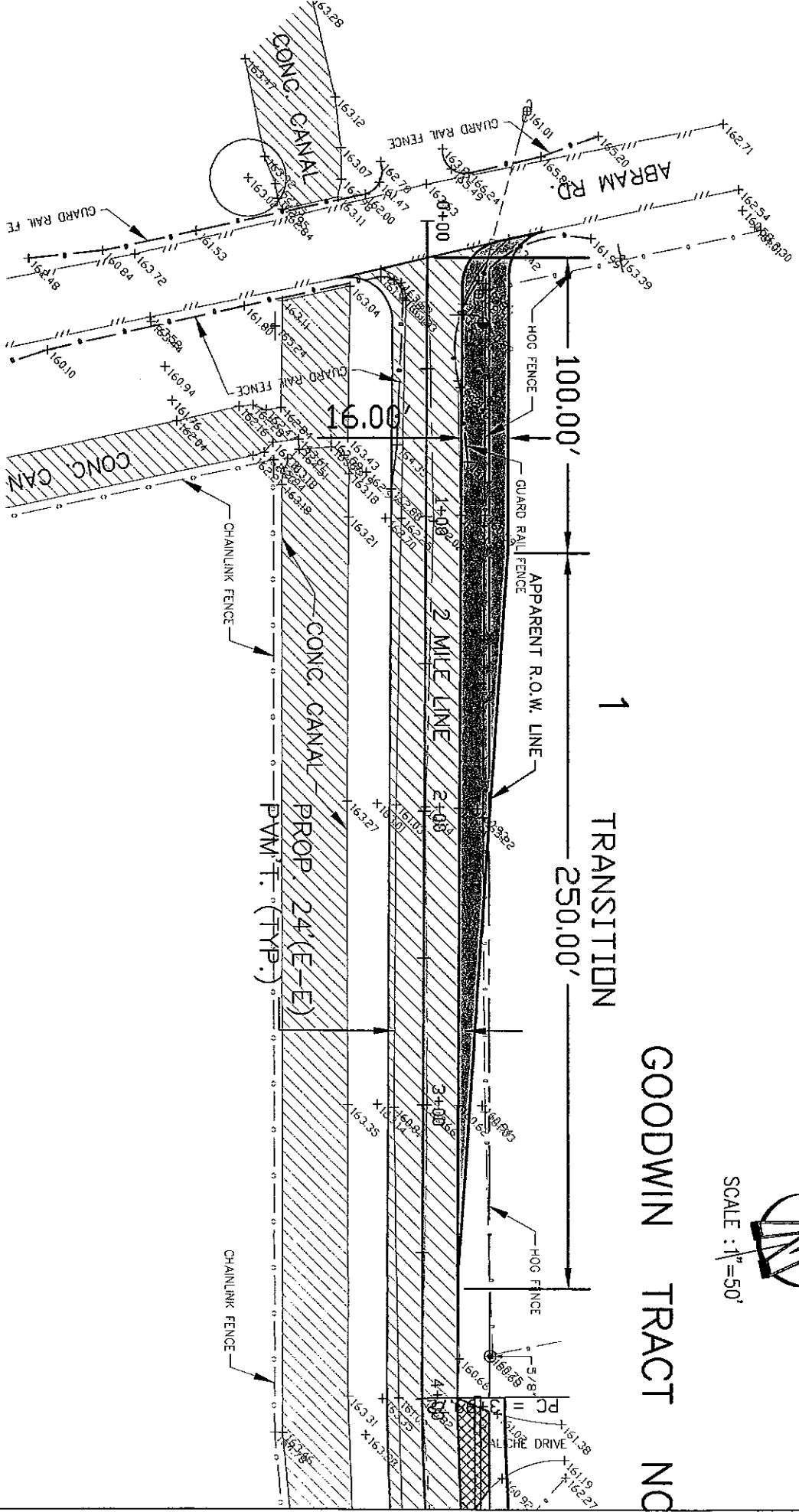

1  
TRANSITION

250.00'

GOODWIN TRACT NO

SCALE : 1" = 50'

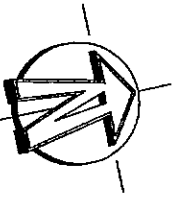

GOODWIN TRACT NO. 2

42

SCALE: 1"=50'

