

- Legend**
- Meter (M)
 - Spray Heads (●)
 - Valves (⊕)
 - Controller (⊠)
 - Rainsensor (⊖)
 - 1" PVC (—)
 - PVB (▲)
 - Drip Area (●)
 - Shut Off Valve (⊞)
- Section # [] Section Size
- GPM
- Design Pressure _____
- Actual Pressure _____

Meeting Hall Pavilion

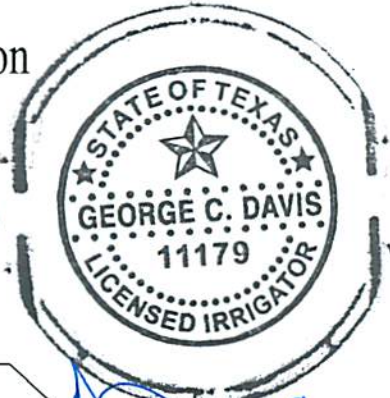

9-18-9

[Signature]

North
Scale: 1"=20'

Irrigation Designer: George Davis
 Drawn by: Jose Oliviera
 Green Thumb
 1304 H East Tansack Avenue
 McAllen, Texas 78501
 Phone: (956) 380-2289
 Fax: (956) 381-8631
 Date: 9/18/2009

Sprinkler System Design For
Meeting Hall Pavilion
 Hidalgo County Texas



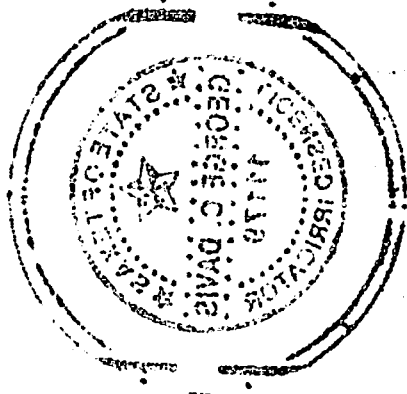

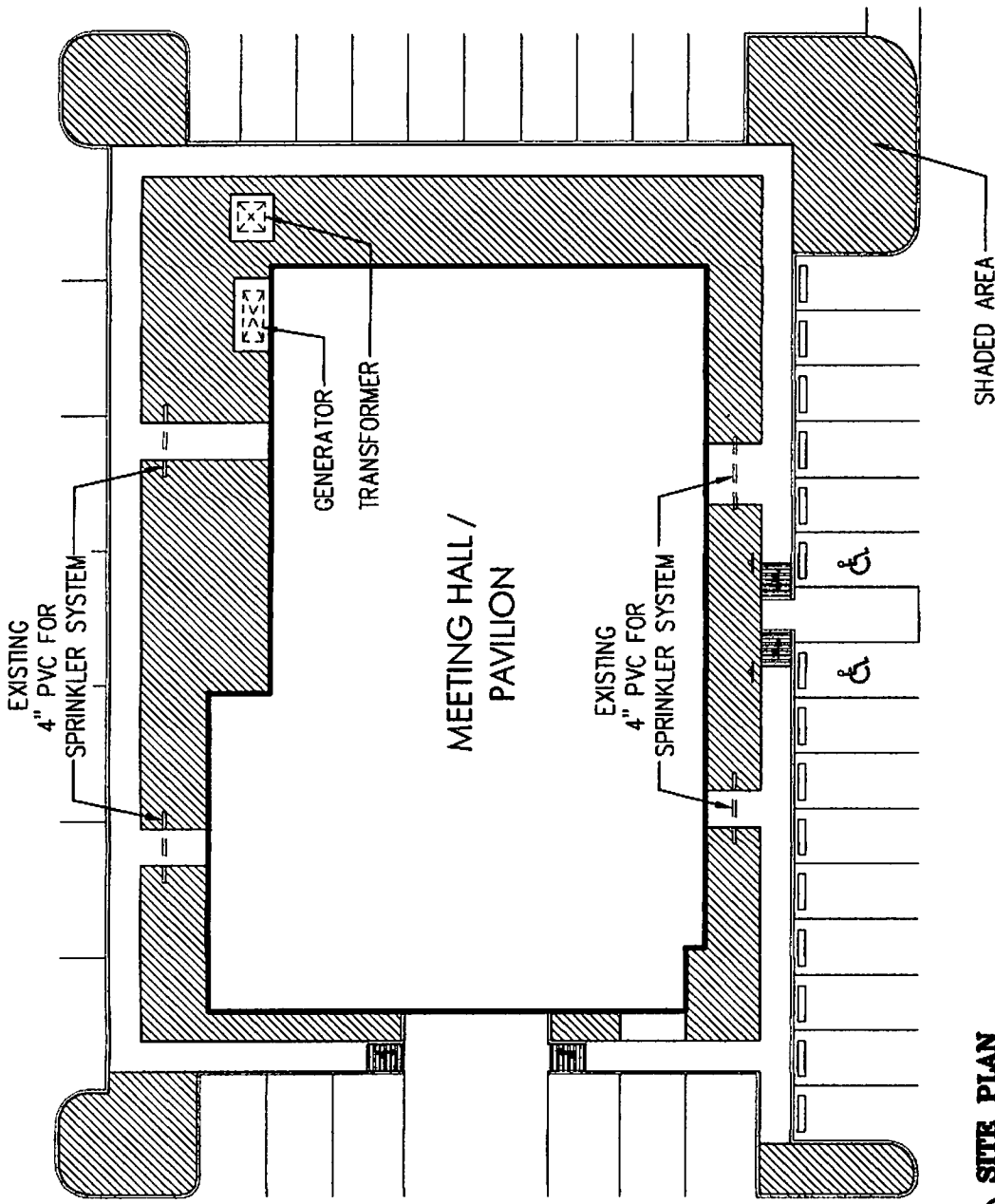

SITE PLAN
SCALE: 1" = 30'-0"

<p>SHADED AREA: 1. INSTALL IRRIGATION SYSTEM 2. ADD TOPSOIL FILL 3. ADD GRASS</p>	<p>S.F. FOR SHADED AREA: 6,400 S.F.</p>
---	---

DATE: 9.16.09

MEETING HALL / PAVILION
HIDALGO COUNTY PRECINCT 3
HIDALGO COUNTY, TEXAS

AGADC
 Alcoy Garcia Associates
 Design Consulting
 1333 E. HEWITT AVE.
 WYLLDEN, TEXAS 75001
 TEL. 936.618.2007 FAX 936.618.2003
 C-1048, AGAHAGADC.COM

1. ALL DIMENSIONS ARE IN FEET AND INCHES.
 2. ALL DIMENSIONS ARE TO FACE UNLESS OTHERWISE NOTED.
 3. ALL DIMENSIONS ARE TO CENTERLINE UNLESS OTHERWISE NOTED.
 4. ALL DIMENSIONS ARE TO CENTERLINE UNLESS OTHERWISE NOTED.
 5. ALL DIMENSIONS ARE TO CENTERLINE UNLESS OTHERWISE NOTED.

6. ALL DIMENSIONS ARE TO CENTERLINE UNLESS OTHERWISE NOTED.
 7. ALL DIMENSIONS ARE TO CENTERLINE UNLESS OTHERWISE NOTED.

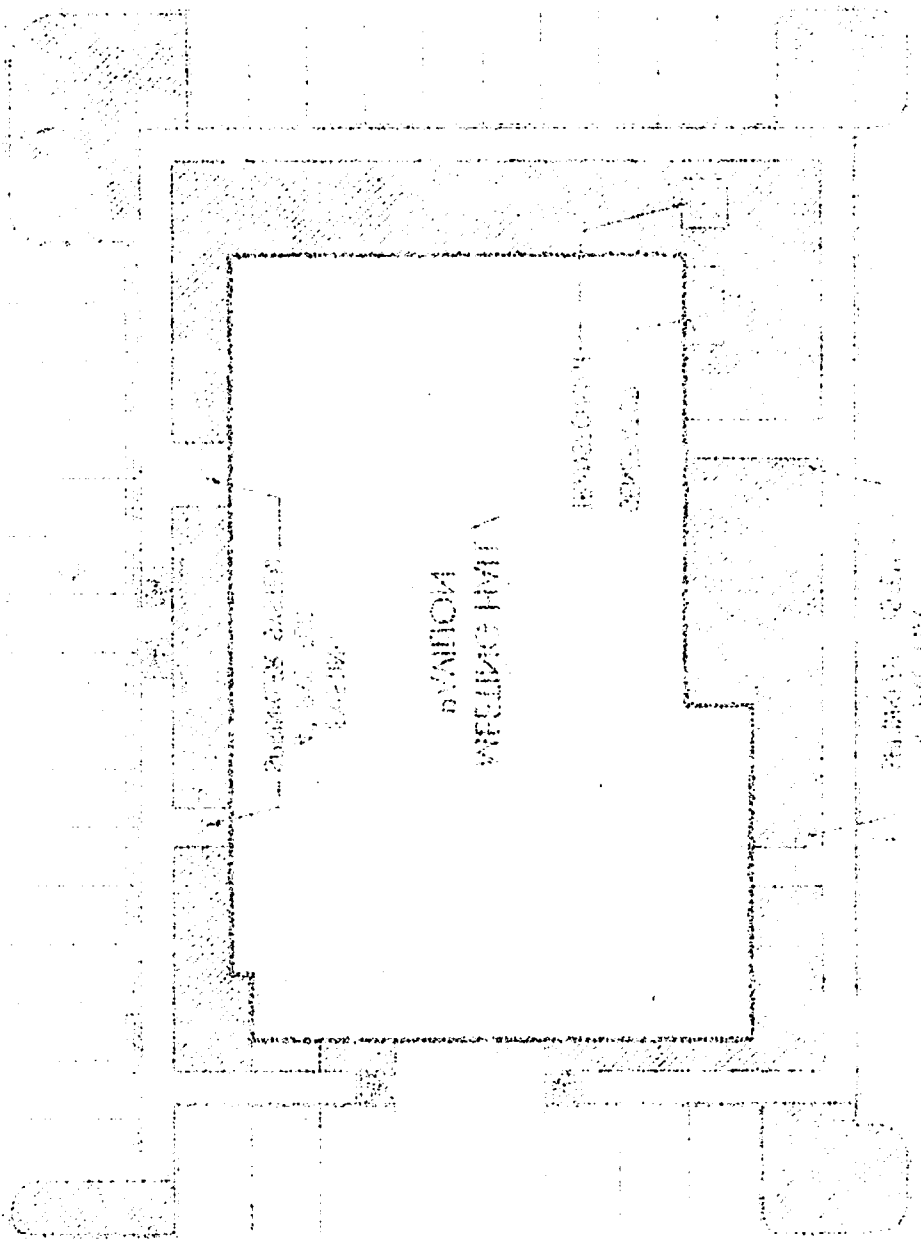

HUNTER COUNTY TEXAS
 HUNTER COUNTY ELECTRIC
 MEETING HALL / BAYLOR

AGATE
 HUNTER COUNTY TEXAS
 HUNTER COUNTY ELECTRIC
 MEETING HALL / BAYLOR

CONSTRUCTION CHANGE DIRECTIVE

PROJECT: Meeting Hall/Pavilion
Precinct 3
Hidalgo County, Texas

DIRECTIVE NUMBER: **FIVE**

DATE: October 13, 2009

TO CONTRACTOR:
G.A.S. Enterprises, Inc.
P.O. Box 309
Elsa, TX 78543

ARCHITECT'S PROJECT NO. ---

CONTRACT FOR: General Construction

You are hereby directed to make the following change in the Contract:

Work Items	Amount
Charge project for testing services, L&G Invoice No. 09-9-000018.....	\$ 592.90
Charge project for testing services, L&G Invoice No. 09-9-000027.....	1,007.05
Provide Landscaping as per attached drawings.....	<u>6,782.00</u>
Total.....	\$ 8,381.95

Testing invoice copies and Contractor's Landscaping Cost Proposal attached

Proposed Adjustments to Construction Contract to Apply to Above Costs

Reduce Testing Allowance by	\$ 181.15	Allowance Balance after this CCD..	0.00
Reduce HVAC Contingency Allowance by	\$ 1,000.00	Allowance Balance after this CCD...\$	0.00
Reduce Electrical Contingency Allowance by.....	\$ 1,000.00	Allowance Balance after this CCD...\$	0.00
Reduce Plumbing Contingency Allowance by	\$ 488.80	Allowance Balance after this CCD...\$	511.12
Reduce Betterment Allowance by	\$ 0.00	Allowance Balance after this CCD...\$	1,000.00
Reduce Landscaping Allowance by	<u>\$ 5,712.00</u>	Allowance Balance after this CCD...\$	0.00
Total reductions.....	\$ 8,381.95		

No change in Construction Contract amount.
Construction Contract Time Extension: 10 days

When signed by the Owner and Architect and received by the Contractor, this document becomes effective IMMEDIATELY as a Construction Change Directive (CCD), and the Contractor shall proceed with the change(s) described above.

Architect:
Alcocer Garcia Associates
1333 East Jasmine
McAllen, Texas 78501

Owner:
County of Hidalgo, Texas
100 E. Cano
Edinburg, TX 78539

General Contractor:
G.A.S. Enterprises, Inc.
P.O. Box 309
Elsa, TX 78543

By: Scott Garcia

By: _____

By: [Signature]

Title: ARCHITECT

Title: _____

Title: PRESIDENT

Date: 10-19-09

Date: _____

Date: 10/20/09





**Construction Material Testing
Geotechnical Engineering**

INVOICE
Invoice Date: 08/02/09
Invoice No: 09-9-000018

Page 1 of 2

2100 W. Expressway 83
Mercedes, TX 78570
Office (956) 565-0760 Fax (956) 565-6746

Client Address: GAS Enterprises
Rene Salinas
P.O. Box 309

Elsa, TX. 78543

Account No.: L258
Project No: L256901
Project Desc.: Meeting Hall Pavilion

Due Date: UPON RECEIPT
Billed to Date: \$7,361.75

===== Invoice Detail by Report =====

<u>Report No.</u>	<u>Sampled</u>	<u>Qty</u>	<u>Billing Code</u>	<u>Unit Type</u>	<u>Unit Rate</u>	<u>Extension</u>
R034-28	07/08/2009	3.00	920:92036 - Grout Compressive Strength	EACH	\$25.00	\$75.00
R034-28	07/08/2009	0.50	940:94050 - Eng. Tech. (Concrete)	Hour	\$46.00	\$23.00
R034-28	07/08/2009	1.00	950:95060 - Administrative / Clerical	10%	\$11.40	\$11.40
R034-28	07/08/2009	1.00	950:95061 - Test Report	Each	\$16.00	\$16.00
Report Number R034-28 for a Subtotal of:						\$125.40
R036-28	07/14/2009	3.00	920:92036 - Grout Compressive Strength	EACH	\$25.00	\$75.00
R036-28	07/14/2009	0.50	940:94050 - Eng. Tech. (Concrete)	Hour	\$46.00	\$23.00
R036-28	07/14/2009	1.00	950:95060 - Administrative / Clerical	10%	\$11.40	\$11.40
R036-28	07/14/2009	1.00	950:95061 - Test Report	Each	\$16.00	\$16.00
Report Number R036-28 for a Subtotal of:						\$125.40
R037-28	07/17/2009	4.00	920:92036 - Grout Compressive Strength	EACH	\$25.00	\$100.00
R037-28	07/17/2009	0.50	940:94050 - Eng. Tech. (Concrete)	Hour	\$46.00	\$23.00
R037-28	07/17/2009	1.00	950:95060 - Administrative / Clerical	10%	\$13.90	\$13.90
R037-28	07/17/2009	1.00	950:95061 - Test Report	Each	\$16.00	\$16.00
Report Number R037-28 for a Subtotal of:						\$162.90
R038	08/21/2009	1.00	920:92033 - Air Content (Pressure Method)	Each	\$18.00	\$18.00
R038	08/21/2009	4.00	920:92035 - Cyl. Specimen Prep./Hold/Cure	Each	\$9.00	\$36.00
R038	08/21/2009	2.00	940:94050 - Eng. Tech. (Concrete)	Hour	\$46.00	\$92.00
R038	08/21/2009	20.00	950:95058 - Vehicle Trip Charge	Mile	\$0.50	\$10.00
R038	08/21/2009	1.00	950:95060 - Administrative / Clerical	10%	\$17.20	\$17.20

REMIT TO: 2100 W. Expressway 83
Mercedes, TX 78570
Office (956) 565-0760 Fax (956) 565-6746

PAST DUE BALANCES SUBJECT TO 1.5% SERVICE CHARGE PER MONTH
PLEASE REFERENCE INVOICE NUMBER WITH PAYMENT



L&G Engineering Laboratory

Construction Material Testing
Geotechnical Engineering

INVOICE

Invoice Date: 09/02/09
Invoice No: 09-9-000018

Page 2 of 2

2100 W. Expressway 83
Mercedes, TX 78570
Office (956) 565-0760 Fax (956) 565-6746

===== Invoice Detail by Report =====

<u>Report No.</u>	<u>Sampled</u>	<u>Qty</u>	<u>Billing Code</u>	<u>Unit Type</u>	<u>Unit Rate</u>	<u>Extension</u>
R038	08/21/2009	1.00	060:95081 - Test Report	Each	\$16.00	\$16.00
<i>Report Number R038 for a Subtotal of:</i>						<u>\$169.20</u>
Total for this Invoice:						\$592.90

REMIT TO: 2100 W. Expressway 83
Mercedes, TX 78570
Office (956) 565-0760 Fax (956) 565-6746

PAST DUE BALANCES SUBJECT TO 1.5% SERVICE CHARGE PER MONTH
PLEASE REFERENCE INVOICE NUMBER WITH PAYMENT

L&G Engineering Laboratory

Construction Material Testing Geotechnical Engineering

INVOICE
Invoice Date: 09/29/2009
Invoice No: 09-9-000027

Page 1 of 2

2100 W. Expressway 83
Mercedes, TX 78570
Office (956) 565-0760 Fax (956) 565-6746

Client Address: GAS Enterprises
Rene Salinas
P.O. Box 309

Elsa, TX. 78543

Account No.: L256
Project No: L256901
Project Desc.: Meeting Hall Pavilion

Due Date: UPON RECEIPT
Billed to Date: \$8,368.80

===== Invoice Detail by Report =====

<u>Report No.</u>	<u>Sampled</u>	<u>Qty</u>	<u>Billing Code</u>	<u>Unit Type</u>	<u>Unit Rate</u>	<u>Extension</u>
R039-28	08/21/2009	4.00	920:92034 - Comp. Strength of Cyl. Specimen	Each	\$12.00	\$48.00
R039-28	08/21/2009	0.50	940:94047 - Eng. Tech. (Concrete / Lab)	Each	\$46.00	\$23.00
R039-28	08/21/2009	1.00	950:95080 - Administrative / Clerical	10%	\$8.70	\$8.70
R039-28	08/21/2009	1.00	950:95061 - Test Report	Each	\$16.00	\$16.00
Report Number R039-28 for a Subtotal of:						\$95.70
R040	08/27/2009	1.00	920:92033 - Air Content (Pressure Method)	Each	\$18.00	\$18.00
R040	08/27/2009	4.00	920:92035 - Cyl. Specimen Prep./Hold/Cure	Each	\$9.00	\$36.00
R040	08/27/2009	3.00	940:94080 - Eng. Tech. (Concrete)	Hour	\$46.00	\$138.00
R040	08/27/2009	40.00	950:95058 - Vehicle Trip Charge	Mile	\$0.50	\$20.00
R040	08/27/2009	1.00	950:95080 - Administrative / Clerical	10%	\$22.80	\$22.80
R040	08/27/2009	1.00	950:95061 - Test Report	Each	\$16.00	\$16.00
Report Number R040 for a Subtotal of:						\$250.80
R041	09/01/2009	1.00	920:92033 - Air Content (Pressure Method)	Each	\$18.00	\$18.00
R041	09/01/2009	4.00	920:92035 - Cyl. Specimen Prep./Hold/Cure	Each	\$9.00	\$36.00
R041	09/01/2009	3.00	940:94080 - Eng. Tech. (Concrete)	Hour	\$46.00	\$138.00
R041	09/01/2009	20.00	950:95058 - Vehicle Trip Charge	Mile	\$0.50	\$10.00
R041	09/01/2009	1.00	950:95060 - Administrative / Clerical	10%	\$21.80	\$21.80

REMIT TO: 2100 W. Expressway 83
Mercedes, TX 78570
Office (956) 565-0760 Fax (956) 565-6746

PAST DUE BALANCES SUBJECT TO 1.5% SERVICE CHARGE PER MONTH
PLEASE REFERENCE INVOICE NUMBER WITH PAYMENT



**Construction Material Testing
Geotechnical Engineering**

INVOICE
Invoice Date: 09/29/2009
Invoice No: 09-9-000027

2100 W. Expressway 83
Mercedes, TX 78570
Office (956) 565-0760 Fax (956) 565-6746

===== Invoice Detail by Report =====

<u>Report No.</u>	<u>Sampled</u>	<u>Qty</u>	<u>Billing Code</u>	<u>Unit Type</u>	<u>Unit Rate</u>	<u>Extension</u>
R041	09/01/2009	1.00	950:95061 - Test Report	Each	\$16.00	\$16.00
Report Number R041 for a Subtotal of:						\$239.80
R042	09/02/2009	1.00	920:92033 - Air Content (Pressure Method)	Each	\$18.00	\$18.00
R042	09/02/2009	4.00	920:92035 - Cyl. Specimen Prep./Hold/Cure	Each	\$9.00	\$36.00
R042	09/02/2009	3.00	940:94050 - Eng. Tech. (Concrete)	Hour	\$46.00	\$138.00
R042	09/02/2009	40.00	950:95058 - Vehicle Trip Charge	Mile	\$0.50	\$20.00
R042	09/02/2009	1.00	950:95060 - Administrative / Clerical	10%	\$22.80	\$22.80
R042	09/02/2009	1.00	950:95061 - Test Report	Each	\$16.00	\$16.00
Report Number R042 for a Subtotal of:						\$250.80
R043	08/27/2009	2.00	920:92034 - Comp. Strength of Cyl. Specimen	Each	\$12.00	\$24.00
R043	08/27/2009	0.25	940:94047 - Eng. Tech. (Concrete / Lab)	Each	\$46.00	\$11.50
R043	08/27/2009	1.00	950:95060 - Administrative / Clerical	10%	\$5.15	\$5.15
R043	08/27/2009	1.00	950:95061 - Test Report	Each	\$16.00	\$16.00
Report Number R043 for a Subtotal of:						\$58.65
R044	09/01/2009	2.00	920:92034 - Comp. Strength of Cyl. Specimen	Each	\$12.00	\$24.00
R044	09/01/2009	0.25	940:94047 - Eng. Tech. (Concrete / Lab)	Each	\$46.00	\$11.50
R044	09/01/2009	1.00	950:95060 - Administrative / Clerical	10%	\$5.15	\$5.15
R044	09/01/2009	1.00	950:95061 - Test Report	Each	\$16.00	\$16.00
Report Number R044 for a Subtotal of:						\$58.65
R045	09/02/2009	2.00	920:92034 - Comp. Strength of Cyl. Specimen	Each	\$12.00	\$24.00
R045	09/02/2009	0.25	940:94047 - Eng. Tech. (Concrete / Lab)	Each	\$46.00	\$11.50
R045	09/02/2009	1.00	950:95060 - Administrative / Clerical	10%	\$5.15	\$5.15
R045	09/02/2009	1.00	950:95061 - Test Report	Each	\$16.00	\$16.00
Report Number R045 for a Subtotal of:						\$58.65
Total for this Invoice:						\$1,007.03

REMIT TO: 2100 W. Expressway 83
Mercedes, TX 78570
Office (956) 565-0760 Fax (956) 565-6746

**PAST DUE BALANCES SUBJECT TO 1.5% SERVICE CHARGE PER MONTH
PLEASE REFERENCE INVOICE NUMBER WITH PAYMENT**

G.A.S. ENTERPRISES, INC.
P.O. BOX 309, ELSA, TEXAS 78543
(956)262-7106 FAX (956)262-7107

FACSIMILE TRANSMITTAL SHEET

TO:	George	FROM:	Mari
COMPANY:	AGAPC	DATE:	10/13/09
FAX NUMBER:		TOTAL NO. OF PAGES INCLUDING COVER:	5
PHONE NUMBER:		SENDER'S REFERENCE NUMBER:	
RE:		YOUR REFERENCE NUMBER:	

- URGENT FOR REVIEW PLEASE COMMENT PLEASE REPLY PLEASE RECYCLE

NOTES/COMMENTS:

There is also still testing that has not been done on the parking lot.

Remember we discussed that this would be approximately \$1,000.00

CONTACT G.A.S. ENTERPRISES, INC. AT (956)262-7106 IF NOTED PAGES ARE NOT RECEIVED. THANK YOU

PROPOSAL/CONTRACT

G.A.S. ENTERPRISES, INC.
GENERAL CONTRACTOR

P.O. BOX 309
Elsa, Texas 78543
Phone (956) 262-7106
Fax (956) 262-7107

PROPOSAL SUBMITTED TO: AGA, Inc. DATE: 9/22/09
Attn: George Garcia
STREET: 1333 E. Jasmine JOB NAME: Precinct 3
Meeting Hall/Pavilion
CITY, STATE AND ZIP: McAllen, Texas 78504 JOB LOCATION: Palmview

We hereby submit specifications and estimates for:

All material and labor for the installation of a (9) zone sprinkler system to include the following:

- (1) Hunter SRC 9 station indoor controller
- (9) Hunter SRV 1" electric valves
- (1) 1" Febco 765 1" Backflow and test
- (131) 4" Hunter pop up spray heads
- (16) gauge wiring
- 9'6" Valve boxes
- Polypipe for spray heads
- (1) Hunter Rainsensor
- 1 Year Warranty

Also included is all material and labor the installation of 6400 sq ft of St. Augustine Floratam sod and 75 cy of 3" layer of topsoil

We Propose hereby to furnish material and labor – complete in accordance with above specifications, for the sum of:

Six Thousand Seven Hundred Eighty Two and No/100----dollars (\$ 6,782.00)

Payment to be made as follows:

Upon Completion

Authorized
Signature _____

Note: This proposal may be withdrawn by us if not accepted within 30 days.

Acceptance of Proposal – The above prices, specifications and conditions are satisfactory and are hereby accepted. You are authorized to do the work as specified. Payment will be made as outlined above.

Signature _____ Date _____