

INDEX OF DRAWINGS

SHEET NO. _____	TITLE
CS	COVER SHEET
AS1.1	SITE PLANS - EDINBURG NO. 4 AND EDINBURG NO. 5
AS1.2	SITE PLAN - SAN JUAN NO. 2
STRUCTURAL	
S11	GENERAL NOTES
S21	ROOF AND FLOOR FRAMING PLANS
S31	ROOF AND FLOOR FRAMING DETAILS
ARCHITECTURAL	
A11	FLOOR PLAN, EXTERIOR ELEVATIONS, BUILDING & WALL SECTIONS, INTERIOR ELEVATIONS
A12	ROOM FINISH SCHEDULE, DOOR SCHEDULE, DOOR & WINDOW ELEVATIONS, INTERIOR ELEVATIONS, MILLWORK SECTIONS
MEP	
M10	FLOOR PLAN - MECHANICAL
M20	MECHANICAL SCHEDULES & WALL UNIT DETAIL
ES1.1	ELECTRICAL SITE PLAN EDINBURG NO. 4
ES1.2	ELECTRICAL SITE PLAN EDINBURG NO. 5
ES2	ELECTRICAL SITE PLAN SAN JUAN NO. 2
E10	FLOOR PLAN - LIGHTING & LIGHTING SCHEDULE
E20	FLOOR PLAN - ELECTRICAL & GENERAL NOTES
E30	ELECTRICAL LEGEND
E40	ELECTRICAL DETAILS
E50	ELECTRICAL SCHEMATIC DIAGRAMS & DISCONNECT SCHEDULE
PS1.1	PLUMBING SITE PLAN EDINBURG NO. 4
PS1.2	PLUMBING SITE PLAN EDINBURG NO. 5
PS2	PLUMBING SITE PLAN SAN JUAN NO. 2
P10	PLUMBING SYMBOL LEGEND & GENERAL NOTES
P20	PLUMBING FIXTURE SCHEDULE, PLUMBING SYMBOL LEGEND & GENERAL NOTES
P30	PLUMBING DETAILS

VICINITY MAP EDINBURG/SAN JUAN, TEXAS

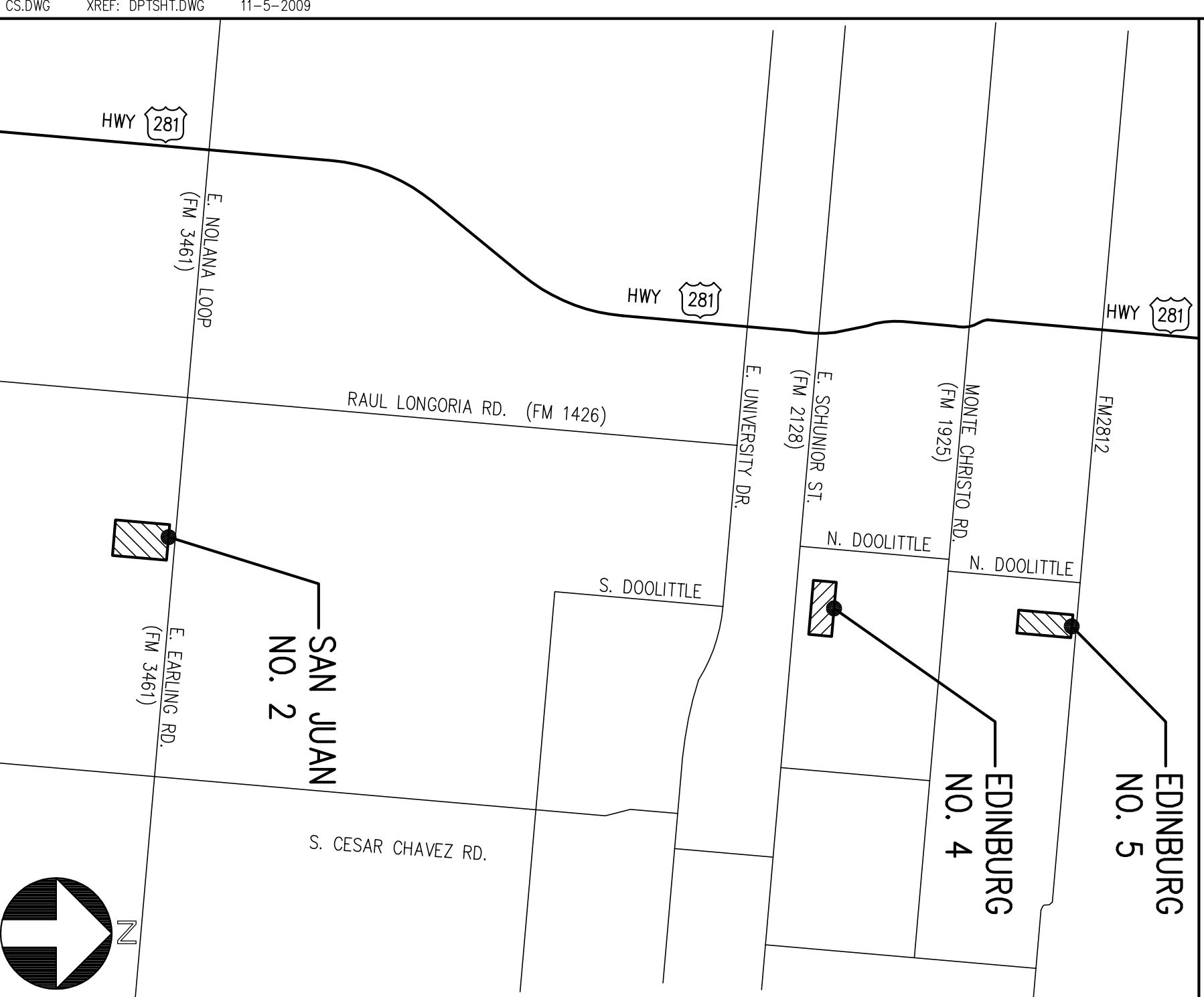

HIDALGO COUNTY HEADSTART PROGRAM THREE PORTABLE CLASSROOM ADDITION

FOR

HIDALGO COUNTY HEADSTART PROGRAM

POLICY COUNCIL MEMBERS

2008-2009

ERIC RODRIGUEZ	CHAIRPERSON
ZAHYDEE HERNANDEZ	VICE-CHAIRPERSON
DORA RODRIGUEZ	SECRETARY
GERARDO "JERRY" CHAPA	TREASURER
JOHANNA AGUILAR	PARLIAMENTARIAN

BRENDA REYNA	PARENT REPRESENTATIVE
LAURA AGUILAR	PARENT REPRESENTATIVE
FILOMENA LEO	COMMUNITY REPRESENTATIVE
ROEL PENNA	COMMUNITY REPRESENTATIVE
LUIS SOLIS	COMMUNITY REPRESENTATIVE
JANIE SOLIS	COMMUNITY REPRESENTATIVE

rike • ogden • figueroa • allex • architects inc. McAllen, texas

CHANIN ENGINEERING, LLC
TRINITY MEP ENGINEERING, PLLC

STRUCTURAL CONSULTING ENGINEERS
MEP CONSULTING ENGINEERS

rofo
architects

rike • ogden • figueroa • allex
107 West Ave
McAllen, TX 78501
409.646.7771
f.409.687.3433
www.roc.com

McAllen Hidalgo

Copyright © 2007

NOTES:

HIDALGO COUNTY HEADSTART PROGRAM
THREE PORTABLE CLASSROOM ADDITION

HIDALGO COUNTY

TEXAS

PROJECT NO. 29009
DRAWN BY C.A.
DATE

CS