

Client: HIDALGO COUNTY PRECINCT NO. 2  
 Project: TOWER ROAD DRAINAGE Items  
 By: Ramiro Gutierrez  
 Date: 02/17/10

| ITEM NO.        | DESCRIPTION  | UNIT | QTY | UNIT COST  | TOTAL COST         |
|-----------------|--|------|-----|------------|--------------------|
| <b>BASE BID</b> |  |      |     |            |                    |
| * 400           | Cement Stabilized Backfill                             | CY   | 0   | \$20.00    | \$0.00             |
| * 400           | Cut & Restore Pavement                                 | SY   | 9   | \$36.10    | \$332.12           |
| * 402           | Trench Excavation Protection                           | LF   | 342 | \$1.25     | \$427.50           |
| 464             | Reinforced Concrete Pipe (CI III) (18) (Rubber Gasket) | LF   | 382 | \$29.50    | \$11,269.00        |
| 464             | Reinforced Concrete Pipe (CI III) (24) (Rubber Gasket) | LF   | 0   | \$33.90    | \$0.00             |
| 464             | Reinforced Concrete Pipe (CI III) (30) (Rubber Gasket) | LF   | 0   | \$54.50    | \$0.00             |
| 464             | Reinforced Concrete Pipe (CI III) (36) (Rubber Gasket) | LF   | 0   | \$65.50    | \$0.00             |
| 464             | Reinforced Concrete Pipe (CI III) (42) (Rubber Gasket) | LF   | 0   | \$90.10    | \$0.00             |
| 465             | Inlet (Complete) (Ty C)                                | EA   | 1   | \$3,100.00 | \$3,100.00         |
| 465             | Manhole (Complete) (Ty A)                              | EA   | 0   | \$2,200.50 | \$0.00             |
| * 467           | Safety End Treatment (18") (4:1)                       | EA   | 0   | \$600.00   | \$0.00             |
| * 467           | Safety End Treatment (18") (3:1)                       | EA   | 0   | \$700.00   | \$0.00             |
| * 506           | Construction Exits (Ty II) (Install)                   | SY   | 0   | \$15.50    | \$0.00             |
| * 506           | Construction Exits (Ty II) (Removal)                   | SY   | 0   | \$5.50     | \$0.00             |
| * 506           | Temp Sediment Control Fence                            | LF   | 46  | \$2.25     | \$103.50           |
| 4035            | RC Low Head Pressure Pipe (CL III) (18 IN)             | LF   | 0   | \$22.35    | \$0.00             |
| 4035            | RC Low Head Pressure Pipe (CL III) (24 IN)             | LF   | 0   | \$32.50    | \$0.00             |
| 4035            | Stand Pipe (24 IN)                                     | EA   | 0   | \$4,000.00 | \$0.00             |
|                 |  |      |     |            |                    |
|                 |  |      |     |            |                    |
|                 | <b>TOTAL BASE BID</b>                                  |      |     |            | <b>\$15,232.12</b> |

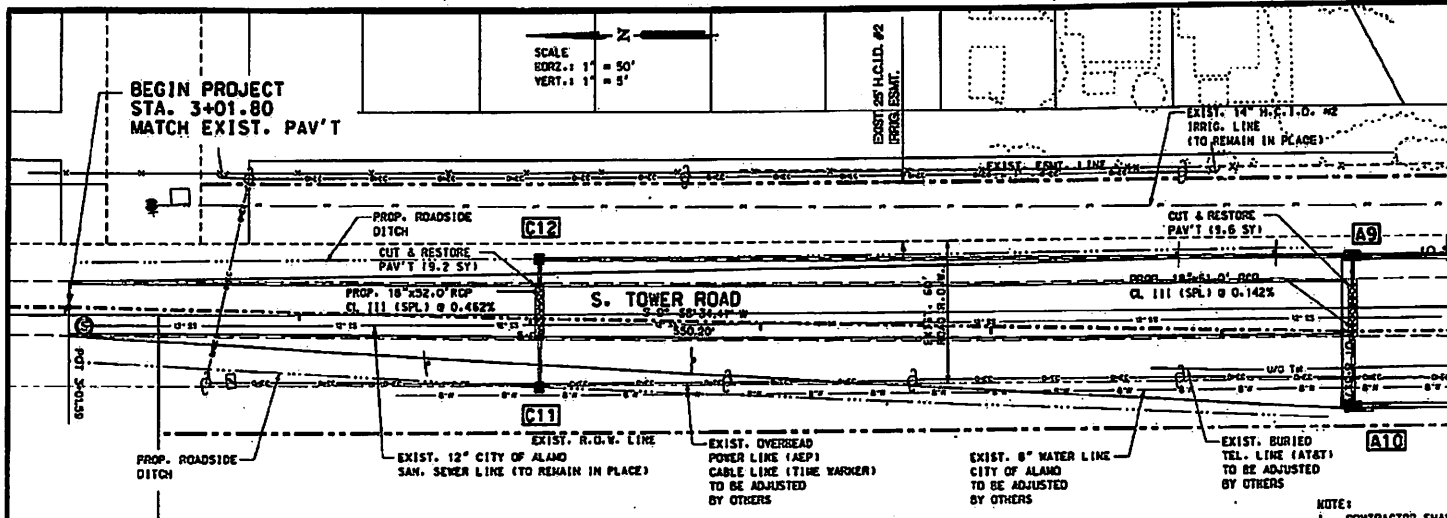

- LEGEND**
- PROP. ASPHALT DRIVEWAY
  - PROP. CONCRETE DRIVEWAY
  - TRAFFIC DIRECTION
  - PROP. TURNOUTS
  - OPEN CUT
  - SANITARY SEWER MANHOLE
  - EXIST. MANHOLES
  - TEL. MARKER
  - FIRE HYDRANT
  - POWER POLE
  - POWER POLE W/ LIGHT
  - EXIST. MANHOLE BOX
  - WATER VALVE
  - TREE WASH
  - MONITOR WELL
  - STRUCTURE TO BE RELOCATED BY CONTRACTOR
  - EXIST. POWER POLES TO BE ADJUSTED BY OTHERS
  - BOX
  - FLOW DIRECTION
  - SAN. SEWER LINE
  - WATER LINE
  - ELEC. LINE
  - OVERHEAD ELEC./TEL./CABLE
  - OVERHEAD ELEC./CABLE
  - OVERHEAD POWER LINE
  - GAS LINE
  - STORM DRAIN LINE

**NOTE:**  
 1. CONTRACTOR SHALL VERIFY ALL UTILITIES, HORIZONTAL AND VERTICAL INFORMATION IN THE FIELD, PRIOR TO CONSTRUCTION.  
 2. CONTRACTOR TO COORDINATE WITH CITY OF ALAMO/A.N.W.S.C. PRIOR TO CONSTRUCTION.

| STR. I.D. | DESCRIPTION        | STA./OFFSET            | TOP OF STR. ELEV. | PROP. FL. OF STR. | PROP. FL. OF PIPE (NORTH) | PROP. FL. OF PIPE (SOUTH) | PROP. FL. OF PIPE (EAST) | PROP. FL. OF PIPE (WEST) |
|-----------|--------------------|------------------------|-------------------|-------------------|---------------------------|---------------------------|--------------------------|--------------------------|
| A9        | TY 7" INLET        | STA. 8+56.00, 32.0' LT | 96.72             | 91.47             | 91.47                     | 91.47                     | -                        | 91.29                    |
| A10       | TY 7" INLET        | STA. 8+56.00, 32.0' RT | 96.72             | 92.07             | -                         | -                         | 92.07                    | -                        |
| C11       | TY "C" GRATE INLET | STA. 5+04.00, 29.0' RT | 95.56             | 92.25             | -                         | -                         | 92.25                    | -                        |
| C12       | TY "C" GRATE INLET | STA. 5+04.00, 25.0' LT | 95.56             | 92.00             | -                         | 92.00                     | -                        | 92.00                    |

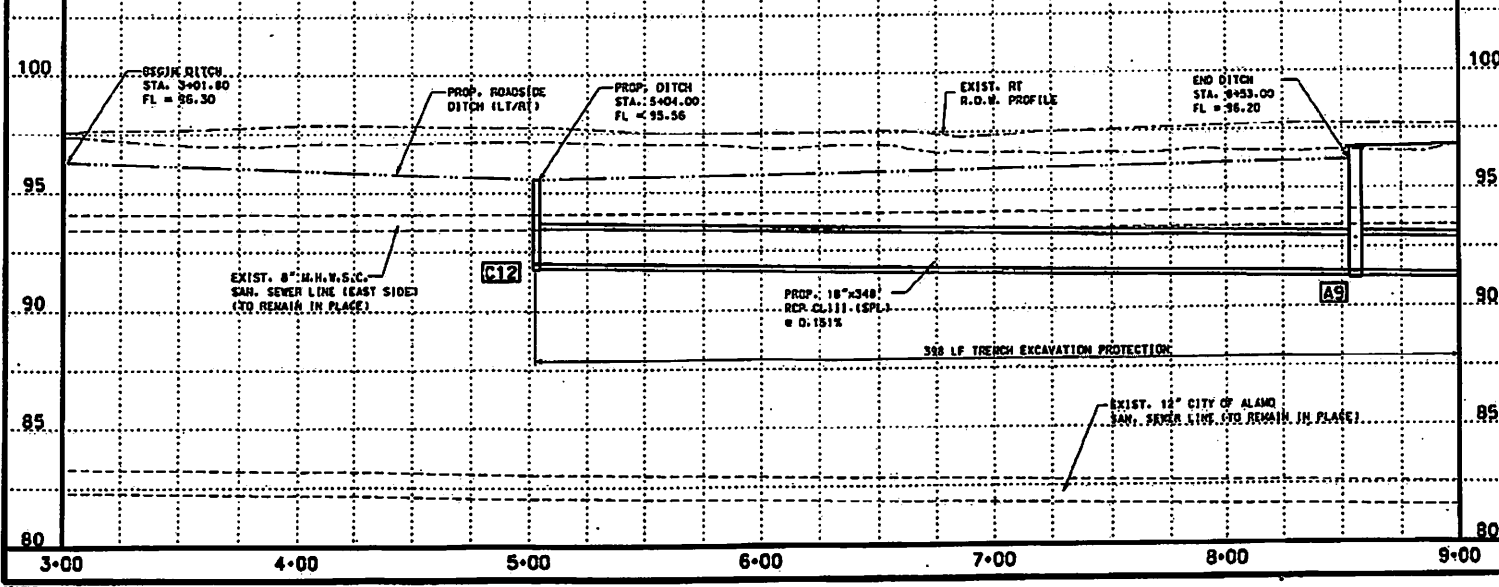

**P.E.**

THE SEAL APPLIED TO THIS DOCUMENT IS VALID ONLY IF IT IS USED IN ACCORDANCE WITH THE RULES AND REGULATIONS OF THE BOARD OF PROFESSIONAL ENGINEERS AND SURVEYORS OF THE STATE OF TEXAS.  
 DATE: 7-17-06  
 AUTHORITY: A POWER OF ATTORNEY HAS BEEN FILED WITH THE BOARD OF PROFESSIONAL ENGINEERS AND SURVEYORS OF THE STATE OF TEXAS.

SHEET 1 OF 15

**HIDALGO COUNTY PRECINCT No.2  
TOWER ROAD  
UTILITY AND DRAINAGE**

| REVISIONS | DATE | BY |
|-----------|------|----|
|           |      |    |

**R. Gutierrez Engineering Corporation** Professional Engineers & Land Surveyors  
 100 E. BARRIE BLVD. • PEARLAND, TEXAS 77657  
 (281) 281-2222 • FAX (281) 281-2228

| PROJECT NUMBER | COUNTY | HIGHWAY NO. |
|----------------|--------|-------------|
|                |        |             |

| DRAWN BY: | CHECKED BY: | SHEET NO. |
|-----------|-------------|-----------|
|           |             | 112       |