

**METES AND BOUNDS DESCRIPTION
OF
(TRACT TWO)
A 15.00 FOOT DRAINAGE EASEMENT,
BEING A 0.39 OF AN ACRE OF LAND OUT
OF LOT 12, BLOCK 31,
ALAMO LAND AND SUGAR COMPANY SUBDIVISION,
HIDALGO COUNTY, TEXAS,
AS PER MAP RECORDED IN
VOLUME 1, PAGES 24-26 M.R.H.C.**

Being a 0.39 of an acre of land out of Lot 12, Block 31, Alamo Land and Sugar Company Subdivision, Hidalgo County, Texas, as per map recorded in Volume 1, Pages 24-26, Map Records of Hidalgo County, Texas. Said 0.39 of an acre of land being more particularly described by metes and bounds as follows;

Commencing at a cotton picker spindle found at the Northwest corner of Lot 12, Block 31, Alamo Land and Sugar Company Subdivision; **Thence**, South 81 degrees 15 minutes 00 seconds East, with the North line of said Lot 12, Block 31, a distance of 150.00 feet to a cotton picker spindle found at the Southwest corner of VIP East II Subdivision (recorded in Volume 58, Page 72, Map Records of Hidalgo County, Texas); **Thence**, South 08 degrees 45 minutes 00 seconds West, a distance of 20.00 feet pass a No. 4 rebar set at the South Right of Way line of Ridge Road and at a total distance of 35.00 to a No. 4 rebar set (with a plastic cap stamped RGEC) for the Northwest corner and the **POINT OF BEGINNING** of this tract of land;

THENCE, South 81 degrees 15 minutes 00 seconds East, parallel to the North line of said Lot 12, Block 31, a distance of 1140.00 feet to a No. 4 rebar set (with a plastic cap stamped RGEC) at the West Right of Way line of Cesar Chavez Road, for the Northeast corner of this tract of land;

THENCE, South 08 degrees 45 minutes 00 seconds West, with the West Right of Way line of said Cesar Chavez Road, a distance of 15.00 feet to a No. 4 rebar set (with a plastic cap stamped RGEC) for the Southeast corner of this tract of land;

THENCE, North 81 degrees 15 minutes 00 seconds West, parallel to the North line of said Lot 12, Block 31, a distance of 1140.00 feet to a No. 4 rebar set (with a plastic cap stamped RGEC) at the East line of Hidalgo County Drainage District No. One drainage ditch Right of Way (as recorded in Warranty Deed Doc. No. 884095, Official Records of Hidalgo County, Texas), for the Southwest corner of this tract of land;

THENCE, North 08 degrees 45 minutes 00 seconds West, with the East line of said Hidalgo County Drainage District No. One drainage ditch Right of Way, a distance of 15.00 feet to the **POINT OF BEGINNING** and containing 0.39 of an acre of land more or less.

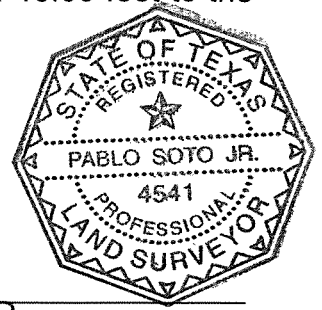

Pablo Soto, Jr. - R.P.L.S. No. 4515
Date: 10/27/10

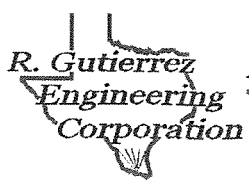

**METES AND BOUNDS DESCRIPTION
OF
(TRACT ONE)
A 15.00 FOOT TEMPORARY WORKING EASEMENT,
BEING A 0.39 OF AN ACRE OF LAND OUT
OF LOT 12, BLOCK 31,
ALAMO LAND AND SUGAR COMPANY SUBDIVISION,
HIDALGO COUNTY, TEXAS,
AS PER MAP RECORDED IN
VOLUME 1, PAGES 24-26 M.R.H.C.**

Being a 0.39 of an acre of land out of Lot 12, Block 31, Alamo Land and Sugar Company Subdivision, Hidalgo County, Texas, as per map recorded in Volume 1, Pages 24-26, Map Records of Hidalgo County, Texas. Said 0.39 of an acre of land being more particularly described by metes and bounds as follows;

Commencing at a cotton picker spindle found at the Northwest corner of Lot 12, Block 31, Alamo Land and Sugar Company Subdivision; **Thence**, South 81 degrees 15 minutes 00 seconds East, with the North line of said Lot 12, Block 31, a distance of 150.00 feet to a cotton picker spindle found at the Southwest corner of VIP East II Subdivision (recorded in Volume 58, Page 72, Map Records of Hidalgo County, Texas); **Thence**, South 08 degrees 45 minutes 00 seconds West, a distance of 20.00 feet to a No. 4 rebar set (with a plastic cap stamped RGEN) at the South Right of Way line of Ridge Road for the Northwest corner and the **POINT OF BEGINNING** of this tract of land;

THENCE, South 81 degrees 15 minutes 00 seconds East, with the South Right of Way line of said Ridge Road, a distance of 1140.00 feet to a No. 4 rebar set (with a plastic cap stamped RGEN) at the West Right of Way line of Cesar Chavez Road, for the Northeast corner of this tract of land;

THENCE, South 08 degrees 45 minutes 00 seconds West, with the West Right of Way line of said Cesar Chavez Road, a distance of 15.00 feet to a No. 4 rebar set (with a plastic cap stamped RGEN) for the Southeast corner of this tract of land;

THENCE, North 81 degrees 15 minutes 00 seconds West, parallel to the North line of said Lot 12, Block 31, a distance of 1140.00 feet to a No. 4 rebar set (with a plastic cap stamped RGEN) at the East line of Hidalgo County Drainage District No. One drainage ditch Right of Way (as recorded in Warranty Deed Doc. No. 884095, Official Records of Hidalgo County, Texas), for the Southwest corner of this tract of land;

THENCE, North 08 degrees 45 minutes 00 seconds West, with the East line of said Hidalgo County Drainage District No. One drainage ditch Right of Way, a distance of 15.00 feet to the **POINT OF BEGINNING** and containing 0.39 of an acre of land more or less.

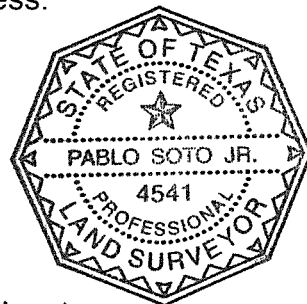

A handwritten signature in black ink, appearing to read "Pablo Soto, Jr.", written over a horizontal line.

Pablo Soto, Jr. – R.P.L.S. No. 4515

Date: 10/27/10