

LEGEND

- DOWN GUY
- ⊙ SANITARY SEWER MANHOLE
- ⊙ EXIST. STANDPIPES
- ⊙ TEL MARKER
- ⊙ FIRE HYDRANT
- ⊙ POWER POLE
- ⊙ POWER POLE W/LIGHT
- ⊙ WATER VALVE
- ⊙ MONITOR WELL
- ⊕ STRUCTURE TO BE RELOCATED BY CONTRACTOR
- ⊕ EXIST. POWER POLES TO BE ADJUSTED BY OTHERS
- SS SAN. SEWER LINE
- W WATER LINE
- OHEC OVERHEAD ELEC./CABLE
- U/G TEL UNDERGROUND TEL.
- GAS GAS LINE
- FM FORCE MAIN

SCALE
HORIZ. : 1"=50'
VERT. : 1"=5'

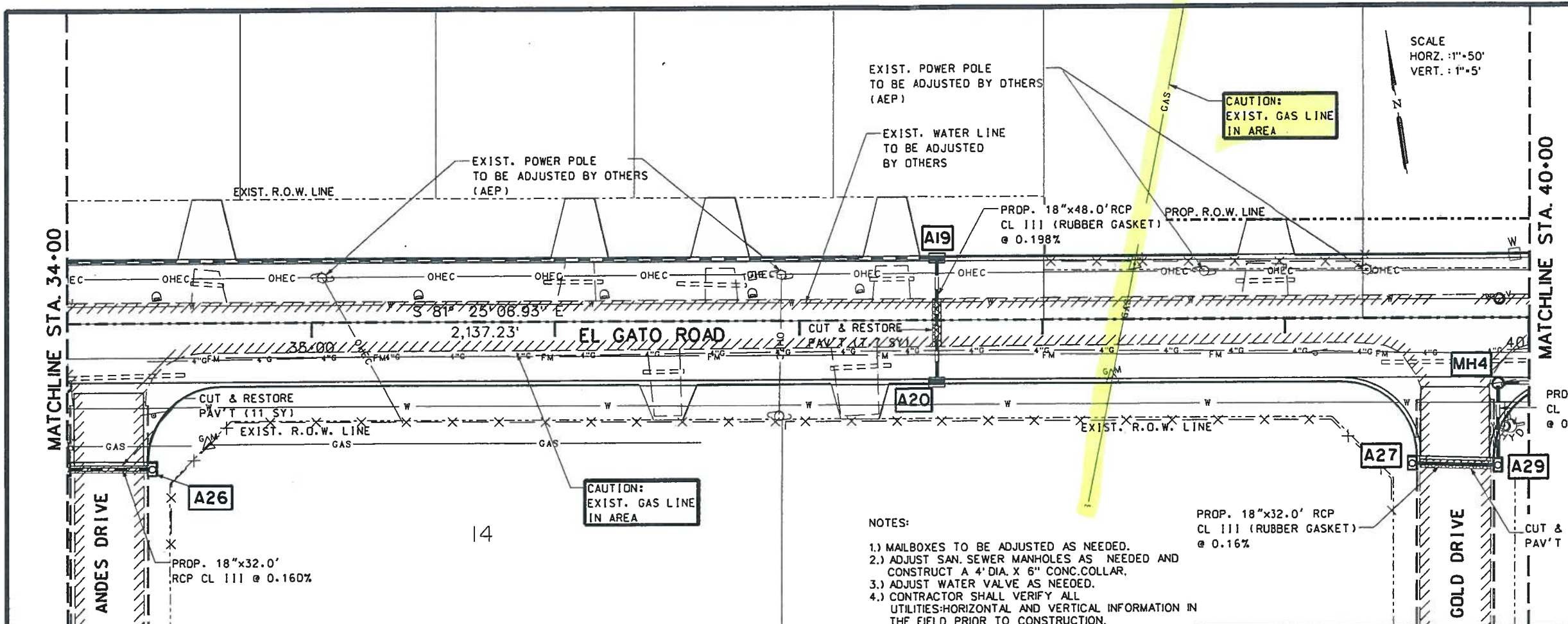

NOTES:

- 1.) MAILBOXES TO BE ADJUSTED AS NEEDED.
- 2.) ADJUST SAN. SEWER MANHOLES AS NEEDED AND CONSTRUCT A 4" DIA. X 6" CONC. COLLAR.
- 3.) ADJUST WATER VALVE AS NEEDED.
- 4.) CONTRACTOR SHALL VERIFY ALL UTILITIES-HORIZONTAL AND VERTICAL INFORMATION IN THE FIELD PRIOR TO CONSTRUCTION.

STR. I.D.	DESCRIPTION	STA./OFFSET	TOP OF STR. ELEV.	PROP. FL. OF STR.	PROP. FL. OF PIPE (NORTH)	PROP. FL. OF PIPE (SOUTH)	PROP. FL. OF PIPE (EAST)	PROP. FL. OF PIPE (WEST)
105	A19 TY "F" INLET W/1 EXT.	STA. 37+57.00, 25.50' LT.	95.46	90.50	-	91.00	-	90.50
	A20 TY "F" INLET W/1 EXT.	STA. 37+57.00, 25.50' RT.	95.46	91.10	91.10	-	-	-
	A27 TY "A" INLET W/1 EXT.	STA. 39+52.20, 59.0' RT.	94.34	90.14	-	-	90.14	-
	A29 TY "A" INLET W/1 EXT.	STA. 39+87.40, 59.84' RT.	94.36	89.65	89.65	-	-	89.65
	A26 TY "A" INLET W/1 EXT.	STA. 34+32.70, 59.00' RT.	94.59	89.61	-	-	-	89.61
	MH4 PROP. TY "A" MANHOLE	STA. 39+87.40, 26.50' RT.	94.51	89.61	-	-	-	-

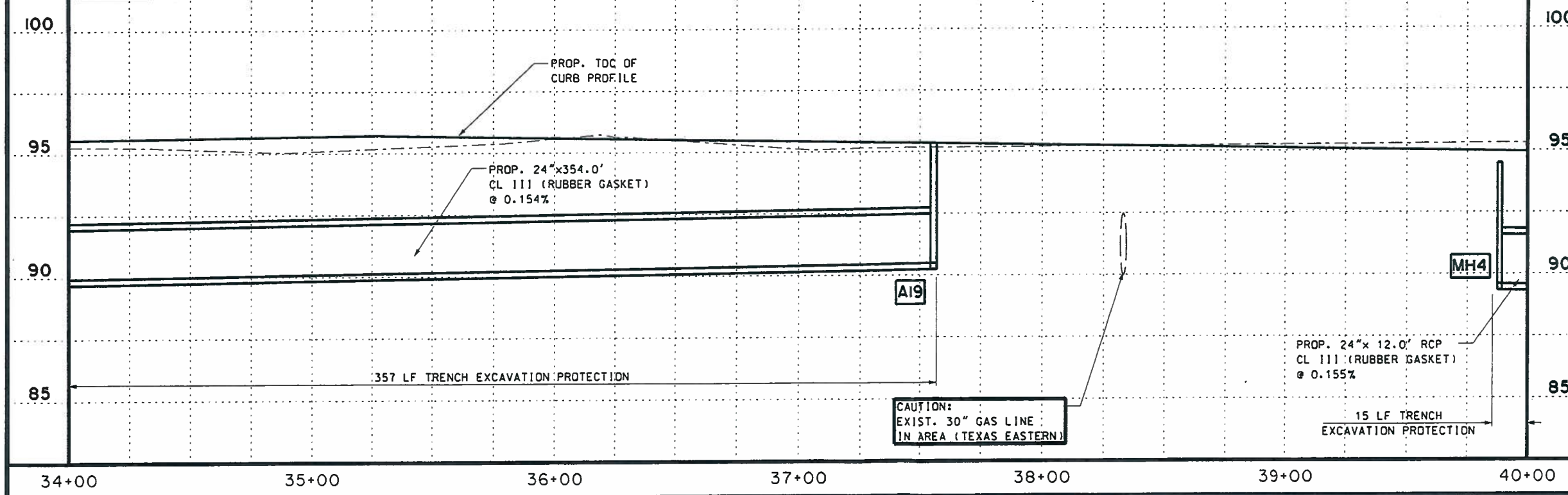

THE SEAL APPEARING ON THIS DOCUMENT WAS AUTHORIZED BY RAMIRO GUTIERREZ, P.E. 65948
DATE: 9-23-10
ALTERATION OF A SEALED DOCUMENT WITHOUT PROPER NOTIFICATION TO THE RESPONSIBLE ENGINEER IS AN OFFENSE UNDER THE TEXAS ENGINEERING PRACTICE LAW.

SHEET 6 OF 7

**EL GATO ROAD
UTILITY & DRAINAGE**

REVISIONS	DATE:	BY:
FIRM No. 486		
PROJECT NUMBER	COUNTY	HIGHWAY NO.
DRAWN BY:	CHECKED BY:	SHEET No.
DESIGNED BY:	CHECKED BY:	55