

Hidalgo County  
Border Colonia Access Program



Jardin Terrace Subdivision  
Paving and Drainage Improvements Estimate



# ATTACHMENT "A"

## Description of Work Proposed

ATTACHMENT A  
Application for Border Colonia Access Program  
Description of Work Proposed

The Jardin Terrace Subdivision (EDAP #M1080348) project consists of approximately 1500 l.f. of repaving with a proposed typical road section of 8 inches of caliche base and 1.5 inches of asphalt or as determined through geotechnical soil tests. Project also includes associated drainage with road side ditches and all necessary appurtenances.

Colonia Jardin Terrace Subdivision consists of 1 interior road(s) and approximately 1500 l.f. inadequately paved road that contributes in inadequate drainage and limited access to the Colonia Residents. Please refer to the photograph on **Attachment C** that further illustrate the need and conditions of the Colonia Road

The proposed project involves paving of Mahala Drive. The proposed project provides the Colonias Residents necessary access to Glasscock Road a paved County Road. Please Refer to **Attachment D and E** that illustrates the Colonias location and access.

The Proposed Project is in a proposed school bus route or maybe considered for a future bus route. Please Refer to **Attachment F**.

# ATTACHMENT "B"

## Quantity Estimates

**Attachment "B"**

**Colonia Name** Jardin Terrace Subdivision  
**Street(s) Name** Mahala Drive  
**EDAP Number** M1080348

Length of proposed roadway 1500 FT Existing 50-ft ROW

Proposed Roadway Travel lane 10 min and one 1 curb off set min 24 FT B-B      2-12' proposed lane

# of Parcels to be acquired 0

Estiamted Cost of Land to be acquired \$ -

**Estimated Quantities Roadway**

Preparing ROW	15	STA	\$ 1,000.00		\$ 15,000.00
8" Flex Base (Compl in place) (TY E GR 4)	5032	SY	\$ 7.25		\$ 36,482.00
Reworking Base Material (DC)(TY D CL6)	5032	SY	\$ 2.00		\$ 10,064.00
ASPH Material (MC-30)	1006	GAL	\$ 5.00		\$ 5,030.00
ASPH Conc (TY D)(1 1/2")	4345	SY	\$ 8.75		\$ 38,018.75
Barricades, Sign and Traffice Handling	2	MO	\$ 1,000.00		\$ 2,000.00
Turnouts (ASPH-CONC-PAV)(PB-2)	40	SY	\$ 15.00		\$ 600.00
Relocate Mail Boxes	0	LS	\$ 5,000.00		\$ 5,000.00
					\$ -

**Estimated Quantities Drainage**

Driveway (ASPH-CONC-PAV)(PB-1)	23	EA	\$ 500.00		\$ 11,500.00
Driveway (Concrete 3000 PSI)	20	EA	\$ 1,000.00		\$ 20,000.00
15" ADS Culvert Pipe	860	LF	\$ 20.00		\$ 17,200.00
18" RCP Culvert Pipe	70	LF	\$ 50.00		\$ 3,500.00
Safety End Treatment	2	EA	\$ 800.00		\$ 1,600.00
Temporary Sediment Control Fence	360	LF	\$ 5.00		\$ 1,800.00
		SY			\$ -

**Professional Costs (% costs may vary from county to county)**

Basic Engineering Services (8.5% of Total Estimated Construction Cost)	\$ 14,262.55
Special Services Design Surveys (2.5% of Total Estimated Construction Cost)	\$ 4,194.87
Categorical Exclusion (Enviromental Document)	
Material Testing Services (3.5% of Total Estimated Construction Cost)	\$ 5,872.82
<b>Sub-Total</b>	<b>\$ 24,330.24</b>
<b>Total Estimated Construction Cost</b>	
Roadway Construction Cost	\$ 112,194.75
Drainage Estimated Quantities	\$ 55,600.00
<b>Sub-Total</b>	<b>\$ 167,794.75</b>

**ROW Costs (Land Acquisitions)\*\***

Estimated cost of Land	
ROW Mapping (\$2.00/parcel)	
<b>Sub-Total</b>	<b>\$ -</b>

\*\*Attorney, appraisal, and filing fees are not included in this estimate

**Contingencies**

2.87% of the sum of Professional, Construction and ROW Costs	\$ 5,520.00
--	-------------

Total Roadwork	\$ 142,044.99	Cost per mi this pro	\$ 94.70
Total Drainage	\$ 55,600.00	Allowable per mile	\$ 94.70
<b>Project Total</b>	<b>\$ 197,644.99</b>	<b>Allowable this proj.</b>	<b>\$ 142,045.45</b>

# ATTACHMENT "C"

## Photographs

**ATTACHMENT "C"**



**Jardin Terrace Subdivision**

**Mahala Dr.**

**COLONIA ID. No. M1080348**

**COMMENTS: EXISTING NARROW POORLY PAVED ROADWAY**

**ATTACHMENT "D"**

**LOCATION/MAP**

ATTACHMENT "D"

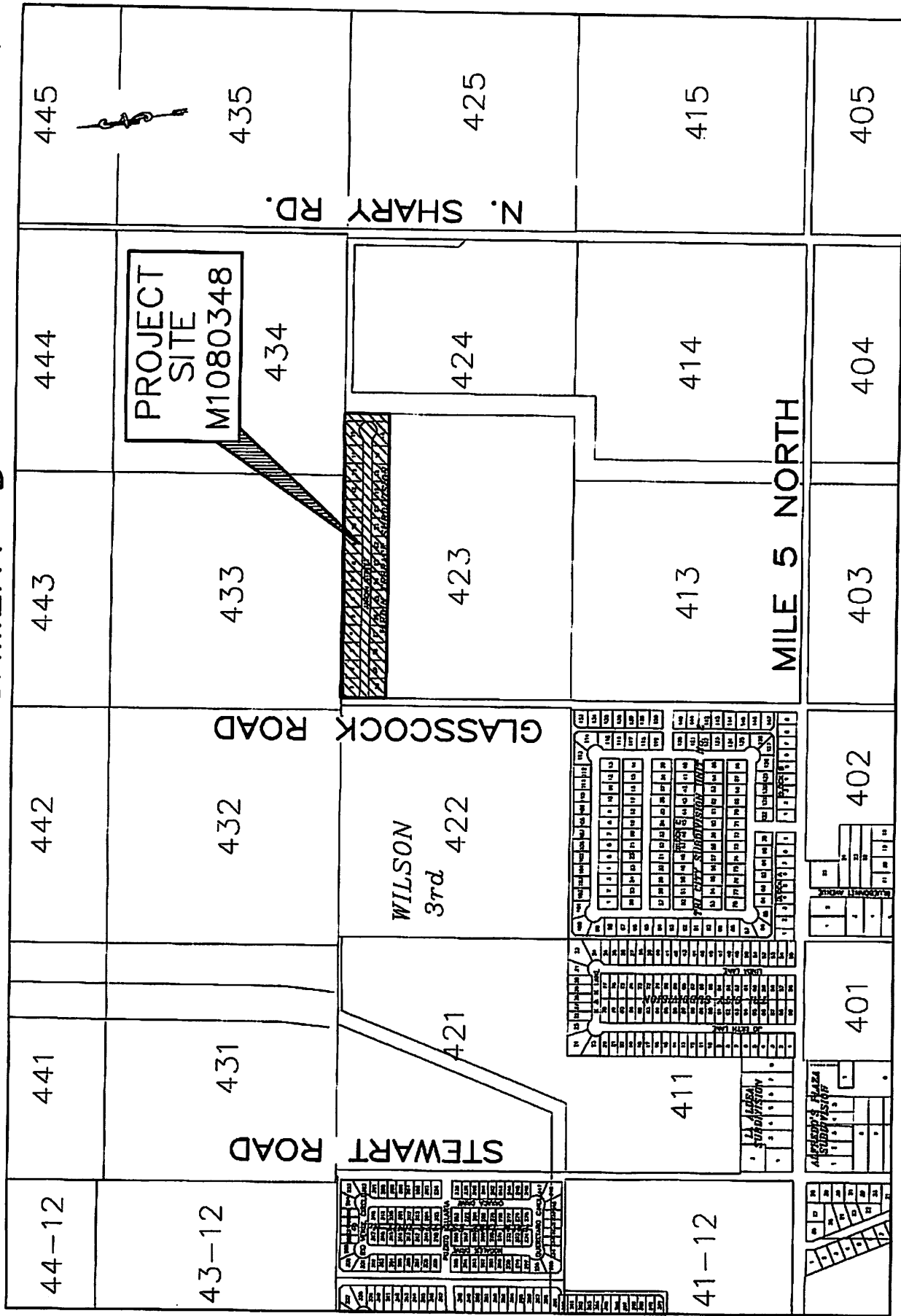

LOCATION MAP  
JARDIN TERRACE SUBDIVISION  
COLONIA ID. NO. M1080348

**ATTACHMENT "E"**

**Subdivision Plat**

# Attachment "E"



Recorded to Book 23, Page 159-B  
 County, Texas  
 Dallas and Fort Worth  
 County Surveys

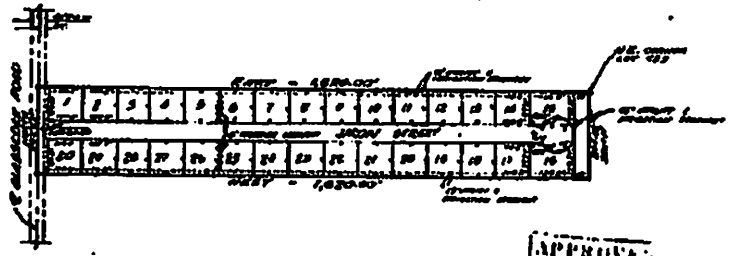

## SUBDIVISION PLAN OF LARKIN TERRACE SUBDIVISION

THE ABOVE SET FORTH AND SET OUT BY THE ABOVE SIGNED  
 SUBDIVISION PLAN OF LARKIN TERRACE IN S.W. 1/4 SEC. 10, T. 10N., R. 10W.,  
 COUNTY, TX IS ACCORDING TO THE STATE SURVEY, 1922.  
 COUNTY TEXAS

DATE OF PLAN  
 COUNTY OF TEXAS

THE CORNER OF THE LAND HEREIN DESCRIBED AND SHOWN HEREIN IS BOUNDARY AND  
 THE CORNER OF THE LAND HEREIN DESCRIBED IS BOUNDARY AND SHOWN HEREIN TO THE USE  
 OF THE PUBLIC RECORDS OF THE COUNTY, TEXAS, COUNTY, TEXAS, COUNTY, TEXAS, COUNTY, TEXAS,  
 COUNTY, TEXAS AND SHALL BE BOUNDARY AND SHOWN HEREIN TO THE PUBLIC RECORDS OF THE COUNTY,  
 COUNTY, TEXAS

*U. H. [Signature]*

DATE OF PLAN  
 COUNTY OF TEXAS

THE CORNER OF THE LAND HEREIN DESCRIBED AND SHOWN HEREIN IS BOUNDARY AND  
 THE CORNER OF THE LAND HEREIN DESCRIBED IS BOUNDARY AND SHOWN HEREIN TO THE USE  
 OF THE PUBLIC RECORDS OF THE COUNTY, TEXAS, COUNTY, TEXAS, COUNTY, TEXAS, COUNTY, TEXAS,  
 COUNTY, TEXAS AND SHALL BE BOUNDARY AND SHOWN HEREIN TO THE PUBLIC RECORDS OF THE COUNTY,  
 COUNTY, TEXAS

*W. H. [Signature]*

DATE OF PLAN  
 COUNTY OF TEXAS

THE CORNER OF THE LAND HEREIN DESCRIBED AND SHOWN HEREIN IS BOUNDARY AND  
 THE CORNER OF THE LAND HEREIN DESCRIBED IS BOUNDARY AND SHOWN HEREIN TO THE USE  
 OF THE PUBLIC RECORDS OF THE COUNTY, TEXAS, COUNTY, TEXAS, COUNTY, TEXAS, COUNTY, TEXAS,  
 COUNTY, TEXAS AND SHALL BE BOUNDARY AND SHOWN HEREIN TO THE PUBLIC RECORDS OF THE COUNTY,  
 COUNTY, TEXAS

*[Signature]*

THE CORNER OF THE LAND HEREIN DESCRIBED AND SHOWN HEREIN IS BOUNDARY AND  
 THE CORNER OF THE LAND HEREIN DESCRIBED IS BOUNDARY AND SHOWN HEREIN TO THE USE  
 OF THE PUBLIC RECORDS OF THE COUNTY, TEXAS, COUNTY, TEXAS, COUNTY, TEXAS, COUNTY, TEXAS,  
 COUNTY, TEXAS AND SHALL BE BOUNDARY AND SHOWN HEREIN TO THE PUBLIC RECORDS OF THE COUNTY,  
 COUNTY, TEXAS

*[Signature]*

THE CORNER OF THE LAND HEREIN DESCRIBED AND SHOWN HEREIN IS BOUNDARY AND  
 THE CORNER OF THE LAND HEREIN DESCRIBED IS BOUNDARY AND SHOWN HEREIN TO THE USE  
 OF THE PUBLIC RECORDS OF THE COUNTY, TEXAS, COUNTY, TEXAS, COUNTY, TEXAS, COUNTY, TEXAS,  
 COUNTY, TEXAS AND SHALL BE BOUNDARY AND SHOWN HEREIN TO THE PUBLIC RECORDS OF THE COUNTY,  
 COUNTY, TEXAS

# ATTACHMENT "F"

## District School Bus Route Correspondence

# Sharyland Independent School District

1106 N. Shary Road, Mission, Texas 78572-4652

<http://www.Sharyland.k12.tx.us>

Phone: (956) 580-5200

Fax: (956) 585-2972

## Board of Trustees

Paul R. Rodriguez - President  
Guillermo Reyna, C.P.A. - Vice Pres.  
Juan F. Zuniga - Secretary  
Fernando Ramirez - Asst. Sec.  
Suzanne Pena - Member  
Rolando Pena - Member  
Dr. Noel O. Garza - Member



*"To Better Serve All Students"*

## Administration

Scott B. Owings  
Superintendent  
Jesse Muñiz  
Assistant Superintendent  
Business and Finance

March 25, 2008

## ATTACHMENT "F"

Mr. Jack Foster  
Texas Department of Transportation  
600 West Expressway 83  
P.O. Drawer EE  
Pharr TX 78577

RE: Border Colonia Access Program – Bus Route Designations

Dear Mr. Foster:

Our school district serves the following residents in the colonias identified below:

Colonia	T.W.D.B. ID #
Basham #14	M1080079
Jardin Terrace Subdivision	M1080348

This district is responsible for the transportation of the children of these colonias to and from their respective schools throughout our District. Road conditions in these colonias limit the ability of our transportation personnel to reach the children of the colonia creating a hardship on these families to get their children to school.

Currently the public streets in these colonias serve as bus routes where our buses can maneuver. Those areas that our buses are not accessible are not served, but if the roadways were improved our bus routes would extend into the colonias to serve the children of the area. The paving of roadways in the above-identified colonias would greatly enhance and expand our capability to serve the children of the Colonias.

Thank you in advance for your assistance and should you have any questions or require further information please do not hesitate to contact me at (956) 580-5200.

Sincerely,

Mr. Scott Owings, Superintendent  
Sharyland I.S.D.

CC: Mr. Agapito Vargas Jr., Executive Director Hidalgo County Colonia Access Program  
Project Files