

Hidalgo County
Border Colonia Access Program



Randolph Barnett Subdivision No. 1
Paving and Drainage Improvements Estimate

ATTACHMENT "A"

Description of Work Proposed

ATTACHMENT A
Application for Border Colonia Access Program
Description of Work Proposed

The Randolph Barnett Subdivision No.1 (EDAP #M1080600) project consists of approximately 650 l.f. of repaving with a proposed typical road section of 8 inches of caliche base and 1.5 inches of asphalt or as determined through geotechnical soil tests. Project also includes associated drainage with road side ditches and all necessary appurtenances.

Colonia Randolph Barnett Subdivision No.1 consists of 1 interior road(s) and approximately 650 l.f. inadequately paved road that contributes in inadequate drainage and limited access to the Colonia Residents. Please refer to the photograph on **Attachment C** that further illustrate the need and conditions of the Colonia Road

The proposed project involves paving of Elizabeth Street. The proposed project provides the Colonias Residents necessary access to Schuerbach Road a paved County Road. Please Refer to **Attachment D and E** that illustrates the Colonias location and access.

The Proposed Project is in a proposed school bus route or maybe considered for a future bus route. Please Refer to **Attachment F**.

ATTACHMENT "B"

Quantity Estimates

Attachment "B"

Colonia Name Randolph Barnett Subdivision No.1
Street(s) Name Elizabeth St.
EDAP Number M1080600

Length of proposed roadway 650 FT Existing 50-ft ROW

Proposed Roadway Travel lane 10 min and one 1 curb off set min 24 FT B-B 2-12' proposed lane

of Parcels to be acquired 0
 Estiamted Cost of Land to be acquired \$ -

Estimated Quantities Roadway

Preparing ROW	6.6	STA	\$ 1,000.00		\$ 6,600.00
8" Flex Base (Compl in place) (TY E GR 4)	2544	SY	\$ 7.25		\$ 18,444.00
Reworking Base Material (DC)(TY D CL6)	2544	SY	\$ 2.00		\$ 5,088.00
ASPH Material (MC-30)	509	GAL	\$ 5.00		\$ 2,545.00
ASPH Conc (TY D)(1 1/2")	2212	SY	\$ 8.75		\$ 19,355.00
Barricades, Sign and Traffice Handling	2	MO	\$ 1,000.00		\$ 2,000.00
Turnouts (ASPH-CONC-PAV)(PB-2)	40	SY	\$ 15.00		\$ 600.00
Relocate Mail Boxes	0	LS	\$ 5,000.00		\$ 5,000.00
		TON			\$ -
		MO			\$ -
		SY			\$ -
		SY			\$ -
		LF			\$ -
		LF			\$ -
		SY			\$ -
		EA			\$ -
					\$ -

Estimated Quantities Drainage

Driveway (ASPH-CONC-PAV)(PB-1)	20	EA	\$ 500.00		\$ 10,000.00
Driveway (Concrete 3000 PSI)	6	EA	\$ 1,000.00		\$ 6,000.00
15" ADS Culvert Pipe	520	LF	\$ 20.00		\$ 10,400.00
18" RCP Culvert Pipe	70	LF	\$ 50.00		\$ 3,500.00
Safety End Treatment	2	EA	\$ 800.00		\$ 1,600.00
Temporary Sediment Control Fence	230	LF	\$ 5.00		\$ 1,150.00
		CY	\$ -		\$ -

Professional Costs (% costs may vary from county to county)

Basic Engineering Services (8.5% of Total Estimated Construction Cost)	\$ 7,843.97
Special Services Design Surveys (2.5% of Total Estimated Construction Cost)	\$ 2,307.05
Categorical Exclusion (Enviromental Document)	
Material Testing Services (3.5% of Total Estimated Construction Cost)	\$ 3,229.87
Sub-Total	\$ 13,380.89
Total Estimated Construction Cost	
Roadway Construction Cost	\$ 59,632.00
Drainage Estimated Quantities	\$ 32,650.00
Sub-Total	\$ 92,282.00
ROW Costs (Land Acquisitions)**	
Estimated cost of Land	
ROW Mapping (\$2.00/parcel)	
Sub-Total	\$ -

**Attorney, appraisal, and filing fees are not included in this estimate

Contingencies

10% of the sum of Professional, Construction and ROW Costs

Total Roadwork	\$ 73,012.89	Cost per mi this pro	\$ 112.33
Total Drainage	\$ 32,650.00	Allowable per mile	\$ 94.70
Project Total	\$ 105,662.89	Allowable this proj.	\$ 61,553.03

ATTACHMENT "C"

Photographs



**Intersection of Elizabeth Street and Schuerbach Road
Barnett # 2, Hidalgo County, Precinct 3**

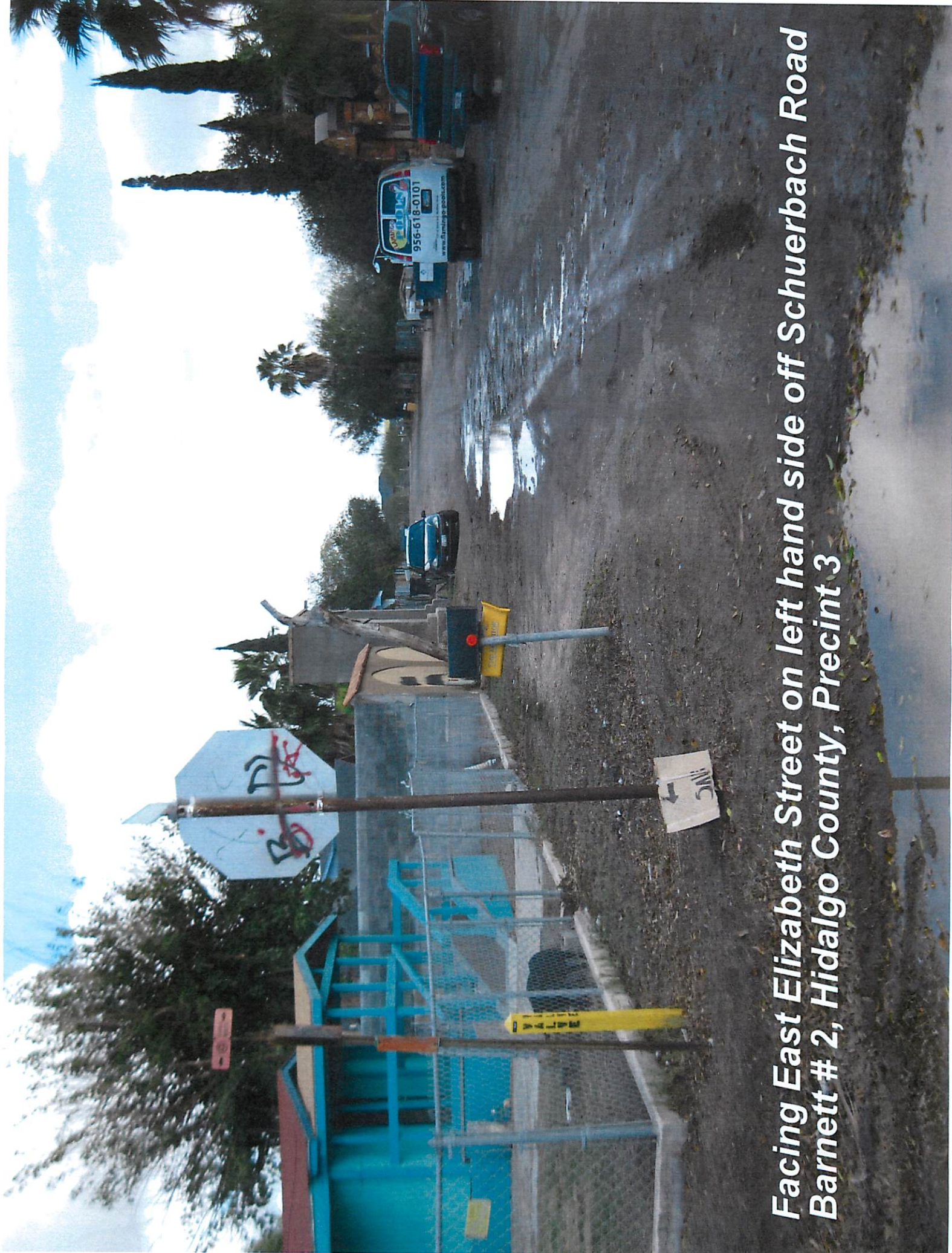

Facing East Elizabeth Street on left hand side off Schuerbach Road
Barnett # 2, Hidalgo County, Precinct 3



Facing East on Elizabeth Street center portion off Schuerbach Road
Barnett # 2, Hidalgo County, Precinct 3

*Facing West from the culldesac on Elizabeth Street
Barnett # 2, Hidalgo County Precinct 3*





**Again facing West on Elizabeth Street from the culldesac
Barnett # 2, Hidalgo County, Precinct 3**



*One more shot facing West on Elizabeth Street
Barnett # 2, Hidalgo County, Precinct 3*

ATTACHMENT "D"

LOCATION/MAP

ATTACHMENT "D"

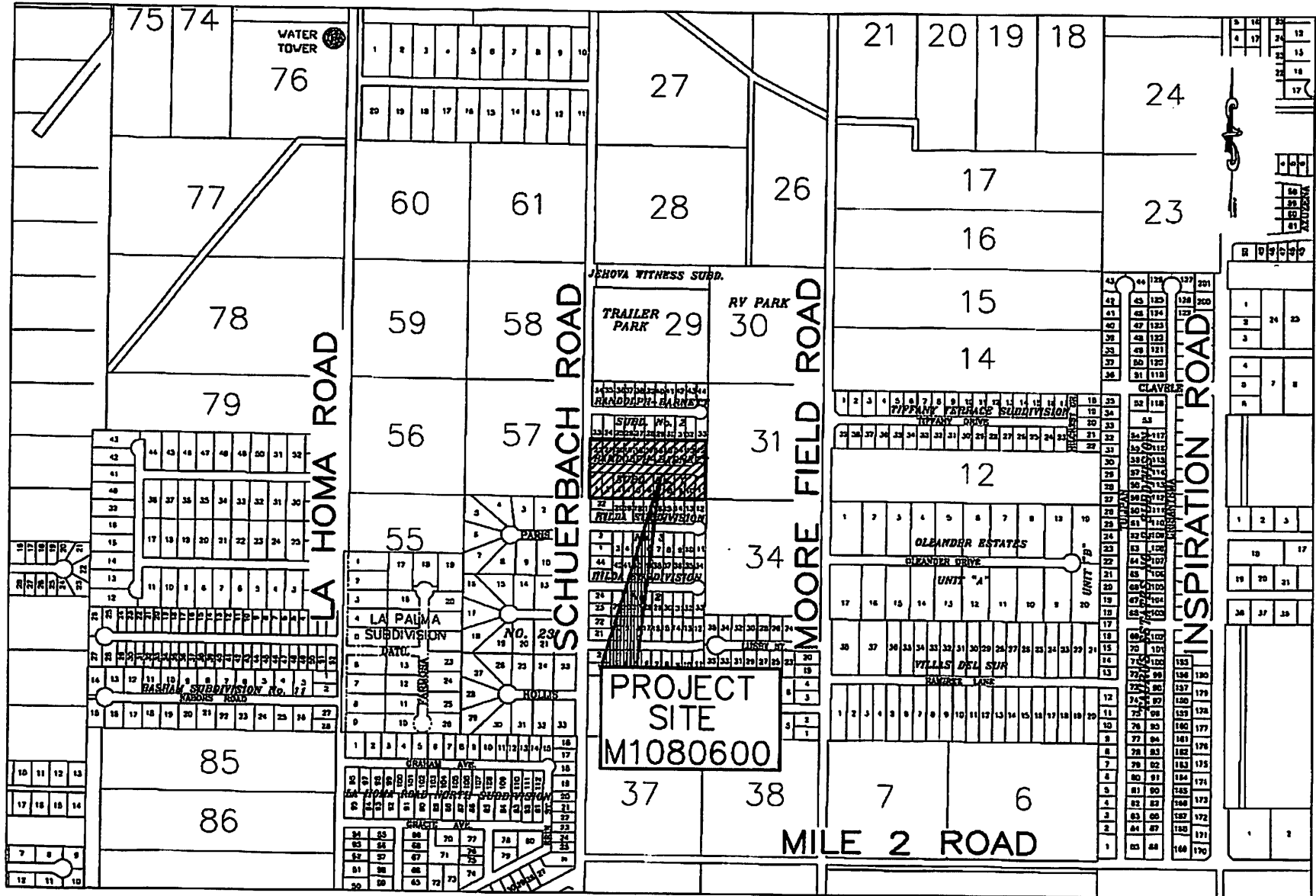

LOCATION MAP
RANDOLPH-BARNETT SUBDIVISION No. 1
COLONIA ID. NO. M1080600

ATTACHMENT "E"

Subdivision Plat

ATTACHMENT "F"

District School Bus Route Correspondence

ATTACHMENT "F"

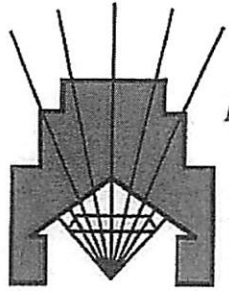

*La
Joya*

Independent School District
Superintendent of Schools
201 East Expressway 83, La Joya, TX 78560
Tel (956) 580-5000 Fax (956) 580-5444

Board of Trustees
Rita Garza-Uresti, *President*
Jose A. "Fito" Salinas, *Vice-President*
John Valente Alaniz, *Secretary*
Joe Aguilar, *Member*
Arturo Gonzalez, Jr., *Member*
Joel Garcia, *Member*
Elma Garza, *Member*

March 25, 2008

Mr. Jack Foster
Texas Department of Transportation
600 West Expressway 83
P.O. Drawer EE
Pharr TX 78577

RE: Border Colonia Access Program – Bus Route Designations

Dear Mr. Foster:

Our school district serves the following residents in the colonias identified below:

Colonia	T.W.D.B. ID #
Ariel Hinojosa	M1080055
Basham #18	M1080082
Benavides Subdivision No. 2	M1080097
Blue Star Enterprises Subdivision No. 2	M1080111
Casa De Los Vecinos Subdivision	M1080141
Havana Lomas Subdivision No. 4	M1080310
Havana Lomas Subdivision No. 5	M1080311
Hilda Subdivision No. 2	M1080324
King Ranch Subdivision	M1080357
La Hermosa Subdivision	M1080375
La Homa Groves Estates	M1080380
La Suena Subdivision	M1080397
Las Cuevas	M1080409
Loma Linda Heights Subdivision	M1080421
Ramirez Subdivision	M1080587
Ramirez Subdivision No. 2	M1080588
Ramirez Subdivision No. 3	M1080589
Randolph Barnett Subdivision	M1080600
Regal Estates	M1080606

This district is responsible for the transportation of the children of these colonias to and from their respective schools throughout our District. Road conditions in these colonias limit the ability of our transportation personnel to reach the children of the colonia creating a hardship on these families to get their children to school.

Currently the public streets in these colonias serve as bus routes where our buses can maneuver. Those areas that our buses are not accessible are not served, but if the roadways were improved our bus routes would extend into the colonias to serve the children of the area. The paving of roadways in the above-identified colonias would greatly enhance and expand our capability to serve the children of the Colonias.

Thank you in advance for your assistance and should you have any questions or require further information please do not hesitate to contact me at (956) 580-6050.

Sincerely,



Dr. Alda T. Benavides, Superintendent
La Joya I.S.D.

CC: Mr. Agapito Vargas Jr., Executive Director Hidalgo County Colonia Access Program
Project Files