

RFP NO:2012-065-MSS	Buyer: Moises Salazar	Tel. No: 318-2626 ext. 4863
---------------------	-----------------------	-----------------------------

## **REQUEST FOR PROPOSALS**

### **Hidalgo County Precinct No. 1**

### **Solar Powered Lights -Phase II**

Contact Person:

Martha L. Salazar, CPPB, Purchasing Agent  
Hidalgo County Purchasing Department  
Physical Address 2802 So. Bus. Hwy. 281  
Postal Mailing Address: 2812 So. Bus. Hwy. 281  
(Same Building) Corner of Canton & Bus. 281  
Edinburg, Texas 78539



(956) 318-2626

Form HCPD-04

**LEGAL NOTICE**

**RFP NO: 2012-065-MSS**

1. Proposals will be received for **"Hidalgo County Precinct No. 1- EECBG Grant –Solar Powered Lights -Phase II"** in accordance with the requirements attached hereto as Exhibit "A." Proposals should address all requirements set forth. Proposers may suggest substitutions of features which they feel would be in the best interest of Hidalgo County ("County"). Strong rationale must be presented for any deviation from the requirements. Hidalgo County reserves the right to reject the deviation and its effect on the overall proposal.
2. One (1) original and three (3) copies of all proposals are required, with the proposers name and address clearly typed/printed on upper left hand corner and the proper notation clearly typed/printed on the lower left hand corner of the envelope and/or package, **"RFP NO.: 2012-065-MSS "Hidalgo County Precinct No. 1- EECBG –Solar Powered Lights -Phase II"** and in County's Purchasing Department, Physical Address 2802 So. Bus. Hwy. 281/Postal Mailing Address 2812 So. Bus. Hwy 281 (Same Building) Corner of Canton and Business 281, Administration Building, Edinburg, Texas, on or before, February 13, 2012. **NO LATE ARRIVALS WILL BE ACCEPTED. ANY PROPOSAL RECEIVED AFTER THAT TIME WILL NOT BE ACCEPTED AND WILL BE RETURNED. OVERNIGHT MAIL MUST ALSO BE PROPERLY LABELED ON THE OUTSIDE OF EXPRESS ENVELOPE OR PACKAGE IN REFERENCE TO PROPOSAL.** Hidalgo County reserves the right to refuse and reject any/all proposals and to waive any/all formalities or technicalities, or to accept the proposal considered the best and most advantageous to Hidalgo County.
3. Hidalgo County reserves the right to separate and accept, or eliminate any item(s) listed under this proposal that it deems necessary to accommodate budgetary and/or operational requirements. Hidalgo County also reserves the right to reject any or all proposals submitted and further reserves the right to design the evaluation criteria to be used in selecting the lowest and best proposal for approval. Receipt of any proposal shall under no circumstances obligate County to accept the lowest dollar proposal. The award of this contract shall be made to the responsible offeror whose proposal is determined to be the best evaluated offer resulting from negotiation, taking into consideration the relative importance of price and other evaluation factors as herein set forth.
4. Failure of the delivered item(s) to perform as specified, or failure to meet the stated delivery schedule shall release Hidalgo County from all obligations to the contracting party with regard to the item(s) in question. In such event, County may elect to award the contract to the next-lowest responsible proposer, or to reject all proposals and re-bid project.
5. **For work to be performed at a County owned or operated location, each proposer shall, in its sole discretion, visit the job site before preparing the proposal and thoroughly familiarize himself/herself with existing conditions. Proposer should take field dimensions and note all circumstances which affect the dollar amount of the proposal.**
6. Descriptive specifications are referenced in this document to indicate the general kind and quality of equipment desired by Hidalgo County. Due to various styles and models of equipment, proposers are required to include illustrations, specifications, explanation of warranties, and service data with their proposal including catalogue numbers and any necessary references.

7. No proposal may be withdrawn within sixty (60) days from the scheduled time to open proposals.
8. Proposed prices are to remain firm for a minimum of ninety (90) days after priced proposal opening.
9. Any interpretations, amendments, corrections or changes to this proposal document must be in a written addendum and signed by the County Judge or his designee. Addenda will be mailed to all who are known to have received a copy of the Request for Proposals. Proposers shall acknowledge receipt of all addenda as a part of their proposal.
10. County reserves the right to accept or reject any or all proposals.
11. Costs are to be net F.O.B., County Prepaid.
12. County is exempt from Federal Excise Tax, State Tax and Local Tax. Do Not include tax in cost figure. If it is determined that tax was included in the cost figures it will not be included in the tabulation of any awards. Tax exemption certificates will be furnished upon request.
13. Funds for this procurement have been provided through the County budget for this fiscal year only. County, on an annual basis, has the right to reconsider a contract during the budget process for ensuing years if financial resources of County are insufficient to meet the liabilities of said contract. The award of a proposal or contract hereunder will not be construed to create a debt of the County which is payable out of funds beyond the current fiscal year.
14. Upon award and prior to execution of a contract, Sole Proprietorships are required to submit a copy of their social security cards to the Hidalgo County Auditor's Office in order to establish an account with the County. All awarded vendors must submit a completed W-9 and a copy of their Federal ID Number Certificate.
15. BILLING AND PAYMENT INSTRUCTIONS:
  - . Invoices must include:
    - a) Name and address of successful proposer
    - b) Name and address of receiving department or official
    - c) Purchase Order Number (if any)
    - d) Notation "Hidalgo County Precinct No. 1- EECBG - Solar Powered Lights - Phase II" -2012-065-MSS
    - e) Descriptive information as to the items or services delivered, including product code, item number, quantity, etc.
  - . Discount payments will be considered when offered.

Contact person for Billing and Payment questions:

Hidalgo County Precinct No. 1  
Martha Mena, Executive Assistant  
1902 Joe Stephens Ave.  
Weslaco, TX 78596  
Ph: (956) 968-8733

16. Schedule of Events

Proposal Due Date,	February 13	, 2012
Award of Contract		, 2012
Commence Work or Deliver Products		, 2012

17. Proposer or Performance Bond and Debarment Certification; Payment under Contract:

- If the contract proposed is for the construction of public works or is for a contract for goods and services exceeding **\$100,000**, all bidders shall furnish a good and sufficient proposer bond in the amount of five percent of the total contract price. A proposer bond must be executed with a surety company authorized to do business in Texas. All proposers are also required to furnish a certification or acknowledgment stating that the contractor or vendor is free from debarment or suspension pursuant to federal regulation 45CFR76.
- Together with the signing of a contract or issuance of a purchase order following the acceptance of a proposal, and prior to commencement of the actual work, the proposer shall furnish a performance bond to the County for the full amount of the contract, if that contract exceeds \$50,000.
- If the contract is for **\$50,000** or less, no money will be paid to the contractor until completion and acceptance of the work or the fulfillment of the purchase obligation to the County, and, if applicable, the receipt by County of satisfactory evidence that all subcontractors and material men have been paid.
- If a contract is for the construction, alteration or repair of public buildings or public works, the contractor *shall* provide a payment bond for a contract in excess of Twenty Five Thousand Dollars (**\$25,000.00**), as required by Tex. Govt. Code Ch. 2253.
- For requirements contracts, bond requirements are determined by applying the proposed unit price to the estimated quantities included in the specifications.

18. Ethical Standards:

- It shall be a breach of ethics to offer, give or agree to give any elected official, department head or employee, or former elected official, department head or employee, of the County, or for any elected official, department head or employee or former elected official, department

head or employee of the County, to solicit, demand, accept or agree to accept from another person, entity or organization, a gratuity or an offer of employment in connection with any decision, approval, disapproval, recommendation, preparation or any part of a program requirement or purchase request, influencing the content of any specification or procurement standard, rendering of advice, investigation, auditing, or in any other advisory capacity in any proceeding or application, request for ruling, determination, claim or controversy, or other particular matter pertaining to any program requirement or a contract or subcontract, or to any solicitation or proposal therefore pending before any department or agency of the County.

- It shall be a breach of ethics for any payment, gratuity or offer of employment to be made by or on behalf of a subcontractor under a contract to the prime contractor or higher tier subcontractor for any contract for the County, or any person associated therewith, as an inducement for the award of a subcontract or order.
- No public official shall have an interest in a contract awarded hereunder except in accordance with Tex. Loc. Govt. Code Chapter 171.

19. **Disclosure of Conflict of Interest**

**Effective January 1, 2006, Chapter 176 of the Texas Local Government Code requires that any vendor, person, consultant or contractor considering doing business with Hidalgo County ("the County") to disclose in the Conflict of Interest Questionnaire (the "CIQ") attached as Exhibit D, the vendor, person, consultant or contractor's affiliation or business relationship that might cause a conflict of interest with the County. By law, the CIQ must be filed with the Hidalgo County Clerk's Office no later than the seventh business day after the date the person becomes aware of facts that require that statement to be filed. The disclosure requirement applies to a person or business who contracts or seeks to contract with Hidalgo County for the sale or purchase of property, goods or service. Any purchase order or contract resulting from this process shall be considered null and void if the successful bidder fails to comply with Texas Local Government Code Chapter 176. Vendors, consultants, contractors and others who desire to conduct business with Hidalgo County are encouraged to refer to Texas Local Government Code Chapter 176 for the details of this law. An offense under Texas Local Government Code Chapter 176 is a Class C Misdemeanor.**

**Please Submit completed CIQ forms to the Hidalgo County Clerk's Office located at 100 N. Closner, Edinburg, Texas 78539-Hidalgo County Courthouse**

**COMPLETION AND SUBMISSION OF FORM CIQ IS THE SOLE RESPONSIBILITY OF THE PROSPECTIVE BIDDER.**

- 20. If, during the life of any contract or proposal awarded, the successful proposer's net prices generally available to other customers for items awarded herein are reduced below the contracted price, it is understood and agreed that the benefits of such reduction shall be extended to County.
- 21. Proposals, and all goods and services provided there under, shall comply with all federal, state and

local laws concerning this type(s) of goods and/or services.

22. Minimum Standards for Responsible Prospective Proposers: A prospective proposer must affirmatively demonstrate proposer's responsibility. A prospective proposer, by submitting a proposal, represents to County that it meets the following requirements:
- . Possess and submit a Certificate of Account Status indicating bidder is in "Good Standing" with the Texas Comptroller of Public Accounts if such bidder is incorporated in the State of Texas. To secure a certificate of "Good Standing", you may access the following website: [www.window.state.tx.us/taxinfo/coasintr.html](http://www.window.state.tx.us/taxinfo/coasintr.html) . If the bidder is not incorporated in Texas, the bidder must submit the appropriate evidence of filing with the Texas Secretary of State stating that the business is authorized to transact business in Texas
  - . Possess or is able to obtain adequate financial resources as required to perform under the proposal;
  - . Be able to comply with the required or proposed delivery schedule;
  - . Have a satisfactory record of performance;
  - . Have a satisfactory record of integrity and ethics;
  - . Be otherwise qualified and eligible to receive an award.
23. Successful proposer will pay or cause to be paid, without cost or expenses to County, all FICA, FUTA/SUTA and Federal Income Withholding Taxes of all employees, and all wages and benefits as required by Federal or State law. Successful proposers officers, agents and/or employees will not be entitled to any benefits of an employee or elected official of County, including, but not limited to, benefits associated with County's civil service system.
24. Any contract award to a successful proposer will be in effect until (a) the contract expires, (b) delivery and acceptance of products, and/or performance of services ordered, or (c) terminated by County with thirty (30) day's written notice prior to cancellation.
25. County reserves the right to enforce performance of any contract awarded hereunder in any manner prescribed by law or deemed to be in the best interest of the County in the event of breach or default by successful proposer; County reserves the right to terminate any contract immediately in the event a successful proposer fails to:
- A. Meet schedules;
  - B. Pay any required fees or taxes; or
  - C. Otherwise perform in accordance with the requirements.
26. Successful proposer shall defend, indemnify and save harmless County and all its elected officials, officers, agents and employees from all suits, actions, or other claims of any character, name and description brought for or on account of any injuries or damages received or sustained by any person,

persons, or property on account of any negligent act or fault of the successful proposer, or of any agent, employee, subcontractor or supplier in the execution of, or performance under, any contract which may result from proposal award. Successful proposer indemnifies and will indemnify and save harmless County from liability, claim or demand on their part, agents, servants, customers, and/or employees whether such liability, claim or demand arise from event or casualty happening or within the occupied premises themselves or happening upon or in any of the halls, elevators, entrances, stairways or approaches of or to the facilities within which the occupied premises are located. Successful proposer shall pay any judgment with costs which may be obtained against County growing out of such injury or damages, and shall, upon request, provide a defense to County by counsel reasonably acceptable to County. Successful proposers indemnity hereunder shall include, but is not limited to, claims relating to patent, copyright or trademark infringement, and the like, arising out of the goods or services provided by successful proposer.

27. Successful proposer shall warrant that all items/services shall conform with the specifications and/or all warranties provided under the Uniform Commercial Code and be free from all defects in material, workmanship and the like. Items supplied under a contract pursuant to this Request for Proposals shall be subject to County's approval. Items found to be defective or not meeting specifications shall be replaced by successful proposer within two business days at no expense to County. Items not picked up within one (1) week after notification shall be deemed a donation to County and may be used or disposed of at County's discretion and without waiver of any other rights of County as to the item's nonconformity.
28. This document and any disputes arising hereunder shall be governed and construed according to the laws of the State of Texas, and will be performable exclusively in Hidalgo County, Texas.
29. The successful proposer shall not assign, sell, transfer or convey its rights under any awarded contract, in whole or in part, without the prior written consent of County.
30. Proposers shall provide with the proposal response, a list of at least three (3) references where like services have been supplied by their firm. Include the name of the business or government, address, telephone number and name of representative or contact person.
31. Proposers must provide **all** documentation requested with this Proposal in their response. Failure to provide this information may result in rejection of the proposal as non conforming.

Proposal  
for

**Hidalgo County Precinct No. 1-  
Solar Powered Lights -Phase II (EECBG)**

**RFP NO: 2012-065-MSS**

**February 13, 2012**

To: Martha L. Salazar, CPPB, Purchasing Agent  
Hidalgo County Purchasing Department  
2802 So. Bus. Hwy 281  
Postal Mailing Address: 2812 So. Bus. 281  
(Same Building) Corner of Canton & Bus. 281)  
Edinburg, Texas 78539

In accordance with the Requirements, and subject to all laws and regulations of the United States and state and local laws, the undersigned bidder proposes and commits to furnish all labor, equipment, material, software and services as set forth in the documents hereinbefore mentioned. The undersigned proposer further agrees, upon acceptance of its proposal, to execute a contract and/or Purchase Order issued by Hidalgo County for performing and completing the work described in the Requirements within the time stated and for the prices proposed in the documents attached hereto and made a part hereof.

Proposer acknowledges receipt of all of the pages of the documents referenced in the Checklist presented in connection with this procurement. Proposer understands that Hidalgo County reserves the right to reject any or all proposals and further reserves the right to design the evaluation criteria to be used in selecting the lowest and best proposal.

Proposer agrees that this proposal shall be good and may not be withdrawn for a period of thirty (30) calendar days after the scheduled closing time for receiving proposals, as contained in the Requirements.

Respectfully submitted,

Proposer: Facility Solutions Group

Address: 585 S. Padre Island Drive, Corpus Christi, TX 78405

By: 

Printed Name: David Thomas

Title: Division Manager

HIDALGO COUNTY PURCHASING DEPARTMENT

EXHIBIT "A"

Hidalgo County Precinct No. 1

Solar Powered Lights Phase II (EECBG)

2012-065-MSS

---

PROJECT PLANS AND SPECIFICATIONS

---

HIDALGO COUNTY PURCHASING DEPARTMENT

**EXHIBIT "A"**

Hidalgo County Precinct No. 1

**Solar Powered Lights- Phase II (EECBG)**

2012-065-MSS

**PLANS, SPECIFICATIONS TERMS AND CONDITIONS**

---

**SCOPE OF WORK:** Scope of Work will be as provided by project engineer, Raul Sesin, P.E., Hidalgo County Planning Department on attached plans and specifications.

Dear Participants, currently the Hidalgo County Precinct No. 1 is requesting a proposal through your Buy Board Contract.

Pursuant to the scope of work attached hereto, Hidalgo County Precinct No. 1 is seeking proposals through your Buy Board awarded contract pricing.

**General Requirements:**

1. **PREVAILING WAGE RATES/DAVIS BACON ACT COMPLIANCE:**  
The Contractor and each Subcontractor who performs work under the Contract must pay, at a minimum, the prevailing wage rates to a worker employed by it in the performance of the Work.
2. Proposal must comply with the Buy American Provisions of the American Recovery and Reinvestment Act.

## SECTION 30050

### SOLAR POWERED LIGHTS

#### 1. SCOPE OF PROJECT

**1.1 Design:** All components of the solar lighting system shall be mounted on the pole and shall not be accessible from the ground without mechanical means.

**1.2 Operation:** Lights shall be stand-alone solar powered systems and shall not be connected to grid power. Overall, the system shall operate automatically without the use of a separate photo cell. The solar panel itself shall act as a photocell. It shall sense a low light level at dusk and shall turn the light on to run full from dusk to dawn, and shall adjust automatically as the days get longer. These functions shall be regulated by the controller. There shall be no day to day maintenance or adjustment required. All of the controller settings shall be done at the factory.

**1.3 Warranty:** Proposal submitted without written warranties will be considered non-responsive. Contractor shall meet or exceed the following list of warranties.

- |                           |                                    |
|---------------------------|------------------------------------|
| * Solar panel: 25 Years   | * Aluminum Panel Backing: 20 Years |
| * Aluminum Arm: 20 Years  | * Aluminum Bracket: 20 Years       |
| * Aluminum Pole: 20 Years | * Battery Box: 20 Years            |
| * Reflector: 10 Years     | * Luminaire: 5 Years               |
| * Battery: 5 Years        | * Controller: 5 Years              |
| * LED Lamps: 5 Years      |                                    |

**1.4 Submittals:** Contractor shall submit copies of manufacturer's owner manual and maintenance manual.

**1.5 Light Levels:** Light level requirements must comply with the Illuminating Engineering Society of North America (IESNA) recommendations to determine appropriate lighting level requirements for application.

#### 2. PERFORMANCE CRITERIA AND CONSIDERATIONS.

- Solar panels shall be protected on top by tempered glass.
- Each unit shall be free standing and self-contained.
- The system shall be powered by sunlight.
- LED light source shall consist of multi-junction strip type LED's.
- 100,000 hours rated lamp life.
- 2182 lumens total output with no lens losses from LED packaging.
- 5500 Kelvin – bright white color light.

- 10 days autonomy (battery reserve) for all weather conditions.
- Advanced Power Management LED driver to extend lamp operation and conserve battery power in times of extended inclement weather.
- The system shall be mounted high on the pole for vandal resistance and no wires shall run through the pole to the ground.
- System shall be sized in accordance with United States Department Of Energy specifications for this type of system.
- System shall automatically adjust light during periods of inclement weather to ensure that the lights are constantly on.

### 3. WRITTEN SPECIFICATIONS

#### 3.1 Solar Power Unit

The solar module shall contain polycrystalline solar cells, protected on the upper surface by low iron tempered glass. The solar module shall have a rugged aluminum frame which connects to brackets for attachment to the mounting arm at a 45 degree tilt. All wiring connections shall be with weathered resistant plugs as to keep installation simple, eliminate incorrect wiring, and prevent exposure to corrosion. Stainless steel hardware shall be used throughout. Solar modules shall carry a 25 year manufacturer's warranty.

The solar module array shall exhibit the following characteristics:

Cells:	poly-crystalline silicon cells
Total Watts:	300 watts
Tilt Angle:	45 degrees
Connections:	Weather resistant plug, 4 & 2 pin, color coded

#### 3.2 Fixture

The overhead fixture shall be a die cast corrosion resistant aluminum style fixture with a glass swag lens. Fixture enclosure is to be water tight, sealed, dust and insect free with electrostatic powder-coated finish. Fixture and light source will contain no mercury or lead and present no environmental disposal issues. The electrical connection shall be with weather resistant plugs to simplify installation, eliminate reverse wiring, and prevent exposure to corrosion.

The fixture shall exhibit the following characteristics:

Type:	Die cast corrosion resistant aluminum style fixture
Finish:	Electrostatic powder-coated finish
Fixture Enclosure:	Water tight, sealed, dust and insect free
Lens:	Swag glass lens with Intrusion Protection

### 3.3 Light Source (LED Light Emitting Diode)

The light source shall be solid-state strip LED (light emitting diode) with digital driver. 100,000 hour rated lamp life, 25 watt LED, 90 lumens per watt out of fixture at rated power.

LED's should be multi-junction strip type LED's – 4 strips per quad, and 48 LED's per strip for a total of 192 LED's per quad. Each fixture shall have one quad for a total of 192 LED's. System shall have no lens losses from the LED packaging and reflector coated to prevent degradation of reflective surface with a 50G shock rating.

The light source (LED) shall exhibit the following characteristics:

Type:	Strip LED with digital driver
Rated lamp life:	100,000 hours
Lamp Lumens:	90 lumens per watt at rated power
LED:	LED 25 watt, 5500 Kelvin 50,000 hour guaranteed lamp life
Heat Removal:	LED's mounted directly to heat sinking plate
Reflector:	Reflector system captures light emitted from the LED and directs to the targeted area.
Shock Rating:	50G's
Environmental Issues:	No environmental issues. System contains no mercury or lead.
LED Drive:	Electronic driver
Capacitors:	No electrolytic capacitors shall be used.
Power Management:	Power Management shall conserve battery power in times of extended inclement weather.

### 3.4 Controller

The controller shall be a microprocessor based charge controller designed exclusively for the running of solar lighting applications. Controller shall feature automatic charge termination for batteries. Low voltage disconnect shall be set to extend battery life. Controller shall autosense system voltage and shall have weatherproof connectors. It shall be circuit protected with UL approved weather sealing and a charge current rating of 20 amps.

Controller shall be located inside the battery box. Controller shall be factory pre-set for full dusk to dawn operation (approximately 13.5 hours).

Charge/Load Controller shall exhibit the following characteristics:

Method of Charge:	Pulse width modulation charging algorithm
-------------------	---

LVD Disconnect:	Set to extend battery life
Test routines:	Built in for checking installation of solar lighting system.
Connectors:	Weatherproof connectors
Location:	Controller located inside battery box
Run time:	Factory pre-set full dusk to dawn operation (approximately 13.5 hours).

### 3.5 Battery and Battery Enclosure

Battery shall be of sealed valve, regulated gel type, requiring no maintenance, air shippable, capable of 1300 minimum cycles to 30% depth of discharge, and rated for 99 amp hours at the 100 hour rate. 10 days autonomy (battery reserve) for all weather conditions. The wire harness shall include a weather resistant ATO fuse holder and plug to eliminate system failure due to corrosion, and accommodate quick/easy installation.

The Battery enclosure shall be aluminum, vented and shaded by solar array with access door loaded from front. Battery enclosure shall house battery and controller. Entire unit shall be shaded by the panels to avoid heat and mounted high on the pole to avoid vandalism.

The battery shall exhibit the following characteristics:

Type:	Sealed valve regulated gel
Voltage:	12 volts each
Location of Box:	High on pole, under panels, avoids heat and vandalism
Enclosure:	Aluminum vented
Access Door:	Loaded from front
Battery Reserve:	10 days
Power Management:	Protects battery life in periods of bad weather
Regular Maintenance:	None

### 3.6 Brackets and Arms

The support frame shall be constructed of tubular extruded aluminum. The fixture support arm shall be constructed of aluminum tube. All hardware shall be stainless steel. The overall Effective Projected Area of the entire system including luminaire shall not exceed 28 square feet.

Solar Array Support Frame:	Side of pole
Angle of Tilt:	45 degrees
Fixture Support Arm:	10 feet aluminum
Material:	Aluminum
Hardware:	Stainless Steel

### **3.7 Pole**

Standard wood pole to support proposed luminaire system shall be provided and installed by Contractor. Wood pole shall meet American National Standards Institute (ANSI) Standard Specifications for Wood Poles.

### **3.8 Wire Connections**

All wire connections shall be with weather resistant plugs, keyed to make installation quick and easy and to eliminate failure due to corrosion and incorrect wiring.

### **3.9 Concrete Base**

In the event that ground conditions require the use of a concrete base for the embeddedment of the poles, the Contractor shall provide a fixed cost to secure that the poles are anchored to support the luminaire system.

### **4.0 PAYMENT**

Compensation will be for furnishing all materials, labor, equipment, tools and incidentals required for the work in accordance with the plans and these specifications. Any incidental work incurred by contractor to accomplish said plans, specifications, and contract pay items, shall be deemed to be included in the project and therefore shall not be considered for additional compensation.

**\*\*\* END OF SECTION \*\*\***

# HIDALGO COUNTY PRECINCT No. 1 SOLAR LIGHTS PROJECT PH 2

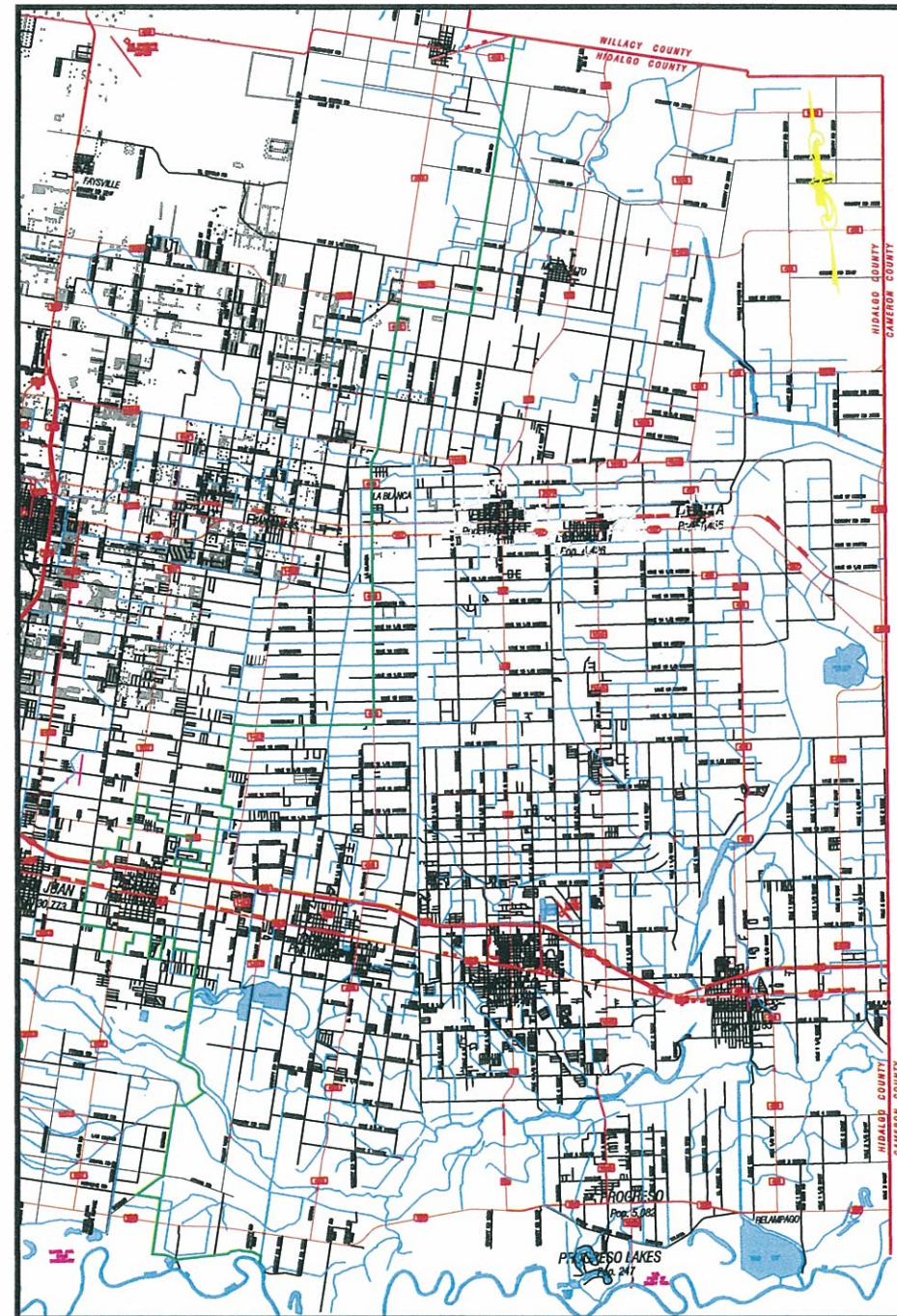
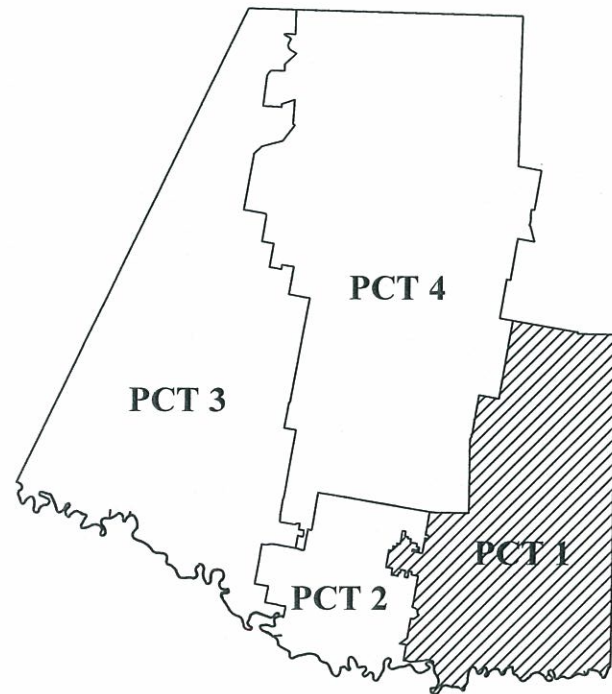

## HIDALGO COUNTY PLANNING DEPARTMENT

1304 S. 25 TH. STREET  
EDINBURG TX. 78539  
TEL: (956) 318-2840 ★ FAX: (956) 318-2844  
www.co.hidalgo.tx.us  
RAUL E. SESIN, P.E., C.F.M.  
PLANNING ADMINISTRATOR

### CITY OF MERCEDES, CITY OF ELSA, CITY OF EDCOUCH, AND CITY OF LA VILLA

REVISION:	DATE:
HIDALGO COUNTY PCT 1 ADDED NEW SITES.	11/20/11
HIDALGO COUNTY PCT 1 ADJUSTED SOLAR LIGHT LOCATIONS	1/20/11
HIDALGO COUNTY PCT 1 DELETED SITES AND ADJUSTED LOCATION OF SOLAR LIGHTS.	2/06/12
HIDALGO COUNTY PCT 1 ADDED 10 MORE SOLAR LIGHTS.	2/15/12

<i>RAMON GARCIA</i>	<i>COUNTY JUDGE</i>
<i>COMMISSIONER JOEL QUINTANILLA</i>	<i>PRECINCT No. 1</i>
<i>COMMISSIONER HECTOR "TITO" PALACIOS</i>	<i>PRECINCT No. 2</i>
<i>COMMISSIONER JOE M. FLORES</i>	<i>PRECINCT No. 3</i>
<i>COMMISSIONER JOSEPH PALACIOS</i>	<i>PRECINCT No. 4</i>



This seal appearing on this document was authorized by Raul E. Sesin P.E. No. 86374 on the above designated date.

RAUL E. SESIN-P.E. No. 86374

9TH ST.

MARIO LEAL DRIVE

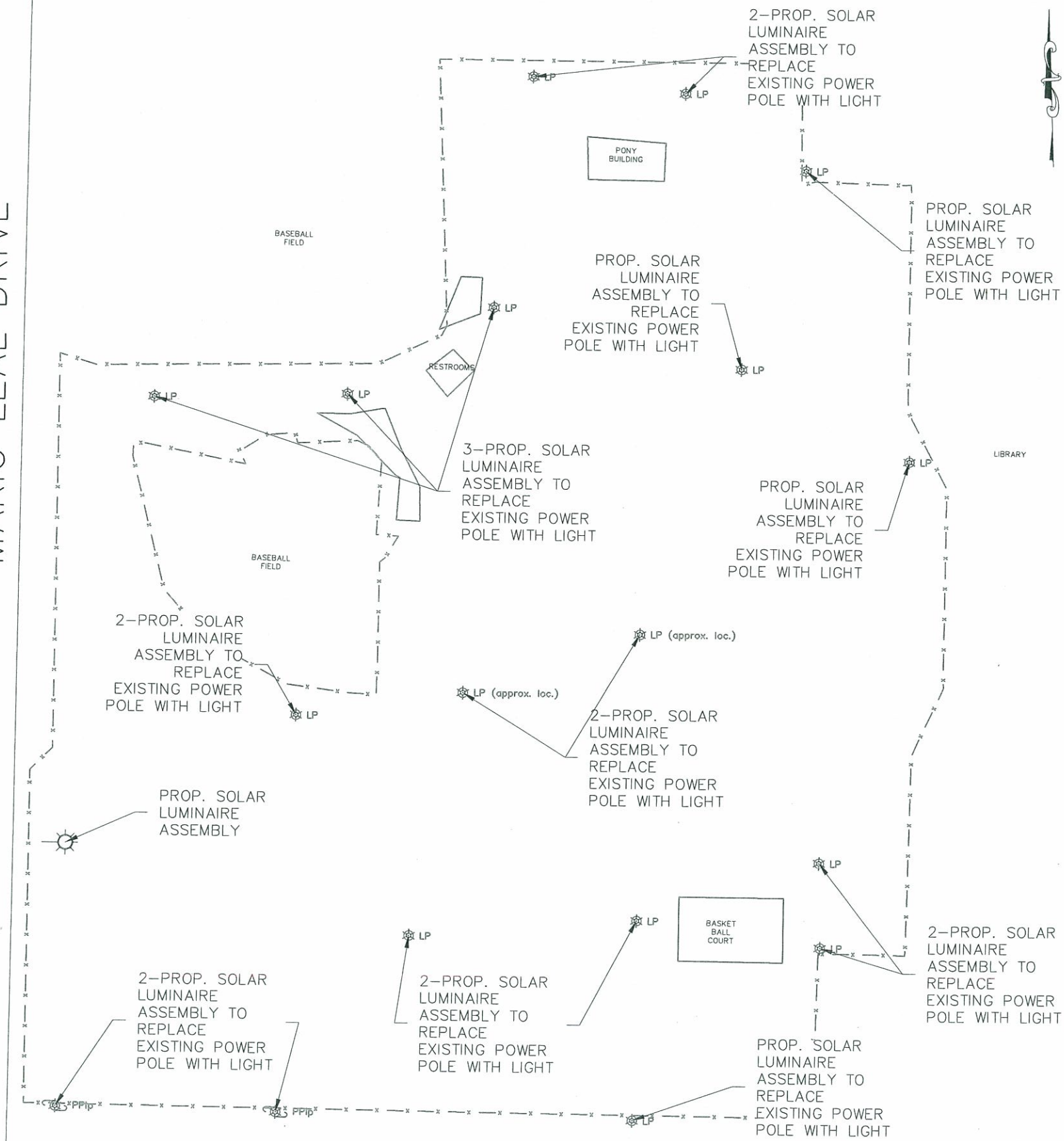

6TH ST.

**NOTES:**  
 ALL LUMINAIRE ASSEMBLY LOCATIONS ARE TENTATIVE, THE CONTRACTOR SHALL DETERMINE THE OPTIMUM LOCATION BASED ON R.O.W. AVAILABILITY, FIELD CONDITIONS, AND MANUFACTURER'S RECOMMENDATIONS.

LUMINAIRE ADJUSTMENTS SUBJECT TO APPROVAL BY THE ENGINEER.

LUMINAIRE ARMS SHALL BE AIMED PERPENDICULAR TO THE CENTERLINE OF ROADWAY OR AS DIRECTED BY THE ENGINEER.

LUMINAIRE ASSEMBLY WILL BE INSTALL NEXT TO EXISTING SERVICE POLE WHEN LOCATED INSIDE ROW OR WHERE DETERMINE BY THE ENGINEER.

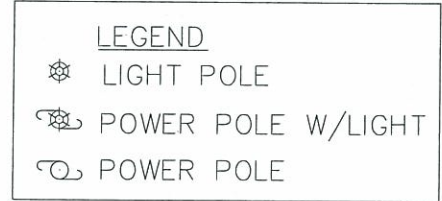

**SUMMARY OF QUANTATIES**

DESCRIPTION	UNIT	QTY
FURNISH AND INSTALL SOLAR LIGHTING ASSEMBLIES (COMPLETE IN PLACE)	EA	19

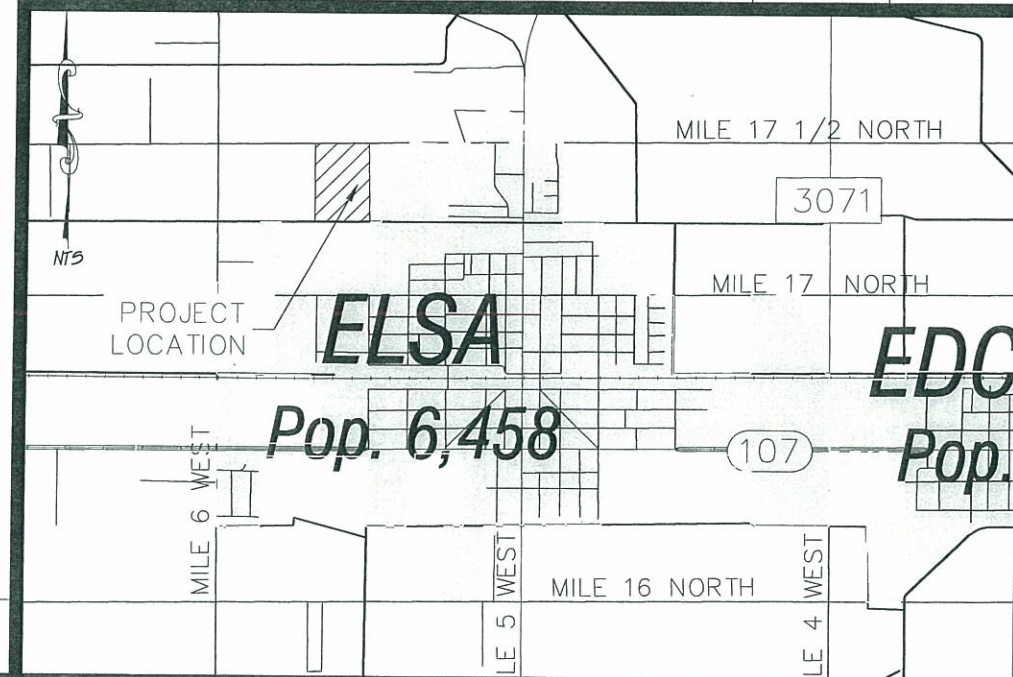

HIDALGO COUNTY  
 PLANNING DEPARTMENT  
 1304 S. 25 TH. STREET  
 EDINBURG TX 78539  
 TEL: (956) 318-2840 FAX: (956) 318-2844  
 www.co.hidalgo.tx.us  
 RAUL E. SESIN, P.E., C.F.M.  
 PLANNING ADMINISTRATOR

**HIDALGO COUNTY  
 PRECINCT 1 PROJECT**

MARIO LEAL PARK  
 CITY OF ELSA  
 PROPOSED LUMINAIRE ASSEMBLY

STATE OF TEXAS  
 RAUL E. SESIN  
 86374  
 LICENSED PROFESSIONAL ENGINEER  
 This seal appearing on this document was authorized by Raul E. Sesin P.E. No. 86374 on the above designated date.  
 RAUL E. SESIN - P.E. No. 86374

SCALE: 1"=100'  
 DATE: 11-12-11  
 DRAWN BY: CYNTHIA PEREZ  
 DESIGNED BY: R. SESIN  
 REVISED BY: R. SESIN  
 SURVEYED BY: E. ISIDRO  
 PROJECT FILE:

SHEET:  
 10 OF 1

Drawing: I:\PCT 1\pct 1 solar light ph 2\elsa park\mario leal park.dwg Plotted by: cynthia.perez  
 Layout: Tab: plan b Date: 02/13/2012 Time: 08:24:36 AM

SOUTHERN AVE.

COMMERCIAL ST.

HILL ST.

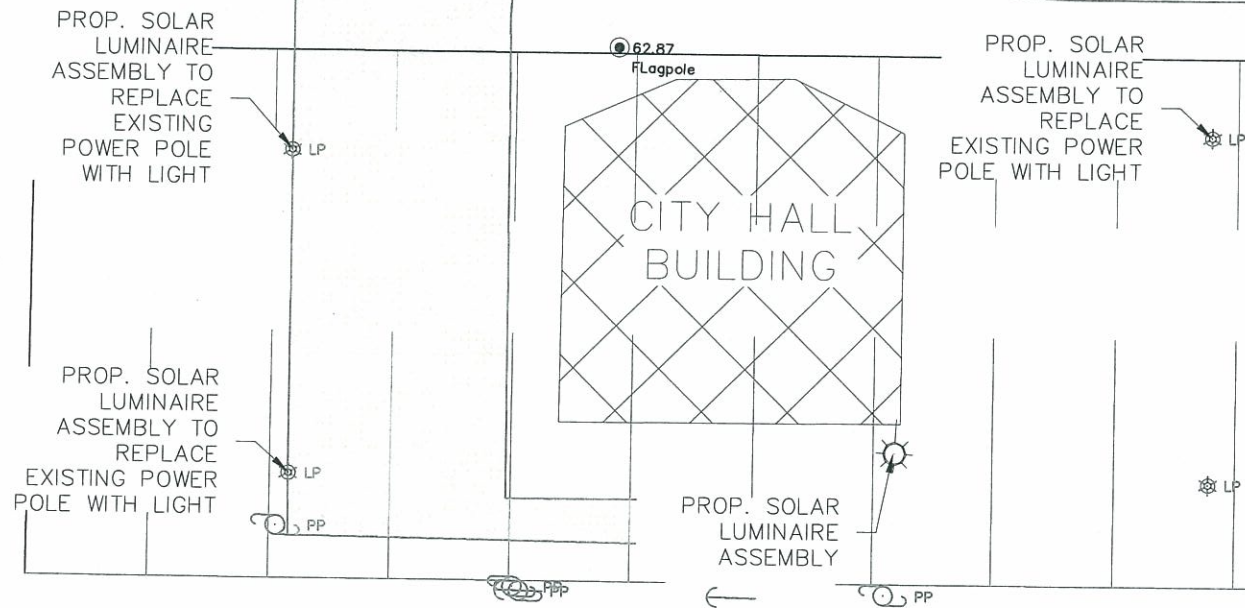

**LEGEND**

- ☼ LIGHT POLE
- ⊕ POWER POLE W/LIGHT
- ⊙ POWER POLE

**NOTES:**  
 ALL LUMINAIRE ASSEMBLY LOCATIONS ARE TENTATIVE, THE CONTRACTOR SHALL DETERMINE THE OPTIMUM LOCATION BASED ON R.O.W. AVAILABILITY, FIELD CONDITIONS, AND MANUFACTURER'S RECOMMENDATIONS.

LUMINAIRE ADJUSTMENTS SUBJECT TO APPROVAL BY THE ENGINEER.

LUMINAIRE ARMS SHALL BE AIMED PERPENDICULAR TO THE CENTERLINE OF ROADWAY OR AS DIRECTED BY THE ENGINEER.

LUMINAIRE ASSEMBLY WILL BE INSTALL NEXT TO EXISTING SERVICE POLE WHEN LOCATED INSIDE ROW OR WHERE DETERMINE BY THE ENGINEER.

**SUMMARY OF QUANTATIES**

DESCRIPTION	UNIT	QTY
FURNISH AND INSTALL SOLAR LIGHTING ASSEMBLIES (COMPLETE IN PLACE)	EA	4

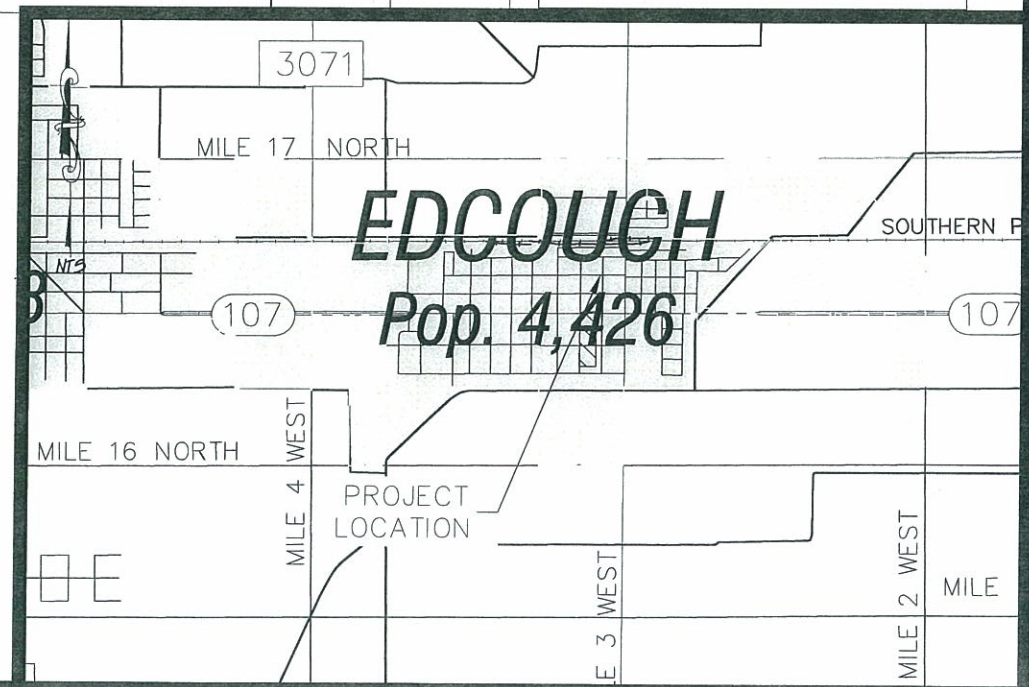

HIDALGO COUNTY  
 PLANNING DEPARTMENT  
 1304 S. 25 TH STREET  
 EDINBURG TX 78539  
 TEL: (956) 318-2840 FAX: (956) 318-2844  
 www.co.hidalgo.tx.us  
 RAUL E. SESIN, P.E., C.F.M.  
 PLANNING ADMINISTRATOR



**HIDALGO COUNTY  
 PRECINCT 1 PROJECT**

CITY OF EDCOUCOCH  
 CITY HALL  
 PROPOSED LUMINAIRE ASSEMBLY

STATE OF TEXAS  
 RAUL E. SESIN  
 86374  
 LICENSED PROFESSIONAL ENGINEER  
 This seal appearing on this document was authorized by Raul E. Sesin P.E. No. 86374 on the above designated date.  
 RAUL E. SESIN P.E. No. 86374

SCALE: 1"=30'  
 DATE: 11-15-11  
 DRAWN BY: CYNTHIA PEREZ  
 DESIGNED BY: R. SESIN  
 REVISED BY: E. SIDRO  
 SURVEYED BY: E. SIDRO  
 PROJECT FILE:

SHEET:  
 10F1

Drawing: I:\PCT 1\sect 1\solar light ph 2\edcouch city hall\edcouch city hall.dwg Plotted by: cynthia.perez  
 Layout: Tab: Layout1 Date: 02/13/2012 Time: 10:49:43 AM

CRENSHAW

PROP. SOLAR LUMINAIRE ASSEMBLY TO REPLACE EXISTING POWER POLE WITH LIGHT

PROP. SOLAR LUMINAIRE ASSEMBLY TO REPLACE EXISTING POWER POLE WITH LIGHT

PROP. SOLAR LUMINAIRE ASSEMBLY

CITY OF EDCOUCH BUILDING

BELL PARK

BASKET BALL COURT

PLAY GROUND

SHADE

SHADE

SHADE

PARKING

ADKINS AVE.

PROP. SOLAR LUMINAIRE ASSEMBLY TO REPLACE EXISTING POWER POLE WITH LIGHT

PROP. SOLAR LUMINAIRE ASSEMBLY TO REPLACE EXISTING POWER POLE WITH LIGHT

INDUSTRIAL DRIVE

GUERRA SUBD.

LEGEND

- ☼ LIGHT POLE
- ⊕ POWER POLE W/LIGHT
- ⊖ POWER POLE

NOTES:

ALL LUMINAIRE ASSEMBLY LOCATIONS ARE TENTATIVE, THE CONTRACTOR SHALL DETERMINE THE OPTIMUM LOCATION BASED ON R.O.W. AVAILABILITY, FIELD CONDITIONS, AND MANUFACTURER'S RECOMMENDATIONS.

LUMINAIRE ADJUSTMENTS SUBJECT TO APPROVAL BY THE ENGINEER.

LUMINAIRE ARMS SHALL BE AIMED PERPENDICULAR TO THE CENTERLINE OF ROADWAY OR AS DIRECTED BY THE ENGINEER.

LUMINAIRE ASSEMBLY WILL BE INSTALL NEXT TO EXISTING SERVICE POLE WHEN LOCATED INSIDE ROW OR WHERE DETERMINE BY THE ENGINEER.

SUMMARY OF QUANTATIES

DESCRIPTION	UNIT	QTY
FURNISH AND INSTALL SOLAR LIGHTING ASSEMBLIES (COMPLETE IN PLACE)	EA	4

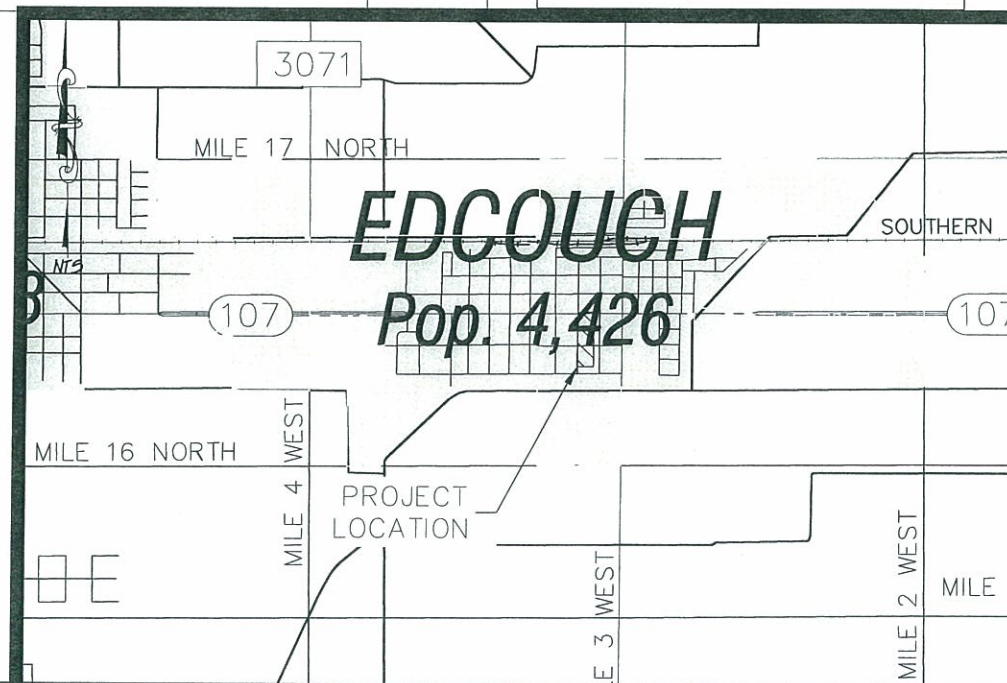

CITY OF EDCOUCH  
BELL PARK  
PROPOSED LUMINAIRE ASSEMBLY

STATE OF TEXAS  
RAUL E. SESIN  
LICENSED PROFESSIONAL ENGINEER  
No. 86374  
This seal appearing on this document was authorized by Raul E. Sesin P.E. No. 86374 on the above designated date.

SCALE: 1"=50'  
DATE: 11-15-11  
DRAWN BY: CYNTHIA PEREZ  
DESIGNED BY: R. SESIN  
REVISED BY: R. SESIN  
SURVEYED BY: E. SIDRO  
PROJECT FILE:

SHEET:  
10F1

HIDALGO COUNTY  
PLANNING DEPARTMENT  
1304 S. 25 TH STREET  
EDINBURG TX, 78539  
TEL: (956) 318-2840 FAX: (956) 318-2844  
www.co.hidalgo.tx.us  
RAUL E. SESIN, P.E., C.F.M.  
PLANNING ADMINISTRATOR



HIDALGO COUNTY  
PRECINCT 1 PROJECT

Drawing: I:\PCT 1\pct 1 solar light ph 2\edcouch-bell park\edcouch-bell park.dwg Plotted by: cynthia.perez  
Layout: Tab: Layout1 Date: 02/13/2012 Time: 11:24:13 AM

ADKINS AVE.

PROP. SOLAR LUMINAIRE ASSEMBLY TO REPLACE EXISTING POWER POLE WITH LIGHT

PROP. SOLAR LUMINAIRE ASSEMBLY TO REPLACE EXISTING POWER POLE WITH LIGHT

PROP. SOLAR LUMINAIRE ASSEMBLY TO REPLACE EXISTING POWER POLE WITH LIGHT

PROP. SOLAR LUMINAIRE ASSEMBLY TO REPLACE EXISTING POWER POLE WITH LIGHT

TOWNSITE LOT 31

TANKS

EXIST BLDG

RESERVOIR

TOWNSITE LOT 7

EXIST. DITCH

LEGEND

- ☼ LIGHT POLE
- ⊕ POWER POLE W/LIGHT
- ⊖ POWER POLE

**NOTES:**  
 ALL LUMINAIRE ASSEMBLY LOCATIONS ARE TENTATIVE, THE CONTRACTOR SHALL DETERMINE THE OPTIMUM LOCATION BASED ON R.O.W. AVAILABILITY, FIELD CONDITIONS, AND MANUFACTURER'S RECOMMENDATIONS.

LUMINAIRE ADJUSTMENTS SUBJECT TO APPROVAL BY THE ENGINEER.

LUMINAIRE ARMS SHALL BE AIMED PERPENDICULAR TO THE CENTERLINE OF ROADWAY OR AS DIRECTED BY THE ENGINEER.

LUMINAIRE ASSEMBLY WILL BE INSTALL NEXT TO EXISTING SERVICE POLE WHEN LOCATED INSIDE ROW OR WHERE DETERMINE BY THE ENGINEER.

**SUMMARY OF QUANTATIES**

DESCRIPTION	UNIT	QTY
FURNISH AND INSTALL SOLAR LIGHTING ASSEMBLIES (COMPLETE IN PLACE)	EA	4

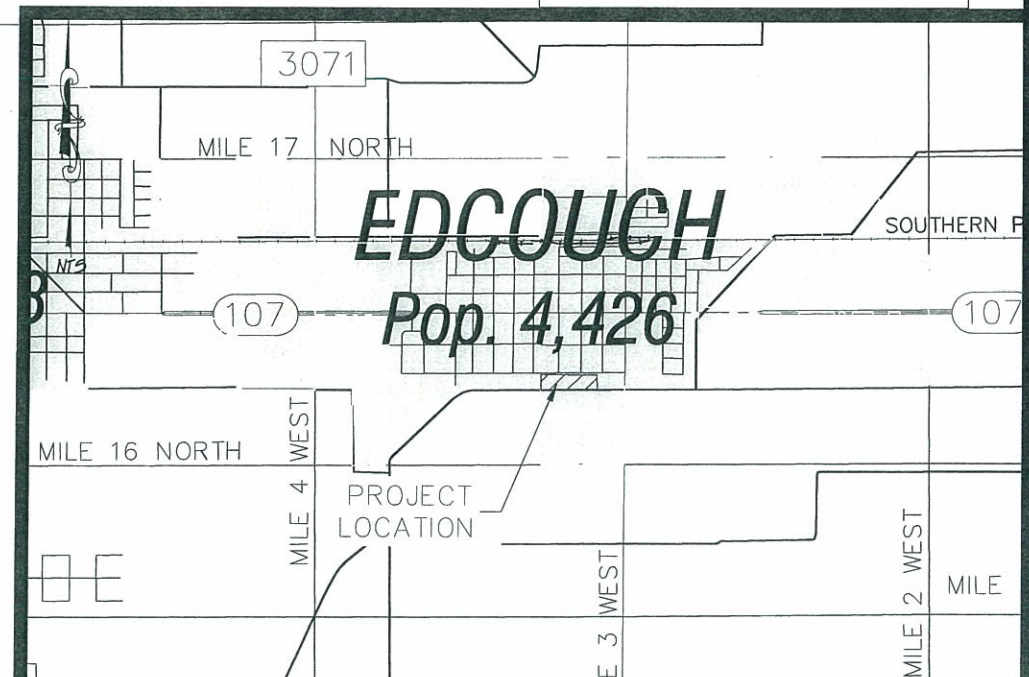

HIDALGO COUNTY PLANNING DEPARTMENT  
 1304 S. 25 TH STREET  
 EDINBURG TX 78539  
 TEL: (956) 318-2840 FAX: (956) 318-2844  
 www.co.hidalgo.tx.us  
 RAUL E. SESIN, P.E., C.F.M.  
 PLANNING ADMINISTRATOR



**HIDALGO COUNTY  
 PRECINCT 1 PROJECT**

**CITY OF EDCOUCHE  
 WATER TREATMENT  
 PLANT  
 PROPOSED LUMINAIRE ASSEMBLY**

STATE OF TEXAS  
 RAUL E. SESIN  
 LICENSED PROFESSIONAL ENGINEER  
 86374  
 This seal appearing on this document was authorized by Raul E. Sesin P.E. No. 86374 on the above designated date.  
 RAUL E. SESIN P.E. No. 86374

SCALE: 1"=30'  
 DATE: 11-15-11  
 DRAWN BY: CYNTHIA PEREZ  
 DESIGNED BY: R. SESIN  
 REVISED BY: R. SESIN  
 SURVEYED BY: E. ISIDRO  
 PROJECT FILE:

SHEET:  
 10F1

Drawing: I:\PCT 1\pct 1 solar light ph 2\edcough water plant\edcough water plant.dwg Plotted by: cynthia.perez  
 Layout: Tab: Layout1 Date: 02/13/2012 Time: 11:27:03 AM

MILE 17 N RD

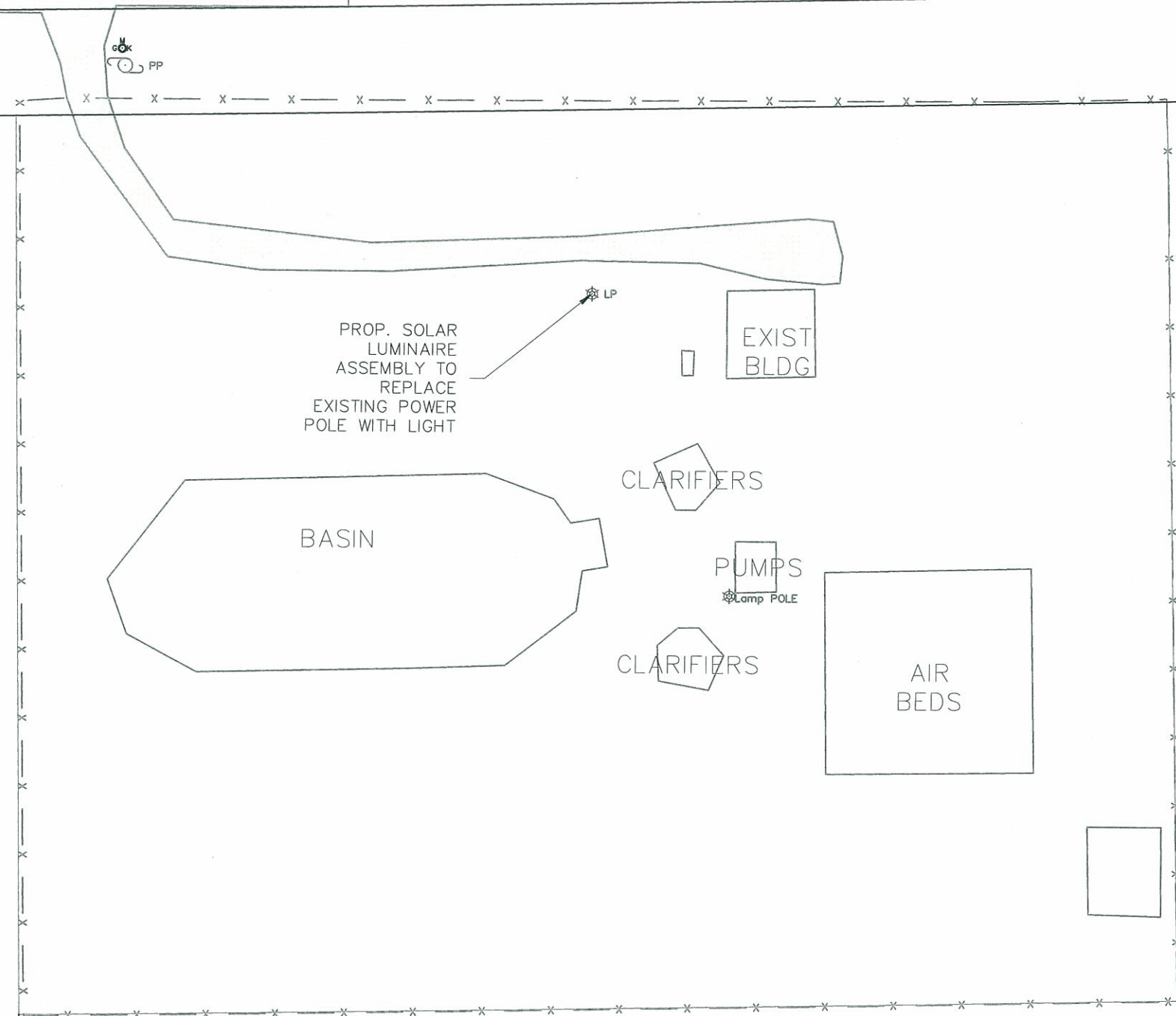

**NOTES:**

ALL LUMINAIRE ASSEMBLY LOCATIONS ARE TENTATIVE, THE CONTRACTOR SHALL DETERMINE THE OPTIMUM LOCATION BASED ON R.O.W. AVAILABILITY, FIELD CONDITIONS, AND MANUFACTURER'S RECOMMENDATIONS.

LUMINAIRE ADJUSTMENTS SUBJECT TO APPROVAL BY THE ENGINEER.

LUMINAIRE ARMS SHALL BE AIMED PERPENDICULAR TO THE CENTERLINE OF ROADWAY OR AS DIRECTED BY THE ENGINEER.

LUMINAIRE ASSEMBLY WILL BE INSTALL NEXT TO EXISTING SERVICE POLE WHEN LOCATED INSIDE ROW OR WHERE DETERMINE BY THE ENGINEER.

**LEGEND**

- POLE
- ⊗ LIGHT POLE
- ⊗ POWER POLE W/LIGHT
- POWER POLE

**SUMMARY OF QUANTATIES**

DESCRIPTION	UNIT	QTY
FURNISH AND INSTALL SOLAR LIGHTING ASSEMBLIES (COMPLETE IN PLACE)	EA	1

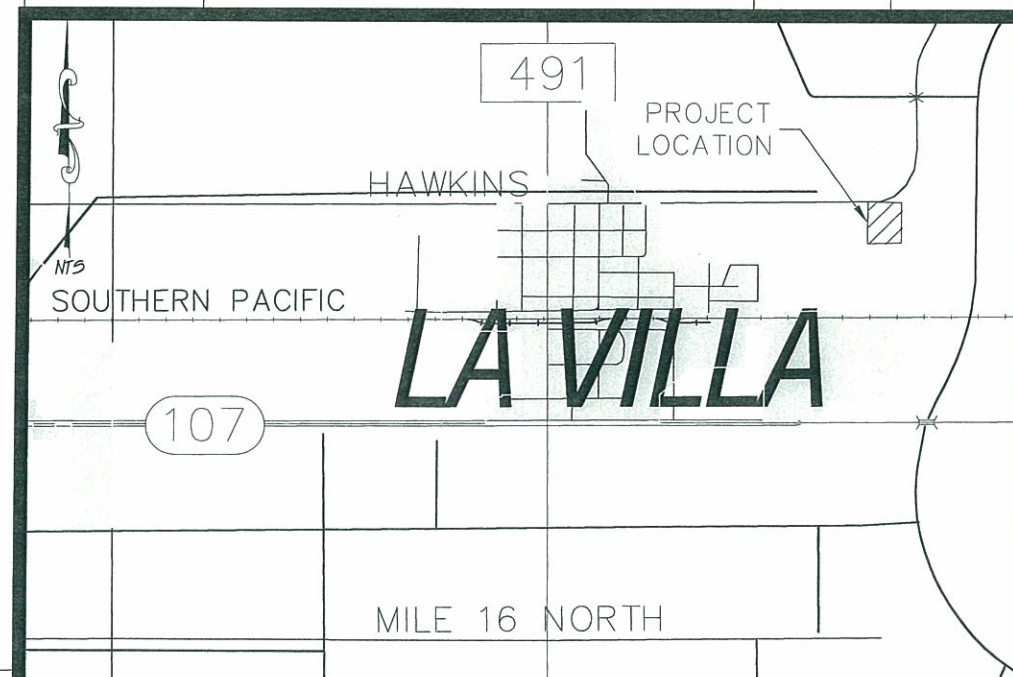

HIDALGO COUNTY  
PLANNING DEPARTMENT  
1304 S. 25 TH STREET  
EDINBURG TX, 78539  
TEL: (956) 318-2840 FAX: (956) 318-2844  
www.co.hidalgo.tx.us  
RAUL E. SESIN, P.E., C.F.M.  
PLANNING ADMINISTRATOR



**HIDALGO COUNTY  
PRECINCT 1 PROJECT**

CITY OF LA VILLA  
WASTE WATER  
TREATMENT PLANT  
PROPOSED LUMINAIRE ASSEMBLY



SCALE: 1"=50'  
DATE: 11-15-11  
DRAWN BY: CYNTHIA PEREZ  
DESIGNED BY: R. SESIN  
REVISED BY: R. SESIN  
SURVEYED BY: E. ISIDRO  
PROJECT FILE:

SHEET:  
**10F1**

Drawing: I:\PCT 1\pct 1 solar light ph 2\la villa sewer plant\la villa sewer plant.dwg Plotted by: cynthia.perez  
Layout: Rob Layout1 Date: 02/13/2012 Time: 11:21:31 AM

Drawing: I:\PCT 1\pct\_1\_solar\_light\_01\la villa city hall\la villa city hall.dwg Plotted by: cynthia.perez  
 Layout: Tab: Layout1 Date: 02/13/2012 Time: 11:22:25 AM

RUNNING TRACK

DUNLAP ST.

CITY HALL

PARKING

CHAPA RD.

PROP. SOLAR LUMINAIRE ASSEMBLY TO REPLACE EXISTING POWER POLE WITH LIGHT

PROP. SOLAR LUMINAIRE ASSEMBLY TO REPLACE EXISTING POWER POLE WITH LIGHT

**NOTES:**

ALL LUMINAIRE ASSEMBLY LOCATIONS ARE TENTATIVE, THE CONTRACTOR SHALL DETERMINE THE OPTIMUM LOCATION BASED ON R.O.W. AVAILABILITY, FIELD CONDITIONS, AND MANUFACTURER'S RECOMMENDATIONS.

LUMINAIRE ADJUSTMENTS SUBJECT TO APPROVAL BY THE ENGINEER.

LUMINAIRE ARMS SHALL BE AIMED PERPENDICULAR TO THE CENTERLINE OF ROADWAY OR AS DIRECTED BY THE ENGINEER.

LUMINAIRE ASSEMBLY WILL BE INSTALL NEXT TO EXISTING SERVICE POLE WHEN LOCATED INSIDE ROW OR WHERE DETERMINE BY THE ENGINEER.

LEGEND	
	POLE
	LIGHT POLE
	POWER POLE W/LIGHT
	POWER POLE

**SUMMARY OF QUANTATIES**

DESCRIPTION	UNIT	QTY
FURNISH AND INSTALL SOLAR LIGHTING ASSEMBLIES (COMPLETE IN PLACE)	EA	2

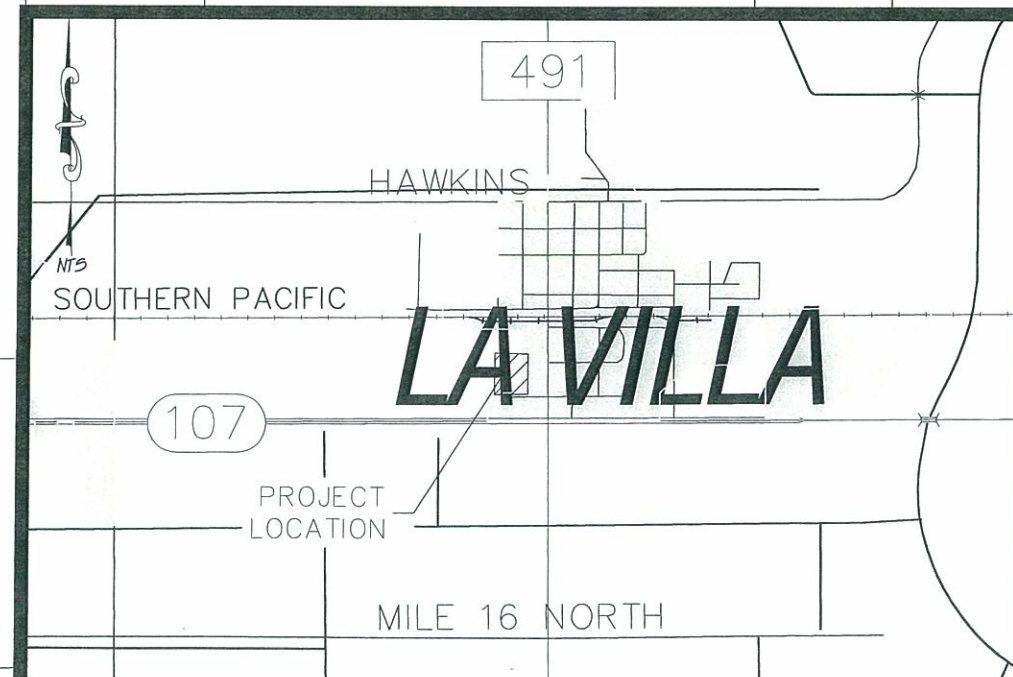

HIDALGO COUNTY  
 PLANNING DEPARTMENT  
 1304 S. 25 TH. STREET  
 EDINBURG TX. 78539  
 TEL: (956) 318-2840 FAX: (956) 318-2844  
 www.co.hidalgo.tx.us  
 RAUL E. SESIN, P.E., C.F.M.  
 PLANNING ADMINISTRATOR

**HIDALGO COUNTY  
 PRECINCT 1 PROJECT**

CITY OF LA VILLA  
 CITY HALL  
 PROPOSED LUMINAIRE ASSEMBLY

STATE OF TEXAS  
 RAUL E. SESIN  
 86374  
 LICENSED PROFESSIONAL ENGINEER  
 This seal appearing on this document was authorized by Raul E. Sesin P.E. No. 86374 on the above designated date.  
 Raul E. Sesin P.E. No. 86374

SCALE: 1"=30'  
 DATE: 11-15-11  
 DRAWN BY: CYNTHIA PEREZ  
 DESIGNED BY: R. SESIN  
 REVISED BY: R. SESIN  
 SURVEYED BY: E. ISIDRO  
 PROJECT FILE:  
 SHEET:  
 10F1

Drawings: A:\PCT\_1\proj\_1\proj\_light\_ph\_2\la villa park\la villa park.dwg Plotted by: cynthia.perez  
Layout Tab: Layout1 Date: 11/17/2011 Time: 09:00:59 PM

GONZALEZ TERRACE

MILE 17 RD N.

PROP. SOLAR LUMINAIRE ASSEMBLY TO REPLACE EXISTING POWER POLE WITH LIGHT

PROP. SOLAR LUMINAIRE ASSEMBLY TO REPLACE EXISTING POWER POLE WITH LIGHT

BALL FIELD  
PROP. SOLAR LUMINAIRE ASSEMBLY TO REPLACE EXISTING POWER POLE WITH LIGHT

PLAY AREA

BASKET BALL COURT

PROP. SOLAR LUMINAIRE ASSEMBLY TO REPLACE EXISTING POWER POLE WITH LIGHT

LA VILLA YOUTH CENTER

RESTROOMS

PARKING

WATER PLANT

TANKS

POND

NOGALES AVE.

H.V.M. LA VILLA LTD.

**NOTES:**

ALL LUMINAIRE ASSEMBLY LOCATIONS ARE TENTATIVE, THE CONTRACTOR SHALL DETERMINE THE OPTIMUM LOCATION BASED ON R.O.W. AVAILABILITY, FIELD CONDITIONS, AND MANUFACTURER'S RECOMMENDATIONS.

LUMINAIRE ADJUSTMENTS SUBJECT TO APPROVAL BY THE ENGINEER.

LUMINAIRE ARMS SHALL BE AIMED PERPENDICULAR TO THE CENTERLINE OF ROADWAY OR AS DIRECTED BY THE ENGINEER.

LUMINAIRE ASSEMBLY WILL BE INSTALL NEXT TO EXISTING SERVICE POLE WHEN LOCATED INSIDE ROW OR WHERE DETERMINE BY THE ENGINEER.

**LEGEND**

- POLE
- ⊙ LIGHT POLE
- ⊙ POWER POLE W/LIGHT
- ⊙ POWER POLE

PROP. SOLAR LUMINAIRE ASSEMBLY TO REPLACE EXISTING POWER POLE WITH LIGHT

PROP. SOLAR LUMINAIRE ASSEMBLY

**SUMMARY OF QUANTATIES**

DESCRIPTION	UNIT	QTY
FURNISH AND INSTALL SOLAR LIGHTING ASSEMBLIES (COMPLETE IN PLACE)	EA	10

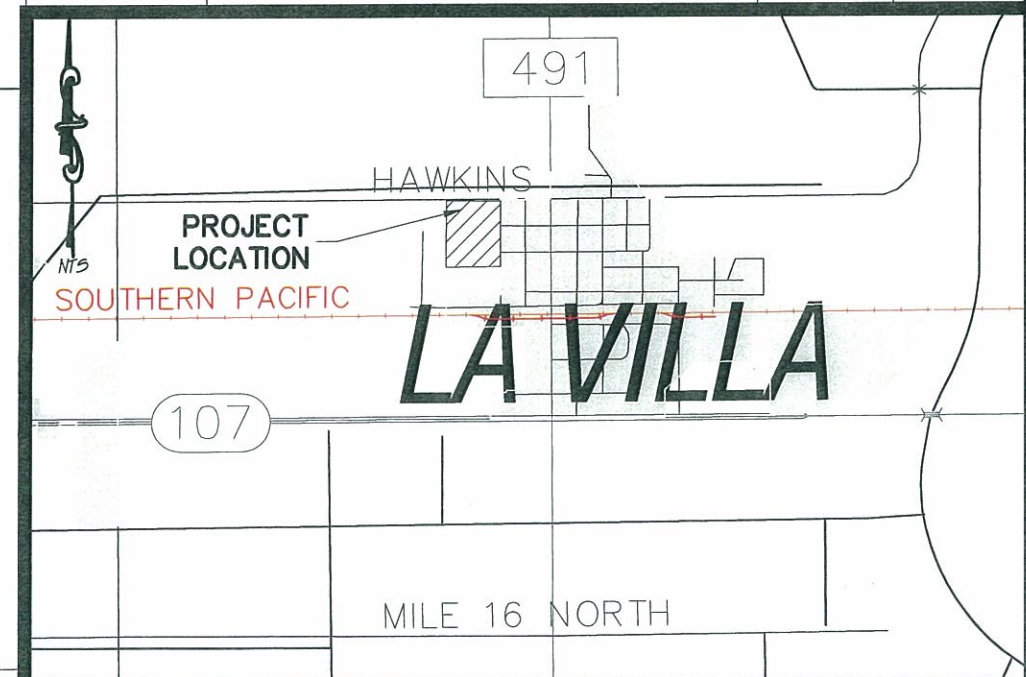

HIDALGO COUNTY  
PLANNING DEPARTMENT  
1304 S. 25 TH. STREET  
EDINBURG TX. 78539  
TEL: (956) 318-2840 FAX: (956) 318-2844  
www.co.hidalgo.tx.us  
RAUL E. SESIN, P.E., C.F.M.  
PLANNING ADMINISTRATOR



**HIDALGO COUNTY  
PRECINCT 1 PROJECT**

**CITY OF LA VILLA  
YOUTH CENTER, PARK  
AND WATER PLANT  
PROPOSED LUMINAIRE ASSEMBLY**

STATE OF TEXAS  
RAUL E. SESIN  
86374  
LICENSED PROFESSIONAL ENGINEER  
This seal appearing on this document was authorized by Raul E. Sesin P.E. No. 86374 on the above designated date.  
RAUL E. SESIN-P.E. No. 86374

SCALE: 1"=100'  
DATE: 11-15-11  
DRAWN BY: CYNTHIA PEREZ  
DESIGNED BY: R. SESIN  
REVISED BY: R. SESIN  
SURVEYED BY: F. HIDRO  
PROJECT FILE:

SHEET:  
**10F1**



Drawing: i:\pct 1\pct 1 solar light.ph 2\MERCEDES CITY PARK\Mercedes park on francis rd.dwg Plotted by: cynthia.perez  
 Layout: 006 Layout1 Date: 11/10/2011 Time: 02:37:43 PM

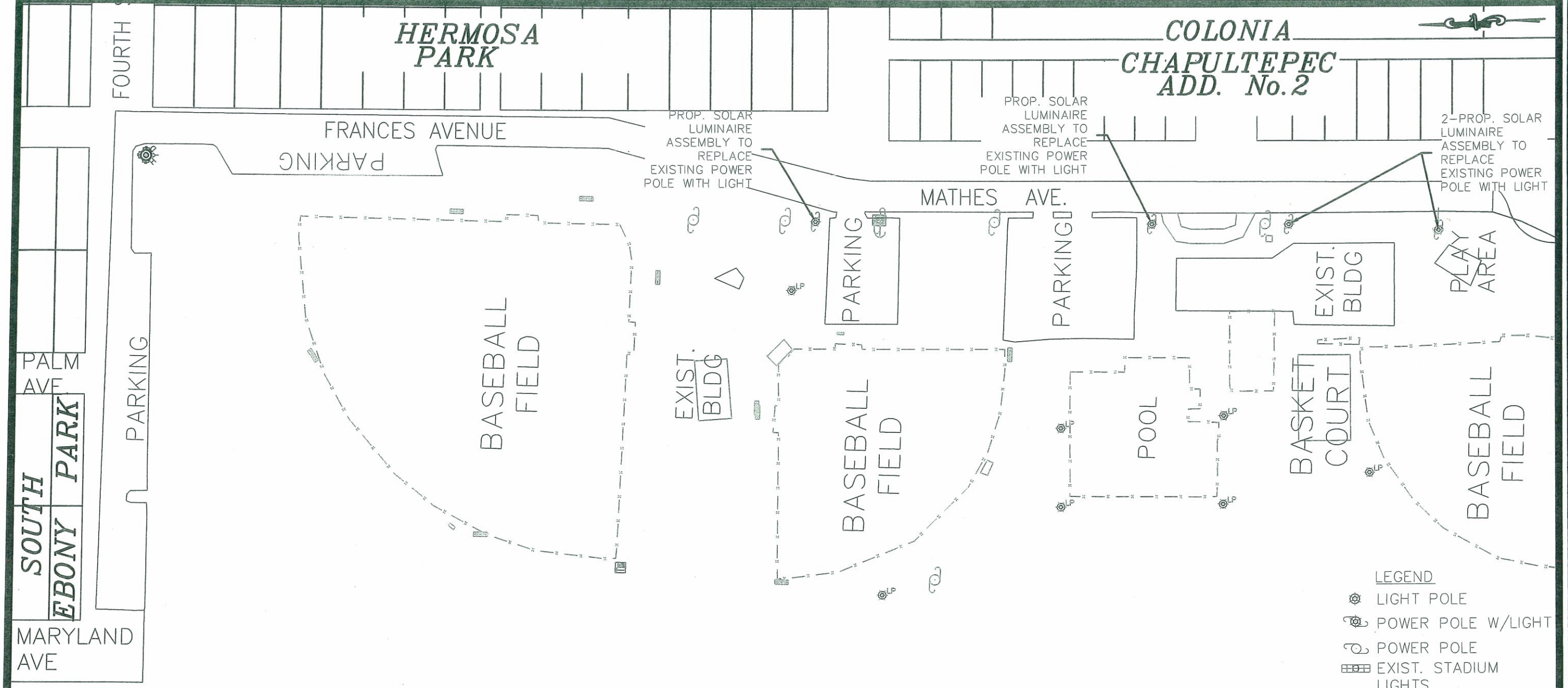

- LEGEND**
- ⊙ LIGHT POLE
  - ⊕ POWER POLE W/LIGHT
  - ⊖ POWER POLE
  - ▤ EXIST. STADIUM LIGHTS

**NOTES:**  
 ALL LUMINAIRE ASSEMBLY LOCATIONS ARE TENTATIVE, THE CONTRACTOR SHALL DETERMINE THE OPTIMUM LOCATION BASED ON R.O.W. AVAILABILITY, FIELD CONDITIONS, AND MANUFACTURER'S RECOMMENDATIONS.

LUMINAIRE ADJUSTMENTS SUBJECT TO APPROVAL BY THE ENGINEER.

LUMINAIRE ARMS SHALL BE AIMED PERPENDICULAR TO THE CENTERLINE OF ROADWAY OR AS DIRECTED BY THE ENGINEER.

LUMINAIRE ASSEMBLY WILL BE INSTALL NEXT TO EXISTING SERVICE POLE WHEN LOCATED INSIDE ROW OR WHERE DETERMINE BY THE ENGINEER.

**SUMMARY OF QUANTATIES**

DESCRIPTION	UNIT	QTY
FURNISH AND INSTALL SOLAR LIGHTING ASSEMBLIES (COMPLETE IN PLACE)	EA	4

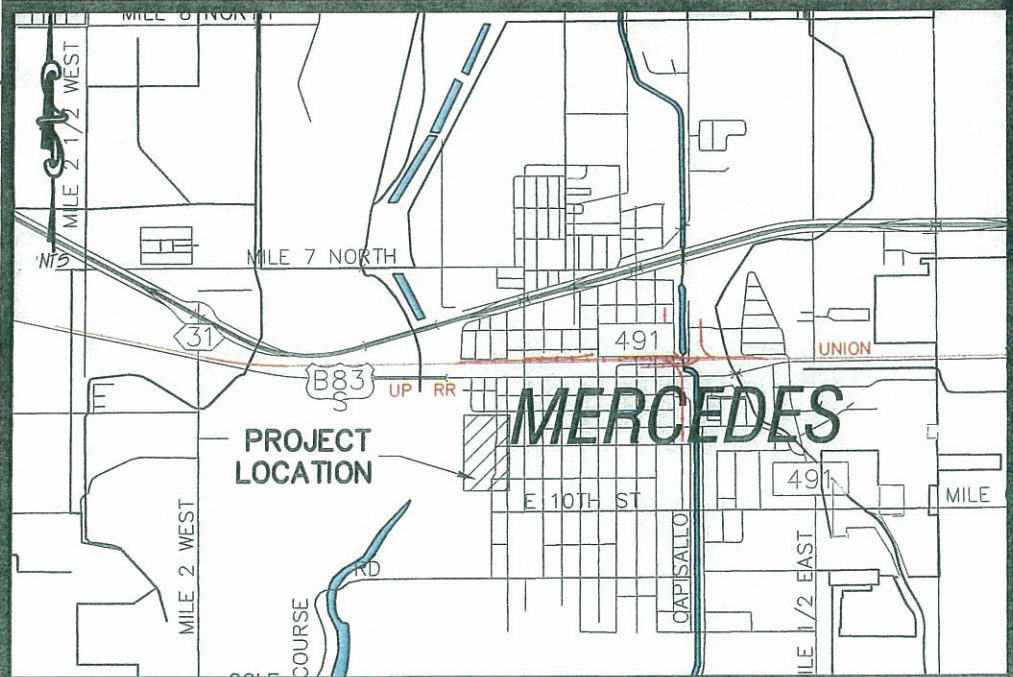

HIDALGO COUNTY  
 PLANNING DEPARTMENT  
 1304 S. 25 TH. STREET  
 EDINBURG TX. 78539  
 TEL: (956) 318-2840 FAX: (956) 318-2844  
 www.edinburgtx.us  
 R. E. SESIN, P.E., C.E.M.  
 PLANNING ADMINISTRATOR

**HIDALGO COUNTY  
 PRECINCT 1 PROJECT**

MERCEDES COLLIER  
 COMPLEX PARK  
 PROPOSED LUMINAIRE ASSEMBLY

STATE OF TEXAS  
 R. E. SESIN  
 86374  
 LICENSED PROFESSIONAL ENGINEER  
 This seal appearing on this document was authorized by Raul E. Sesin P.E. No. 86374 on the above designated date.

SCALE: 1"=100'  
 DATE: 11-8-11  
 DRAWN BY: CYNTHIA PEREZ  
 DESIGNED BY: R. SESIN  
 REVISED BY: R. SESIN  
 SURVEYED BY: E. ISIDRO  
 PROJECT FILE:  
 SHEET:  
 10 OF 1

Drawing: I:\PCT\_1\pct\_1\_eoder\_light\_04\_2\MERCEDES WATER PLANT\Mercedes water plant.dwg Plotted by: cynthiaperez  
 Layout: Tab: Layout1 Date: 11/14/2011 Time: 01:58:34 PM

ILLINOIS AVE.

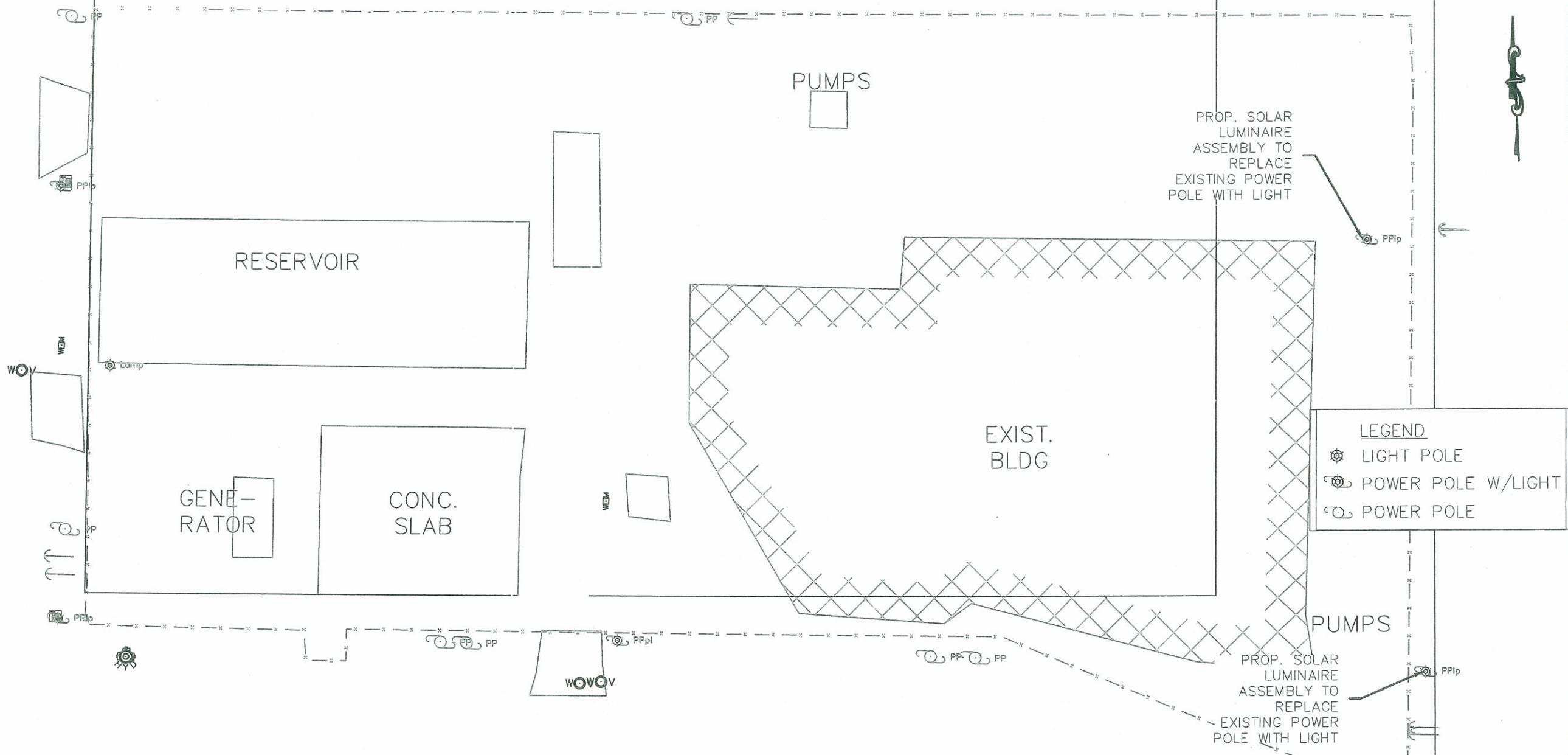

CAPISALLO ST.

**NOTES:**

ALL LUMINAIRE ASSEMBLY LOCATIONS ARE TENTATIVE, THE CONTRACTOR SHALL DETERMINE THE OPTIMUM LOCATION BASED ON R.O.W. AVAILABILITY, FIELD CONDITIONS, AND MANUFACTURER'S RECOMMENDATIONS.

LUMINAIRE ADJUSTMENTS SUBJECT TO APPROVAL BY THE ENGINEER.

LUMINAIRE ARMS SHALL BE AIMED PERPENDICULAR TO THE CENTERLINE OF ROADWAY OR AS DIRECTED BY THE ENGINEER.

LUMINAIRE ASSEMBLY WILL BE INSTALL NEXT TO EXISTING SERVICE POLE WHEN LOCATED INSIDE ROW OR WHERE DETERMINE BY THE ENGINEER.

SUMMARY OF QUANTATIES		
DESCRIPTION	UNIT	QTY
FURNISH AND INSTALL SOLAR LIGHTING ASSEMBLIES (COMPLETE IN PLACE)	EA	2

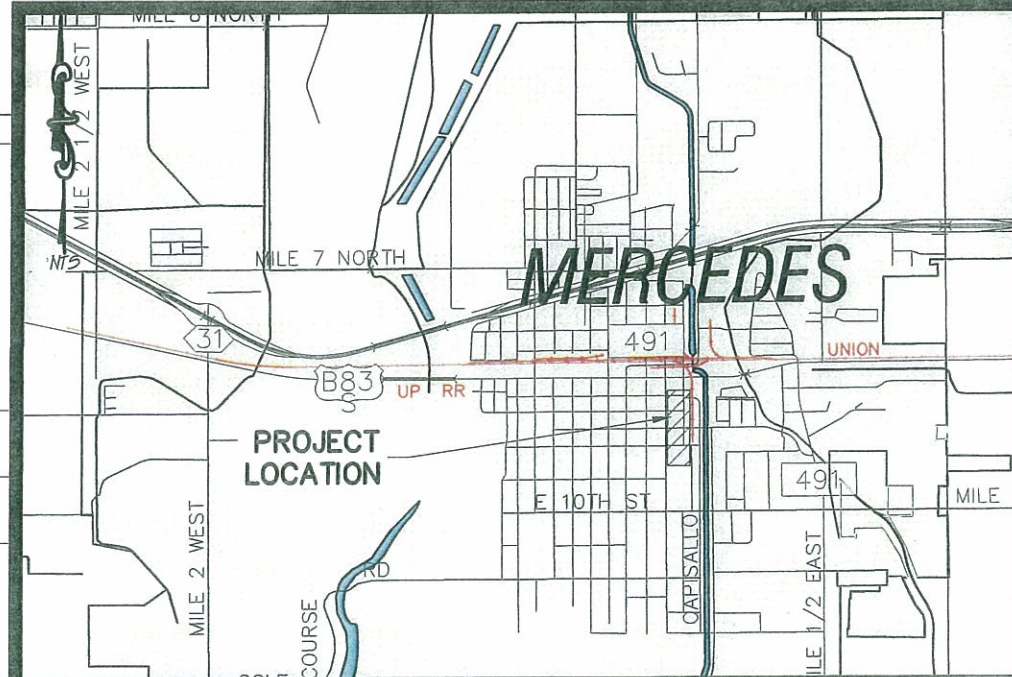

HIDALGO COUNTY  
PLANNING DEPARTMENT

1204 S. 25 TH STREET  
EDINBURG TX 78539

TEL: (956) 318-2840 FAX: (956) 318-2844  
www.co.hidalgo.tx.us

RAUL E. SESIN, P.E., C.F.M.  
PLANNING ADMINISTRATOR

HIDALGO COUNTY  
PRECINCT 1 PROJECT

MERCEDES  
WATER PLANT  
PROPOSED LUMINAIRE ASSEMBLY

STATE OF TEXAS  
RAUL E. SESIN  
86374  
LICENSED PROFESSIONAL ENGINEER

This seal appearing on this document was authorized by Raul E. Sesin P.E. No. 86374 on the above designated date.

RAUL E. SESIN P.E. No. 86374

SCALE: 1"=30'

DATE: 11-10-11

DRAWN BY: CYNTHIA PEREZ

DESIGNED BY: R. SESIN

REVISED BY: R. SESIN

SURVEYED BY: E. BORDO

PROJECT FILE:

SHEET:  
10 OF 1

# HIGH LAND SUBDIVISION

## MILE 9 N ROAD

### MERCEDES LIFT STATION

OWNER: RENE & ESMERALDA ARGUELLES

**LEGEND**

- POLE
- ⊗ POWER POLE W/LIGHT
- ⊙ POWER POLE

PROP. SOLAR LUMINAIRE ASSEMBLY TO REPLACE EXISTING POWER POLE WITH LIGHT

LAMP POST

**NOTES:**  
 ALL LUMINAIRE ASSEMBLY LOCATIONS ARE TENTATIVE, THE CONTRACTOR SHALL DETERMINE THE OPTIMUM LOCATION BASED ON R.O.W. AVAILABILITY, FIELD CONDITIONS, AND MANUFACTURER'S RECOMMENDATIONS.

LUMINAIRE ADJUSTMENTS SUBJECT TO APPROVAL BY THE ENGINEER.

LUMINAIRE ARMS SHALL BE AIMED PERPENDICULAR TO THE CENTERLINE OF ROADWAY OR AS DIRECTED BY THE ENGINEER.

LUMINAIRE ASSEMBLY WILL BE INSTALL NEXT TO EXISTING SERVICE POLE WHEN LOCATED INSIDE ROW OR WHERE DETERMINE BY THE ENGINEER.

### SUMMARY OF QUANTATIES

DESCRIPTION	UNIT	QTY
FURNISH AND INSTALL SOLAR LIGHTING ASSEMBLIES (COMPLETE IN PLACE)	EA	1

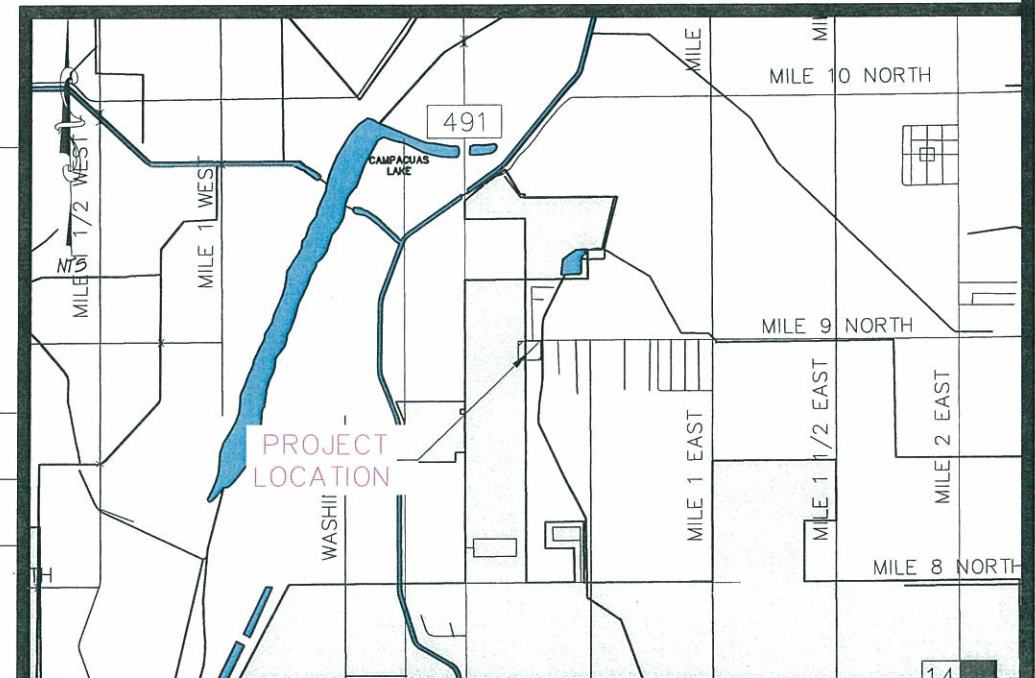

HIDALGO COUNTY PLANNING DEPARTMENT  
 1304 S. 35 TH STREET  
 EDWINGO TX 78539  
 TEL: (956) 318-2840 FAX: (956) 318-2844  
 www.co.hidalgo.tx.us  
 RAUL E. SESIN, P.E., C.F.M.  
 PLANNING ADMINISTRATOR

## HIDALGO COUNTY PRECINCT 1 PROJECT

## CITY OF MERCEDES LIFT STATION PROPOSED LUMINAIRE ASSEMBLY

This seal appearing on this document was authorized by Raul E. Sesin P.E. No. 86374 on the above designated date.

SCALE: 1"=20'  
 DATE: 12-12  
 DRAWN BY: CYNTHIA PEREZ  
 DESIGNED BY: R. SESIN  
 REVISED BY: R. SESIN  
 SURVEYED BY: E. ISIDRO  
 PROJECT FILE:

SHEET:  
 10F1

Drawing: I:\PCT 1\pct 1 solar light ph 2\mercedes lift station\mercedes liftstation plans.dwg Plotted by: cynthia.perez  
 Layout Tab: Layout1 Date: 01/09/2012 Time: 10:52:14 AM

**GENERAL NOTES:**

1. THE CONTRACTOR SHALL INSTALL A FULLY OPERATIONAL SOLAR POWERED LUMINAIRE ASSEMBLY AT PROPOSED LOCATIONS.
2. CONTRACTOR SHALL VERIFY ALL SOLAR MODULES ARE FREE OF ANY OBSTRUCTIONS AND ORIENTATE SOLAR PANELS FOR MAXIMUM SUN EXPOSURE.
3. CONTRACTOR SHALL BE RESPONSIBLE TO CALL DIG TESS 48 HOURS PRIOR TO COMMENCEMENT OF WORK FOR UTILITY SPOTTING @ (1-800-DIG-TESS) AND CONTACT THE HIDALGO COUNTY IRRIGATION DISTRICT AND WATER SUPPLIERS FOR THE PROJECT AREA.
4. CONTRACTOR SHALL STAKE R.O.W. AND OR PROPERTY LINE BY LOCATING PROPERTY PINS ON LOTS ADJACENT TO PROPOSED LUMINAIRE LOCATION.
5. ALL WORK SHALL BE COMPLETED TO THE SATISFACTION OF THE HIDALGO COUNTY PRECINCT NO. 1
6. ANY DAMAGES TO FENCES, WALKS, OR PRIVATE PROPERTY SHALL BE REPAIRED BY THE CONTRACTOR AT HIS EXPENSE.
7. CONTRACTOR TO MAINTAIN ALL EQUIPMENT AND TRANSPORTATION OF SAID EQUIPMENT WITHIN THE EXISTING RIGHT OF WAY OF THE CITY, COUNTY, OR STATE.
8. THE CONTRACTOR SHALL BE RESPONSIBLE TO REPAIR ANY SURFACE IRREGULARITIES, AS DIRECTED BY THE ENGINEER, CAUSED BY THE CONTRACTOR'S WORKING OPERATIONS.
9. THE CONTRACTOR SHALL CLEANUP AND RESTORE THE AREA OF OPERATIONS TO A CONDITION AS GOOD AS OR BETTER THAN THAT WHICH EXISTED PRIOR TO INSTALLATION OF ALL ITEMS TO BE CONSTRUCTED.
10. THE PREPARATION OF THESE PLANS REFLECTS INFORMATION, PROVIDED BY OTHERS, ON THE APPROXIMATE LOCATION AND EXISTENCE OF EXISTING PUBLIC AND PRIVATE UTILITY LINES AND ADJACENT PHYSICAL FEATURES. HOWEVER, THEY DO NOT IMPLY OR AFFIRM THAT ALL UTILITIES OR PHYSICAL FEATURES ARE SHOWN. GENERALLY, UTILITY SERVICE CONNECTIONS ARE NOT INDICATED ON THESE PLANS. CONTRACTOR IS RESPONSIBLE FOR NOTIFICATIONS OF THE OWNER IMMEDIATELY UPON ENCOUNTERING UNFORESEEN CONFLICTS.
11. THE APPROXIMATE LOCATIONS OF KNOWN EXISTING PUBLIC AND PRIVATE UTILITIES ARE SHOWN, CONTRACTOR SHALL DETERMINE THE EXACT HORIZONTAL AND VERTICAL LOCATIONS IN THE FIELD PRIOR TO COMMENCING WORK. CONTRACTOR TO BE FULLY RESPONSIBLE FOR DAMAGES WHICH MIGHT OCCUR BY HIS FAILURE TO EXACTLY LOCATE AND PRESERVE EXISTING UTILITIES.

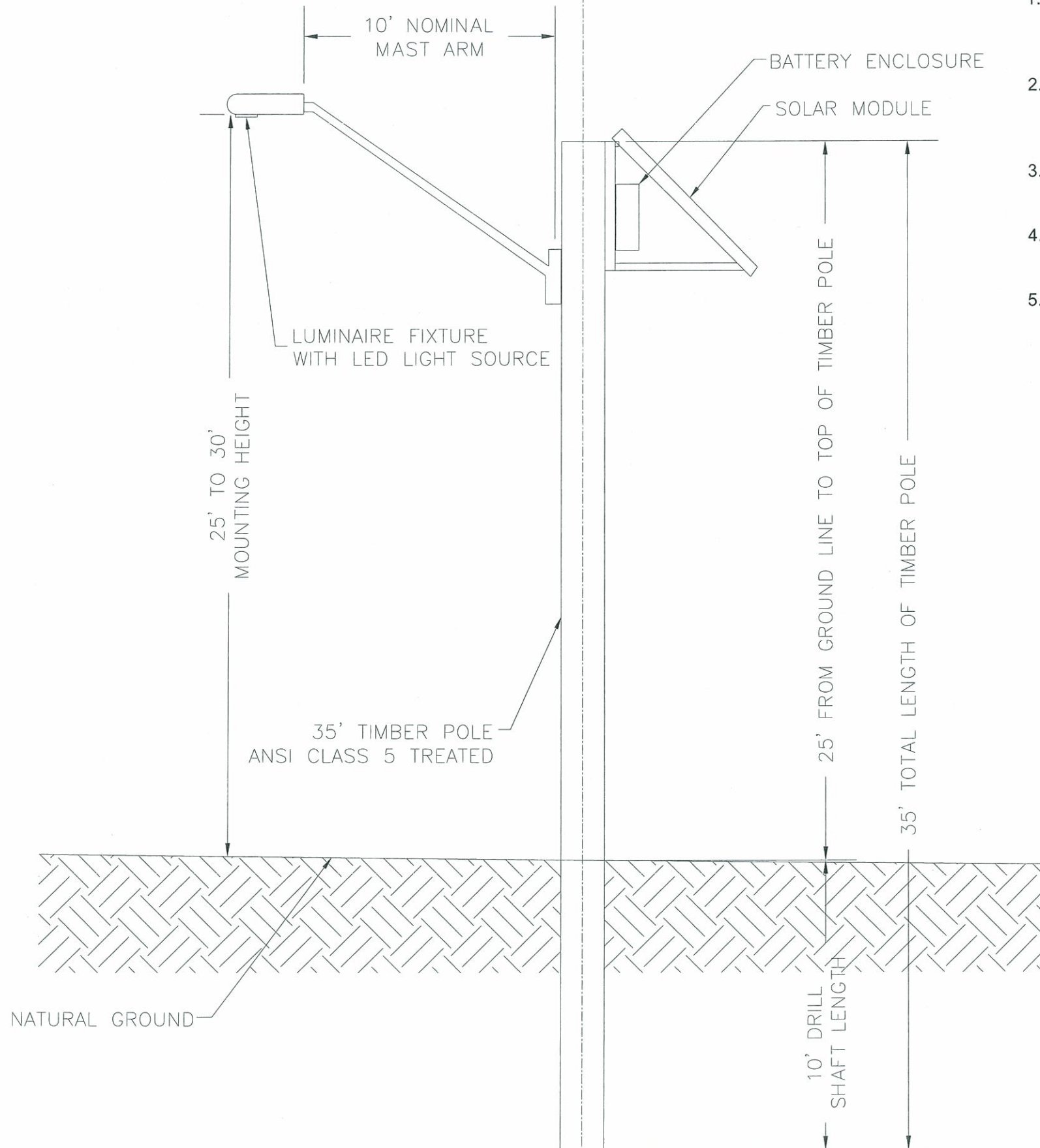

**SEQUENCE OF CONSTRUCTION**

1. CONTRACTOR TO DETERMINE OPTIMUM LOCATION OF LUMINAIRE ASSEMBLIES.
2. ENGINEER TO REVIEW OPTIMUM LOCATION OF LUMINAIRE ASSEMBLIES AND DIRECTION OF LUMINAIRE ARMS.
3. CONTRACTOR TO CALL FOR SPOTTING OF UTILITIES.
4. STAKING OF R.O.W AND OR PROPERTY LINES.
5. INSTALLATION OF LUMINAIRE ASSEMBLIES.

HIDALGO COUNTY  
PLANNING DEPARTMENT  
1304 S. 25 TH. STREET  
EDINBURG TX. 78539  
TEL: (936) 318-2840 FAX: (936) 318-2844  
www.co.hidalgo.tx.us  
RAUL E. SESIN, P.E., C.F.M.  
PLANNING ADMINISTRATOR



**HIDALGO COUNTY  
PRECINCT 1 PROJECT**

**HIDALGO COUNTY PCT 1  
SOLAR LIGHTS PROJECT**  
TYPICAL SOLAR LUMINAIRE ASSEMBLY DETAIL  
AND GENERAL NOTES



This seal appearing on this document was authorized by Raul E. Sesin P.E. No. 86374 on the above designated date.

SCALE: NTS  
DATE: 8-10-11  
DRAWN BY: CYNTHIA PEREZ  
DESIGNED BY: R. SESIN  
REVISED BY: R. SESIN  
SURVEYED BY: E. ISIDRO  
PROJECT FILE:

SHEET:  
1 OF 1

**EXHIBIT "B"**

Hidalgo County Precinct No. 1

**Solar Powered Lights- Phase II (EECBG)**

2012-065-MSS

**PROPOSAL PAGE**

**PROPOSAL Date of request: February 13, 2012**

SAMPLE	Item No.	Estimated Quantity	Unit	Item Description	Unit Bid Price In Words	Unit Price In Figures	Total Extension In Figures
1	20	STA	Preparing ROW		Three Hundred Fifty Dollars Cents	\$300.50	\$6,010.00
<b>PROPOSAL Date of request: February 13, 2012</b>							
Item No.	QTY	Unit	Item Description		Unit Bid Price In Words	Unit Price In Figures	Total Extension In Figures
1	18	EA	To be installed within <u>CITY OF EL SA</u> . Solar Powered Light System including all incidental work and equipment to have the system operational.		LABOR Six thousand six hundred & five Fifty eight Cents MATERIAL One thousand five hundred sixty six Fifty Dollars Cents TOTAL: \$8172. <sup>00</sup>	\$6605. <sup>58</sup> \$1566. <sup>50</sup> \$8172. <sup>08</sup>	\$118,900. <sup>44</sup> \$28,197. <sup>00</sup> \$147,097. <sup>44</sup>
2	12	EA	To be installed within <u>CITY OF EDCOUCH</u> . Solar Powered Light System including all incidental work and equipment to have the system operational.		LABOR Six thousand six hundred & five Fifty eight Cents MATERIAL One thousand five hundred sixty six Fifty Dollars Cents TOTAL: \$8172. <sup>00</sup>	\$6605. <sup>58</sup> \$1566. <sup>50</sup> \$8172. <sup>08</sup>	\$79,266. <sup>96</sup> \$18,798. <sup>00</sup> \$98,064. <sup>96</sup>
3	13	EA	To be installed within <u>CITY OF LA VILLA</u> . Solar Powered Light System including all incidental work and equipment to have the system operational.		LABOR Six thousand six hundred & six Fifty eight Cents MATERIAL One thousand five hundred sixty six Fifty Dollars Cents TOTAL: \$9172. <sup>00</sup>	\$6605. <sup>58</sup> \$1566. <sup>50</sup> \$9172. <sup>08</sup>	\$85,872. <sup>54</sup> \$20,264. <sup>50</sup> \$106,137. <sup>04</sup>

			To be installed within <u>CITY</u> <u>OF MERCED</u> . Solar Powered Light System including all incidental work and equipment to have the system operational.			
4	9	EA		LABOR	Six thousand six hundred \$5.16 Dollars	\$6605. <sup>58</sup>
				MATERIALS	One thousand five hundred sixty six F.C.T.Y Dollars	\$1566. <sup>50</sup>
						\$14,098. <sup>50</sup>
				TOTAL		\$18,172. <sup>08</sup>
						\$73,548. <sup>72</sup>

AS PER CONTRACT No.

PROPOSAL TOTAL COST: \$424,948.<sup>12</sup>

1. PREVAILING WAGE RATES/DAVIS BACON ACT COMPLIANCE	<input checked="" type="checkbox"/>	Insert Check Mark to Acknowledge
2. BUY AMERICAN ACT COMPLIANCE	<input checked="" type="checkbox"/>	

COMPANY NAME: Facility Solutions Group

AUTHORIZED SIGNATURE: *[Signature]*

PRINTED NAME: David Thomas

TITLE: Division Manager

PHONE NUMBER: 361-882-5685

E-MAIL ADDRESS: david.thomas@ESGI.com

## EXHIBIT "C"

### Insurance Requirements

The Bidder awarded the contract shall furnish proof of insurance, which will also include any subcontractor that is subcontracted by the bidder in at least the following limits, to be in place prior to providing any services under this Contract and to continue at all times in force in effect during the term of this Contract:

1. Automobile liability insurance policy with limits of at least Three Hundred Thousand Dollars (\$300,000.00) per person and \$500,000.00 per occurrence, consistent with potential exposure to County under the Texas Tort Claims Act. Coverage should include injury to or death of persons and property damage claims (with limits up to \$500,000.00) arising out of the services provided to County hereunder;
2. Uninsured/Underinsured motorist coverage in an amount equal to the bodily injury limits set forth immediately above;
3. A Five Hundred Thousand Dollar (\$500,000.00) Comprehensive General Liability insurance policy providing additional coverage to all underlying liabilities of County consistent with potential exposure of County under the Texas Tort Claims Act;
4. Workers compensation insurance in amounts established by Texas law, unless the Bidder is specifically exempted from the Texas Workers' Compensation Act, Texas Labor Code Chapter 401, et. seq.

Certificates of insurance naming County as an additional insured shall be submitted to County for approval prior to any services being performed by Contractor. Each policy of insurance required hereunder shall extend for a period equivalent to, or longer than the term of the Contract, and any insurer hereunder shall be required to give at least thirty (30) days written notice to the County prior to the cancellation of any such coverage on the termination date, or otherwise. This Contract shall be automatically suspended upon the cancellation, or other termination, of any required policy of insurance hereunder, and such suspension shall continue until evidence adequate replacement coverage is provided to County. If replacement coverage is not provided within thirty (30) days following suspension of the Contract, this Contract shall automatically terminate.

# Insurance Requirement Acknowledgment

I, David Thomas, authorized representative for Facility Solutions Group,  
Company/Vendor

hereby acknowledge receipt of the County's required insurance limits. Said requirements:

∅ will be acquired within 10 working days after notification from Purchasing Department of bid awarded by the Hidalgo County Commissioners' Court; (\*An insurance certificate for the required insurance limits shall be provided to the Purchasing Department Contracts Manager in order to qualify for award of bid and to execute a contract between our Company and the County.)

∅ will acquire additional amount needed to meet the County's requirements within 10 working days after notification from Purchasing Department of bid awarded by the Hidalgo County Commissioners' Court; currently carry the following:

Automobile Liability: \$ \_\_\_\_\_ General Liability: \$ \_\_\_\_\_

(\*An insurance certificate for the required insurance limits shall be provided to the Purchasing Department Contracts Manager in order to qualify for award of bid and to execute a contract between our Company and the County.) **OR**

∅ have already been met, see attached copy of insurance certificate.

David Thomas  
Authorized Representative

2-13-2012  
Date

**Notice to Bidder:** Failure to provide Certificates of Insurance Purchasing Department Contracts Manager will cause the bid award to be rescinded and then awarded to next lowest bidder. Certificates of Insurance will be monitored/verified on a **quarterly basis** to ensure coverage policy is in place. It is the Company's obligation to maintain the appropriate insurance coverage throughout the term of the contract.

---

**THIS FORM MUST ACCOMPANY BID PACKET**

---



# CERTIFICATE OF LIABILITY INSURANCE

DATE (MM/DD/YYYY)  
2/14/2012

THIS CERTIFICATE IS ISSUED AS A MATTER OF INFORMATION ONLY AND CONFERS NO RIGHTS UPON THE CERTIFICATE HOLDER. THIS CERTIFICATE DOES NOT AFFIRMATIVELY OR NEGATIVELY AMEND, EXTEND OR ALTER THE COVERAGE AFFORDED BY THE POLICIES BELOW. THIS CERTIFICATE OF INSURANCE DOES NOT CONSTITUTE A CONTRACT BETWEEN THE ISSUING INSURER(S), AUTHORIZED REPRESENTATIVE OR PRODUCER, AND THE CERTIFICATE HOLDER.

**IMPORTANT:** If the certificate holder is an ADDITIONAL INSURED, the policy(ies) must be endorsed. If SUBROGATION IS WAIVED, subject to the terms and conditions of the policy, certain policies may require an endorsement. A statement on this certificate does not confer rights to the certificate holder in lieu of such endorsement(s).

<b>PRODUCER</b> Peter Mulcahy Independent Insurance Group 3010 LBJ Freeway Ste. 920 Dallas TX 75234-7004	<b>CONTACT NAME:</b> Diana Allred <b>PHONE (A/C, No, Ext):</b> 972-231-8277 <b>E-MAIL ADDRESS:</b> dianaa@indinsgrp.com	<b>FAX (A/C, No):</b>
	<b>INSURER(S) AFFORDING COVERAGE</b>	
<b>INSURED</b> Facility Solutions Group, Inc. See Named Insureds below 4401 Westgate Blvd, Suite 310 Austin TX 78745-1494	<b>INSURER A:</b> TRAVELERS LLOYDS INS CO	NAIC # 41262
	<b>INSURER B:</b> Travelers Indemnity Company	25658
	<b>INSURER C:</b> Travelers Property Casualty Company	25674
	<b>INSURER D:</b> Underwriters At Lloyds London	15792
	<b>INSURER E:</b> Starr Indemnity & Liab Co	38318
	<b>INSURER F:</b>	

**COVERAGES**

CERTIFICATE NUMBER: 1953507967

REVISION NUMBER:

THIS IS TO CERTIFY THAT THE POLICIES OF INSURANCE LISTED BELOW HAVE BEEN ISSUED TO THE INSURED NAMED ABOVE FOR THE POLICY PERIOD INDICATED. NOTWITHSTANDING ANY REQUIREMENT, TERM OR CONDITION OF ANY CONTRACT OR OTHER DOCUMENT WITH RESPECT TO WHICH THIS CERTIFICATE MAY BE ISSUED OR MAY PERTAIN, THE INSURANCE AFFORDED BY THE POLICIES DESCRIBED HEREIN IS SUBJECT TO ALL THE TERMS, EXCLUSIONS AND CONDITIONS OF SUCH POLICIES. LIMITS SHOWN MAY HAVE BEEN REDUCED BY PAID CLAIMS.

INSR LTR	TYPE OF INSURANCE	ADD'L SUBR INSR   WVD	POLICY NUMBER	POLICY EFF (MM/DD/YYYY)	POLICY EXP (MM/DD/YYYY)	LIMITS	
C	<b>GENERAL LIABILITY</b> <input checked="" type="checkbox"/> COMMERCIAL GENERAL LIABILITY <input type="checkbox"/> CLAIMS-MADE <input checked="" type="checkbox"/> OCCUR <input checked="" type="checkbox"/> Contractual Liab <input checked="" type="checkbox"/> XCU GEN'L AGGREGATE LIMIT APPLIES PER: <input type="checkbox"/> POLICY <input checked="" type="checkbox"/> PRO-JECT <input checked="" type="checkbox"/> LOC		VTC2J-CO-131J8737	10/1/2011	10/1/2012	EACH OCCURRENCE	\$1,000,000
						DAMAGE TO RENTED PREMISES (Ea occurrence)	\$1,000,000
						MED EXP (Any one person)	\$10,000
						PERSONAL & ADV INJURY	\$1,000,000
						GENERAL AGGREGATE	\$2,000,000
						PRODUCTS - COMP/OP AGG	\$2,000,000
							\$
C	<b>AUTOMOBILE LIABILITY</b> <input checked="" type="checkbox"/> ANY AUTO <input type="checkbox"/> ALL OWNED AUTOS <input checked="" type="checkbox"/> HIRED AUTOS <input checked="" type="checkbox"/> Comp/Coll \$1 <input type="checkbox"/> SCHEDULED AUTOS <input checked="" type="checkbox"/> NON-OWNED AUTOS		VTC2J-CAP-131J8749 BAP131J8750 (Phys Dmg)	10/1/2011 10/1/2011	10/1/2012 10/1/2012	COMBINED SINGLE LIMIT (Ea accident)	\$1,000,000
						BODILY INJURY (Per person)	\$
						BODILY INJURY (Per accident)	\$
						PROPERTY DAMAGE (Per accident)	\$
							\$
E	<input checked="" type="checkbox"/> UMBRELLA LIAB <input type="checkbox"/> EXCESS LIAB DED <input checked="" type="checkbox"/> RETENTION \$N/A <input checked="" type="checkbox"/> OCCUR <input type="checkbox"/> CLAIMS-MADE		SISCCCL01603211	10/1/2011	10/1/2012	EACH OCCURRENCE	\$5,000,000
						AGGREGATE	\$5,000,000
						Follows Form	\$
B	<b>WORKERS COMPENSATION AND EMPLOYERS' LIABILITY</b> ANY PROPRIETOR/PARTNER/EXECUTIVE OFFICER/MEMBER EXCLUDED? (Mandatory in NH) If yes, describe under DESCRIPTION OF OPERATIONS below Y/N <input type="checkbox"/> Y <input checked="" type="checkbox"/> N	N/A	VTC2K-UB-8355N839 VTRJ-UB-0923P941 (AZ)	10/1/2011 10/1/2011	10/1/2012 10/1/2012	<input checked="" type="checkbox"/> WC STATU-TORY LIMITS <input type="checkbox"/> OTH-ER	
						E.L. EACH ACCIDENT	\$1,000,000
						E.L. DISEASE - EA EMPLOYEE	\$1,000,000
						E.L. DISEASE - POLICY LIMIT	\$1,000,000
A	Installation Floater Leased/Rented Professional Liab		QT 630 0502P347 QT6300502P347 PFSG00211	10/1/2011 10/1/2011 10/1/2011	10/1/2012 10/1/2012 10/1/2012	Blanket Blanket Occur/Aggre Limits	\$500,000 \$500,000 \$2,000,000

DESCRIPTION OF OPERATIONS / LOCATIONS / VEHICLES (Attach ACORD 101, Additional Remarks Schedule, if more space is required)

Named Scheduled:FSG Electric; FSG Lighting;FSG,INC.;GB Realty Management, LLC;801 Richfield Partnership,LLC;Sign Tech International;Design Electric, Inc.

**CERTIFICATE HOLDER****CANCELLATION**

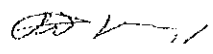
Hidalgo County 2812 S. Highway Business 281 Attn:Purchasing Dept. Edinburg TX 78539	SHOULD ANY OF THE ABOVE DESCRIBED POLICIES BE CANCELLED BEFORE THE EXPIRATION DATE THEREOF, NOTICE WILL BE DELIVERED IN ACCORDANCE WITH THE POLICY PROVISIONS.  AUTHORIZED REPRESENTATIVE 
--	---

© 1988-2010 ACORD CORPORATION. All rights reserved.



# EXHIBIT "D"

## CONFLICT OF INTEREST QUESTIONNAIRE

FORM CIQ

For vendor or other person doing business with local governmental entity

This questionnaire reflects changes made to the law by H.B. 1491, 80th Leg., Regular Session. This questionnaire is being filed in accordance with Chapter 176, Local Government Code by a person who has a business relationship as defined by Section 176.001(1-a) with a local governmental entity and the person meets requirements under Section 176.006(a).

By law this questionnaire must be filed with the records administrator of the local governmental entity not later than the 7th business day after the date the person becomes aware of facts that require the statement to be filed. See Section 176.006, Local Government Code.

A person commits an offense if the person knowingly violates Section 176.006, Local Government Code. An offense under this section is a Class C misdemeanor.

### OFFICE USE ONLY

Date Received

1 Name of person who has a business relationship with local governmental entity.

2  Check this box if you are filing an update to a previously filed questionnaire.

(The law requires that you file an updated completed questionnaire with the appropriate filing authority not later than the 7th business day after the date the originally filed questionnaire becomes incomplete or inaccurate.)

3 Name of local government officer with whom filer has employment or business relationship.

\_\_\_\_\_  
Name of Officer

This section (item 3 including subparts A, B, C & D) must be completed for each officer with whom the filer has an employment or other business relationship as defined by Section 176.001(1-a), Local Government Code. Attach additional pages to this Form CIQ as necessary.

A. Is the local government officer named in this section receiving or likely to receive taxable income, other than investment income, from the filer of the questionnaire?

Yes  No

B. Is the filer of the questionnaire receiving or likely to receive taxable income, other than investment income, from or at the direction of the local government officer named in this section AND the taxable income is not received from the local governmental entity?

Yes  No

C. Is the filer of this questionnaire employed by a corporation or other business entity with respect to which the local government officer serves as an officer or director, or holds an ownership of 10 percent or more?

Yes  No

D. Describe each employment or business relationship with the local government officer named in this section.

4

\_\_\_\_\_  
Signature of person doing business with the governmental entity

\_\_\_\_\_  
Date

N/A



**PROPOSER'S AFFIDAVIT**

**Exhibit "E"**

**PROPOSER'S AFFIDAVIT OF NON-COLLUSION  
NON-CONFLICT OF INTEREST, AND ANTI-LOBBYING  
FOR "TITLE (PROJECT DESCRIPTION)"  
PROJECT NO.:**

STATE OF TEXAS  
COUNTY OF HIDALGO

Affiant, David Thomas, being first duly sworn, deposes that:

(1) Affiant does hereby state neither the Proposer nor any of the Proposer's officers, partners, owners, agents, representatives, employees, or parties in interest, has in any way colluded, conspired, agreed, directly or indirectly with any person, firm, corporation, or other proposer, or potential proposer, to provide any money or other valuable consideration for assistance in procuring or attempting to procure a contract or fix the prices in the attached proposed or the proposal of any other proposer, and further states that no such money or other reward will be hereinafter paid.

(2) Affiant further states they have neither recommended or suggested to Hidalgo County or any of its officials or employees, any of the terms or provisions set forth in their Request for Proposal and subsequent agreement, except at a meeting open to all interested proposers, of which proper notice was given.

(3) Affiant, further states their officers, employees, or agents have not, and will not attempt to lobby, directly or indirectly, the Hidalgo County Commissioner's Court between proposal submission date and award by the Hidalgo County Commissioner's Court.

(4) Affiant further states no officer, or stockholder of the Proposer is a member of the staff, or related to any employee of the Hidalgo County except as noted herein below:

Signature/Title: David Thomas - Division MGR.

Subscribed and sworn to before me this 13<sup>th</sup> day of Feb, 2014.

Notary Public R Rodriguez

My commission expires \_\_\_\_\_, 20\_\_\_\_

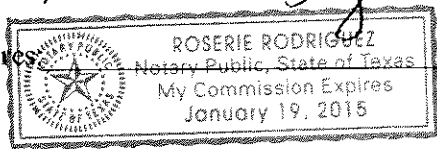



**FSG ELECTRIC APPLICATION FOR CREDIT**

The following information is offered in the interest of obtaining credit with your firm. FSG is a national electrical contractor. We have been incorporated since 1986.

**Our Corporate Office address is:**

FSG Electric  
4401 Westgate Blvd, Suite 310  
Austin, Texas 78745-1494

Phone: 512-440-7985  
Fax: 512-440-0399

**Our Branch Locations: (Where all invoices are to be sent)**

11115 Iota Drive  
San Antonio, Texas 78217

8203A North Lamar  
Austin, Texas 78753

5532 Midway Road, Suite 7  
Ft. Worth, Texas 76117-4640

2525 Walnut Hill, Ste. 100-400  
Dallas, Texas 75220

1045 Entry Drive.  
Bensenville, IL 60106

5115 Steadmont  
Houston, Texas 77040

585 South Padre Island Drive  
Corpus Christi, Texas 78405

9900 Westpoint Dr., 104  
Indianapolis, IN 46258

6435 Vista Drive  
Shawnee, KS 66218

224 Washington Street  
Perth Amboy, NJ 08861

801 Richfield Road  
Placentia, CA 92870

4660 South 33<sup>rd</sup> Street  
Phoenix, AZ 85040

5050 Osage Street, #200  
Denver, CO 80221

7209 Jefferson Street NE  
Albuquerque, NM 87109

10212 Metric Boulevard  
Austin, TX 78758

**Principle:** William D. Graham, President

**The Corporate Bank:**

Wells Fargo Capital Finance  
111 Congress Ave., Suite 2200  
Austin, Texas 78701

**Bank Officer:**

Michael Friesch  
111 Congress Ave., Suite 2200  
Austin, Texas 78701

**Confirmation Department**

Credit Inquiries/Rating/Verifications  
Account # 2000019282574  
512-344-8044 (phone)  
512-344-7318 (fax)

**Trade References:**

Graybar Electric  
Columbia Electric Supply  
Reynolds Company

Frank Slovacek 972-877-5109 (p) 817-213-1373 (f)  
361-888-9101 (p) 361-888-4176 (f)  
214-630-9000 (p) 214-630-4629 (f)

**Federal ID Number:**

74-2942838

**D & B Number:**

06-237-6637

I vouch for the accuracy of the above information and authorize you to contact the references provided above for credit information.

Thank you,

William D. Graham  
President

**FACILITY SOLUTIONS**group



# HIDALGO COUNTY PURCHASING DEPARTMENT Bidder/Vendor Application

Complete in print or type. Please return this application to the Hidalgo County Purchasing Department  
thru Facsimile: (956) 318-2629 or (956) 292-7612  
in person or regular mail to: 2812 S. Business Hwy. 281, Edinburg, Texas 78539  
or e-mail: purchasing@co.hidalgo.tx.us

Company Name: <i>Facility Solutions Group</i>	Telephone No. (361) 882-5685	
dba Name:		
Legal Name: <i>Facility Solutions Group</i>		
Mailing Address: <i>585 S. Padre Island Dr</i>	Fax No. ( )	
Physical Address: <i>VI</i>		
City, State, Zip: <i>Corpus Christi, TX 78405</i>	Tax I.D. No. <i>A/V/2/6/2/1</i>	
Remit to Address: _____ City, State, Zip		
E-Mail Address:		
Representative(s) Name(s) & Title(s)		
Type of Organization (check one): <input type="checkbox"/> Individual <input type="checkbox"/> Partnership <input checked="" type="checkbox"/> Corporation <input type="checkbox"/> Non-Profit <input type="checkbox"/> LLC <input type="checkbox"/> Sole Proprietor <input type="checkbox"/> Other, Specify		
State Identification No. _____ (Please attached completed W-9 form with this application) Federal Identification No. or (if individual) SS No.		
State of Incorporation: <i>TX</i> Date: _____    Other:		
Type of Business (check one): <input type="checkbox"/> Manufacturer <input type="checkbox"/> Wholesaler <input type="checkbox"/> Retailer <input type="checkbox"/> Broker <input type="checkbox"/> Distributor <input type="checkbox"/> Service Organization <input checked="" type="checkbox"/> Other, Specify <i>Electrical Contractor</i>		
Name & Title of Person(s) Authorized to Sign Bids, Proposals, and/or Contracts: <i>DAVID THOMAS, JASON ZIPPRIAN</i>		
<b>Small and/or Disadvantaged Business Information (check application criteria)</b>		
Small Business: _____ Disadvantaged Business (At Least 51% Ownership)		
<input type="checkbox"/> Less than 125,000 annual gross receipt	<input type="checkbox"/> Black American	<input type="checkbox"/> Native American
<input type="checkbox"/> Less than 250,000 annual gross receipt	<input type="checkbox"/> Hispanic American	<input type="checkbox"/> Women
<input type="checkbox"/> Less than 499,000 annual gross receipt	<input type="checkbox"/> Asian Pacific American	<input type="checkbox"/> Other
<input type="checkbox"/> More than 500,000 annual gross receipt		
Have you been certified as a HUB or an MBE/WBE source?: <input type="checkbox"/> Yes <input type="checkbox"/> No		
Indicate Certification No.(s): _____ or are Certificate(s) attached?: <input type="checkbox"/> Yes <input type="checkbox"/> No		
What type of product(s) is/are solicited by your company?: <i>Electrical Contractor</i>		
Would you like to be provided with specifications for procurements of such products?: <input checked="" type="checkbox"/> Yes <input type="checkbox"/> No		
To Be Completed by the County: Rec'd by (Purchasing): _____ Date Rec'd by (Purchasing): _____		
Date Forwarded Information to Auditor's Office: _____ Entry Date: _____ Vendor No.: _____		



## HISTORICALLY UNDERUTILIZED BUSINESS (HUB) DECLARATION

The primary objective of the Hidalgo County HUB Program is to ensure Historically Underutilized Businesses receive a fair and equal opportunity for participation in the County's procurement process. This fact holds true for Services (Professional & Non-Professional), Commodities, and Construction contracts and any subcontracts thereto. The program strongly encourages Prime Contractors to provide subcontracting opportunities to Certified Hub Contractors/Vendors. Our goal for HUB contractor/vendor participation, as well as HUB subcontractor participation is 30%. To be considered as a "Certified HUB Contractor/Vendor" the contractor/vendor must have been certified by, and hold a current and valid certification with any of the three agencies listed below.

Have you been Certified as a HUB or an MBE/WBE source?:  Yes  No

If yes, by whom?:  Texas Building & Procurement Commission  Other \_\_\_\_\_

Indicate Certification No(s): \_\_\_\_\_ or Are Certificate(s) Attached?:  Yes  No

---

### LIST OF CERTIFIED HUB SUBCONTRACTORS

(Attach additional pages if necessary)

What percentage of the Bid, RFP, or RFQ is to be subcontracted with Certified HUB sources?: \_\_\_\_\_ %  
(List HUB Subcontractor information below).

HUB Subcontractor Name: \_\_\_\_\_ HUB Status: \_\_\_\_\_  
Certifying Agency (Check all applicable):  Texas Building & Procurement Commission  Other  
Address: \_\_\_\_\_ City: \_\_\_\_\_ State: \_\_\_\_\_ Zip: \_\_\_\_\_  
Contact Person: \_\_\_\_\_ Title: \_\_\_\_\_ Phone No.: ( ) \_\_\_\_\_  
Subcontract Amount: \$ \_\_\_\_\_ Description of Work to be Performed: \_\_\_\_\_

---

HUB Subcontractor Name: \_\_\_\_\_ HUB Status: \_\_\_\_\_  
Certifying Agency (Check all applicable):  Texas Building & Procurement Commission  Other  
Address: \_\_\_\_\_ City: \_\_\_\_\_ State: \_\_\_\_\_ Zip: \_\_\_\_\_  
Contact Person: \_\_\_\_\_ Title: \_\_\_\_\_ Phone No.: ( ) \_\_\_\_\_  
Subcontract Amount: \$ \_\_\_\_\_ Description of Work to be Performed: \_\_\_\_\_

---

HUB Subcontractor Name: \_\_\_\_\_ HUB Status: \_\_\_\_\_  
Certifying Agency (Check all applicable):  Texas Building & Procurement Commission  Other  
Address: \_\_\_\_\_ City: \_\_\_\_\_ State: \_\_\_\_\_ Zip: \_\_\_\_\_  
Contact Person: \_\_\_\_\_ Title: \_\_\_\_\_ Phone No.: ( ) \_\_\_\_\_  
Subcontract Amount: \$ \_\_\_\_\_ Description of Work to be Performed: \_\_\_\_\_

---