

HIDALGO COUNTY
Professional Engineering Services
Contract # C- 00-000-00-00
Work Authorization Form

WORK AUTHORIZATION NO. 1

THIS WORK AUTHORIZATION is made pursuant to the terms and conditions of Article 1 of the Agreement made by and between HIDALGO COUNTY, action herein by and through the Commissioner's Court, hereinafter called the "Owner," and, L & G Consulting Engineers, Inc. d/b/a L & G Engineering, professional engineers of Mercedes, Texas hereinafter called "Engineer".

PART 1. SCOPE OF WORK

The purpose of this Work Authorization is for the Engineer to provide Engineering Services required for an "Environmental Study" regarding the Precinct No. 3 Old Administration Building, Warehouse and Shop Complex; located at 400 W. 13th Street (Lots 1 thru 9 Blk 212-FMV and Lots 4 thru 9 Blk 205-FMV) project in Mission, Hidalgo County, Texas project for Hidalgo County Precinct No. 3.

The scope of services to be provided by the Owner is identified in *EXHIBIT "A" - Scope of Services to be provided by the Owner* attached hereto.

The scope of services to be provided by the Engineer is identified in *EXHIBIT "B" - Scope of Services to be provided by the Engineer* attached hereto.

PART 2. ESTIMATED COST

The estimated cost for services under this Work Authorization is \$21, 342.67. This amount is based upon the costs outlined in the **Estimated Cost Proposal** attached hereto as *EXHIBIT "D-1" - Fee Schedule*.

PART 3. PAYMENT

Compensation and payment to the Engineer for the services established under this Work Authorization shall be made in accordance with Article 6 of the Agreement.

PART 4. FUNDING

This Work Authorization No. 1 shall be funded through funding source:

Account No. _____

Requisition Number _____ (MUST BE INCLUDED AFTER CC APPROVAL)

PART 5. PERIOD OF SERVICE

This Work Authorization shall become effective on the date of final acceptance of the parties hereto, and terminate upon completion of scopes of the work authorization, as identified on *EXHIBIT "C" - Work Schedule*.

PART 6. RESPONSIBILITIES AND OBLIGATIONS

This Authorization does not waive the parties' responsibilities and obligations provided under the Agreement.

PART 7. ACKNOWLEDGEMENT AND CONFIRMATION

Acknowledgement and confirmation by Hidalgo County Precinct No. 3, Commissioner Joe Flores as to the content and detail of this Work Authorization No. 1.

HIDALGO COUNTY
COMMISSIONER PRECINCT NO. 3

BY: 

PART 8. ACCEPTANCE AND APPROVAL

This Work Authorization is hereby accepted, approved by Hidalgo County Commissioners' Court on April 17, 2012 as indicated below.

THE ENGINEER:
L&G ENGINEERING

By: Jacinto Garza, P.E.
President

THE OWNER:
HIDALGO COUNTY

By: Ramon Garcia,
County Judge

ATTEST:

By: Arturo Guajardo, Jr., County Clerk

LIST OF ATTACHMENTS

- Location Map
- Exhibit A - Services to be provided by Owner
- Exhibit B - Services to be provided by Engineer
- Exhibit C - Work Schedule
- Exhibit D-1 - Fee Schedule

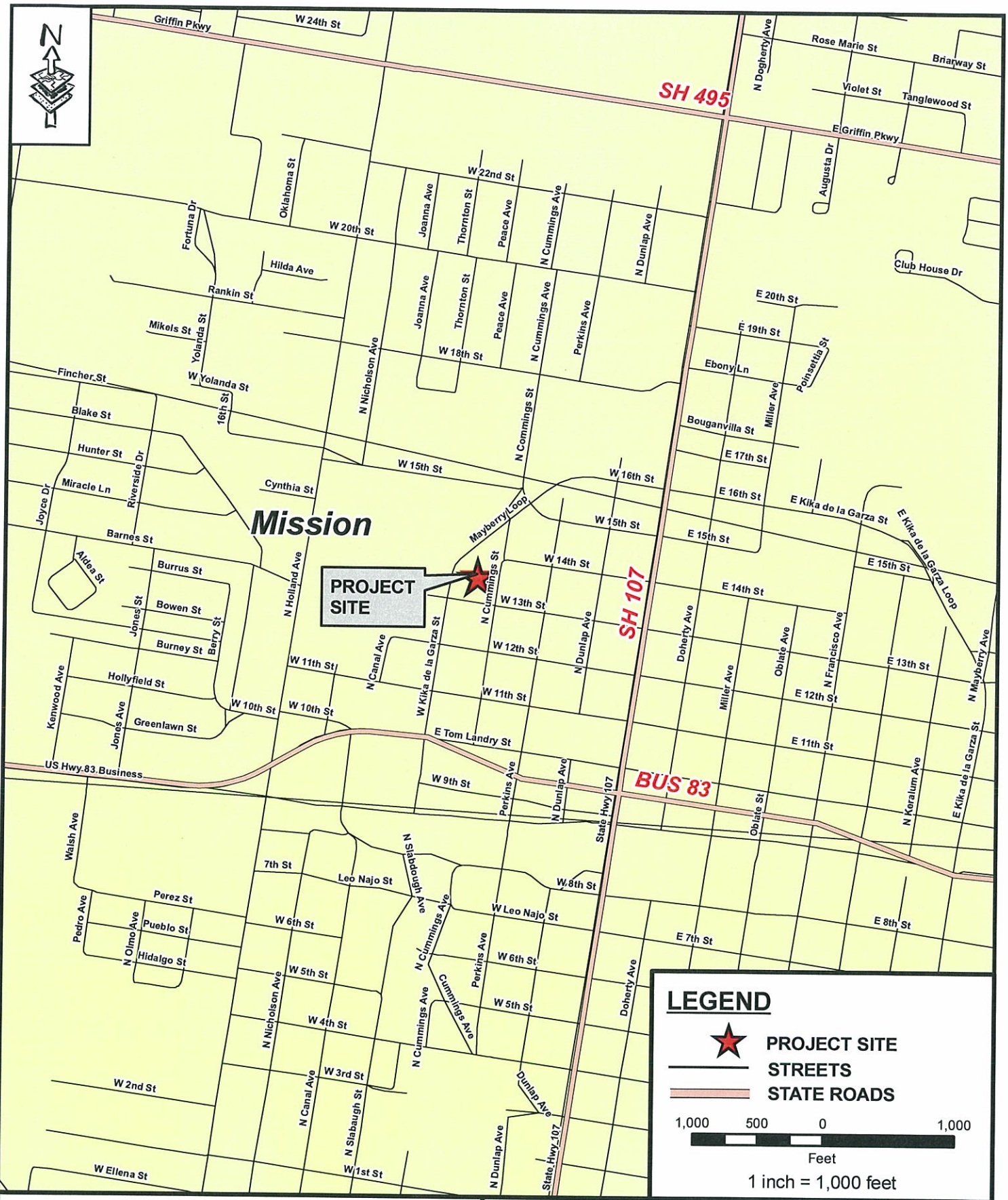

PRECINCT 3 PHASE I LOCATION MAP



L & G Engineering
Transportation Consulting Engineers

EXHIBIT "A"
SERVICES TO BE PROVIDED BY THE OWNER

1. The County will issue work authorization to initiate all required services and designate the authorized representative of the coordination of each work authorization.
2. The County will provide the Engineer with on-going guidance, timely reviews, and decisions necessary to complete services required by the work authorization in order to permit the Engineer to maintain an agreed upon project schedule.
3. The County will process all acceptable requests for payment in a timely manner.

EXHIBIT “B”

SERVICES TO BE PROVIDED BY THE ENGINEER

The work to be furnished by the **Engineer** under this work authorization is to provide **Phase I / Limited Phase II Environmental Site Assessment (ESA) for a property and related structures located at 400 W. 13th Street (Lots 1 thru 9 Blk 212-FMV and Lots 4 thru 9 Blk 205-FMV) in Mission, Hidalgo County, Texas known as the Project.** This report will include the tasks listed in detail below.

The **Engineer** shall furnish all equipment, materials, supplies, and incidentals as needed to perform the services required by this Work Authorization, except as otherwise specified to be provided by the **Owner**.

The **Engineer** will develop/submit a work schedule (as required in ARTICLE 2.3 of the Agreement) that identifies milestone activities and/or deliverables, and that is conformable to the schedule outlined in **EXHIBIT “C”**.

The **Engineer** shall provide the following services required for **the Project**. The Engineer shall maintain a direct line of communication and coordinate very closely with Hidalgo County Precinct 3 on this project.

Specific activities to be performed by the **Engineer** include the following:

SCOPE OF WORK

L&G’s approach for performing the Phase I / Limited Phase II ESA consists of four tasks: first, a review of the public record and an examination of the history of the property; second, an on-site investigation of the property; third sampling and analysis of any possible Asbestos Containing Materials (ACM) and or Chemicals of Concern; and fourth, preparation of a final report summarizing the findings and recommendations of the assessment. The main focus of this site assessment will be to determine if there are any chemical constituents or hazardous materials on the property L&G will use the American Society for Testing and Materials (ASTM) Publication E 1527-00 as technical guidance for the ESA.

Task 1.0 Compilation and Review of Public Records

This task serves to identify evidence in the public record of activities that may have resulted or could result in contamination or deposition of hazardous materials on the site. Activities to be conducted by L&G include:

- Performance of a detailed visual reconnaissance of every section of the site and adjacent properties to observe any signs that may indicate environmental concerns on the site.
- Compilation and review of pertinent public records (e.g., Texas Commission on Environmental Quality, U.S. Environmental Protection Agency, Texas Railroad Commission) regarding past, present and pending enforcement actions and/or investigations at the site and on the adjoining sites.

Task 2.0 Site Reconnaissance

A site reconnaissance will be performed to inspect for evidence of past and/or current presence of hazardous materials on the site and adjoining sites. In addition, L&G will evaluate any factors in the review of the public record that might be indicative of activities that resulted in hazardous materials being used or deposited on the site or that could result in contamination of the site. The site reconnaissance will include:

- Performance of a detailed visual reconnaissance of every section of the site and adjacent property to observe any signs which may indicate the presence of contaminants on the property and contaminant pathways to the property.
- Photographic documentation of all indicative features.

Task 3.0 Asbestos Survey

A site reconnaissance will be performed to inspect for evidence Asbestos Containing Materials (ACM) by a Texas Department of State Health Services (TDSHS) licensed asbestos consultant. The samples will be subjected to asbestos analysis by the EPA interim method for the Determination of Asbestos in Bulk Insulation, EPA-600-R-93/116. The interim method identifies asbestos by Polarized Light Microscopy (PLM) and has a lower quantification limit of one (1) percent by weight. A macroscopic visual estimation by area under a stereoscope was used to quantify the ACM.

The findings of the asbestos survey and any related recommendations pertaining to the demolition of the structures on the subject property will be included in the final report. All abatement activities are required to be performed in accordance with Texas Department of State Health Services (TDSHS) regulations.

In addition, L&G will to collect a total of six (6) soil samples from from 3 borings located on the subject properties. The borings will be completed at a depth of approximately 20 feet below ground surface. The samples will be collected from surface and subsurface soils using a truck mounted conventional auger and a stainless steel split spoon sampler. Field personnel performing the soil sample collection activity will use latex gloves to extract a representative soil sample. Samples will be immediately placed into laboratory-supplied pre-cleaned jars (32-ounce) and preserved on ice. Chain-of-custody forms and delivery protocols will be observed to preserve sample integrity.

The collected samples will be tested for total petroleum hydrocarbons (TPH); benzene, toluene, ethylbenzene, xylenes (BTEX); methyl tertiary butyl ether (MTBE); pesticides (organochlorine); and herbicides (chlorinated). If elevated TPH levels are found, then the sample with the highest TPH will also be tested for polynuclear aromatic hydrocarbons (PAH), if necessary.

Task 4.0 Report Preparation

Upon completion of the above tasks, L&G will provide you with a written report documenting the Phase I / Limited Phase II findings and recommendations. Unless directed otherwise, you will be the only recipient of our report, and no copies will be distributed without your prior approval.

Deliverables:

- 1) A Phase I / Limited Phase II Environmental Site Assessment Report**

PROPOSAL

May 07, 2012

TO: Anthony Garza,
C/o L & G Engineering
2100 West Expressway 83
Mercedes, Texas 78570
Ph: 956.565.9813
agarza@engineers.com

SUBJECT: Asbestos Inspections

PROJECT: Three Commercial Buildings

LOCATION: 400 West 13th Street Lots 1-9 Blk. 212, FMV, 4-9 205, FMV
Mission, Texas 78574

Mr. Garza,

We are pleased to have this opportunity to work with you on the environmental issues concerning the above-mentioned Commercial Buildings.

ACI Environmental Consultants is prepared to provide the professional services necessary to conduct the Limited Asbestos Inspection (Survey) and Report of the above-referenced Buildings. To prepare proper assessments and make recommendations in accordance with the Scope of Professional Services included in this proposal.

The following proposal describes the work to be done, the Scope of Professional Services to be provided, and the cost for the Professional Services.

Scope of Professional Services:

A team of professional Texas Licensed Asbestos Inspectors or Consultants will conduct the Inspection of the area of the building, samplings, testing, analyzing, quantifying and report. All work will be in accordance with the Asbestos Hazard Emergency Response Act (AHERA) 40 CFR 763, SUBPART E-ASBESTOS CONTAINING MATERIALS IN SCHOOLS (AMENDED), Texas Asbestos Health Protection Rules (TAHPR) dated March 2003 and EPA 40 CFR 61.145 Standard for Demolition, Renovation and The Environmental Protection Agency (EPA) National Emission Standards for Hazardous Air Pollutants (NESHAP).

This will be accomplished by conducting field investigations consisting of visual and physical inspection for evidence of suspect Asbestos Containing Building Materials (ACBM). The survey will include sampling and testing of suspected ACBM and analysis by Polarized-Light Microscopy (PLM).

Suspect Asbestos Containing Building Materials will be sampled and tested; however, this proposal does not include sampling and analysis of other hazardous substances or surfaces, which may be contaminated by substances other than asbestos fibers.

The physical inspections describing the condition(s) of the Suspect ACBM will be verified using the inspection information and the test results. Any confirmed ACBM will be assessed and quantified by a Texas Licensed Asbestos Consultant and a written Survey Report will be furnished upon completion.

Cost of Professional Services;

We propose to perform these professional services described above for a fee of \$ **1,850.00**. This price is the total for the Asbestos Professional Services at the above referenced School Camp and includes all site visits, sampling, analysis and final report. The work will be accelerated and the report will be delivered to you within five (5) business days of our receiving of your written acceptance of this proposal, payment and provided our access to the subject structures is not unreasonably limited.

Terms:

Due upon Acceptance-----\$ 1,850.00

Payable to: John Cook
ACI Environmental Consultants
602 West Van Buren Avenue
Harlingen, Texas 78550

If, after review of this material, you find this proposal acceptable, please return one (1) copy of this letter with original signature to provide the authorization (via email) for our firm to begin work of the services described.

Sincerely,



Eustolio (J.R.) Arevalo, Jr.
rgvaci.jr@gmail.com
For ACI Environmental Consultants

Acceptance of Proposal and Authorization to Proceed

Signature

Date

EXHIBIT "C"
WORK SCHEDULE

PROPOSED SCHEDULE

L&G Engineering proposes the schedule presented below for the Old Administration Building and Shop Complex located at 400 W. 13th Street in Mission, Texas Project:

L&G is prepared to initiate this project immediately upon authorization to proceed. We anticipate being able to complete the Phase I /Limited Phase II ESA report within 3-4 weeks of written authorization. If difficulties arise, we will inform the County at the earliest possible time and obtain your concurrence on extending the evaluation period or continuing without the benefit of the information in question.

EXHIBIT D-1
PROJECT FEE SCHEDULE AND
ESTIMATED MANHOUR BREAKDOWN

ENVIRONMENTAL STUDY - 400 W 13TH STREET

	MANHOURS						TOTAL LINE ITEM COST
	GIS Analyst	Senior Environmental Scientist /Specialist	Environmental Scientist /Specialist	Admin / Clerical	TOTAL HOURS	Sub-Contract Amounts	
CONTRACT RATE							
	75.45	129.77	75.45	54.32			
WORK AUTHORIZATION NO. 1							
PHASE II/LIMITED PHASE II ENVIRONMENTAL SITE ASSESSMENT							
1 Task 1.0 Compilation and Review of Public Records	6	2	24	1	33		\$ 2,577.36
2 Task 2.0 Site Reconnaissance	6	2	24	1	33		\$ 2,577.36
3 Task 3.0 Asbestos Survey	6	2	1		3		\$ 334.99
4 Task 4.0 Report Preparation	6	2	24	1	33		\$ 2,577.36
5 Project/Contract Management		24		16	40		\$ 3,983.60
6 L&G Laboratory (Drilling)					0	\$ 2,250.00	\$ -
7 ACI Environmental Consultants (Asbestos testing) <i>(TDSHS Licensed Asbestos Consultant)</i>						\$ 1,850.00	
8 Ambiotec Environmental (soil testing)					0	\$ 4,812.00	\$ -
SUB-TOTAL	18	32	73	19	142	\$ 8,912.00	\$ 12,050.67
Subtotal Manhour Fee with Sub-Consultant Costs						\$	20,962.67

Geosearch (Property Info Search)	\$ 300.00
Sanborn Maps	\$ 80.00
Subtotal Direct Expenses	\$ 380.00

Total Project Fee: \$ 21,342.67