

**SUBDIVISION PLAT OF:
LOMA VERDE SUBDIVISION No. 2**

A 31.62 ACRE TRACT OF LAND OUT OF SHARE 1 OUT OF SHARE "E", LAS MESTENAS GRANT, HIDALGO COUNTY, TEXAS, ACCORDING TO THE MAP OR PLAT THEREOF RECORDED IN VOLUME 4, PAGE 48, MAP RECORDS, HIDALGO COUNTY, TEXAS, AND ACCORDING TO WARRANTY DEED RECORDED UNDER COUNTY CLERK'S DOCUMENT NUMBER 1, OFFICIAL RECORDS, HIDALGO COUNTY, TEXAS.

METES AND BOUNDS
A 31.62 ACRE TRACT OF LAND OUT OF SHARE 1 OUT OF SHARE "E", LAS MESTENAS GRANT, HIDALGO COUNTY, TEXAS, ACCORDING TO THE MAP OR PLAT THEREOF RECORDED IN VOLUME 4, PAGE 48, MAP RECORDS, HIDALGO COUNTY, TEXAS, AND ACCORDING TO WARRANTY DEED RECORDED UNDER COUNTY CLERK'S DOCUMENT NUMBER 1, OFFICIAL RECORDS, HIDALGO COUNTY, TEXAS, MORE PARTICULARLY DESCRIBED BY METES AND BOUNDS AS FOLLOWS:

BEGINNING AT A 1/2" IRON ROD WITH CAP STAMPED WELDEN & HUNT, INC. FOUND ON THE SOUTH LINE OF SHARE 1, THE SOUTH LINE OF SHARE "E" AND THE NORTH RIGHT OF WAY LINE OF MILE 22 1/2 NORTH ROAD FOR THE SOUTH-EAST CORNER OF THE BAK INVESTMENTS, LTD. TRACT, A DISTANCE OF 858.48 FEET TO A 1/2" IRON ROD WITH CAP STAMPED WELDEN & HUNT, INC. FOUND ON THE SOUTH LINE OF SHARE 1, THE SOUTH LINE OF SHARE "E" AND THE NORTH RIGHT OF WAY LINE OF MILE 22 1/2 NORTH ROAD FOR THE SOUTH-EAST CORNER OF SAID TRACT AND THE NORTHWEST CORNER OF THIS TRACT.

THENCE S 78°17' E, ALONG THE NORTH LINE OF SHARE 1, A DISTANCE OF 1,586.05 FEET TO A 1/2" IRON ROD WITH CAP STAMPED WELDEN & HUNT, INC. FOUND ON THE NORTHWEST CORNER OF THE LONGHORN CATTLE INC. TRACT (THE EAST 100 ACRES OF SHARE 1 OUT OF SHARE "E", LAS MESTENAS GRANT, ACCORDING TO WARRANTY DEED WITH VENDOR'S LIES RECORDED UNDER COUNTY CLERK'S DOCUMENT NUMBER 1659172, OFFICIAL RECORDS, HIDALGO COUNTY, TEXAS) AND THE NORTHEAST CORNER OF THIS TRACT.

THENCE S 09°35'47" W, ALONG THE WEST LINE OF THE LONGHORN CATTLE INC. TRACT, A DISTANCE OF 858.48 FEET TO A 1/2" IRON ROD WITH CAP STAMPED WELDEN & HUNT, INC. FOUND ON THE SOUTH LINE OF SHARE 1, THE SOUTH LINE OF SHARE "E" AND ON THE NORTH RIGHT OF WAY LINE OF MILE 22 1/2 NORTH ROAD FOR THE SOUTH-EAST CORNER OF SAID TRACT AND THE SOUTH-EAST CORNER OF THIS TRACT.

THENCE N 78°17' W, ALONG THE SOUTH LINE OF SHARE 1, THE SOUTH LINE OF SHARE "E", AND THE NORTH RIGHT OF WAY LINE OF MILE 22 1/2 NORTH ROAD, A DISTANCE OF 1,586.05 FEET TO THE POINT OF BEGINNING AND CONTAINING 31.62 ACRES OF LAND MORE OR LESS.

BEARINGS ARE IN ACCORDANCE WITH SUBDIVISION OF SHARE "E", LAS MESTENAS GRANT, RECORDED IN VOLUME 4, PAGE 48, MAP RECORDS, HIDALGO COUNTY, TEXAS.

STATE OF TEXAS
COUNTY OF HIDALGO

I, THE UNDERSIGNED, A REGISTERED PROFESSIONAL LAND SURVEYOR IN THE STATE OF TEXAS, DO HEREBY CERTIFY THAT THIS PLAT IS A TRUE AND CORRECT REPRESENTATION OF AN ACTUAL SURVEY OF THE PROPERTY DONE ON THE GROUND UNDER MY SUPERVISION.



Alfonso Quintanilla
ALFONSO QUINTANILLA
R.P.L.S. No. 4165

4-10-2012
DATE

STATE OF TEXAS
COUNTY OF HIDALGO
OWNER'S DEDICATION, CERTIFICATION, AND ATTESTATION

I, KYLE RUPPERT, MANAGER OF HI STARR INVESTMENTS, L.L.C. AS OWNER OF THE 31.62 ACRE TRACT OF LAND ENCOMPASSED WITHIN THE PROPOSED LOMA VERDE SUBDIVISION No. 2, HEREBY SUBDIVIDE THE LAND AS DEPICTED IN THIS SUBDIVISION PLAT AND DEDICATE TO PUBLIC USE THE STREET, PARK, AND EASEMENTS SHOWN HEREIN.

I CERTIFY THAT I HAVE COMPLIED WITH THE REQUIREMENTS OF TEXAS LOCAL GOVERNMENT CODE § 232.032 AND THAT:

- THE WATER QUALITY AND CONNECTIONS TO THE LOTS MEET, OR WILL MEET, THE MINIMUM STATE STANDARDS;
- SEWER CONNECTIONS TO THE LOTS OR SEPTIC TANKS MEET, OR WILL MEET, THE MINIMUM REQUIREMENTS OF STATE STANDARDS;
- ELECTRICAL CONNECTIONS PROVIDED TO THE LOTS MEET, OR WILL MEET, THE MINIMUM STATE STANDARDS;
- GAS CONNECTIONS, IF AVAILABLE, PROVIDED TO THE LOTS MEET, OR WILL MEET, THE MINIMUM STATE STANDARDS.

I ATTEST THAT THE MATTERS ASSERTED IN THIS PLAT ARE TRUE AND COMPLETE.

HI STARR INVESTMENTS, L.L.C.
KYLE RUPPERT, MANAGER
P.O. BOX 959
EDINBURG, TEXAS 78540

STATE OF TEXAS
COUNTY OF HIDALGO

BEFORE ME, the undersigned authority, on this day personally appeared KYLE RUPPERT, MANAGER OF HI STARR INVESTMENTS, L.L.C., known to me to be the person whose name is subscribed to the foregoing instrument, and acknowledged to me that he executed the same for purposes and considerations therein stated.

Given under my hand and seal of office this _____ day of _____, 20____.

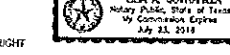

LILIA A. QUINTANILLA - NOTARY PUBLIC

HIDALGO COUNTY
CERTIFICATE OF PLAT APPROVAL
UNDER LOCAL GOVERNMENT CODE § 232.028(a)

WE THE UNDERSIGNED CERTIFY THAT THIS PLAT OF THE LOMA VERDE SUBDIVISION No. 2, WAS REVIEWED AND APPROVED BY THE HIDALGO COUNTY COMMISSIONERS COURT ON _____

Hidalgo County Judge _____ Date _____
Hidalgo County Clerk _____ Date _____

HIDALGO COUNTY
CERTIFICATE OF PLAT APPROVAL

I, THE UNDERSIGNED, CERTIFY THAT THIS PLAT OF LOMA VERDE SUBDIVISION No. 2 WAS REVIEWED AND APPROVED BY THE HIDALGO COUNTY RIGHT OF WAY DEPARTMENT ON _____

HIDALGO COUNTY RIGHT OF WAY DIRECTOR _____ DATE _____

HIDALGO COUNTY
CERTIFICATE OF PLAT APPROVAL

I, THE UNDERSIGNED, CERTIFY THAT THIS PLAT OF LOMA VERDE SUBDIVISION No. 2 WAS REVIEWED AND APPROVED BY THE HIDALGO COUNTY HEALTH DEPARTMENT ON _____

ENVIRONMENTAL HEALTH DIVISION MANAGER _____ DATE _____

NOTE:
HIDALGO COUNTY DRAINAGE DISTRICT NO. 1 HEREBY CERTIFIES THAT THE DRAINAGE PLANS FOR THIS SUBDIVISION COMPLY WITH THE MINIMUM STANDARDS OF THE DISTRICT ADOPTED UNDER TEXAS CODE NO. 49.211(c). THE DISTRICT HAS NOT REVIEWED AND DOES NOT CERTIFY THAT THE DRAINAGE STRUCTURES DESCRIBED ARE APPROPRIATE FOR THE SPECIFIC SUBDIVISION, BASED ON GENERALLY ACCEPTED ENGINEERING CRITERIA. IT IS THE RESPONSIBILITY OF THE DEVELOPER OF THE SUBDIVISION AND ITS ENGINEER TO MAKE THESE DETERMINATIONS.

STATE OF TEXAS
COUNTY OF HIDALGO

I, THE UNDERSIGNED, A LICENSED PROFESSIONAL ENGINEER IN THE STATE OF TEXAS, DO HEREBY CERTIFY THAT THE PROPER ENGINEERING CONSIDERATIONS HAVE BEEN GIVEN TO THIS PLAT.

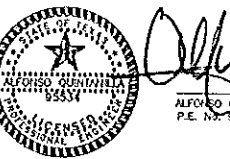

Alfonso Quintanilla
ALFONSO QUINTANILLA
P.E. No. 55574
6-5-12
DATE

HI STARR INVESTMENTS, L.L.C.
KYLE RUPPERT, MANAGER
P.O. BOX 959
EDINBURG, TEXAS 78540

INDEX TO SHEETS

- SHEET 1. - HEADING INDEX, LOCATION MAP AND E.T. - PRINCIPAL CONTACTS, MAP, LOT, STREETS, AND EASEMENT LAYOUT; DESCRIPTION (METES AND BOUNDS); ENGINEER'S & SURVEYOR'S CERTIFICATION; PLAT NOTES AND RESTRICTIONS; OWNER'S ACKNOWLEDGMENT; H.A.W.S.C. CERTIFICATE; HIDALGO COUNTY R.O.W. AND HEALTH DEPT. CERTIFICATE; COUNTY CLERK'S RECORDING CERTIFICATE; H.C.D.O. No. 1 CERTIFICATION; REVISION NOTES.
- SHEET 2. - MAP OF WATER DISTRIBUTION SYSTEM, MAP OF TOPOGRAPHY AND DRAINAGE AND ENGINEER'S CERTIFICATION, COUNTY CLERK'S RECORDING CERTIFICATE.
- SHEET 3. - DRAINAGE REPORT INCLUDING DESCRIPTION OF DRAINAGE AND DRAINAGE SALES, ENGINEERING REPORT, INCLUDING DESCRIPTION OF WATER AND OSSF SYSTEM, AND ENGINEERING CERTIFICATION; REVISION NOTES; COUNTY CLERK'S RECORDING CERTIFICATE.

PLAT NOTES AND RESTRICTIONS:

- FLOOD ZONE STATEMENT:
FLOOD ZONE DESIGNATION: ZONE "X"
AREAS DETERMINED TO BE OUTSIDE 500 YEAR FLOODPLAIN.
COMMUNITY-FAMILY NUMBER 460334 0350 C
MAP REVISED: MAY 17, 2001 LOVA
- MINIMUM BUILDING SETBACK LINES:
FRONT: 50.00 FEET ALONG VALDEZ ROAD (MILE 22 1/2 NORTH)
REAR: 35.00 FEET OR EASEMENT, WHICHEVER IS GREATER
SIDE: 5.00 FEET OR EASEMENT, WHICHEVER IS GREATER

GENERAL NOTE FOR SINGLE FAMILY RESIDENCES: NO MORE THAN ONE-SINGLE FAMILY DETACHED DWELLING SHALL BE LOCATED ON EACH LOT. THIS MUST BE STIPULATED ON ALL DEEDS AND CONTRACTS FOR DEEDS (ANY OTHER USE SHALL REQUIRE PLANNING DEPARTMENT, HEALTH DEPARTMENT AND FIRE MARSHAL APPROVAL). APPLICATIONS FOR CONSTRUCTION ARE REQUIRED PRIOR TO OCCUPANCY.

- MINIMUM FINISH FLOOR NOTE:
MINIMUM FINISH FLOOR ELEVATION SHALL BE 18" ABOVE TOP OF CENTERLINE OF STREET OR 18" ABOVE NATURAL GROUND, WHICHEVER IS GREATER. ELEVATION CERTIFICATE MAY BE REQUIRED FOR LOTS LOCATED OUTSIDE DESIGNATED FLOOD ZONE AT THE TIME FOR APPLICATION FOR CONSTRUCTION TO VERIFY PRE AND POST CONSTRUCTION FINISH FLOOR ELEVATIONS. AN ELEVATION CERTIFICATE SHALL BE REQUIRED FOR ALL LOTS WITHIN A DESIGNATED FLOOD ZONE AT THE TIME FOR A DEVELOPMENT PERMIT APPLICATION.
- BENCHMARK NOTE:
THE FOLLOWING BENCHMARK IS IDENTIFIED ON THE FACE OF THE PLAT AND ON THE ATTACHED ENGINEERING PLANS:
B.M. No. 1 ELEVATION = 71.48 FND 1/2" IRON ROD WITH CAP STAMPED WELDEN & HUNT LOCATED ON THE SOUTHEAST CORNER OF THE SUBDIVISION, HWD 88 DATUM.
- DRAINAGE:
IN ACCORDANCE WITH THE HIDALGO COUNTY DRAINAGE DISTRICT NO. 1 AND HIDALGO COUNTY REQUIREMENTS, THIS DEVELOPMENT WILL BE REQUIRED TO DETAIN A TOTAL OF 74,428.30 FT³ (1.71 ACRE FEET) OF STORM WATER RUNOFF. DRAINAGE RETENTION IN ACCORDANCE WITH THE LOCAL REQUIREMENTS WILL BE ACCOMPLISHED AS FOLLOWS: SEE DRAINAGE REPORT ON SHEET No. 3.
- DRAINAGE SWALE EASEMENTS NOTE:
NO FILL OR FERMANT STRUCTURES SHALL BE ALLOWED WITHIN ANY DRAINAGE SWALE EASEMENT. EACH DRAINAGE SWALE EASEMENT SHALL BE KEPT CLEAR OF FENCES, BUILDINGS, PLANTINGS, AND OTHER OBSTRUCTIONS THAT WOULD INTERFERE WITH THE OPERATION OF THE DRAINAGE SWALE EASEMENT. THE LOT OWNER SHALL BE RESPONSIBLE FOR THE MAINTENANCE OF THE SWALE.
- LEGEND - DENOTES 1/2" IRON ROD SET WITH PLASTIC CAP STAMPED R.P.L.S. 4858, UNLESS OTHERWISE NOTED.
- EACH PURCHASED CONTRACT MADE BETWEEN A SUBDIVIDER AND PURCHASER OF A LOT IN THIS SUBDIVISION SHALL CONTAIN A STATEMENT DESCRIBING HOW AND WHEN WATER, SEWER, ELECTRICITY AND GAS SERVICES WILL BE MADE AVAILABLE TO THE SUBDIVISION.
- ALL PUBLIC UTILITIES EASEMENTS DEDICATED BY THIS PLAT SHALL BE A MINIMUM WIDTH OF 15.00 FEET AS PER THE HIDALGO COUNTY MODEL SUBDIVISION RULES. BY SIGNING THIS PLAT DEVELOPER AND ENGINEER CERTIFY THAT ALL OTHER EASEMENTS SHOWN COMPLY WITH THE SIZE REQUIRED BY EACH UTILITY PROVIDER OCCUPYING AN EASEMENT.
- NO STRUCTURE SHALL BE PERMITTED OVER ANY EASEMENT. EASEMENTS SHALL BE KEPT CLEAR OF FENCES, BUILDINGS, SHEDS, SHRUBS TREES, AND OTHER PLANTINGS (EXCEPT LOW, LESS THAN 18 INCHES MATURE HEIGHT, GROUND COVER, GRASS, OR FLOWERS) AND OTHER OBSTRUCTIONS THAT WOULD INTERFERE WITH THE OPERATIONS AND MAINTENANCE OF THE EASEMENT.

ON-SITE SEWAGE FACILITIES (OSSF) NOTE:

- THIS SUBDIVISION SHALL USE ON-SITE SEWAGE FACILITIES IN ACCORDANCE WITH TCEQ AND HIDALGO COUNTY REGULATIONS FOR SEWAGE DISPOSAL. THE SUBDIVIDER IS RESPONSIBLE FOR PROVIDING AN OSSF ON ALL LOTS.
- OSSF SYSTEM IS BEING DESIGNED FOR DISPOSAL OF DOMESTIC SEWAGE ONLY. A SEPARATE DESIGN SHALL BE SUBMITTED FOR COMMERCIAL USE.
 - EACH LOT ON THIS PLAT COUPLES WITH THE MINIMUM 21,700 SQUARE FEET LOT AREA WITH POTABLE WATER SUPPLY.
 - OSSF SYSTEM SHALL REQUIRE INSPECTION AND APPROVAL BY HIDALGO COUNTY AUTHORIZED DEPARTMENT.
 - SOL ANALYSIS HAS BEEN SUBMITTED TO THE AUTHORIZED HIDALGO COUNTY DEPARTMENT AND EXCEPTS MAY BE ALSO SEEN ON THE UTILITY LAYOUT FOR THIS SUBDIVISION AS SUBMITTED TO THE HIDALGO COUNTY PLANNING DEPARTMENT. THE SOL EVALUATOR HAS DETERMINED THAT THE SOIL IS SUITABLE FOR A STANDARD SEPTIC TANK AND ABSORPTIVE DRAINAGE SYSTEM.
 - APPROVED "OSSF" PERMIT APPLICATION IS REQUIRED INCLUDING INDIVIDUAL LOT PLANNING MATERIALS PRIOR TO OCCUPANCY A LOT.

ALL LOTS IN LOMA VERDE SUBDIVISION No. 2 ARE HEREBY GRANTED A "DRAINAGE SWALE EASEMENT" WITH RESPECT TO SURFACE WATER RUN-OFF FROM ALL LOTS IN LOMA VERDE SUBDIVISION No. 2 TO THE AREA DEPICTED ON THE SUBDIVISION PLAT AS THE "DRAINAGE SWALE" AREAS. LOT OWNERS OF LOMA VERDE SUBDIVISION No. 2 THEIR ASSIGNS AND ANY SUBSEQUENT OWNER OF THE REAL PROPERTY DESIGNATED ON THE SUBDIVISION PLAT ARE RESPONSIBLE FOR THE MAINTENANCE OF THE DRAINAGE SALES. THE COUNTY OF HIDALGO, TEXAS (COUNTY), AND THE HIDALGO COUNTY DRAINAGE DISTRICT NUMBER 1 ("DRAINAGE DISTRICT") MAY ENFORCE THIS PLAT NOTE BY INUNCTION OR ANY OTHER REMEDY PROVIDED BY LAW, AND THE COUNTY AND / OR THE DRAINAGE DISTRICT ARE ALSO ENTITLED TO RECOVER ALL ENFORCEMENT COSTS AND / OR MAINTENANCE COSTS FROM THE LOT OWNERS IN VIOLATION. IN THE EVENT THE DRAINAGE SALES DEPICTED ON THE SUBDIVISION PLAT ARE NO LONGER NECESSARY FOR DRAINAGE OF THE LOTS COMPOSING LOMA VERDE SUBDIVISION No. 2 BECAUSE OF AN ALTERNATE DRAINAGE SYSTEM, CONSTRUCTED AND MAINTAINED BY A POLITICAL SUBDIVISION IN ACCORDANCE WITH ALL APPLICABLE STATE AND LOCAL LAWS AND REGULATIONS, THE COUNTY AND ACTUALLY SERVES ALL THE LOTS IN LOMA VERDE SUBDIVISION No. 2, THE COUNTY AND DRAINAGE DISTRICT ARE HEREBY GRANTED THE RIGHT AND THE AUTHORITY (AND EACH LOT OWNER, BY THE ACCEPTANCE OF A DEED TO LOT IN LOMA VERDE SUBDIVISION No. 2 ACKNOWLEDGES AND AGREES THAT THE COUNTY AND THE DRAINAGE DISTRICT HAS THE RIGHT AND AUTHORITY) TO RELEASE THE DRAINAGE EASEMENT BURENING THE DRAINAGE SALES PURSUANT TO THIS PLAT NOTE, BY AND INSTRUMENT IN WRITING RECORDED IN THE OFFICIAL RECORDS, HIDALGO COUNTY, TEXAS.

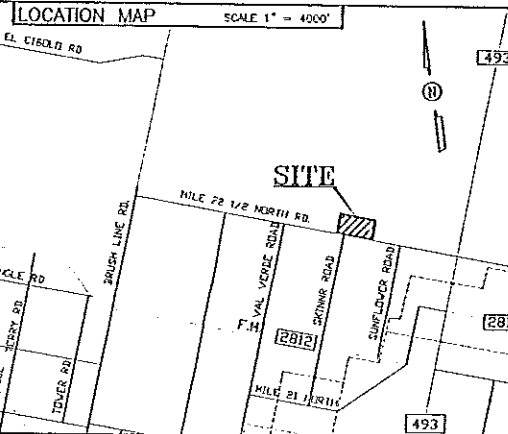

LOCATION OF SUBDIVISION WITH RESPECT TO THE EXTRATERRITORIAL JURISDICTION OF A MUNICIPALITY:
LOMA VERDE SUBDIVISION No. 2, IS LOCATED IN THE EAST HIDALGO COUNTY ON THE NORTH SIDE OF MILE 22 1/2 NORTH ROAD AND 4165 FEET WEST OF F.M. 493 ROAD. THE ONLY HEAVY MUNICIPALITY IS THE CITY OF EDINBURG ACCORDING TO THE OFFICIAL MAP IN THE OFFICE OF THE SECRETARY OF THE CITY OF EDINBURG (POPULATION 77,100) LOMA VERDE SUBDIVISION No. 2, LIES APPROXIMATELY 4.5 MILE FROM THE CITY LIMITS AND IT IS NOT WITHIN THE CITY'S TWO-MILE EXTRA TERRITORIAL JURISDICTION (ETJ) UNDER LOCAL GOVERNMENT CODE § 42.021 AND IT IS NOT WITHIN THE CITY'S FIVE-MILE EXTRA TERRITORIAL JURISDICTION (ETJ) UNDER LOCAL GOVERNMENT CODE § 212.001 AND LIES IN PRECINCT No. 4.

PRINCIPAL CONTACTS:

Name	Address	City & Zip	Phone	Fax
OWNER: HI STARR INVESTMENTS, L.L.C. KYLE RUPPERT, MANAGER	P.O. BOX 959	EDINBURG, TX, 78540	(956)383-0858	(956)383-2101
ENGINEER: ALFONSO QUINTANILLA	124 E. STUBBS	EDINBURG, TX 78539	(956)381-6480	(956)381-0527
SURVEYOR: ALFONSO QUINTANILLA	124 E. STUBBS	EDINBURG, TX 78539	(956)381-6480	(956)381-0527

REVISION NOTES

No.	REVISION	DATE	APPROVED

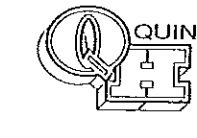

QUINTANILLA, HEADLEY AND ASSOCIATES, INC.
CONSULTING ENGINEERS LAND SURVEYORS
124 E. STUBBS ST. PHONE 956-381-6480
EDINBURG, TEXAS 78539 FAX 956-381-0527
REGISTRATION NUMBER F-1513 OFFICE@QHAENGINEERING.COM

DATE OF PREPARATION: 4-2-12

SHEET NO. 1 OF 3 SHEETS

PREPARED BY	CHECKED BY	APPROVED BY
DATE	REVISED BY	DATE