

I, TOM W. STOVALL, A REGISTERED PUBLIC LAND SURVEYOR, DO HEREBY CERTIFY THE FOREGOING TO BE A TRUE AND CORRECT REPRESENTATION OF THE LAND HEREON DESCRIBED AS PLATTED BY ME FROM SURVEY OF THE OUTSIDE BOUNDARIES OF SAME.

*Tom W. Stovall*  
TOM W. STOVALL 71151  
REGISTERED PUBLIC LAND SURVEYOR  
WESTLACO, TEXAS



STATE OF TEXAS:  
COUNTY OF HIDALGO:

KNOW ALL MEN BY THESE PRESENTS: THAT WE, WILSON R. SCHMIDT AND WIFE, DOROTHY S. SCHMIDT, OWNERS OF THE PROPERTY HEREON DESCRIBED, DO HEREBY ADOPT, DEDICATE AND CONFIRM THE FOREGOING PLAT OF "ASH COUNTRY SUBDIVISION", AND DO HEREBY DEDICATE TO THE PUBLIC THE SURFACE USE OF THE STREETS, ALLEYS AND EASEMENTS THEREON SHOWN.

*Wilson R. Schmidt*  
WILSON R. SCHMIDT, OWNER  
*Dorothy S. Schmidt*  
DOROTHY S. SCHMIDT, OWNER

FILED FOR RECORD THIS DATE  
APR 11 1979  
of *11:20* at *Westlaco, TX*

STATE OF TEXAS:  
COUNTY OF HIDALGO:

BEFORE ME, THE UNDERSIGNED AUTHORITY, ON THIS DAY PERSONALLY APPEARED WILSON R. SCHMIDT, OWNER AND DOROTHY S. SCHMIDT, OWNER, K'OF T. & "O" BE "A PERSONS WHOSE NAMES ARE SUBSCRIBED TO THE FOREGOING INSTRUMENT AND ACKNOWLEDGED THAT THEY EXECUTED THE SAME FOR THE PURPOSES AND CONSIDERATIONS THEREIN EXPRESSED. GIVEN UNDER MY HAND AND SEAL OF OFFICE ON THIS THE 12 DAY OF MARCH A.D., 1979.

*David E. Casanova*  
DAVID E. CASANOVA  
NOTARY PUBLIC IN AND FOR  
HIDALGO COUNTY, TEXAS

APR 2 1979



Submitted to Book 21 page 4  
of the map records of Hidalgo  
County, Texas  
Charles L. Madden  
County Surveyor

THIS PLAT APPROVED BY THE COMMISSIONERS COURT OF HIDALGO COUNTY, TEXAS ON THIS THE \_\_\_\_\_ DAY OF \_\_\_\_\_ A.D., 1979.

ATTEST:

COUNTY CLERK \_\_\_\_\_

APPROVED FOR RECORDING  
BY  
COMMISSIONERS' COURT  
TH. W. *Shongler* 1979  
BANTON SALBANA, County Clerk  
Hidalgo County, Texas  
By: *Shongler*

12631

# LA MILPA SUBDIVISION

LA MILPA SUBDIVISION, BEING A RE-SUBDIVISION OF THE SOUTH 805.7 FEET OF THE EAST 108.0 FEET OF THE WEST 378.0 FEET OF THE WEST 17.12 ACRES OF DOT 14, BLOCK 28, CAPISALLO DISTRICT SUBDIVISION, HIDALGO COUNTY, TEXAS

FILED FOR RECORD THIS DATE

At 1:00 o'clock P.M.

APR 7 1982

SANTOS SALDAMA  
County Clerk, Hidalgo County, Texas

State of Texas,  
County of Hidalgo;

KNOW ALL MEN BY THESE PRESENTS, THAT WE ANTONIO ELIZONDO AND LUCIA ELIZONDO OWNERS OF THE LAND SHOWN ON THIS PLAT, HEREBY APPROVE ACCEPT AND ADOPT THE ACCOMPANYING MAP OF SAID SUBDIVISION.

Antonio Elizondo  
ANTONIO ELIZONDO  
Lucia Elizondo  
LUCIA ELIZONDO

State of Texas,  
County of Hidalgo;

BEFORE ME THE UNDERSIGNED AUTHORITY, ON THIS DAY PERSONALLY APPEARED ANTONIO ELIZONDO AND LUCIA ELIZONDO KNOWN TO ME TO BE THE PERSONS WHOSE NAMES ARE SET FORTH IN THE FORGOING INSTRUMENT, AND ACKNOWLEDGED TO ME THAT THEY EXECUTED SAID INSTRUMENT FOR THE PURPOSES AND CONSIDERATIONS THEREIN STATED.

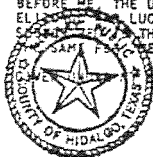

WITNESS MY HAND AND SEAL OF OFFICE THIS 7th DAY OF March 1982.

Leslie Woodruff Blumka  
NOTARY PUBLIC IN AND FOR  
HIDALGO COUNTY, TEXAS.

Leslie Woodruff Blumka  
Notary Public, Hidalgo County, Texas  
My Commission Expires the 30th Day of April 1984

State of Texas,  
County of Hidalgo;

I, ELOY YEPA, REGISTERED PROFESSIONAL ENGINEER AND REGISTERED PUBLIC SURVEYOR IN THE STATE OF TEXAS HEREBY CERTIFY THAT THIS PLAT IS TRUE AND CORRECT AND WAS PREPARED FROM INFORMATION SUPPLIED TO ME BY THE OWNERS.

WITNESS MY HAND AND SEAL THIS 7th DAY OF March 1982.



Eloy Yepa  
ELOY YEPA, P.E.  
REGISTERED PUBLIC SURVEYOR

Leslie Woodruff Blumka  
NOTARY PUBLIC, HIDALGO CO., TEXAS  
Leslie Woodruff Blumka  
Notary Public, Hidalgo County, Texas  
My Commission Expires the 30th Day of April 1984

APPROVAL BY WATER DISTRICT:

THIS PLAT APPROVED BY HIDALGO COUNTY WATER IMPROVEMENT DISTRICT NO. \_\_\_\_\_ ON THIS \_\_\_\_\_ DAY OF \_\_\_\_\_ A.D. 19\_\_\_\_.

PRESIDENT \_\_\_\_\_

SECRETARY \_\_\_\_\_

APPROVE IN OPEN COUNTY COMMISSIONERS COURT THIS 16th DAY OF March A.D. 1982

FILED FOR RECORD THIS \_\_\_\_\_ DAY OF \_\_\_\_\_ A.D. 19\_\_\_\_.

Therese Lou Alsbury, Deputy  
COUNTY CLERK  
HIDALGO COUNTY, TEXAS

APPROVED FOR RECORDING

BY  
COMMISSIONERS' COURT  
This the 16th day of March 1982  
SANTOS SALDAMA, County Clerk  
Hidalgo County, Texas

By Therese Lou Alsbury, Deputy

APPROVED  
FOR RECORDING  
Hidalgo Co. Right of Way Dept.  
By Donald Walker  
Date March 16 1982

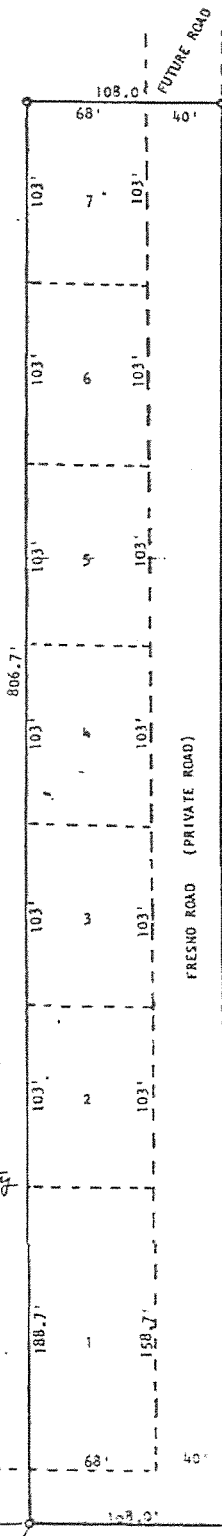

22 Page 89  
to the records of Hidalgo  
County, Texas  
Melden and Hunt, Inc.  
County Surveyors



SCALE: 1" = 50ft.

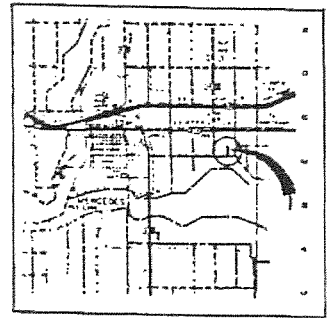

LOCATION MAP  
SCALE: 1" = 2 miles

S.W. CORNER OF LOT # 14  
30'  
60'  
270'

MILE 6 N.



