

COUNTY OF HIDALGO, TEXAS  
PERMIT FOR GEOTECHNICAL ENGINEERING STUDY  
ON COUNTY PUBLIC RIGHT-OF-WAY

This will acknowledge the request of Roba Kistner Consultants, Inc for permission and authorization to conduct Geotechnical Engineering work through the use of "vertical boring" activities and said applicant is here granted to enter upon right-of-ways for the purpose of making such "vertical boring" along the following public roads, to wit:

See Attached Map

Condition that said applicant will comply to the following requirements:

- (1.) That you will provide adequate protection for traveling public with flagmen when necessary.
- (2.) That you will no lay any lines or cables across the pavement.
- (3.) All "vertical boring" on public road right-of-ways shall be confined to the shoulders and borrow pit areas of the roadway and if the roadway being used is a paved or macadamized roadway, then such "vertical boring" will be repaired by permittee.
- (4.) That no "vertical boring" shall be done within one hundred fifty feet (150') of a drainage structure or one hundred feet (100') of an irrigation structure.
- (5.) That no shrubs, trees, or any road facility will be disturbed or removed.
- (6.) No work shall be done while road shoulders, back slope or ditches are wet or soft from recent rains.
- (7.) If any of the right-of-way on which said "vertical boring" is to be done, is within or adjacent to any irrigation district or if you contemplate doing any such "vertical boring" work in any part of said district outside of such right of ways within said irrigation district, first consult with and reach an agreement with the manager of such irrigation district concerning exploratory work with reference to the irrigation and drainage structures and facilities of said irrigation district.
- (8.) Any damage to any public road facilities will be repaired by County's road and highway maintenance and construction crews and you will be billed for any such expense incurred in connection therewith.
- (9.) It is expressly understood and agreed that no representative is made that the County of Hidalgo, Texas is the owner in fee of the public road right of way in question and under consideration; that no representation is made by said County that it has the right to grant and give permission for "vertical boring" exploratory activities, and that permission and granting of request shall not be and become effective until formal permission had been obtained, by written letter or otherwise, from that landowner or owners upon that land which the aforementioned public road traverses and crosses. It is expressly understood and agreed that this permit does not grant permission to make underground or vertical boring surveys of any property in this vicinity, but the applicant shall

fully satisfy itself of the right to enter upon said land for the aforementioned purpose so far as the fee owner or owners thereof are concerned and the County of Hidalgo, Texas shall be applicant, held applicant from any damages or injuries occasioned by the acts of applicant as a result of applicant drilling, blasting or conducting other activities in connection with its proposed vertical boring work and applicant assumes full responsibility and liability for any damages or injuries arising or occasioned there from.

This permit is good for a 60-day period from date approved by Commissioners Court.

Witness our hands this the 18<sup>th</sup> day of March, 2014.

\_\_\_\_\_  
County Judge

\_\_\_\_\_  
Commissioner, Precinct No.1

\_\_\_\_\_  
Commissioner, Precinct No.2

\_\_\_\_\_  
Commissioner, Precinct No.3

\_\_\_\_\_  
Commissioner, Precinct No.4

Katrin Leonard Of Permittee, Raba Kistner Consultants, Inc.

In the aforementioned permit, does hereby accept the granting of same upon the terms, conditions and agreements, covenants and obligations as set forth therein, and agrees that same shall be fully binding upon the Permittee, its successors and assigns.

WITNESS my hand this the 7<sup>th</sup> day of March, 2014.

  
BY: Katrin Leonard, P.E.

Project No. AMA14-018-00  
March 7, 2014

Mr. Joe M. Flores, Commissioner  
Hidalgo County Precinct No. 3  
724 North Breyfogle  
Mission, Texas 78574

Raba Kistner  
Consultants, Inc.  
800 E. Hackberry  
McAllen, TX 78501  
www.rkci.com

P 956 :: 682 :: 5332  
F 956 :: 682 :: 5487  
TBPE Firm F-3257

**RE: Hidalgo County Precinct No. 3 Permit Request Letter  
Boring Locations – Along Various County Roads  
Hidalgo County, Texas**

Dear Commissioner Flores:

Raba Kistner Consultants, Inc. (RKCI) kindly requests permission to access the right-of-way of various county roads as shown on the attached exhibit (Boring Location Map), located within the jurisdiction of the Hidalgo County Precinct No. 3 and 4. As a subconsultant to Halff Associates, Inc. (our client), RKCI has been awarded the Geotechnical Engineering Study for the proposed Sprague Sewer Economically Distressed Areas Program (EDAP) Project. It is our understanding that, depending on the underground utility locations, nineteen of the proposed borings may be located within the right-of-way of Hidalgo County Precinct No. 3. Attached to this letter, you will find Boring Location Map showing the aerial map view of the existing roadways and the proposed boring locations within Precinct Nos. 3 and 4.

Upon completion of drilling operations, borings will be backfilled with generated auger cuttings. The upper six inches of the borings conducted within the existing pavement areas will be patched with cold-mix asphalt and will extend to the existing asphalt-paved surface level. Weather permitting, the field work will take about two to three weeks to complete from its start date.

Should you have any questions, please do not hesitate to contact us.

Very truly yours,

**RABA KISTNER CONSULTANTS, INC.**



Saul Cruz  
Graduate Engineer



Katrin M. Leonard, P.E.  
Associate



SC/KML

Attachment – Boring Location Map  
Copies Submitted: Above (1)

**BORING LOCATION MAP**  
**RKCI Project No. AMA14-018-00**  
**March 7, 2014**

**Precinct No. 3**

**Precinct No. 4**

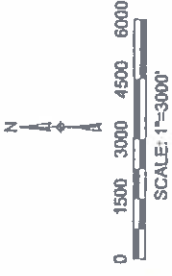

**LEGEND:**

- MPU SERVICE AREA (Yellow outline)
- COMMUNITY NUMBER (Numbered box)
- LATERALS (Blue line)
- INTERCEPTOR (Red line)

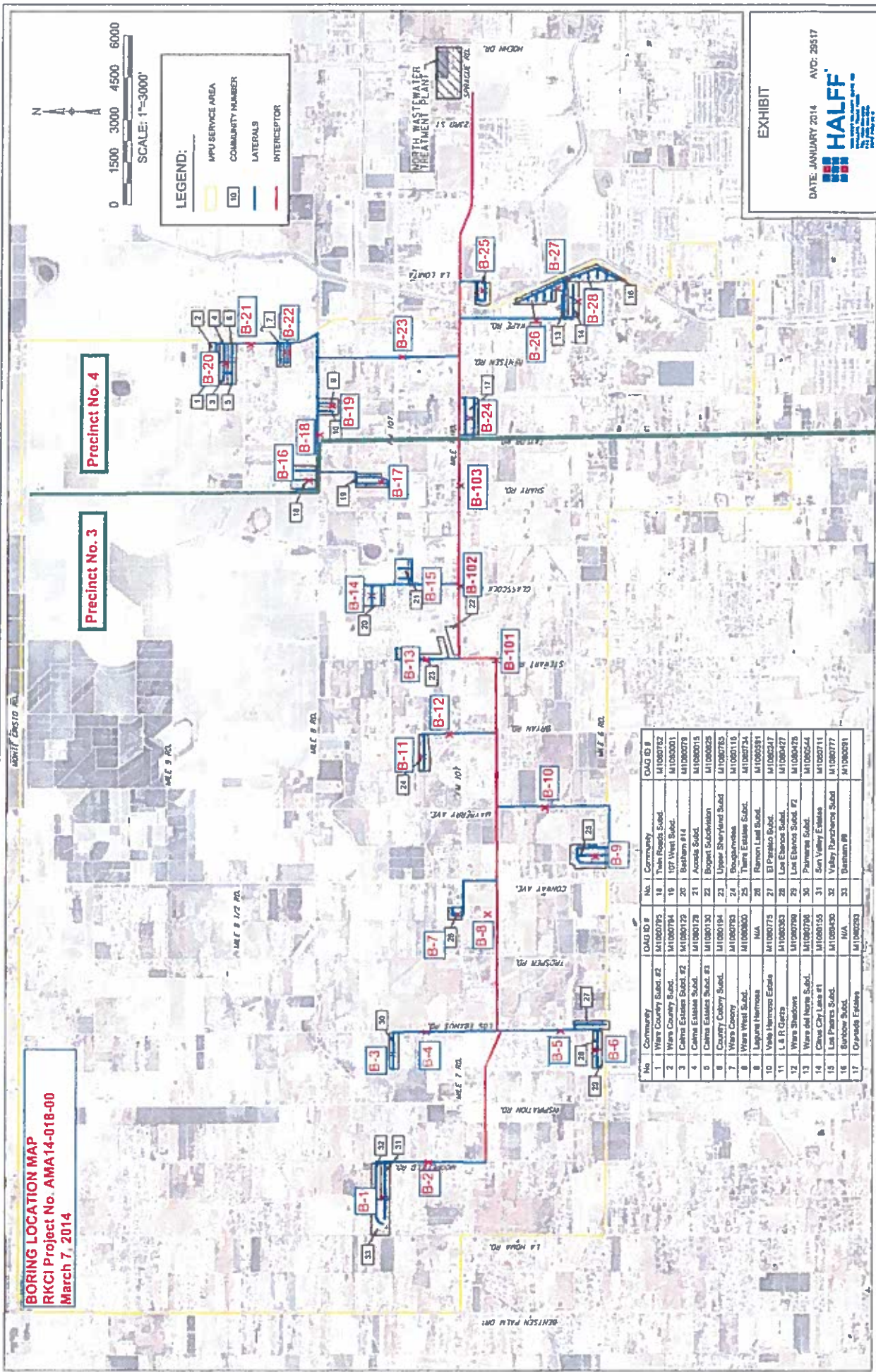

No	Community	DAQ ID #	No.	Community	DAQ ID #
1	Wine Country Subd. #2	M1000785	18	Trin Road Subd.	M1000782
2	Wine Country Subd.	M1000784	19	107 West Subd.	M1000001
3	Catalina Estates Subd. #2	M1000120	20	Basham #1A	M1000078
4	Catalina Estates Subd.	M1000120	21	Acacia Subd.	M1000015
5	Catalina Estates Subd. #3	M1000130	22	Poppen Subdivision	M1000028
6	Country Colony Subd.	M1000194	23	Upper Sherylard Subd.	M1000783
7	Wine Country	M1000783	24	Douganmas	M1000116
8	Wine West Subd.	M1000800	25	Terra Estates Subd.	M1000734
9	Laguna Harbors	N/A	26	Ramon Leaf Subd.	M1000091
10	Vine Harbors Estate	M1000775	27	El Paisano Subd.	M1000247
11	L & R Quartz	M1000303	28	Los Encinos Subd.	M1000427
12	Wine Shadows	M1000789	29	Los Encinos Subd. #2	M1000428
13	Wine del Norte Subd.	M1000789	30	Palmeria Subd.	M1000544
14	Clara Chy Lake #1	M1000155	31	Sun Valley Estates	M1000711
15	Los Peñas Subd.	M1000430	32	Valley Ranchers Subd.	M1000777
16	Shelby Subd.	16A	33	Blenheim #B	M1000591
17	Orlando Estates	M1000253			

**EXHIBIT**

DATE: JANUARY 2014 AYC: 25517

Project No. AMA14-018-00  
March 7, 2014

Mr. Joseph Palacios, Commissioner  
Hidalgo County Precinct No. 4  
1051 North Doolittle Road  
Edinburg, Texas 78539

Raba Kistner  
Consultants, Inc.  
800 E. Hackberry  
McAllen, TX 78501  
www.rkci.com

P 956 :: 682 :: 5332  
F 956 :: 682 :: 5487  
TBPE Firm F-3257

**RE: Hidalgo County Precinct No. 4 Permit Request Letter  
Boring Locations – Along Various County Roads  
Hidalgo County, Texas**

Dear Commissioner Palacios:

Raba Kistner Consultants, Inc. (RKCI) kindly requests permission to access the right-of-way of various county roads as shown on the attached exhibit (Boring Location Map), located within the jurisdiction of the Hidalgo County Precinct No. 3 and 4. As a subconsultant to Halff Associates, Inc. (our client), RKCI has been awarded the Geotechnical Engineering Study for the proposed Sprague Sewer Economically Distressed Areas Program (EDAP) Project. It is our understanding that, depending on the underground utility locations, twelve of the proposed borings may be located within the right-of-way of Hidalgo County Precinct No. 4. Attached to this letter, you will find Boring Location Map showing the aerial map view of the existing roadways and the proposed boring locations within Precinct Nos. 3 and 4.

Upon completion of drilling operations, borings will be backfilled with generated auger cuttings. The upper six inches of the borings conducted within the existing pavement areas will be patched with cold-mix asphalt and will extend to the existing asphalt-paved surface level. Weather permitting, the field work will take about three to four weeks to complete from its start date.

Should you have any questions, please do not hesitate to contact us.

Very truly yours,

**RABA KISTNER CONSULTANTS, INC.**

  
Saul Cruz  
Graduate Engineer

  
Katrin M. Leonard, P.E.  
Associate



March 7, 2014

SC/KML

Attachment – Boring Location Map  
Copies Submitted: Above (1)

**BORING LOCATION MAP**  
**RKCI Project No. AMA14-018-00**  
**March 7, 2014**

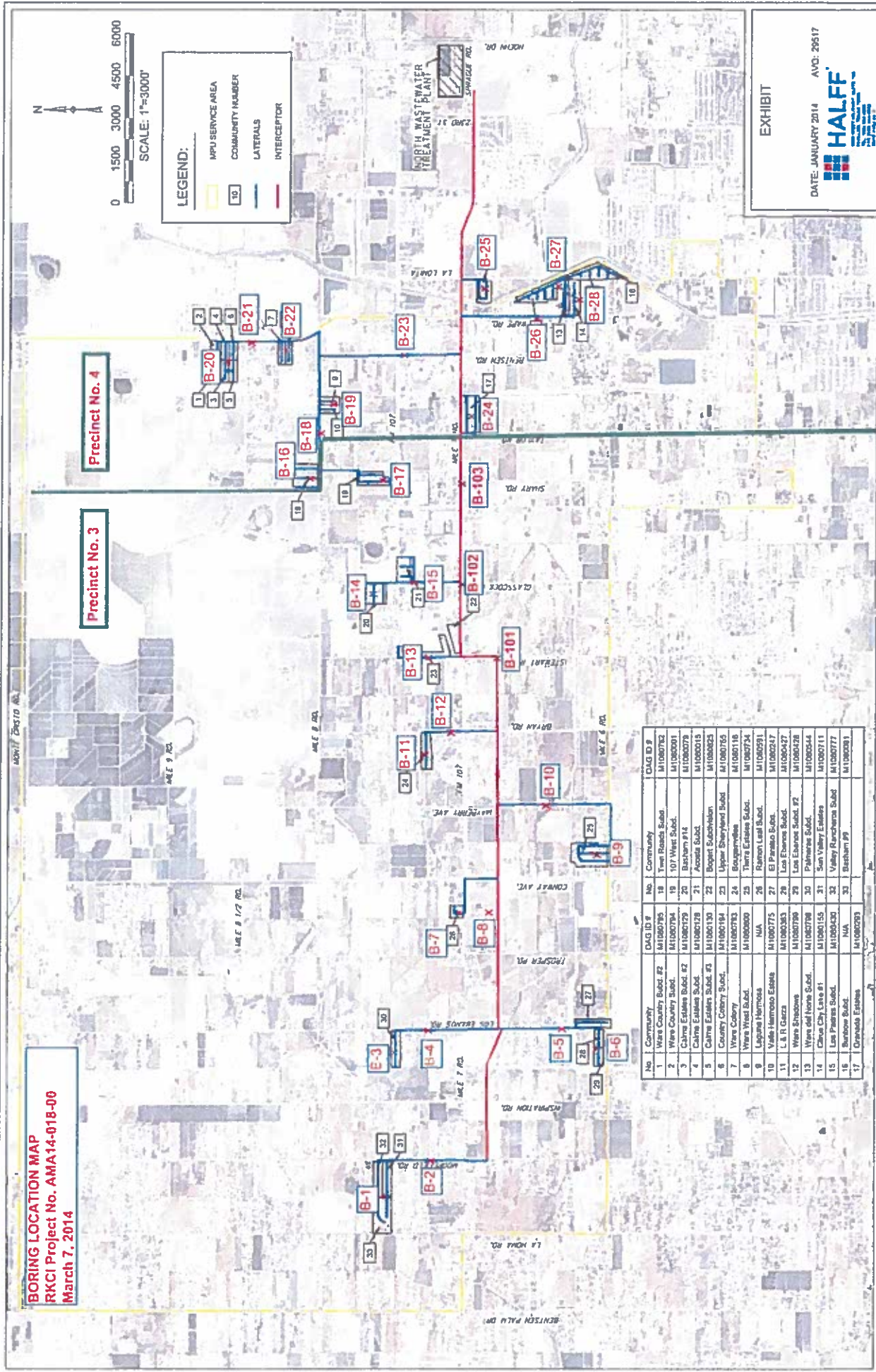

**LEGEND:**

- APU SERVICE AREA
- COMMUNITY NUMBER
- LATERALS
- INTERCEPTOR



EXHIBIT

DATE: JANUARY 2014 AVO: 29517

No	Community	DAG ID #	No	Community	DAG ID #
1	Ware Country Subd. #2	M1080795	18	Town Roads Subd.	M1080782
2	Ware Country Subd.	M1080794	19	107 West Subd.	M1080791
3	Calme Estates Subd. #2	M1080793	20	Barham #14	M1080779
4	Calme Estates Subd.	M1080792	21	Acacia Subd.	M1080718
5	Calme Estates Subd. #3	M1080791	22	Dogart Subdivision	M1080625
6	Country Colony Subd.	M1080790	23	Upper Sharyland Subd.	M1080765
7	Ware Colony	M1080789	24	Encoguerres	M1080716
8	Ware West Subd.	M1080800	25	Terra Estates Subd.	M1080734
9	Laguna Hermosa	N/A	26	Ramon Leal Subd.	M1080291
10	Valle Hermoso Estates	M1080775	27	El Paraiso Subd.	M1080247
11	L. & R. Garza	M1080383	28	Los Ebanos Subd.	M1080427
12	Ware Shavano	M1080799	29	Los Ebanos Subd. #2	M1080428
13	Ware del Norte Subd.	M1080798	30	Palmas Subd.	M1080544
14	China City Subd. #1	M1080155	31	Sun Valley Estates	M1080711
15	Low Patters Subd.	M1080430	32	Valley Ranchmans Subd.	M1080777
16	Barrow Subd.	N/A	33	Barham #9	M1080381
17	Orlando Estates	M1080293			