



AIA[®] Document G714[™] – 2007

Construction Change Directive

PROJECT: <i>(Name and address)</i> Hidalgo County Remodel Old Admin Bldg 100 E Cano Edinburg, Texas 78539	DIRECTIVE NUMBER: 005	OWNER <input checked="" type="checkbox"/>
TO CONTRACTOR: <i>(Name and address)</i> D Wilson Construction P.O. Box 3455 McAllen, Texas 78502	DATE: April 05, 2014	ARCHITECT <input checked="" type="checkbox"/>
	CONTRACT FOR: General Construction	CONSULTANT <input checked="" type="checkbox"/>
	CONTRACT DATED: October 23, 2012	CONTRACTOR <input checked="" type="checkbox"/>
	ARCHITECT'S PROJECT NUMBER:	FIELD <input type="checkbox"/>
		OTHER <input type="checkbox"/>

You are hereby directed to make the following change(s) in this Contract:
(Describe briefly any proposed changes or list any attached information in the alternative.)

1. Removal of existing quarry tile and mortar bed at First Floor of West Wing. Provide new mortar bed. Finish to receive new ceramic tile flooring.....\$10,049.00 (includes GC oh/p)
2. Concrete Floor Expansion Joint Material-First Floor....\$3,479.00 (includes GC oh/p)
3. Floor Leveling, 1st and 2nd Floors.....\$2,761.00 (includes GC OH/P).
4. Revisions to Commissioners Court Meeting Room and Public Affairs Offices...Cost Pending
5. Revisions to District Attorney's Offices.....Cost Pending
6. Add the amount of \$1,600.00 credit from door hardware to project allowance (New Project Allowance \$6,027.00).

PROPOSED ADJUSTMENTS

1. The proposed basis of adjustment to the Contract Sum or Guaranteed Maximum Price:

- Lump Sum of \$ 16,289.00 (items 1,2, & 3 above)
- Unit Price of \$ per
- As provided in Section 7.3.3 of AIA Document A201[™]-2007
- As follows:
For Items 4, and 5 above, cost adjustments pending General Contractor's pricing

2. The Contract Time is proposed to N/A . The proposed adjustment, if any, is N/A
 Pending (0) days.

When signed by the Owner and Architect and received by the Contractor, this document becomes effective IMMEDIATELY as a Construction Change Directive (CCD), and the Contractor shall proceed with the change(s) described above.

Contractor signature indicates agreement with the proposed adjustments in Contract Sum and Contract Time set forth in this CCD.

Alcocer Garcia Associates, Inc.
 ARCHITECT *(Firm name)*
 1333 E Jasmine
 McAllen, Texas 78501
 ADDRESS

County of Hidalgo
 OWNER *(Firm name)*
 2802 S Business Highway 281
 Edinburg, Texas 78539
 ADDRESS

D. Wilson Construction Company
 CONTRACTOR *(Firm name)*
 P.O. Box 3455
 McAllen, Texas 78502
 ADDRESS

BY *(Signature)*
 George A Garcia, Architect
(Typed name)

BY *(Signature)*
 Ramon Garcia, County Judge
(Typed name)

BY *(Signature)*
 Bill Wilson
(Typed name)

DATE

DATE

DATE

April 24, 2014

REQUEST FOR PROPOSAL:

Please submit cost proposal for the removal and disposal of approximately 2,000 s.f. of existing quarry tile flooring and mortar bed at West Wing of the Old Administration Building.

Labor and material cost for new mortar bed. Prepped to receive new 20"x20" ceramic floor tile. Top of new finish mortar bed to be flush with adjacent concrete slab.

Sincerely,

Alcócer García Associates, Inc.

Eduardo Alcócer

Eduardo Alcócer

President

OPTION 4



Estimate

Date	Estimate #
4/24/2014	3542

2831 E Alberta Rd
Edinburg Tx 78542

Tele: Alex: (956) 227-4298 / Luis: (956) 219-5539
Fax: (956) 781-4250
E-Mail: concretgolden@yahoo.com

Name / Address
D Wilson Construction Attn: Manny Job: Re-Model Former Administration Bldg. Hidalgo County, Tx Phone No: (432) 212-3214

P.O. No.	Project
	Remodel Administration Bldg

Description	Qty	Rate	Total
Remove tile and concrete labor only		3,000.00	3,000.00
2000sq ft x \$1.50		2,400.00	2,400.00
Pour concrete back labor only		1,700.00	1,700.00
2000sq ft x \$1.20		800.00	800.00
Concrete 14 yds x \$110.00		1,200.00	1,200.00
Pump			
Materials (rebar, wire mesh and accessories)			
Thank you for your business. Exclusions: Permits/ fees/ bonds, testing dewatering, lime stabilization, concrete forming for elevated (suspended) slabs and cast in place columns, floor sealer and floor jt sealer/ or hardeners, colored and/ or stained concrete, masonry dowel caps, barricades, safety cables, grouting, waterproofing, demolition work of any type, light pole bases, survey and layout of building corners, embedded items (steel plates, striping, haul off of trash, concrete work outside of above schedule.		Total \$9,100.00 949.00 10,049	

April 21, 2014

**REQUEST FOR INFORMATION
FLOOR EXPANSION JOINT PREPARATION**

D. Wilson construction Company, reports an existing expansion joint in the slab and recommends that this joint be prepared by installing a Crack Isolation Membrane or Dalseal TS over this joint.

Provide a cost proposal for this work.

Also, provide the lineal feet and width of the joint along with material information and the application method recommended by manufacturer so we can discuss this with the Owner.

Sincerely,

Alcocer Garcia Associates, Inc.

Eduardo Alcocer

President

Proposal

MION TERRAZZO TILE AND MARBLE CO., INC.

2045 No. 77 Sunshine Strip
HARLINGEN, TEXAS 78550
Phone (956) 423-6207 • Fax: (956) 423-9591

PROPOSAL SUBMITTED TO D. Wilson	PHONE	DATE April 24, 2014
STREET	JOB NAME Hidalgo Administration Bldg. (RFP) dated 4/21/14	
CITY, STATE AND ZIP CODE	JOB LOCATION Edinburg, Texas	
ARCHITECT	DATE OF PLANS	JOB PHONE

Since you have 20"X20" tile we need to cover a 24" wide area over the expansion joint.

We propose to furnish labor and materials for the installation of the following:

East to West-130' Expansion Joint	\$1,300.00 (One Thousand Three Hundred Dollars)
North to South-200' Expansion Joint	\$1,850.00 (One Thousand Eight Hundred Fifty Dollars)

Payment to be made as follows: _____ dollars (\$ _____)

Mion Terrazzo Tile & Marble, Co., Inc.

Robert Mion, President

All material is guaranteed to be as specified. All work to be completed in a workmanlike manner according to standard practices. Any alteration or deviation from above specifications involving extra costs will be executed only upon written orders, and will become an extra charge over and above the estimate. All agreements contingent upon strikes, accidents or delays beyond our control. Owner to carry fire, tornado and other necessary insurance. Our workers are fully covered by Workmen's Compensation Insurance.

Authorized Signature

Robert Mion

Note: This proposal may be withdrawn by us if not accepted within _____ days.

Acceptance of Proposal — The above prices, specifications and conditions are satisfactory and are hereby accepted. You are authorized to do the work as specified. Payment will be made as outlined above.

Signature _____

Signature _____

Date of Acceptance: _____

GC CHIP - #



May 5, 2014

AGA Design Consultants
1333 E. Jasmine Ave
McAllen, Texas, 78501

ATN: George Garcia

RE: HC Reno to Former Admin Bldg. /Floor Prep Proposal.

Mr. Garcia,

Per your request this is a formal notice to you that the cost to prep the existing floor substrate for new flooring is \$2,761.00. This amount includes D Wilson's mark up. You have the backup proposal from our flooring subcontractor already. We understand that the additional proposal amount to apply the joint membrane will be addressed at a later date.

Thank you,

A handwritten signature in black ink, appearing to read "MM Ornelas", written over a light blue horizontal line.

MM Ornelas
D Wilson Construction

General Construction | Design Build | Construction Management

P.O. Box 3455 • 1209 East Pecan • McAllen, Texas 78502-3455 • 956-686-9573 • Fax 956-686-3270
www.dwilsonconstruction.com

Proposal

MION TERRAZZO TILE AND MARBLE CO., INC.

2045 No. 77 Sunshine Strip
HARLINGEN, TEXAS 78550

Phone (956) 423-6207 • Fax: (956) 423-9591

PROPOSAL SUBMITTED TO D. Wilson		PHONE	DATE May 5, 2014
STREET		JOB NAME Hidalgo Administration Bldg.	
CITY, STATE AND ZIP CODE		JOB LOCATION Edinburg, Texas	
ARCHITECT	DATE OF PLANS		JOB PHONE

Revised Quote dated 4/28/14

These are not options. Each one reflects a different area. Both are necessary to provide a quality installation.

1.) To level concrete floor.

For the sum of \$2,500.00 (Two Thousand Five Dollars)

2.) To furnish & install 10,000 sq. of Mapeilastic CI, Crack Iso. Membrane at plumbing trenches.

For the sum of \$18,500.00 (Eighteen Thousand Five Hundred Dollars)

Payment to be made as follows: _____ dollars (\$ _____).

Mion Terrazzo Tile & Marble, Co., Inc.

Robert Mion, President

All material is guaranteed to be as specified. All work to be completed in a workmanlike manner according to standard practices. Any alteration or deviation from above specifications involving extra costs will be executed only upon written orders, and will become an extra charge over and above the estimate. All agreements contingent upon strikes, accidents or delays beyond our control. Owner to carry fire, tornado and other necessary insurance. Our workers are fully covered by Workmen's Compensation Insurance.

Authorized Signature

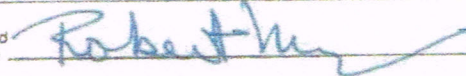

Note: This proposal may be withdrawn by us if not accepted within _____ days.

Acceptance of Proposal — The above prices, specifications and conditions are satisfactory and are hereby accepted. You are authorized to do the work as specified. Payment will be made as outlined above.

Date of Acceptance: _____

Signature _____

Signature _____

**1st AND 2nd FLOORS REMODEL
 FORMER ADMINISTRATION BUILDING
 HIDALGO COUNTY, TEXAS**

THE USE OF THESE
 DRAWINGS IS RESTRICTED TO
 THE PROJECT AND SITE FOR
 WHICH THEY WERE PREPARED.
 REPRODUCTION WITHOUT
 PERMISSION IS PROHIBITED.
 THE OWNER IS RESPONSIBLE.

DATE: 08/12
 DRAWN BY: G.A.
 CHECKED BY: G.A.
 FILE NAME: H.C.A.B.
 SHEET:

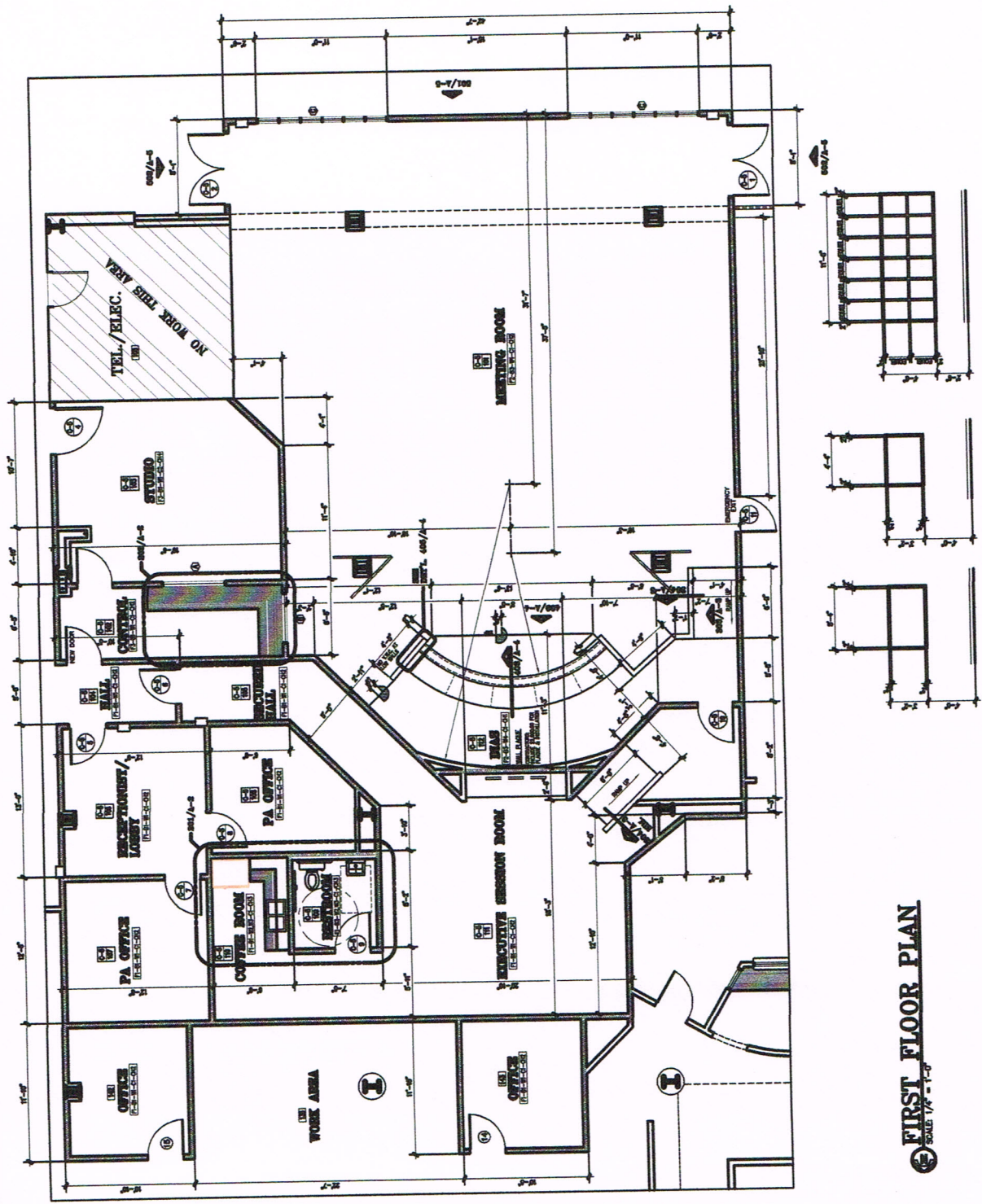

FIRST FLOOR PLAN
 SCALE: 1/8" = 1'-0"

Eduardo Alcocer

From: Manuel Ornelas <manuelo@dwilsonconstruction.com>
Sent: Wednesday, April 16, 2014 6:22 PM
To: ED; george@agadc.com
Cc: mateos@dwilsonconstruction.com; horacioq@dwilsonconstruction.com; Stan Ramos; jrodriguez@prodigycompany.com; valde.guerra@co.hidalgo.tx.us
Subject: FW: Emailing: Hidalgo Co. Admin 1st & 2nd Floor Change order #1 Credit
Attachments: Hidalgo Co. Admin 1st & 2nd Floor Change order #1 Credit.pdf

Ed, Please see attached. Please review and inquire of the client if they are interested in this proposal and I'll generate a formal Change Request for a credit back to them. Please insure they know that some of the existing panic HDW will remain. Please advise ASAP.

Thank you,

Manuel M. Ornelas
Project Manager
D. Wilson Construction
Mobile: 956-336-8577

From: Cliff Carnahan [mailto:ccarnahan@archdiv8.com]
Sent: Monday, April 14, 2014 4:01 PM
To: Manuel Ornelas
Subject: Emailing: Hidalgo Co. Admin 1st & 2nd Floor Change order #1 Credit

Manny,

Attached is a change order that deducts some of the originally scheduled hardware on the existing openings. The existing exit devices are dark bronze, but they all appeared to be functioning properly. If I only provide a new cylinder and instead of a new exit device that is where the bulk of the credit comes from. If they decide they want new exit devices it will be extremely difficult for your installer to put the new exit devices on the doors which are prepped for an old style of exit device (panic bar).

Please let me know if this is accepted.

Thank you,

Cliff Carnahan

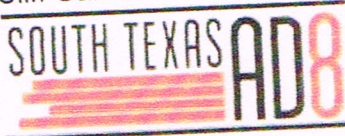

AUSTIN • SAN ANTONIO • VALLEY

2810 N Expressway 77 Suite F
Harlingen, TX 78552
(956) 440-8160 Office
(956) 802-8469 Mobile
(855) 820-6616 Toll Free
(956) 440-8260 Fax

Project: 390165 - 1ST AND 2ND FLOOR RENOVATIONS TO ADMINISTRATION BLG
Contemplated Change Order # 1
Existing opening changes

-1	Single Door #EP1	Exterior from Existing Pump Room 1st Flr			LHR
1	Single Door #EP1	Exterior from Existing Pump Room 1st Flr			LHR
3	Hinges	ECBB1100 4 1/2 x 4 1/2	US10B	HA	
-1	Lockset	T581PD D 50-210F-GMK 50-219F "DO NOT DUPLICATE"	626	FL	
1	Mortise Cylinder	987	613	FL	
1	Mortise Cylinder	987 #6 CAM 008876-001	613	FL	
-1	Door Closer	SC81 SS Full Cover SC80-18PA SC80-30 SC80-61 TBWMS	689	FL	
1	Door Closer	SC81 RW/PA Full Cover TBWMS	695	FL	
-3	Hinges	ECBB1100 4 1/2 x 4 1/2 NRP	US26D	HA	
-1	Protection Plate	345D	US32D	HA	
-1	Set Weatherstrip	891S V 1 x 36" 2 x 84"	MIL	HA	
-1	Door Sweep	750S N 36"	CLR	HA	
1	Door Sweep	750S N 36"	DBA	HA	
-1	Threshold	520S V 36"	MIL	HA	
-1	Single Door #NEW1	Exterior from Stair #4 (existing)			LHR
1	Single Door #NEW1	Exterior from Stair #4 (existing)			LHR
-1	Exit Device	25-R-NL x 512NL SEX BOLTS (4)	SP28, US28	FL	
1	Rim Cylinder	951 008862 008876-001 50-210F-GMK	US10B	FL	
-1	Pair Doors #E1	Exterior from Entry Vestibule 145			RHRA
1	Pair Doors #E1	Exterior from Entry Vestibule 145			RHRA
-2	Rim Cylinder	951 50-210F-GMK	US26D	FL	
-2	Mortise Cylinder	987 50-210F-GMK	626	FL	
1	Mortise Cylinder	987 #6 CAM 008876-001	613	FL	
-1	Pair Doors #E2	Entry Vestibule 145 from Vestibule 146			RHRA
1	Pair Doors #E2	Entry Vestibule 145 from Vestibule 146			RHRA
-2	Rim Cylinder	951 50-210F-GMK	US26D	FL	
-2	Mortise Cylinder	987 50-210F-GMK	626	FL	
1	Mortise Cylinder	987 #6 CAM 008876-001	613	FL	
-1	Single Door #E3	Entry Vestibule 145 from Stair #1 168			LHR
1	Single Door #E3	Entry Vestibule 145 from Stair #1 168			LHR
-1	Passage Set	W101S D	626	FL	
1	Rim Cylinder	951 008862 008876-001 50-210F-GMK	US10B	FL	
-1	Wall Stop	236W	US32D	HA	
-3	Hinges	ECBB1100 4 1/2 x 4 1/2	US26D	HA	
-3	Door Silencer	307D	GREY	HA	
-1	Pair Doors #E4	Exterior Canopy from Atrium 101			RHRA
1	Pair Doors #E4	Exterior Canopy from Atrium 101			RHRA
-1	Exit Device	24-R-L x 712L R,V DANE SEX BOLTS (4)	RHR SP28, US28	FL	

Project: 390165 - 1ST AND 2ND FLOOR RENOVATIONS TO ADMINISTRATION BLG
Contemplated Change Order # 1
Existing opening changes

-1	Exit Device	24-R-EO SEX BOLTS (4)	US28	FL	
1	Mortise Cylinder	987 #6 CAM 008876-001	613	FL	
-2	Door Closer	SC71 SS SC70-18PA SC70-30	689	FL	
		SC70-61 TBWMS			
2	Door Closer	SC81 RW/PA Full Cover TBWMS	695	FL	
-2	Brush Weatherstrip	802S B 84"	MIL	HA	
-1	Set Weatherstrip	891S V 1 x 72" 2 x 84"	MIL	HA	
-2	Door Sweep	750S N 36"	CLR	HA	
2	Door Sweep	750S N 36"	DBA	HA	
-1	Threshold	413S 72"	MIL	HA	
-2	Door Silencer	307D	GREY	HA	
					LHR
-1	Single Door #E5	Exterior Canopy from Stair #2 103			LHR
1	Single Door #E5	Exterior Canopy from Stair #2 103			
-1	Lockset	T581PD D 50-210F-GMK 50-219F	626	FL	
		"DO NOT DUPLICATE"			
1	Exit Device	24-R-L x 510L DANE	LHR	SP313, 313AN	FL
				US10B	FL
1	Rim Cylinder	951 50-210F-GMK		689	FL
-1	Door Closer	SC81 SS Full Cover SC80-18PA			
		SC80-30 SC80-61 TBWMS			
-3	Hinges	ECBB1100 4 1/2 x 4 1/2 NRP	US26D	HA	
-1	Protection Plate	345D	US32D	HA	
-1	Set Weatherstrip	891S V 1 x 36" 2 x 84"	MIL	HA	
1	Set Weatherstrip	891S V 1 x 36" 2 x 84"	DBA	HA	
-1	Door Sweep	750S N 36"	CLR	HA	
1	Door Sweep	750S N 36"	DBA	HA	
-1	Threshold	520S V 36"	MIL	HA	
1	Threshold	520S V 36"	DBA	HA	
					RHR
-1	Single Door #E7	Atrium 101 from Stair #3 181			RHR
1	Single Door #E7	Atrium 101 from Stair #3 181			
3	Hinges	ECBB1100 4 1/2 x 4 1/2	US10B	HA	
-1	Exit Device	25-R-L x 510L DANE SEX BOLTS (4)	RHR	SP28, US28	FL
		951 008862 008876-001		US10B	FL
1	Rim Cylinder	50-210F-GMK			
-1	Door Closer	SC81 SS Full Cover SC80-18PA	689	FL	
		SC80-30 SC80-61 TBWMS			
1	Door Closer	SC81 RW/PA Full Cover TBWMS	695	FL	
-3	Hinges	ECBB1100 4 1/2 x 4 1/2	US26D	HA	
					RHRA
-1	Pair Doors #E10	Exterior from Hall - South Side			RHRA
1	Pair Doors #E10	Exterior from Hall - South Side			
-2	Rim Cylinder	951 50-210F-GMK	US26D	FL	
-2	Mortise Cylinder	987 50-210F-GMK	626	FL	
1	Mortise Cylinder	987 #6 CAM 008876-001	613	FL	
2	Door Closer	SC81 RW/PA Full Cover TBWMS	695	FL	
					RHR
-1	Single Door #E11	Atrium 101 from Stair #4 (existing)			RHR
1	Single Door #E11	Atrium 101 from Stair #4 (existing)			RHR

Project: 390165 - 1ST AND 2ND FLOOR RENOVATIONS TO ADMINISTRATION BLG
Contemplated Change Order # 1
Existing opening changes

3	Hinges	ECBB1100 4 1/2 x 4 1/2		US10B	HA	
-1	Exit Device	25-R-L x 510L DANE SEX BOLTS (4)	RHR	SP28, US28	FL	
1	Rim Cylinder	951 008862 008876-001 50-210F-GMK		US10B	FL	
-1	Door Closer	SC81 SS Full Cover SC80-18PA SC80-30 SC80-61 TBWMS		689	FL	
-3	Hinges	ECBB1100 4 1/2 x 4 1/2		US26D	HA	
-1	Pair Doors #E12	Exterior from Atrium 101				RHRA
1	Pair Doors #E12	Exterior from Atrium 101				RHRA
-1	Exit Device	24-R-L x 712L R,V DANE SEX BOLTS (4)	RHR	SP28, US28	FL	
-1	Exit Device	24-R-EO SEX BOLTS (4)		US28	FL	
1	Mortise Cylinder	987 #6 CAM 008876-001		613	FL	
-2	Door Closer	SC71 SS SC70-18PA SC70-30 SC70-61 TBWMS		689	FL	
2	Door Closer	SC81 RW/PA SC80-18 TBWMS		695	FL	
-2	Brush Weatherstrip	802S B 84"		MIL	HA	
-1	Set Weatherstrip	891S V 1 x 72" 2 x 84"		MIL	HA	
-2	Door Sweep	750S N 36"		CLR	HA	
2	Door Sweep	750S N 36"		DBA	HA	
-1	Threshold	413S 72"		MIL	HA	
1	Threshold	413S 72"		DBA	HA	
-1	Single Door #E13	Stair #3 203 from Hall 202				RHR
1	Single Door #E13	Stair #3 203 from Hall 202				RHR
-1	Exit Device	25-R-L x 510L DANE SEX BOLTS (4)	RHR	SP28, US28	FL	
1	Rim Cylinder	951 008862 008876-001 50-210F-GMK		US10B	FL	
-1	Door Closer	SC81 SS Full Cover SC80-18PA SC80-30 SC80-61 TBWMS		689	FL	
-3	Hinges	ECBB1100 4 1/2 x 4 1/2		US26D	HA	
-1	Single Door #E14	Stair #4 226 from Hall 202				LHR
1	Single Door #E14	Stair #4 226 from Hall 202				LHR
-1	Exit Device	25-R-L x 510L DANE SEX BOLTS (4)	LHR	SP28, US28	FL	
1	Rim Cylinder	951 008862 008876-001 50-210F-GMK		US10B	FL	
-1	Door Closer	SC81 SS Full Cover SC80-18PA SC80-30 SC80-61 TBWMS		689	FL	
1	Door Closer	SC81 RW/PA Full Cover TBWMS		695	FL	
-3	Hinges	ECBB1100 4 1/2 x 4 1/2		US26D	HA	
1	478" Cover plate	478 COVER			VH01	
-1	Single Door #E18	Stair #2 250 from Elevator Lobby 2 - 249				LHR
1	Single Door #E18	Stair #2 250 from Elevator Lobby 2 - 249				LHR
-1	Exit Device	25-R-L x 510L DANE SEX BOLTS (4)	LHR	SP28, US28	FL	

Project: 390165 - 1ST AND 2ND FLOOR RENOVATIONS TO ADMINISTRATION BLG
Contemplated Change Order # 1
Existing opening changes

1	Rim Cylinder	951 008862 008876-001 50-210F-GMK	US10B	FL
-1	Door Closer	SC81 SS Full Cover SC80-18PA SC80-30 SC80-61 TBWMS	689	FL
1	Door Closer	SC81 RW/PA Full Cover TBWMS	695	FL
-3	Hinges	ECBB1100 4 1/2 x 4 1/2	US26D	HA
-1	Single Door #E20	Stair #1 281 from Work Area 278		LHR
1	Single Door #E20	Stair #1 281 from Work Area 278		LHR
-1	Exit Device	25-R-L x 510L DANE SEX BOLTS (4)	LHR SP28, US28	FL
1	Rim Cylinder	951 008862 008876-001 50-210F-GMK	US10B	FL
-1	Door Closer	SC81 SS Full Cover SC80-18PA SC80-30 SC80-61 TBWMS	689	FL
1	Door Closer	SC81 RW/PA Full Cover TBWMS	695	FL
-3	Hinges	ECBB1100 4 1/2 x 4 1/2	US26D	HA

Section Totals
 Finish Hardware

Pre-Tax Total

(1,600.00)
 (1,600.00)