

PLEASE >> Please remit To:
DETACH >> AEP-Texas Central Co.
STUB >> Sandra Casas
AND >> 355 W Highway 77
RETURN >> San Benito TX 78586
WITH >> Bill To:
PAYMENT >> Hidalgo County Precinct No. 4
2812 S BUSINESS 281
Edinburg, TX 78539

Company No: 211
Contract No: DWMS00000249482
Customer No: 11109771
Date: 10/29/2014
Amount Due: 20,249.46

Amount Remitted: _____

Contract No: DWMS00000249482
Date: 10/29/2014

PRO FORMA

Customer No: 11109771
Purchase Order: 51978702

Description	Quantity	UOM	Init Amt	Net Amount
INSTALL OVERHEAD 3-PHASE PRIMARY WITH THREE 277/480 VOLT TRANSFORMERS TO SERVE NEW LIFT STATION ON MILE 17 ROAD NORTH & HOLMES RD IN SAN CARLOS, TX	1.0	EA	20,249.46	20,249.46

Amount Due: 20,249.46

AEP Texas Central Company

**Contribution-In-Aid-Of-Construction Agreement
For Electric Distribution Service**

Hidalgo County Precinct No. 4
Service: HOLMES AVE
SAN CARLOS, TX

Mailing: 2812 S BUSINESS 281
Edinburg, TX 78539

Contract #: DWMS00000249482 Work Request #: 51978702

Date: 10/29/2014

You, Hidalgo County Precinct No. 4 (Customer) have requested AEP Texas Central Company (Company) to install/construct certain electric distribution facilities (hereinafter referred to as "Facilities") as follows:INSTALL OVERHEAD 3-PHASE PRIMARY WITH THREE 277/480 VOLT TRANSFORMERS TO SERVE NEW LIFT STATION ON MILE 17 ROAD NORTH & HOLMES RD IN SAN CARLOS,TX

The cost for construction/installation of the requested Facilities will be in excess of what would normally be provided by Company at no additional cost to the Customer to initiate service. In accordance with the Company's approved Tariff, as filed with the Public Utilities Commission of Texas, the Customer agrees to pay Company a one-time, non-refundable, Contribution-In-Aid-Of-Construction (CIAC) in the amount of 20,249.46. The Customer understands that he/she receives no ownership or control of the Facilities by virtue of the payment of the CIAC. The Facilities installed by the Company will remain the property of the Company. The Company expressly retains the right to use said Facilities for any purpose which Company deems appropriate under good utility practices, including the distribution of electric service to other customers.

Company agrees to INSTALL OVERHEAD 3-PHASE PRIMARY WITH THREE 277/480 VOLT TRANSFORMERS TO SERVE NEW LIFT STATION ON MILE 17 ROAD NORTH & HOLMES RD IN SAN CARLOS,TX, and the Customer agrees to provide PAY CIAC \$20,249.46 BEFORE AEP CONSTRUCTION STARTS. and to be ready to take electric service on or before 10/29/2014.

It is understood and agreed that the Company will not begin construction/installation of the Facilities until full payment of the CIAC has been received by the Company; therefore, Customer understands and agrees that he/she needs to make full payment of the CIAC in sufficient time to allow for the construction/installation to be completed by the In Service Date.

The pricing of the CIAC quoted herein is based on the specifics of the Customer's request, including the Customer's stated In Service Date, and must be accepted by the Customer by executing and returning to the Company this Agreement by 1/27/2015 to remain valid. Should Customer alter the request for facilities, or request a delay in (or is otherwise unable to take service by) the stated In Service Date, the Company reserves the right to update the pricing and require an additional CIAC payment to reflect any increases in cost due to the alteration in requested facilities or the delay in taking service, or both.

Nothing contained herein shall be construed as a waiver or relinquishment by Company of any right it has or may hereafter have to discontinue service for default in the payment of any bill owing or to become owing hereunder or for any reason or cause allowed by law.

By signing and returning this Agreement, Customer understands and accepts the above described terms and conditions.

Customer
By _____
Signature: _____
Title: _____
Date: _____

Company
By _____
Signature: _____
Title: _____
Date: _____

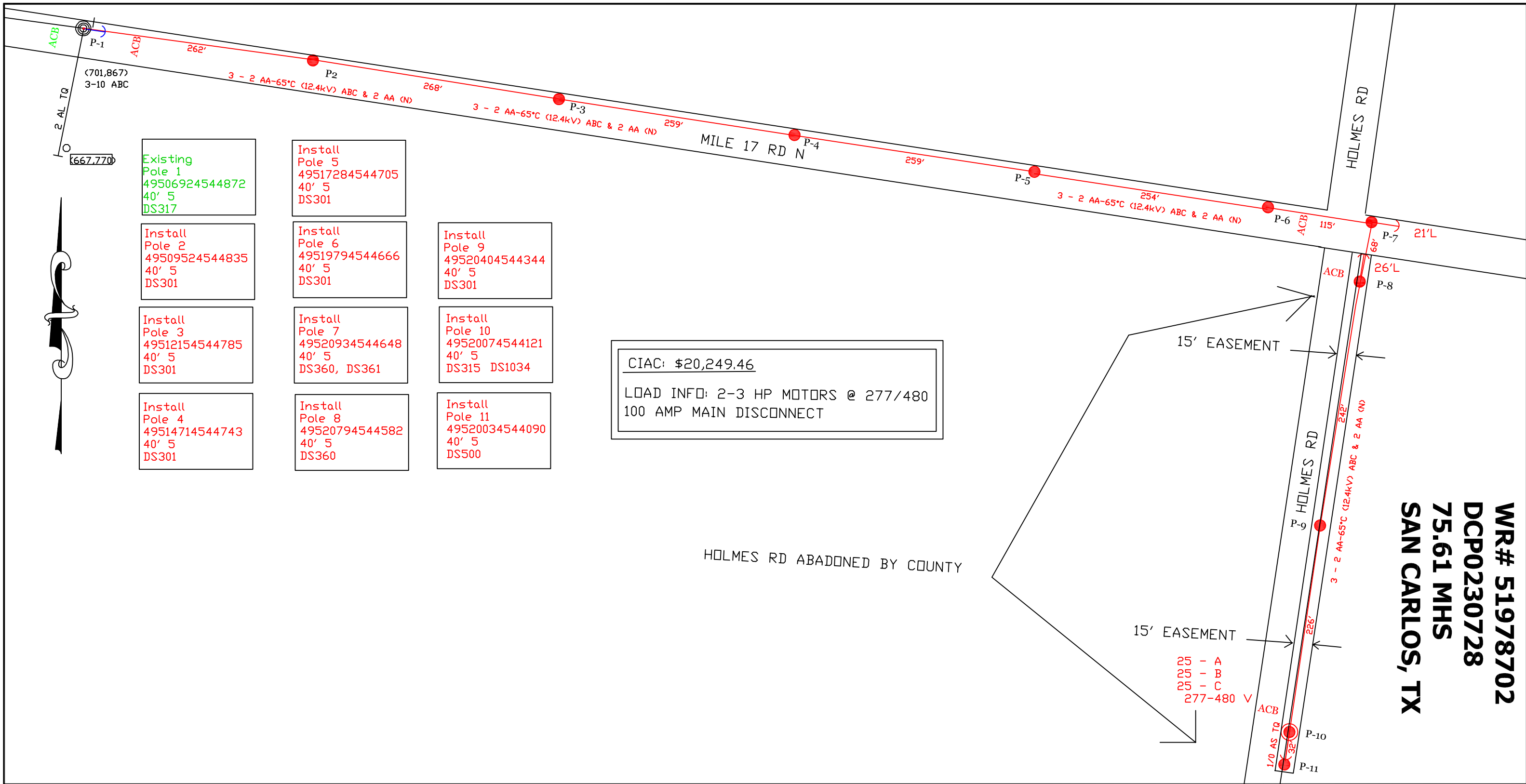

Existing Pole 1
49506924544872
40' 5
DS317

Install Pole 5
49517284544705
40' 5
DS301

Install Pole 2
49509524544835
40' 5
DS301

Install Pole 6
49519794544666
40' 5
DS301

Install Pole 9
49520404544344
40' 5
DS301

Install Pole 3
49512154544785
40' 5
DS301

Install Pole 7
49520934544648
40' 5
DS360, DS361

Install Pole 10
49520074544121
40' 5
DS315 DS1034

Install Pole 4
49514714544743
40' 5
DS301

Install Pole 8
49520794544582
40' 5
DS360

Install Pole 11
49520034544090
40' 5
DS500

CIAC: \$20,249.46
LOAD INFO: 2-3 HP MOTORS @ 277/480
100 AMP MAIN DISCONNECT

WR# 51978702
DCP0230728
75.61 MHS
SAN CARLOS, TX



AEP - TEXAS		DATE REQUESTED: 12/20/2014	BUCKET TRUCK?: YES
		DATE REQUIRED: 12/25/2014	TRUCK TO SITE?: YES
JOB NAME: JOSE OCHOA - HIDALGO COUNTY PCT. 4			
LOCATION: SAN CARLOS, TX			4 WD?: NO
COUNTY: HIDALGO			
DIVISION: CP	DISTRICT: 200	CREW HQ: 11707	STATION No.: 1005
CIRCUIT No.: 94SB3500			
W/R#: 51978702	WO# DCP0230728	STA/CIR NAME: ELSA STA	
JU PROPOSAL(S): EDNI00039	NOT STAKED	NOT CLEARED	VOLTAGE: 12.47KV / 7.2KV
MAP: B/W		QUAD: ---	
R/W#: ---		PHASES: ABC N	
CUSTOMER SERVICE: CI-NEW SERVICE		DATE: 10/30/2014	PRINT #: ---
		SCALE: 1:100	PAGE: 1 OF 1
DRAWN BY: PAUL ANZALDUA (956) 330-0261			