

100% SUBMITTAL

US 281 MILITARY ROAD

DATE: 7/15/2015 11:20:21 AM

FILE: c:\project\ise\dannenbaum\hcrma\work\air\jose.vosquez\dms28863\SH365\_0033\_TITILEBORD.dgn

COUNTY: HIDALGO  
HWY. NO.: US 281  
DATE ACCEPTED: \_\_\_\_\_

PROJ. NO.: \_\_\_\_\_  
LETTING DATE: \_\_\_\_\_

INDEX DATA  
SHEET ON PAGE 2

FINAL PLAN DATA :  
FINAL CONTRACT PRICE: \_\_\_\_\_  
CONTRACTORS NAME: \_\_\_\_\_  
CONTRACTORS ADDRESS: \_\_\_\_\_  
LETTING DATE: \_\_\_\_\_  
DATE WORK BEGAN: \_\_\_\_\_  
DATE WORK COMPLETED: \_\_\_\_\_  
DATE OF ACCEPTANCE: \_\_\_\_\_  
HCRMA DATE OF ACCEPTANCE: \_\_\_\_\_  
CHANGE ORDERS & SUPP. AGREEMENTS :

# HIDALGO COUNTY REGIONAL MOBILITY AUTHORITY

## PLANS OF PROPOSED ROADWAY IMPROVEMENT

CSJ : 0220 - 01 - 023, ETC.

FEDERAL AID PROJECT NO. US 281: CBI1502(587)  
FEDERAL AID PROJECT NO. BSIF CONNECTOR: CC 921-2-337

### US 281 (MILITARY ROAD) AND BSIF CONNECTOR

PROJECT LENGTH: US 281  
ROADWAY: 9408 FT = 1.78 Mi.  
BRIDGE: 292 FT = 0.06 Mi.  
TOTAL: 9700 FT = 1.84 Mi.

LIMITS: US 281 (MILITARY RD)  
FROM: 0.47 MILES EAST OF SP 600  
US 281 (SOUTH CAGE BLVD)  
TO: FM 2557 (SOUTH STEWART ROAD)

PROJECT LENGTH: BSIF CONNECTOR  
ROADWAY: 3549 FT = 0.67 Mi.  
BRIDGE: 0 FT = 0.00 Mi.  
TOTAL: 3549 FT = 0.67 Mi.

LIMITS FOR BSIF CONNECTOR:  
FROM: US 281 (MILITARY RD)  
TO: SP 29 (VETERANS RD)

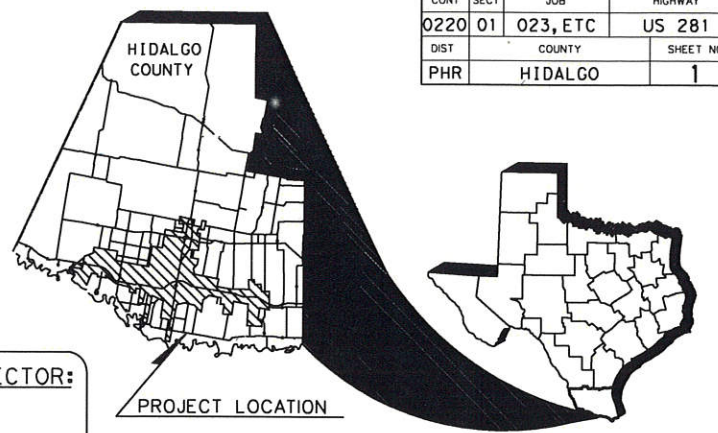

|                             |         |           |         |
|-----------------------------|---------|-----------|---------|
| FEDERAL AID PROJECT NO.     |         |           |         |
| US281: CBI1502 (587)        |         |           |         |
| BSIF CONNECTOR: CC921-2-337 |         |           |         |
| CONT                        | SECT    | JOB       | HIGHWAY |
| 0220                        | 01      | 023, ETC  | US 281  |
| DIST                        | COUNTY  | SHEET NO. |         |
| PHR                         | HIDALGO | 1         |         |

CONSTRUCTION OF WIDENING TO 4 LANE DIVIDED URBAN, ETC.  
CONSISTING OF GRADING, CONCRETE PAVEMENT, ASPHALT, LIME TREATED SUBGRADE,  
FLEXIBLE BASE, CULVERT STRUCTURES, BRIDGE, RIPRAP, SIGNING, DELINEATION, AND PAVEMENT MARKINGS

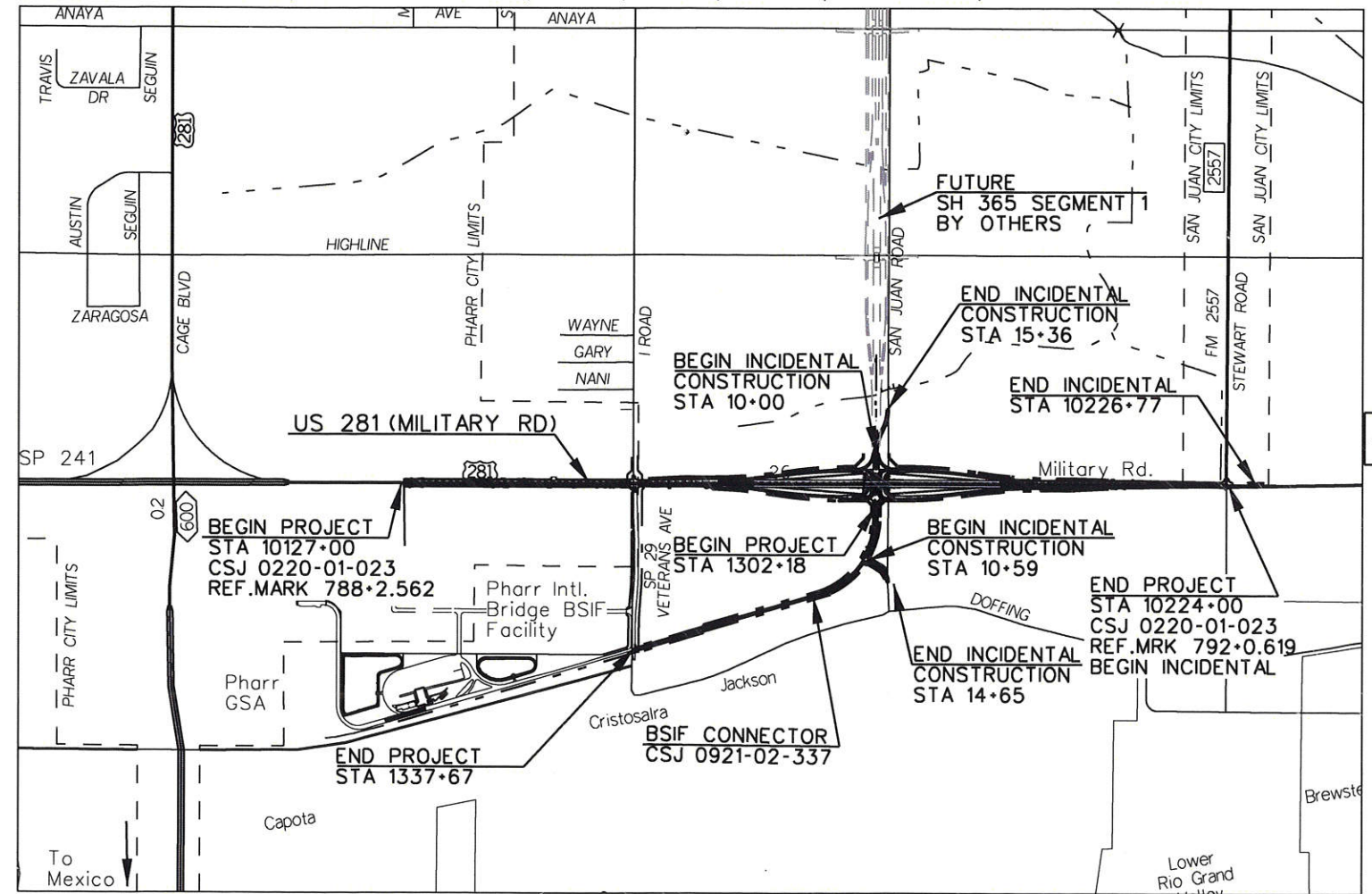

SCALE: 1"=1 MI.



LEGEND  
--- CITY LIMITS

LOCAL ENTITIES

HIDALGO COUNTY DRAINAGE DISTRICT NO. 1  
CONCURRENCE : \_\_\_\_\_ DATE : \_\_\_\_\_

NAME \_\_\_\_\_ TITLE \_\_\_\_\_

CITY OF PHARR  
CONCURRENCE : \_\_\_\_\_ DATE : 7-16-15

NAME *Paula...* TITLE Mayor

HIDALGO COUNTY IRRIGATION DISTRICT #2  
CONCURRENCE : \_\_\_\_\_ DATE : 9/8/15

NAME *Benny L...* TITLE District Mgr.

HIDALGO COUNTY JUDGE  
CONCURRENCE : \_\_\_\_\_ DATE : \_\_\_\_\_

NAME \_\_\_\_\_ TITLE \_\_\_\_\_

HIDALGO COUNTY REGIONAL MOBILITY AUTHORITY

© 2015

Texas Department of Transportation

PROGRAM MANAGEMENT CONSULTANT  
**DANNENBAUM**  
ENGINEERING CORPORATION

T.B.P.E. FIRM REGISTRATION #392  
1109 NOLANA LOOP, STE 280 MCALLEN, TX 78504 (956) 682-3677

**TEDSI** INFRASTRUCTURE GROUP  
Consulting Engineers  
1201 E. Expressway 83  
Mission, Texas 78572  
(956) 424-7898

TBPE F-1640

PILAR RODRIGUEZ, P. E. DATE \_\_\_\_\_  
EXECUTIVE DIRECTOR

ALL CONSTRUCTION WORK WAS PERFORMED IN ACCORDANCE WITH THE PLANS, SPECIFICATIONS AND CONTRACT. ALL PROPOSED CONSTRUCTION WAS COMPLETED UNLESS OTHERWISE NOTED.

SPECIFICATIONS ADOPTED BY THE TEXAS DEPARTMENT OF TRANSPORTATION ON NOVEMBER 1, 2014 AND SPECIFICATION ITEMS LISTED AND DATED AS FOLLOWS SHALL GOVERN ON THIS PROJECT. REQUIRED CONTRACT PROVISIONS FOR FEDERAL-AID CONSTRUCTION CONTRACTS (FORM FHWA 1273, MAY 2012).

| PROJECT DATA  |  |
|---|--|
| DESIGN SPEED:<br>45 mph - BSIF Connector<br>~ STA.1302+18 TO STA.1337+67  | FUNCTION CLASS<br>BSIF CONNECTOR ~ LOCAL CONNECTOR |
| 60 mph - US 281 ~ STA.10127+00 TO STA.10224+00                            | US 281 ~ PRINCIPAL ARTERIAL                        |
| REGISTERED ACCESSIBILITY SPECIALIST (RAS)<br>TDLR INSPECTION NOT REQUIRED | BRIDGE<br>STA. 10180+85.92 TO STA. 10183+77.92     |
| ADT<br>2015 - 28,600<br>2035 - 39,600                                     | EQUATIONS:<br>NONE                                 |
| EXCEPTIONS:<br>NONE   | RAILROAD CROSSINGS:<br>NONE                        |

RECOMMENDED FOR LETTING : 07-15-15  
*Paula...*  
DANNENBAUM PME PROJECT MANAGER

SUBMITTED FOR LETTING : 07-15-15  
*Mark...*  
TEDSI PROJECT ENGINEER

RECOMMENDED FOR LETTING : 7/29/15  
*Julio...*  
TxDOT DISTRICT ENGINEER

APPROVED FOR LETTING : 7-16-15  
*[Signature]*  
HCRMA EXECUTIVE DIRECTOR

SUBMITTED FOR LETTING : 7/29/15  
*Norma Y. B., P.E.*  
TxDOT ADVANCED PLANNING/  
PROJECT MANAGEMENT SUPERVISOR