



City of Mercedes
 Saladino Park
 Quote#: 0916-0023
 January 14, 2016

Park Place Recreation Designs, Inc.
 PO Box 18186
 San Antonio, TX 78218
 800-626-0238 Fax 210-832-0115

QTY	DESCRIPTION	LIST PRICE	BUY BOARD PRICE (#423-13)	MIRACLE SALE PRICE
1	#714-S437J	\$ 23,402.00	\$ 19,892.00	\$ 16,990.00
2	#1268 Bench 8ft (\$588 each)	\$ 1,176.00	\$ 1,000.00	\$ 1,000.00 *
	Shipping~no BuyBoard discount	\$ 1,565.00	\$ 1,565.00	\$ 196.00 **
	GRAND TOTAL	\$ 26,143.00	\$ 22,457.00	\$ 18,186.00

* #1268 currently not on sale so BuyBoard Discount applies

** Shipping charges apply only to #1268

Miracle

City of Mercedes

Saladino Park

714-5437

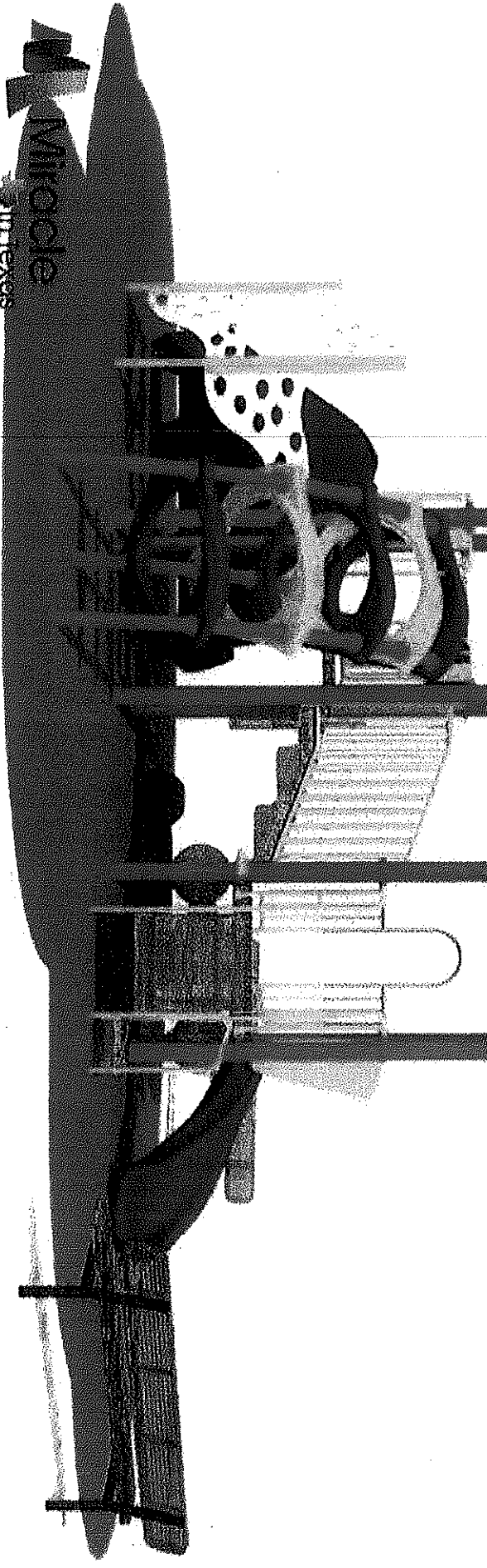
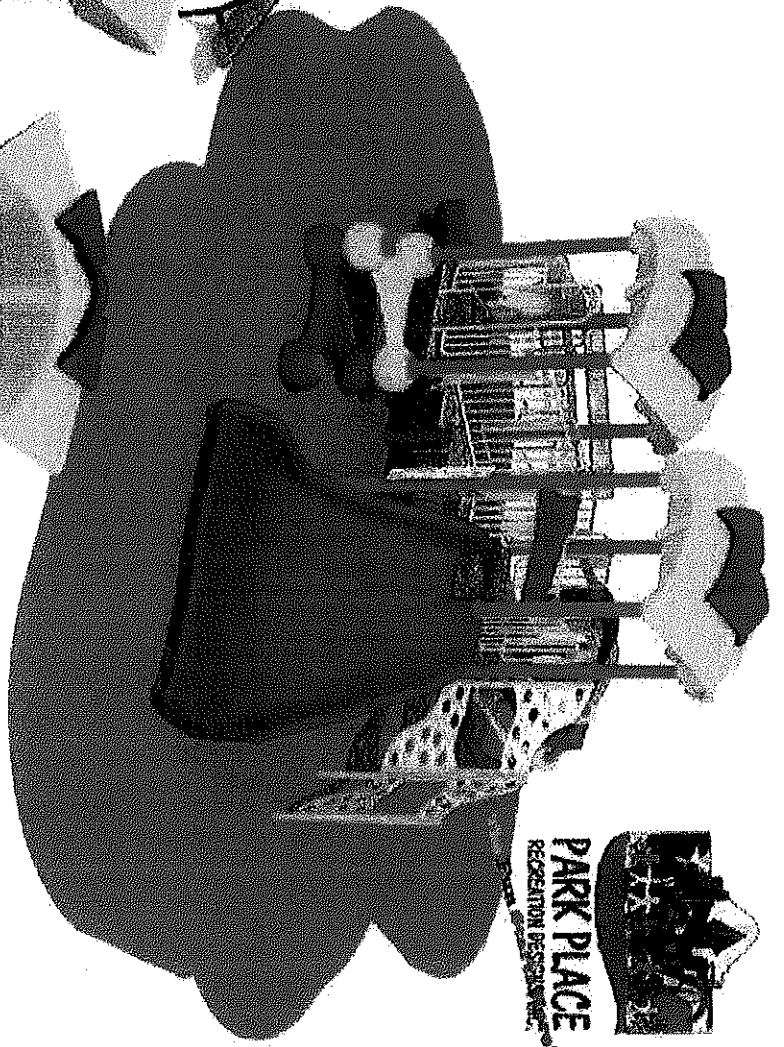
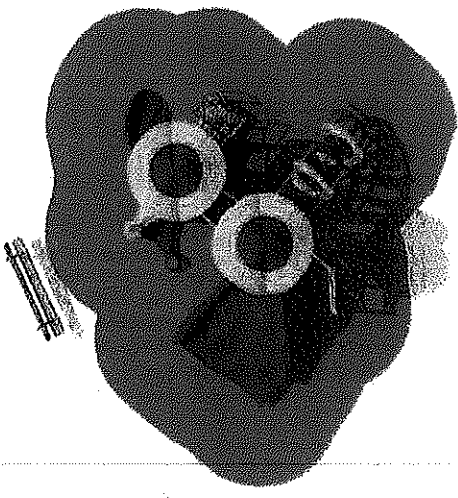

City of Mercedes 714-S437
Mercedes, TX

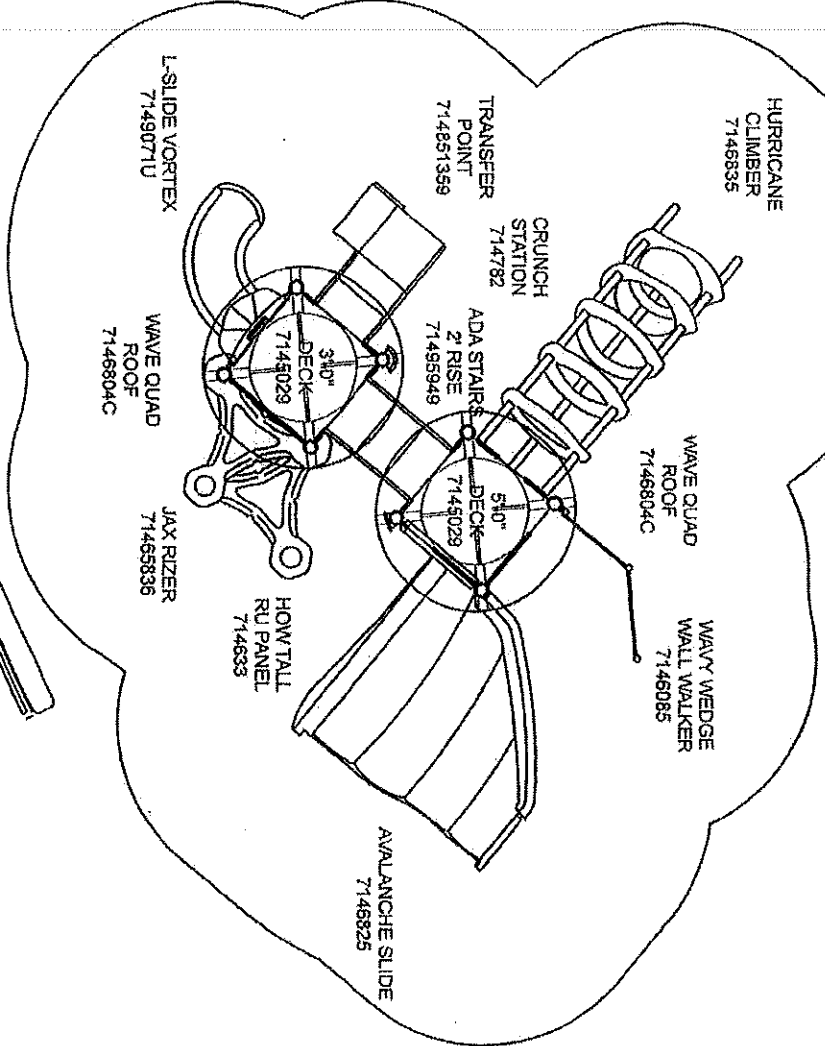

PARK PLACE RECREATION DESIGNS, INC.

P.O. Box 18186
San Antonio, TX
PHONE NO: (210) 821-5878
FAX NO: (210) 832-0115
GROUND SPACE: 28'-6" x 22'-6"
PROTECTIVE AREA: 37'-9" x 22'-6"
DRAWN BY: Bob Alvarez

009_42383377428

COMPLIES TO ASTM/CPSC
COMPLIES TO ADA

To promote safe and proper equipment use by children, Miracle recommends the installation of either a Miracle safety sign or other appropriate safety signage near each play system's main entry point(s) to inform parents and supervisors of the age appropriateness of the play system and general rules for safe play.

THE PLAY COMPONENTS IDENTIFIED IN THIS PLAN ARE IPEMA CERTIFIED THE USE AND LAYOUT OF THESE COMPONENTS CONFORM TO THE REQUIREMENTS OF ASTM F1487.
AN ENERGY ABSORBING PROTECTIVE SURFACE IS REQUIRED UNDER & AROUND ALL PLAY SYSTEMS



ASTM F1487	1
IPEMA CERTIFIED	2
ASTM F1487	3
IPEMA CERTIFIED	4
ASTM F1487	5
IPEMA CERTIFIED	6
ASTM F1487	7
IPEMA CERTIFIED	8
ASTM F1487	9
IPEMA CERTIFIED	10
ASTM F1487	11
IPEMA CERTIFIED	12
ASTM F1487	13
IPEMA CERTIFIED	14
ASTM F1487	15
IPEMA CERTIFIED	16
ASTM F1487	17
IPEMA CERTIFIED	18
ASTM F1487	19
IPEMA CERTIFIED	20
ASTM F1487	21
IPEMA CERTIFIED	22
ASTM F1487	23
IPEMA CERTIFIED	24
ASTM F1487	25
IPEMA CERTIFIED	26
ASTM F1487	27
IPEMA CERTIFIED	28
ASTM F1487	29
IPEMA CERTIFIED	30
ASTM F1487	31
IPEMA CERTIFIED	32
ASTM F1487	33
IPEMA CERTIFIED	34
ASTM F1487	35
IPEMA CERTIFIED	36
ASTM F1487	37
IPEMA CERTIFIED	38
ASTM F1487	39
IPEMA CERTIFIED	40
ASTM F1487	41
IPEMA CERTIFIED	42
ASTM F1487	43
IPEMA CERTIFIED	44
ASTM F1487	45
IPEMA CERTIFIED	46
ASTM F1487	47
IPEMA CERTIFIED	48
ASTM F1487	49
IPEMA CERTIFIED	50
ASTM F1487	51
IPEMA CERTIFIED	52
ASTM F1487	53
IPEMA CERTIFIED	54
ASTM F1487	55
IPEMA CERTIFIED	56
ASTM F1487	57
IPEMA CERTIFIED	58
ASTM F1487	59
IPEMA CERTIFIED	60
ASTM F1487	61
IPEMA CERTIFIED	62
ASTM F1487	63
IPEMA CERTIFIED	64
ASTM F1487	65
IPEMA CERTIFIED	66
ASTM F1487	67
IPEMA CERTIFIED	68
ASTM F1487	69
IPEMA CERTIFIED	70
ASTM F1487	71
IPEMA CERTIFIED	72
ASTM F1487	73
IPEMA CERTIFIED	74
ASTM F1487	75
IPEMA CERTIFIED	76
ASTM F1487	77
IPEMA CERTIFIED	78
ASTM F1487	79
IPEMA CERTIFIED	80
ASTM F1487	81
IPEMA CERTIFIED	82
ASTM F1487	83
IPEMA CERTIFIED	84
ASTM F1487	85
IPEMA CERTIFIED	86
ASTM F1487	87
IPEMA CERTIFIED	88
ASTM F1487	89
IPEMA CERTIFIED	90
ASTM F1487	91
IPEMA CERTIFIED	92
ASTM F1487	93
IPEMA CERTIFIED	94
ASTM F1487	95
IPEMA CERTIFIED	96
ASTM F1487	97
IPEMA CERTIFIED	98
ASTM F1487	99
IPEMA CERTIFIED	100

BENCHES (PARK)

Model	Description	Weight	Price
System BN			
12021	BENCH FRAME ONLY HEAVY DUTY-PERM	70	\$206
12031	BENCH FRAME ONLY HEAVY DUTY-PORT	45	\$276
1214	SWINGING PARK BENCH, STEEL-PERM	200	\$937
1228I	8' REDWOOD DBL PEDESTAL FLAT BENCH, MC-ING	125	\$488
1228P	8' REDWOOD DBL PEDESTAL FLAT BENCH, MC-PORT	125	\$523
1228S	8' REDWOOD DBL PEDESTAL FLAT BENCH, MC-SURF	125	\$529
1229P	8' REDWOOD DBL PDSTL FLAT BENCH, MC-PORT, LA	125	\$666
1229S	8' REDWOOD DBL PDSTL FLAT BENCH, MC-SURF, LA	125	\$646
1241	8' ALUM BENCH, PAINTED FRAME-ING	65	\$503
1241P	8' ALUM BENCH, PAINTED FRAME-PORT	75	\$503
1242	8' ALUM BENCH, GALV FRAME-ING	65	\$443
12421	8' ALUM BENCH, GALV FRAME-PORT	75	\$443
12461	6' ONE PIECE BENCH, STEEL-PORT	90	\$522
1248	8' ONE PIECE BENCH, STEEL-PERM	120	\$449
12481	8' ONE PIECE BENCH, STEEL-PORT	130	\$540
12521	6' BENCH, MIRACOTE ALUM-PORT	85	\$452
1253	6' BENCH, ANOD ALUM-PERM	80	\$398
12541	SLEEP INHIBITORS FOR BENCH	6	\$55
1256	6' SUPER SLAT BENCH W/BACK, STEEL-PERM	120	\$693
1257	6' SUPER SLAT BENCH W/BACK, STEEL-PORT	120	\$748
1258	8' SUPER SLAT BENCH W/BACK, STEEL-PERM	120	\$727
1259	8' SUPER SLAT BENCH W/BACK, STEEL-PORT	140	\$799
1264I	6' REDWOOD DBL PEDESTAL FLAT BENCH, MC-ING	100	\$389
1264P	6' REDWOOD DBL PEDESTAL FLAT BENCH, MC-PORT	100	\$435
1264S	6' REDWOOD DBL PEDESTAL FLAT BENCH, MC-SURF	100	\$419
1265P	6' REDWOOD DBL PDSTL FLAT BENCH, MC-PORT, LA	100	\$581
1265S	6' REDWOOD DBL PDSTL FLAT BENCH, MC-SURF, LA	100	\$582
1268	8' BENCH, 2-3/8' LEGS M'THERM-PERM	200	\$588
12681	8' BENCH, 2-3/8' LEGS M'THERM-PORT	200	\$612
1281R	6' SLAT BENCH W/O BACK, RECYCLED-PERM	125	\$493
1283R	8' SLAT BENCH W/O BACK, RECYCLED-PERM	155	\$718
1287R	8' CONTOUR BENCH W/O BACK, RECYCLED-PERM	210	\$1,028
1288R	8' CONTOUR BENCH W/BACK, RECYCLED-PERM	285	\$1,397
1289I	6' REDWOOD BENCH, PAINTED FRAME-INGROUND	75	\$348
1289IGV	6' REDWOOD BENCH, GALV FRAME-INGROUND	100	\$333
1289P	6' REDWOOD BENCH, PAINTED FRAME-PORTABLE	75	\$348
1289PGV	6' REDWOOD BENCH, GALV FRAME-PORTABLE	100	\$333
1289S	6' REDWOOD BENCH, PAINTED FRAME-SURFACE MO	75	\$348
1289SGV	6' REDWOOD BENCH, GALV FRAME-SURFACE MOUNT	100	\$333
1290I	8' REDWOOD BENCH, PAINTED FRAME-INGROUND	120	\$408

12/9/2015

**Items are considered play components for the purpose of compliance with ADA guidelines.

This Price List is confidential and privileged, and is intended for the sole use of the person or entity to which it is addressed ("Recipient"). Any review, transmission, reproduction, publication (in any form or medium), dissemination or other use of, or taking of any action in reliance upon, this price list and the information contained herein without the express written authorization of Miracle Recreation Equipment Company is strictly prohibited. The Recipient shall keep confidential and shall not disclose this price list or the information contained herein to any third person or entity (private or governmental) except to such of its employees or agents who need to know for the purpose of purchasing products. The Recipient shall take all reasonable actions, including without limitation court proceedings, to restrain its employees and agents from unauthorized disclosure or use of this Price List or the information contained herein.



Phone: 800-695-2919
Fax: 800-211-5454
Email: info@buyboard.com

Welcome Monica [Log Off]

[Administration](#) | [RFQ](#) | [Reports](#) | [Shopping Cart](#) | [Help](#)

Search Results

Search:
 All
 Vendor Discounts Only
 Catalog Pricing Only

Show results Narrow Results:

Vendor	Description
Park Place Recreation Design, Inc.	5% Discount Off Miracle Recreation Equipment pricelist for Shade Canopies & Structures
Park Place Recreation Design, Inc.	5% Discount Off Miracle Recreation Equipment pricelist for Outdoor Bleacher & Seating Systems
Park Place Recreation Design, Inc.	15% Discount Off Miracle Recreation Equipment pricelist for Playground Sports Equipment
Park Place Recreation Design, Inc.	15% Discount Off Miracle Recreation Equipment pricelist for Playground Equipment

Refine Your Search:
[Vendors](#)
None Selected
[Price Range](#)
Show all prices
[Category](#)
None Selected
[Contract](#)
None selected

Extended Product Information

Reference Number:
Part Number: Catalog
Full Description:

Additional Searches:
[Search by Vendor](#)
[Browse Contracts](#)

Showing 1 to 4 of 4 entries

[First](#) [Previous](#) [1](#) [Next](#) [Last](#)

[Additional Resources](#)



Phone: 800-695-2919

Fax: 800-211-5454

Email: info@buyboard.com

Welcome Monica | Log Off |

Administration

RFQ

Reports

Shopping Cart

Help

Vendor Contract Information

[Back](#)

Search:

714-S437J

All

Vendor Discounts Only

Catalog Pricing Only

Vendor Name: Park Place Recreation Design, Inc.

Address: 4225 Woodburn

San Antonio, TX 78218

Phone Number: (210) 821-5878

Email: marilyn@mlracleparkplace.com

Federal ID: 74-2336170

Contact: Marilyn Ahrens

Accepts RFQs: Yes

Minority Owned Vendor: No

Women Owned Vendor: No

Contract Name: Parks & Recreation Equipment, Field Lighting Products & Installation

Contract#: 423-13

Effective Date: 10/01/2013

Expiration Date: 09/30/2016

Payment Terms: Net 30 days

Delivery Days: 30

Shipping Terms: Pre-paid and added to invoice

Freight Terms: FOB Destination

Ship Via: Common Carrier

Region Served: Texas Regions 1, 2, 3, 13, 15, 20

States Served: Texas

Quote Reference Number: 423-13

Return Policy: 2% restocking fee

Refine Your Search:

Vendors

None Selected

Price Range

Show all prices

Category

None Selected

Contract

None selected

Additional Searches:

[Search by Vendor](#)

[Browse Contracts](#)

Additional Resources

Contract Documents

Proposal Documents: [Click to view BuyBoard Proposal Documents](#)

Regulatory Notice: [Click to view Bonding Regulatory Notice](#)

Construction Services Advisory: [Click to view the Construction Related Goods and Services Advisory](#)

Contact us 800-695-2919

CERTIFICATE OF INTERESTED PARTIES

FORM 1295

1 of 1

Complete Nos. 1 - 4 and 6 if there are interested parties. Complete Nos. 1, 2, 3, 5, and 6 if there are no interested parties.	OFFICE USE ONLY CERTIFICATION OF FILING
1 Name of business entity filing form, and the city, state and country of the business entity's place of business. Park Place Recreation Designs, Inc. San Antonio, TX United States	Certificate Number: 2016-16969
2 Name of governmental entity or state agency that is a party to the contract for which the form is being filed. City of Mercedes Park Projects	Date Filed: 02/23/2016
Date Acknowledged:	

3 Provide the identification number used by the governmental entity or state agency to track or identify the contract, and provide a description of the goods or services to be provided under the contract.

5015-50-0306-5000-5000
 Purchase of Playground Equipment

4	Name of Interested Party	City, State, Country (place of business)	Nature of interest (check applicable)	
			Controlling	Intermediary

5 Check only if there is NO Interested Party.

6 AFFIDAVIT I swear, or affirm, under penalty of perjury, that the above disclosure is true and correct.

Marilyn Ahrens

Signature of authorized agent of contracting business entity

AFFIX NOTARY STAMP / SEAL ABOVE

Sworn to and subscribed before me, by the said *Marilyn Ahrens* 23rd day of February, 20 16, to certify which, witness my hand and seal of office.

Nathan C. Hartings

Signature of officer administering oath

Printed name of officer administering oath: Nathan C. Hartings Title: officer administering oath

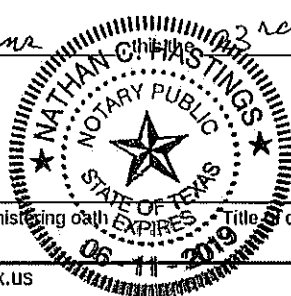

CERTIFICATE OF INTERESTED PARTIES

FORM 1295

1 of 1

Complete Nos. 1 - 4 and 6 if there are interested parties.
 Complete Nos. 1, 2, 3, 5, and 6 if there are no interested parties.

OFFICE USE ONLY CERTIFICATION OF FILING

1 Name of business entity filing form, and the city, state and country of the business entity's place of business.

Park Place Recreation Designs, Inc.
 San Antonio, TX United States

Certificate Number:
 2016-16969

Date Filed:
 02/23/2016

2 Name of governmental entity or state agency that is a party to the contract for which the form is being filed.

City of Mercedes Park Projects

Date Acknowledged:
 02/23/2016

3 Provide the identification number used by the governmental entity or state agency to track or identify the contract, and provide a description of the goods or services to be provided under the contract.

5015-50-0306-5000-5000
 Purchase of Playground Equipment

4	Name of Interested Party	City, State, Country (place of business)	Nature of interest (check applicable)	
			Controlling	Intermediary

5 Check only if there is NO Interested Party.

6 AFFIDAVIT I swear, or affirm, under penalty of perjury, that the above disclosure is true and correct.

 Signature of authorized agent of contracting business entity

AFFIX NOTARY STAMP / SEAL ABOVE

Sworn to and subscribed before me, by the said _____, this the _____ day of _____, 20_____, to certify which, witness my hand and seal of office.

 Signature of officer administering oath Printed name of officer administering oath Title of officer administering oath