

RECEIVED

HIDALGO COUNTY
URBAN COUNTY PROGRAM
UCP CONTRACT CHANGE ORDER REQUEST

MAR 10 2016

URBAN COUNTY PROGRAM

CITY/PCT. <u>City of La Villa, Hidalgo County</u> (Address) <u>916 South Mike Chapa, La Villa, TX 78562</u>	DATE <u>02/26/2016</u> CHANGE ORDER NO. <u>03</u>
CONTRACTOR/FIRM Saenz Brother Construction, LLC 3226 N. Victoria Road Donna, TX 78537 Phone #: <u>(956) 464-3400</u>	PROJECT/NAME/ACCT. NO. "City of La Villa – Waste Water Improvements Project" 5011/12/13-45-0310—5000-4500-UCP-ML

You are hereby requested to comply with the following changes from the contract plans and specifications:

<input type="checkbox"/>
<input type="checkbox"/>
<input checked="" type="checkbox"/>

Final Quantitative Adjustments
Unit Prices
Quantitative Addition

<input type="checkbox"/>
<input checked="" type="checkbox"/>
<input type="checkbox"/>

Quantitative Deletion
Time Extension
Other

REASON: City of La Villa requested construction of all-weather road access to existing mechanical building and new headworks facility and replacement of existing weir gate at oxidation ditch outfall with new and improved weir gate.

The Contractor's breakdown for the cost of the paving and site gate are listed in the following tabulation.

Item 1: Paving	
a. Construct concrete approaches according to plans 150.72 cu yds.	\$ 46,346.40
b. Construct caliche access drives according plans 435.15 cu. yds.	\$ 44,385.30
c. Provide and install SETs and pipe crossings according to plans 176 CY	\$ 5,500.00
Item 2: Weir Gate	
a. Provide and install according to plans Weir Gate 1 LS	\$ 20,000.00
Total Added Changes	\$ 116,231.70

Contract price prior to change order	\$ 583,000.00.
Net Increase/Decrease of this Change Order	\$ 116,231.70.
Contract Price with Change Order	\$ 699,231.70.

Increase/Decrease in time Forty – Five (45) days.

**HIDALGO COUNTY
URBAN COUNTY PROGRAM
UCP CONTRACT CHANGE ORDER REQUEST**

Richard D. Seitz, P.E. 3/14/2016
PROJECT ENGINEER SIGNATURE DATE

Richard D. Seitz 3/14/2016
PRINTING NAME DATE

[Signature] 3/14/16
CONTRACTOR'S SIGNATURE DATE

Fernando Suarez 3/14/16
PRINTING NAME DATE

(FOR URBAN COUNTY PROGRAM USE ONLY)

Scope Increase

Quantitative Addition/Deletion

Scope Decrease

Final Quantitative Adjustment

L/M Beneficiary Change/Impact

Other

Environmental Impact

Approved

Disapproved

Title: Director

Signature: _____
Diana R. Serna

Date: _____

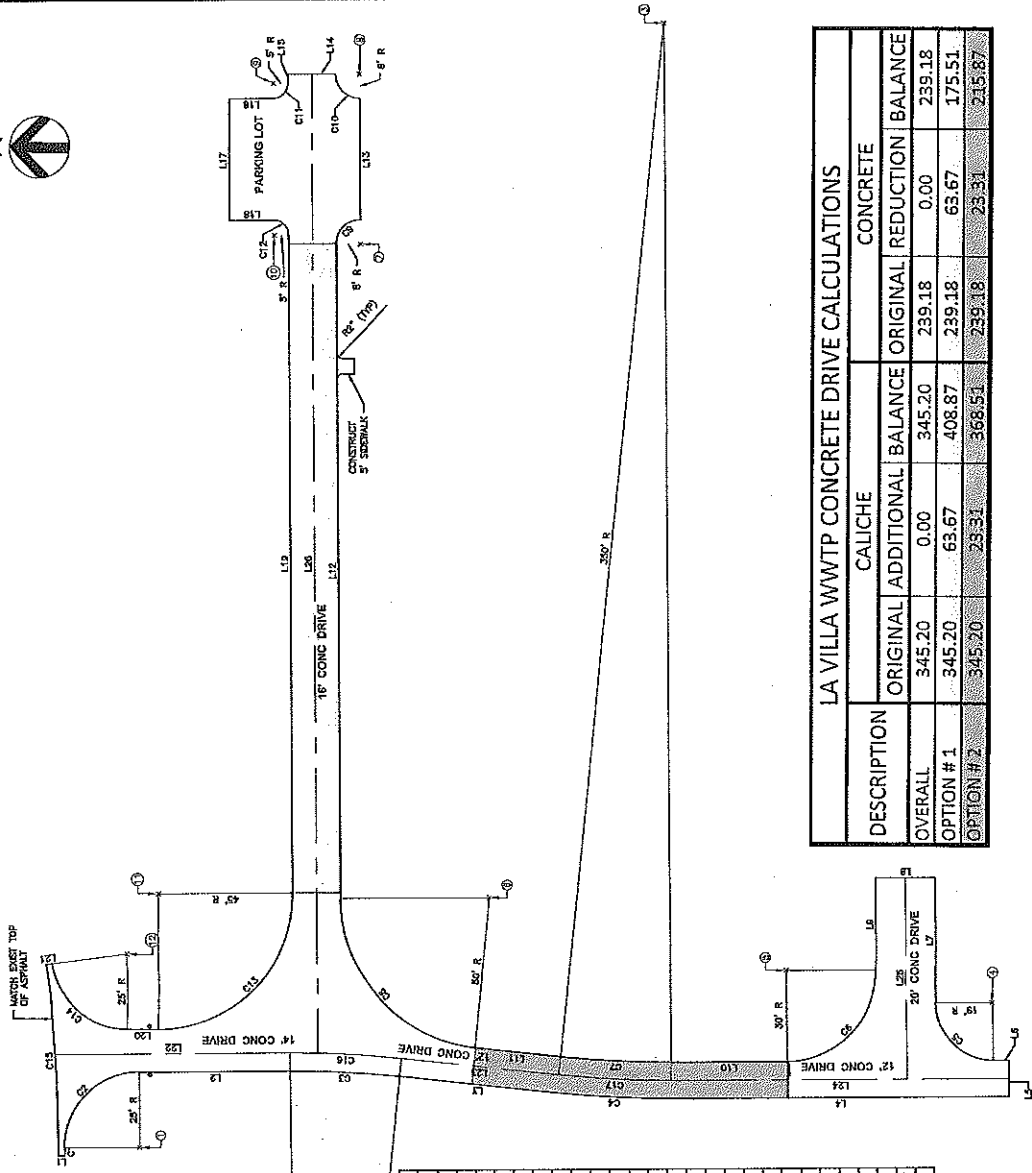

LINE #	LENGTH	DIRECTION
L1	2.000	S07°35'14.87"E
L2	50.511	S01°14'04.65"E
L3	53.262	S04°51'24.35"W
L4	112.766	S01°14'04.65"E
L5	12.000	N88°45'05.35"W
L6	3.001	S01°14'04.65"E
L7	41.809	N88°45'16.22"E
L8	20.000	N01°14'43.78"E
L9	30.845	N88°45'16.22"E
L10	26.752	S01°14'04.65"E
L11	28.938	S04°51'24.35"W
L12	21.678	N88°45'16.22"E
L13	46.000	N88°45'16.22"E
L14	18.000	N01°14'43.78"E
L15	3.000	N88°45'16.22"E
L16	15.000	S01°14'43.78"E
L17	40.000	N88°45'16.22"E
L18	27.887	N88°45'16.22"E
L19	15.000	S01°14'43.78"E
L20	16.411	S07°35'27.38"E
L21	2.000	S07°35'46.60"E
L22	78.377	S01°14'04.65"E
L23	53.262	S04°51'24.35"W
L24	112.766	S01°14'04.65"E
L25	66.654	S07°35'46.60"E
L26	32.649	N88°45'16.22"E

CURVE #	RADIUS	DELTA	CHORD LENGTH	CHORD BEARING	ARC LENGTH	ARC BEARING
C1	494.000	007°20'38"	2.814	N88°13'28.28"E	2.814	2.814
C2	25.000	089°42'45"	32.267	N46°03'28.60"W	38.145	38.145
C3	343.000	008°05'25"	36.448	N01°48'39.85"E	36.448	36.448
C4	358.000	038°05'28"	37.600	S01°48'39.85"W	37.648	37.648
C5	18.000	089°29'21"	28.868	S43°48'35.79"W	28.842	28.842
C6	30.000	009°00'38"	42.400	S48°14'24.21"E	47.130	47.130
C7	344.000	089°05'28"	38.565	S01°48'39.85"W	38.572	38.572
C8	50.000	083°53'32"	66.847	S48°48'20.28"W	73.215	73.215
C9	3.000	080°00'00"	11.314	N46°14'43.78"W	12.050	12.050
C10	8.000	080°00'00"	11.314	S47°45'16.22"W	12.586	12.586
C11	5.000	090°00'00"	7.071	S46°14'43.78"E	7.854	7.854
C12	5.000	090°00'00"	7.071	N45°45'16.22"E	7.854	7.854
C13	45.000	002°21'16"	50.035	S48°04'02.50"E	70.934	70.934
C14	26.000	032°28'41"	32.968	S47°31'22.87"W	35.934	35.934
C15	168.000	077°42'32"	63.448	N88°39'58.23"E	63.488	63.488
C16	348.000	068°05'28"	37.688	N01°48'39.85"E	37.104	37.104
C17	350.000	090°05'28"	37.103	S01°48'39.85"W	37.210	37.210

POINT NO	DESCRIPTION	NORTHING	EASTING
1	R CTR	1863552.641	1175235.448
2	R CTR	1863539.826	1175075.884
3	R CTR	1863536.681	1174975.663
4	R CTR	1863512.071	1174648.052
5	R CTR	1863294.728	1174267.533
6	R CTR	1863343.653	1174480.123
7	R CTR	1863537.233	1174885.492
8	R CTR	1863536.648	1175251.681
9	R CTR	1863541.237	1175748.028
10	R CTR	1863581.628	1175986.258
11	R CTR	1863595.154	1176476.638
12	R CTR	1863581.644	1176489.452

DESCRIPTION	CALICHE		CONCRETE	
	ORIGINAL BALANCE	ADDITIONAL BALANCE	ORIGINAL BALANCE	REDUCTION BALANCE
OVERALL	345.20	0.00	239.18	239.18
OPTION #1	345.20	63.67	239.18	175.51
OPTION #2	345.20	23.31	239.18	215.87

EXHIBIT "B"
PLANT DRIVE POINT DATA SHEET
1" = 20'

ENGINEERS CALCULATIONS OF QUANTITIES AND COST						
Material	Thickness in inches	Qty Sq ft	Qty Sq Yd	Qty Cu Yd	Unit Cost Per Cu. Yd.	Total Cost
Concrete	6	8139	904.33	150.72	\$ 307.50	\$ 46,346.40
Caliche	8	11481	1275.67	283.48	\$ 102.00	\$ 28,914.96
Caliche	8	1743	193.67	43.04	\$ 102.00	\$ 4,390.08
Caliche	14	2514	279.33	108.63	\$ 102.00	\$ 11,080.26
Total		15738	1748.67	435.15	\$ 102.00	\$ 44,385.30
					TOTAL	\$ 90,731.70
						\$ 20,000.00
						\$ 5,500.00
						\$ 116,231.70

CONVERSION OF SQ. YD. COST TO CU. YD. COST	
6" Concrete	904.33 sq yds at \$51.25 per sq yds = \$46,346.91 / 150.72 cu. Yds yields cost per cu. Yd. of \$307.50
6" Caliche	1275.67 sq yds at \$17.00 per sq yd = \$21686.39 \$21686.39 / 212.61 cu. Yds yields cost per cu. Yd. of \$102.00