

## **CONSTRUCTION MANAGEMENT AGREEMENT**

This Construction Management Agreement ("Agreement") effective as of \_\_\_\_ day of May, 2016, is by and between Le Fevre Engineering Management Consulting, LLC ("Construction Manager" or "CM") and Hidalgo County, Texas acting by and through its Urban County Program ("County").

### **RECITALS**

WHEREAS, County requires construction management services for the Delta Area Connector/East Lateral located within Hidalgo County Precinct No. 1 as is more particularly described in Schedule A (the "Project");

WHEREAS, the County of Hidalgo solicited Request for Qualifications (RFQ) for the development and establishment of a yearly pool for Construction Management Services;

WHEREAS, from which Construction Manager has been selected from the "Pool" of pre-qualified construction managers from response to the Request for Qualifications (RFQ); and

WHEREAS, County has selected the Construction Manager to provide construction management services within Hidalgo County Precinct No. 1, in accordance with Request for Qualifications (RFQ) Procurement Packet and through its procured approved pool of Construction Managers.

NOW THEREFORE, in consideration of the mutual covenants and conditions herein contained, County and Construction Manager do mutually agree as follows:

### **ARTICLE 1. SCOPE OF WORK**

CM agrees to perform the services identified in Exhibit B (the "Services"), which is attached to, and is part of, this Agreement, in accordance with the terms of this Agreement. In addition to the Services set forth in Exhibit B, CM shall provide the following Pre-Construction and Construction Phase services:

#### **1.01 Pre-Construction Phase**

- a. Participate in planning sessions with County
- b. Assist County and the design and construction teams with permitting related issues.

## 1.02 Construction Phase

a. Provide administrative, management and related services to coordinate scheduled activities and responsibilities of selected Contractor and the Hidalgo County Drainage District Number One (collectively the "Contractor") engaged on the Project and the design team with each other to manage the Project in accordance with the latest approved cost estimate and County's Project budget, the Project schedule agreed between County, the selected Contractors and the CM (the "Project Schedule") and the contract documents identified in the agreements negotiated with the Contractor and the design team (the "Contract Documents").

b. Update and reissue the Project Schedule as required to show current conditions. If an update indicates that the previously approved Project Schedule may not be met, the CM shall recommend corrective action to the County.

c. Use best efforts to obtain satisfactory performance from the Contractors and the design team and recommend courses of action to the County when requirements of a contract are not being fulfilled.

d. Monitor the approved cost estimate and show actual costs for activities in progress and estimates for uncompleted tasks by way of comparison with such approved estimate.

e. Develop cash flow reports and forecasts for the Project and advise the County as to variances between actual and budgeted or estimated costs. Provide detailed written weekly progress reports describing work completed during the preceding week, percentage of work completed to date, cost of work completed to date, percentage of budget utilized to date, change orders requested and approved, and identifying any variances from schedule or cost projections or noteworthy situations, all in a form that is capable of being submitted to and understood by County and any involved organizations.

f. Maintain accounting records for authorized work performed under unit costs, additional work performed on the basis of actual costs of labor and materials, and other work requiring accounting records. All accounting records shall be maintained in a manner and level of detail that is acceptable to the County and that is in accordance with generally accepted accounting and auditing practices.

g. Develop and implement procedures for the review and processing of applications for payment from Contractor working on the Project and the design team for progress and final payment.

h. Based on its observations and evaluations of each application for payment, review and certify the amounts due to the Contractors working on the Project and the design team and submit such certification and application for payment, together with periodic draw requests, in a form acceptable to County for review and approval.

i. Determine in general that the work performed by Contractor engaged on the Project or the design team is being performed in accordance with the requirements of the Contract Documents, endeavoring to guard the County against defects and deficiencies in the work. The CM, as agent for the County, shall have authority, upon written authorization from the County, to require additional inspection or testing of the work in accordance the provisions of the Contract Documents, whether or not such work is fabricated, installed or completed.

j. Review requests for changes, assist in negotiating change order proposals, submit recommendations to County, and, if they are accepted, review change orders, construction change directives or other contract modifications which incorporate the design team's modifications to the Contract Documents.

k. Assist the County in the review, evaluation and documentation of any claims pursuant to the applicable construction or design agreements.

l. In collaboration with the design team and the Contractor selected to work on the Project, establish and implement procedures for expediting the processing and approval of shop drawings, product data, samples and other submittals.

m. Coordinate the correction and completion of the work. Following issuance of a Certificate of Substantial Completion of the work or a designated portion thereof, evaluate the completion of the work and make recommendations to the County when work is ready for final inspection. Assist the County and any representatives of the County in conducting final inspections.

## ARTICLE 2. PERFORMANCE OF SERVICES

2.01. Performance shall commence on the date specified in a notice to proceed issued by County to CM and shall continue until sixty (60) days after Final Completion of the Project, unless earlier terminated in accordance with the terms of this Agreement.

2.02 Additional services, if needed, will be completed within a time frame to be mutually decided and set by the parties to this Agreement. CM shall perform the Services using CM-owned materials, supplies and equipment to the extent possible.

2.03 In performing the Services, CM shall assign qualified (and, if required by applicable law, licensed) personnel and perform in accordance with the professional standards and with the skill, diligence and quality control/quality assurance measures expected of a recognized professional project management and construction consulting firm performing services of a similar nature in the State of Texas and that has experience performing such Services for similar projects (the "Standard of Care"). CM is hereby given notice that County will be relying upon the accuracy, competence, and completeness of CM's Services.

2.04 CM shall at all times comply with all applicable laws, ordinances, statutes, rules, and regulations. In addition, when at the Project, CM and its employees and agents shall comply with all the County's personnel safety rules and all applicable conditions or requirements of any permit or authorization, order or directive issued by any court or governmental regulatory agency with jurisdiction over the Project.

## ARTICLE 3. CM'S REPRESENTATIONS

CM represents that is fully experienced and properly qualified to perform the Services as provided under this Agreement and that it is, and will remain for the duration of this Agreement, properly permitted, licensed, equipped, organized and financed to perform such Services.

## ARTICLE 4. TERM

This Contract is for the period of twelve (12) months, effective May 25, 2016 and will expire August 25, 2017 or unless sooner terminated as provided by herein.

#### ARTICLE 5. COMPENSATION AND PAYMENT

As consideration for rendering the Services provided for in this Contract, the County agrees to pay the Construction Manager the amounts specified in Exhibit B attached hereto payable against written invoice submitted by Construction Manager stating hours worked and the task described on Exhibit B. The request for payment shall be made using forms acceptable to the County and shall show the total amount with hours by each category of individual at the hourly fee for such individual as shown in Exhibit C (attached hereto and incorporated herein) and the sub tasks completed on Exhibit B attached hereto earned to the date of submission and the amount due and payable as of the date of the current billing. Upon receipt of said request for payment, County shall submit a requisition for payment of said services in the customary manner provide for payments utilized by Hidalgo County, Texas. Construction Manager agrees to separately account for the receipt and/ or expenditure of funds received pursuant to this Agreement and to keep adequate books and records of all such receipts and/or expenditures. All payments to Construction Manager shall be mailed to the address shown in article paragraph 21, hereof. Failure by County to object, or payment made by County, shall not constitute a waiver of any claim or objection which County may have, nor shall any failure to object or make payment bar County from refusing to make payment because of a breach by CM of any warranty, representation or condition of this Agreement.

#### ARTICLE 6. INDEPENDENT CONTRACTOR

Except as otherwise expressly provided in this Agreement or otherwise authorized in writing by County, in performing the Services and incurring expenses under this Agreement, CM shall operate as, and have the status of, an independent contractor, CM shall be solely responsible for determining the means and methods of performing the Services and shall have complete charge and responsibility for CM's personnel engaged in the performance of the Services.

#### ARTICLE 7. ASSIGNMENT

CM shall not assign any of its rights, interests or obligations under this Agreement or subcontract any of the Services to be performed by under this Agreement without the express written consent of County. Any subcontract or Assignment shall be

subject to all terms of this Agreement. County shall have the right to assign this Agreement to a third party upon notice to CM.

#### ARTICLE 8. INSPECTION OF WORK

The County has the right at all reasonable times to inspect or otherwise evaluate the work performed or being performed hereunder and the premises in which it is being performed. If any inspection or evaluation is made on the premises of the Construction Manager, or a subcontractor, the Construction Manager shall provide and require its subcontractor, if any, to provide all reasonable facilities and assistance for the safety and convenience of the inspectors in the performance of their duties. All inspections and evaluations shall be performed in such a manner as will not unduly delay the work.

#### ARTICLE 9. AMENDMENTS

9.01 If it becomes necessary at any time during the Agreement term to change the scope of work, the contract period, the maximum amount payable, the complexity, or the character of this Agreement, an amendment must be prepared and executed within the Agreement term. The County retains the right to reject any such amendment proposed by the Construction Manager unless the County finds the proposed amendment necessary to complete the work authorized herein. Any such amendments shall be made in writing agreed to by all parties hereto and duly executed before the end of the Agreement term as specified.

9.02 If the County finds it necessary to require changes in completed work because of errors made by the Construction Manager, the County shall require the Construction Manager to correct the work at no cost to the County and without amendment to the contract. If the changes are made at the request of the County and are not due to errors of the Construction Manager, the County will reimburse the Construction Manager for the additional work at the hourly fees established in Exhibit C. If payment for the additional work will cause the maximum amount payable to be exceeded, an amendment shall be executed in accordance with the terms of this provision.

## ARTICLE 10. OWNERSHIP OF DOCUMENTS

Notwithstanding any other provision herein to the contrary:

10.01 Without payment of additional compensation to the CM, any documents prepared by the CM for this Project shall become the County's property upon completion, cancellation, suspension or termination of the Services or this Agreement and upon payment of all sums due to the CM for work properly performed if applicable prior to the date of termination. Reproducible copies of the original documents shall be turned over to the County at that time in a format reasonably acceptable to County.

10.02 Reuse of any of these documents by the County shall be at County's risk. The CM shall be permitted to retain copies, including reproducible copies, of any or all documents for such use it may require, except that use of any document without substantial modification shall be attributed to the County and shall have County's prior written consent. Any such re-use by the CM shall be at its own risk.

10.03 To the extent that the County has paid for the CM's Services under this Agreement, the CM hereby grants to the County a non-exclusive, perpetual, royalty-free license to the intellectual property embodied in the documents prepared by the CM in connection with the Project. County may make any changes, additions, and deletions thereto, all without further permission or consent of the CM, although the CM shall not be liable to the County or any third party as a result of any such changes, additions, or deletions.

## ARTICLE 11. INSURANCE

Construction Manager agrees to provide liability insurance covering its activities in providing the services for County in an amount not less than the minimum amounts prescribed by the Texas Tort Claims Act, §100.001, et seq., Texas Civil Practices and Remedies Code, and shall furnish County a certificate of insurance, attached hereto as Exhibit \_\_\_\_, issued by the insurer that such insurance is in full force and effect.

## ARTICLE 12. VOLUNTARY TERMINATION

The County may terminate this Agreement at any time for any reason or no reason at all upon the giving of thirty (30) days prior written notice to the other party. All earned fees of Construction Manager for work satisfactorily performed by Construction

Manager shall be paid in accordance with the hours worked by Construction Manager at the hourly rates described in Exhibit C up to including the date of termination.

#### ARTICLE 13. INDEMNIFICATION

CM agrees to indemnify, defend and hold harmless County, and its respective officers, elected officials, employees, representatives, and agents (collectively, the "Indemnification Parties"), against any all claims, losses, damages, liabilities, costs or expenses (including, without limitation, attorney's fees and costs of litigation and or settlement, whether incurred as a result of a claim by a third party or an indemnitee hereunder) arising out of the Services performed pursuant to this Agreement, except to the extent arising out of the willful misconduct of the Indemnified Party that is seeking to be indemnified.

#### ARTICLE 14. NO ASSIGNMENT

Except as otherwise herein provided, Construction Manager, may not assign the obligations or rights under this Agreement to any person without the prior written consent of County.

#### ARTICLE 15. CONFLICT

Nothing in this Agreement shall be construed so as to require the commission of any act contrary to law, and whenever there is any conflict between any provision of this Agreement and any present or future law, ordinance or administrative, executive or judicial regulation, order or decree, or amendment thereof, contrary to which the parties have no legal right to contract, the latter shall prevail, but in such event the affected provision or provisions of this Agreement shall be modified only to the extent necessary to bring them within the legal requirements and only during the time such conflict exists.

#### ARTICLE 16. TERMINATION BY COUNTY

If Construction Manager fails to deliver quality service, fails to achieve the defined goals, outcomes, strategies and outputs set by County, or if Construction Manager fails to comply with any conditions in this Agreement, then County shall have the right to terminate this Agreement upon the giving of ten (10) days prior written notice to Construction Manager. Construction Manager shall receive payment of the documented hours spent working on the Project at hourly rates stated in Exhibit C.

ARTICLE 17. NO WAIVER

No waiver by County of any breach of any provision of this Agreement shall be deemed to be a waiver of any preceding or succeeding breach of the same or any other provision hereof.

ARTICLE 18. ENTIRE CONTRACT

This Agreement contains the entire agreement between the parties hereto, and each party acknowledges that neither has made (either directly or through any agent or representative) any representations or agreements in connection with this Agreement not specifically set forth herein. This Agreement may be modified or amended only by agreement in writing executed by County and Construction Manager, and not otherwise.

ARTICLE 19. VENUE

This Agreement shall be construed under and in accordance with the laws of the State of Texas, and all obligations of the parties created hereunder are performable in Hidalgo County, Texas. The parties hereby consent to personal jurisdiction in Hidalgo County, Texas.

ARTICLE 20. ATTORNEYS FEES

In the unlikely event that a dispute occurs which is litigated or arbitrated, or a cause of action in law or equity is filed concerning the operation, construction, interpretation, or enforcement of this Agreement, the losing party shall bear the cost of the attorney's fees incurred by the prevailing party and any and all costs applicable thereto, including, but not limited to, court costs, deposition fees, expert witness fees, out-of-pocket expenses and travel expenses which are incurred by the prevailing party.

ARTICLE 21. NOTICES

Except as may be otherwise specifically provided in this Contract, all notices, demands, requests or communications required or permitted hereunder shall be in writing and shall either be (i) personally delivered against a written receipt, or (ii) sent by registered or certified mail, return receipt requested, postage prepaid and addressed to the parties at the addresses set forth below, or at such other addresses as may have been theretofore specified by written notice delivered in accordance herewith:

If to County: County of Hidalgo  
Attention: County Judge  
100 E. Cano, 2<sup>nd</sup> Floor  
Edinburg, Texas 78539

If to Construction Manager: LeFevre Engineering & Management Consulting,  
LLC  
Richard LeFevre, PE/President  
612 Nolana Avenue, Suite 520  
McAllen, Texas 78504

Each notice, demand, request or communication which shall be delivered or mailed in the manner described above shall be deemed sufficiently given for all purposes at such time as it is personally delivered to the addressee or, if mailed, at such time as it is deposited in the United States mail.

ARTICLE 22. DISCOVERY OF CONFLICTS, ERRORS, OMISSIONS OR DISCREPANCIES

In the case of conflicts, discrepancies, errors or omissions among the various parts of this Agreement, CM shall submit the matter immediately to County for clarification. Any Services affected by such conflicts, discrepancies, errors or omissions which are performed by CM prior to clarification by County shall be at CM's risk.

ARTICLE 23. RESPONSIBILITY TO CORRECT DEFICIENCIES

It shall be CM's responsibility to correct, in a timely fashion and at CM's sole expense, any deficiencies in its Services resulting from CM's failure to act in accordance with the Standard of Care, provided such deficiencies are reported to CM within one hundred twenty (120) days after completion of the Services.

ARTICLE 24. FORCE MAJEURE

Neither party hereto shall be considered in default in the performance of its obligations hereunder to the extent that performance of any such obligation is prevented or delayed by any cause, existing or future, which is beyond in reasonable control of such party, and which by that party's exercise of due diligence and foresight could not reasonably have been avoided. Upon removal of such cause, the party affected shall resume its performance as soon as reasonably possible. Neither CM's financial inability

to perform nor an event which could have been prevented had CM acted in accordance with the Standard of Care shall be deemed to be an event of Force Majeure.

ARTICLE 25. EXECUTION OF DOCUMENTS

The parties hereto covenant and agree that they will execute such other and further instruments and documents as are or may become necessary or convenient to effectuate and carry out the terms of this Agreement.

ARTICLE 26 BINDING CONTRACT

This Agreement shall be binding upon and inure to the benefit of the parties hereto and their respective legal representatives, successors, and assigns where permitted by this Agreement.

ARTICLE 27 GENDER

All pronouns used in this Agreement shall include the other gender, whether used in the masculine, feminine or neuter gender, and the singular shall include the plural whenever and as often as may be appropriate

ARTICLE 28. AUTHORITY

The execution and performance of this Contract by County and Construction Manager have been duly authorized by all necessary laws, resolutions or corporate action, and this Agreement constitutes the valid and enforceable obligations of County and Construction Manager in accordance with its terms.

ARTICLE 29 COMMITMENT OF CURRENT REVENUES

In the event that, during any term hereof, the County does not appropriate sufficient funds to meet to the obligations of this Agreement, the County may terminate this Agreement upon thirty (30) days written notice to the Construction Manager. County agrees, however, to use reasonable efforts to secure funds necessary for the continued performance of this Agreement. The parties intend this provision to be a continuing right to terminate this Agreement at the expiration of each budget period of the County pursuant to the provisions of Tex. Loc. Govt. Code Ann. §271.903 (Vernon Supp. 1995).

ARTICLE 30. IMMUNITIES

Nothing in this Agreement is intended to and County does not hereby waive, release or relinquish any right to assert any of the defenses County enjoys by virtue of the state or federal constitution, laws, rules or regulations, and any sovereign, official or qualified immunity available to County as to any claim or action of any person, entity, or individual against County.

Executed as of the day and year written above.

CONSTRUCTION MANAGER:  
LeFEVRE CONSTRUCTION MANAGERING &  
MANAGEMENT CONSULTING, LLC

BY: \_\_\_\_\_  
Wesley Richard LeFevre, PE/President

COUNTY:  
HIDALGO COUNTY

BY: \_\_\_\_\_  
Hon. Ramon Garcia, County Judge

ATTEST:

\_\_\_\_\_  
Arturo Guajardo, Jr., County Clerk

APPROVED AS TO FORM:

ATLAS, HALL & RODRIGUEZ, LLP

By: \_\_\_\_\_  
Stephen L. Crain

EXHIBITS

- EXHIBIT A -Project Description
- EXHIBIT B -Scope of Services to be provided by Construction Manager
- EXHIBIT C -Work Schedule
- EXHIBIT D -Construction Manager's Rates
- EXHIBIT E -Certificate of Insurance (Hidalgo County)

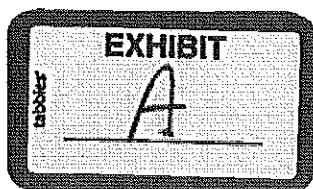

**Hidalgo County – Precinct No. 1 GLO Flood &  
Drainage Improvement Project known as  
Delta Area Connector/East Lateral Project**

**Phase I, II, III**

**GLO Contract No. 12-406-000-6453**

**DRS210068/DRS220068**





PHASE II

CHINAUX EXCAVATION  
BY CONTRACT



THE SEAL APPEARED ON THIS DOCUMENT  
WAS FORGEOVER BY  
OSCAR CAUSINO, P.E., No. 981101  
DATE: 11/13/14  
AFTERWARD BY A COURT ORDER  
RENDERED IN LITIGATION IN AN OFFICE  
PROVIDED BY THE STATE BAR

No.	Description	Chg. No.	Date

**DAS**

1001 E. Exposition St., Suite 100  
Houston, TX 77055  
Tel: (281) 447-8184  
Fax: (281) 447-8184



**DLINC**  
DOS LOGISTICS, INC.

150 E. FM ROAD, SUITE 200  
HOUSTON, TX 77055  
PHONE: (281) 447-8184  
FAX: (281) 447-8184

Project: EAST LATERAL  
EXHIBIT CROSSING  
ROUND 21 - PHASE I

Sheet Title:  
PROPOSED CONSTRUCTION LIMITS

Scale: 1" = 40'  
Date: 11/13/14  
Drawn by: [Name]  
Checked by: [Name]

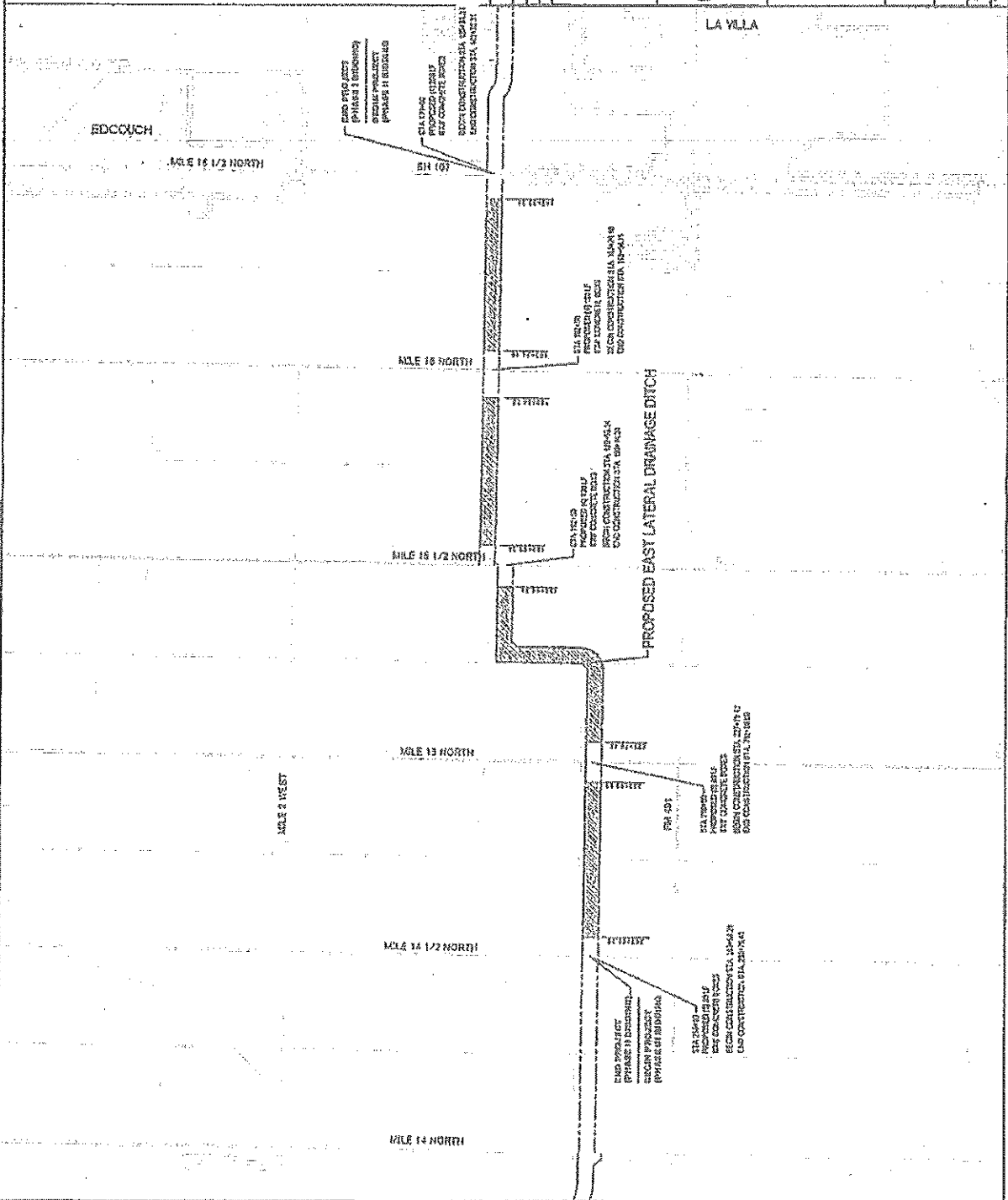

Small text at the bottom of the page, likely a reference or disclaimer.



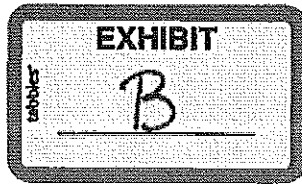

SCOPE OF SERVICES

Urban County Program Year \_\_\_\_ (201\_\_) Delta Area Connector/East Lateral

PREPARED BY:

**LeFEVRE ENGINEERING & MANAGEMENT CONSULTING, LLC.  
(LEMC)**

The County of Hidalgo, Texas, proposes to construct Urban County Program Year \_\_\_\_  
(201\_\_) Delta Area Connector/East Lateral.

The following tasks are based on a twelve (12) month contract. Any additional time will be negotiated with the County.

**Project Tasks**

**Task 1 – Observation, Management, & Coordination of County Forces for Construction of the Delta Area Connector/East Lateral**

1. Prepare and conduct a preconstruction meeting with all stakeholders to establish responsibilities and guidelines for all entities involved in the project.
2. Develop project objectives by reviewing project proposals and plans; conferring with the County and Project Engineer.
3. Determine project responsibilities by identifying project phases and elements; assigning personnel to phases and elements of the construction.
4. Work with Project Engineer and Owner to determine project specifications by reviewing project design, customer requirements, and performance standards.
5. Determine project schedule by studying project plan and specifications; calculating time requirements in coordination with project engineer and HDDNo.1 personnel.
6. Maintains project schedule by monitoring project progress; coordinating activities; resolving problems that may occur in project construction.
7. Control project plan by reviewing design, specifications, and plan and schedule changes; recommending actions to Owner and/or Project Engineer
8. Prepares construction project status reports by collecting, analyzing, and summarizing information and trends and recommending actions to Owner and Project Engineer.
9. Ensure compliance with federal, state, county and local regulations.
10. Maintain competent supervisory staff to coordinate and provide general direction of the work and progress of the contractors on the project.
11. Observe the work as it is being performed for general conformance with working drawings and specifications.
12. Establish procedures for coordinating among the public, owner, engineer, and contractors with respect to all aspects of the project.
13. Implement such procedures; maintaining job site records and making appropriate progress reports to owner on a weekly basis.



7. Control project plan by assisting County with reviewing design, specifications, and plan and schedule changes; recommending actions to Owner and/or Project Engineer
8. Prepares construction project status reports by collecting, analyzing, and summarizing information and trends and recommending actions to Owner and Project Engineer.
9. Ensure compliance with federal, state, county and local regulations.
10. Maintain competent supervisory staff to coordinate and provide general direction of the work and progress of the contractors on the project.
11. Observe the work as it is being performed for general conformance with working drawings and specifications.
12. Establish procedures for coordinating among the public, owner, project engineer, and contractors with respect to all aspects of the project.
13. Implement such procedures; assisting Contractor with maintaining job site records and making appropriate progress reports to owner on a weekly basis.
14. Insure delivery of materials to off-site areas of storage and oversight of County resources used for delivery.
15. Implement labor policy for Contractor in conformance with the requirements of the public owner and other State and Federal requirements for project.
16. Review the safety and equal opportunity programs of each Contractor for conformance with the public owner's policy and making recommendations.
17. Review and process all applications for payment by involved contractors and material suppliers in accordance with the terms of the contract.
18. Make recommendations for and processing requests for changes in the work and maintaining records of change orders.
19. Schedule and conduct job meetings to ensure orderly progress of the work.
20. Develop and monitor a project progress schedule.
21. Coordinate and expedite the work of all contractors.
22. Provide periodic status reports to owner, or project engineer
23. Establish and maintain a cost control system and conducting meetings to review costs.
24. Submission of Certified Payroll on a weekly basis to the Owner.
25. Submit Urban County Monthly Employment Utilization Reports to Owner.
26. Submit Section 3 Monthly Reports.
27. Submit Payroll Deductions for Employees (if any)
28. Submit photos with status reports.
29. Review and assist Project Engineer with preparation of As-Builts.
30. Conduct weekly meetings with all stakeholders to discuss progress (via teleconference call)
31. Conduct monthly meetings with all stakeholders in person to discuss project progress, monthly invoicing, etc.
32. Coordination of material testing for proposed project.

Contract Amount:

\$ 96,130.00

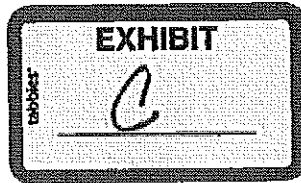

Hourly Rates of Construction Manager

Urban County Program Year \_\_\_\_ (201\_\_) Delta Area Connector/East Lateral

PREPARED BY:  
**LeFEVRE ENGINEERING & MANAGEMENT CONSULTING, LLC.**  
**(LEMC)**

Task 1 -- Construction Phase Engineering, Inspection, Construction Staking, Administration	\$83,535.00
Task 2 -- Construction Management, Administration, Construction Phase Engineering	\$96,130.00
<b>Total</b>	<b>\$179,665.00</b>

This Fee is based on a twelve  
(12) month contract.

HOURLY FEES

PRINCIPAL	\$200.00/HOUR
PROJECT ENGINEER	\$175.00/HOUR
PROJECT MANAGER	\$130.00/HOUR
DESIGNER/TECHNICIAN	\$ 85.00/HOUR
ADMINISTRATIVE	\$ 85.00/HOUR
INSPECTOR/PROJECT REPRESENTATIVE	\$ 75.00/HOUR

\*Reimbursables, Materials, and Travel are incorporated into hourly fees for individuals and will not be requested for this project.

COUNTY OF HDALCO - PRECINCT NO. 1  
 CONSTRUCTION MANAGEMENT  
 DELTA AREA CONNECTOR/EAST LATERAL  
 EXHIBIT C

ID	Task Name	Duration	Start	Finish
1	Approval of Contract to LEVE	1 day	Wed 4/23/16	Wed 4/23/16
2	Construction Management Preliminary Phase (Delta Area Connector/East Lateral)	45 days	Fri 5/1/16	Thu 7/22/16
3	Construction Stage (Delta Area Connector/East Lateral) Phase II & III	251 days	Mon 4/11/16	Fri 4/16/17
4	Restoration of A-ward by Earthier	10 days	Mon 4/11/16	Fri 4/23/16
5	Notice to Proceed for Construction - Delta Area Connector/East Lateral	1 day	Mon 4/25/16	Mon 4/25/16
6	Construction Management and oversight	303 edays	Tue 4/26/16	Sun 4/17/17
7	Construction Final Inspection	15 days	Mon 5/1/17	Fri 5/19/17
8	Owner's Acceptance of Project	10 days	Mon 4/27/17	Fri 4/14/17
9	104 - Construction Stage (Delta Area Connector/East Lateral) Phase I - Completion	281 days	Wed 4/28/16	Wed 4/19/17
10	Construction Management and oversight	350 edays	Wed 4/27/16	Wed 4/25/17
11	Constructor Final Inspection	10 days	Wed 4/6/17	Tue 4/18/17
12	Owner's Acceptance of Project	1 day	Wed 4/19/17	Wed 4/19/17

Task: **Delta Area Connector/East Lateral**

Task ID: **104**

Task Name: **Construction Stage (Delta Area Connector/East Lateral) Phase I - Completion**

Task Description: **Construction Management and oversight**

Task Summary: **Construction Management and oversight**

Project Summary: **Construction Stage (Delta Area Connector/East Lateral) Phase I - Completion**

External Milestones: **Construction Stage (Delta Area Connector/East Lateral) Phase I - Completion**

Manual Summary: **Construction Stage (Delta Area Connector/East Lateral) Phase I - Completion**

Manual Task: **Construction Stage (Delta Area Connector/East Lateral) Phase I - Completion**

Duration: **281 days**

Manual Summary Path: **Construction Stage (Delta Area Connector/East Lateral) Phase I - Completion**

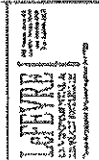

LARRY  
CONSTRUCTION MANAGEMENT

