

# Requisition

Req # 00339174

PO # 759817

Date: 03/22/17

Bill To:   x  
              x

Vendor : 221562  
 HALFF ASSOCIATES, INC.  
 5000 WEST MILITARY HIGHWAY, SUITE  
 100  
 MCALLEN TX 78503  
 FAX (214)739-0108

Ship To: HIDALGO CO. PCT 4  
 1051 N. DOOLITTLE  
 EDINBURG TX 78542

Contact: NICK PEREZ  
 956-383-3112

Contract No: C-16-188-05-10

Special Instructions:  
 PCT#425

QUANTITY	UOM	DESCRIPTION	UNIT PRICE	AMOUNT
1.00	LOT	C-16-188-05-10, EXP. 05/09/2017 CC APPROVAL ON 03/21/2017, AI-58983  Work Authorization No. 3 Halff Associates, Inc. C-16-188-05-10 for "Building Repairs, Renovations, Alteration, Additions and/or Other Related Services to County Owned Buildings" for the Facility Improvements  J.R. "Milo" Ponce Memorial Park located at 3516 E. FM 2812 in Edinburg, TX in Hidalgo County Precinct 4. DO NOT DUPLICATE ORDER		
		CC "Building Repairs, Renovations, Alteration, Additions and/or Other Related Services to County Owned Buildings" for the Facility Improvements for J.R. "Milo" Ponce Memorial Park	48,090.00	48,090.00
		<u>Account No</u>  7-1100-452-00-124-009-0-334	<u>Encumbrance</u>  48,090.00	
			Freight	.00
			Total	48,090.00
		REPORT ROAD HAZARDS 1-866-HCR-SAFE OR 1-866-427-7233		

Authorized By: \_\_\_\_\_

**INVOICE**



ENGINEERS ARCHITECTS SCIENTISTS PLANNERS SURVEYORS

**REMITTANCE ADDRESS**  
**Half Associates, Inc**  
**P.O. Box 678316**  
**Dallas, TX 75267**  
**www.halff.com**

**RECEIVED**  
 APR 28 2017  
 BY: *Jack P. [Signature]*

Hidalgo County Commissioner's Court  
 1051 North Doolittle Road  
 Edinburg, TX. 78542  
 Attention: Ms. Maria 'Lulu' Lucio

Invoice Date : 04/25/2017  
 Invoice # : M224761  
 Project : 31806  
 Invoice Group : 03  
 Client Code : HIDAL5

Project Name : Hidalgo County\2016-2017 Various WA

For Professional Services Rendered through: 4/16/2017

Re: MEP, Civil Engineering, Surveying Services  
 Project Name: J.R. "Milo" Ponce Memorial Park Improvements  
 Edinburg, TX  
 Contract Number: C-16-188-05-10 \Purchase Order #759817  
 Work Authorization #03

\*\* Please contact Maribel Martinez (956-664-0286)  
 with any questions regarding this invoice.

Phase / Task / Name	Fee	Previous Amount	% Complete	Current Amount	Total Fee Earned
WA03 -- J.R, "Milo" Ponce Memorial Park	48,090.00	0.00	55.71	26,790.00	26,790.00
<b>Totals:</b>	<b>48,090.00</b>	<b>0.00</b>	<b>55.71</b>	<b>26,790.00</b>	<b>26,790.00</b>
Total Fee Earned To Date					26,790.00
Less Previous Billings					0.00
<b>Amount Due this Invoice</b>					<b>26,790.00</b>

TERMS: DUE UPON RECEIPT  
**ORIGINAL**

(214) 346-6200

(214) 739-0108 Fax

AVO 31806

Invoice # M224761

Date: 4/25/2017

Hidalgo County - Professional Engineering Contract # C-16-188-05-10

Improvements for J.R. "Milo" Ponce Memorial Park \PO 759817

Work Authorization WA-03: Billing Summary

Phase/Task	Scheduled Value (\$)	Percent Complete (%)	Total Fee Earned (\$)	Previous Billing (\$)	Current Amount (\$)
Facility Improvement Design					
Landscape Architecture	10,000.00	70	7,000.00	0.00	7,000.00
Civil Engineering	6,595.00	70	4,616.50	0.00	4,616.50
Survey	6,595.00	100	6,595.00	0.00	6,595.00
Electrical Engineering	9,005.00	70	6,303.50	0.00	6,303.50
Structural Engineering (Chanin)	3,250.00	70	2,275.00	0.00	2,275.00
RAS (C. Gonzalez)	1,650.00	0	0.00	0.00	0.00
Bid	3,280.00	0	0.00	0.00	0.00
Construction Administration	7,715.00	0	0.00	0.00	0.00
	TOTAL	55.71%	26,790.00	0.00	26,790.00







J.R. "MIL" PONCE  
Memorial Park  
Edinburg, Texas 78542



**HALFF**  
ARCHITECTS  
INCORPORATED  
10000 W. HIGHTWAY 170  
DALLAS, TEXAS 75243  
TEL: (214) 343-7000  
FAX: (214) 343-7001

Revised	By	Date

**PROGRESS SET**  
FOR INTERIM REVIEW ONLY  
THIS SET OF DRAWINGS IS FOR INTERIM REVIEW ONLY AND IS NOT TO BE USED FOR CONSTRUCTION. ANY CHANGES TO THIS SET MUST BE APPROVED BY THE ARCHITECT. THE ARCHITECT'S OFFICE SHALL BE RESPONSIBLE FOR THE PROGRESS SET.

Project No.	2102220000
Revision	04.13.17
Drawn By	AC
Checked By	ME
Scale	AS SHOWN
Sheet Title	OPERATOR SET

GATE DETAIL  
C3-0  
Sheet Number

6S197-1L  
TYPICAL  
OPERATOR SET

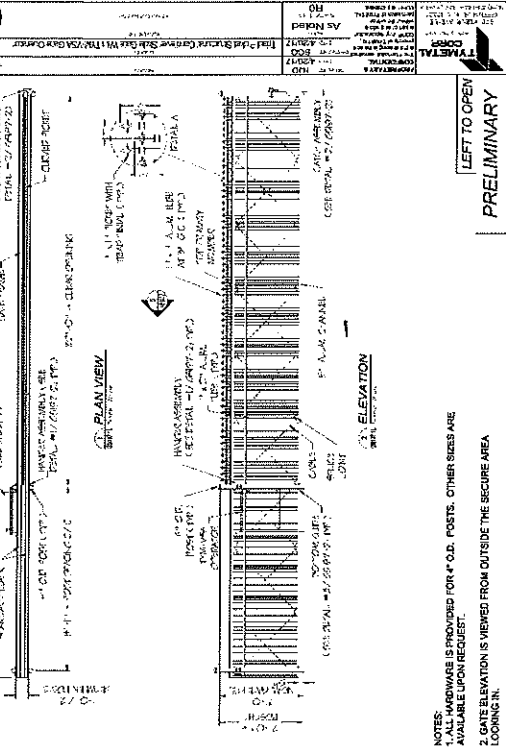

**NOTES:**  
1. ALL HARDWARE IS PROVIDED FOR 4\"/>

6S197-3  
TYPICAL  
OPERATOR SET

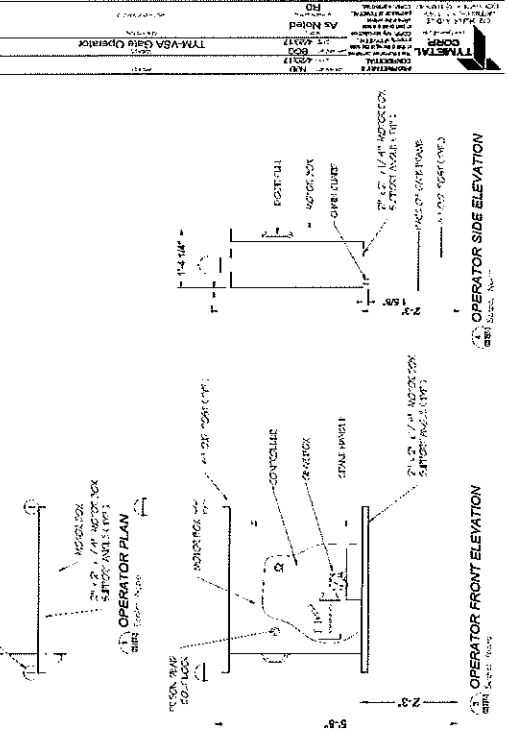

6S197-1R  
TYPICAL  
OPERATOR SET

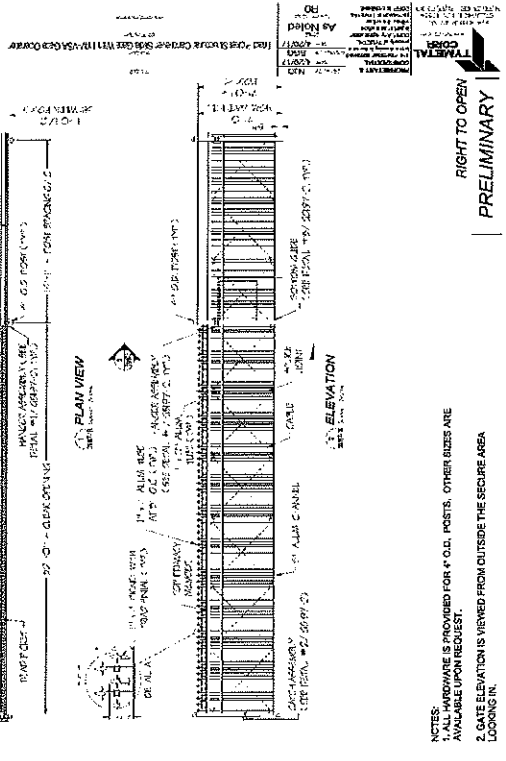

**NOTES:**  
1. ALL HARDWARE IS PROVIDED FOR 4\"/>

6S197-2  
TYPICAL  
OPERATOR SET

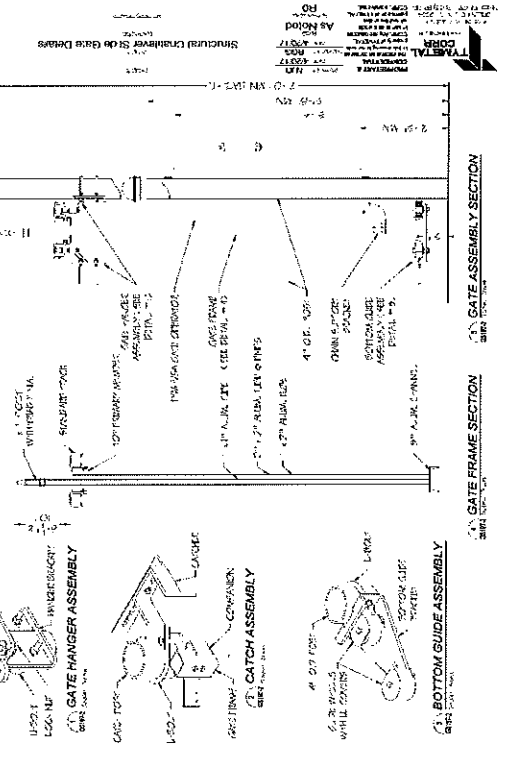







Revision	
Date	
Checked by	

**PRELIMINARY**  
FOR INTER-DEPT ONLY  
THIS DRAWING IS FOR INFORMATION ONLY AND IS NOT TO BE USED FOR CONSTRUCTION, BIDDING OR CONTRACTING. IT IS SUBJECT TO CHANGE WITHOUT NOTICE.  
DATE: 01/15/2017  
BY: J.M.

Project No.	1302700003
Issue	4/13/2017
Drawn By	CHAVEZ
Checked By	
Scale	AS SHOWN
Sheet No.	43-0110

ELECTRICAL DETAILS  
**E4.01**  
Sheet Number

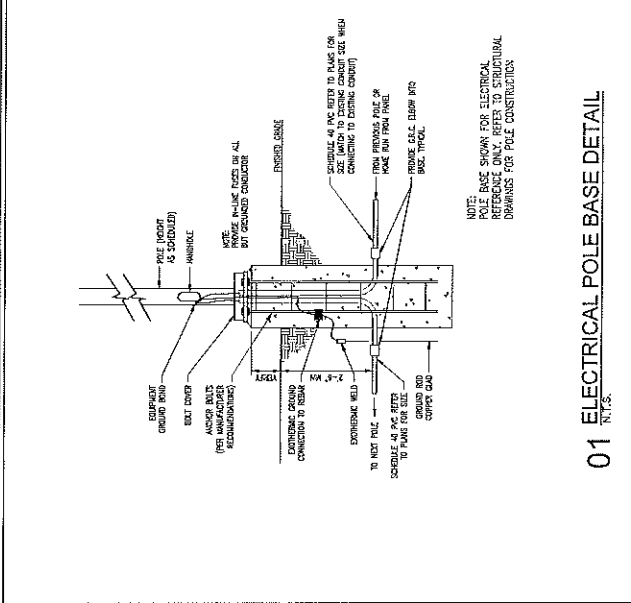

**01 ELECTRICAL POLE BASE DETAIL**  
N.T.S.

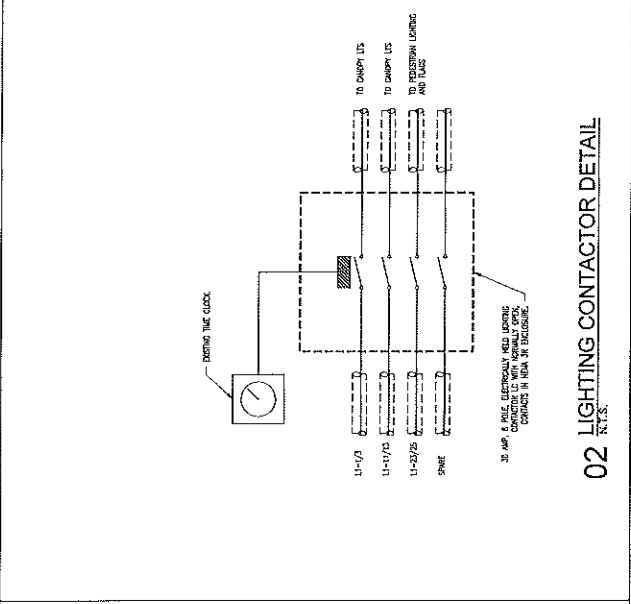

**02 LIGHTING CONTACTOR DETAIL**  
N.T.S.

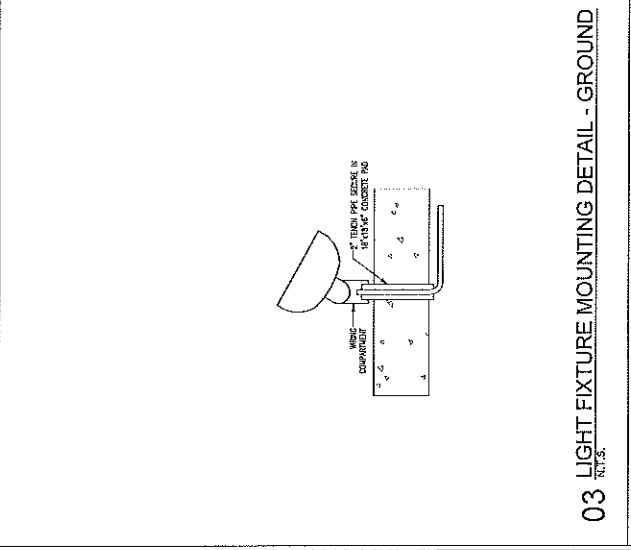

**03 LIGHT FIXTURE MOUNTING DETAIL - GROUND**  
N.T.S.









Project No.	1127
Client	City of Edburg
Site	Edburg, Texas
Phase	Final
Scale	As Shown
Sheet No.	L3.02

**PROGRESS ONLY**

Project No.	1127
Client	City of Edburg
Site	Edburg, Texas
Phase	Final
Scale	As Shown
Sheet No.	L3.02

SITE DETAILS  
L3.02  
Sheet Number

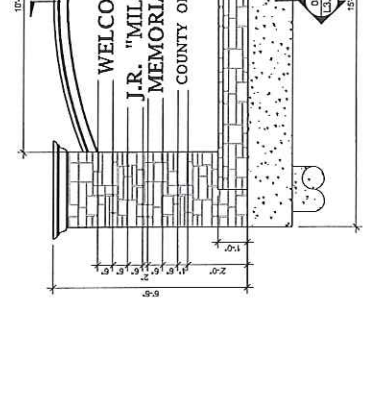
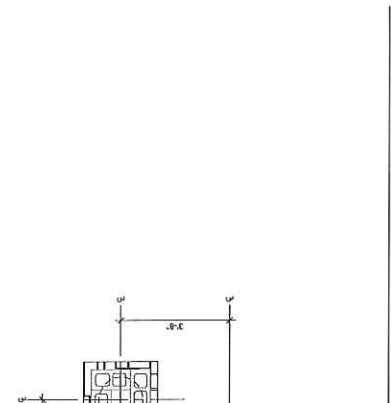
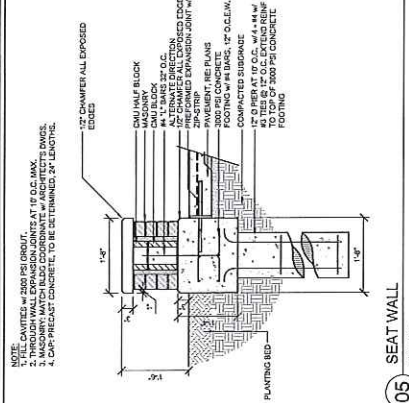
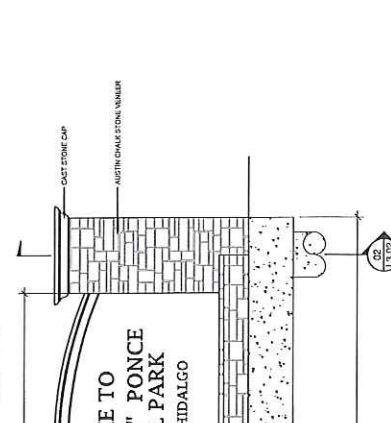
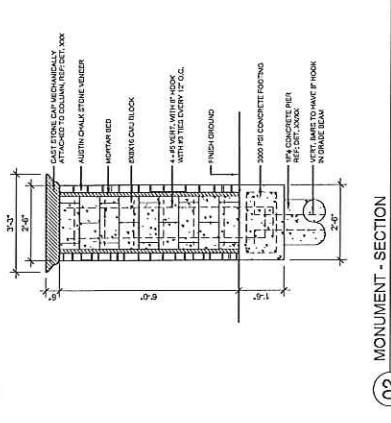
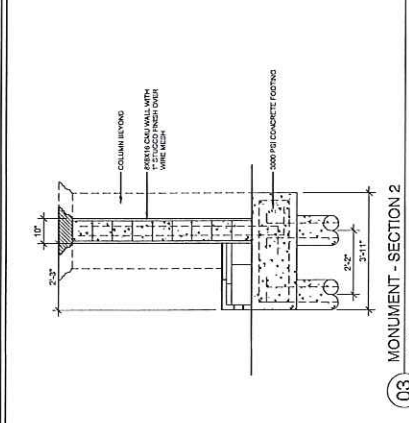

**NOTE:**  
1. FINISH = 3/8\"/>

**04 MONUMENT - PLAN**  
10' x 12'

**01 MONUMENT - ELEVATION**  
10' x 12'







**PLANTING NOTES**

- EXISTING CONDITIONS: THE LANDSCAPE CONTRACTOR SHALL BE RESPONSIBLE FOR ASSESSING THE SITE AND IDENTIFYING ANY OBSTRUCTIONS TO THE WORK. THE CONTRACTOR SHALL BE RESPONSIBLE FOR OBTAINING ALL NECESSARY PERMITS AND APPROVALS PRIOR TO THE START OF WORK. THE CONTRACTOR SHALL BE RESPONSIBLE FOR OBTAINING ALL NECESSARY PERMITS AND APPROVALS PRIOR TO THE START OF WORK. THE CONTRACTOR SHALL BE RESPONSIBLE FOR OBTAINING ALL NECESSARY PERMITS AND APPROVALS PRIOR TO THE START OF WORK.
- PLANTS: ALL PLANTS SHALL BE NURSERY GROWN PLANTS MEETING THE SPECIFICATIONS OF THE DRAWINGS. PLANTS SHALL NOT BE SPECIES OR SIZE DESIGNATED ON THE DRAWINGS. PLANTS SHALL NOT BE SPECIES OR SIZE DESIGNATED ON THE DRAWINGS. PLANTS SHALL NOT BE SPECIES OR SIZE DESIGNATED ON THE DRAWINGS.
- PLANTING: PLANTS SHALL BE PLANTED AT THE SPECIFIED SPACING AND DEPTH. PLANTS SHALL BE PLANTED AT THE SPECIFIED SPACING AND DEPTH. PLANTS SHALL BE PLANTED AT THE SPECIFIED SPACING AND DEPTH.
- SOIL: THE LANDSCAPE CONTRACTOR SHALL BE RESPONSIBLE FOR OBTAINING ALL NECESSARY PERMITS AND APPROVALS PRIOR TO THE START OF WORK. THE CONTRACTOR SHALL BE RESPONSIBLE FOR OBTAINING ALL NECESSARY PERMITS AND APPROVALS PRIOR TO THE START OF WORK.
- IRRIGATION: THE LANDSCAPE CONTRACTOR SHALL BE RESPONSIBLE FOR OBTAINING ALL NECESSARY PERMITS AND APPROVALS PRIOR TO THE START OF WORK. THE CONTRACTOR SHALL BE RESPONSIBLE FOR OBTAINING ALL NECESSARY PERMITS AND APPROVALS PRIOR TO THE START OF WORK.
- MAINTENANCE: THE LANDSCAPE CONTRACTOR SHALL BE RESPONSIBLE FOR OBTAINING ALL NECESSARY PERMITS AND APPROVALS PRIOR TO THE START OF WORK. THE CONTRACTOR SHALL BE RESPONSIBLE FOR OBTAINING ALL NECESSARY PERMITS AND APPROVALS PRIOR TO THE START OF WORK.

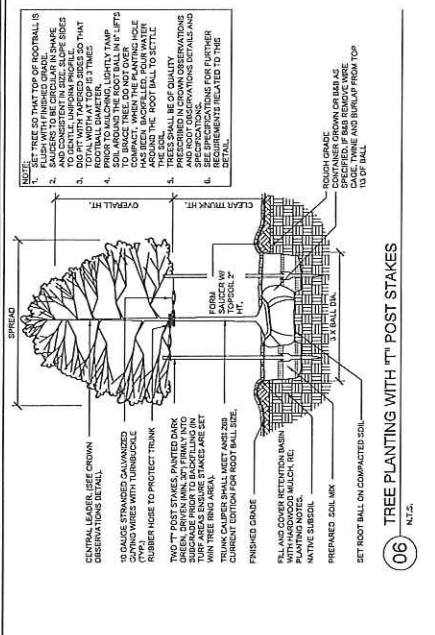

**06 TREE PLANTING WITH T POST STAKES**  
1/2" = 1'-0"

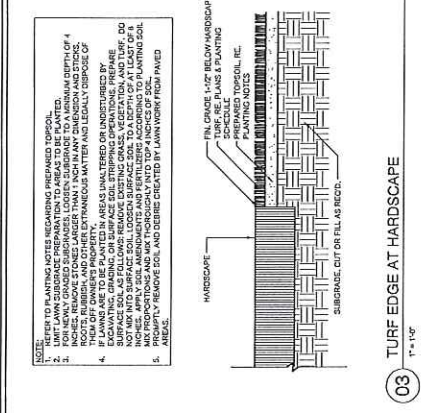

**03 TURF EDGE AT HARDSCAPE**  
1/2" = 1'-0"

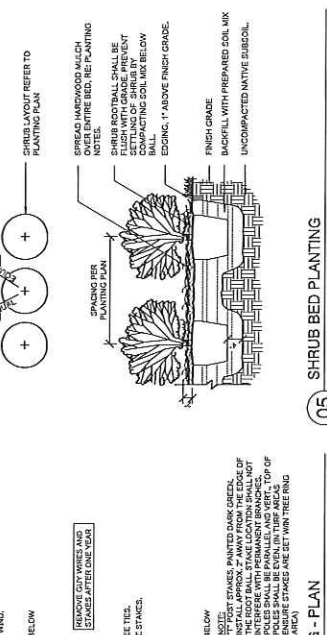

**05 SHRUB BED PLANTING**  
3/8" = 1'-0"

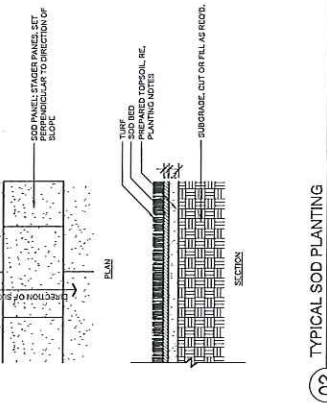

**02 TYPICAL SOD PLANTING**  
1/2" = 1'-0"

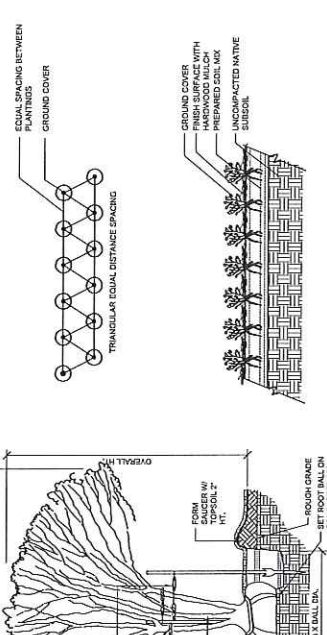

**07 MULTI-TRUNK TREE PLANTING WITH T POST STAKES**  
3/8" = 1'-0"

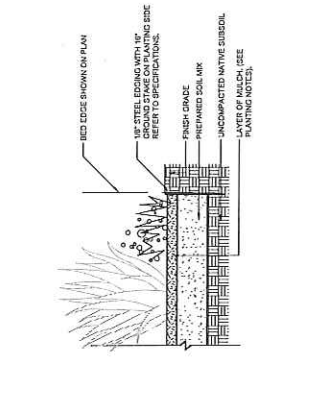

**04 GROUND COVER**  
3/8" = 1'-0"

J.R. "MILLO" PONCE  
Edinburg, Texas 78542

**HALFF**  
THE FRAZER GROUP  
1800 W. WYATT BLVD. SUITE 100  
MCKINNEY, TX 75069  
PH: 972.566.4400  
WWW.HALFF.COM

**PROGRESS ONLY**

PROJECT NO.: 2108000003  
DATE: 04/13/17  
DRAWN BY: [Name]  
CHECKED BY: [Name]  
SCALE: AS NOTED

LANDSCAPE NOTES & DETAILS

L5:02  
Sheet Number