

June 1, 2017

Hidalgo County Urban County Program
Attn: Ms. Diana R. Serna, Director
427 E. Durante Avenue, Suite 107
Alamo, Texas 78516

RE: City of Peñitas-Street Improvements
5014/15-60-0311-5000-6000-UCP-GVG
Amendment Request-Supplemental No. 1

Dear Ms. Serna;

This submittal is to request an amendment to the contract for the above stated project to include the following revisions:

Revision No. 1: Development of plans for extension of Mesquite Avenue Improvement of 126.5 feet to the South. Attached please find Revision No. 1.

Cost of revision: \$1,294.40

Revision No. 2: Extension of Pike Avenue from Mesquite Avenue to Laurel Street. Attached please find Revision No. 2.

Cost of revision: \$3,259.20

The total amount for this amendment (Supplemental No. 1) is **\$4,553.60**. If you have any questions in reference to this request, please contact Mr. Victor Trevino or myself at (956) 424-3335.

Sincerely,

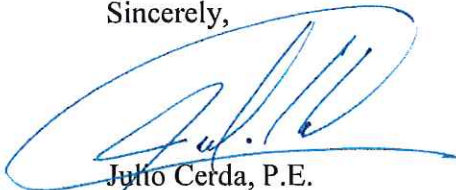

Julio Cerda, P.E.
President



- LEGEND:**
- 1" EXIST. 10" DIAM. RICH WATER LINE
 - 1.5" EXIST. 10" DIAM. RICH FORCE MAIN SANITARY SEWER LINE
 - 1.5" EXIST. 10" DIAM. RICH SANITARY SEWER LINE
 - 1" EXIST. 10" DIAM. RICH GAS PIPELINE
 - 1" EXIST. UNDERGROUND FIBER OPTIC CABLE
 - 1" EXIST. UNDERGROUND TELE. LINE
 - 1" EXIST. UNDERGROUND ELECTRIC LINE
 - 1" EXIST. HIGH VOLTAGE TRANSMISSION LINE
 - 1" EXIST. UNDERGROUND ELECTRIC LINE
 - 1" EXIST. OVERHEAD ELECTRIC LINE WITH CABLE LINE ATTACHED
 - 1" EXIST. OVERHEAD ELECTRIC LINE WITH FIBER OPTIC AND CABLE LINE ATTACHED
 - TC=00.00 TOP OF CURB ELEVATION
 - PROF. 4" CONC. SIDEWALK
 - EXISTING ASPHALT PAVEMENT
 - PROPOSED 4" CONC. DRIVEWAY
 - PROPOSED ASPHALT PAVEMENT

MATCH LINE STA. 15+00

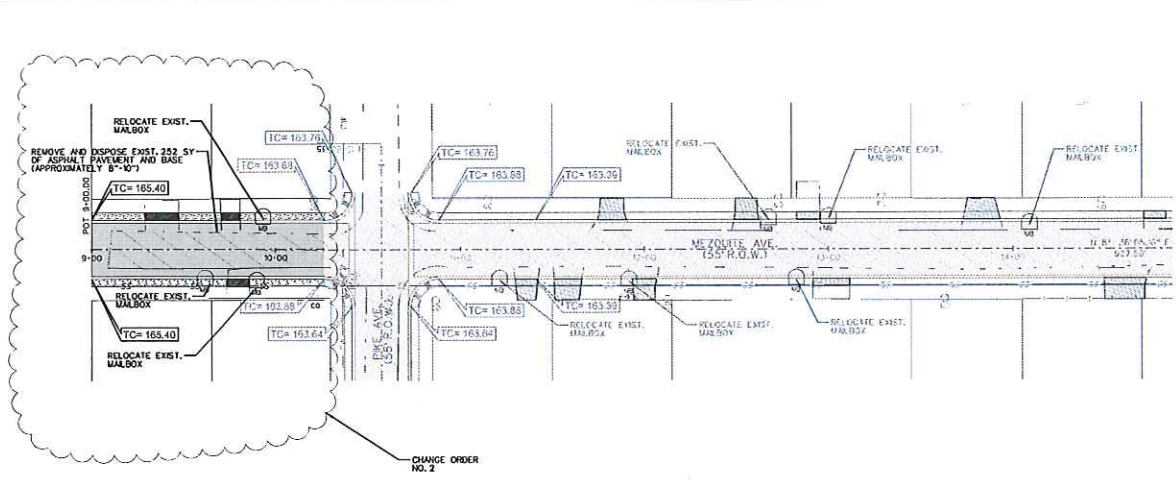

* RE-GRADE ALL EXISTING CLEAN OUTS TO PROP. GRADE (1.75')

PROP. TOC	
166	166
165	165
164	164
163	163
162	162
161	161
160	160
159	159
158	158

JERRY C. CERDA
P.E. 90524
DATE: 04/25/2017

SOUTH TEXAS INFRASTRUCTURE GROUP

900 S. STEWART, SUITE 13 PM (936) 424-3325
MISSION, TEXAS 78172 FAX (936) 424-3132
T&PE REG # 15200

MEZZQUITE AVENUE
STA. 09+00.00 TO STA. 10+26.50

SCALE: HOR 1" = 50'
VER 1" = 2'

DATE: 04/25/2017	CHK: []	DES: []	DR: []	INCHES: []
BY: []	INT: []	COUNTY: []	SHEET NO.: []	TOTAL SHEETS: []
DR: []	PVT: []	PROJECT: []	DATE: []	SCALE: []

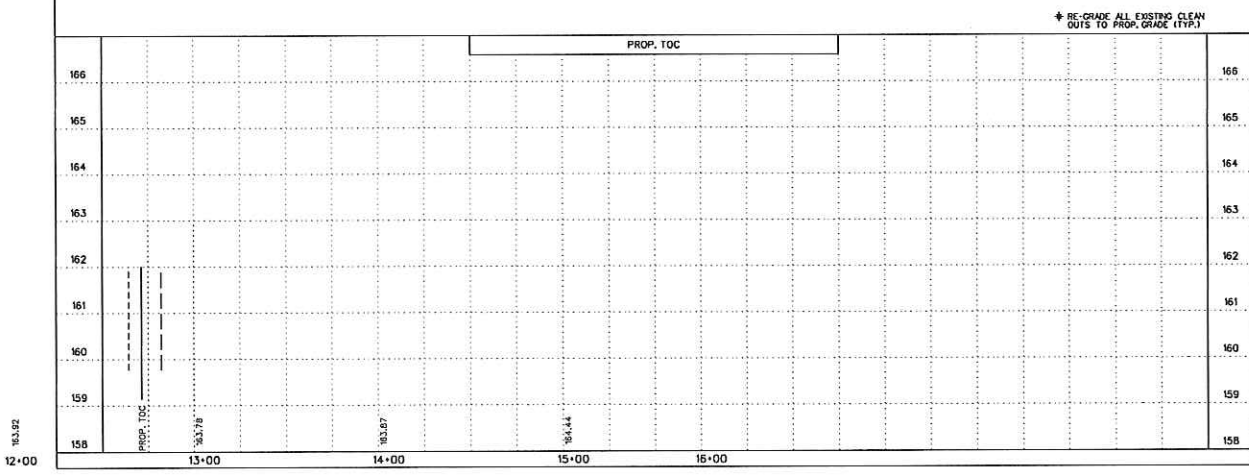
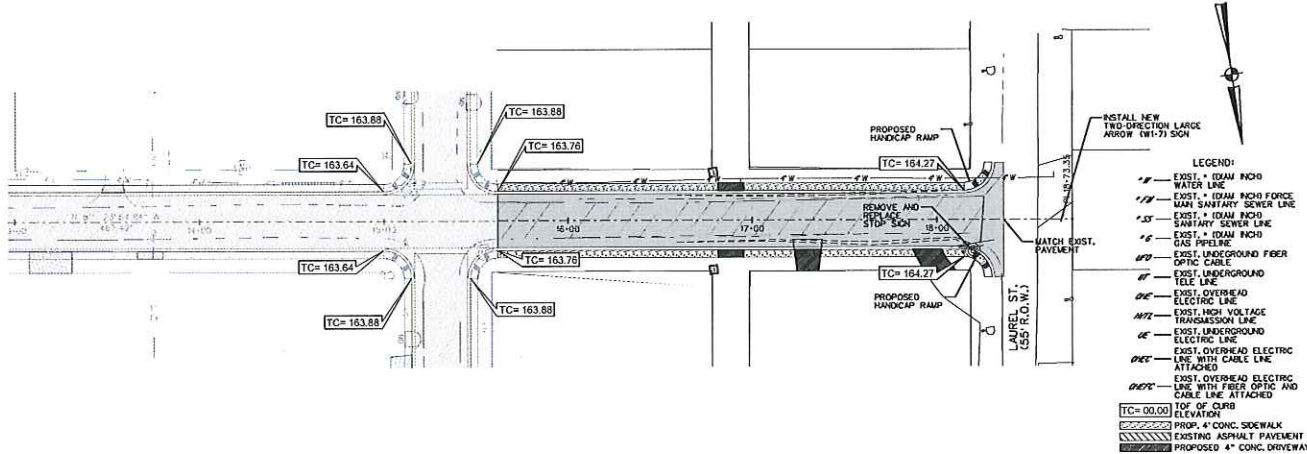

STATE OF TEXAS
 SEAL OF THE STATE ENGINEER
 J. C. CERDA
 LICENSE NO. 90524
 PROFESSIONAL ENGINEER

[Signature]
 J. C. CERDA
 P.E. 90524
 05/05/2017
 DATE

SOUTH TEXAS INFRASTRUCTURE GROUP
 910 S. STEVART, SUITE 113 PM (956) 424-3335
 MISSION, TEXAS 78372 FAX (956) 424-3132
 T&E REG. # 15009

PIKE AVENUE EXTENSION
 STA. 15+61.85 TO STA. 18+36.35

SCALE:
 HOR. 1" = 50'
 VERT. 1" = 5'

DATE	BY	CHKD	APP'D	JOB	NO. SHEET
05/05/2017					

12-00 13.92

Fiscal year thru period ending 06/30/2017

60

Description	Month to date	Year to date	Ytd encumbrnce	Annual budget	Annual var	% used
5015 60 0311 5000 6000 STREET IMPROVEMENTS	.00	.00	.00	151,958.88	151,958.88	.0%
5015 60 0311 5200 6011 TEXAS CORDIA CONSTRUCTION	.00	.00	103,005.86	103,005.86	.00	100.0%
Total Expenditure	.00	.00	103,005.86	254,964.74	151,958.88	40.4%

STATE OF TEXAS §
 §
COUNTY OF HIDALGO §

FIRST AMENDMENT TO PROFESSIONAL SERVICES AGREEMENT

This First Amendment to Professional Services Agreement is made this 13th day of June, 2017 by and between Hidalgo County acting by and through its Urban County Program ("County") and South Texas Infrastructure Group, LLC ("Engineer").

WHEREAS, County and Engineer entered into that certain Agreement dated October 4, 2016 in which Engineer agreed to provide engineering services for the purposes of road improvements;

WHEREAS, at the time the Agreement was executed County and Engineer did not realize the roads to be reconstructed extended beyond the original scope of services set forth in the Agreement; and

WHEREAS, the parties desire to amend the Agreement as hereinafter provided.

NOW THEREFORE, for and in consideration of the terms and provisions set forth herein and, for other good and valuable consideration, the receipt and sufficiency of which are hereby acknowledged, County and Engineer hereby agree to the following amendments to the Agreement:

1. The following shall be added to Exhibit B:

Development of plans for extension of Mesquite Avenue Improvements of 126.5 feet to the South in accordance with Revision No. 1, a copy of Revision No. 1 attached hereto as Exhibit A ("Mesquite Avenue").

Extension of Pike Avenue from Mesquite Avenue to Laurel Street in accordance with Revision No. 2, a copy of Revision No. 2 attached hereto as Exhibit B ("Pike Avenue").
2. Exhibit C shall be increased by the cost associated with Mesquite Avenue of \$1,294.40 and by the cost associated with Pike Avenue of \$3,259.20.
3. Except as modified herein, all terms and conditions of the Agreement, as amended, remain in full force and effect. County and Engineer ratify and confirm the terms and provisions of the Agreement, as amended.

EXECUTED IN DUPLICATE ORIGINALS and effective as the day and year first written above.

**COUNTY OF HIDALGO URBAN COUNTY
PROGRAM**

ATTEST:

By: _____
Ramon Garcia, County Judge

By: _____
Arturo Guajardo, Jr., County Clerk

SOUTH TEXAS INFRASTRUCTURE GROUP, LLC

By: _____

Printed Name: _____

Title: _____

APPROVED AS TO FORM:

ATLAS, HALL & RODRIGUEZ, LLP

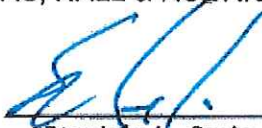
By:  _____
Stephen L. Crain

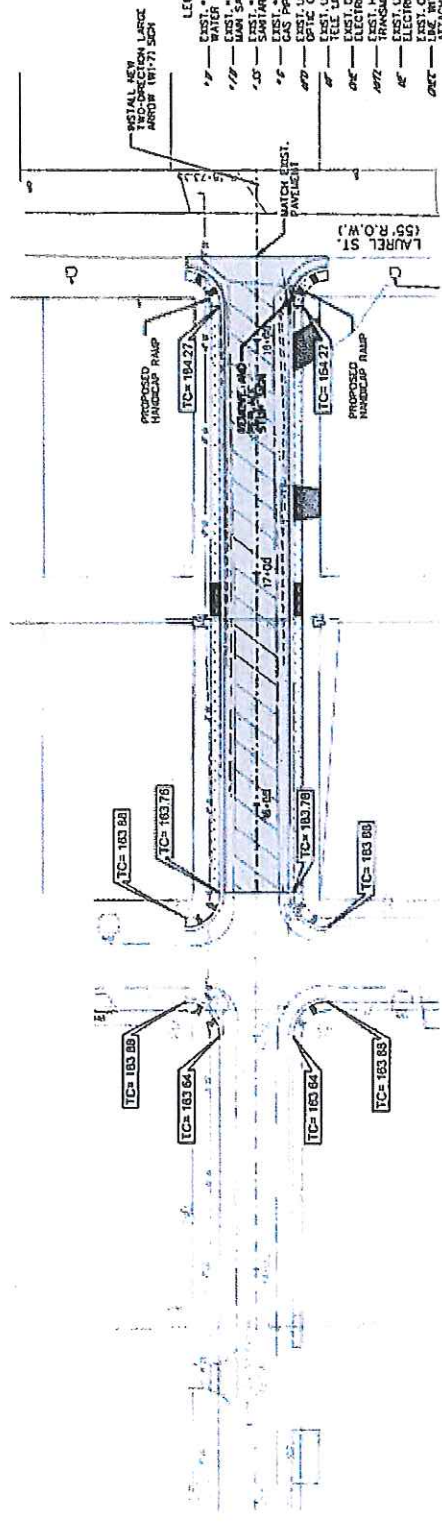

- LEGEND:
- 1" - EXIST. 4" DIAM. WCHD WATER LINE
 - 1" - EXIST. 4" DIAM. WCHD FORCE MAIN SANITARY SEWER LINE
 - 1" - EXIST. 4" DIAM. WCHD SANITARY SEWER LINE
 - 4" - EXIST. 4" DIAM. WCHD GAS PIPING
 - 4" - EXIST. 4" DIAM. WCHD OPTIC CABLE
 - 4" - EXIST. UNDERGROUND TELE. UNDERGROUND ELECTRIC LINE
 - 4" - EXIST. UNDERGROUND TRANSMISSION LINE
 - 4" - EXIST. UNDERGROUND ELECTRIC LINE
 - 4" - EXIST. OVERHEAD ELECTRIC TRANSMISSION LINE
 - 4" - EXIST. OVERHEAD ELECTRIC CABLE LINE
 - 4" - EXIST. OVERHEAD ELECTRIC CABLE LINE WITH FIBER OPTIC CABLE
 - 4" - EXIST. OVERHEAD ELECTRIC CABLE LINE WITH FIBER OPTIC CABLE
 - 4" - EXIST. OVERHEAD ELECTRIC CABLE LINE WITH FIBER OPTIC CABLE
- TC=184.27 TOP OF CURB ELEVATION
 TC=184.28 TOP OF CURB ELEVATION
 TC=183.83 TO 183.86 EXISTING ASPHALT PAVEMENT
 TC=183.83 TO 183.86 PROPOSED 4" CONC. DRIVEWAY



J. C. Cerda
 J. C. CERDA
 P.E. 100324
 05/05/2017
 DATE

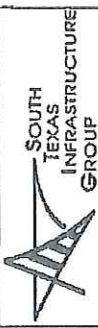

SOUTH TEXAS INFRASTRUCTURE GROUP
 510 S. STEWART, SUITE 1376, FRESNO, TEXAS 76702
 PHONE: (817) 424-2132
 FAX: (817) 424-2132
 WWW: SOUTHTEXASINFRASTRUCTURE.COM

PIKE AVENUE EXTENSION
 STA. 15+61.85 TO STA. 18+36.35

SCALE:
 HORIZ. 1" = 40'
 VERT. 1" = 10'

NO.	DATE	BY	CHKD.	APP'D.
1	05/05/2017	JCC	JCC	JCC
2				
3				
4				
5				

← RE-USE ALL EXISTING CURB CUTS TO PROP. GRADE (11%)

STATION	PROF. TOC	PROF. TOC	PROF. TOC	PROF. TOC	PROF. TOC	PROF. TOC
158	13+00	13+00	14+00	14+00	15+00	15+00
159						
160						
161						
162						
163						
164						
165						
166						

