

**DELTA LAKE COUNTY PARK
MONTE ALTO, TEXAS, HIDALGO COUNTY**

DESIGN FOR:
HIDALGO COUNTY PRECINCT # 1
1902 Joe Stephens Ave.
Ste. 101, Weslaco, TX 78599

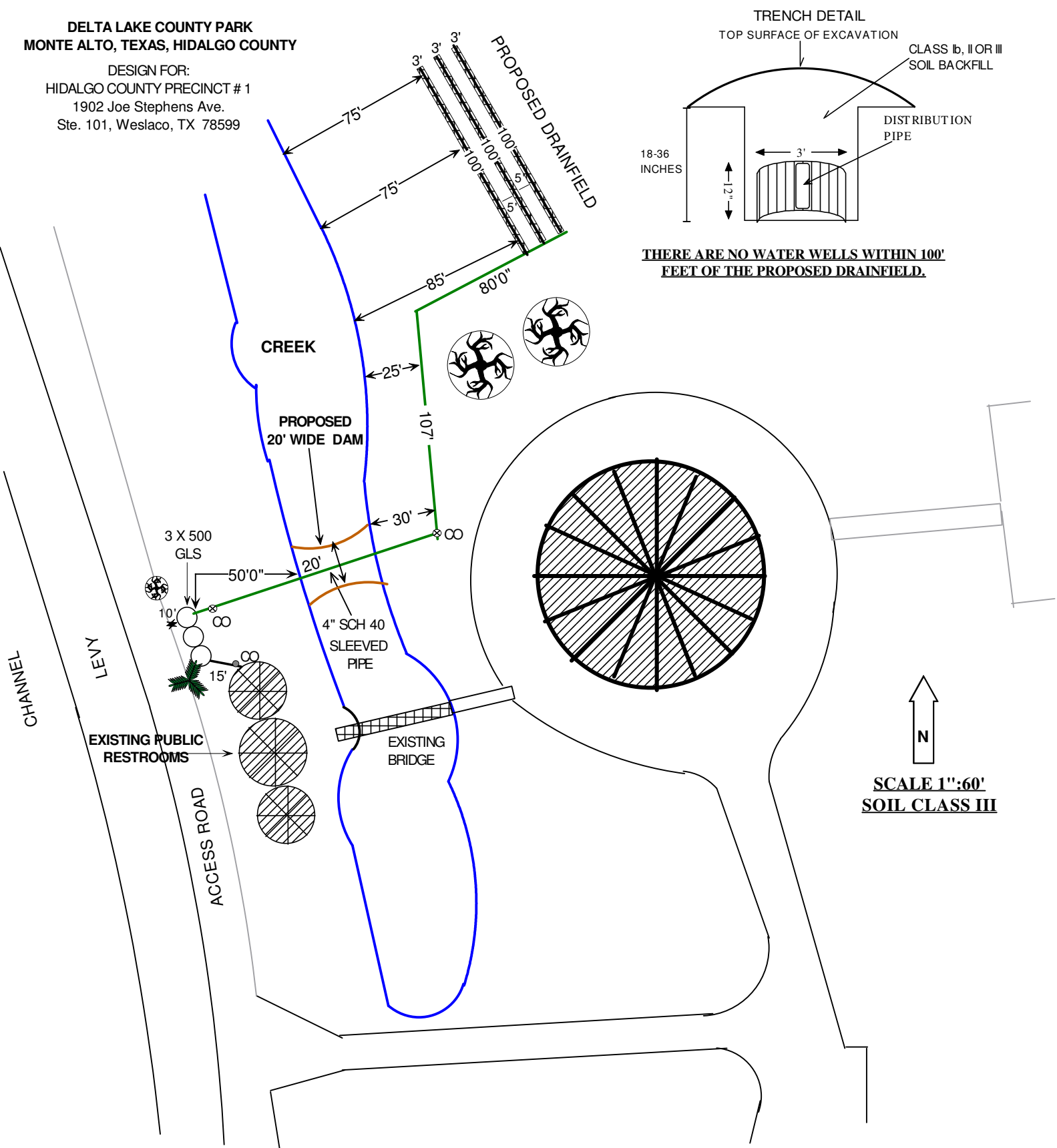

THERE ARE NO WATER WELLS WITHIN 100' FEET OF THE PROPOSED DRAINFIELD.

EXISTING PUBLIC RESTROOM WITH 2 / WC SEPTIC SYSTEM PROPOSAL # 1

TABLE III

Parks (without bathhouse per person) 8 gpd
WATER SAVING DEVICES
50 OCCUPANTS
50 X 8 GPD = 400
TOTAL GPD = 400

3. For Q greater than or equal to 351 gal/day but less than or equal to 500 gal/day:
V = 1250 gallons

USE OF 3 X 500 GLS SEPTIC TANKS

CALCULATIONS

Ra = CLASS SOIL III
Ra = .20
Q = 400.0 GAL/DAY
GPD = 400.0 GLS / DAY (TABLE III)

AREA REQUIREMENTS:

A = QRa
A = 400.0 / .20
A = 2000.0 SQF
A = 2000.0 SQF / 5 = 400.0 L.F.

AREA REQUIREMENTS: 3' WIDE INF/PANEL

L = .75 A / (3+2)
L = .75 X 2000 SQF / 5
L = 1500.0 / 5
L = 300.0 L.F.

USE OF 300.0 L.F. OF 3 FEET WIDE TRENCHES OF INFILTRATOR PANELS HIGH CAPACITY
3 FEET MINIMUM SEPARATION BETWEEN TRENCHES
TOTAL OF 300.0 L.F.

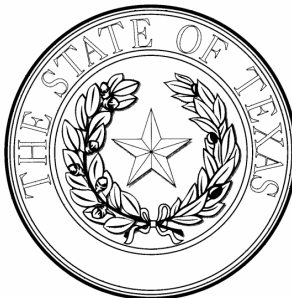

Alberto J. Garcia

ALBERTO J. GARCIA, R.S.
REGISTRATION # 2603 EXP 03/2018
06-01-17