



Ricoh USA, Inc.  
70 Valley Stream Parkway  
Malvern, PA 19355

# Product Schedule

Product Schedule Number: \_\_\_\_\_

Master Lease Agreement Number: \_\_\_\_\_

This Product Schedule (this "Schedule") is between Ricoh USA, Inc. ("we" or "us") and \_\_\_\_\_, as customer or lessee ("Customer" or "you"). This Schedule constitutes a "Schedule," "Product Schedule," or "Order Agreement," as applicable, under the \_\_\_\_\_ (together with any amendments, attachments and addenda thereto, the "Lease Agreement") identified above, between you and \_\_\_\_\_. All terms and conditions of the Lease Agreement are incorporated into this Schedule and made a part hereof. If we are not the lessor under the Lease Agreement, then, solely for purposes of this Schedule, we shall be deemed to be the lessor under the Lease Agreement. It is the intent of the parties that this Schedule be separately enforceable as a complete and independent agreement, independent of all other Schedules to the Lease Agreement.

## CUSTOMER INFORMATION

Customer (Bill To)				Billing Contact Name			
Product Location Address				Billing Address (if different from location address)			
City	County	State	Zip	City	County	State	Zip
Billing Contact Telephone Number			Billing Contact Facsimile Number			Billing Contact E-Mail Address	

## PRODUCT/EQUIPMENT DESCRIPTION ("Product")

Qty	Product Description: Make & Model

Qty	Product Description: Make & Model

## PAYMENT SCHEDULE

<b>Minimum Term</b> <i>(months)</i>

<b>Minimum Payment</b> <i>(Without Tax)</i>
*****\$

<b>Minimum Payment Billing Frequency</b>
Monthly
Quarterly
Other: _____

<b>Advance Payment</b>
1st Payment
1st & Last Payment
Other: _____

Sales Tax Exempt: YES (Attach Exemption Certificate) Customer Billing Reference Number (P.O. #, etc.) \_\_\_\_\_  
 Addendum(s) attached: YES (check if yes and indicate total number of pages: \_\_\_\_\_)

## TERMS AND CONDITIONS

- The first Payment will be due on the Effective Date. If the Lease Agreement uses the terms "Lease Payment" and "Commencement Date" rather than "Payment" and "Effective Date," then, for purposes of this Schedule, the term "Payment" shall have the same meaning as "Lease Payment," and the term "Effective Date" shall have the same meaning as "Commencement Date."
- You, the undersigned Customer, have applied to us to rent the above-described Product for lawful commercial (non-consumer) purposes. **THIS IS AN UNCONDITIONAL, NON-CANCELABLE AGREEMENT FOR THE MINIMUM TERM INDICATED ABOVE**, except as otherwise provided in any non-appropriation provision of the Lease Agreement, if applicable. If we accept this Schedule, you agree to rent the above Product from us, and we agree to rent such Product to you, on all the terms hereof, including the terms and conditions of the Lease Agreement. **THIS WILL ACKNOWLEDGE THAT YOU HAVE READ AND UNDERSTAND THIS SCHEDULE AND THE LEASE AGREEMENT AND HAVE RECEIVED A COPY OF THIS SCHEDULE AND THE LEASE AGREEMENT.**
- Additional Provisions (if any) are: \_\_\_\_\_

**THE PERSON SIGNING THIS SCHEDULE ON BEHALF OF THE CUSTOMER REPRESENTS THAT HE/SHE HAS THE AUTHORITY TO DO SO.**

<b>CUSTOMER</b>	
By: <input checked="" type="checkbox"/>	<i>Authorized Signer Signature</i>
Printed Name: _____	
Title: _____	Date: _____

<b>Accepted by: RICOH USA, INC.</b>	
By: <input checked="" type="checkbox"/>	<i>Authorized Signer Signature</i>
Printed Name: _____	
Title: _____	Date: _____

## ORDER AGREEMENT

Master Maintenance and Sale Agreement Date:		Sale Type :	LEASE
---	--	-------------	-------

BILL TO INFORMATION			
Customer Legal Name: HIDALGO, COUNTY OF			
Address Line 1: 1051 N DOOLITTLE RD		Contact: PEREZ,NICK	
Address Line 2:		Phone: (956)383-3112	
City: EDINBURG		E-mail: nick.perez@co.hidalgo.tx.us	
ST / Zip: TX/78542-0337	County: HIDALGO	Fax: (956)381-5905	

ADDITIONAL ORDER INFORMATION	
<b>Check All That Apply:</b>	
<ul style="list-style-type: none"> <li>◇ Sales Tax Exempt (Attach Valid Exemption Certificate)</li> <li>◇ PO Included PO# _____</li> <li>◇ Syndication</li> </ul>	<ul style="list-style-type: none"> <li>◇ Fixed Service Charge</li> <li>◇ PS Service (Subject to and governed by separate Statement of Work)</li> <li>◇ IT Service (Subject to and governed by separate Statement of Work)</li> </ul>
◇ Add to Existing Service Contract # _____	

This is an Order made pursuant to the terms and conditions of the above referenced Master Agreement(s) between Customer and Ricoh USA, Inc. The signature below indicates that the customer accepts all terms and conditions of the applicable Master Agreement(s) for this sale, including by not limited to the terms set forth in the Master Agreement(s) and any Exhibit A thereto, all of which are incorporated herein by reference and made part of this Order. Each party agrees that electronic signatures of the parties on this Order will have the same force and effect as manual signature. Ricoh may accept this Order by either its signature or by commencing performance (e.g. Product delivery, initiating Services, etc.).

SERVICE INFORMATION		
Service Term (Months)	Base Billing Frequency	Overage Billing Frequency
48 Months	MONTHLY	QUARTERLY

SHIP TO INFORMATION			
Customer Name: HIDALGO COUNTY			
Address Line 1: 1051 N DOOLITTLE RD		Contact: PEREZ,NICK	
Address Line 2:		Phone: (956)383-3112	
City: EDINBURG		E-mail: nick.perez@co.hidalgo.tx.us	
ST / Zip: TX/78542-0337	County: HIDALGO	Fax: (956)381-5905	

PRODUCT INFORMATION							
Product Description	Qty	Service Type	B/W Allowance (Per Base Billing Frequency)	B/W Ovg	Color Allowance (Per Base Billing Frequency)	Color Ovg	Service Base (Per Base Billing Frequency)
RICOH MPCW2201SP BRANDING SET	1	Bronze	2,600	\$0.0333	0	\$0.0519	\$87.22

BASIC CONNECTIVITY / PS / IT SERVICES INFORMATION	
BASIC CONNECTIVITY / PS / IT Services Description	Quantity
[OA] PPSE Training AEC WF	1



**BASIC CONNECTIVITY / PS / IT SERVICES INFORMATION**

BASIC CONNECTIVITY / PS / IT Services Description	Quantity
TS NETWORK & SCAN	1

**ORDER TOTALS**

<b>Service Type Offerings:</b>	<b>Product Total:</b>	
<b>Gold:</b> Includes all supplies and staples. Excludes paper.	<b>BASIC CONNECTIVITY / PS / IT Services:</b>	
<b>Silver:</b> Includes all supplies. Excludes paper and staples.	<b>Buyout:</b>	
<b>Bronze:</b> Parts and labor only. Excludes paper, staples and supplies.	<b>Grand Total: (Excludes Tax)</b>	
<b>Additional Provisions:</b>		

<b>Accepted by Customer</b>	<b>Accepted: Ricoh USA, Inc.</b>
Authorized Signature: _____	Authorized Signature: _____
Printed Name: _____	Printed Name: _____
Title: _____	Title: _____
Date: _____	Date: _____



# RICOH

## Texas Association of School Board

### Purchase / Lease / Full Maintenance

#### Schedule B to

Ricoh Master Pricing Agreement

Terms & Conditions to reference Ricoh Master Agreement.

Lease rates are subject to quarterly review and adjustment, unless otherwise noted in the Ricoh Master Agreement.

Lease payments exclude taxes.

Ricoh Product Code EDP	Ricoh Equipment and Options Prices Per Unit	Jun-17 Suggested Retail Price	Contract Equipment Purchase Price	FMV Lease			Service Plan Options							
				36 Monthly Payments	48 Monthly Payments	DISCOUNTED 48 MO LEASE	Base Charge	Base Frequency	B&W Allowance	B&W CPC	Color Allowance	Color CPC	Supplies Included	Production 11x17 Click
				404830	MP CW2201SP	\$14,500.00	\$7,272.00	\$257.70	\$218.59	\$202.99	\$105.00	MTH	2,600	0.0420
PP-ISFWFAEC	PPSE Training AEC WF	1,200.00	1,080.63	36.50	29.19	30.79								
006428MIU	ESP XG-PCS-15D (120 Volt, 15 Amp)	346.00	138.00	4.73	4.01	4.01								
PS-CONN-WFC	Network & Scan	450.00	-	-	-	-								
404836	MP CW2201 B Unit	1,419.00	630.00	21.58	18.31	16.04								
404833	2nd Roll Option RU6550	2,229.00	993.00	34.02	28.86									
404834	Roll Holder Unit Type M23	135.00	60.00	2.06	1.74									
404835	File Format Converter	669.00	297.00	10.18	8.63									
404858	NFC Card Reader	335.00	149.00	5.10	4.33									
417499	DataOverwriteSecurity Unit Type M19	479.00	181.00	6.20	5.26									
417428	OCR Unit	335.00	146.00	5.00	4.24									
417493	IEEE 802.11a/g/n Interface Unit Type M19	739.00	331.00	11.34	9.62									
415873	PrintCopy Tool	2,538.00	1,384.00	47.42	40.22									
404888	PrintCopy Tool Type D2016	1,199.00	847.00	29.02	24.61									
404889	PrintCopy Upgrade Kit 2016	500.00	418.00	14.32	12.15									
EQ-RETURN-SEG2PLUS	Lease Return	250.00	-	-	-									
		TOTAL PURCHASE PRICE	\$ 9,120.63	48 Month Lease Price	\$ 270.10	\$ 253.83	\$87.22		Discounted B&W Rate	\$0.0333	Discounted Color Rate	\$0.0519	TOTAL MONTHLY PAYMENT	\$341.05

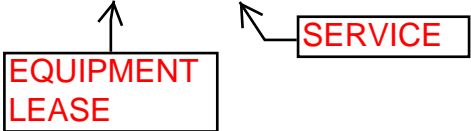

# Lease Calculator

<b>Fix Rate</b>	<b>Fix Payment</b>
Product/Property Value	<input type="text" value="9120.63"/>
Residual Value	<input type="text" value="0"/>
Lease Term	<input type="text" value="4"/> years
	<input type="text" value="0"/> months
Monthly Payment	<input type="text" value="253.53"/>
<b>Calculate</b> 	

## Result

<b>Interest/Return Rate</b>	<b>14.935%</b>
Total of 48 Monthly Payments	\$12,169.44
Total Interest	\$3,048.81

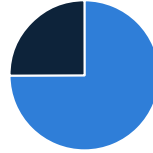

# Capital/ Operating Lease Log2017

Install Date	Serial No.	Lease End Date	CC Date	Agenda No.	Dept No.	Department Name	REQ No.	Co-op Contract No.	Model	Equipment Monthly Pmt	Title Xfer at End of Lease? (Y/N)	Bargain Purchase Option? (Y/N)	Lease Term in Months	Est. Economic Useful Life in Mo.'s	Total Principal Pmts Over Lease Term	FMV of Leased Equip. at Lease Inception - CASH PRICE	Capital or Operating Lease? (Calculated Field)	Not to exceed 15% Interest
			11/28/2017	62583	124	Comm. PCT 4	359803	BB 537-17	MP CW2201SP	\$ 253.83	N	N	48	60	\$ 12,183.84	\$ 9,120.63	Capital Lease	14.999%

# CERTIFICATE OF INTERESTED PARTIES

FORM 1295

1 of 1

Complete Nos. 1 - 4 and 6 if there are interested parties.  
Complete Nos. 1, 2, 3, 5, and 6 if there are no interested parties.

**OFFICE USE ONLY  
CERTIFICATION OF FILING**

**Certificate Number:**  
2017-274136

**Date Filed:**  
10/19/2017

**Date Acknowledged:**  
10/25/2017

**1 Name of business entity filing form, and the city, state and country of the business entity's place of business.**  
Ricoh USA, Inc.  
Malvern, PA United States

**2 Name of governmental entity or state agency that is a party to the contract for which the form is being filed.**  
County of Hidalgo

**3 Provide the identification number used by the governmental entity or state agency to track or identify the contract, and provide a description of the services, goods, or other property to be provided under the contract.**  
Req# 359803  
Lease and Service of Ricoh MPCW2201SP

4	Name of Interested Party	City, State, Country (place of business)	Nature of interest (check applicable)	
			Controlling	Intermediary
	Ricoh USA, Inc.	Malvern, PA United States	X	

**5 Check only if there is NO Interested Party.**

**6 AFFIDAVIT** I swear, or affirm, under penalty of perjury, that the above disclosure is true and correct.

\_\_\_\_\_  
Signature of authorized agent of contracting business entity

AFFIX NOTARY STAMP / SEAL ABOVE

Sworn to and subscribed before me, by the said \_\_\_\_\_, this the \_\_\_\_\_ day of \_\_\_\_\_, 20\_\_\_\_\_, to certify which, witness my hand and seal of office.

\_\_\_\_\_  
Signature of officer administering oath      Printed name of officer administering oath      Title of officer administering oath

# CERTIFICATE OF INTERESTED PARTIES

FORM 1295

1 of 1

Complete Nos. 1 - 4 and 6 if there are interested parties.  
Complete Nos. 1, 2, 3, 5, and 6 if there are no interested parties.

## OFFICE USE ONLY CERTIFICATION OF FILING

Certificate Number:  
2017-274136

Date Filed:  
10/19/2017

Date Acknowledged:

**1 Name of business entity filing form, and the city, state and country of the business entity's place of business.**

Ricoh USA, Inc.  
Malvern, PA United States

**2 Name of governmental entity or state agency that is a party to the contract for which the form is being filed.**

County of Hidalgo

**3 Provide the identification number used by the governmental entity or state agency to track or identify the contract, and provide a description of the services, goods, or other property to be provided under the contract.**

Req# 359803  
Lease and Service of Ricoh MPCW2201SP

4	Name of Interested Party	City, State, Country (place of business)	Nature of interest (check applicable)	
			Controlling	Intermediary
	Ricoh USA, Inc.	Malvern, PA United States	X	

5 Check only if there is NO Interested Party.

**6 AFFIDAVIT**

I swear, or affirm, under penalty of perjury, that the above disclosure is true and correct.



Karl Lamb  
Signature of authorized agent of contracting business entity

AFFIX NOTARY STAMP / SEAL ABOVE

Sworn to and subscribed before me, by the said Karl Lamb, this the 19th day of October, 2017, to certify which, witness my hand and seal of office.

Virgil Delgado  
Signature of officer administering oath

Virgil Delgado  
Printed name of officer administering oath

Notary Public  
Title of officer administering oath

RICOH  
MP CW2201SP  
Color Wide  
Format MFP

**Date: November 7, 2017**



RICOH  
MP CW2201SP  
Color Wide  
Format MFP

**Date: November 7, 2017**





## Presentation for: Hidalgo County

Presented by:

Aissa Acevedo  
Technology Specialist

Sergio Gomez  
Sr. Sales Specialist Commercial & Industrial Print

October 2, 2017





# RICOH MP CW2201SP: Product Design

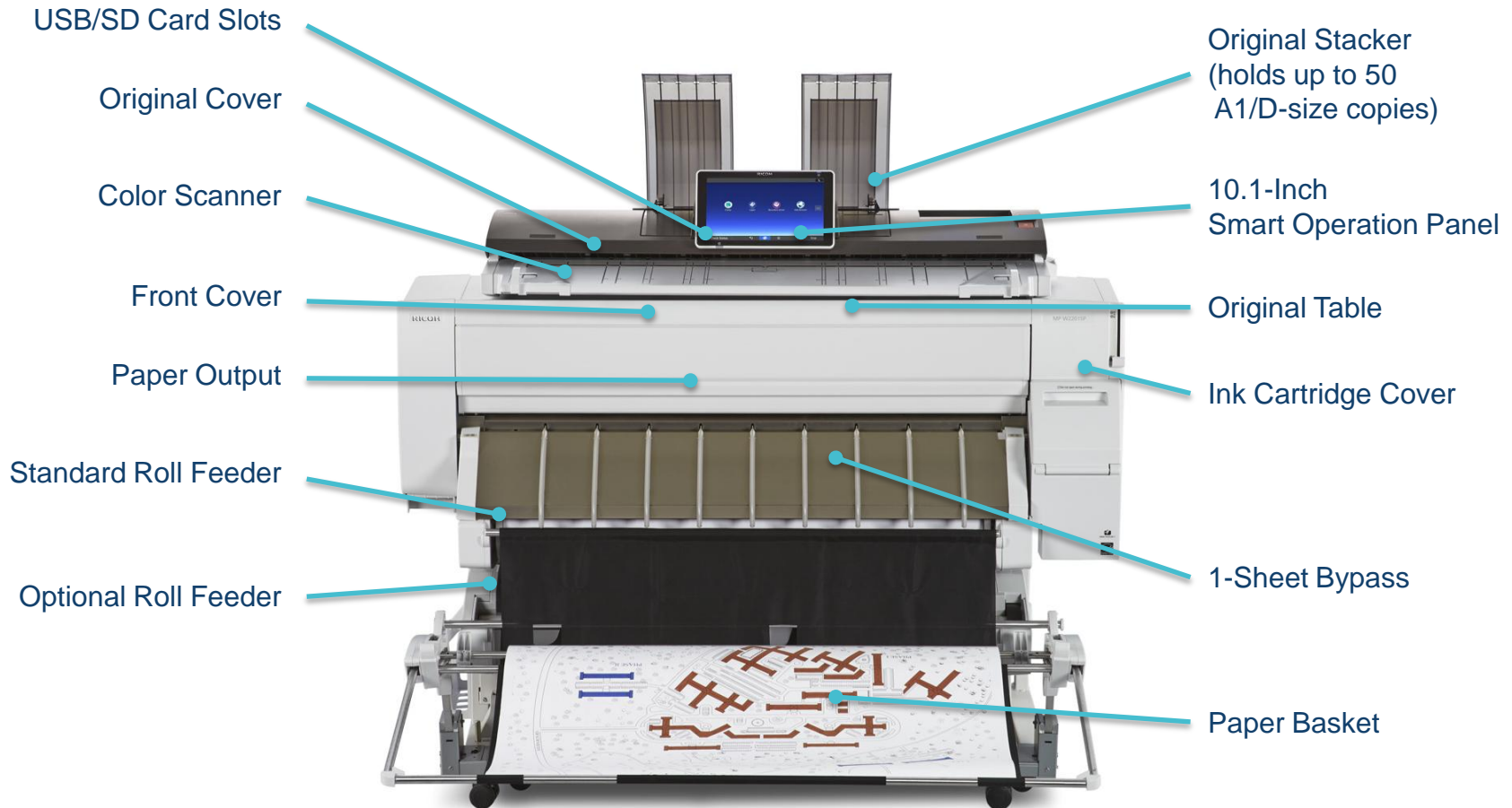

## MP CW2201SP Dimensions:

Width: 55.5" (1,420mm) • Depth: 26.6" (676mm) • Height: 48.0" (1,219mm) • Weight: 265 lbs. (120kg)

## Benefit from a best-in-class solution uniquely designed for large format document creation and distribution:

- **Save Space** with an all-in-one color wide format MFP
- **Deliver Fine Details** with the latest inkjet technology
- **Be More Productive** with a customizable user interface
- **Improve Efficiency** with remote management capabilities
- **Support a Mobile Workforce** with scan-to functionalities, remote management
- **Produce Confidently** with advanced security features
- **Sustain Low TCO** with eco-friendly features



**MP CW2201SP**



# Key Features & Benefits

## Reliable Output & Image Capture

- Up to **1200 x 1200 dpi** print resolution for fine detail reproduction
- **Copy & Scan Resolutions up to 600 dpi** (2400 dpi TWAIN is supported for A4 size prints)
- Ricoh's **Next-Generation Inkjet Technology** is smudge resistant for superior results
- **Fast-drying, pigment-based ink** embeds color pigment between the paper fibers
- **Dual print heads** and minimal dot spread allows users to achieve optimum results on every job
- **Save set-up and execution time** with PDF Batch Print (which allows user to place multiple PDF files in a print queue), or PDF Direct Print (which allows PDF files to be sent for printing without having to open a PDF application).
- An **Emergency Print** feature that automatically switches to precise black & white should the color ink unintentionally run out
- Handles a wide array of media including Plain Paper, Recycle Paper, Inkjet Plain Paper, Tracing Paper, Matte Film, Coated Paper, Coated Paper (CAD) and Special Paper

## Look Sharp

When your image is always on the line you need the reliability of a color wide format MFP that can capture, communicate, and accurately represent your ideas.



# Key Features & Benefits

## Convenient and Compact Design

- **One single mainframe** platform supports **multiple functions**
- **Clamshell design** enables system front-access for easier replacement of paper rolls and inks. Clear paper jams in an efficient and timely manner
- **Overall ergonomic design** makes it easy to operate the control panel or set roll paper (paper guides have been extended 30mm compared to previous model)
- **1-Roller Feed with optional second roller supports multiple media types.**
  - Accepts up to 590" roll paper (2" and 3" cores) up to 36" (3') wide
- **A Simplified Stacker Operation** reduces the number of steps required to set up the output basket and get on with your day.

## Do More With More Space

Conserve valuable office space, maintain a clean and organized look and meet your production requirements all while reducing your carbon footprint. It's small, but mighty.



# Key Features & Benefits

## Productivity Enhancing Scanning Capabilities

- **Scan Speed/Resolution:**
  - B&W: 3.14 ips (600 dpi)
  - Color: 1.05 ips (600 dpi)
  - Network TWAIN Scan: Up to 2400 dpi
- **Scan-to Functionalities** provide the ability to distribute documents efficiently and instantly, how and where recipients want them.
  - Scan-to Email
  - Scan-to Folder
  - Scan-to FTP
  - Scan-to URL/Document Server
  - Scan-to Media (USB/SD Card)
- **OCR Capabilities** allows you the ability to scan and create editable text files from hardcopy originals

## Deliver Accurate Information Quickly

Sharing information and ensuring it is delivered to where it needs to go in the format it needs to be. Creating a more flexible environment to do business.



# Key Features & Benefits

## Environmental Attributes

- **EPEAT Gold Label**
- **ENERGY STAR® Compliant**
- **Sleep Mode** low power consumption when machine is not in use
- **Combine copy** prints multi-page documents on a single sheet
- **Ink Save Mode** reduces ink consumption by up to 50%
- **Short Warm-up Time** is less than 40 second reduces energy consumption
- Meets **RoHS Directive Compliance** with Lead-Free, Hazardous-free Substances

## Keep Costs and Consumption Low

This single wide format multifunction platform features an array of energy saving features contribute to a low Total Cost of Ownership.



# Key Features & Benefits

## Best-in-Class Security

- **HDD data encryption** The Hard Drive Data Encryption function encodes documents stored on the hard drive which safeguards your data files even if the hard drive is removed
- **PDF Encryption** protects sensitive information from being intercepted and altered
- **User Authentication** options for eliminating unauthorized usage
- **Administrator Authentication** gives select admins the ability to manage user access and prevents users from altering system settings
- **DataOverwriteSecurity System (DOSS)** automatically overwrites the area of the hard drive used for image processing which makes it virtually impossible to extract or recover sensitive data from the hard drive
- **User Lockout function** prevents users from making multiple log-in attempts

## Create, Distribute and Share, Securely.

In many CAD-centric environments, highly sensitive yet mission-critical data must travel across the network in order to move business forward. Safeguard your intellectual property and collaborate with confidence knowing your best ideas are protected.

# Output Examples

## CAD Drawing



## PFP/CRD

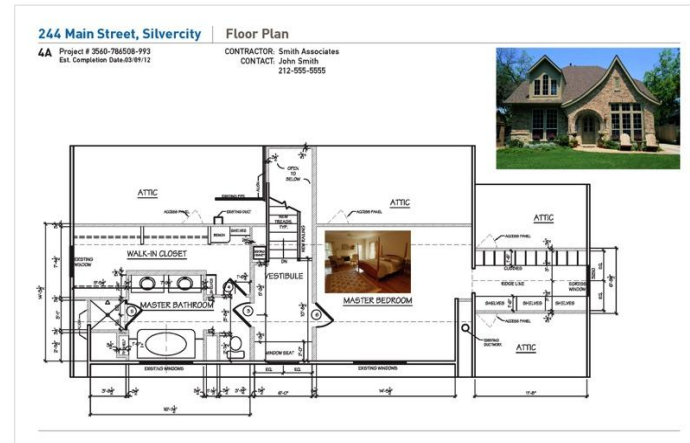

## Renderings

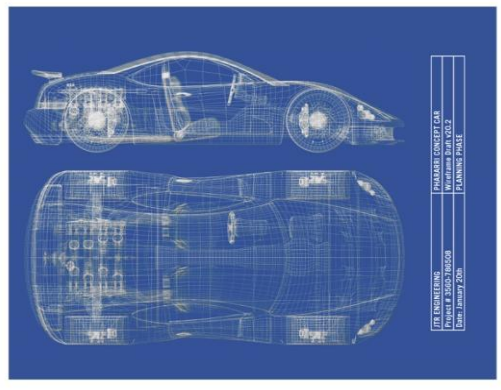

## Map





## Cash Purchase Price - \$8,909.00

### 48 month Lease program

- \$253.83 a month
- \$87.22 a month – 48 mo. Bronze Plan
  - Service includes parts and labor only
  - Toner not included
  - Includes first 2600 square feet
  - B/W Overages billed quarterly @ .0333
  - Color Overages billed quarterly @ .0519
  
- Pricing is based off of State of Texas TASB Contract 537-17 and includes a further discount.

**RICOH**  
imagine. change.