

## Application for Water Service

Applications are accepted from **Monday through Friday from 8:00 am to 4:30 pm.**  
Please fill out and bring the completed application to the office.

1. Only the property owner may fill out the application.
2. **We will need a copy of the deed to show proof of ownership.**
3. Please read and sign the Service Agreement.
4. We will need for you to attain **1 permit** from the **Hidalgo County Planning Dept., (956) 318-2840, located at 1304 S. 25th St., Edinburg**, if you live outside city limits and have septic tanks. If you live within the **city limits, the city you pertain to will provide you with the permits.** If you live in **Willacy County** we will need a building permit from the **Willacy County Courthouse** annex building in Raymondville. For more information please call the county inspector at (956) 689-3393. In **Cameron County**, you will need to attain **1 permit** from the **Cameron County Environmental Health Department, Jesse Silva (956-247-3606) or Richard Castillo (956-247-3604).**
5. Place a stake on your property where you want the water meter. The stake should be at least 3 feet high with your name painted on the stake. Wherever you place the stake, is where we will set the meter. If you ever have to move the meter, you will have to pay for relocating the meter.
  - **Keep in mind that we will need access to the meter at all times. Fences, dogs, and driveways must be considered before placing the stake on your property.** If you are planning to build a fence, you must build the fence allowing access to the meter. If you already have a fence, you must fix the fence in a way our repair and meter departments have access to the meter. Keeping meter box free of litter is your responsibility. **Do not tie your dog close to the meter.**
6. If you do not live in a subdivision, please use the map diagram on the application to indicate the nearest crossroads where you live.
7. If you have water related medical emergency, please furnish a proof document signed by a physician stating the water-related emergency.
8. If the Developer of your subdivision has given you a pre-paid letter we will need it for our files. The letter will replace the amount of your membership and the customer only pays the inspection.
9. Please provide us with a copy of your **picture ID or Drivers License.**
10. Please sign and date at the bottom once you have read and understood the above mentioned.

---

Applicant's Signature

---

Date

---

New Accts. Rep.

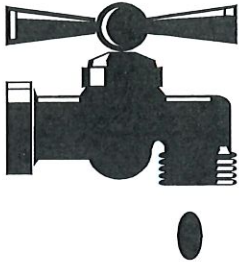

**North Alamo Water Supply  
Corporation  
420 S. Doolittle Rd.  
Edinburg, Tx 78542  
383-1618**

WO# \_\_\_\_\_  
ROW \_\_\_\_\_ PE \_\_\_\_\_  
RES \_\_\_\_\_ COM \_\_\_\_\_  
DEED \_\_\_\_\_  
PD \_\_\_\_\_ ND \_\_\_\_\_  
AMT \$ \_\_\_\_\_

Date: 11/11/2018  
 Property owner(s): Hidalgo County Precinct 4 Spouse \_\_\_\_\_  
 Home Phone # (956) 383-3112 Work Phone # (\_\_\_\_) same  
 Driver's License # N/A Driver's License # N/A  
 Marital Status: Single (\_\_\_\_) Married (\_\_\_\_) Widowed (\_\_\_\_)  
 Mailing Address: 1051 N. Doolittle Road  
 City: Edinburg State TX Zip Code 78542  
 Number in family Milo Ponce Park  
 Will you have a sprinkler system? Yes  
 Will the water be for residential or commercial use? Commercial  
 If commercial, please state what type of business: Government  
 And, what will the water service be used for? Restroom facility  
 Subdivision Name: Santa Cruz Gardens Lot # 637 Blk # 15  
 Name of Road: FM 2812 (Milo Ponce Park)  
 Description of lot (empty lot, house; color) Milo Ponce Park

The following information is requested by the Federal Government in order to monitor compliance with Federal laws prohibiting discrimination against applicants seeking to participate in this program. You are not required to furnish this information, but are encouraged to do so. This information will not be used in evaluating your application or to discriminate against you in any way. However, if you choose not to furnish it, we are required to note the race/national origin of individual applicants on the basis of visual observation or surname.

\_\_\_\_ Male \_\_\_\_ Female

\_\_\_\_ White, Not of Hispanic Origin      \_\_\_\_ Black, Not of Hispanic Origin  
 \_\_\_\_ American Indian or Alaskan Native      \_\_\_\_ Hispanic  
 \_\_\_\_ Other, Specify \_\_\_\_\_      \_\_\_\_ Asian or Pacific Islander

Rec # \_\_\_\_\_ Date Paid \_\_\_\_\_ Amt \$ \_\_\_\_\_

***This institution is an equal opportunity provider, and employer.***

Have you previously received water service from North Alamo Water Supply Corporation (NAWSC), if so, under your name or another persons name? Yes

If yes, please list below all names and account numbers.

Name: Hidalgo County Pct. 4 Name: Hidalgo County Pct. 4 Name: Hidalgo County Pct. 4  
Acct # 32-6803-000-00 Acct # 31-5645-100-00 Acct # 36-2354-000-00

Do you understand and agree that once the Board of Directors of NAWSC has accepted your application for membership and a water meter has been installed by NAWSC for your use, the monthly minimum and usage fee will commence and you as the member will be responsible for it's payment to NAWSC regardless of whether or not water is used or whether or not plumbing is connected to members side of the meter?

Yes  No

Do you understand and agree that you as the NAWSC member are responsible for all charges to the membership account regardless of who used the water?

Yes  No

Do you understand and agree the Board of Directors of NAWSC has the authority and responsibility of fixing the charges and fees to cover the costs and provide funds to meet legal obligations of NAWSC?

Yes  No

Do you understand and agree the service agreement authorizes access of the NAWSC to the meter located on your property and assumes you will comply with the laws Texas and the Texas Department of Health regarding your use of the water service?

Yes  No

Do you understand and agree that some time in the future, NAWSC may require a right-of-way easement over and across your property for the purpose of installing potable water facilities and your refusal to grant such easement of such form, as may be required by NAWSC, will result in discontinuance of your water service and cancellation of your NAWSC membership?

Yes  No

Do you acknowledge that you must maintain in compliance with all applicable local governmental Ordinances or regulations, including but not limited to ordinances or regulations relating to the regulations of subdivisions, and that your failure to comply, may result in the termination of the water service to you?

Yes  No

Do you understand that there are no exemptions for a service charge, due to a trip that a serviceman or service made?

Yes  No

\_\_\_\_\_  
Applicant's Signature

\_\_\_\_\_  
Date

**North Alamo Water Supply Corporation  
Service Agreement**

AGREEMENT made on this \_\_\_\_\_ day of \_\_\_\_\_, 20\_\_\_\_ between North Alamo Water Supply Corporation, a Corporation organized under the laws of the State of Texas ( here in after call The Corporation ) and \_\_\_\_\_.

The Corporation agrees to sell and deliver water to the Member and Member agrees to purchase and receive water from the Corporation, for general farm use and domestic purposes, in accordance with the bylaws and rules of the Corporation as amended from time to time by the Corporation's Board of Directors.

The member shall pay the Corporation for service hereunder at the rates and upon the terms and conditions set forth in the rate schedule adopted from time to time by Corporation's Board of Directors  
The Board of Directors shall have the authority to cancel the membership of any member in the event of nonpayment of any water charges or assessments owing by said member within thirty (30) days after demand for payment by mail, properly addressed to such delinquent member.

All water shall be metered by Water Meters furnished and installed by the Corporation.

In the event the total water supply shall be insufficient to meet all the needs of the Members, or in the event there is a shortage of water, the Corporation may pro-rate the water available among the various Members on such basis as is deemed suitable by the Board of Director, and may also prescribe a Schedule of hours covering the use of water for any purposes by particular Members and require adherence thereto or prohibit the use of water for any purposes; provided that, if at any time the total water supply by insufficient to meet all the needs of all the members the Corporation must first satisfy all the needs of all Members for domestic purposes before supplying any water for livestock purposes and must satisfy all the needs of all Members for both domestic and livestock before supplying any water for garden purposes.

The member shall allow his property to be inspected for possible cross-connections and other potential contamination hazards. These inspections shall be conducted by the Corporation or its designated agent prior to initiating new water service; when there is reason to believe that cross-connections or other potential contamination hazards exist; or after any major changes to the water distribution. No direct connection between the public drinking water supply and a potential source of contamination is permitted. Potential sources of contamination shall be isolated from the public water system by an air-gap or an appropriate backflow prevention device. No cross-connection between the public drinking water supply and a private water system is permitted. No connection which allows water to be returned to the public drinking water supply is permitted. No pipe or pipe fitting which contains more than 8.0% lead may be used for the installation or repair of plumbing at any connection which provides water for human use. No solder or flux which contains more than 0.2% lead can be used for the installation or repair of plumbing at any connection which provides water for human use.

The Member shall install and maintain at his own expense a service line from the meter to the point of use.

The Member shall hold the Corporation harmless from any and all claims or demands for damages to real-estate or personal property occurring from the point of Member ties on to the Corporation meter to the final destination of the line installed by Member. The Member agrees to grant to the Corporation an easement of right-of-way for the purpose of installing, maintaining, and operating such pipelines, meter valves and any other such equipment which may be deemed necessary for the Corporation on such form as is required by the Corporation. Failure to provide such requested easements may result in the termination of water service.

The Corporation shall have the right to locate a water service meter and pipe, necessary to connect the meter on the property of the Member at a point to be chosen by the Corporation and shall have access to its property on the Member's premises at all time for any purpose connected with or in the furtherance of its business operations, and on discontinuance of service shall have the right to remove any of its property from the Members premises.

If the customer fails to comply with the terms of the Service Agreement, the Corporation may at its option, either terminate service or properly install, test, and maintain an appropriate backflow prevention device at the service connection. Any expenses associated with the enforcement of this agreement shall be billed to the customer.

Member signature \_\_\_\_\_ Co-Owner/Spouse \_\_\_\_\_

**\*\*\* PLEASE STAKE METER LOCATION WITH NAME ON STAKE\*\*\*  
STAKE SHOULD BE AT LEAST 3 FEET HIGH.**

Make map showing closest crossroads.

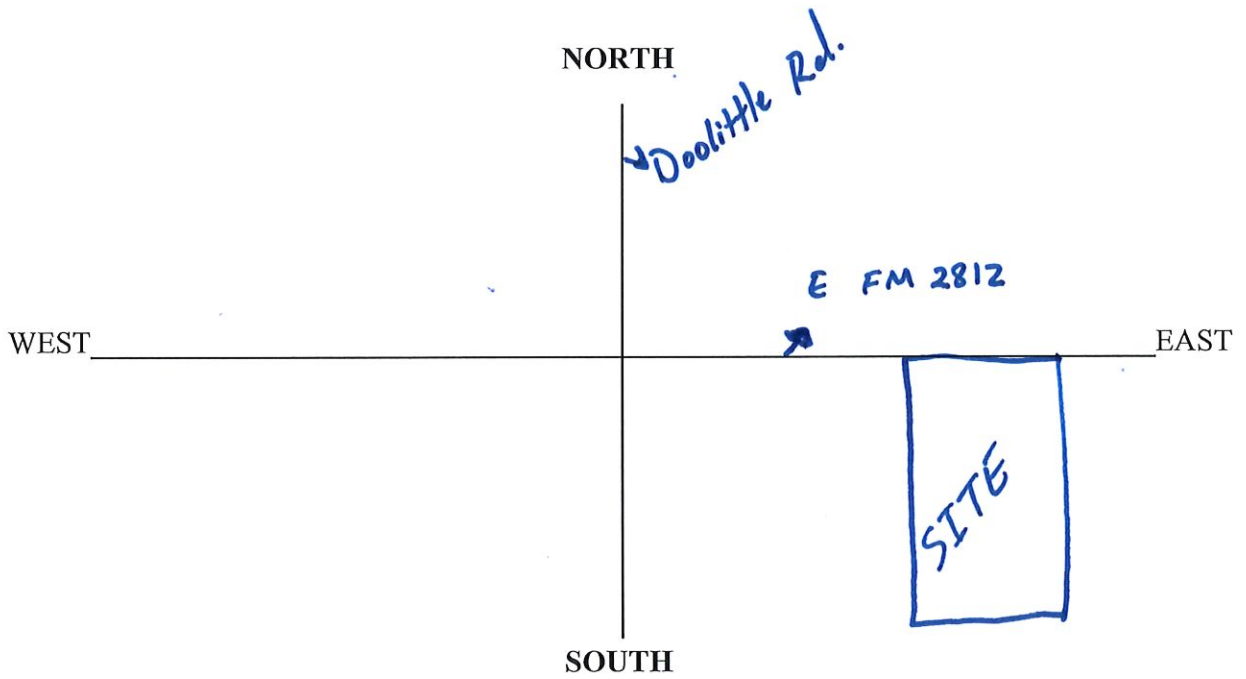

INFORMATION DISCLOSURE

The Texas Legislature has enacted a bill, which was effective September 1, 1993, allowing publicly-owned utilities to give their customers the option of making the customer's address, telephone number, and social security number confidential.

IS THERE A CHARGE FOR THIS SERVICE?

Yes. There is a one-time charge of \$1.00 to cover the cost of set-up and implementation order for \$1.00 to:

North Alamo Water Supply Corporation  
420 South Doolittle Road  
Edinburg, TX 78539

Your response is not necessary if you do not want this service.

WE MUST STILL PROVIDE THIS INFORMATION UNDER LAW TO CERTAIN PERSONS. We must still provide this information to (1) an official or employee of the state or a political subdivision of the state, or the federal government acting in an official capacity; (2) an employee of a utility acting in connection with the employee's duties; (3) an consumer reporting agency; (4) a contractor or subcontractor approved by and providing services to the utility or to the state, a political subdivision of the state, the federal government, or an agency of the state or federal government; (5) a person for whom the customer has contractually waived confidentiality for personal information; or (6) another entity that provides water, wastewater, sewer, gas, garbage, electricity, or drainage service for compensation.

---

Detach and Return This Section

**Need all information and signature**

Yes, I want you to make my personal information (address, telephone number, and social security number) confidential. I have enclosed my payment of \$1.00 for this service.

\_\_\_\_\_  
Name of Account Holder

\_\_\_\_\_  
Account Number

\_\_\_\_\_  
Address

\_\_\_\_\_  
Area Code/Telephone

\_\_\_\_\_  
City                      State              Zip Code

\_\_\_\_\_  
**Signature**

## Cash Received

\$100 Bills			Quarter Rolls		
\$50 Bills			Dime Rolls		
\$20 Bills			Nickel Rolls		
\$10 Bills			Penny Rolls		
\$5 Bills			Loose Change		
\$1 Bills					
<b>Total</b>					