

CONSTRUCTION CONTRACT CHANGE ORDER NUMBER: 1

1. CONTRACTOR: Earthworks Enterprise, LLC
2. Change Order Work Limits: Sta. 11+11 to Sta. 58+00
3. Type of Change (on federal-aid non-exempt projects): Minor (Major/Minor)
4. Describe the change and the reason for the change order. When necessary, include exceptions to this agreement.

Modify TCP: Close Dicker Road from 23rd to 10th Street to expedite construction and reduce construction cost within a one mile segment. The one-mile segment has no residents or business that would require public access or a need for phased construction to managing traffic for safety. This plan does not modify the pavement structure and allows for a seamless construction without the need for traffic control. The quantities have been reduced and plan sheets have been modified. No time

CCSJ:	<u>0921-02-312</u>
Project:	<u>STP 2019(086)TP</u>
Highway:	<u>Dicker Road</u>
County:	<u>Hidalgo</u>
District:	<u>Pharr</u>
Contract Number:	<u>C-19-017-11-05</u> <u>2019-017-7-31-RFV</u>

5. New or revised plan sheet(s) are attached and numbered: 11a, 11ab, 16a, 17a, 18a, 19a, see Cover Sheet for Addl

Each signatory hereby warrants that each has the authority to execute this Change Order.

<p>By signing this change order, the contractor agrees to waive any and all claims for additional compensation due to any and all other expenses; additional changes for time, overhead and profit; or loss of compensation as a result of this change. Further, the contractor agrees that this agreement is made in accordance with Item 4 and the Contract. Exceptions should be noted in the response for #5 above.</p>	<p>The following information must be provided</p> <p>Time Ext. #: <u>0</u> Days added on this C.O.: <u>0</u></p> <p>Amt. added by this change order: <u>\$-539,375.16</u></p>
	<p>For TxDOT use only:</p> <p>Days participating: _____</p> <p>Amount participating: _____</p> <p>Signature _____ Date _____</p> <p>Name/Title _____</p>
<p>THE CONTRACTOR Date <u>1-15-2020</u></p> <p>By <u>[Signature]</u></p> <p>Typed/Printed Name <u>Humberto Garcia Jr</u></p> <p>Typed/Printed Title <u>Owner</u></p>	

RECOMMENDED FOR EXECUTION:

<p><u>[Signature]</u> <u>1-16-2020</u></p> <p>Name/Title _____ Date _____</p>	<p>Name/Title _____ Date _____</p> <p><input type="checkbox"/> APPROVED <input type="checkbox"/> REQUEST APPROVAL</p>
<p>Name/Title _____ Date _____</p>	<p>Name/Title _____ Date _____</p> <p><input type="checkbox"/> APPROVED <input type="checkbox"/> REQUEST APPROVAL</p>
<p>Name/Title _____ Date _____</p>	<p>Name/Title _____ Date _____</p> <p><input type="checkbox"/> APPROVED <input type="checkbox"/> REQUEST APPROVAL</p>
<p>Name/Title _____ Date _____</p>	<p>Name/Title _____ Date _____</p> <p><input type="checkbox"/> APPROVED</p>

Engineer's Seal:



Change Order #1 Dicker Road

Owner: Hidalgo County Precinct #2

To: Earthworks Enterprise, LLC
PO Box 595
Penitas, Texas 78576

From: B2Z Engineering

Project: Dicker Road
Contract: C-19-17-11-05
Project #: STP 2019(086)TP
CSJ: 0921-02-312
Limits: Spur 115(23rd Street) to FM 2061(Jackson Road)

Change Order #1 has been approved to make the following Contract Changes:

Description:

Change Order #1 allows for changes to the traffic control plan to expedite construction and reduce costs within a one-mile segment of Dicker Road between 23rd Street (Spur 115) and 10th Street (FM 336) on the west end of the project. This one-mile segment has no residents or business that would require public access or a need for phased construction to manage traffic safety. The detour around Dicker Road is within a half mile distance to the south or a one and half mile distance to the north. Traffic traveling east or west on Dicker Road will turn north or south at 23rd and 10th street to go into McAllen or the City of Hidalgo, respectively. The plan requires additional signing for the detour, and message boards will be used for advanced public notice. This plan does not modify the pavement structure but allows for a seamless construction without traffic or phasing. The detour quantities have been reduced and plan sheets have been modified to reflect a road closure on Dicker Road. This cost saving plan has been presented, reviewed and accepted by both the County and the Contractor for Change Order No.1.

Purpose:

The Hidalgo County Precinct #2 Office identified locations within the plans to modify construction phases in order to save money, without compromising the overall intent of the project. This change order allows the County to save funds and complete the work with no traffic interference or interferences with local business's or residences. A new contract item will be introduced in this change order, Detour Traffic (Spl) for a one-time payment to detour traffic around Dicker Road. The City of Hidalgo and TxDOT have been notified of the detours and agree with the new designated routes. The existing signals at 23rd and 10th Street will remain in place for traffic movement that does not require temporary signal adjustments.

The change order has been signed by the Contractor and AE. There is no additional funding involved, and a reduction in quantities and values. There is no funding involved, only reduction of values. The County has been notified of the Change Order and agrees with CO #1. The changes

do not impact the original environmental assessment, do not impact TDLR elements, do not impact wetlands, or waters of the US, archeological, historical or social issues; endangered species or any other regulated areas within the project will not see change. This change order does not cause a disturbance that would require a Construction Site Notice (CSN) or Notice of Intent (NOI). This CO will require additional signing to detour traffic outside of the original project limits, without impact to the project. Dicker Road dead ends at 23rd Street, where traffic must turn north or south already. Traffic will perform the same function at 10th Street, which a majority of truck traffic normally take to get to the trade zone on Spur 115.

B2Z has reviewed the change order with Precinct #2, to explain the breakdown of items and payment according to the governing Specification 1L-9L. See TxDOT Change Order Form 2146-L used to describe bid item changes and cost changes. Revised plan sheets include 11a, 11ab, 16a-20a, 27a, 29a, 32a-35a, 40a, 41a, 46a, 47a, 52a, 53a, 56a, 57a, 60a, 61a, 64a.

CHANGE IN CONTRACT PRICE:	CHANGE IN CONTRACT TIME:
Original Contract Price <u>\$16,519,063.02</u>	Original Contract Time <u>460 working Days</u>
Previous Change Orders <u>\$0.00</u>	Previous Change Orders <u>0 Working Days</u>

Contract Price prior to this Change Order <u>\$16,519,063.02</u>	Contract Time prior to this Change Order <u>460 Working Days</u>
Net increase/decrease of the Change Order <u>-\$539,375.16</u>	Net increase/decrease of the Change Order <u>0 Working Days</u>
Contract Price with all approved Change Orders <u>\$15,979,687.86</u>	Contract Time with all approved Change Orders <u>460 Working Days</u>

ESTIMATE QUANTITY

ITEM NO.	DESCRIPTION	UNIT	TOTAL	
			EST	FINAL
0100 6002	PREPARING ROW	STA	136.4	
0104 6009	REMOVING CONC (RIPRAP)	SY	470.0	
0104 6015	REMOVING CONC (SIDEWALKS)	SY	35.0	
0104 6017	REMOVING CONC (DRIVEWAYS)	SY	1433.0	
0104 6022	REMOVING CONC (CURB AND GUTTER)	LF	1419.0	
0104 6032	REMOVING CONC (WHEELCHAIR RAMP)	SY	122.0	
0104 6037	REMOVE CONC (RAIL)	LF	540.0	
0110 6001	EXCAVATION (ROADWAY)	CY	62071.0	
0132 6006	EMBANKMENT (FINAL)(DENS CONT)(TY C)	CY	51338.0	
0160 6005	FURNISHING AND PLACING TOPSOIL	CY	50.0	
0164 6029	CELL FBR MLCH SEED(TEMP)(WARM)	SY	50955.0	
0164 6031	CELL FBR MLCH SEED(TEMP)(COOL)	SY	50955.0	
0168 6001	VEGETATIVE WATERING	MG	1000.0	
0189 6003	SOIL RETENTION BLANKETS (CL 1) (TY C)	SY	244.0	
0204 6003	SPRINKLING (DUST CONTROL)	MG	545.6	
0216 6001	PROOF ROLLING	HR	60.0	
0247 6225	FL BS (RDWY DEL)(TY E GR 4)(FNAL POS)	CY	18253.0	
0251 6185	REWORK BS MATL (TY B)(11')(DENS CONT)	CY	18013.0	
0260 6011	LIME TRT (EXST MATL) (12")	SY	105861.0	
0260 6016	LIME (HYD. COM. OR QK(SLURRY))	TON	3682.0	
0260 6058	LIME TRT(MIX EXST MATL & NEW BASE)(11")	SY	102902.0	
0305 6003	SALV. HAUL & STKPL RCL APH PV (2 TO 4")	SY	58552.0	
0310 6009	PRIME COAT (MC-30)	GAL	20580.0	
0341 6008	D-GR HMA TY-B PG64-22	TON	24102.0	
0341 6047	D-GR HMA TY-D SAC-A PG78-22	TON	16453.0	
0354 6041	PLANE ASPH CONC PAV (1.5")	SY	5647.0	
0400 6005	CEM STABIL BKFL	CY	720.6	
0400 6006	CUT & RESTORING ASPH PAV	SY	603.0	
0400 6010	STRUCT EXCAV (SPECIAL)	CY	6281.0	
0401 6001	FLOWABLE BACKFILL	CY	15.0	
0402 6001	TRENCH EXCAVATION PROTECTION	LF	14113.0	
0403 6001	TEMPORARY SPL SHORING	SF	2005.0	
0409 6002	PRESTR CONC PIL (18 IN SQ)	LF	1218.0	
0416 6030	DRILL SHAFT (TRF SIG POLE) (24 IN)	LF	126.0	
0416 6032	DRILL SHAFT (TRF SIG POLE) (36 IN)	LF	98.0	
0420 6019	CL C CONC (ABUT)(EXTEND)	CY	117.8	
0420 6033	CL C CONC (CAP)(EXTEND)	CY	23.0	
0422 6003	REINF CONC SLAB (EXTEND SLAB)	SF	8631.0	
0425 6037	PRESTR CONC GIRDER (TX40)	LF	427.9	
0425 6039	PRESTR CONC GIRDER (TX54)	LF	372.3	
0432 6001	RIPRAP (CONC)(4 IN)	CY	993.0	
0432 6002	RIPRAP (CONC)(5 IN)	CY	186.0	
0442 6007	STR STEEL (MISC NON - BRIDGE)	LB	546.0	
0450 6023	RAIL (TY SSTR)	LF	625.5	
0450 6042	RAIL (TY PR1)	LF	3505.5	
0452 2003	REMOVE RAIL (CONC POST & MTL ELEM)	LF	540.0	
0454 6001	SEALED EXPANSION JOINT (4 IN) (SEJ - A)	LF	127.5	
0462 6003	CONC BOX CULV (4 FT X 2 FT)	LF	63.0	
0462 6004	CONC BOX CULV (4 FT X 3 FT)	LF	339.0	
0462 6012	CONC BOX CULV (6 FT X 5 FT)	LF	2452.0	
0462 6013	CONC BOX CULV (6 FT X 6 FT)	LF	1512.0	
0462 6060	CONC BOX CULV (7 FT X 5 FT)(EXTEND)	LF	148.0	
0462 6070	CONC BOX CULV (9 FT X 7 FT)(EXTEND)	LF	223.0	
0464 6003	RC PIPE (CL III)(18 IN)	LF	206.0	
0464 6025	RC PIPE (CL V)(18 IN)	LF	400.0	
0464 6038	RC PIPE (CL III)(18 IN)(SPL)	LF	1474.0	
0464 6039	RC PIPE (CL III)(24 IN)(SPL)	LF	1424.0	
0464 6040	RC PIPE (CL III)(30 IN)(SPL)	LF	1931.0	
0464 6041	RC PIPE (CL III)(36 IN)(SPL)	LF	250.0	
0464 6042	RC PIPE (CL III)(42 IN)(SPL)	LF	1037.0	
0464 6043	RC PIPE (CL III)(48 IN)(SPL)	LF	520.0	
0464 6044	RC PIPE (CL III)(54 IN)(SPL)	LF	1651.0	

ESTIMATE QUANTITY (CONT)

ITEM NO.	DESCRIPTION	UNIT	TOTAL	
			EST	Change Order #1
0464 6045	RC PIPE (CL III)(60 IN)(SPL)	LF	915	
0465 6029	INLET (COMPL)(PCU)(3FT)(NONE)	EA	19	
0465 6030	INLET (COMPL)(PCU)(3FT)(LEFT)	EA	15	
0465 6031	INLET (COMPL)(PCU)(3FT)(RIGHT)	EA	8	
0465 6033	INLET (COMPL)(PCU)(4FT)(NONE)	EA	1	
0465 6035	INLET (COMPL)(PCU)(4FT)(RIGHT)	EA	2	
0465 6037	INLET (COMPL)(PCU)(5FT)(NONE)	EA	2	
0465 6038	INLET (COMPL)(PCU)(5FT)(LEFT)	EA	1	
0465 6039	INLET (COMPL)(PCU)(5FT)(RIGHT)	EA	1	
0465 6041	INLET (COMPL)(PCU)(6FT)(NONE)	EA	3	
0465 6074	INLET (COMPL)(PSL)(RC)(5FTX5FT)	EA	4	
0465 6076	INLET (COMPL)(PSL)(RC)(6FTX6FT)	EA	2	
0465 6077	INLET (COMPL)(PSL)(RC)(8FTX8FT)	EA	5	
0465 6158	INLET (COMPL)(PAZD)(FG)(3FTX3FT-3FTX3FT)	EA	5	
0465 6160	INLET (COMPL)(PAZD)(FG)(4FTX4FT-4FTX4FT)	EA	1	
0465 6176	INLET (COMPL)(CURB)(TY C1) (MOD)	EA	10	
0467 6356	SET (TY II) (18 IN) (RCP) (3: 1) (C)	EA	2	
0467 6388	SET (TY II) (24 IN) (RCP) (3: 1) (C)	EA	1	
0480 6001	CLEAN EXIST CULVERTS	EA	2	
0486 6003	REMOV STR (MANHOLE)	EA	1	
0496 6005	REMOV STR (WINGWALL)	EA	4	
0496 6007	REMOV STR (PIPE)	LF	5979	
0496 9001	REMOVE STRUCT (EXIST STANDPIPE)	EA	3	
0496 9002	REMOVE STRUCT (EXIST IRRIG VALVE)	EA	3	
0785 6011	BRIDGE JOINT REPLACEMENT (SEJ)	LF	361	
1007 9001	IRRIG WELL (48") (STANDPIPE)	EA	3	
1007 9002	IRRIG VALVE (14") ALFALFA	EA	3	
1008 6006	PRSSR IRRIG PVC PIPE (15")	LF	388	
7018 6090	CASING (STEEL) (24 IN) (OPEN TRENCH)	LF	256	
0500 6001	MOBILIZATION	LS	1	
0502 6001	BARRICADES, SIGNS AND TRAFFIC HANDLING	MO	23	
0506 6001	ROCK FILTER DAMS (INSTALL) (TY 1)	LF	92	
0506 6004	ROCK FILTER DAMS (INSTALL) (TY 4)	LF	9	
0506 6011	ROCK FILTER DAMS (REMOVE)	LF	101	
0506 6021	CONSTRUCTION EXITS (INSTALL) (TY 2)	SY	1463	
0506 6024	CONSTRUCTION EXITS (REMOVE)	SY	1463	
0506 6031	FRNT END LOADER WORK (ERSN & SEDM CONT)	HR	80	
0506 6038	TEMP SEDMT CONT FENCE (INSTALL)	LF	5147	
0506 6039	TEMP SEDMT CONT FENCE (REMOVE)	LF	5147	
0506 6041	BIODEG EROSN CONT LOGS (INSTL) (12")	LF	1085	
0506 6043	BIODEG EROSN CONT LOGS (REMOVE)	LF	1085	
0506 6001	CONSTRUCTING DETOURS	SY	19864	9073
0512 6001	PORT CTB (FUR & INST)(SGL SLOPE)(TY 1)	LF	3180	
0512 6009	PORT CTB (FUR & INST)(LOW PROF)(TY 1)	LF	6880	3120
0512 6010	PORT CTB (FUR & INST)(LOW PROF)(TY 2)	LF	320	240
0512 6025	PORT CTB (MOVE)(SGL SLP)(TY 1)	LF	2130	
0512 6049	PORT CTB (REMOVE)(SGL SLP)(TY 1)	LF	3180	
0512 6057	PORT CTB (REMOVE)(LOW PROF)(TY 1)	LF	6880	3120
0512 6058	PORT CTB (REMOVE)(LOW PROF)(TY 2)	LF	320	240
0529 6029	CONC CURB & GUTTER (TY A)	LF	26665	
0529 6031	CONC CURB & GUTTER (VALLEY GUTTER) (48")	LF	89	
0530 6004	DRIVEWAYS (CONC)	SY	831	
0530 6005	DRIVEWAYS (ACP)	SY	6225	
0531 6001	CONC SIDEWALKS (4")	SY	16141	
0531 6004	CURB RAMPS (TY 1)	EA	28	
0540 6001	MTL W-BEAM GD FEN (TIM POST)	LF	575	

DATE: 7/15/2019
FILE: SPLEES

CO #1 - Detour Traffic 23rd Street to 10th Street

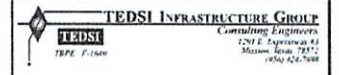
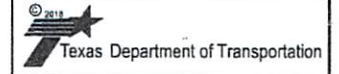
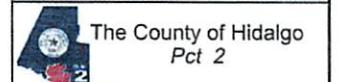

DICKER ROAD ESTIMATE QUANTITY

SHEET 1 OF 2					
06	0921	02	312	DICKER ROAD	
TEXAS	PHR	HIDALGO	No 2	HIDALGO	118

ESTIMATE QUANTITY (CONT)

ITEM NO.	DESCRIPTION	UNIT	TOTAL	
			EST	Change Order #1
0540 6006	MTL BEAM GD FEN TRANS (THRIE-BEAM)	EA	4	
0540 6015	DRIVEWAY TERMINAL ANCHOR SECTION	EA	2	
0540 6016	DOWNSTREAM ANCHOR TERMINAL SECTION	EA	2	
0542 6001	REMOVE METAL BEAM GUARD FENCE	LF	2801	
0542 6002	REMOVE TERMINAL ANCHOR SECTION	EA	8	
0545 6001	CRASH CUSH ATTEN (IN STL)	EA	10	
0545 6003	CRASH CUSH ATTEN (MOVE & RESET)	EA	4	
0545 6005	CRASH CUSH ATTEN (REMOVE)	EA	10	
0590 6007	MAILBOX INSTALL-S (WC-POST) TY 3	EA	2	
0618 6016	CONDT (PVC) (SCH 40) (1")	LF	806	
0618 6023	CONDT (PVC) (SCH 40) (2")	LF	4965	
0618 6033	CONDT (PVC) (SCH 40) (4")	LF	854	
0618 6034	CONDT (PVC) (SCH 40) (4") (BORE)	LF	213	
0620 6007	ELEC CONDR (NO.8) BARE	LF	1591	
0620 6009	ELEC CONDR (NO.6) BARE	LF	95	
0620 6010	ELEC CONDR (NO.6) INSULATED	LF	190	
0621 6005	TRAY CABLE (4 CONDR) (12 AWG)	LF	1900	
0624 6002	GROUND BOX TY A (122311)W/APRON	EA	52	
0624 6008	GROUND BOX TY C (162911)W/APRON	EA	3	
0625 6002	ZINC-COAT STL WIRE STRAND (3/16")	LF	3012	
0628 6301	ELC SRV TY T 120/240 000(NS)GS(L)TS(O)	EA	3	
0644 6027	IN SM RD SN SUP&AM TYS80(1)SA(P)	EA	46	
0644 6030	IN SM RD SN SUP&AM TYS80(1)SA(T)	EA	7	
0644 6033	IN SM RD SN SUP&AM TYS80(1)SA(U)	EA	3	
0644 6038	IN SM RD SN SUP&AM TYS80(1)SA(U-EXAL)	EA	1	
0644 6076	REMOVE SM RD SN SUP&AM	EA	35	
0658 6013	IN STL DEL ASSM (D-SW)SZ (BR)CTB	EA	10	
0658 6061	IN STL DEL ASSM (D-SW)SZ 1 (BRF)GF2	EA	6	
0658 6062	IN STL DEL ASSM (D-SW)SZ 1 (BRF)GF2 (BI)	EA	3	
0662 6004	WK ZN PAV MRK NON-REMOV (W)4*(SLD)	LF	99644	40758
0662 6017	WK ZN PAV MRK NON-REMOV (W)ARROW	EA	3	
0662 6018	WK ZN PAV MRK NON-REMOV (W)DBL ARW	EA	0	
0662 6029	WK ZN PAV MRK NON-REMOV (W)WORD	EA	3	
0662 6034	WK ZN PAV MRK NON-REMOV (Y)4*(SLD)	LF	76426	48974
0662 6060	WK ZN PAV MRK REMOV (W)4*(BRK)	LF	150	
0662 6063	WK ZN PAV MRK REMOV (W)4*(SLD)	LF	3500	
0662 6071	WK ZN PAV MRK REMOV (W)8*(SLD)	LF	200	
0662 6075	WK ZN PAV MRK REMOV (W)24*(SLD)	LF	304	235
0662 6095	WK ZN PAV MRK REMOV (Y)4*(SLD)	LF	4654	
0666 6030	REFL PAV MRK TY I (W)8*(DOT)(100MIL)	LF	312	
0666 6036	REFL PAV MRK TY I (W)8*(SLD)(100MIL)	LF	1682	
0666 6042	REFL PAV MRK TY I (W)12*(SLD)(100MIL)	LF	2351	
0666 6048	REFL PAV MRK TY I (W)24*(SLD)(100MIL)	LF	573	
0666 6300	RE PM W/RET REQ TY I (W)4*(BRK)(100MIL)	LF	6450	
0666 6303	RE PM W/RET REQ TY I (W)4*(SLD)(100MIL)	LF	3330	
0666 6312	RE PM W/RET REQ TY I (Y)4*(BRK)(100MIL)	LF	4250	
0666 6315	RE PM W/RET REQ TY I (Y)4*(SLD)(100MIL)	LF	29716	
0668 6005	PREFAB PAV MRK TY B (W)4*(BRK)CNTST	LF	140	
0668 6077	PREFAB PAV MRK TY C (W) (ARROW)	EA	41	
0668 6085	PREFAB PAV MRK TY C (W) (WORD)	EA	17	
0672 6007	REFL PAV MRKR TY I-C	EA	441	
0672 6009	REFL PAV MRKR TY II-A-A	EA	2997	2279
0677 6001	ELIM EXT PAV MRK & MRKS (4")	LF	40970	33479

ESTIMATE QUANTITY (CONT)

ITEM NO.	DESCRIPTION	UNIT	TOTAL	
			EST	Change Order #1
0677 6003	ELIM EXT PAV MRK & MRKS (8")	LF	1648	1503
0677 6005	ELIM EXT PAV MRK & MRKS (12")	LF	568	472
0677 6007	ELIM EXT PAV MRK & MRKS (24")	LF	1350	1312
0677 6008	ELIM EXT PAV MRK & MRKS (ARROW)	EA	20	26
0677 6012	ELIM EXT PAV MRK & MRKS (WORD)	EA	48	13
0680 6002	INSTALL HWY TRF SIG (ISOLATED)	EA	4	
0680 6004	REMOVING TRAFFIC SIGNALS	EA	4	
0681 6001	TEMP TRAF SIGNALS	EA	4	2
0682 6001	VEH SIG SEC (12")LED(GRN)	EA	32	
0682 6002	VEH SIG SEC (12")LED(GRN ARW)	EA	12	
0682 6003	VEH SIG SEC (12")LED(YEL)	EA	32	
0682 6004	VEH SIG SEC (12")LED(YEL ARW)	EA	12	
0682 6005	VEH SIG SEC (12")LED(RED)	EA	32	
0682 6006	VEH SIG SEC (12")LED(RED ARW)	EA	4	
0682 6017	PED SIG SEC (LED)(2 INDICATIONS)	EA	18	
0682 6023	BACK PLATE (12")X3 SEC	EA	14	
0682 6025	BACK PLATE (12")X5 SEC	EA	4	
0684 6010	TRF SIG CBL (TY A)(12 AWG)(5 CONDR)	LF	7955	
0684 6012	TRF SIG CBL (TY A)(12 AWG)(7 CONDR)	LF	2034	
0684 6080	TRF SIG CBL (TY C)(14 AWG)(2 CONDR)	LF	14364	
0686 6019	INS TRF SIG PL AM (S)STR(TY D)	EA	2	
0686 6020	INS TRF SIG PL AM (S)STR(TY D)LUM	EA	5	
0687 6001	PED POLE ASSEMBLY	EA	21	
0688 6001	PED DETECT PUSH BUTTON (APS)	EA	18	
0688 6003	PED DETECTOR CONTROLLER UNIT	EA	3	
0688 6004	VEH LP DETECT (SAWCUT)	LF	7910	
5088 6001	BIRD EXCLUSION METHOD	SF	29027	
6001 6002	PORTABLE CHANGEABLE MESSAGE SIGN	EA	2	

CO #1 - Detour Traffic 23rd Street to 10th Street

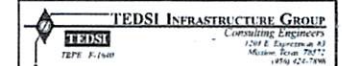
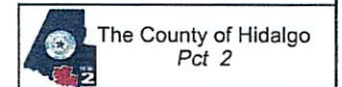

DICKER ROAD ESTIMATE QUANTITY

SHEET 2 OF 2					
100	001	001	001	001	001
06	0021	02	312	DICKER ROAD	
100	001	001	001	001	001
TEXAS	PHR	HIDALGO	No. 2	HIDALGO	1180

DATE: 04/25/2018
FILE: SILESS

CO #1 - Detour Traffic
23rd Street to 10th Street



PHASE I - TEMPORARY TRAFFIC SIGNAL SUMMARY												
ITEM	CODE	DESCRIPTION	UNIT	DICKER RD AT SP 115 (23RD ST)		DICKER RD AT SH 336 (10TH ST)		DICKER RD AT McCOLL RD		DICKER RD AT FM 2061 (JACKSON RD)		TOTAL
				ESTIMATE	FINAL	ESTIMATE	FINAL	ESTIMATE	FINAL	ESTIMATE	FINAL	
* 681	6001	TEMP TRAF SIGNALS	EA	1		1		1		1		4
		BACK PLATE (12 IN) (3 SEC)	EA	2		2		2		2		6
		BACK PLATE (12 IN) (4 SEC)	EA			2		2		2		6
		CONDT (RM) (2")	LF	35		35				35		105
		ELEC CONDR (NO. 6) BARE	LF	6		6				6		18
		ELEC CONDR (NO. 6) INSULATED	LF	12		12				12		36
		ELEC SERV TY T 120/240 009 (NS)IGS(L)TP(O)	EA			1				1		3
		GROUND ROD, 5/8" X 8'	EA	2		4				4		10
		ROADWAY LIGHT ON TRAFFIC SIGNAL POLE (250 WATT)	EA	1						0		1
		PHOTOELECTRIC CELL	EA	1						0		1
		POLE MOUNTED SIGNAL CONTROLLER	EA	1		1				1		3
		SIGN, "LEFT ON GREEN ARROW ONLY", R10-5, 24" X 30"	EA	1		2		2		2		7
		SIGN, "ONE WAY", R6-11, 36" X 12"	EA	1								1
		TRAF SIG CBL (TY A) (12 AWG) (05 CONDR)	LF	1255		375				364		1994
		TRAF SIG CBL (TY A) (12 AWG) (07 CONDR)	LF	172		874		402		709		2067
		VEH SIG SEC (12 IN) LED (RED ARW)	EA	1						0		1
		VEH SIG SEC (12 IN) LED (YEL ARW)	EA	1		2				2		5
		VEH SIG SEC (12 IN) LED (GRN ARW)	EA	1		4		2		4		11
		VEH SIG SEC (12 IN) LED (GRN)	EA	4		10		4		10		28
		VEH SIG SEC (12 IN) LED (RED)	EA	4		10		4		10		28
		VEH SIG SEC (12 IN) LED (YEL)	EA	4		10		4		10		28
		TIMBER POLES W/ ANCHORS	EA	2		4				4		10
		ZINC-COAT STL WIRE STRAND (3/8 IN)	LF	502		1446				1216		3164
		TRAY CABLE (4 CONDR)(12 AWG)	LF	658								658

- ⊙ ITEMS WILL NOT BE PAID FOR DIRECTLY BUT SHALL BE CONSIDERED SUBSIDIARY TO ITEM 681
- * ITEM TO INCLUDE PAYMENT FOR ALL PHASES OF CONSTRUCTION.

DATE: 4/26/2018 8:44:03 PM
FILE: D:\car\Signal\Temp\099

The County of Hidalgo
Pct 2

Texas Department of Transportation

TEDSI INFRASTRUCTURE GROUP
Consulting Engineers
1201 E. Expressway 41
Arlington, Texas 76010
1956 42-0-7603

**DICKER ROAD
SUMMARY
TEMPORARY TRAFFIC SIGNALS
PHASE I**

SHEET 1 OF 3

PROJECT NO.	06	LINE	0521	ITEM	02	JOB	312	REPORT	DICKER ROAD
TITLE	SEC	ISSUES	REV	DATE					
TEXAS	PHR	HIDALGO	PG 2	HIDALGO					17a

CO #1 - Detour Traffic
23rd Street to 10th Street

PHASE II - TEMPORARY TRAFFIC SIGNAL SUMMARY												
ITEM	CODE	DESCRIPTION	UNIT	DICKER RD AT SP 115 (23RD ST)		DICKER RD AT SH 336 (10TH ST)		DICKER RD AT McCOLL RD		DICKER RD AT FM 2061 (JACKSON RD)		TOTAL
				ESTIMATE	FINAL	ESTIMATE	FINAL	ESTIMATE	FINAL	ESTIMATE	FINAL	
681	6001	TEMP TRAF SIGNALS	EA									0
		RELOCATE/ADJUST SIGNAL HEADS	EA	4		4		4		4		16
		RELOCATE/ADJUST SIGNS	EA	1		2		2		2		7

Ⓢ

Ⓢ ITEMS WILL NOT BE PAID FOR DIRECTLY BUT SHALL BE CONSIDERED SUBSIDIARY TO ITEM 681



DATE: 4/26/2018 6:44:23 PM
FILE: Dicker Signals Temp.dgn



The County of Hidalgo
Pct 2



Texas Department of Transportation



TEDSI INFRASTRUCTURE GROUP
Consulting Engineers
1201 E. Expressway 18
Houston, Texas 77052
713-426-7800

DICKER ROAD
SUMMARY
TEMPORARY TRAFFIC SIGNALS
PHASE 2

SHEET 2 OF 3

PROJECT NO.	DATE	REV	BY	DESCRIPTION
05	0521	02	312	DICKER ROAD
SHEET NO.	DATE	BY	APP'D	SCALE
TEXAS	PHR	NIDALGO	No. 2	HIDALGO

CO #1 - Detour Traffic
23rd Street to 10th Street



PHASE III - TEMPORARY TRAFFIC SIGNAL SUMMARY

ITEM	CODE	DESCRIPTION	UNIT	DICKER RD AT SP 115 (23RD ST)		DICKER RD AT SH 336 (19TH ST)		DICKER RD AT McCOLL RD		DICKER RD AT FM 2061 (JACKSON RD)		TOTAL
				ESTIMATE	FINAL	ESTIMATE	FINAL	ESTIMATE	FINAL	ESTIMATE	FINAL	
681	6001	TEMP TRAF SIGNALS	EA									0
		RELOCATE/ADJUST SIGNAL HEADS	EA	4		4		4		4		16
		RELOCATE/ADJUST SIGNS	EA	1		2		2		2		7

Ⓢ ITEMS WILL NOT BE PAID FOR DIRECTLY BUT SHALL BE CONSIDERED SUBSIDIARY TO ITEM 681



The County of Hidalgo
Pct 2



Texas Department of Transportation



TEDSI INFRASTRUCTURE GROUP
Consulting Engineers
1201 E. Expressway 33
Mission, Texas 78149
956.626.7893

**DICKER ROAD
SUMMARY
TEMPORARY TRAFFIC SIGNALS
PHASE III**

SHEET 3 OF 3

PROJECT NO.	ALERT	TEXT	JOB	ISSUE NO.
06 2921	02	312		DICKER ROAD
STATE	COUNTY	PCT	SPR	DRAWING NO.
TEXAS	PHR	HIDALGO	No 2	HIDALGO 198

DATE: 4/26/2018 8:44:03 PM
FILE: Dickers Signal - Temp 198

SUMMARY OF TRAFFIC CONTROL PLAN

SHEET	490 6008	0502 6001	0508 6001	0512 6001	0512 6009	0512 6010	0512 6025	0512 6049	0512 6057	0512 6058	0545 6001	0545 6003	0545 6005	0662 6004	0662 6017	0662 6018	0662 6029	0662 6034	
	CUT & REST ASPH PAV	BARRIC. SIGNS AND TRAFFIC HANDLING	CONSTR DETOURS	PORT CTB (FUR & INST) (SINGL SLP) (TY 1)	PORT CTB (FUR & INST) (LOW PROF) (TY 1)	PORT CTB (FUR & INST) (LOW PROF) (TY 2)	PORT CTB (MOVE) (SINGL SLP) (TY 1)	PORT CTB (REMOVE) (SINGL SLP) (TY 1)	PORT CTB (REMOVE) (LOW PROF) (TY 1)	PORT CTB (REMOVE) (LOW PROF) (TY 2)	CRASH CUSH (INSTALL)	CRASH CUSH (ATTN (MOV&RESET))	CRASH CUSH (ATTN (REMOVE))	WK ZN PAV MRK (NON-REMOV (W) 4" (SLD))	WK ZN PAV MRK (NON-REMOV (W) (ARROW))	WK ZN PAV MRK (NON-REMOV (W) (DDBL ARROW))	WK ZN PAV MRK (NON-REMOV (W) (WORD))	WK ZN PAV MRK (NON-REMOV (Y) 4" (SLD))	
	SY	MO	SY	LF	LF	LF	LF	LF	LF	LF	EA	EA	EA	LF	EA	EA	EA	EA	LF
PHASE I																			
-1 OF 6	10		2090											4500					4500
-2 OF 6	75		2485											4000					4000
3 OF 6	21		2477	100							1			4640					4640
4 OF 6	35		3430	1610							1			4500					4500
5 OF 6	35		2286	100							1			4416					4520
6 OF 6	35		880	320							1			2547	1		1		2682
TOTAL PH I	245		13864	2130	0	0	0	0	0	0	4	0	0	25321	1	0	1		25516
PHASE II																			
-1 OF 6				1600	60									4000					4000
-2 OF 6	141			3070	30									4500					4000
3 OF 6	92			90	1620	120	100				1	1		4674					4674
4 OF 6				960	780	40	1610				1	1		4500					4500
5 OF 6	125				720	80	100				1	1		4636					4636
6 OF 6							320							2600	1		1		2600
TOTAL PH II	358		0	1050	6880	320	2130	0	0	0	2	4	0	25548	1	0	1		25548
PHASE III																			
-1 OF 6									1090	60				2000					1638
-2 OF 6									2070	20				2900					4500
3 OF 6								190	1620	120				2					4684
4 OF 6								2670	780	40				2					4476
5 OF 6								100	720	80				1					4476
6 OF 6								320						1			1		2588
TOTAL PH III	0	0	0	0	0	0	0	3180	6890	320	0	0	0	12772	1	0	1		25390
TOTAL	603	29	13864	3180	6880	320	2130	3180	6890	320	6	4	0	63641	3	0	3		76426

SUMMARY OF TRAFFIC CONTROL PLAN (CONT)

SHEET	0662 6060	0662 6063	0662 6071	0662 6075	0662 6095	0672 6009	0677 6001	0677 6003	0677 6005	0677 6007	0677 6008	0677 6012	0601 6002
	WK ZN PAV MRK REMOV(W) 4"(BRK)	WK ZN PAV MRK REMOV(W) 4"(SLD)	WK ZN PAV MRK REMOV(W) 8"(SLD)	WK ZN PAV MRK REMOV (W) 24" (SLD)	WK ZN PAV MRK REMOV (Y) 4" (SLD)	REFL PAV MRKR TY II A-A	ELIM EXT MRK & MRKS (4")	ELIM EXT MRK & MRKS (8")	ELIM EXT MRK & MRKS (12")	ELIM EXT MRK&MRKS 24"	ELIM EXT PAV MRK & MRKS (ARROW)	ELIM EXT PAV MRK & MRKS (WORD)	PORT. CHANG. MESSAGE SIGN
	LF	LF	LF	LF	LF	EA	LF	LF	LF	LF	EA	EA	EA
PHASE I													
-1 OF 6				12			112	5180	140	30	20	2	
-2 OF 6				12			114	6000					
3 OF 6				12			116	5380	140		2	1	
4 OF 6		300			300		120	5400					
5 OF 6				24			112	4970	503	216	52	5	3
6 OF 6		1432	100	42	1368		106	4963	526	256	64	8	5
TOTAL PH I	0	1732	100	102	1668		680	31023	1309	568	142	17	11
PHASE II													
-1 OF 6				10			110	2000			12		
-2 OF 6				10			114	2000					
3 OF 6				10			118	2342					
4 OF 6		300			300		120	2280					
5 OF 6				20			116	2318					
6 OF 6	150	611	100	32	968		110	2436	100		24	1	1
TOTAL PH II	150	911	100	82	1268		690	13915	100	0	36	1	2
PHASE III													
-1 OF 6				12			110						
-2 OF 6				12			114						
3 OF 6				12			118						
4 OF 6		150			300		120	600					
5 OF 6				25			116						
6 OF 6	100	707	160	37	1418		100	1720	190		32	1	1
TOTAL PH III		867		120	1718		680	2320	190		32	1	1
TOTAL	150	3508	200	304	4654		2050	47267	1509	568	210	19	2

CO #1 - Detour Traffic
23rd Street to 10th Street



The County of Hidalgo
Pct 2

Texas Department of Transportation

TEDSI INFRASTRUCTURE GROUP
Consulting Engineers
1201 E. Expressway #1
Mission, Texas 78147
1875 426-7400

DICKER ROAD
TCP SUMMARY

SHEET 1 OF 1				
DATE	DIST	SEC	JOB	PROJECT
06	0521	02	312	DICKER ROAD
STATE	COUNTY	SECTION	LOT	ACRES
TEXAS	PHR	HIDALGO	No 2	HIDALGO

DATE: 11/16/2019 1:58:36 PM
FILE: C:\Users\jmm\Documents\TCP\...

THE CONTRACTOR MAY SUBMIT A SIGNED AND SEALED ALTERNATE CONSTRUCTION SEQUENCE AND TRAFFIC CONTROL PLAN TO ENGINEER FOR CONSIDERATION OTHERWISE, MUST FOLLOW TCP CONSTRUCTION PHASES AS SHOWN ON TCP PLANS. IN ADDITION TO THE GENERAL NOTES REQUIREMENTS, THE FOLLOWING PROVISIONS GOVERN THIS CONTRACT.

SEQUENCE OF CONSTRUCTION.

CONSTRUCT THE DICKER ROAD IMPROVEMENTS IN FOUR (4) MAIN PHASES AS NOTED IN THIS NARRATIVE.

INSTALL PROJECT LIMIT AND ADVANCE WARNING SIGNS. INSTALL CROSSROAD BARRICADES/SIGNS, AS SHOWN ON THE TRAFFIC CONTROL PLANS (TCP) ALL IN ACCORDANCE WITH THE (TMUTCD) AND/OR AS DIRECTED BY THE ENGINEER. THESE SIGNS SHALL BE ERECTED AND PLACED PRIOR TO COMMENCING ANY PROPOSED ROADWAY CONSTRUCTION AND SHALL REMAIN IN PLACE FOR THE DURATION OF THE PROJECT AND UNTIL FINAL ACCEPTANCE OF THE PROJECT BY OWNER. CLOSURE HOURS ARE DEFINED AS FOLLOWS:

- a. OFF-PEAK - 9 AM TO 3 PM MONDAY THRU FRIDAY
- b. PEAK - 5 AM TO 9 AM AND 3 PM TO 10 PM MONDAY THRU FRIDAY
- c. NIGHT TIME HOURS - 10 PM TO 5 AM MONDAY THRU FRIDAY
- d. WEEKEND HOURS - 10 PM FRIDAY TO 5 AM MONDAY.

CHANGEABLE MESSAGE BOARDS TO BE PLACED TO NOTIFY TRAVELING PUBLIC ON PLANNED CLOSURE DATE OR MOVEMENTS RESTRICTIONS 5 WORKING DAYS IN ADVANCE OF APPROVED DATE.

PHASE I - STEP 1 CONSTRUCT IRRIGATION CROSSINGS:

1. PRIOR TO THE BEGINNING OF THIS STEP, ADVANCE WARING SIGNS MUST BE INSTALLED.
2. CONSTRUCT IRRIGATION CROSSINGS UTILIZING TXDOT TCP LATEST STANDARDS (TCP 2-1 THRU TCP 2-7). ALL IRRIGATION CROSSINGS TO BE COMPLETED ON THIS PHASE.
3. CONSTRUCTION OF IRRIGATION CROSSINGS SHALL BE DONE DURING OFF-PEAK HOURS, AT NIGHT TIME HOURS OR DURING WEEKEND HOURS AFTER PREVIOUS COORDINATION WITH HCWID No 3 AND HCID No 2 REPRESENTATIVES.
4. CONSTRUCT HCWID No 3 LATERAL DRAIN EQUALIZER @ STA 26+92.19 AS SHOWN IN CULVERT LAYOUT No 1.
5. CONSTRUCT HCWID No 3 IRRIGATION CROSSING EQUALIZERS @ STA 43+64 AND STA 50+50 AS SHOWN IN IRRIGATION LAYOUTS 1 AND 2.
6. CONSTRUCT HCID No 2 IRRIGATION CROSSING @ STA 102+05, STA 115+21 AND STA 132+41 AS SHOWN IN IRRIGATION LAYOUTS 3,4 AND 5.

PHASE I - CONSTRUCTING DETOURS AND NORTH SIDE BRIDGE WIDENING:

1. PRIOR TO THE BEGINNING OF THIS PHASE, HAVE TRAFFIC CONTROL DEVICES, STRIPING AND SW3P ITEMS AS SHOWN ON THE PLANS OR AS DIRECTED BY THE ENGINEER, IN PLACE. CONSTRUCTION WORK WILL NOT BEGIN UNTIL THE ENGINEER GIVES APPROVAL.
2. PLACE TRAFFIC ON SOUTH SIDE AS SHOWN IN TCP PLANS.
3. EXTEND EXISTING 24" RCP CULVERT CROSSING WITH S.E.T. AT STA 114+30 FOR ROADSIDE DITCHES DRAIN ON SPUR 115 (23RD ST), REGRADE EXISTING DITCHES IF NECESSARY TO MAINTAIN DRAINAGE PATTERNS AND REMOVE ANY DEBRIS.
4. CONSTRUCT SYSTEM A OUTFALL 30" RCP FROM STA 23+80 TO CONNECTION AT OUTFALL A AS SHOWN IN PLANS, THIS SYSTEM WILL BE USED TO DRAIN DURING PHASE I CONSTRUCTION. BUILD LATERAL UP TO THE PROPOSED CL AND PLUG IT.
5. CONSTRUCT SYSTEM B OUTFALL FROM STA 79+32 TO STA 86+80 AS NECESSARY TO MAINTAIN POSITIVE DRAINAGE THROUGHOUT ALL PHASES OF CONSTRUCTION. REGRADE DITCHES TO MAINTAIN EXISTING DRAINAGE PATTERNS AND REMOVE, RELAY OR EXTEND EXISTING DRAINAGE LINES AND STRUCTURES AS NEEDED, THIS WORK WILL BE CONSIDER INCIDENTAL TO OTHERS ITEMS. BUILD LATERAL UP TO THE PROPOSED CL AND PLUG IT.
6. CONSTRUCT NORTH SIDE EXTENSION OF EXISTING CULVERT CROSSINGS AT STA 86+89.34 AND STA 89+93.93, INSTALL SW3P SEDIMENT CONTROL DEVICES AS SHOWN ON PLANS.
7. CONSTRUCT SYSTEM B OUTFALL 6"x6" CONCRETE BOX FROM STA 79+30 TO CONNECTION AT OUTFALL B AS SHOWN IN PLANS, THIS SYSTEM WILL BE USED TO DRAIN DURING PHASE I CONSTRUCTION. BUILT LATERAL UP TO THE PROPOSED CL AND PLUG IT.
8. CONSTRUCT NORTH SIDE OF PROPOSED EMBANKMENT TO ITS FINAL ELEVATION FROM STA 81+00 TO STA 95+00 AS SHOWN ON TYPICAL SECTION DETAIL "A" WITH 1.5" ACP TY D (FOR EROSION PROTECTION) AND 6" LIME TREATED FLEXIBLE BASE TY E GRADE 4, PROTECT SLOPE WITH FINAL 4" CONCRETE RIPRAP.
9. CONSTRUCT SYSTEM C OUTFALL RCP FROM STA 125+30 TO CONNECTION AT OUTFALL C AS SHOWN IN PLANS, THIS SYSTEM WILL BE USED TO DRAIN DURING PHASE I CONSTRUCTION. BUILT LATERAL UP TO THE PROPOSED CL AND PLUG IT.
10. CONSTRUCT DETOURS ON NORTH SIDE OF DICKER ROAD AS SHOWN ON PLANS, (SEE DETOUR PAVEMENT STRUCTURE).
11. CONSTRUCT NORTH SIDE WIDENING OF PROPOSED BRIDGES AS SHOWN ON PLANS. NORTH SIDE BRIDGE JOINT REPLACEMENT (SEJ) TO BE DONE IN THIS PHASE. KEEP (1) TWO-WAY SURFACE ROADWAY LANES (MIN 11 FT LANES) FOR THRU TRAFFIC ALL THE TIME UNLESS OTHERWISE APPROVED BY ENGINEER.
12. CONSTRUCT NORTH SIDE WIDENING OF DICKER ROAD FROM STA 145+75.66 TO STA 149+33.69 (END INCIDENTAL WORK) INCLUDING PAVEMENT (EXCEPT 1.5" FINAL ACP LIFT SURFACE COURSE), CONCRETE CURB AND GUTTER, SIDEWALK AND DRIVEWAYS.

CO #1 - Detour Traffic
23rd Street to 10th Street

CO #1 - Phase I Step I (Construct Dicker Rd between 23rd to 10th Street)

Detour traffic around Dicker Road starting at Stations 11+11 (23rd Street) and ending at 58+00 (10th Street) to construct this section without phasing. Use signing and signals to detour Dicker Road traffic north to Spur 115 or south to Las Milpas Road. This section has no residents, and only two business at 23rd Street, with access. They will be allowed access from Dicker Road during construction, if required.



TE 4/29/2018

The County of Hidalgo
Pct 2

Texas Department of Transportation

TEDSI INFRASTRUCTURE GROUP
Consulting Engineers
1291 E. Expressway #3
Mission, Texas 78149
(956) 421-7808

DICKER ROAD
SEQUENCE OF CONSTRUCTION

SHEET 1 OF 2

LINE NO.	DATE	BY	CHKD	REVISION
06	08/21	02	312	DICKER ROAD
TXAS	PHR	HIDALGO	No 2	HIDALGO 278

DATE: 4/25/2018 1:32:27 PM
FILE: D:\s\101\CP\001.dgn

LEGEND	
	CONSTRUCTION AREA
	DETOUR
	WORK ZONE PVTM MARK (NON-REM) 4" WHITE SOLID
	WORK ZONE PVTM MARK (NON-REM) 4" WHITE SOLID
	WORK ZONE PVTM MARK (REM) 4" WHITE SOLID
	WORK ZONE PVTM MARK (REM) 4" WHITE SOLID
	WORK ZONE PVTM MARK (REM) 4" YELLOW SOLID
	WORK ZONE PVTM MARK (REM) 4" YELLOW SOLID
	WORK ZONE PVTM MARK (NON-REM) 24" WHITE SOLID
	WORK ZONE PVTM MARK (NON-REM) 8" WHITE SOLID
	DROP OFFS GREATER THAN OR EQUAL TO 2" MUST BE PROTECTED BY A 3:1 OR FLATTER SLOPE WHEN NO ROAD WORKS IS BEING DONE IN THE IMMEDIATE AREA, (EDGE COND I)
	DROP OFFS GREATER THAN 24" MUST BE PROTECTED WITH LOW PROFILE CONC BARRIER (TY 1 & 2) W/ BARRIERS REFLECTOR
	MATCH EXISTING/ADJACENT CROSS SLOPE AND ELEVATION
	EXISTING TRAFFIC DIRECTION
	PROPOSED TRAFFIC DIRECTION

- NOTES:
1. STORM SEWER LATERALS SHALL BE INSTALLED AS PER PHASE II LAYOUTS AND PLUGGED AS NECESSARY FOR FUTURE CONNECTION IN PHASE III.
 2. PLUG IS NOT A BID ITEM SHALL BE SUBSIDIARY TO ITEMS 464.
 3. STORM LATERALS SHALL BE INSTALLED AS PER PHASE III LAYOUTS. UNPLUG AND COMPLETE LATERALS AS INDICATED.
 4. REMOVAL OF PLUG IS NOT A BID ITEM SHALL BE SUBSIDIARY TO ITEMS 464.

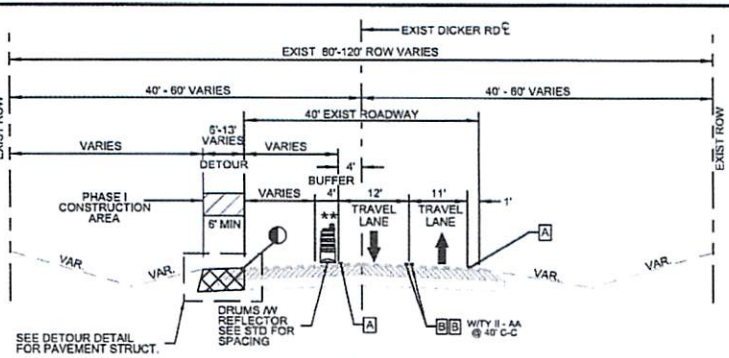

DICKER ROAD
CONSTRUCTING DETOURS
PHASE I TYPICAL SECTION

STATIONS LIMITS	OFFSET FROM PGL TO EDGE OF DETOUR
FROM STA 11+11 TO STA 37+17	18 FT (MIN 16')
FROM STA 58+62 TO STA 81+00	18 FT (MIN 16')
FROM STA 95+00 TO STA 114+51	18 FT
FROM STA 115+65 TO STA 133+81	18 FT
FROM STA 140+00 TO STA 144+92	26 FT TO 14 FT

** NOTE: IN PHASE I FROM STA 81+00 TO STA 88+10 AND FROM STA 129+00 TO STA 133+20 PORT C.T.B.(SGL SLP)(TY 1) W/REFLECTORS WILL BE USED IN LIEU OF DRUMS W/ REFLECTORS (SEE TCP PHASE I LAYOUTS FOR MORE DETAILS)

**CO #1 - Detour Traffic
23rd Street to 10th Street**

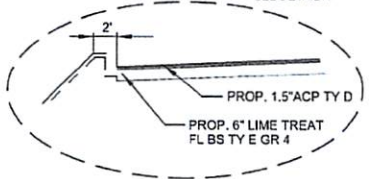

DETAIL A
FROM STA 81+00 TO STA 95+00
N.T.S.
NOTE: PHASE I CONSTRUCT SYSTEM B OUTFALL 6'X5' CB FROM STA 79+32 TO STA 88+60 AS PER PLAN SHEETS IN ORDER TO MAINTAIN POSITIVE DRAINAGE.

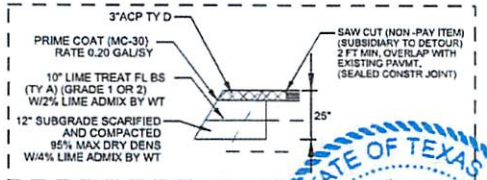
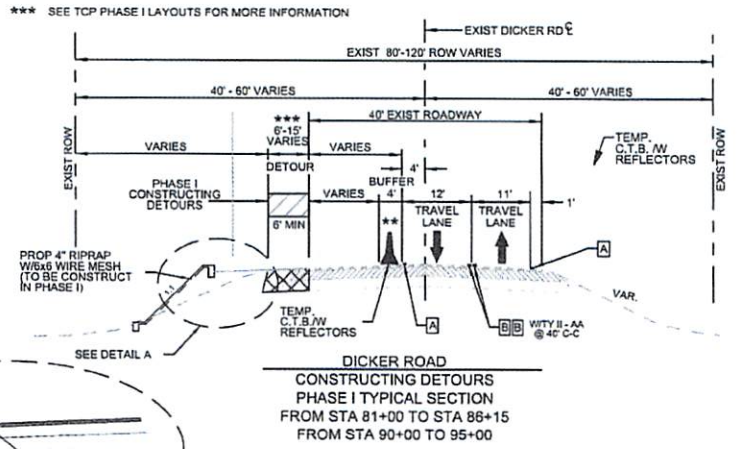

DETOUR DETAIL PAVEM STRUCTURE
N.T.S.
TO BE PAID UNDER CONSTRUCT. DETOUR PAY (ITEM 308)
ADDITIONAL FILL SHALL BE SUBSIDIARY.

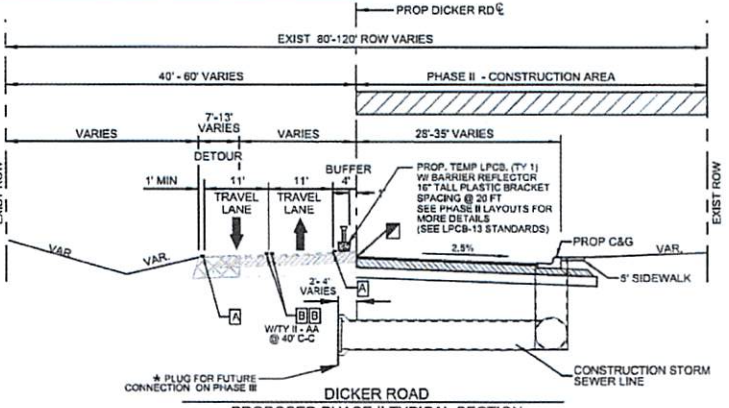

PROPOSED PHASE II TYPICAL SECTION
FROM Sta 58+62 TO STA 144+92
(PAVEMENT STRUCTURE TO BE BUILT UP TO 1.5" HMAC TY 'D' FIRST LIFT)
(FINAL 1.5" HMAC TY 'D' LIFT SURFACE COURSE WILL BE PLACE IN PHASE IV
OVER ENTIRE LENGTH AND WIDTH OF ROADWAY)

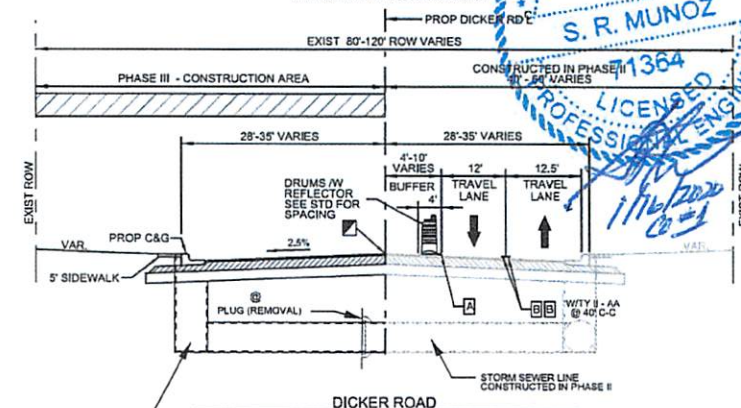

DICKER ROAD
PROPOSED PHASE III TYPICAL SECTION
FROM Sta 58+62 TO STA 144+92
(PAVEMENT STRUCTURE TO BE BUILT UP TO 1.5" HMAC TY 'D' FIRST LIFT)
(FINAL 1.5" HMAC TY 'D' LIFT SURFACE COURSE WILL BE PLACE IN PHASE IV
OVER ENTIRE LENGTH AND WIDTH OF ROADWAY)



THE COUNTY OF HIDALGO
Pct 2

Texas Department of Transportation

TEDSI INFRASTRUCTURE GROUP
Consulting Engineers
1201 E. Espinosa #3
McAllen, Texas 78501
Tel: 361.7140

DICKER ROAD
TRAFFIC CONTROL PLAN
PROPOSED TYPICAL SECTION
PHASE I,
PHASE II AND PHASE III

SCALE: 1/4" = 1'-0"

DATE: 4/25/2018	TIME: 1:32:28 PM	FILE: D:\proj\100-110-111-111-111.dwg
-----------------	------------------	---------------------------------------

SHEET 1 OF 1

NO	DATE	BY	APP	REVISION
06	05/21	02	312	DICKER ROAD
07	08/14	02/01/17	107	07' 00" 1/4" = 1'-0"

TEXAS PHR HIDALGO No 2 HIDALGO 299

LEGEND

- |— TY 3 BARRICADE
- DIRECTION OF TRAFFIC FLOW
- ⊕ POST MOUNTED SIGN
- ⊕ POST MOUNTED SIGN
- ⊕ TRAFFIC BARRIERS
- ▨ CONSTRUCTION AREA
- ↔ DETOUR ROUTE

- NOTES:**
- CONTRACTOR TO COORDINATE WITH SCHOOL VALLEY VIEW EARLY COLLEGE PRINCIPAL A WEEK IN ADVANCE PRIOR TO CLOSING Mc COLL RD AND DRIVEWAY.
 - ALL STORM DRAIN NECESSARY WORK TO BE DONE AND COMPLETED ON WEEKEND. AREA NEEDS TO BE OPEN DURING SCHOOL HOURS.

**CO #1 - Detour Traffic
23rd Steet to 10th Street**

The County of Hidalgo
Pct 2

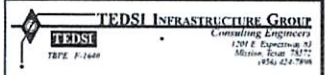

**DICKER ROAD
TRAFFIC CONTROL PLAN
23RD TO 10TH STREET**

SCALE: N.T.S. SHEET 1 OF 1

DATE	BY	REV	DESCRIPTION
06	0921	02	312 DICKER ROAD
TXAS	PHR	HIDALGO	No 2 HIDALGO 32a



NOTE:
1. THE CONTRACTOR SHALL REFER TO "80" AND "TOP" STANDARDS FOR SIGN SPACING AND ADDITIONAL SIGNING.

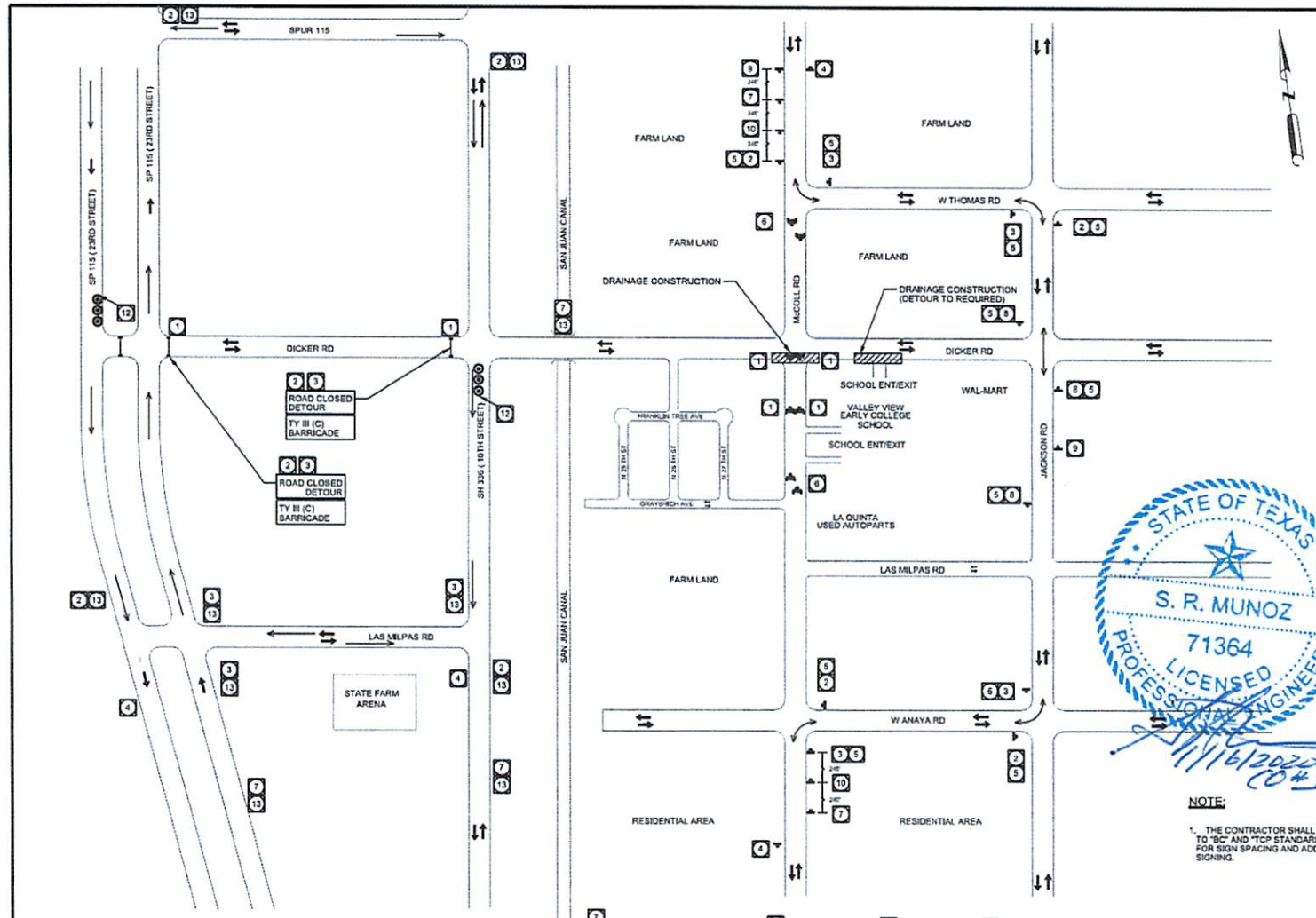



1	2	3	4	5	6	7	8	9	10	11 A	12	13
R11-3 48" X 30"	M4-2L (30" X 24")	M4-2R (30" X 24")	M4-2a (24" X 18")	M4-5N	R11-4 (60" X 30")	CW25-2D (48" X 48")	M4-2S (30" X 24")	CW25-1D 48" X 48"	CW25-3D (48" X 48")	M4-10L 48" X 18"	ER3-2	M4-5N

DATE: 11/16/2022 1:18:28 PM
FILE: SF1655

SHEET SUMMARY																				
STATION LIMITS	ITEM 400 CUT & REST ASPH PAV (SY)	ITEM 500 CONSTRUCTING DETOURS (SY)	ITEM 512 PORT CTB (FUR & INST) (TY 1) (LF)	ITEM 545 CRASH CUSH ATTEN (INSTALL) (EA)	PAVEMENT MARKINGS (ITEM 602)						ITEM 672 REFL PAV MRR TY B A-A (EA)	ELIMINATING EXISTING PAVEMENT MARKINGS								
					NON-REMOVABLE			REMOVABLE				4" PAV/MT MARKINGS (LF)	8" PAV/MT MARKINGS (LF)	12" PAV/MT MARKINGS (LF)	24" PAV/MT MARKINGS (LF)	* WORD (EA)	** ARROW (EA)			
					4" YELLOW SOLID (LF)	4" WHITE SOLID (LF)	24" WHITE SOLID (LF)	WORD (EA)	DEL. ARROW (EA)	8" YELLOW SOLID (LF)	4" WHITE SOLID (LF)	8" WHITE SOLID (SO/HD) (LF)	24" WHITE SOLID (LF)							
10+00 TO 34+00	48	3302			4538	4538							12	112	5130	140	96	20	7	2

LEGEND	
	CONSTRUCTION AREA
	DETOUR
CUT & RESTORING PAVEMENT	
A	WORK ZONE PAV/MT MARK (NON-REM) 4" WHITE SOLID
B	WORK ZONE PAV/MT MARK (NON-REM) 4" YELLOW SOLID
C	WORK ZONE PAV/MT MARK (REM) 4" WHITE SOLID
D	WORK ZONE PAV/MT MARK (REM) WHITE 4" (BROKEN)
E	WORK ZONE PAV/MT MARK (REM) 4" YELLOW (DOT)
F	WORK ZONE PAV/MT MARK (REM) 4" YELLOW (DOT)
G	WORK ZONE PAV/MT MARK (REM) 24" WHITE SOLID
H	WORK ZONE PAV/MT MARK (REM) 8" WHITE SOLID
	CRASH CUSHION ATTENUATOR
	PORTABLE CONC TRAFFIC BARRIER
	LOW PROFILE CONCRETE BARRIER (LPCB-13 TYPE 2)
	DIRECTION OF TRAFFIC FLOW
	PAVEMENT MARKINGS
	TYPE 3 BARRICADE
	CHANNELIZING DEVICE
	CONSTRUCTION SIGN
	TYPE CLASS 1 WARNING REFLECTOR
N-R	(NON-REMOV)
R	(REMOV)

 ROBERTO FERRER CANAL

 5/25/2018

 The County of Hidalgo
 Pct 2

 Texas Department of Transportation



FEDSI INFRASTRUCTURE GROUP
 Consulting Engineers
 1201 E. Expressway #12
 Midland, Texas 79701
 (409) 421-7900

DICKER ROAD
TCP PHASE I
 STA. 10+00 TO STA. 34+00

SHEET 1 OF 6

DATE	BY	CHKD	APPD	NO.	DESCRIPTION
05/20/18	0921	02		313	DICKER ROAD

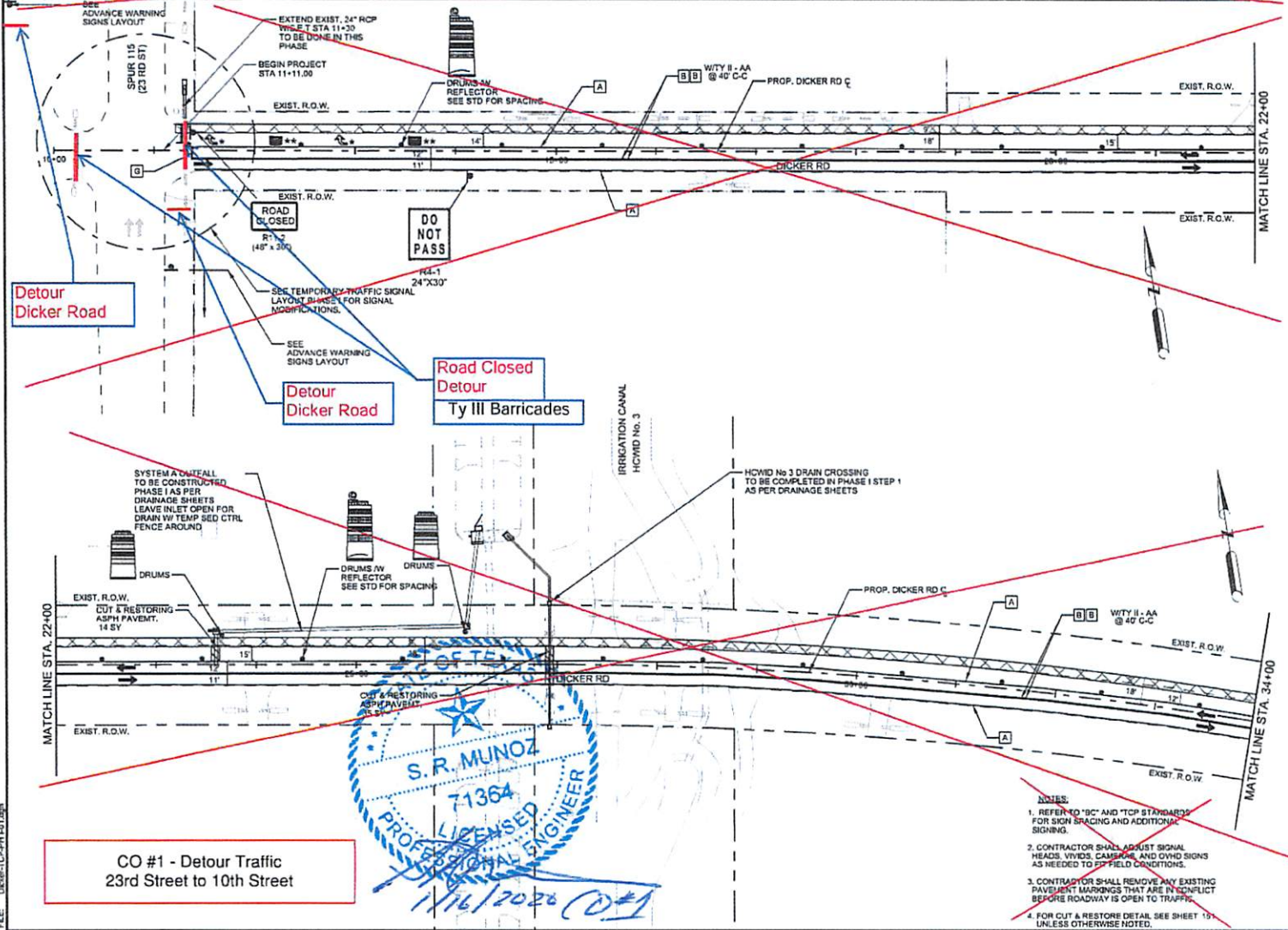
TEXAS PHR HIDALGO No 2 HIDALGO 349



CO #1 - Detour Traffic
 23rd Street to 10th Street

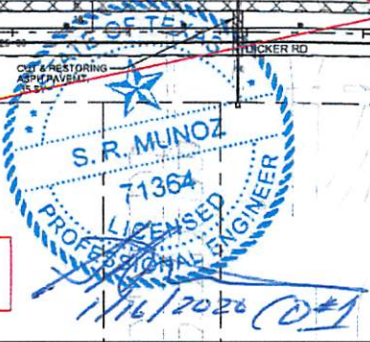

S. R. MUNOZ
 71364
 PROFESSIONAL ENGINEER
 LICENSED
 1/16/2026 (0#)

- NOTES:**
- REFER TO "BC" AND "TCP" STANDARDS FOR SIGN SPACING AND ADDITIONAL SIGNING.
 - CONTRACTOR SHALL ADJUST SIGNAL HEADS, VIEWS, CAMERAS, AND CVHD SIGNS AS NEEDED TO FIT FIELD CONDITIONS.
 - CONTRACTOR SHALL REMOVE ANY EXISTING PAVEMENT MARKINGS THAT ARE IN CONFLICT BEFORE ROADWAY IS OPEN TO TRAFFIC.
 - FOR CUT & RESTORE DETAIL SEE SHEET 101 UNLESS OTHERWISE NOTED.

DATE: 4/25/2018 1:30:32 PM
 FILE: D:\CPH\1511.dwg

SHEET SUMMARY																	
STATION LIMITS	ITEM 409 CUT & REST ASPH PAV (SY)	ITEM 509 CONSTRUCTING DETOURS (SY)	ITEM 512 PORT CTB (FUR & INST) (SINGL SLP) (TY 1) (LF)	ITEM 545 CRASH CUSH ATTEN (INSTALL) (EA)	PAVEMENT MARKINGS (ITEM 662)								ITEM 672 REFLECTIVE PAV MFR TY II A-A (EA)	ITEM 677 ELIMINATING EXISTING PAVEMENT MARKINGS			
					NON-REMOVABLE				REMOVABLE					WORD	ARROW	WORD	ARROW
					4" YELLOW SOLID (LF)	4" WHITE SOLID (LF)	24" WHITE SOLID (LF)	WORD	DIR ARROW	4" YELLOW SOLID (LF)	4" WHITE SOLID (LF)	8" WHITE SOLID (LF)	24" WHITE SOLID (LF)				
34+00 TO 58+00	70	2499			4638	4638							12	114	5200		

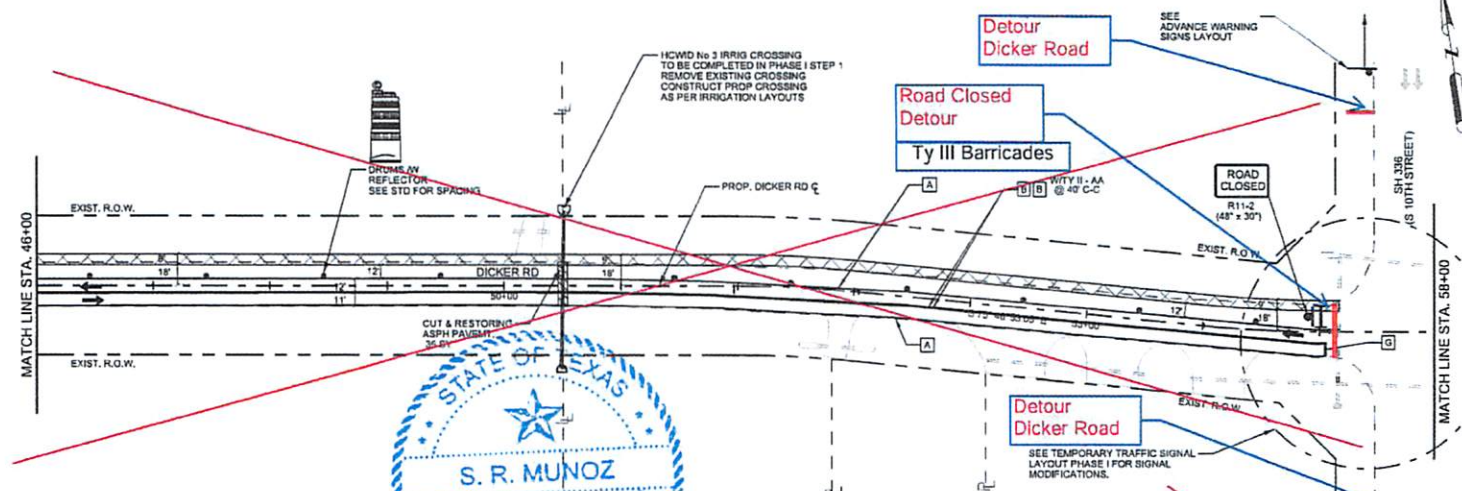
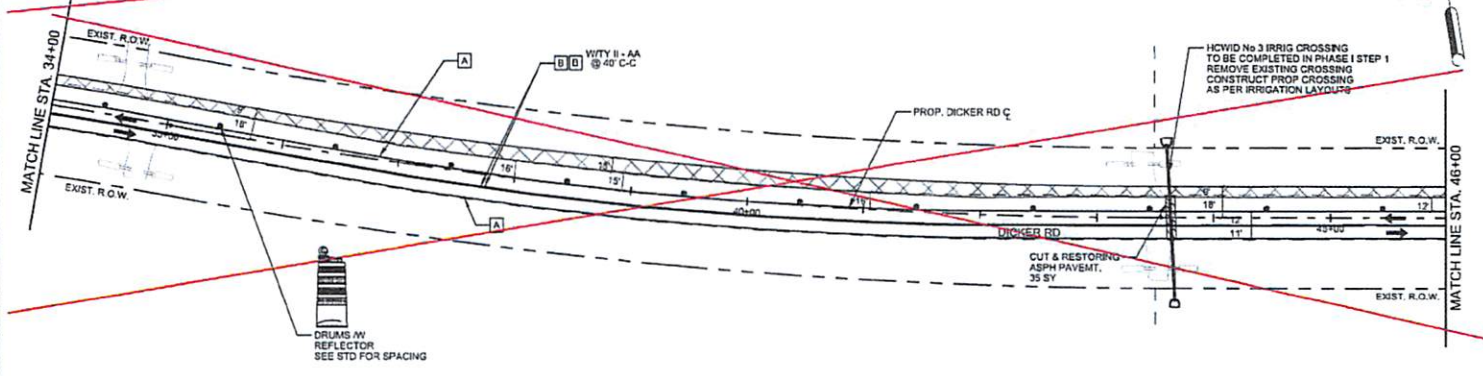
LEGEND	
	CONSTRUCTION AREA
	DETOUR
	CUT & RESTORING PAVEMENT
	WORK ZONE PAVMT MARK (NON-REM)
	4" YELLOW SOLID
	WORK ZONE PAVMT MARK (REM)
	4" WHITE SOLID
	WORK ZONE PAVMT MARK (REM) WHITE 4" (BROKEN)
	WORK ZONE PAVMT MARK (REM) 4" YELLOW SOLID
	WORK ZONE PAVMT MARK (REM) 4" YELLOW (DOT)
	WORK ZONE PAVMT MARK (REM) 24" WHITE SOLID
	WORK ZONE PAVMT MARK (REM) 8" WHITE SOLID
	CRASH CUSHION ATTENUATOR
	PORTABLE CONC TRAFFIC BARRIER
	LOW PROFILE CONCRETE BARRIER (LPCB-13 TYPE 2)
	DIRECTION OF TRAFFIC FLOW
	PAVEMENT MARKINGS
	TYPE 3 BARRICADE
	CHANNELIZING DEVICE
	CONSTRUCTION SIGN
	TYPE A CLASS 1 WARNING REFLECTOR
	N-R (NON-REMOV)
	R (REMOV)



CO #1 - Detour Traffic
23rd Street to 10th Street

- NOTES:**
1. REFER TO 'BC' AND 'TOP STANDARDS' FOR SIGN SPACING AND ADDITIONAL SIGNING.
 2. CONTRACTOR SHALL ADJUST SIGNAL HEADS, VISORS, CAMERAS AND DVD SIGNS AS NEEDED TO FIT FIELD CONDITIONS.
 3. CONTRACTOR SHALL REMOVE ANY EXISTING PAVEMENT MARKINGS THAT ARE IN CONFLICT BEFORE ROADWAY IS OPEN TO TRAFFIC.
- FOR CUT & RESTORE DETAIL SEE SHEET 151 UNLESS OTHERWISE NOTED.



The County of Hidalgo
Pct 2

Texas Department of Transportation

TEDSI INFRASTRUCTURE GROUP
Consulting Engineers
1201 E. Expressway #11
McCombs, Texas 78737
817.414.7400

DICKER ROAD
TCP PHASE I
STA. 34+00 TO STA. 58+00

SCALE: 1"=100'

TICK	DATE	BY	JOB
06	08/21	C2	312 DICKER ROAD
T.A.S.	REV	ISSUED BY	DATE
TEXAS	PHR	HIDALGO	No 2 HIDALGO

SHEET 2 OF 6

DATE: 4/25/2018 1:32:32 PM
FILE: D:\srs\10-1111\107.dwg

SHEET SUMMARY

STATION LIMITS	ITEM 400 CUT & REST ASPH PAV (SY)	ITEM 512 PORT CTB (FLR & INST) (SINGL SLP) (TY 1) (LF)	ITEM 545 CROSS CUSH ATTEN (INSTALL) (EA)	NON REMOVABLE				REMOVABLE				ITEM 672 REFL PAV MKR TY II A-A (EA)	ELIMINATING EXISTING PAVEMENT MARKINGS			
				4"YELLOW SOLID (LF)	4"WHITE SOLID (LF)	24"WHITE SOLID (EA)	WORD (EA)	DBL ARROW (EA)	4"YELLOW SOLID (LF)	24"WHITE SOLID (LF)	4"WHITE SOLID (LF)		24"WHITE SOLID (LF)	WORD (EA)	ARROW (EA)	
10+00 TO 34+00				4538	4538					10	112	2262	12	1		

LEGEND	
	CONSTRUCTION AREA
	DETOUR
	CUT & RESTORING PAVEMENT
	WORK ZONE PAVMT MARK (NON-REM)
	4" WHITE SOLID
	WORK ZONE PAVMT MARK (NON-REM)
	4" YELLOW SOLID
	WORK ZONE PAVMT MARK (REM)
	8" WHITE SOLID
	WORK ZONE PAVMT MARK (REM)
	WHITE 4" (BROKEN)
	WORK ZONE PAVMT MARK (REM)
	4" YELLOW SOLID
	WORK ZONE PAVMT MARK (REM)
	4" YELLOW (DOT)
	WORK ZONE PAVMT MARK (REM)
	24" WHITE SOLID
	WORK ZONE PAVMT MARK (REM)
	8" WHITE SOLID
	CRASH CUSHION ATTENUATOR
	PORTABLE CONC TRAFFIC BARRIER
	LOW PROFILE CONCRETE BARRIER (LPCB-13 TYPE 2)
	DIRECTION OF TRAFFIC FLOW
	PAVEMENT MARKINGS
	TYPE 3 BARRICADE
	CHANNELIZING DEVICE
	CONSTRUCTION SIGN
	TYPE A CLASS 1 WARNING REFLECTOR
	N-R (NON-REMOV)
	R (REMOVE)



ROBERTO PINA-CAPRAL
116247
TE 4/25/2018

The County of Hidalgo
Pct 2



Texas Department of Transportation



TEDSI INFRASTRUCTURE GROUP
Consulting Engineers
1201 F. Express # 41
Mission, Texas 78141
954 424-7908

**DICKER ROAD
TCP PHASE II**
STA. 10+00 TO STA. 34+00

SCALE: 1"=100'

DATE	BY	CHKD	APP	DESCRIPTION
05	0521	02	312	DICKER ROAD
PHR	PHR	PHR	PHR	PHR
TEXAS	PHR	HIDALGO	Sta 2	HIDALGO

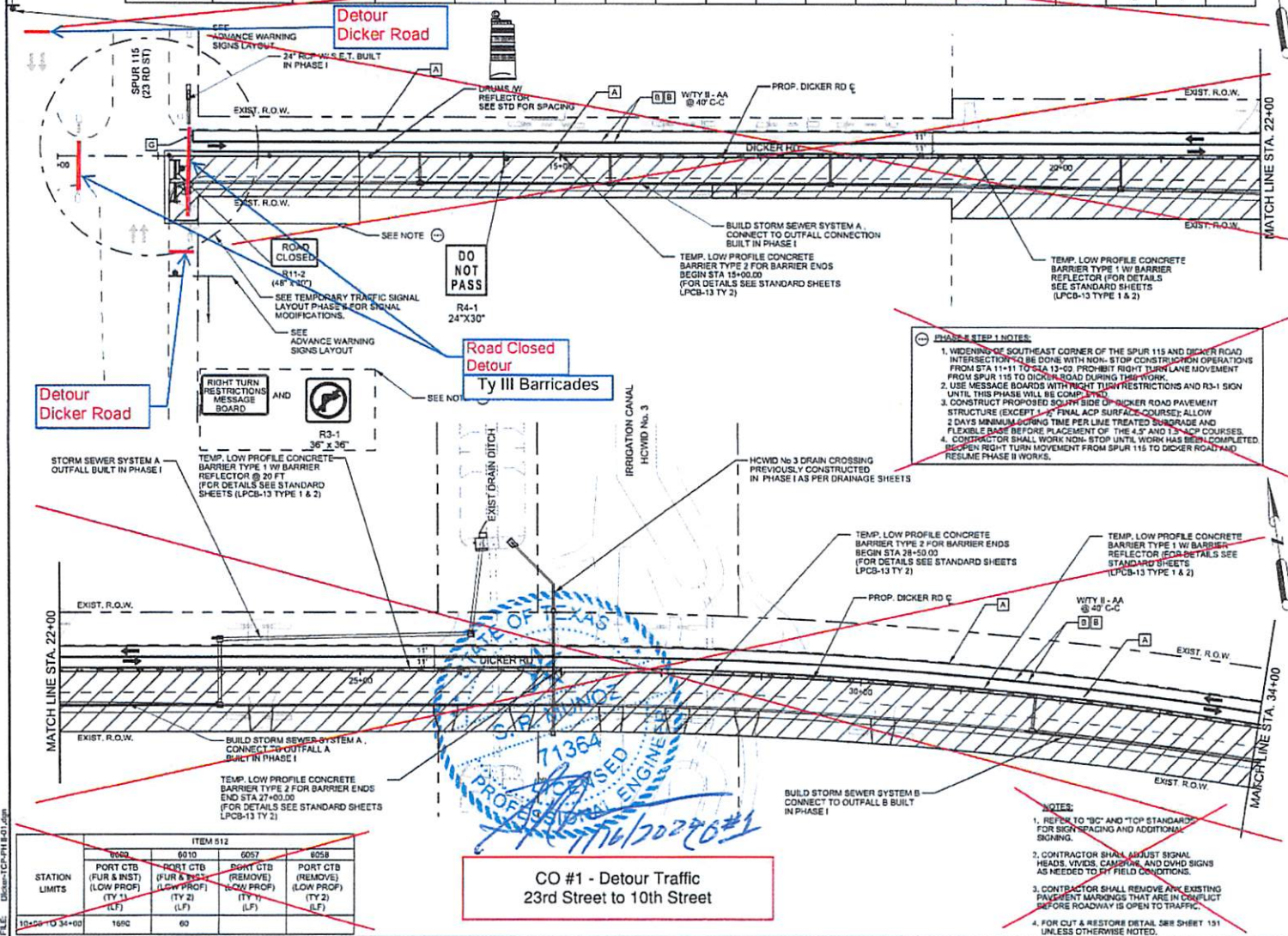
SHEET 1 OF 5

S.P. BULLOCK
71364
PROFESSIONAL ENGINEER
7/16/2022

**CO #1 - Detour Traffic
23rd Street to 10th Street**

DATE: 4/25/2018 1:32:36 PM
FILE: Dicker-TCP-Ph II.dwg

STATION LIMITS	ITEM 512			
	PORT CTB (FLR & INST) (LOW PROF) (TY 1) (LF)	PORT CTB (FLR & INST) (LOW PROF) (TY 2) (LF)	SPMT CTB (REMOVE) (TY 1) (LF)	PORT CTB (REMOVE) (LOW PROF) (TY 2) (LF)
10+00 TO 34+00	1600	60		

SHEET SUMMARY																		
STATION LIMITS	ITEM 400 CUT & REST ASPH PAV (SY)	ITEM 512 PORT CTB (FUR & INST) (TY 1) (LF)	ITEM 545 CRASH CUSH ATTEN (INSTALL) (EA)	PAVEMENT MARKINGS (ITEM 662)								ITEM 672 REFL PAV MKR TY II A-A (EA)	ITEM 677 ELIMINATING EXISTING PAVEMENT MARKINGS					
				NON REMOVABLE				REMOVABLE					4" PAV/MT MARKINGS (LF)	8" PAV/MT MARKINGS (LF)	12" PAV/MT MARKINGS (LF)	24" PAV/MT MARKINGS (LF)	WORD (EA)	ARROW (EA)
10+00 TO 34+00				4" YELLOW SOLID (LF)	4" WHITE SOLID (LF)	24" WHITE SOLID (LF)	WORD (EA)	DBL ARROW (EA)	4" YELLOW SOLID (LF)	4" WHITE SOLID (LF)	8" WHITE SOLID (LF)	24" WHITE SOLID (LF)	12	112				

LEGEND	
	CONSTRUCTION AREA
	DETOUR
	CUT & RESTORING PAVEMENT
	WORK ZONE PAVT MARK (NON-REM) 4" WHITE SOLID
	WORK ZONE PAVT MARK (NON-REM) 4" YELLOW SOLID
	WORK ZONE PAVT MARK (REM) 4" WHITE SOLID
	WORK ZONE PAVT MARK (REM) WHITE 4" (BROKEN)
	WORK ZONE PAVT MARK (REM) 4" YELLOW (DOT)
	WORK ZONE PAVT MARK (REM) 24" WHITE SOLID
	WORK ZONE PAVT MARK (REM) 8" WHITE SOLID
	CRASH CUSHION ATTENUATOR
	PORTABLE CONC TRAFFIC BARRIER
	LOW PROFILE CONCRETE BARRIER (LPCB-13 TYPE 2)
	DIRECTION OF TRAFFIC FLOW
	PAVEMENT MARKINGS
	TYPE 3 BARRICADE
	CHANNELIZING DEVICE
	CONSTRUCTION SIGN
	TYPE A CLASS 1 WARNING REFLECTOR
	(NON-REMOV)
	(REMOVE)

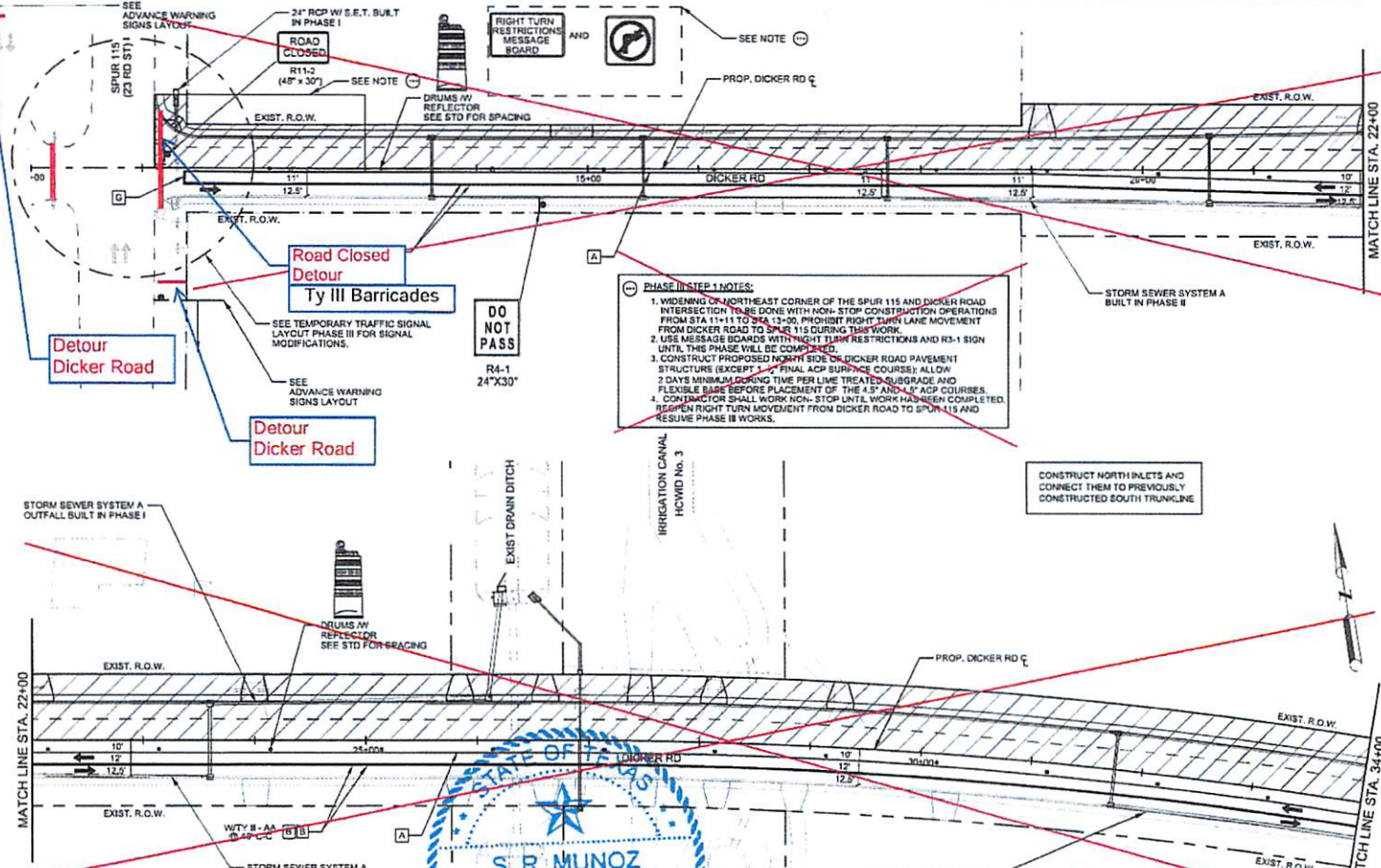

PHASE I/STEP 1 NOTES:

1. WIDENING OF NORTHEAST CORNER OF THE SPUR 115 AND DICKER ROAD INTERSECTION TO BE DONE WITH NON-STOP CONSTRUCTION OPERATIONS FROM STA 11+11 TO STA 12+00, PROHIBIT RIGHT TURN LANE MOVEMENT FROM DICKER ROAD TO SPUR 115 DURING THIS WORK.
2. USE MESSAGE BOARDS WITH RIGHT TURN RESTRICTIONS AND R3-1 SIGN UNTIL THIS PHASE WILL BE COMPLETED.
3. CONSTRUCT PROPOSED NORTH SIDE OF DICKER ROAD PAVEMENT STRUCTURE (EXCEPT 3" FINAL ACP SURFACE COURSE); ALLOW 2 DAYS MINIMUM DRYING TIME PER LIME TREATED SUBGRADE AND FLEXIBLE BASE BEFORE PLACEMENT OF THE 1.5" AND 4.5" ACP COURSES.
4. CONTRACTOR SHALL WORK NON-STOP UNTIL WORK HAS BEEN COMPLETED. RESUME RIGHT TURN MOVEMENT FROM DICKER ROAD TO SPUR 115 AND RESUME PHASE II WORKS.

CONSTRUCT NORTH INLETS AND CONNECT THEM TO PREVIOUSLY CONSTRUCTED SOUTH TRUNKLINE

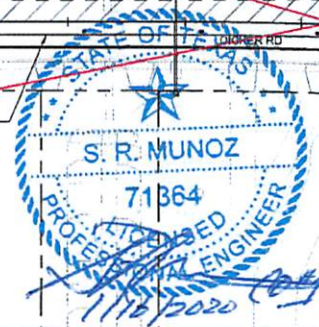

CO #1 - Detour Traffic 23rd Street to 10th Street

- NOTES:**
1. REFER TO "BC" AND "TOP" STANDARDS FOR SIGN SPACING AND ADDITIONAL SIGNING.
 2. CONTRACTOR SHALL ADJUST SIGNAL HEADS, WINGS, CAMERAS, AND DASH SIGNS AS NEEDED TO FIT FIELD CONDITIONS.
 3. CONTRACTOR SHALL REMOVE ANY EXISTING PAVEMENT MARKINGS THAT ARE IN CONFLICT BEFORE ROADWAY IS OPEN TO TRAFFIC.
 4. FOR CUT & RESTORE DETAIL SEE SHEET 151 UNLESS OTHERWISE NOTED.

DATE: 4/25/2018 1:32:11 PM
FILE: E:\Projects\2018\1801\1801.dwg

STATION LIMITS	ITEM 512			
	PORT CTB (FUR & INST) (LOW PROF) (TY 1) (LF)	PORT CTB (FUR & INST) (LOW PROF) (TY 2) (LF)	PORT CTB (REMOVE) (LOW PROF) (TY 1) (LF)	PORT CTB (REMOVE) (LOW PROF) (TY 2) (LF)
10+00 TO 34+00	4009	6010	6057	6058
	1090	60		

E 4/25/2018

The County of Hidalgo

 Pct 2

Texas Department of Transportation

TEDSI INFRASTRUCTURE GROUP

 Consulting Engineers

 1301 F. Expressway #2

 Midland, Texas 79701

 (409) 424-7400

DICKER ROAD

TCP PHASE III

 STA. 10+00 TO STA. 34+00

SCALE: 1" = 100'

 SHEET 1 OF 8

NO. 06	DATE 09/21/02	JOB 312	DICKER ROAD
BY PWR	CHKD PWR	DATE 09/21/02	DATE 09/21/02
TEXAS	PWR	HIDALGO	No. 2 HIDALGO

483

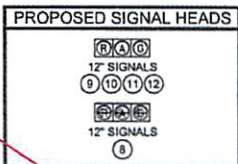
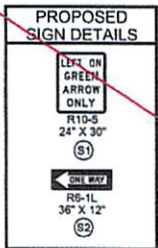

NOTE: BACK PLATES SHALL BE INSTALLED FOR SIGNAL HEADS (11)(12)

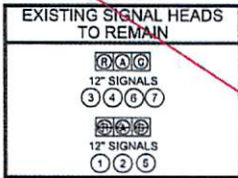

LEGEND

- PROPOSED TIMBER POLE WANCHOR WIRES
- EXISTING STRAIN POLE TO REMAIN
- PROPOSED SPAN WIRE
- EXISTING SPAN WIRE TO REMAIN
- ⊕ PROPOSED HORIZONTAL SIGNAL HEAD
- ⊕ EXISTING HORIZONTAL SIGNAL HEAD TO REMAIN
- ⊕ PROPOSED POLE MOUNTED CONTROLLER CABINET
- PROPOSED POLE MOUNTED ELECTRICAL SERVICE
- PROPOSED LUMINAIRE
- EXISTING LUMINAIRE TO REMAIN
- WIRE RUN DESIGNATION
- DIRECTION OF TRAFFIC FLOW

ELECTRICAL SCHEDULE

ITEM	TOTAL QTY	RUN NUMBER	A	B	C	D	E	F	G	H	J	K	L	M	N	P	Q	R
POWER	12	11C-#8																
LUMINAIRE	658	4/C-#12 TRAY CBL	1	1	1	1	1	1	1	2	2	2	2	2	2	2	2	
ILSN		4/C-#12 TRAY CBL																
GROUND	6	1/C-#8 BARE																
PEDESTRIAN HEADS		2/C-#12																
		4/C-#12																
		4/C-#12																
SIGNAL HEADS	1209	5/C-#12	1	1	1	2	2	3	3	4	4	4	5	6	6			
	1221	7/C-#12																1
		35' 2" RMC																1
CONDUIT		2" PVC																
		2" PVC BORE																
		4" PVC																
		4" PVC BORE																

* INCLUDES QUANTITY ON SIGNAL POLES.

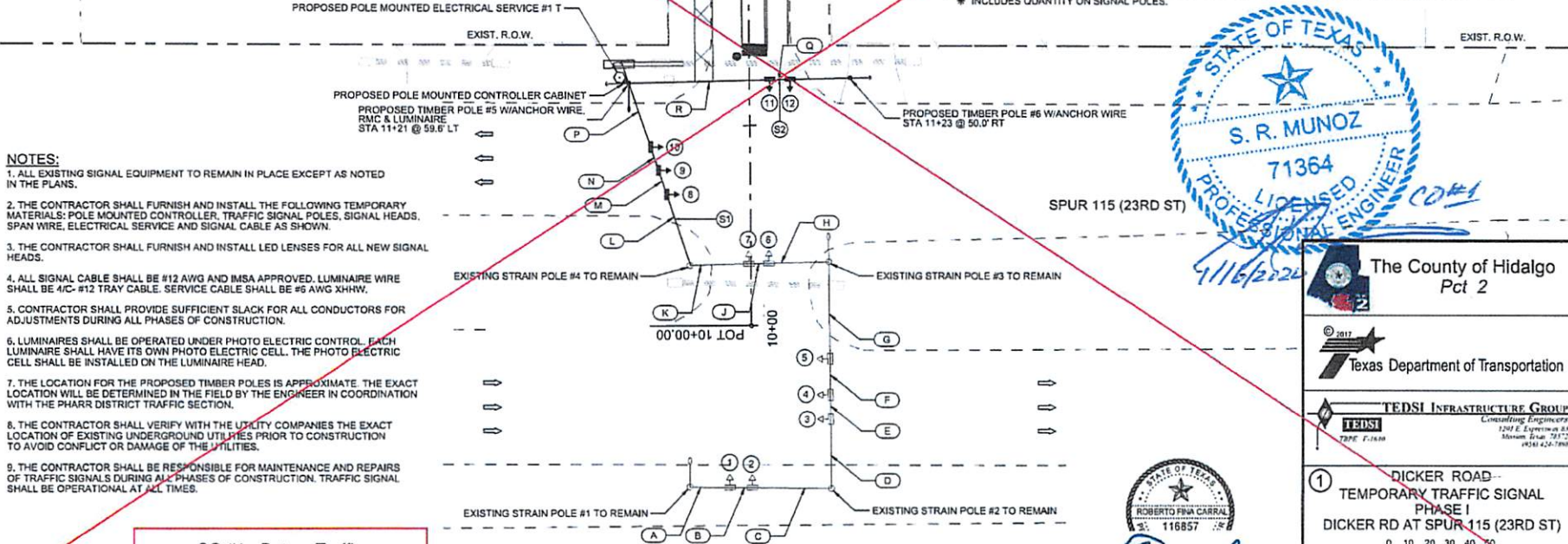

- NOTES:**
- ALL EXISTING SIGNAL EQUIPMENT TO REMAIN IN PLACE EXCEPT AS NOTED IN THE PLANS.
 - THE CONTRACTOR SHALL FURNISH AND INSTALL THE FOLLOWING TEMPORARY MATERIALS: POLE MOUNTED CONTROLLER, TRAFFIC SIGNAL POLES, SIGNAL HEADS, SPAN WIRE, ELECTRICAL SERVICE AND SIGNAL CABLE AS SHOWN.
 - THE CONTRACTOR SHALL FURNISH AND INSTALL LED LENSES FOR ALL NEW SIGNAL HEADS.
 - ALL SIGNAL CABLE SHALL BE #12 AWG AND IMSA APPROVED. LUMINAIRE WIRE SHALL BE 4/C-#12 TRAY CABLE. SERVICE CABLE SHALL BE #6 AWG XHHW.
 - CONTRACTOR SHALL PROVIDE SUFFICIENT SLACK FOR ALL CONDUCTORS FOR ADJUSTMENTS DURING ALL PHASES OF CONSTRUCTION.
 - LUMINAIRES SHALL BE OPERATED UNDER PHOTO ELECTRIC CONTROL. EACH LUMINAIRE SHALL HAVE ITS OWN PHOTO ELECTRIC CELL. THE PHOTO ELECTRIC CELL SHALL BE INSTALLED ON THE LUMINAIRE HEAD.
 - THE LOCATION FOR THE PROPOSED TIMBER POLES IS APPROXIMATE. THE EXACT LOCATION WILL BE DETERMINED IN THE FIELD BY THE ENGINEER IN COORDINATION WITH THE PHARR DISTRICT TRAFFIC SECTION.
 - THE CONTRACTOR SHALL VERIFY WITH THE UTILITY COMPANIES THE EXACT LOCATION OF EXISTING UNDERGROUND UTILITIES PRIOR TO CONSTRUCTION TO AVOID CONFLICT OR DAMAGE OF THE UTILITIES.
 - THE CONTRACTOR SHALL BE RESPONSIBLE FOR MAINTENANCE AND REPAIRS OF TRAFFIC SIGNALS DURING ALL PHASES OF CONSTRUCTION. TRAFFIC SIGNAL SHALL BE OPERATIONAL AT ALL TIMES.

**CO #1 - Detour Traffic
23rd Street to 10th Street**

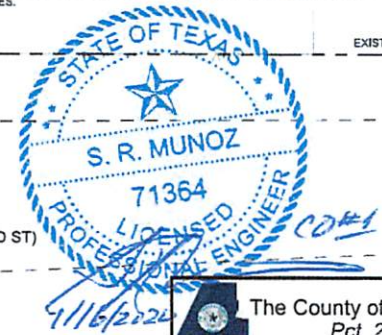

The County of Hidalgo
Pct 2

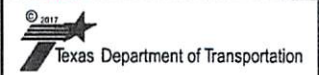

TEDSI INFRASTRUCTURE GROUP
Consulting Engineers
1201 E. Expressway #11
Marathon, Texas 79702
(409) 424-7800

**DICKER ROAD -
TEMPORARY TRAFFIC SIGNAL
PHASE I
DICKER RD AT SPUR 115 (23RD ST)**

SCALE 1" = 50'

SHEET 1 OF 1

DATE	4/25/2018	REV	02	BY	RC
PROJECT	0521	LOCATION	312	SECTION	DICKER ROAD
CITY	PHR	COUNTY	No 2	STATE	HIDALGO

DATE: 4/25/2018 1:12:46 PM
FILE: Dickor Signal Temp.dwg



4/25/2018

ELECTRICAL SCHEDULE														
ITEM	TOTAL QTY	RUN NUMBER	A	B	C	D	E	F	G	H	J	K	L	M
POWER	12	1/C-#8	12	86	80	14	12	56	15	12	84	43	12	96
LUMINAIRE		4/C-#12 TRAY CBL												
IL-SN		4/C-#12 TRAY CBL												
GROUND	6	1/C-#6 BARE												
		1/C-#6 BARE												
PEDESTRIAN HEADS		2/C-#12												
		4/C-#12												
		7/C-#12												
SIGNAL HEADS	375	5/C-#12				1	1	1	1	1	1	1	1	1
	834	7/C-#12		1	1	2	2	2	1	1	1	1	2	2
	35	2" RMC												
CONDUIT		2" RMC												
		2" PVC BORE												
		4" PVC												
		4" PVC BORE												

* INCLUDES QUANTITY ON SIGNAL POLE.

- LEGEND**
- PROPOSED TIMBER POLE W/ANCHOR WIRES
 - PROPOSED SPAN WIRE
 - PROPOSED HORIZONTAL SIGNAL HEAD
 - PROPOSED POLE MOUNTED CONTROLLER CABINET
 - PROPOSED POLE MOUNTED ELECTRICAL SERVICE WIRE RUN DESIGNATION
 - DIRECTION OF TRAFFIC FLOW

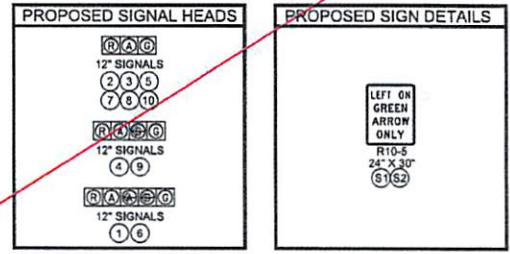

NOTE: BACK PLATES SHALL BE INSTALLED FOR SIGNAL HEADS 4, 5, 9, 10

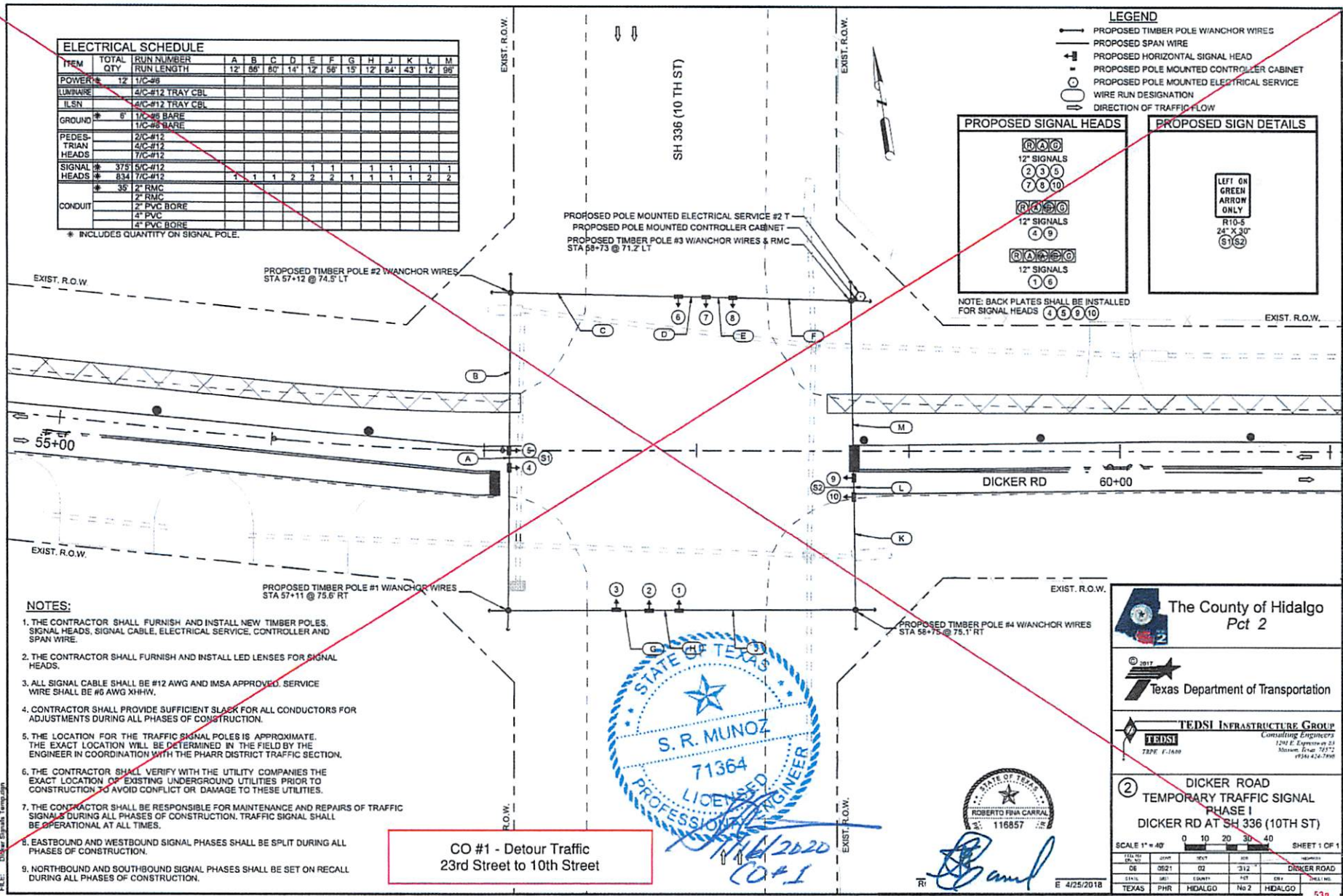

- NOTES:**
1. THE CONTRACTOR SHALL FURNISH AND INSTALL NEW TIMBER POLES, SIGNAL HEADS, SIGNAL CABLE, ELECTRICAL SERVICE, CONTROLLER AND SPAN WIRE.
 2. THE CONTRACTOR SHALL FURNISH AND INSTALL LED LENSES FOR SIGNAL HEADS.
 3. ALL SIGNAL CABLE SHALL BE #12 AWG AND IMSA APPROVED. SERVICE WIRE SHALL BE #6 AWG XHHW.
 4. CONTRACTOR SHALL PROVIDE SUFFICIENT SLACK FOR ALL CONDUCTORS FOR ADJUSTMENTS DURING ALL PHASES OF CONSTRUCTION.
 5. THE LOCATION FOR THE TRAFFIC SIGNAL POLES IS APPROXIMATE. THE EXACT LOCATION WILL BE DETERMINED IN THE FIELD BY THE ENGINEER IN COORDINATION WITH THE PHARR DISTRICT TRAFFIC SECTION.
 6. THE CONTRACTOR SHALL VERIFY WITH THE UTILITY COMPANIES THE EXACT LOCATION OF EXISTING UNDERGROUND UTILITIES PRIOR TO CONSTRUCTION TO AVOID CONFLICT OR DAMAGE TO THESE UTILITIES.
 7. THE CONTRACTOR SHALL BE RESPONSIBLE FOR MAINTENANCE AND REPAIRS OF TRAFFIC SIGNALS DURING ALL PHASES OF CONSTRUCTION. TRAFFIC SIGNAL SHALL BE OPERATIONAL AT ALL TIMES.
 8. EASTBOUND AND WESTBOUND SIGNAL PHASES SHALL BE SPLIT DURING ALL PHASES OF CONSTRUCTION.
 9. NORTHBOUND AND SOUTHBOUND SIGNAL PHASES SHALL BE SET ON RECALL DURING ALL PHASES OF CONSTRUCTION.

CO #1 - Detour Traffic
23rd Street to 10th Street



The County of Hidalgo
Pct 2

© 2017
Texas Department of Transportation

TEDSI INFRASTRUCTURE GROUP
Consulting Engineers
1201 E. Expressway 83
Brownsville, Texas 77802
78786-11600

DICKER ROAD
TEMPORARY TRAFFIC SIGNAL
PHASE I
DICKER RD AT SH 336 (10TH ST)

SCALE 1" = 40'

DATE: 4/27/2018
FILE: Dmr Signals Temp.dwg

DATE: 4/25/2018

SHEET 1 OF 1

STATE	CDR	REV	DATE	DESCRIPTION
TX	0821	02	3/12	DICKER ROAD
STATE	DR	CDR	REV	DATE
TX	PHR	HIDALGO	No 2	HIDALGO

538

NOTES:

CONTRACTOR RESPONSIBLE FOR MAINTENANCE AND REPAIRS OF TRAFFIC SIGNALS DURING ALL PHASES OF CONSTRUCTION.

* DENOTES EXISTING SIGNAL HEADS/SIGNS TO BE ADJUSTED TO FIT FIELD CONDITIONS.

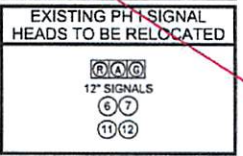
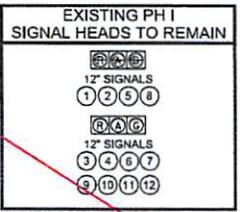
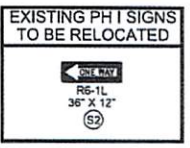

LEGEND

- EXISTING TIMBER POLE W/ANCHOR WIRE
- EXISTING STRAIN POLE TO REMAIN
- EXISTING SPAN WIRE TO REMAIN
- ◁ EXISTING HORIZONTAL SIGNAL HEAD TO REMAIN
- EXISTING POLE MOUNTED CONTROLLER CABINET
- EXISTING POLE MOUNTED ELECTRICAL SERVICE
- EXISTING LUMINAIRE TO REMAIN
- ⇨ DIRECTION OF TRAFFIC FLOW

NOTES:

INFORMATION SHOWN RELATIVE TO EXISTING UNDERGROUND UTILITIES AND CONDUITS IS BASED ON THE BEST AVAILABLE INFORMATION SUPPLIED BY TxDOT, LOCAL ENTITIES, VARIOUS UTILITY COMPANIES AND FIELD SURVEYS.

EXISTING POLE MOUNTED ELECTRICAL SERVICE #1 T

EXIST. R.O.W.

EXISTING POLE MOUNTED CONTROLLER CABINET

EXISTING TIMBER POLE #5 W/ANCHOR WIRE, RMC & LUMINAIRE

EXISTING TIMBER POLE #6 W/ANCHOR WIRE

SPUR 115 (23RD ST)

EXISTING STRAIN POLE #3 TO REMAIN

EXISTING STRAIN POLE #4 TO REMAIN

10+00

EXISTING STRAIN POLE #1 TO REMAIN

EXISTING STRAIN POLE #2 TO REMAIN

CO #1 - Detour Traffic
23rd Street to 10th Street

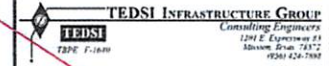
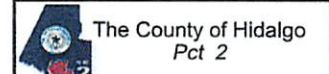

1 DICKER ROAD
TEMPORARY TRAFFIC SIGNAL
PHASE II
DICKER RD AT SPUR 115 (23RD ST)

SCALE 1" = 50'

100	200	300	400	500
0	10	20	30	40
50	0021	02	312	
TEXAS	PHR	HIDALGO	No 2	HIDALGO

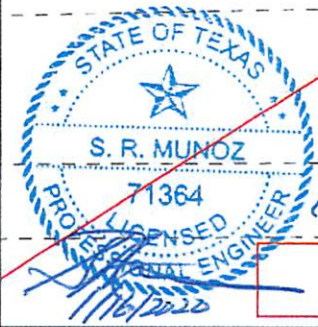

DATE: 4/25/2018
FILE: Dicker Signal Temp.dgn

TE 4/25/2018

NOTES:

CONTRACTOR RESPONSIBLE FOR MAINTENANCE AND REPAIRS OF TRAFFIC SIGNALS DURING ALL PHASES OF CONSTRUCTION.

* DENOTES EXISTING SIGNAL HEADS/SIGNS TO BE ADJUSTED TO FIT FIELD CONDITIONS.

LEGEND

- ○ — EXISTING TIMBER POLE W/ANCHOR WIRES
- — — EXISTING SPAN WIRE
- □ — EXISTING HORIZONTAL SIGNAL HEAD
- □ — EXISTING POLE MOUNTED CONTROLLER CABINET
- □ — EXISTING POLE MOUNTED ELECTRICAL SERVICE
- ⇄ DIRECTION OF TRAFFIC FLOW

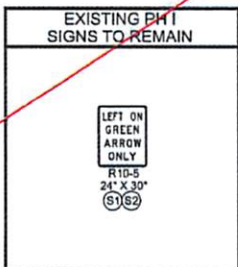
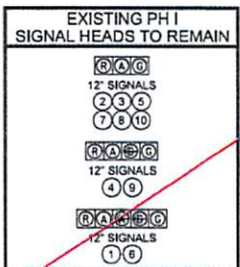
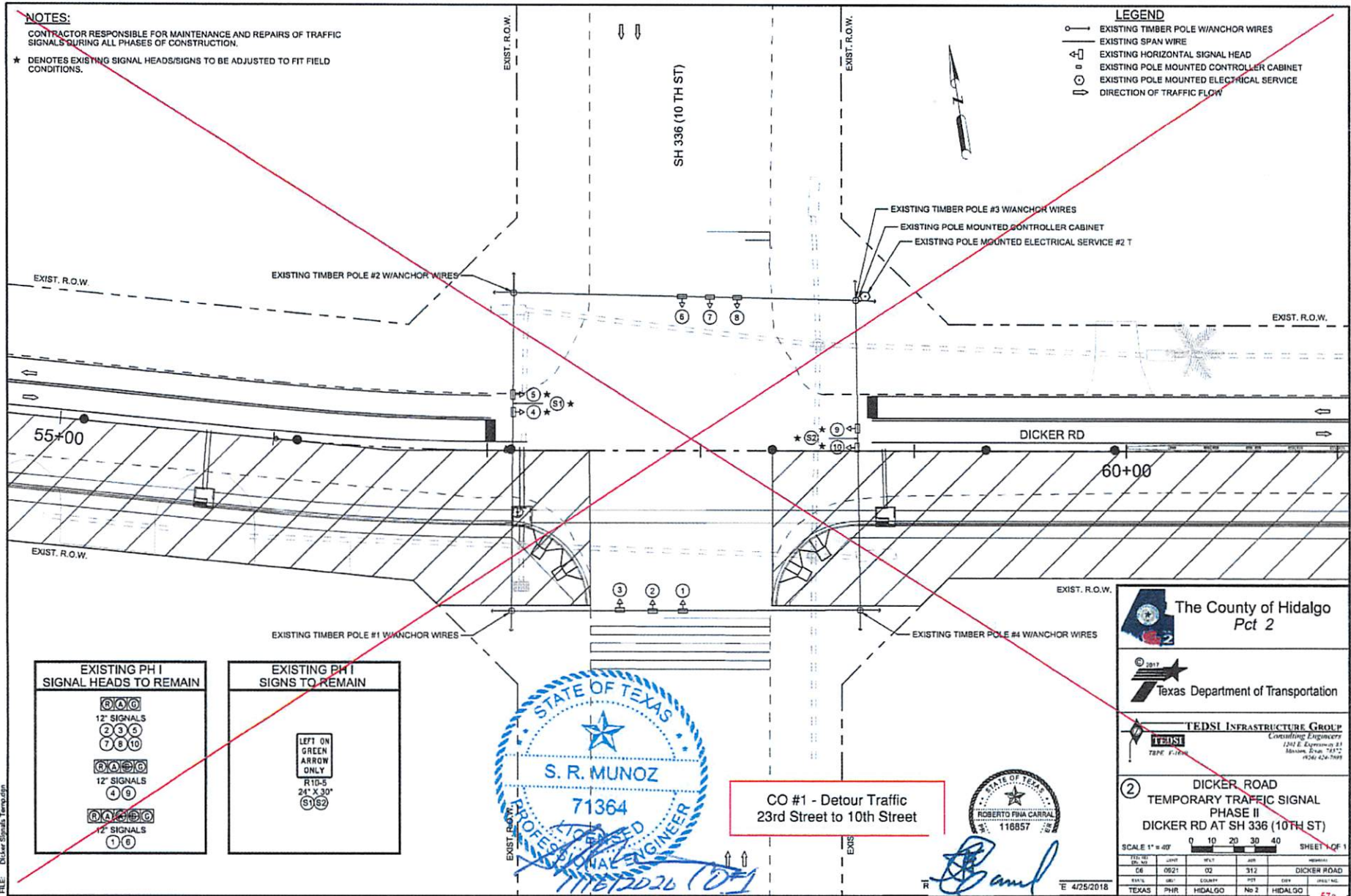

CO #1 - Detour Traffic
23rd Street to 10th Street



[Handwritten Signature]

The County of Hidalgo
Pct 2

Texas Department of Transportation

TEDSI INFRASTRUCTURE GROUP
Consulting Engineers
1261 E. Expressway #11
San Antonio, Texas 78212
(214) 426-7899

② DICKER ROAD
TEMPORARY TRAFFIC SIGNAL
PHASE II
DICKER RD AT SH 336 (10TH ST)

SCALE 1" = 40'

DATE	APP'D	REV'D	APP'D
08/06/21	02	312	DICKER ROAD
PHR	PHR	PHR	PHR
TEXAS	PHR	HIDALGO	No 2 HIDALGO

57a

DATE: 4/25/2018 1:32:47 PM
FILE: Dickersignals Temp.dgn

NOTES:

CONTRACTOR RESPONSIBLE FOR MAINTENANCE AND REPAIRS OF TRAFFIC SIGNALS DURING ALL PHASES OF CONSTRUCTION.

* DENOTES EXISTING SIGNAL HEADS/SIGNS TO BE ADJUSTED TO FIT FIELD CONDITIONS.

LEGEND

- → EXISTING TIMBER POLE W/ANCHOR WIRE
- EXISTING STRAIN POLE TO REMAIN
- EXISTING SPAN WIRE TO REMAIN
- ◁ ▷ EXISTING HORIZONTAL SIGNAL HEAD TO REMAIN
- ◻ EXISTING POLE MOUNTED CONTROLLER CABINET
- ⊙ EXISTING POLE MOUNTED ELECTRICAL SERVICE
- EXISTING LUMINAIRE TO REMAIN
- ⇄ DIRECTION OF TRAFFIC FLOW

NOTES:

INFORMATION SHOWN RELATIVE TO EXISTING UNDERGROUND UTILITIES AND CONDUITS IS BASED ON THE BEST AVAILABLE INFORMATION SUPPLIED BY TXDOT, LOCAL ENTITIES, VARIOUS UTILITY COMPANIES AND FIELD SURVEYS.

EXISTING PH II SIGNS TO REMAIN

LEFT ON GREEN
ARROW ONLY
RTD-5
24" X 30"
(S1)

ONE WAY
R5-1L
36" X 12"
(S2)

EXISTING PH II SIGNAL HEADS TO REMAIN

12" SIGNALS
1 2 5 8

12" SIGNALS
3 4 6 7
9 10 11 12



CO #1 - Detour Traffic
23rd Street to 10th Street

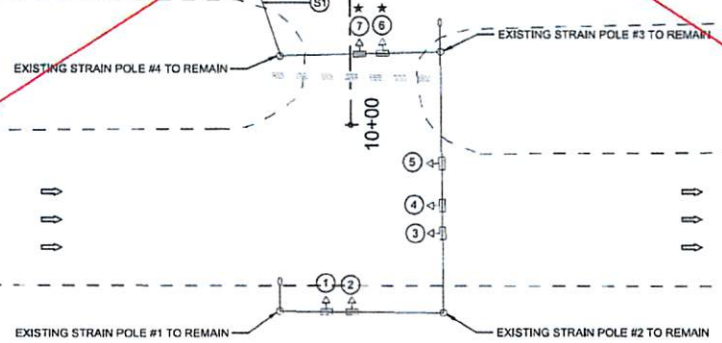
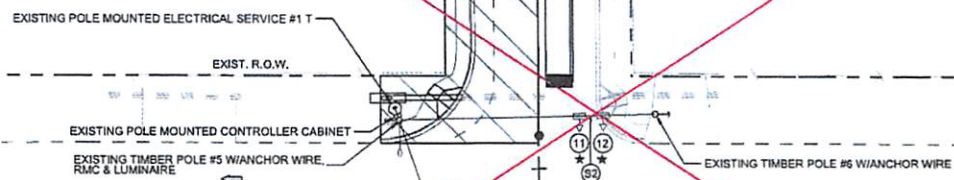

The County of Hidalgo
Pct 2

Texas Department of Transportation

TEDSI INFRASTRUCTURE GROUP
Consulting Engineers
1201 E. Expressway #11
Mission, Texas 78147
(951) 424-7900

DICKER ROAD
TEMPORARY TRAFFIC SIGNAL
PHASE III
DICKER RD AT SPUR 115 (23RD ST)

SCALE 1" = 50'

DATE	DATE	DATE	DATE
06	09/21	02	312
TXAS	PHR	HIDALGO	No 2

DICKER ROAD
SHEET 1 OF 1

4/26/2018

DATE: 4/25/2018 1:32:48 PM
FILE: Dickker_Signals_Temp.dwg

NOTES:

CONTRACTOR RESPONSIBLE FOR MAINTENANCE AND REPAIRS OF TRAFFIC SIGNALS DURING ALL PHASES OF CONSTRUCTION.

* DENOTES EXISTING SIGNAL HEADS/SIGNS TO BE ADJUSTED TO FIT FIELD CONDITIONS.

- LEGEND**
- EXISTING TIMBER POLE W/ANCHOR WIRES
 - EXISTING SPAN WIRE
 - EXISTING HORIZONTAL SIGNAL HEAD
 - EXISTING POLE MOUNTED CONTROLLER CABINET
 - EXISTING POLE MOUNTED ELECTRICAL SERVICE
 - DIRECTION OF TRAFFIC FLOW

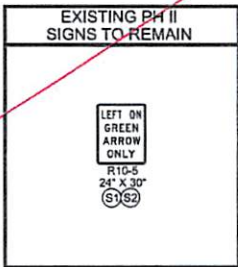
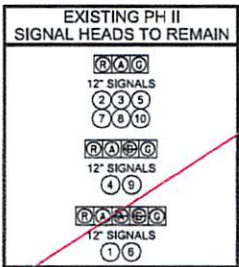
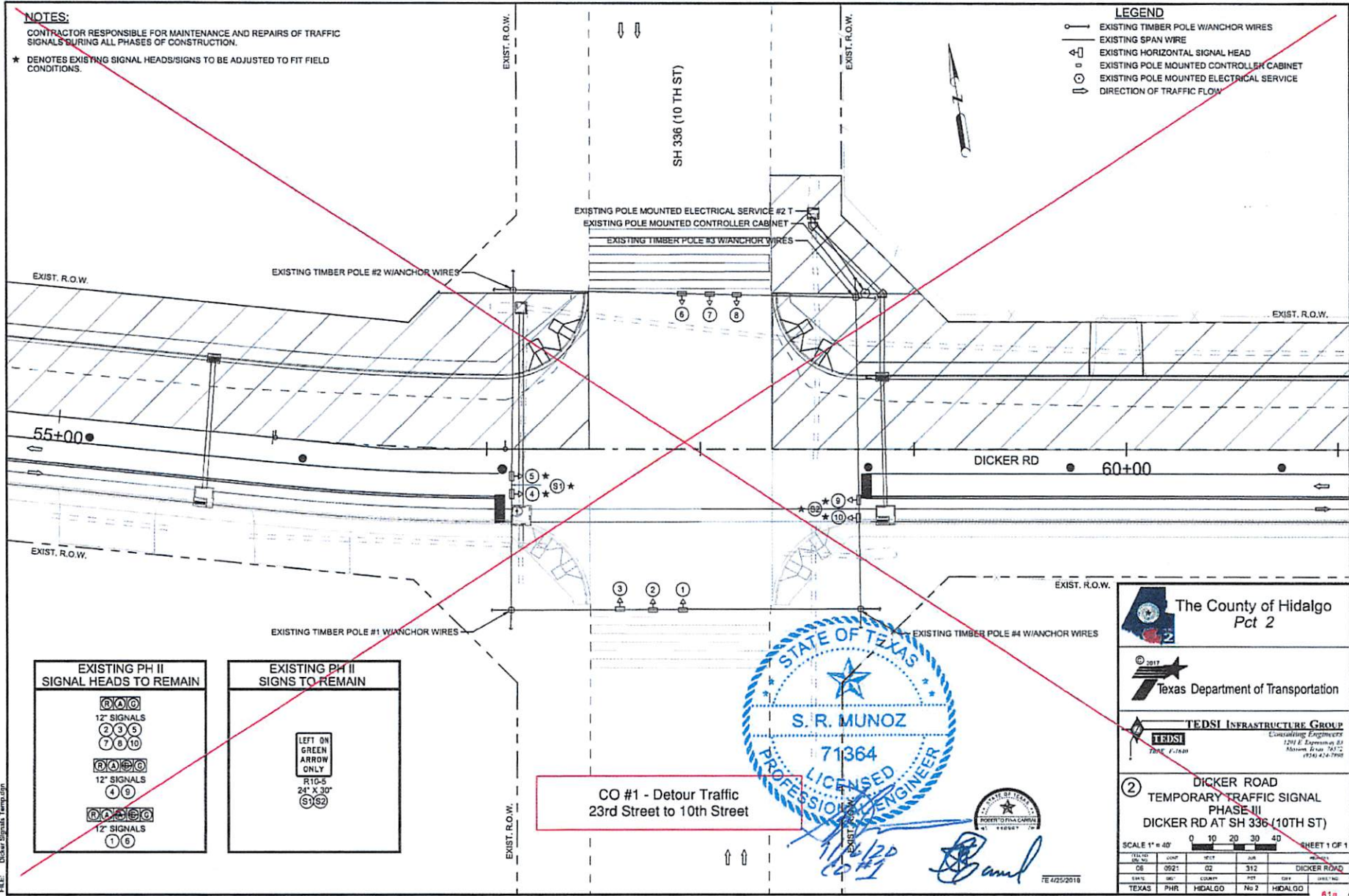

CO #1 - Detour Traffic
23rd Street to 10th Street

The County of Hidalgo
Pct 2

© 2017
Texas Department of Transportation

TEDSI INFRASTRUCTURE GROUP
Consulting Engineers
1201 E. Expressway 83
Brownsville, TX 77802
(361) 424-7900

2 DICKER ROAD
TEMPORARY TRAFFIC SIGNAL
PHASE II
DICKER RD AT SH 336 (10TH ST)

SCALE 1" = 40'

SHEET 1 OF 1

PROJECT NO.	0921	02	312	DICKER ROAD
DISTRICT	PHR	HIDALGO	No 2	HIDALGO

DATE: 4/25/2018
FILE: Dicker Signal Temp.dgn

DATE: 4/25/2018 1:22:59 PM
FILE: Dicker Signal Temp.dgn

ELECTRICAL SERVICE DATA (TEMPORARY TRAFFIC SIGNALS)
ITEM 628

Service Pole No.	Location	Service Pole Description	Service Conduit Size RMC	Service Conductors No./Size XHHW	Safety Switch Amps	Main Disconnect Ckt. Bkr. Pole/Amp	Two-Pole Contactor Amps	Panelbd./ Loadcenter Amp Rating	Circuit No.	Branch Ckt. Bkr. Pole/Amps	Branch Circuit Amps	KVA Load
1 T	DICKER RD AT SPUR 115 (23RD ST)	TY T (120/240) 000 (NS) GS (L) TP (O)	1.25"	3/#6 AWG	N/A	N/A	30	70	TS	1P/50	2	1.0
2 T	DICKER RD AT SH 336 (10TH ST)	TY T (120/240) 000 (NS) GS (N) TP (O)	1.25"	3/#6 AWG	N/A	N/A	N/A	70	TS	1P/50	2	0.2
EXISTING	DICKER RD AT McCOLL RD	EXISTING ELECTRICAL SERVICE TO REMAIN IN PLACE										
3 T	DICKER RD AT FM 2061 (JACKSON RD)	TY T (120/240) 000 (NS) GS (N) TP (O)	1.25"	3/#6 AWG	N/A	N/A	N/A	70	TS	1P/50	2	0.2

CIRCUITS: TS = TRAFFIC SIGNAL, LUM = LUMINAIRE.



CO #1 - Detour Traffic
23rd Street to 10th Street

The County of Hidalgo
Pct 2

© 2017
Texas Department of Transportation

TEDSI INFRASTRUCTURE GROUP
Consulting Engineers
1201 E. Expressway 317
McAllen, Texas 78501
(361) 424-7800

DICKER ROAD
TEMPORARY TRAFFIC SIGNAL
ELECTRICAL SERVICE DATA

SHEET 1 OF 1

DESIGN NO.	DATE	REV	BY	CHK
06	09/21	02	312	DICKER ROAD
TITLE	SEC	COUNTY	PCT	LOCAL NO.
TEXAS	PHR	HIDALGO	No 2	HIDALGO

64a

DATE: 4/25/2018 1:32:50 PM
FILE: Dicker Signals Temp.dgn