

Change Order #9

Regional Linear Park Phase II (Hike & Bike Trail)

Owner: Hidalgo County Precinct #2

To: Texas Cordia Construction, LLC
3149-A Center Pointe Drive
Edinburg, Texas 78539

From: B2Z Engineering

Project: Regional Linear Park Phase II
Project#: STP 2019 (086) TP
Contract: C-18-199-02-12
CSJ: 0921-02-409
Limits: Hall Acres to Ridge Road

Change Order #9 has been approved to make the following Contract Changes:

Description & Purpose:

Change Order #9 was created to remove and replace five illumination poles and assemblies that were damaged by non-construction related parties in both Phase I and II of the Regional Linear Park Project. The Hidalgo County Precinct #2 also requested to order eight additional poles to have for future use.

The damages include four poles located in Phase I (LP-F27, LP-A29, LP-A2, & LP-H12) and one pole located in Phase II (LP-M11). This change order is needed to add two new bid items; item 9009-001 is to remove and replace the five damaged poles, and item 9009-002 is to purchase eight additional luminaire poles and assemblies (material only). The work is minor, and four of the five poles are outside of the project limits. At the request of Hidalgo County Precinct #2, all expenses are to be included under Phase II and they will assume all costs associated with this change order.

The two new items are unique, and their prices are not comparable to statewide bid averages. The items and prices have been reviewed closely and accepted by Precinct #2 for payment according to the governing Specification 1L-9L.

This change order has been signed by both the contractor and AE. Third party funding is involved, and the additional funds have been approved by the County to amend the current contract agreement and reflect the changes shown in this change order. The changes do not impact the original environmental assessment, do not impact TDLR elements, do not impact wetlands, and do not impact waters of the US, archeological, historical or social issues; endangered species, or any other regulated areas within the project. This change order does not cause disturbances larger than 1 acre or require a Construction Site Notice (CSN) or Notice of Intent (NOI).

The status of this change order is awaiting approval. The plans were prepared by L&G Engineering, and the change order was prepared by B2Z Engineering. See TxDOT Change Order

Form 2146-L used to introduce new bid items and prices. Revised plan sheets include 145a, 146a, 147a, 148a, 149a, 150a, 151a, 152a and 153a.

CHANGE IN CONTRACT PRICE:	CHANGE IN CONTRACT TIME:
Original Contract Price <u>\$3,409,415.00</u>	Original Contract Time <u>400 Working Days</u>
Previous Change Orders <u>\$357,067.98</u>	Previous Change Orders <u>0 Working Days</u>

Contract Price prior to this Change Order <u>\$3,766,482.98</u>	Contract Time prior to this Change Order <u>400 Working Days</u>
Net increase/decrease of this Change Order <u>\$58,051.77</u>	Net increase/decrease of this Change Order <u>0 Working Days</u>
Contract Price with all approved Change Orders <u>\$3,824,534.75</u>	Contract Time with all approved Change Orders <u>400 Working Days</u>

CONSTRUCTION CONTRACT CHANGE ORDER NUMBER: 9

1. CONTRACTOR: Texas Cordia Construction, LLC
2. Change Order Work Limits: Sta. 505+00 to Sta. 545+00
3. Type of Change (on federal-aid non-exempt projects): Minor (Major/Minor)
4. Describe the change and the reason for the change order. When necessary, include exceptions to this agreement.

Change Order #9 was created to remove and replace five illumination poles and assemblies that were damaged by non-construction related parties in both Phase I and II of the RLPP Project. This change order introduces two new items; 1) 9009-001, remove & replace damaged illumination assemblies (five total) and 2) 9009-002, to order eight additional assemblies (material only) as request by Hidalgo County Precinct #2 to have for future use.

CCSJ:	<u>0921-02-409</u>
Project:	<u>STP 2019 (086) TP</u>
Highway:	<u>Hike & Bike</u>
County:	<u>Hidalgo</u>
District:	<u>Pharr</u>
Contract Number:	<u>C-18-199-02-12</u>

5. New or revised plan sheet(s) are attached and numbered: 145a, 146a, 147a, 148a, 149a, 150a, 151a, 152a, & 153a

Each signatory hereby warrants that each has the authority to execute this Change Order.

<p>By signing this change order, the contractor agrees to waive any and all claims for additional compensation due to any and all other expenses; additional changes for time, overhead and profit; or loss of compensation as a result of this change. Further, the contractor agrees that this agreement is made in accordance with Item 4 and the Contract. Exceptions should be noted in the response for #5 above.</p>	<p>The following information must be provided</p> <p>Time Ext. #: <u>0</u> Days added on this C.O.: <u>0</u></p> <p>Amt. added by this change order: <u>\$58,051.77</u></p> <p>For TxDOT use only:</p> <p>Days participating: <u>0</u></p> <p>Amount participating: <u>\$0.00</u></p> <p>Signature _____ Date _____</p> <p>Name/Title _____</p>
<p>THE CONTRACTOR _____ Date <u>6/30/2020</u></p> <p>By <u>[Signature]</u></p> <p>Typed/Printed Name <u>Yara Corbett P.E</u></p> <p>Typed/Printed Title <u>CEO</u></p>	

RECOMMENDED FOR EXECUTION:

<p><u>[Signature]</u> _____ Date <u>4/30/2020</u></p> <p>Name/Title _____ Date _____</p>	<p>Name/Title _____ Date _____</p> <p><input type="checkbox"/> APPROVED <input type="checkbox"/> REQUEST APPROVAL</p>
<p>Name/Title _____ Date _____</p>	<p>Name/Title _____ Date _____</p> <p><input type="checkbox"/> APPROVED <input type="checkbox"/> REQUEST APPROVAL</p>
<p>Name/Title _____ Date _____</p>	<p>Name/Title _____ Date _____</p> <p><input type="checkbox"/> APPROVED <input type="checkbox"/> REQUEST APPROVAL</p>
<p>Name/Title _____ Date _____</p>	<p>Name/Title _____ Date _____</p> <p><input type="checkbox"/> APPROVED</p>

Engineer's Seal:



CONSTRUCTION CONTRACT CHANGE ORDER NUMBER: 9

Estimated Cost:

CCSJ: 0921-02-409

Paid by Invoice? (Yes No)

TABLE A: Force Account Work and Materials Placed into Stock

LABOR	HOURLY RATE	EQUIPMENT	HOURLY RATE

TABLE B: Contract Items

ITEM	DESCRIPTION	UNIT	UNIT PRICE	ORIGINAL + PREVIOUSLY REVISED		NEW		OVERRUN/ UNDERRUN	
				QUANTITY	ITEM COST	QUANTITY	ITEM COST		
9009-001	Rem/Repl Damaged Illum Asbly	EA	6,044.85	0.00	0.00	5.00	30,224.25	30,224.25	
9009-002	Lumin Pole & Light Fixt(Matl Only)	EA	3,478.44	0.00	0.00	8.00	27,827.52	27,827.52	
TOTALS						0.00		58,051.77	58,051.77

ILLUMINATION QUANTITIES - SHEET TOTALS					
ITEM	DESCR CODE	DESCRIPTION	UNIT	QUANTITIES	
					SHEET 20
HC 011		FURNISH AND INSTALL VISIONAIRE LIGHTING PREMIER II (PRE-2-T4-48LC-3-4K-UNV-PT-FINISH) EQ LUMINAIRE FIXTURE AND LUMINAIRE POLE TRADITIONAL CONCRETE INC. D412-SG-EA-3T COMPLETE IN PLACE, INCLUDING ALL COMPONENTS AND FOUNDATION.	EA	11	
HC 001		FURNISH AND INSTALL LIGHTING FIXTURE (LED WATERPROOF) TYPE ILX3525-055UV-F5M-55ND-SSL (IP68) WITH AN IP68 GLAND, IP68 JUNCTION BOX AND STEEL WIRE MESH COVER ASSEMBLY PROTECTION	EA	2	
618	6023	CONDT (PVC) (SCH 40) (2")	LF	610	
620	6007	ELEC CONDR (NO.8) BARE	LF	610	
684	6009	TRF SIG CBL (TY A) (12 AWG) (4 CONDR)	LF	805	
HC 002		ELEC CONDR (NO.10) PVC JACKET, 90 DEGREE CELCIUS INSULATION, 600V	LF	50	
HC 009		GALVANIZED RIGID STEEL CONDUIT (1-1/4")	LF	50	
624	6001	GROUND BOX TY A (122311)	EA	4	

THIS POLE HAS BEEN MODIFIED TO SHOW A LUMINAIRE WITH A 15° TILT FROM THE HORIZONTAL. SEE DETAIL A AND ROADWAY ILLUMINATION POLE STANDARD SHEET RIP (3)-17 PAGE 3 OF 4

[1]

LOCATION & ORIENTATION TABLE

LUM ID	STA.	OFFSET	*ORIENTATION
L-M1	506+97.82	9' LT	0.0°
L-M2	507+38.53	9' LT	0.0°
L-M3	507+78.53	9' LT	0.0°
L-M4	508+18.53	9' LT	0.0°
L-M5	508+58.53	9' LT	0.0°
L-M6	508+98.53	9' LT	0.0°
L-M7	509+38.53	9' LT	0.0°
L-M8	509+78.53	9' LT	0.0°
L-M9	510+18.53	9' RT	0.0°
L-M10	510+58.53	9' RT	0.0°
L-M11	510+98.53	9' RT	0.0°
** LP-D25	228+95.14	7.92' LT	13.96° CCW
** LP-D26	228+56.70	7.98' LT	0.25° CW
L-L5	506+18.4	0.0'	0.0°
L-L6	506+46.4	0.0'	0.0°

*ORIENTATION IS MEASURED FROM A PERPENDICULAR LINE TO THE PATHWAY.
 CW - CLOCKWISE
 CCW - COUNTER CLOCKWISE
 STATIONS AND OFFSETS ARE MEASURED FROM THE
 **EXISTING HIKE AND BIKE TRAIL

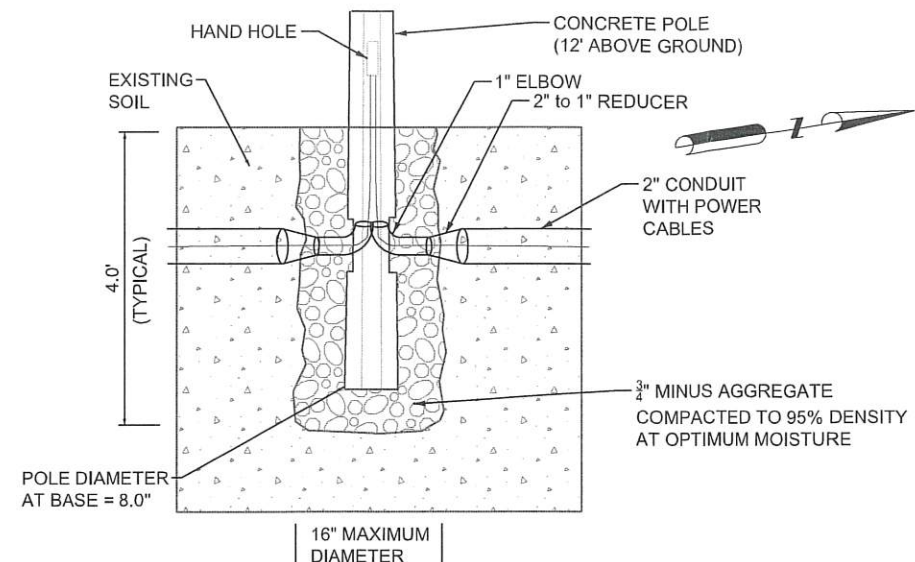

POLE EMBEDMENT DETAIL (TYP.) FOR L-M1 THRU L-M11

NOTES:

1. THE CONTRACTOR SHALL COORDINATE WITH UTILITY COMPANIES TO VERIFY THE LOCATION OF EXISTING UTILITIES PRIOR TO CONSTRUCTION TO AVOID CONFLICT WITH OR DAMAGE TO THESE UTILITIES.
2. ALL STATIONS AND OFFSETS ARE WITH REFERENCE TO THE CENTERLINE OF THE PATHWAY.
3. ALL LUMINAIRES ALONG STRAIGHT PORTIONS OF THE PATHWAY ARE TO BE PLACED AT A SPACING OF 135', AN OFFSET OF 8' FROM THE CENTERLINE OF THE PATHWAY, ORIENTED PERPENDICULAR TO IT AND LUMINAIRE HEADS ARE TO BE TILTED 15° (SEE DETAIL A) UNLESS OTHERWISE NOTED.
4. THE STATIONS, OFFSETS, ORIENTATIONS AND TILT FOR ONLY THOSE LUMINAIRES THAT ARE NON TYPICAL HAVE BEEN LISTED IN THE TABLE.
5. CONDUIT RUNS ARE HORIZONTAL ONLY.
6. CONDUCTOR RUNS ARE BOTH HORIZONTAL AND VERTICAL.

LEGEND	
	PROPOSED GROUND BOX TYPE A
	IN RD IL (TY SA) 30S-4 (400W EQ) LED WITH TRASTAR DURALIGHT DURA-ST40-4K-120-2-GR-SCLB
	PROPOSED OVERHEAD TUNNEL LIGHTING FIXTURE IWL-3-035UV-2M-55 (IP68) OR EQUIVALENT
	PROPOSED OCTAGONAL CONCRETE POLE WITH "VISIONAIRE LIGHTING PREMIER II" FIXTURE OR EQUAL
	EXISTING OCTAGONAL CONCRETE POLE WITH "VISIONAIRE LIGHTING PREMIER II" FIXTURE
	PROP. ELECTRICAL SERVICE
	PROPOSED 2" (SCH 40) PVC CONDUIT
	PROPOSED 2" (SCH 80) PVC CONDUIT BORE
	PROPOSED 1-1/4" GALVANIZED RIGID STEEL CONDUIT

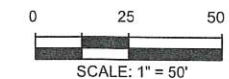

8/22/2018

L&G Engineering
 Highway / Civil
 Structural / Bridge
 Environmental
 Firm No. : F-4105
 2100 W. Expressway 83
 Mercedes, TX. 78570
 Phone : (956) 565-9813
 Fax : (956) 565-9018
 900 S. Stewart Rd., Ste. 10
 Mission, TX. 78572
 Phone : (956) 585-1909
 Fax : (956) 585-1927

ETSI
 Ergonomic Transportation Solutions, Inc.
 TEXAS REGISTERED ENGINEERING FIRM NO. F-000625
 5300 Hollister Road, Suite 220
 Houston, Texas 77040
 Tel. (713) 956-9601 Fax (713) 956-9667

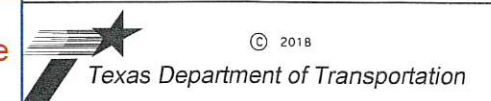

REGIONAL LINEAR PARK PROJECT SEC. 2 LIGHTING LAYOUT

SHEET 20 OF 20				
CK DN:	MNR	CONT	SECT	JOB
CK DW:	RLM	0921	02	409
CK TR:	HCS	DIST	COUNTY	RLPP
		PHR	HIDALGO	145a

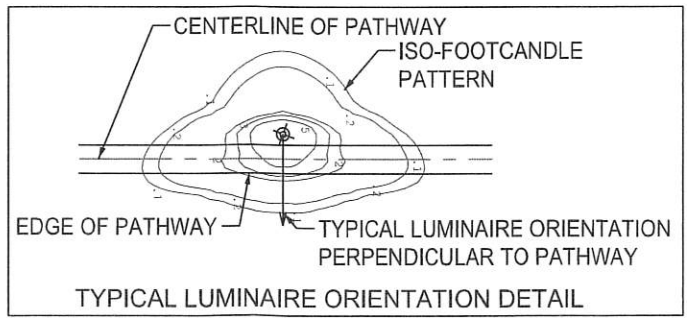
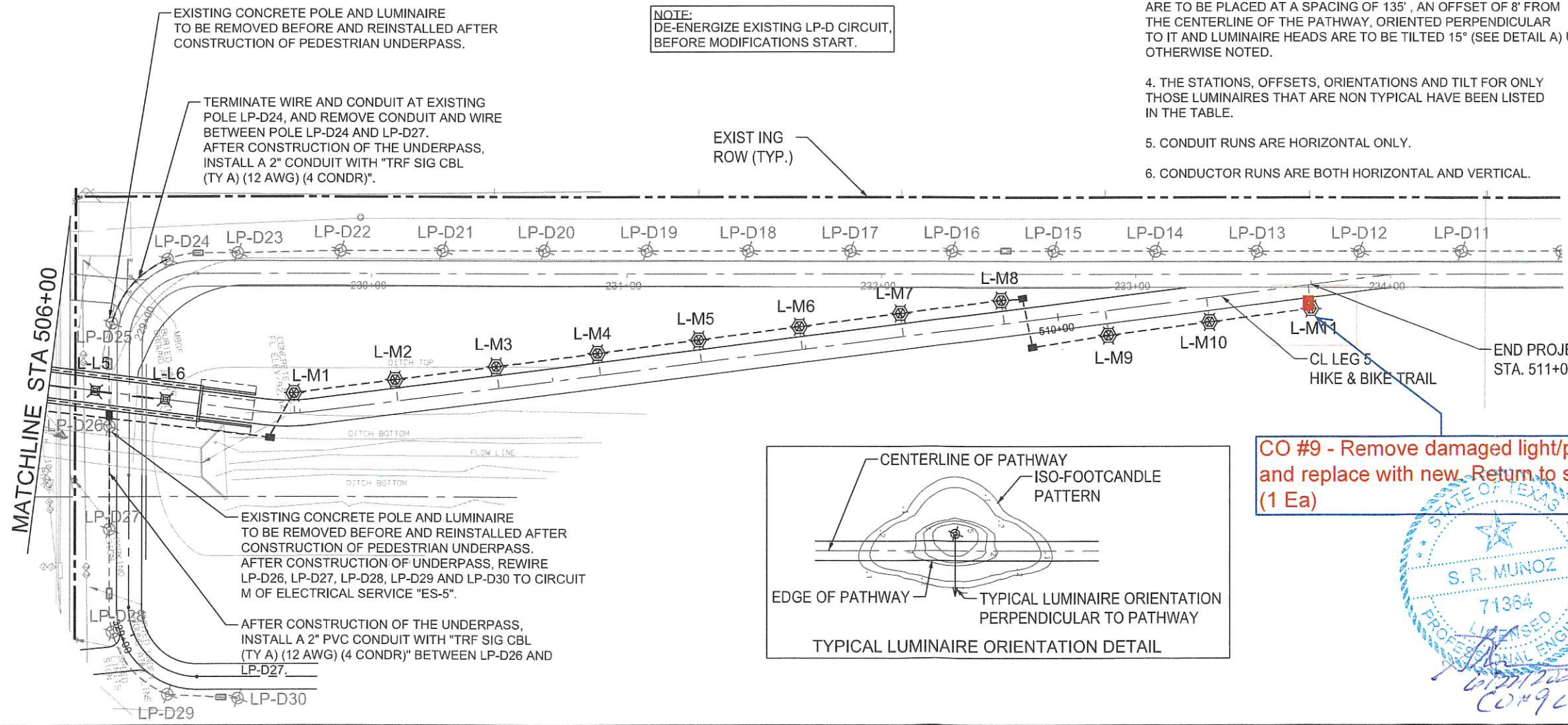

CO #9 - Remove damaged light/pole and replace with new. Return to service (1 Ea)



DATE: 8/22/2018 1:12:57 PM
 FILE: N:\CLIENTS\L&G\HIKE_BIKE_INETS\WORK\LIGHTING_LAYOUT\LP_20.dgn

STP_2017_02521_TP
NOV.2016

PROJ. NO.
LETTING DATE

COUNTY
HWT. NO.
DATE ACCEPTED

REGIONAL LINEAR PARK (SECI) 0921-02-365

INDEX DATA
SHEET ON PAGE 2

FINAL PLAN DATA :

FINAL CONTRACT PRICE: _____
CONTRACTORS NAME: _____
CONTRACTORS ADDRESS: _____
LETTING DATE: _____
DATE WORK BEGAN: _____
DATE WORK COMPLETED: _____
DATE OF ACCEPTANCE: _____

CHANGE ORDERS AND
SUPPLEMENTAL AGREEMENTS:

ALL CONSTRUCTION WORK WAS PERFORMED IN ACCORDANCE WITH THE PLANS, SPECIFICATIONS AND CONTRACT. ALL PROPOSED CONSTRUCTION WAS COMPLETED UNLESS OTHERWISE NOTED.

HIDALGO COUNTY
PRECINCT NO.2 : _____
DATE: _____

REGISTERED ACCESSIBILITY SPECIALIST (RAS) INSPECTION REQUIRED.

TDLR No. EABPRJ _____

SPECIFICATIONS ADOPTED BY THE TEXAS DEPARTMENT OF TRANSPORTATION ON NOVEMBER 1, 2014 AND SPECIFICATION ITEMS LISTED AND DATED AS FOLLOWS, SHALL GOVERN ON THIS PROJECT: REQUIRED CONTRACT PROVISIONS FOR ALL FEDERAL-AID CONSTRUCTION CONTRACTS (FORM FHWA 1273, MAY 2012).

HIDALGO COUNTY PRECINCT NO.2

PLANS OF PROPOSED HIKE AND BIKE TRAIL

FEDERAL AID PROJECT: STP 2017 (252) TP
HIDALGO COUNTY

REGIONAL LINEAR PARK (SECTION 1)

CSJ: 0921-02-365
NET LENGTH OF PROJ = 12,767.30 FT. = 2.418 MI.
(TRACK LANE MILES)

LIMITS: RIDGE RD. TO SAN ANTONIO AVE.

THE PROJECT WILL CONSIST OF A SHARED-USE TRAIL AND WILL INCLUDE: GRADING, ASPHALT, SIGNING, PAVEMENT MARKINGS, LIGHTING, LANDSCAPING, AND VARIOUS PEDESTRIAN FACILITIES & ELEMENTS.

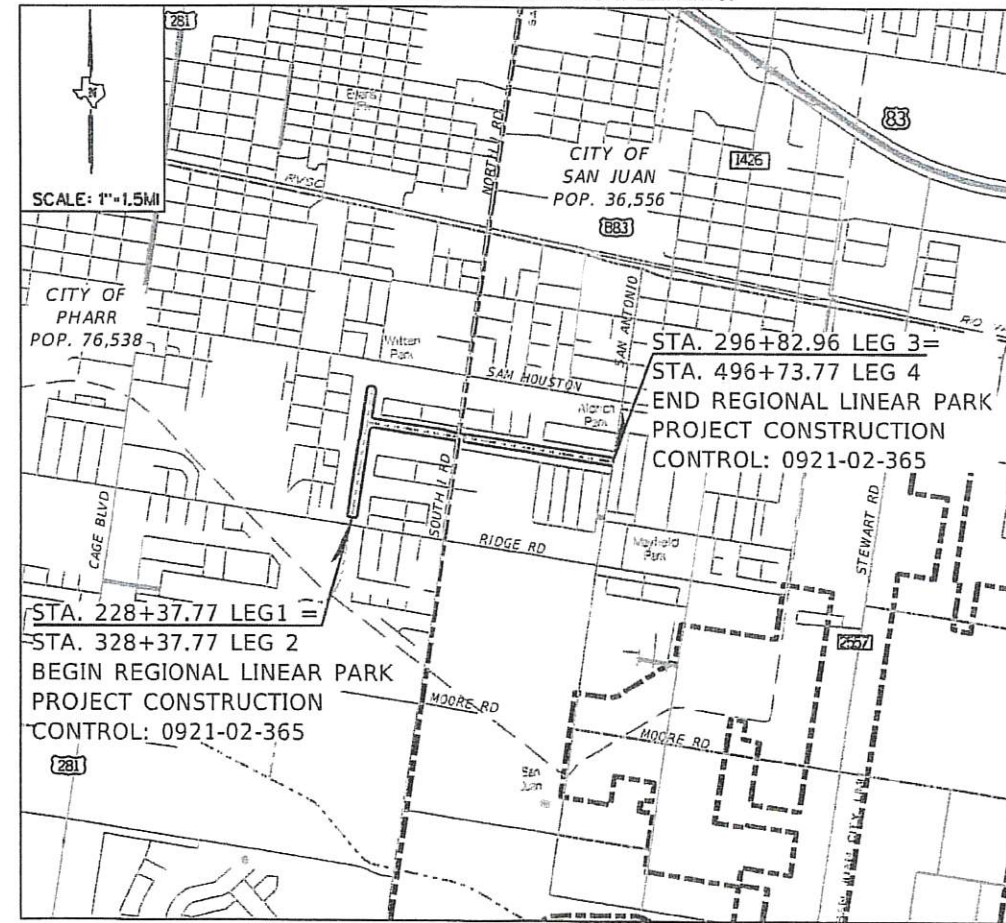

© 2016 by Texas Department of Transportation; all rights reserved.

PROJECT DATA

DESIGN SPEED:
RLPP: 12 MPH

EXCEPTIONS:
NONE

RAILROAD CROSSINGS:
NONE

EQUATIONS:
STA 228+37.77 LEG 1- STA 296+82.97 LEG 3-
STA 328+37.77 LEG 2 STA 496+73.77 LEG 4
STA 274+56.25 LEG 3- STA 471+70.16 LEG 4
STA 576+03.38 TURN 2 STA 671+70.16 TURN 2
STA 284+72.23 LEG 3- STA 484+03.03 LEG 4
STA 736+01.53 TURN 3 STA 784+03.03 TURN 3
STA 285+42.23 LEG 3 STA 485+33.03 LEG 4-
STA 837+31.53 TURN 4 STA 885+33.03 TURN 4

Texas Department of Transportation
RECOMMENDED FOR LETTING : _____ APPROVED FOR LETTING : _____
DISTRICT ENGINEER DIRECTOR, TRAFFIC OPERATIONS DIVISION
SUBMITTED FOR LETTING : _____ APPROVED FOR LETTING : _____
LG PROJECT COORDINATOR DIRECTOR, DESIGN DIVISION

FED. AID DIV. NO.	FEDERAL AID PROJECT NO.	SHEET NO.	
6	STP 2017 (252) TP	146a	
STATE	STATE DIST. NO.	COUNTY	
TEXAS	PHR	HIDALGO	
CONT	SECT.	JOB	HIGHWAY NO.
0921	02	365	RLPP

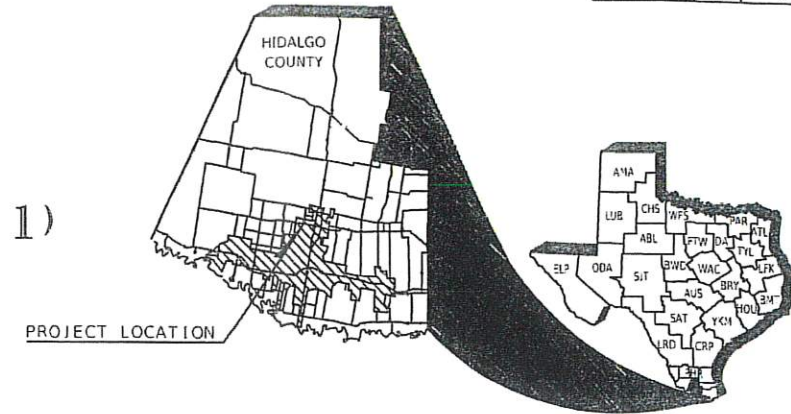

CO #9 - Change Order #9
Regional Linear Park Phase I
Remove and replace damaged with
new poles and return to service.

LOCAL ENTITIES	
HIDALGO COUNTY DRAINAGE-DISTRICT NO. 1 CONCURRENCE : _____ NAME _____ TITLE _____	DATE : 11/15/16 NAME _____ TITLE _____
CITY OF PHARR CONCURRENCE : _____ NAME _____ TITLE _____	DATE : 11/15/16 NAME _____ TITLE _____
CITY OF SAN JUAN CONCURRENCE : _____ NAME _____ TITLE _____	DATE : 11/8/2016 NAME _____ TITLE _____

L & G Engineering
2100 W. Expressway 83
Mercedes, TX. 78570
Phone : (956) 585-9813
Fax : (956) 565-9018
900 S. Stewart Rd., Ste. 10
Mission, TX. 78572
Phone : (956) 585-1909
Fax : (956) 585-1927
Firm No. : F-4105
DATE : 11/2/16
NAME _____
TITLE _____

APPROVED FOR LETTING : _____
PRECINCT NO.2

\\192.168.2.192\projects\Countries\HDB\Project 2\Bike & Bike Project Linear Park Project\MicroStation Data\01 GENERAL\03 Proj.dwg\Hdb_PROJ_LAYOUT_LEG1.dgn

10/27/2016

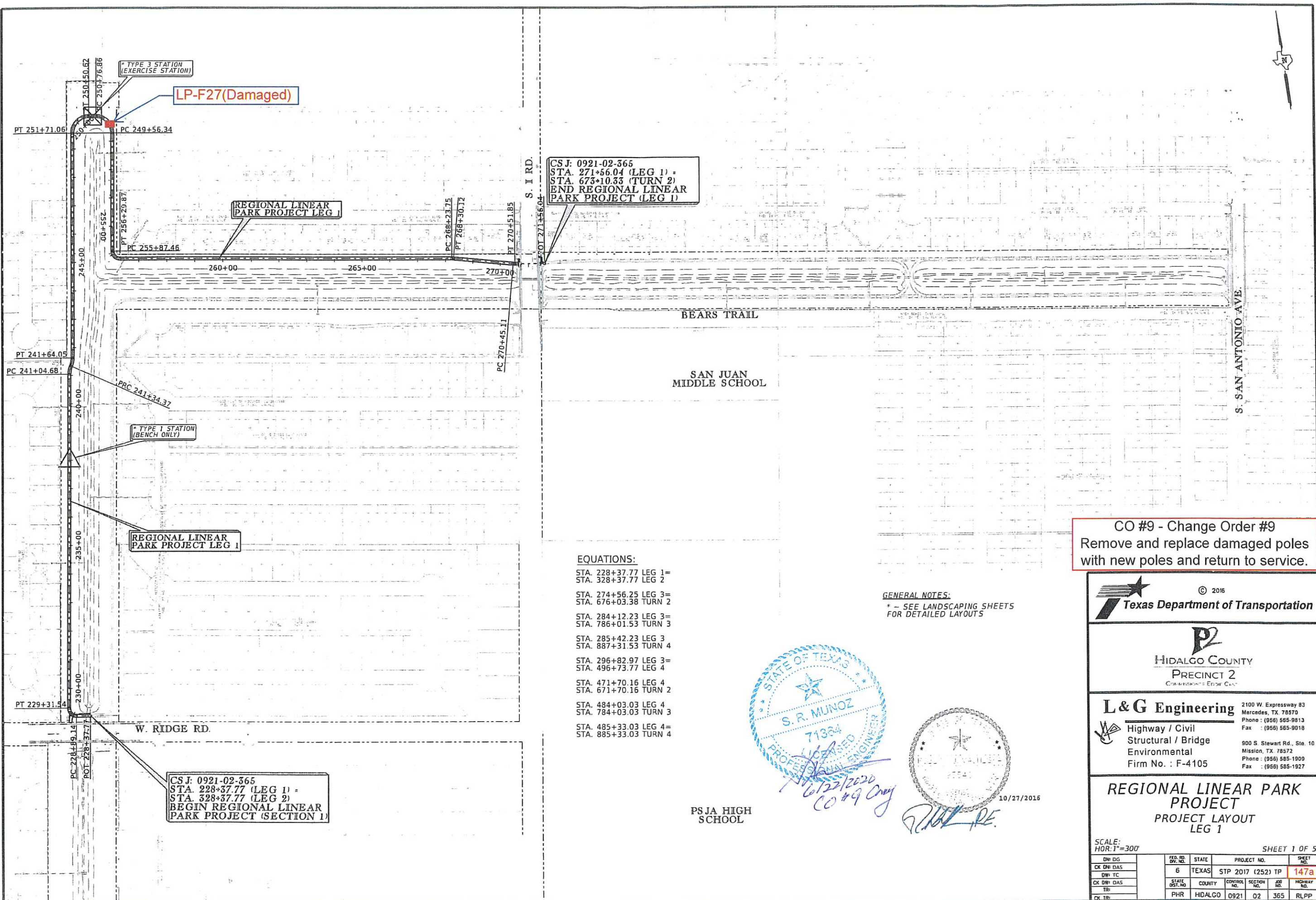

CS J: 0921-02-365
 STA. 271+56.04 (LEG 1) -
 STA. 673+10.33 (TURN 2)
 END REGIONAL LINEAR
 PARK PROJECT (LEG 1)

CS J: 0921-02-365
 STA. 228+37.77 (LEG 1) -
 STA. 328+37.77 (LEG 2)
 BEGIN REGIONAL LINEAR
 PARK PROJECT (SECTION 1)

- EQUATIONS:**
- STA. 228+37.77 LEG 1=
 - STA. 328+37.77 LEG 2
 - STA. 274+56.25 LEG 3=
 - STA. 676+03.38 TURN 2
 - STA. 284+12.23 LEG 3=
 - STA. 786+01.53 TURN 3
 - STA. 285+42.23 LEG 3
 - STA. 887+31.53 TURN 4
 - STA. 296+82.97 LEG 3=
 - STA. 496+73.77 LEG 4
 - STA. 471+70.16 LEG 4
 - STA. 671+70.16 TURN 2
 - STA. 484+03.03 LEG 4
 - STA. 784+03.03 TURN 3
 - STA. 485+33.03 LEG 4=
 - STA. 885+33.03 TURN 4

GENERAL NOTES:
 * - SEE LANDSCAPING SHEETS
 FOR DETAILED LAYOUTS

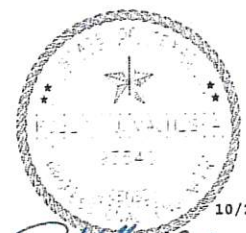

PS JA HIGH SCHOOL

CO #9 - Change Order #9
 Remove and replace damaged poles
 with new poles and return to service.



HIDALGO COUNTY
 PRECINCT 2
 COMMISSIONER ERIC CAST

L & G Engineering
 Highway / Civil
 Structural / Bridge
 Environmental
 Firm No. : F-4105

2100 W. Expressway B3
 Mercedes, TX 78570
 Phone : (956) 565-9813
 Fax : (956) 565-9018

900 S. Stewart Rd., Ste. 10
 Mission, TX 78572
 Phone : (956) 585-1909
 Fax : (956) 585-1927

**REGIONAL LINEAR PARK
 PROJECT
 PROJECT LAYOUT
 LEG 1**

SCALE:
 HOR: 1"=300'

SHEET 1 OF 5

CHKD BY:	DW:	TR:	FED. DIST. NO.:	STATE:	PROJECT NO.:	SHEET NO.:
CKD BY:	DW:	TR:	6	TEXAS	STP 2017 (252) TP	147a
TR:	TR:	TR:	STATE DIST. NO.:	COUNTY:	CONTROL NO.:	JOB NO.:
TR:	TR:	TR:	PHR	HIDALGO	0921 02	365
TR:	TR:	TR:				RLPP

\\192.88.2.192\projects\Cities\Hidalgo\Projects\Bike Project\Linear Park Project\MicroStation Data\01 GENERAL\03 Proj Layout\HMB_PROJ_LAYOUT_LEG2.dgn

10/27/2016

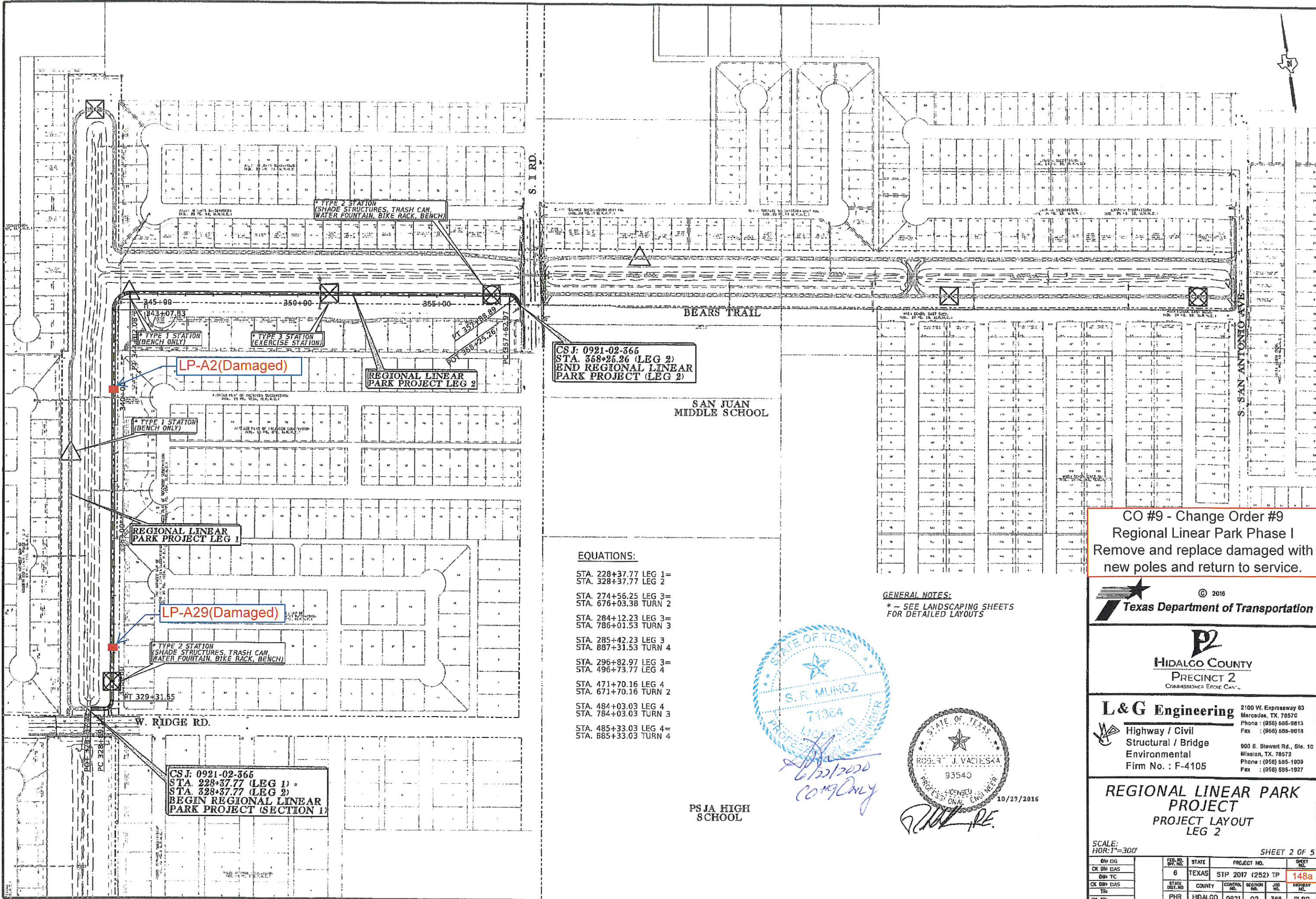

CSJ: 0921-02-366
 STA. 368+26.26 (LEG 2)
 END REGIONAL LINEAR
 PARK PROJECT (LEG 2)

LP-A2(Damaged)

LP-A29(Damaged)

CSJ: 0921-02-366
 STA. 228+37.77 (LEG 1) =
 STA. 328+37.77 (LEG 2)
 BEGIN REGIONAL LINEAR
 PARK PROJECT (SECTION 1)

- EQUATIONS:**
- STA. 228+37.77 LEG 1 =
STA. 328+37.77 LEG 2
 - STA. 274+56.25 LEG 3 =
STA. 676+03.38 TURN 2
 - STA. 284+12.23 LEG 3 =
STA. 786+01.53 TURN 3
 - STA. 285+42.23 LEG 3 =
STA. 887+31.53 TURN 4
 - STA. 296+82.97 LEG 3 =
STA. 496+73.77 LEG 4
 - STA. 471+70.16 LEG 4 =
STA. 671+70.16 TURN 2
 - STA. 484+03.03 LEG 4 =
STA. 784+03.03 TURN 3
 - STA. 485+33.03 LEG 4 =
STA. 885+33.03 TURN 4

GENERAL NOTES:
 * - SEE LANDSCAPING SHEETS
 FOR DETAILED LAYOUTS



PSJA HIGH SCHOOL

CO #9 - Change Order #9
 Regional Linear Park Phase I
 Remove and replace damaged with
 new poles and return to service.

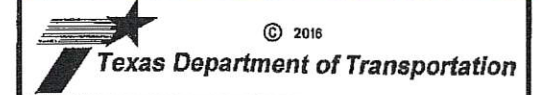

HIDALGO COUNTY
 PRECINCT 2
 COMMISSIONER ERNE CANO

L & G Engineering
 Highway / Civil
 Structural / Bridge
 Environmental
 Firm No. : F-4105

2100 W. Expressway 83
 Mercedes, TX. 78570
 Phone : (956) 696-9813
 Fax : (956) 696-9018

900 S. Stewart Rd., Ste. 10
 Mission, TX. 78572
 Phone : (956) 696-1009
 Fax : (956) 696-1927

**REGIONAL LINEAR PARK
 PROJECT**
 PROJECT LAYOUT
 LEG 2

SCALE:
 HOR: 1"=300'

SHEET 2 OF 5

DN DG	FED. RD.	STATE	PROJECT NO.	SHEET NO.
CK DN DAS	6	TEXAS	STP 2017 (252) TP	148a
DN TC	STATE DIST. NO.	COUNTY	CONTROL NO.	SECTION NO.
CK DN DAS	PHR	HIDALGO	0921	02
TR			365	RLPP
CK TR				

\\192.168.2.192\projects\Councils\HID\Precinct 2\Bike & Bike Project (Linear Park Project)\MicroStation Data\01 GENERAL\03 Proj Layout\HidB_PROJ_LAYOUT_LEG3.dgn

10/27/2016

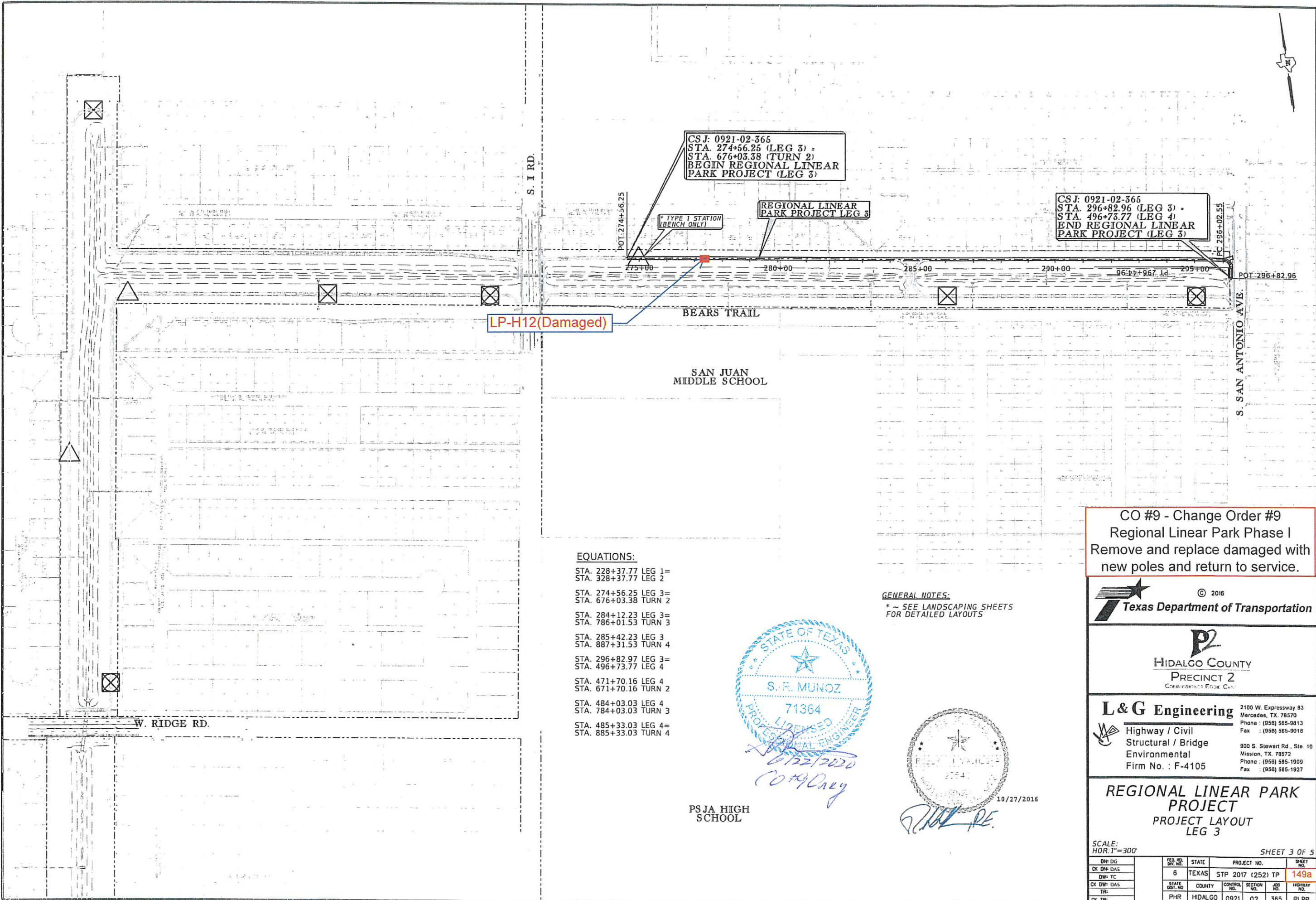

- EQUATIONS:**
- STA. 228+37.77 LEG 1=
 - STA. 328+37.77 LEG 2
 - STA. 274+56.25 LEG 3=
 - STA. 676+03.38 TURN 2
 - STA. 284+12.23 LEG 3=
 - STA. 786+01.53 TURN 3
 - STA. 285+42.23 LEG 3
 - STA. 887+31.53 TURN 4
 - STA. 296+82.97 LEG 3=
 - STA. 496+73.77 LEG 4
 - STA. 471+70.16 LEG 4
 - STA. 671+70.16 TURN 2
 - STA. 484+03.03 LEG 4
 - STA. 784+03.03 TURN 3
 - STA. 485+33.03 LEG 4=
 - STA. 885+33.03 TURN 4

GENERAL NOTES:
 * - SEE LANDSCAPING SHEETS
 FOR DETAILED LAYOUTS



CO #9 - Change Order #9
Regional Linear Park Phase I
 Remove and replace damaged with
 new poles and return to service.



HIDALGO COUNTY
PRECINCT 2
 Commissioners Eric Cantrell

L & G Engineering 2100 W. Expressway 83
 Mercedes, TX. 78570
 Phone : (956) 565-9813
 Fax : (956) 565-9018

Highway / Civil
 Structural / Bridge
 Environmental
 Firm No. : F-4105

900 S. Stewart Rd., Ste. 10
 Mission, TX. 78572
 Phone : (956) 585-1909
 Fax : (956) 585-1927

**REGIONAL LINEAR PARK
 PROJECT**
**PROJECT LAYOUT
 LEG 3**

SCALE:
 HOR: 1"=300'

SHEET 3 OF 5

DW: DG	REV. NO.	STATE	PROJECT NO.	SHEET NO.
CK DW: DAS	6	TEXAS	STP 2017 (252) TP	149a
DW: TC	STATE DIST. NO.	COUNTY	CONTROL NO.	SECTION NO.
CK DW: DAS	PHR	HIDALGO	0921	02
TR:			365	RLPP
CK TR:				

ILLUMINATION QUANTITIES - SHEET TOTALS				
ITEM	DESCR CODE	DESCRIPTION	UNIT	QUANTITIES
				SHEET 1
SS		FURNISH AND INSTALL PHILIPS TOWN GUIDE CLASSIC T (PBDP103-50W64LED 4K-MP-PC-C-LE2) EQ LUMINAIRE FIXTURE AND LUMINAIRE POLE TRADITIONAL CONCRETE INC. D412-SG-EA-3T COMPLETE IN PLACE, INCLUDING ALL COMPONENTS AND FOUNDATION.	EA	32
TXDOT 618	6023	CONDT (PVC) (SCH 40) (2")	LF	1,240
TXDOT 620	6003	ELEC CONDR (NO.12) BARE	LF	1,720
TXDOT 684	6009	TRF SIG CBL (TY A) (12 AWG) (4 CONDR)	LF	1,720
TXDOT 624	6002	GROUND BOX TY A (122311) W/APRON	EA	6
TXDOT 628	6009	ELC SRV TY A 120/240 060 (NS) SS (E) SP (O)	EA	

- NOTES:**
1. THE CONTRACTOR SHALL COORDINATE WITH UTILITY COMPANIES TO VERIFY THE LOCATION OF EXISTING UTILITIES PRIOR TO CONSTRUCTION TO AVOID CONFLICT WITH OR DAMAGE TO THESE UTILITIES.
 2. ALL STATIONS AND OFFSETS ARE WITH REFERENCE TO THE CENTERLINE CLOSEST TO THE RESPECTIVE LUMINAIRE.
 3. ALL LUMINAIRES ALONG STRAIGHT PORTIONS OF THE TRACK ARE TO BE PLACED AT A SPACING OF 40', AN OFFSET OF 4' FROM THE EDGE OF THE TRACK AND ORIENTED PERPENDICULAR TO THE PATHWAY.
 4. THE STATIONS, OFFSETS AND ORIENTATIONS FOR ONLY THOSE LUMINAIRES THAT ARE NON TYPICAL HAVE BEEN LISTED IN THE TABLE.
 5. CONDUIT RUNS ARE HORIZONTAL ONLY.
 6. CONDUCTOR RUNS ARE BOTH HORIZONTAL AND VERTICAL.

LOCATION & ORIENTATION TABLE			
LUM ID	STA.	OFFSET	*ORIENTATION
LP-D23	229+47.41	8.04' LT	3.45° CW
LP-D24	229+21.99	7.67' LT	10.47° CCW
LP-D25	228+95.14	7.92' LT	13.96° CCW
LP-D26	228+56.70	7.98' LT	0.25° CW
LP-D27	328+58.87	7.92' RT	0.25° CW
LP-D28	328+96.71	7.98' RT	15.57° CW
LP-D29	329+22.54	8.88' RT	10.22° CW
LP-D30	329+47.83	8.44' RT	0.57° CW

*ORIENTATION IS MEASURED FROM A PERPENDICULAR LINE TO THE PATHWAY.
 CW - CLOCKWISE
 CCW - COUNTER CLOCKWISE

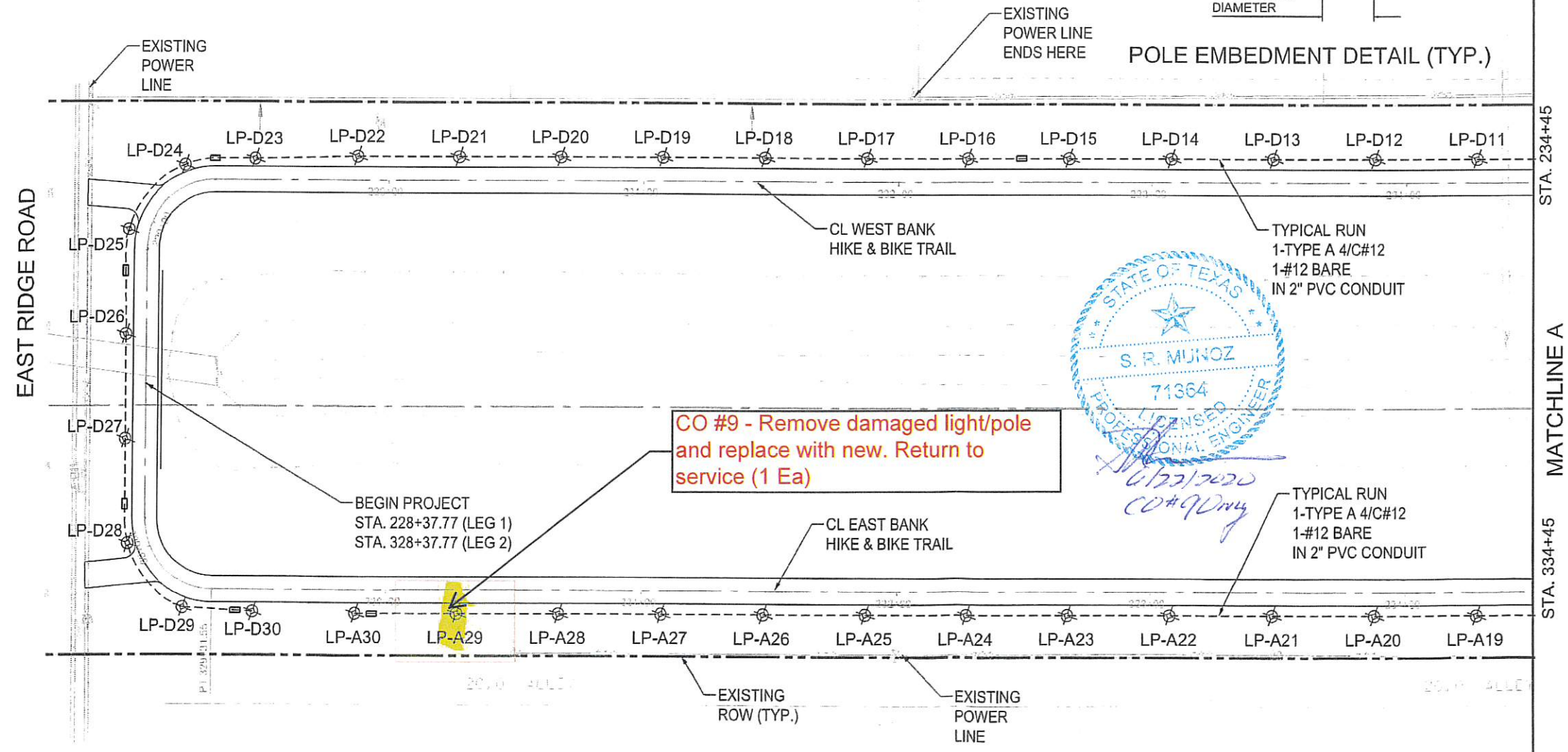
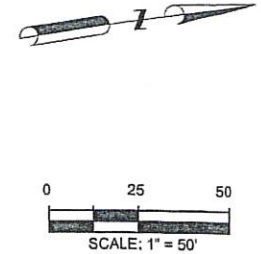
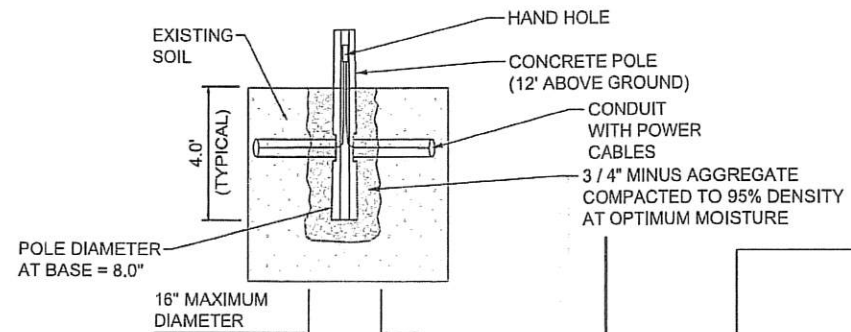

HIDALGO COUNTY
 PRECINCT 2
 COMMISSIONER EDDIE CANTU

[Signature]
 C. SIMEONIDIS
 60919
 REGISTERED PROFESSIONAL ENGINEER

6/5/2017

L&G Engineering
 Highway / Civil
 Structural / Bridge
 Environmental
 Firm No. : F-4105

2108 W. Expressway 83
 Mercedes, TX 78070
 Phone : (956) 565-9813
 Fax : (956) 565-9818

908 S. Stewart Rd., Ste. 10
 Mission, TX 78572
 Phone : (956) 385-1909
 Fax : (956) 385-1927

ETSI
 Ergonomic Transportation Solutions, Inc.
 TEXAS REGISTERED ENGINEERING FIRM NO. F - 020625

5300 Hollister Road, Suite 220
 Houston, Texas 77040
 Tel. (713) 956-9601 Fax (713) 956-9667

Texas Department of Transportation

REGIONAL LINEAR PARK PROJECT
 LIGHTING LAYOUT
 EAST RIDGE ROAD
 TO MATCHLINE A

SHEET 1 OF 11	
MNR	CONTR
RLM	SECT
HCS	JOB
	HIGHWAY
	DIST
	COUNTY
	SHEET NO.

ILLUMINATION QUANTITIES - SHEET TOTALS				
ITEM	DESCR CODE	DESCRIPTION	UNIT	SHEET 3
HC002	6001	FURNISH AND INSTALL PHILIPS TOWN GUIDE CLASSIC T (PBDP103-50W64LED 4K-MP-PC-C-LE2) EQ LUMINAIRE FIXTURE AND LUMINAIRE POLE TRADITIONAL CONCRETE INC. D412-SG-EA-3T COMPLETE IN PLACE, INCLUDING ALL COMPONENTS AND FOUNDATION.	EA	28
618	6023	CONDT (PVC) (SCH 40) (2")	LF	1,158
620	6003	ELEC CONDR (NO.12) BARE	LF	1,578
684	6009	TRF SIG CBL (TY A) (12 AWG) (4 CONDR)	LF	1,578
624	6002	GROUND BOX TY A (122311) W/APRON	EA	8
628	6009	ELC SRV TY A 120/240 060 (NS) SS (E) SP (O)	EA	1

LOCATION & ORIENTATION TABLE

LUM ID	STA.	OFFSET	ORIENTATION
LP-C5	240+27.71	8.35' LT	0.0°
LP-C6	240+67.58	7.97' LT	13.10° CW
LP-C7	241+07.76	8.50' LT	1.23° CCW
LP-C8	241+47.09	8.46' LT	7.98° CCW
LP-C9	241+89.22	8.65' LT	2.16° CCW
LP-B3	342+67.47	7.91' RT	1.00° CW
LP-B4	343+07.45	8.41' RT	1.00° CW
LP-B5	343+43.05	7.98' LT	8.35° CW
LP-B6	343+77.47	8.05' LT	4.19° CCW
LP-B7	344+15.81	8.38' RT	0.78° CCW
LP-F14	256+35.08	8.93' RT	7.57° CW
LP-F15	256+01.52	9.07' LT	0.75° CCW

*ORIENTATION IS MEASURED FROM A PERPENDICULAR LINE TO THE PATHWAY.
 CW - CLOCKWISE
 CCW - COUNTER CLOCKWISE

NOTES:

1. THE CONTRACTOR SHALL COORDINATE WITH UTILITY COMPANIES TO VERIFY THE LOCATION OF EXISTING UTILITIES PRIOR TO CONSTRUCTION TO AVOID CONFLICT WITH OR DAMAGE TO THESE UTILITIES.
2. ALL STATIONS AND OFFSETS ARE WITH REFERENCE TO THE CENTERLINE CLOSEST TO THE RESPECTIVE LUMINAIRE.
3. ALL LUMINAIRES ALONG STRAIGHT PORTIONS OF THE TRACK ARE TO BE PLACED AT A SPACING OF 40', AN OFFSET OF 4' FROM THE EDGE OF THE TRACK AND ORIENTED PERPENDICULAR TO THE PATHWAY.
4. THE STATIONS, OFFSETS AND ORIENTATIONS FOR ONLY THOSE LUMINAIRES THAT ARE NON TYPICAL HAVE BEEN LISTED IN THE TABLE.
5. CONDUIT RUNS ARE HORIZONTAL ONLY.
6. CONDUCTOR RUNS ARE BOTH HORIZONTAL AND VERTICAL.

LEGEND

- PROPOSED GROUND BOX TYPE A
- PROPOSED OCTAGONAL CONCRETE POLE WITH "PHILIPS TOWN GUIDE CLASSIC T" FIXTURE OR EQUAL
- PROP. ELECTRICAL SERVICE (METERED) TY A 120/240 060 (NS) SS (E) SP (O)
- PROPOSED 2" (SCH 40) PVC CONDUIT
- PROPOSED 2" (SCH 80) PVC CONDUIT BORE

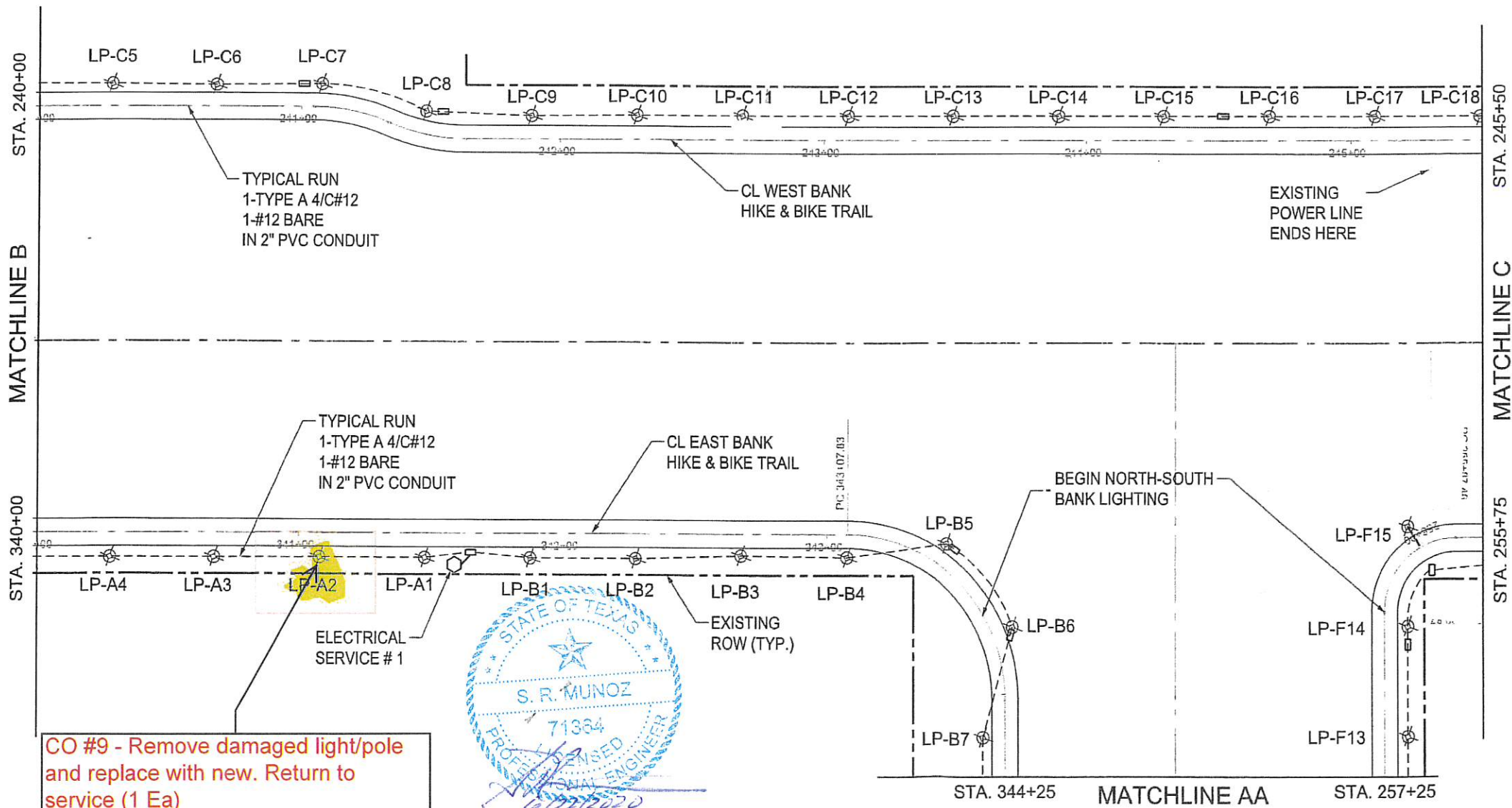
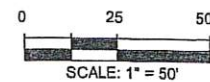

HIDALGO COUNTY
PRECINCT 2
COMMISSIONER EDDIE CARR

10/26/2016

L&G Engineering 2100 W. Expressway 83
Mercedes, TX. 78570
Phone : (956) 565-9813
Fax : (956) 565-9018

Highway / Civil
Structural / Bridge
Environmental
Firm No. : F-4105

900 S. Stewart Rd., Ste. 10
Mission, TX. 78572
Phone : (956) 565-1909
Fax : (956) 565-1927

ETSI 5300 Hollister Road, Suite 220
Houston, Texas 77040
Tel. (713) 956-9601 Fax (713) 956-9667

Ergonomic Transportation Solutions, Inc.
Texas Registered Engineering Firm No. F-000625

2016
Texas Department of Transportation

REGIONAL LINEAR PARK PROJECT
LIGHTING LAYOUT
MATCHLINE B TO C

SHEET 3 OF 11

MNR	CONTR	SECT	JOB	HIGHWAY
RLM	0921	02	365	RLPP
HCS	DIST	COUNTY	SHEET NO.	
	PHR	HIDALGO	151a	

DATE: 10/26/2016 10:39:12 AM
FILE: N:\CLIENTS\I&G\HIKE_BIKE\ETSI_WORKLAYOUTS\LP_3.dgn

ILLUMINATION QUANTITIES - SHEET TOTALS				
ITEM	DESCR CODE	DESCRIPTION	UNIT	SHEET 4
HC002	6001	FURNISH AND INSTALL PHILIPS TOWN GUIDE CLASSIC T (PBDP103-50W64LED 4K-MP-PC-C-LE2) EQ LUMINAIRE FIXTURE AND LUMINAIRE POLE TRADITIONAL CONCRETE INC. D412-SG-EA-3T COMPLETE IN PLACE, INCLUDING ALL COMPONENTS AND FOUNDATION.	EA	27
618	6023	CONDT (PVC) (SCH 40) (2")	LF	1,033
620	6003	ELEC CONDR (NO.12) BARE	LF	1,438
684	6009	TRF SIG CBL (TY A) (12 AWG) (4 CONDR)	LF	1,438
624	6002	GROUND BOX TY A (122311) W/APRON	EA	4
628	6009	ELC SRV TY A 120/240 060 (NS) SS (E) SP (O)	EA	

LOCATION & ORIENTATION TABLE

LUM ID	STA.	OFFSET	ORIENTATION
LP-C27	249+09.38	8.65' LT	1.21° CW
LP-C28	249+49.13	8.59' LT	1.21° CW
LP-C29	249+75.36	8.75' LT	5.44° CW
LP-C30	250+06.77	8.30' LT	2.21° CW
LP-F16	255+65.53	9.02' LT	2.74° CCW
LP-F25	252+05.43	8.07' LT	1.96° CCW
LP-F26	251+66.27	9.00' LT	0.77° CCW
LP-F27	251+35.78	8.60' LT	6.16° CW
LP-F28	251+04.07	8.31' LT	5.42° CW
LP-F29	250+76.81	9.09' LT	1.26° CW
LP-F30	250+38.24	8.42' LT	4.39° CW

*ORIENTATION IS MEASURED FROM A PERPENDICULAR LINE TO THE PATHWAY.
 CW - CLOCKWISE
 CCW - COUNTER CLOCKWISE

NOTES:

1. THE CONTRACTOR SHALL COORDINATE WITH UTILITY COMPANIES TO VERIFY THE LOCATION OF EXISTING UTILITIES PRIOR TO CONSTRUCTION TO AVOID CONFLICT WITH OR DAMAGE TO THESE UTILITIES.
2. ALL STATIONS AND OFFSETS ARE WITH REFERENCE TO THE CENTERLINE CLOSEST TO THE RESPECTIVE LUMINAIRE.
3. ALL LUMINAIRES ALONG STRAIGHT PORTIONS OF THE TRACK ARE TO BE PLACED AT A SPACING OF 40', AN OFFSET OF 4' FROM THE EDGE OF THE TRACK AND ORIENTED PERPENDICULAR TO THE PATHWAY.
4. THE STATIONS, OFFSETS AND ORIENTATIONS FOR ONLY THOSE LUMINAIRES THAT ARE NON TYPICAL HAVE BEEN LISTED IN THE TABLE.
5. CONDUIT RUNS ARE HORIZONTAL ONLY.
6. CONDUCTOR RUNS ARE BOTH HORIZONTAL AND VERTICAL.

LEGEND

- PROPOSED GROUND BOX TYPE A
- PROPOSED OCTAGONAL CONCRETE POLE WITH "PHILIPS TOWN GUIDE CLASSIC T" FIXTURE OR EQUAL
- PROP. ELECTRICAL SERVICE (METERED) TY A 120/240 060 (NS) SS (E) SP (O)
- PROPOSED 2" (SCH 40) PVC CONDUIT
- PROPOSED 2" (SCH 80) PVC CONDUIT BORE

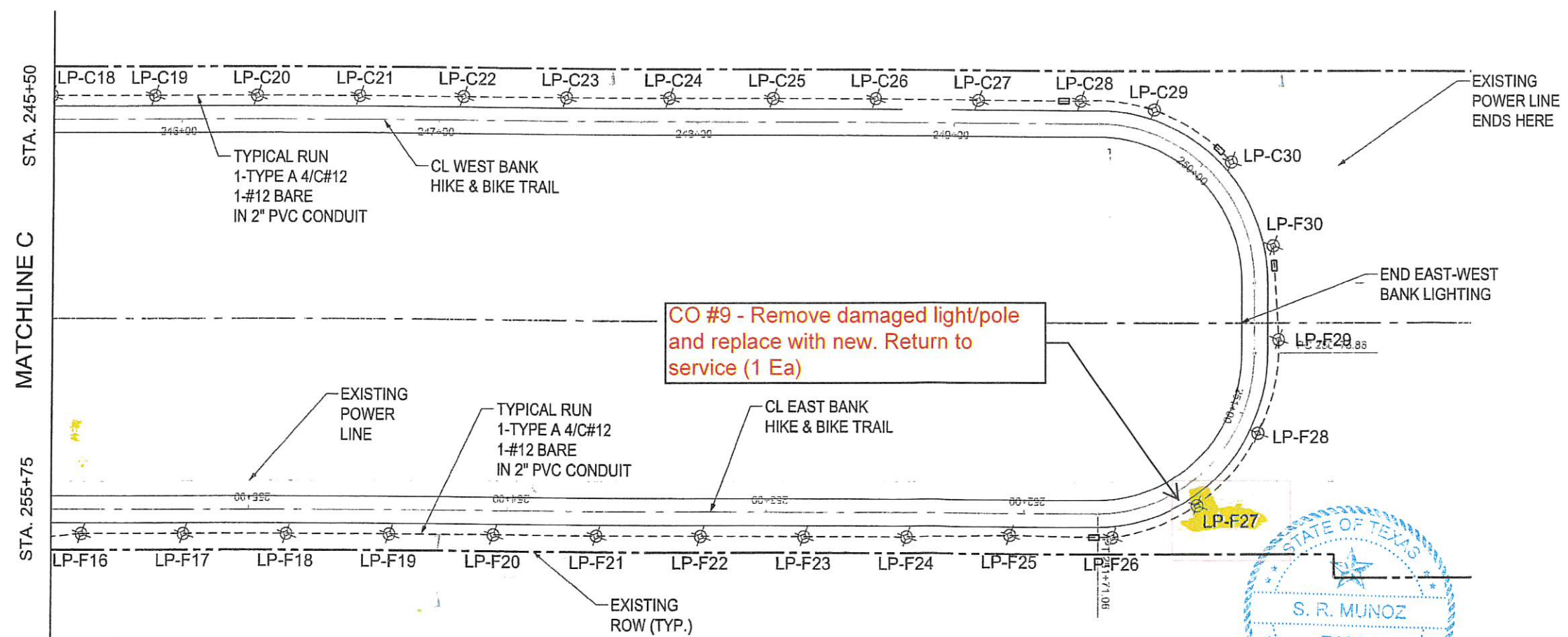
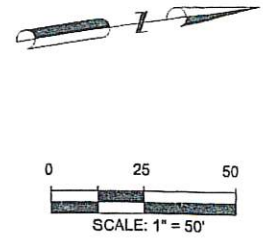

HIDALGO COUNTY
PRECINCT 2
 County of Hidalgo, Texas

10/26/2016

L&G Engineering 2100 W. Expressway 33
 Mercedes, TX. 78570
 Phone : (956) 365-9813
 Fax : (956) 365-9018

Highway / Civil
 Structural / Bridge
 Environmental
 Firm No. : F-4105

900 S. Stewart Rd., Ste. 10
 Mission, TX. 78572
 Phone : (956) 385-1909
 Fax : (956) 385-1927

ETSI 5300 Hollister Road, Suite 220
 Houston, Texas 77040
 Tel. (713) 956-9601 Fax (713) 956-9667

Ergonomic Transportation Solutions, Inc.
 Texas Registered Engineering Firm No. F-000625

© 2015
Texas Department of Transportation

REGIONAL LINEAR PARK PROJECT
 LIGHTING LAYOUT
 MATCHLINE C

SHEET 4 OF 11

CONTRACT NO.	MNR	CONTRACT	SECTION	JOB	HIGHWAY
	RLM	0921	02	365	RLPP
CLIENT	HCS	DISTRICT	COUNTY	CITY	SHEET NO.
		PHR	HIDALGO		152a

DATE: 10/26/2016 10:39:44 AM
 FILE: N:\CLIENTS\L&G\HIKE_BIKE\ETSI_WORK\LAYO\SLP_4.dgn

S. R. MUNOZ
 71364
 LICENSED PROFESSIONAL ENGINEER

CO #9 Only

ILLUMINATION QUANTITIES - SHEET TOTALS				
ITEM	DESCR CODE	DESCRIPTION	UNIT	SHEET 8
HC002	6001	FURNISH AND INSTALL PHILIPS TOWN GUIDE CLASSIC T (PBDP103-50W64LED 4K-MP-PC-C-LE2) EQ LUMINAIRE FIXTURE AND LUMINAIRE POLE TRADITIONAL CONCRETE INC. D412-SG-EA-3T COMPLETE IN PLACE, INCLUDING ALL COMPONENTS AND FOUNDATION.	EA	28
618	6023	CONDT (PVC) (SCH 40) (2")	LF	1,100
620	6003	ELEC CONDR (NO.12) BARE	LF	1,520
684	6009	TRF SIG CBL (TY A) (12 AWG) (4 CONDR)	LF	1,520
624	6002	GROUND BOX TY A (122311) W/APRON	EA	4
628	6009	ELC SRV TY A 120/240 060 (NS) SS (E) SP (O)	EA	

NOTES:

1. THE CONTRACTOR SHALL COORDINATE WITH UTILITY COMPANIES TO VERIFY THE LOCATION OF EXISTING UTILITIES PRIOR TO CONSTRUCTION TO AVOID CONFLICT WITH OR DAMAGE TO THESE UTILITIES.
2. ALL STATIONS AND OFFSETS ARE WITH REFERENCE TO THE CENTERLINE CLOSEST TO THE RESPECTIVE LUMINAIRE.
3. ALL LUMINAIRES ALONG STRAIGHT PORTIONS OF THE TRACK ARE TO BE PLACED AT A SPACING OF 40', AN OFFSET OF 4' FROM THE EDGE OF THE TRACK AND ORIENTED PERPENDICULAR TO THE PATHWAY.
4. THE STATIONS, OFFSETS AND ORIENTATIONS FOR ONLY THOSE LUMINAIRES THAT ARE NON TYPICAL HAVE BEEN LISTED IN THE TABLE.
5. CONDUIT RUNS ARE HORIZONTAL ONLY.
6. CONDUCTOR RUNS ARE BOTH HORIZONTAL AND VERTICAL.



LEGEND

- PROPOSED GROUND BOX TYPE A
- PROPOSED OCTAGONAL CONCRETE POLE WITH "PHILIPS TOWN GUIDE CLASSIC T" FIXTURE OR EQUAL
- PROP. ELECTRICAL SERVICE (METERED) TY A 120/240 060 (NS) SS (E) SP (O)
- PROPOSED 2" (SCH 40) PVC CONDUIT
- PROPOSED 2" (SCH 80) PVC CONDUIT BORE

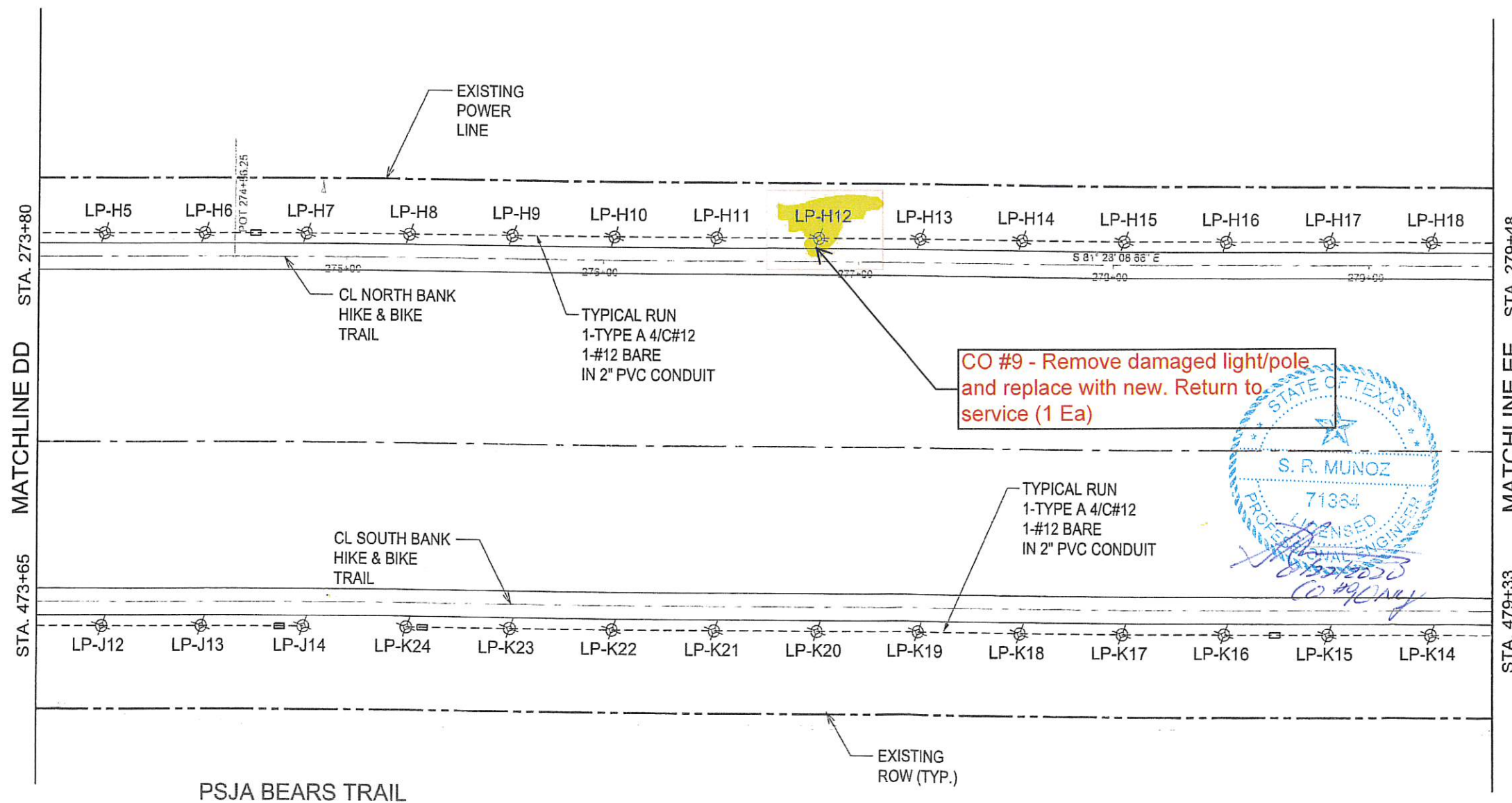
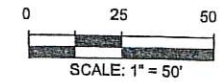

HIDALGO COUNTY
PRECINCT 2
Commissioned Board County

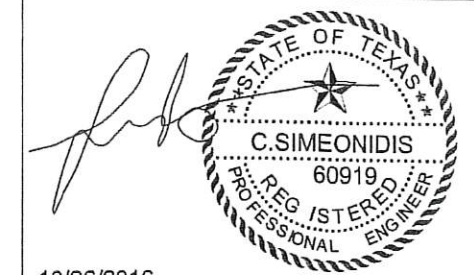

10/26/2016
L&G Engineering
2100 W. Expressway 83
Mercedes, TX. 78370
Phone : (956) 565-9813
Fax : (956) 565-9015
Highway / Civil
Structural / Bridge
Environmental
Firm No. : F-4105
900 S. Stewart Rd., Ste. 10
Mission, TX. 78372
Phone : (956) 585-1909
Fax : (956) 585-1927

ETSI
5300 Hollister Road, Suite 220
Houston, Texas 77040
Tel. (713) 956-9601 Fax (713) 956-9667
Ergonomic Transportation Solutions, Inc.
Texas Registered Engineering Firm No. F-000625

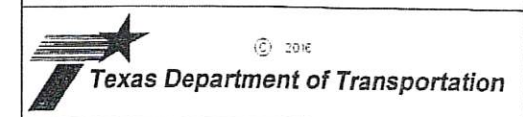

REGIONAL LINEAR PARK PROJECT
LIGHTING LAYOUT
MATCHLINE DD TO EE

SHEET 8 OF 11				
CK DR:	MNR	CCNT	SECT	JOB
	RLM	0921	02	365
CK DW:	HCS	DIST	COUNTY	RLPP
		PHR	HIDALGO	
CK TR:				SHEET NO. 153a

DATE: 10/26/2016 10:42:08 AM
FILE: N:\CLIENTS\L&G\HIKE_BIKE\ETSI_WORKLAYOUTS\LP_8.dgn

AUSTIN TRAFFIC SIGNAL CONSTRUCTION COMPANY, INC.

P.O. Box 130
Round Rock, Texas 78680

Ph. (512) 255-9951
Fax (512) 255-0146

MAR 30,2020

PROPOSAL

CONTROL :
PROJECT: HIKE AND BIKE
HIGHWAY: HALL ACRES
COUNTY: HIDALGO

Item No.	Item-code	Desc. Code	Bid Item Description	Unit of Measure	Approx. Quantities	Unit Bid Price	Amount
690			REPLACE DAMAGE CONCRETE POLES	EA	4	\$5,700.00	\$22,800.00
690			ADDITIONAL CONCRETE POLES MATERIAL ONLY	EA	8	\$3,280.00	\$26,240.00
Total Bid Amount							\$49,040.00

\$54,740.00

\$28,500.00

NOTES:

- 1) 1ST ITEMS ORIGINAL BID PRICE
- 2) 2ND ITEM IS TO DELIVER MATERIAL ONLY

CONTACT Steve Rutledge for any questions at 956-239-1615

shall be established by dividing the actual invoice cost by the actual number of hours the equipment is involved in the Work. Owner reserves the right to limit the hourly rate to comparable Blue Book rates. When the invoice specifies the rental rate does not include fuel, lubricants, repairs and servicing, the Blue Book hourly operating cost shall be allowed to be added for each hour the equipment operates. The allowable equipment hourly rates shall be paid for each hour the equipment is involved in the Work and an additional maximum of fifteen percent (15%) may be added as compensation.

8.2.4.3. When the invoice specifies equipment operators as a component of the equipment rental, payment will be made at the invoice rate for each operator for each day the equipment is needed for the work.

8.2.4.4. **Standby Equipment Costs.**

Contractor shall be entitled to standby costs only when directed to standby in writing by Owner. Standby costs may include actual documented Project overhead costs of Contractor, consisting of administrative and supervisory expenses incurred at the Project Site. Standby equipment costs shall not be allowed during periods when the equipment would otherwise have been idle.

8.2.4.4.1. **Contractor-Owned Equipment.** For Contractor-owned machinery, trucks, power tools, or other equipment:

- Standby will be paid at 50% (to remove operating cost) of the FHWA rental rates found in the *Rental Rate Blue Book* multiplied by the regional adjustment factor and the rate adjustment factor.
- Standby costs will not be allowed during periods when the equipment would have otherwise been idle.

8.2.4.4.2. **Equipment Not Owned by the Contractor.** For equipment rented from a third party not owned by the Contractor:

- Standby will be paid at the invoice daily rental rate, excluding operating cost, which includes fuel, lubricants, repairs, and servicing. Owner reserves the right to limit the daily standby rate to comparable FHWA rental rates found in the *Rental Rate Blue Book* multiplied by the regional adjustment factor and the rate adjustment factor.
- Standby will be paid for equipment operators when included on the invoice and equipment operators are actually on standby.
- Standby costs will not be allowed during periods when the equipment would have otherwise been idle.

8.2.5. **Subcontracting.** Contractor shall be allowed administrative cost only when extra Work, ordered by Owner, is performed by a Subcontractor or Subcontractors. The maximum allowable payment for administrative cost shall not exceed five percent (5%) of the total Subcontractor work.

8.2.6. **Law Enforcement.** Off-duty peace officers and patrol cruisers shall be considered as Subcontractors, with regard to consideration of allowable contractor markups.

8.2.7. **Railroad Flaggers.** An additional 5% of the actual invoice cost will be paid as compensation for administrative cost, superintendence, and profit.

8.2.8. **Bond Cost.** The actual cost of the Contractor's bond on the extra work will be paid. No charge for superintendence will be made unless considered necessary and ordered by Owner.

9. **RETAINAGE**

Owner will withhold retainage on the Contractor. The Contractor may withhold retainage on subcontractors in accordance with state and federal regulations.

10. **PAYMENT PROVISIONS FOR SUBCONTRACTORS**

For the purposes of this Article only, the term subcontractor includes suppliers and the term work includes materials provided by suppliers at a location approved by Owner.

These requirements apply to all tiers of subcontractors. Incorporate the provisions of this Article into all subcontract or material purchase agreements.

10.1. Contractor shall, within ten (10) calendar days following receipt of payment from Owner, pay all bills for labor and materials performed and furnished by others in connection with the construction, furnishing and equipping of the improvements and the performance of the work, and shall, if requested, provide Owner with written evidence of such payment. Contractor's failure to make payments or provide written evidence of such payments within such time shall constitute a material breach of this contract, unless Contractor is able to demonstrate to Owner bona fide disputes associated with the unpaid Subcontractor(s) or supplier(s) and its/their work. Contractor shall include a provision in each of its subcontracts imposing the same written documentation of payment obligations on its Subcontractors as are applicable to Contractor hereunder, and if Owner so requests, shall provide copies of such Subcontractor payments to Owner. If Contractor has failed to make payment promptly to Contractor's Subcontractors or for materials or labor used in the Work for which Owner has made payment to the Contractor, Owner shall be entitled to withhold payment to Contractor to the extent necessary to protect Owner.

10.2. Owner shall, if practicable and upon request, furnish to Subcontractor information regarding percentages of completion or amounts applied for by Contractor and action taken thereon by Owner on account of portions of the Work done by such Subcontractor.

10.3. Neither Owner nor Engineer shall have an obligation to pay or to see to the payment of money to a Subcontractor, except as may otherwise be required by law, if any.

10.4. Payments to material suppliers shall be treated in a manner similar to that provided in Section 9L.5.3.2, Section 9L.5.3.3 and Section 9L.9.1 herein regarding Subcontractors.

Completed subcontractor work includes vegetative establishment, test, maintenance, performance, and other similar responsibilities of the subcontractor.