

CONTRACT ALLOWANCE EXPENDITURE APPROVAL (CAEA)

PROJECT: Hidalgo County Courthouse



HIDALGO COUNTY
TEXAS



CAEA Approval Form

To be completed separately for allowance expenditure within the construction contract

Contractor: MORGANTI **PM Firm:** JACOBS **Date:** 2021-12-20

CAEA	48
-------------	-----------

Reason for Change:

- Contract Document Error or Omission
- Unknown / Unforeseen Conditions
- Owner Requested Change
- Other (specify) _____

Description of Change:

CAEA-48 - CPR 51 Exterior Handrails

Original Contract Allowance Amount per Contract =	\$ 402,669	A
Total of previously Approved CAEAs =	\$ 273,237	B
Total Amount (for this allowance) =	\$ 88,269	C
Remaining of Contract Allowance =	\$ 41,163	D = A - (B + C)

Prepared by:

Robert Gonzalez *Robert Gonzalez* 12/20/21
 Name Signature Date
Morganti
 Title: Project Manager

Reviewed by:

John Niesen _____ _____
 Name Signature Date
HDR
 Title: Project Manager

Oscar Garcia _____ _____
 Name Signature Date
JACOBS
 Title: Project Manager

Approval by the Owner will constitute authorization to proceed with this change.

Approved by:		
V	I	
S	A	
Hidalgo County	Signature	Date
Title: VISA		

Note - All applicable supporting documentation (including price proposal) needs to be attached.



December 20, 2021

Jacobs

Change Order CPR 51 Exterior Handrails adds (9) lighted handrails with associated electrical.

Dear Mr. Garcia,

Listed below is the additional scope of work along with associated labor and materials to complete the work.

Description	Amount
Metro	\$ 91,930.00
Credit for Steel Handrail	\$ (5,000.00)
<hr/>	
Clarifications:	Sub-Total \$ 86,930
	Bond \$ -
	Builder's Risk \$ -
Refer to Sheet:	CCIP \$ -
	SDI \$ 1,339
	Permit \$ -
Specs:	Fee \$ -
	Sales Tax
	Total \$ 88,269

This proposal will expire 15 days from date of original submission.
Any delay in approval will result in project delays & additional costs.

Sincerely,

Robert Gonzalez

By signing this proposal, I agree to the change in scope and contract amount.

By: _____ Date: _____

Jacobs



METRO ELECTRIC, INC.

TECL #17140

Main Office
1901 Industrial Dr.
McAllen, TX 78504
956.686.2323

Branch Office
5255 Commercial Dr.
Brownsville, TX 78523
956.831.7801

www.metroelectric-rgv.com

Morganti Texas, Inc.
112 E. Cano St.
Edinburg, TX 78539

Attention: Mr. Robert Gonzalez

Reference: Hidalgo County Courthouse
Metro CPR 82
MTI CPR 51

Gentlemen,

We submit the add sum for the scope of work detailed below in the amount of:

Ninety One Thousand Nine Hundred Thirty Dollars (\$91,930.00)

Conduit and wire for nine (9) Cole LED Lit Handrails.

Note: Handrails cannot be released based on the sketch RFI 542 SK2 per Cole's terms and conditions. Field measurements along with photographs of site conditions when measurements are taken are required.

We will not proceed with this additional work until your written change order is received.

Sincerely,
Metro Electric, Inc.

Stewart P. Gregorie

Stewart P. Gregorie
Sr. Project Manager

Cc: Andrew Munoz
Alejandra Icazbalceta
Job File 3419

Metro Electric, Inc., TECL #17140

Regulated by The Texas Department of Licensing and Regulation, P.O. Box 12157, Austin, Texas 78711, +1 (800)
803-9202, +1 (512) 463-6599;

website: <https://www.license.state.tx.us/complaints>.



Change Price Request

Project Name:	Hidalgo County Texas - NEW COURTHOUSE Main Building Package	CPR Number:	51
Project Number:	10085982		
Regarding:	Exterior Handrails	Date:	June 22, 2021

Description of Change:
These documents are issued to supplement the response to RFI 542.

The revisions can be summarized as follows:

REVISIONS TO SPECIFICATIONS

*** NONE ***

REVISIONS TO DRAWINGS

Architectural:

1. Sheet RFI 542 SK2
 - a. ADD sheet in its entirety.

Electrical:

2. Sheet E-101
 - a. ADD electrical to handrail locations.

END OF CPR #51

All Work shall be in accordance with the terms, stipulations and conditions of original Contract Documents.

Amount: \$ **Time Change (Calendar Days):**

Construction Mgr / Contractor:	By:	Date:	
Morganti Texas, Inc.			
Architect/Engineer:	By:	Date:	Recommendation:
HDR Architecture, Inc.			
Owner:	By:	Date:	Action:
County of Hidalgo Texas			[] Approved [] Rejected

The Contractor is directed to make changes indicated above for the proposed amount and time after Owner approval.
If allowed by the Contract Documents, this document is considered a fully executed Change Order after Owner approval.

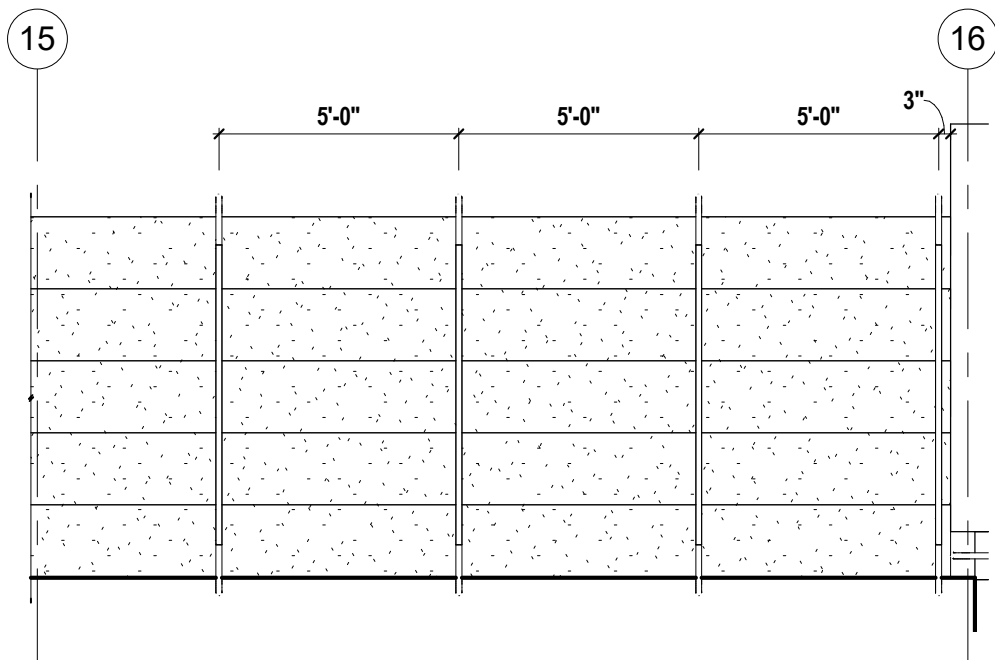

1 TYPICAL EXTERNAL STAIR PLAN
 1/4" = 1'-0"

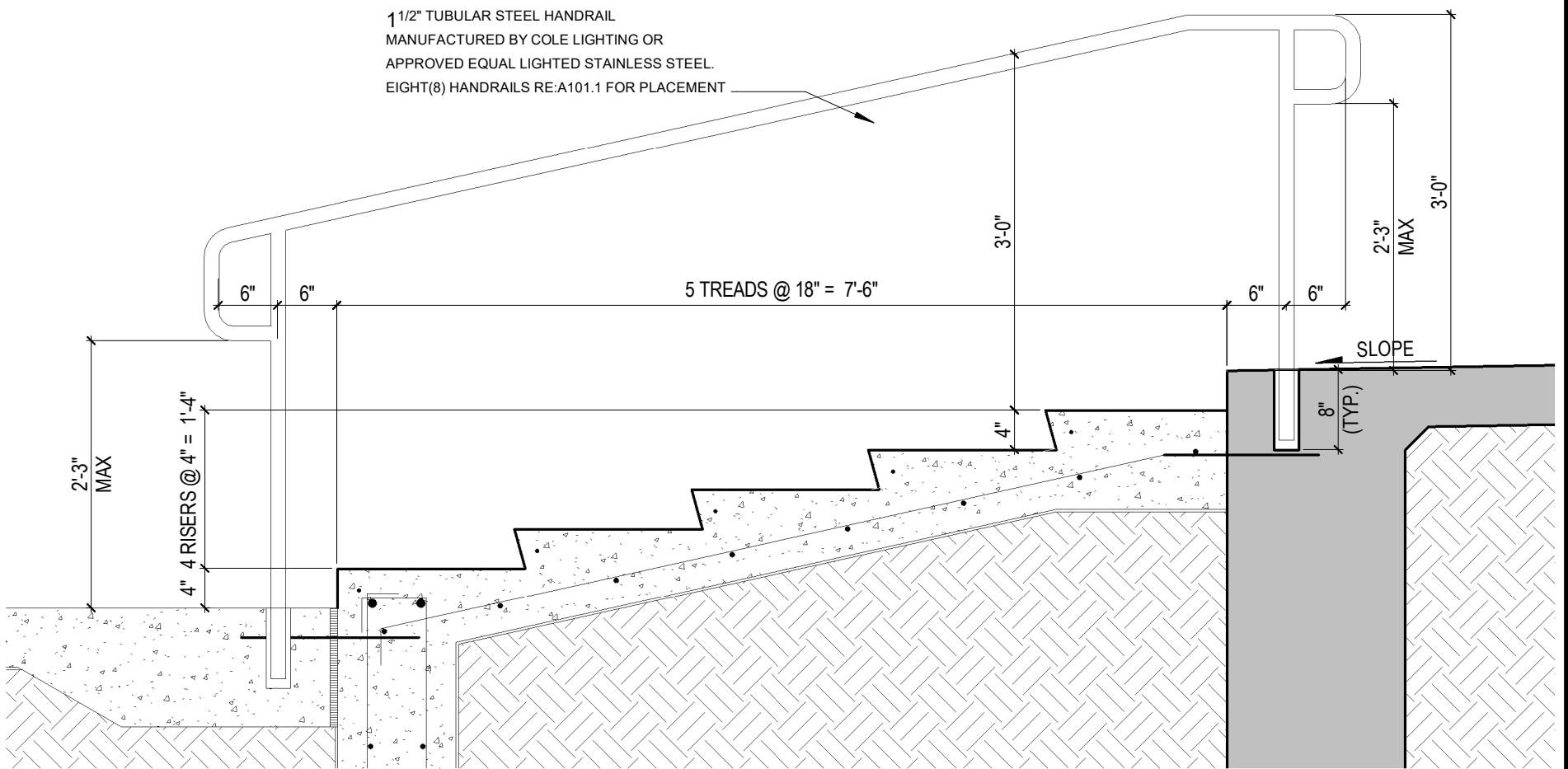

RE: D2/C501 FOR ADDITIONAL HANDRAIL INFORMATION

2 TYP. EXTERIOR STAIR SECTION
 3/4" = 1'-0"



300 S. 8th Street
 McAllen, Texas
 78501
 956.661.0400
 www.goERO.com

Sheet Title:		RFI 542 EXHIBIT	
Project Name:		NEW COUNTY COURTHOUSE	
Project No.:	DATE:	RFI 542 SK2	
10085982	06/22/21		

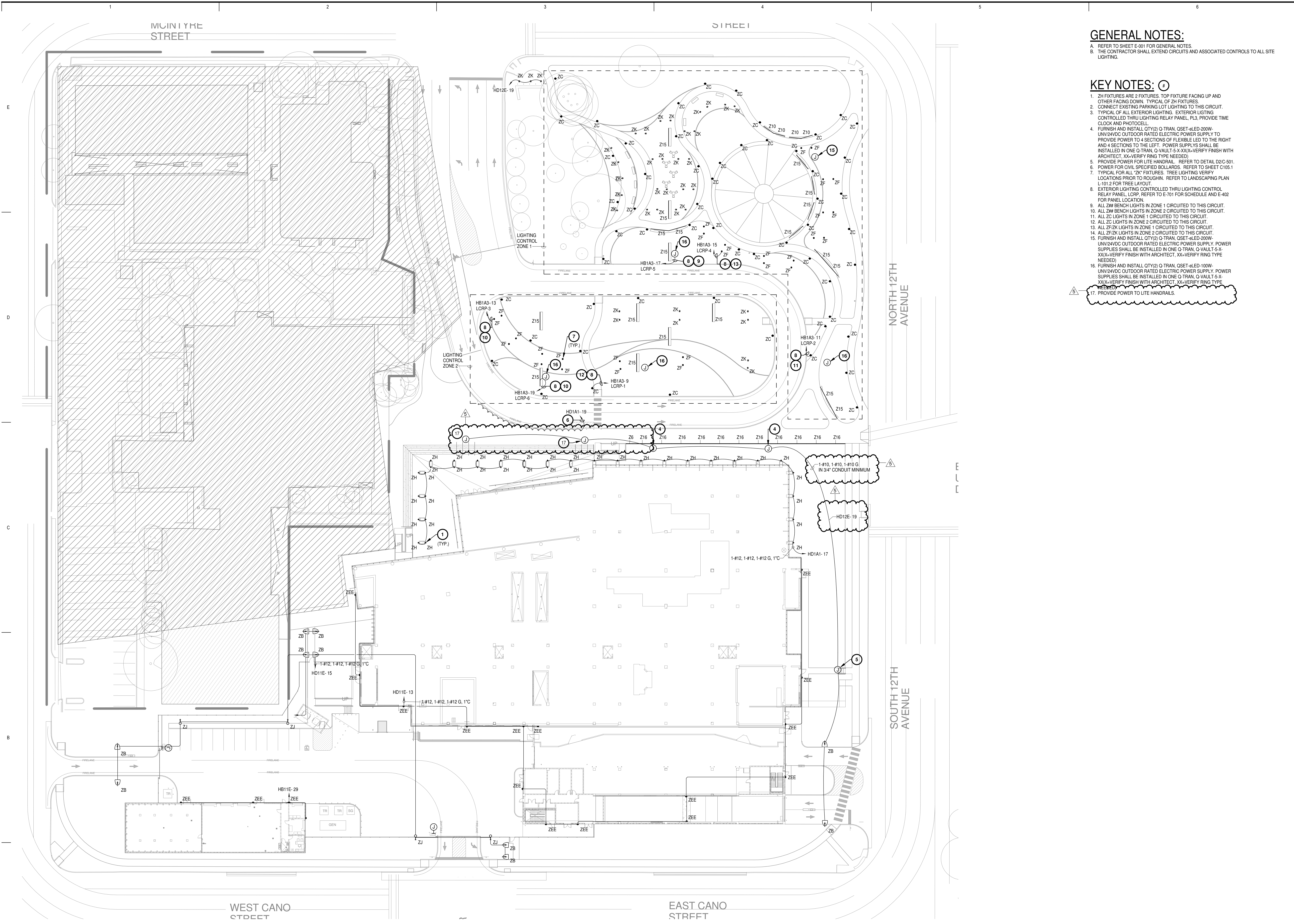

GENERAL NOTES:

- A. REFER TO SHEET E-001 FOR GENERAL NOTES.
- B. THE CONTRACTOR SHALL EXTEND CIRCUITS AND ASSOCIATED CONTROLS TO ALL SITE LIGHTING.

KEY NOTES:

1. ZH FIXTURES ARE 2 FIXTURES. TOP FIXTURE FACING UP AND OTHER FACING DOWN. TYPICAL OF ZH FIXTURES.
2. CONNECT EXISTING PARKING LOT LIGHTING TO THIS CIRCUIT.
3. TYPICAL OF ALL EXTERIOR LIGHTING. EXTERIOR LIGHTING CONTROLLED THRU LIGHTING RELAY PANEL. PL3. PROVIDE TIME CLOCK AND PHOTOCELL.
4. FURNISH AND INSTALL QTY(2) Q-TRAN, OSET-4LED-200W-UNV24VDC OUTDOOR RATED ELECTRIC POWER SUPPLY TO PROVIDE POWER TO 4 SECTIONS OF FLEXIBLE LED TO THE RIGHT AND 4 SECTIONS TO THE LEFT. POWER SUPPLIES SHALL BE INSTALLED IN ONE Q-TRAN, Q-VAULT 5-X-XXX-VERIFY FINISH WITH ARCHITECT. XX-VERIFY RING TYPE NEEDED).
5. PROVIDE POWER FOR LITE HANDRAIL. REFER TO DETAIL D0/C-501.
6. POWER FOR CIVIL SPECIFIED BOLLARDS. REFER TO SHEET C105.1
7. TYPICAL FOR ALL ZK FIXTURES. TREE LIGHTING VERIFY LOCATIONS PRIOR TO ROUGHIN. REFER TO LANDSCAPING PLAN L-101.2 FOR TREE LAYOUT.
8. EXTERIOR LIGHTING CONTROLLED THRU LIGHTING CONTROL RELAY PANEL. LCRP. REFER TO E-701 FOR SCHEDULE AND E-402 FOR PANEL LOCATION.
9. ALL ZH BENCH LIGHTS IN ZONE 1 CIRCUITED TO THIS CIRCUIT.
10. ALL ZH BENCH LIGHTS IN ZONE 2 CIRCUITED TO THIS CIRCUIT.
11. ALL ZC LIGHTS IN ZONE 1 CIRCUITED TO THIS CIRCUIT.
12. ALL ZC LIGHTS IN ZONE 2 CIRCUITED TO THIS CIRCUIT.
13. ALL ZF/ZK LIGHTS IN ZONE 1 CIRCUITED TO THIS CIRCUIT.
14. ALL ZF/ZK LIGHTS IN ZONE 2 CIRCUITED TO THIS CIRCUIT.
15. FURNISH AND INSTALL QTY(2) Q-TRAN, OSET-4LED-200W-UNV24VDC OUTDOOR RATED ELECTRIC POWER SUPPLY. POWER SUPPLIES SHALL BE INSTALLED IN ONE Q-TRAN, Q-VAULT 5-X-XXX-VERIFY FINISH WITH ARCHITECT. XX-VERIFY RING TYPE NEEDED).
16. FURNISH AND INSTALL QTY(2) Q-TRAN, OSET-4LED-100W-UNV24VDC OUTDOOR RATED ELECTRIC POWER SUPPLY. POWER SUPPLIES SHALL BE INSTALLED IN ONE Q-TRAN, Q-VAULT 5-X-XXX-VERIFY FINISH WITH ARCHITECT. XX-VERIFY RING TYPE NEEDED).
17. PROVIDE POWER TO LITE HANDRAILS.



HDR ARCHITECTURE INC.
8750 N. CENTRAL EXPRESSWAY
SUITE 100
DALLAS, TX 75231



HALFF ASSOCIATES
5000 WEST MILITARY STREET, SUITE 100
MCALLEN, TX 78503
HALFF ASSOCIATES FIRM REGISTRATION NUMBER IS F-312

HIDALGO COUNTY,
TEXAS
NEW COUNTY
COURTHOUSE

COURTHOUSE SQUARE
EDINBURG, TEXAS 78539



Project Manager	JOHN NIESEN
Project Designer	KATE DIAMOND
Project Architect	BARRY PETERSON
Landscape Architect	TREY HEATON
Civil Engineer	CHET LEUGERS
Structural Engineer	JOEL GALINDO
Mechanical Engineer	TREY MURRAY
Electrical Engineer	JOSE A. DELGADO
Interior Designer	LAURA WARREN
Equipment Planner	PADLA CONTRERAS
Wayfinding	CHARLEA INGRAM
Drawn By	GAC

MARK	DATE	DESCRIPTION
1	06/21/2019	RFI #169
2	07/22/2019	CPR # 14-ADDED SCOPE
3	08/02/19	CPR#15
4	10/30/20	CPR#47
5	04/15/21	RFI #542

Project Number	32530
Issue Date	09/17/19

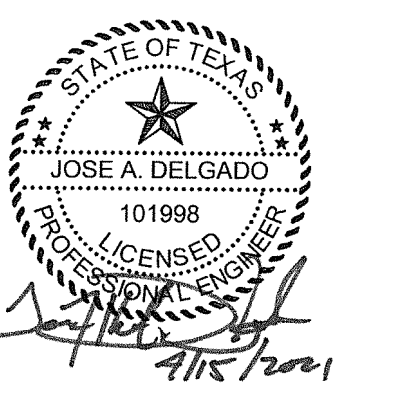

Sheet Name
**ELECTRICAL LIGHTING
SITE PLAN**

Scale
As indicated

Sheet Number
E-101

Project Status
100% CONSTRUCTION DOCUMENTS

1 ELECTRICAL LIGHTING SITE PLAN
1" = 30'-0"

4/19/2021 2:28:23 PM