

CONSTRUCTION CONTRACT CHANGE ORDER NUMBER: 3

1. CONTRACTOR: REIM Construction, Inc.

2. Change Order Work Limits: Sta. 198+18 to Sta. 292+84

3. Type of Change (on federal-aid non-exempt projects): Major (Major/Minor)

4. Describe the change and the reason for the change order. When necessary, include exceptions to this agreement.

CO #3 adds time and funding to remove rock in order to installing reinforced pipe. Structural Excavation Special, an existing item will be used to remove the rock. Pipe installation slowed to 1/3 the prod. requiring an additional 70 days of contract time.
 1. Ex. Bid Item 400-6010 - Struct Excav (SPL) - Extend Plan Quantity
 2. 464-6063 RC Pipe(CL IV)(42In) (SPL) Extend Plan Quantity
 3. 464-6044 RC Pipe(CL III)(54In) (SPL) Reduce Plan Quantity

CCSJ:	0921-02-321
Project:	STP 2021(256) MM
Highway:	Mile 3 N
County:	Hidalgo
District:	21-Pharr
Contract Number:	C-20-294-02-23

5. New or revised plan sheet(s) are attached and numbered: 14a,250a,254a,261a,274a,275a,283a,284a,286a,287a,290a-293a,313a-315a

Each signatory hereby warrants that each has the authority to execute this Change Order.

By signing this change order, the contractor agrees to waive any and all claims for additional compensation due to any and all other expenses; additional changes for time, overhead and profit; or loss of compensation as a result of this change. Further, the contractor agrees that this agreement is made in accordance with Item 4 and the Contract. Exceptions should be noted in the response for #5 above.	The following information must be provided Time Ext. #: <u>1</u> Days added on this C.O.: <u>70</u> Amt. added by this change order: <u>\$236,635.00</u>
	For TxDOT use only: Days participating: _____ Amount participating: _____ Signature _____ Date _____ Name/Title _____
THE CONTRACTOR Date <u>3/30/22</u> By <u>Miguel A. Ramos</u> Typed/Printed Name <u>Miguel A. Ramos</u> Typed/Printed Title <u>President</u>	

RECOMMENDED FOR EXECUTION:

<u>[Signature]</u> <u>3/28/22</u> Name/Title _____ Date _____	<u>[Signature]</u> _____ Name/Title _____ Date _____ <input type="checkbox"/> APPROVED <input type="checkbox"/> REQUEST APPROVAL
_____ Name/Title _____ Date _____	_____ Name/Title _____ Date _____ <input type="checkbox"/> APPROVED <input type="checkbox"/> REQUEST APPROVAL
_____ Name/Title _____ Date _____	_____ Name/Title _____ Date _____ <input type="checkbox"/> APPROVED <input type="checkbox"/> REQUEST APPROVAL
_____ Name/Title _____ Date _____	_____ Name/Title _____ Date _____ <input type="checkbox"/> APPROVED

Engineer's Seal:

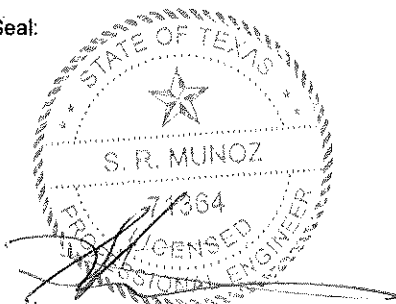

INVOICE RECEIVED BY
AG ON 3/31/22
 GOODS/SERVICES RECEIVED BY
 _____ ON _____

Change Order #3
Mile 3 N Road

To: REIM Construction, Inc.
9612 Stewart Rd.
Mission, Texas 78573

From Owner: Hidalgo County Precinct #3
and: B2Z Engineering, LLC

Project: Mile 3 N Road
Project #: STP 2021 (256) MM
Contract: C-20-294-02-23
CSJ: 0921-02-321
Limits: Tom Gill Road to FM 492 (Goodwin Road)

Change Order #3 - in the amount of \$236,635.00 and 70 days has been reviewed and approved by Hidalgo County Precinct 3 to make the following contract changes.

Description:

Change Order #3 adds both work and time to the original contract for removing hard rock while installing reinforced concrete pipe (RCP) in Lines "A", "B" and "C". Encountering rock was an unexpected and considered a differing site condition that was not identified within the Mile 3 project plans. In December 2021, REIM Construction immediately notified Precinct 3 that excavating rock was costing the operation a lot of money and delaying their normal operation. REIM is now requesting assistance with both funding and time and has provided the documentation to show that the requests are not unreasonable.

Structural Excavation (Special) - Item 400-6010

Structural excavation (SPL) is an existing bid item within the Mile 3 project plans used to pay for rock removal below the pipe flowline. The rock is replaced with sand that provides a soft cushion underneath the pipe. Since the designer L&G Engineering did not core the project in anticipation of additional rock, only 3001 CY was established for the pipe bedding. CO #3 will use this item to introduce new quantities for payment, adding another 3864 CY into Mile 3.

REIM encountered a very small amount of rock in Outfall "A", and the majority of it in Lines "B" and "C" in-between Sta 199+50 and Sta 294+80. They encountered rock as shallow as 3ft below natural ground and removed 19-foot segments just to install the pipe. The removal was very slow, requiring a second excavator with a large hammer to break it up while the first excavator removed the rock and placed pipe. The daily pipe production was reduced from 15 to 5 joints of pipe per day, taking 3 times as long to install one joint. The contractor is requesting 70 days of time, which is not unreasonable and was verified by the inspector on the project. 70 days will be added to the contract.

Precinct 3 verbally approved the additional work using the existing structural excavation item and the price of \$54/CY to remove the extra rock. REIM agreed and both contractor and inspector worked very closely to verify rock thickness and the delayed production to approve this change order.

REIM encountered other differing site conditions when installing the reinforced concrete pipe in both Outfall's B & C. In Outfall B-2, REIM was instructed to add 232 ft of 42" CL IV to reach a

drain point within the pit. In Outfall "C", REIM was instructed to not place 9 ft of 54" RCP CL III pipe because it would overextend beyond a cliff drop off.

Purpose:

Change Order #3 is added compensation and time for rock removal due to the unforeseen field conditions not included in the Mile 3 project plans. The original plans were prepared by Consultant L&G Engineering, and the change order modifications were prepared by B2Z Engineering. The change order has been signed by both the Contractor and AE. This work is currently under construction and the contractor is awaiting TxDOT concurrence to incorporate the changes for payment.

Hidalgo County is fully aware of this Change Order and agrees to modify the current schedule of values to reflect the changes below. The rock was identified during construction and is impacting the current construction progress.

These changes do not require additional ROW. The changes do not impact the original environmental assessment, do not impact TDLR elements, do not impact wetlands, and do not impact waters of the US, archeological, historical, or social issues, endangered species, or any other regulated areas within the project. This change order does not cause a disturbance that would require modification to the Construction Site Notice (CSN) or Notice of Intent (NOI).

B2Z has reviewed the change order with Hidalgo County Precinct 3, to explain the breakdown of the items and dollar value changes according to the governing Specification 1L-9L. Attached, see TxDOT Change Order Form 2146-L used to describe bid item changes and cost changes. Modified Sheet No. include, 14a, 250a, 254a, 261a, 274a, 275a, 283a, 284a, 286a, 287a, 290a, 291a, 292a, 293a, 314a, 315a and 313a are attached.

CHANGE IN CONTRACT PRICE:	CHANGE IN CONTRACT TIME:
Original Contract Price \$14,028,648.44	Original Contract Time 480 Working Days
Previous Change Orders -\$538,580.23	Previous Change Orders 0 Working Days

Contract Price prior to this Change Order \$13,490,068.21	Contract Time prior to this Change Order 480 Working Days
Net increase/decrease of the Change Order \$236,635.00	Net increase/decrease of the Change Order 70 Working Days
Contract Price with all approved Change Orders \$13,726,703.21	Contract Time with all approved Change Orders 550 Working Days

Summary

	Plans Org Quantity CY	Reim Revised Quantity CY
<i>Line A</i>	1178	566
<i>Line B</i>	168	1,989
<i>Line C</i>	1487	4,310
<i>Sht 12</i>	7	0
<i>Sta 304+00</i>	13	0
<i>Sta 315+20</i>	148	0
	3001	6865
CO #3 Amount		3864

Rock Excavation & Removal

Line "B"		Pipe	Rock	Pipe	Trench	Rock	Rock	
Sta	Sta	Length	Depth	Size	Ft	CF	CY	
		Ft	Ft	In				
199+50.	199+90.	Trunk	40	7	42	6.38	1786.4	66
199+90.	200+28.	Trunk	38	11	42	6.38	2666.84	99
200+28.	200+76.	Trunk	48	15.5	42	6.38	4746.72	176
200+76.	201+80.	Trunk	104	18	42	6.38	11943.36	442
201+80.	202+50.	Trunk	70	18	36	5.79	7295.4	270
202+50.	203+38.	Trunk	88	16	36	5.79	8152.32	302
203+38.	205+35.	Trunk	197	15	36	5.79	17109.45	634
Total							1989	

Line "C"		Pipe	Rock	Pipe	Trench	Rock	Rock	
Sta	Sta	Length	Depth	Size	Ft	CF	CY	
		Ft	Ft	In				
294+80.	294+80.	Outfall	241	4	54	9.412	9073.168	336
294+80.	291+50.	Trunk	330	0	54	9.412	0	0
291+50.	283+75.	Trunk	775	1	54	9.412	7294.3	270
283+75.	280+75.	Trunk	300	1	54	9.412	2823.6	105
280+75.	277+75.	Trunk	300	1	42	6.38	1914	71
265+58.	262+71.	Trunk	287	8	42	6.38	14648.48	543
262+71.	262+47.	Trunk	24	11	42	6.38	1684.32	62
262+47.	261+59.	Trunk	88	15	42	6.38	8421.6	312
261+59.	261+03.	Trunk	56	15	42	6.38	5359.2	198
261+03.	259+83.	Trunk	120	15	42	6.38	11484	425
259+83.	258+92.	Trunk	91	15	42	6.38	8708.7	323
258+92.	255+39.	Trunk	353	8	42	6.38	18017.12	667
255+39.	254+83.	Trunk	56	3	42	6.38	1071.84	40
250+54.	246+56.	Trunk	398	3	42	6.38	7617.72	282
246+56.	244+76.	Trunk	180	4	42	6.38	4593.6	170
244+76.	242+63.	Trunk	213	6	36	5.79	7399.62	274
242+63.	241+25.	Trunk	138	8.5	30	5.33	6252.09	232
Total							4310	

CO #3
Outfall B-2
Add 42 In Pipe
Plan Sheet 313a

MH B7 to OUTFALL "B-2"	104	Line Quantity
Actual	336	Revised Quantity
Added	232	of 42"RCP

Network "B" PQ	526
Revised Network "B" PQ	758

Item 42In RCP CL IV (PQ)	2102
Revised Item 42In RCP CL IV PQ	2334

CO #3
Outfall C
Deduct 54 In Pipe
Plan Sheet 315a

MH C34 to	OUTFALL "C"	241	Line Quantity
	Actual	232	Revised Quantity
	Added	-9	of 54"RCP

Network "C" PQ	520
Revised Network "C" PQ	511

Item 54In RCP CL III (PQ)	1424
Revised Item 54In RCP CL III PQ	1415



ESTIMATED STORM DRAIN QUANTITIES

LINK ID	LINK UPSTREAM NODE	LINK DOWNSTREAM NODE	LINK RISE (LF)	RCP SIZE (IN.)	ACTUAL LENGTH (FT.)	ITEM 464 (R.C.P. CL III)					ITEM 464 (CL IV)		ITEM 400				ITEM 402
						6038	6039	6040	6041	6044	6073	6064	6001	6005	6010	6011	6001
						18"	24"	30"	36"	54"	54"	60"	STRUCTURAL EXCAVATION X	CEMENT STABILIZED BACKFILL	STRUCTURAL EXCAVATION (SPL)	SAND BACKFILL	TRENCH PROTECTION
(LF)	(LF)	(LF)	(LF)	(LF)	(LF)	(LF)	(LF)	(CY)	(CY)	(CY)	(CY)	(LF)					
L-A8	A-8	A-7	1.5	18	72	72							80	24	0	0	72
T-A7	A-7	MHA17	4.5	54	138					138			705	0	49	196	138
L-A16	A16	A15	1.5	18	65	65							69	22	0	0	64
L-A18	A18	A17	1.5	18	75	75							83	25	0	0	74
L-A20	A20	A19	1.5	18	76	76							79	25	0	0	76
L-A22	A22	A21	1.5	18	77	77							79	26	0	0	61
L-A24	A24	A23	1.5	18	65	65							68	22	0	0	57
L-A26	A26	A25	1.5	18	66	66							70	22	0	0	63
T-A13	MHA14	MHA13	4.5	54	319				327				1481	0	113	453	319
T-A15	A15	A15-A	4.5	54	223				223				987	0	79	316	223
T-A17	A17	A-7	4.5	54	341					341			1587	0	121	484	341
T-A19	A19	MHA17	3	36	42				42				88	0	0	26	42
T-A21	A21	A19-A	2.5	30	130								246	0	0	67	130
T-A23	A23	A21	2.5	30	295								550	0	0	151	295
T-A25	A25	A23	2	24	310								427	0	0	130	310
T-MHA9	MHA9	MHA10	5	60	442								2226	0	166	699	442
L-A16-A	A16-A	A15-A	1.5	18	63	63							62	21	0	0	9
T-A15-A	A15-A	A17	4.5	54	143					143			616	0	51	203	143
T-A19-A	A19-A	A19	2.5	30	143								265	0	0	73	143
T-MHA10	MHA10	MHA11	5	60	442								2263	0	166	699	442
T-MHA11	MHA11	MHA12	5	60	372								2204	0	225.00	588	372
T-MHA12	MHA12	OUT-A1	5	60	135								899	0	341.00	213	135
T-MHA13	MHA13	A15	4.5	54	211					211			966	0	75	299	211
T-MHA17	MHA17	MHA9	5	60	445								2311	0	167	704	445
TOTAL						559	310	568	42	904	479	1836	18411	187	566.00	5301	4607

* FOR CONTRACTORS INFORMATION ONLY (NON-PAY)

CO#2

CO#3

Inlets & Monholes

NODE ID	TYPE	STATION	OFFSET	ELEVATION	REFERENCE CHAIN	REFERENCE PGL	ITEM 465 - INLETS										INLET
							6029	6031	6032	6033	6036	6039	6041	6044	6075	6077	
							PCU (3') (NONE)	PCU (3') (RIGHT)	PCU (3') (BOTH)	PCU (4') (NONE)	PCU (4') (BOTH)	PCU (5') (RIGHT)	PCU (6') (NONE)	PCU (6') (BOTH)	PSL (RC) (5'X6')	PSL (RC) (8'X8')	
(EA)	(EA)	(EA)	(EA)	(EA)	(EA)	(EA)	(EA)	(EA)	(EA)								
MHA12A - Junction - STA 159+10.00, 1470' TOP=214.00 FL=193.50																	
A-7	Curb	157+60.00	-36	214.44	MILE 3RD	PRM13PROF											1
A-8	Curb	157+60.00	48	214.07	MILE 3RD	PRM13PROF	1										
A15	Curb	150+38.00	-36	213.45	MILE 3RD	PRM13PROF							0				
A16	Curb	150+23.00	36	213.50	MILE 3RD	PRM13PROF	1										
A17	Curb	154+10.00	-36	212.29	MILE 3RD	PRM13PROF							0				
A18	Curb	154+10.00	48	211.99	MILE 3RD	PRM13PROF			1								
A19	Curb	159+52.10	-48	214.40	MILE 3RD	PRM13PROF				1							
A20	Curb	159+52.10	36	214.70	MILE 3RD	PRM13PROF			1								
A21	Curb	162+35.00	-48	217.08	MILE 3RD	PRM13PROF				1							
A22	Curb	162+35.00	36	217.38	MILE 3RD	PRM13PROF	1										
A23	Curb	165+35.00	-36	218.56	MILE 3RD	PRM13PROF			1								
A24	Curb	165+35.00	36	218.56	MILE 3RD	PRM13PROF	1										
A25	Curb	168+50.00	-36	219.19	MILE 3RD	PRM13PROF			1								
A26	Curb	168+50.00	36	219.19	MILE 3RD	PRM13PROF	1										
MHA9	Junction	159+08.00	405	212.11	MILE 3RD	PRM13PROF											1
A15-A	Curb	152+65.00	-36	212.74	MILE 3RD	PRM13PROF			1								
A16-A	Curb	152+65.00	36	212.74	MILE 3RD	PRM13PROF							0				
A19-A	Curb	161+00.00	-48	215.58	MILE 3RD	PRM13PROF				1							
MHA10	Junction	159+08.00	855	211.70	MILE 3RD	PRM13PROF											1
MHA11	Junction	159+08.00	1305	210.82	MILE 3RD	PRM13PROF											1
MHA12	Junction	159+10.00	1685	214.90	MILE 3RD	PRM13PROF									1		
MHA13	Junction	148+23.00	-29.5	214.23	MILE 3RD	PRM13PROF									0		1
MHA14	Junction	145+00.00	-48	214.47	MILE 3RD	PRM13PROF									0		1
MHA17	Junction	159+04.00	-48	214.42	MILE 3RD	PRM13PROF											1
OUT-A1	Outlet	160+52.00	1697	214.21	MILE 3RD	PRM13PROF											
TOTAL							5	1	3	1	2	1	1	0	1	7	

INLET
6040
PCU
5FT
BOTH
(EA)
3
CO#2

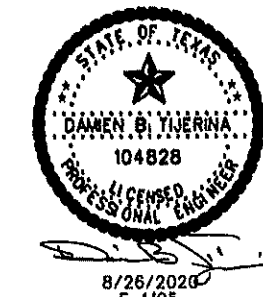
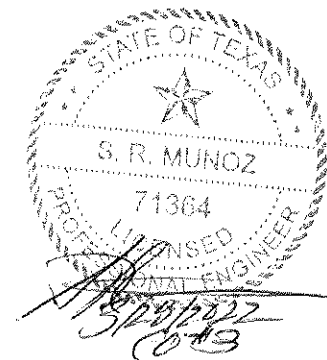

CO#3 - Change Order #3
Structural Excavation SPL
Rock Excavation and Removal
Adjust 42" CL IV Pipe Quantity
Adjust 54" CL III Pipe Quantity

CO#2 - Change Order #2
Adjust plan quantity errors for storm
sewer reinforced concrete pipes,
inlets, and manholes.



Texas Department of Transportation
© 2020

L & G Engineering
Highway / Civil
Structural / Bridge
Environmental
Firm No. : F-4106
Exp. 08/31/2020
2100 W. Expressway 83
Mercedes, TX 78570
Phone : (958) 665-9813
Fax : (958) 665-9818
900 S. Stewart Rd., Ste. 10
Mission, TX 78572
Phone : (958) 665-1909
Fax : (958) 665-1927

MILE 3 ROAD
STORM DRAIN QUANTITIES
NETWORK A

DR	DATE	STATE	PROJECT NO.	ROWAY NO.
CK DR	D.B.T.	6	TX	MILE 3
DR	DATE	COUNTY	CONTRACT NO.	SHEET NO.
CK DR	D.B.T.	21	HIDALGO 0921 02	321
TR				250a

- NOTE:
1) STORM DRAIN CALCULATIONS MADE USING GEOPAK DRAINAGE.
2) PONDING WIDTHS DO NOT EXCEED THE WIDTH ALLOWED BY THE HYDRAULIC MANUAL.
3) RAINFALL FREQUENCY 5YR
4) MINIMUM TIME OF CONCENTRATION = 10 MIN.

8/26/2020 R:\2015\03-164_Pct\01-MILE 3 CTom GBL_F14492\DKN\ParSheet\04Mile3_Hydro_Sum_A.dgn

ESTIMATED STORM DRAIN QUANTITIES

LINK ID	LINK UPSTREAM NODE	LINK DOWNSTREAM NODE	LINK RISE (LF)	RCP SIZE (IN.)	ACTUAL LENGTH (FT.)	ITEM 464 (R.C.P. CL III)				CL IV		ITEM 400				ITEM 402
						6038	6039	6040	6041	6062	6063	* 6001	6005	6010	6011	6001
						18"	24"	30"	36"	36"	42"	STRUCTURAL EXCAVATION (CY)	CEMENT STABILIZED BACKFILL (LF)	STRUCTURAL EXCAVATION (SPL)	SAND BACKFILL (LF)	TRENCH PROTECTION (LF)
L-B1	B1	B2	2	24	63		63					82	0	0	26	63
L-B3	B3	B4	2	24	63		63					78	0	0	26	63
L-B5	B5	B6	2	24	63		63					80	0	0	26	63
L-B9	B9	B10	1.5	18	64	64						62	21	0	0	
T-B2	B2	MHB2	2.5	30	133			133				319	0	0	68	133
T-B4	B4	MHB8	2.5	30	179			179				349	0	0	92	179
T-B6	B6	B8	2.5	30	282			282				617	0	0	145	282
T-B7	B7	OUT-B-2	3.5	42	16					336		46	0	2	11	9
T-B8	B8	B7	3.5	42	64					64		315	0	8	46	64
L-B11	B11	B12	1.5	18	64	64						61	21	0	0	
L-B13	B13	B14	1.5	18	76	76						71	25	0	0	
L-B15	B15	B16	1.5	18	76	76						71	25	0	0	
L-B17	B17	B18	2	24	76		76					92	0	0	32	76
L-B19	B19	B20	1.5	18	65	65						64	22	0	0	13
L-B21	B21	B22	1.5	18	66	66						64	22	0	0	
L-B23	B23	B24	1.5	18	66	66						64	22	0	0	
L-B25	B25	B26	2	24	64		64					76	0	0	27	64
L-B27	B27	B28	1.5	18	64	64						62	21	0	0	5
L-BG5	BG5	BG6	1.5	18	49	49						37	16	0	0	
T-B10	B10	B8	3.5	42	358					358		1778	0	42	255	358
T-B12	B12	MHB12	3	36	225				225			1014	0	24	137	225
T-B14	B14	B12	3	36	295					295		1106	0	32	180	295
T-B16	B16	B14	3	36	168			168				477	0	21	119	168
T-B18	B18	MHBG6	3	36	404			404				925	0	0	248	404
T-B20	B20	B18	2	24	297		297					417	0	0	123	297
T-B22	B22	MHB22	1.5	18	256	256						241	88	0	0	
T-B24	B24	MHB10-B	2	24	90		90					103	0	0	35	4
T-B26	B26	B28	3	36	267			267				436	0	0	183	267
T-B28	B28	MHB9	3	36	171			171				296	0	0	104	171
T-BG6	BG6	MHBG6	1.5	18	281	281						273	94	0	0	106
L-B1-B	B1-B	MHB8	1.5	18	68	68						67	23	0	0	14
L-B3-B	B3-B	MHB3	1.5	18	75	75						79	25	0	0	75
XX T-MHB2	MHB2	MHB4	3.5	42	399					0		1350	0	47	284	399
XX T-MHB3	MHB3	MHB6	2	24	240		240					346	0	0	101	240
XX T-MHB4	MHB4	MHB5	3.5	42	393					0		1477	0	46	280	393
XX T-MHB5	MHB5	MHB28	3.5	42	440					0		1845	0	52	314	440
XX T-MHB6	MHB6	B4	2	24	184		184					299	0	0	77	184
XX T-MHB7	MHB7	OUT-B1	3.5	42	456					0		1501	0	54	325	456
T-MHB8	MHB8	B2	2.5	30	188		188					373	0	0	96	188
T-MHB9	MHB9	MHB2	3	36	134			134				244	0	0	82	134
L-B23-B	B23-B	MHB10-B	2	24	68		68					70	0	0	29	
L-B27-B	B27-B	MHB9	1.5	18	68	68						68	23	0	0	23
T-MHB12	MHB12	B10	3	36	359				359			1679	0	39	219	359
T-MHB22	MHB22	B20	2	24	266		266					306	0	0	112	189
XX T-MHB28	MHB28	MHB7	3.5	42	445					0		2042	0	53	317	445
T-MHBG6	MHBG6	B16	3	36	111			111				281	0	0	52	111
T-MHB10-B	MHB10-B	B26	2	24	102							112	0	0	43	28
TOTAL						1338	1576	782	1255	879	758	13608	447	1989	2677	4855

XX TO BE CONSTRUCTED BY HCDD *1 BEFORE CONSTRUCTION OF THIS PROJECT
 * FOR CONTRACTORS INFORMATION ONLY (NON-PAY) CO#2 CO#2 & 3 CO#3

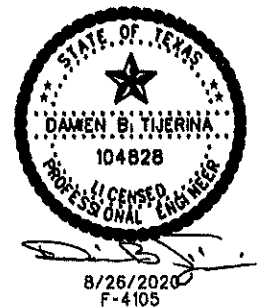
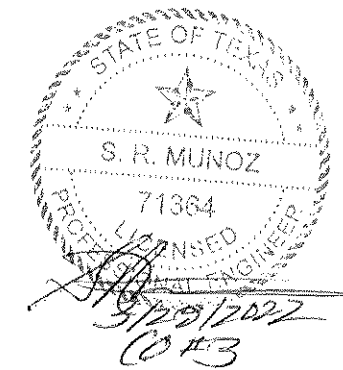

CO#3 - Change Order #3
 Structural Excavation SPL
 Rock Excavation and Removal
 Adjust 42" CL IV Pipe Quantity
 Adjust 54" CL III Pipe Quantity

CO#2 - Change Order #2
 Adjust plan quantity errors for storm sewer reinforced concrete pipes, inlets, and manholes.



Texas Department of Transportation

L & G Engineering
 Highway / Civil
 Structural / Bridge
 Environmental
 Firm No. : F-4105
 Exp. 08/31/2020

2100 W. Expressway 63
 Mercedes, TX. 78570
 Phone : (856) 685-9813
 Fax : (856) 685-9818

800 S. Stewart Rd., Ste. 10
 Mission, TX. 78572
 Phone : (856) 685-1609
 Fax : (856) 685-1827

MILE 3 ROAD
 STORM DRAIN QUANTITIES
 NETWORK B

DR: 6	STATE: TX	PROJECT NO.: 0921 02 321	MILE 3
DATE: 8/26/2020	COUNTY: HIDALGO	SECTION: 02	SHEET: 254a

R:\2015\03-Hid_Pe3\101-MILE 3 (1)am_GA_FM492\CON_PlanSheets\04-Mile3_Hydr_Sum_B.dgn
 8/26/2020

- NOTE:
- 1) STORM DRAIN CALCULATIONS MADE USING GEOPAK DRAINAGE.
 - 2) PONDING WIDTHS DO NOT EXCEED THE WIDTH ALLOWED BY THE HYDRAULIC MANUAL.
 - 3) RAINFALL FREQUENCY 5YR
 - 4) MINIMUM TIME OF CONCENTRATION = 10 MIN.

ESTIMATED STORM DRAIN QUANTITIES																			
LINK ID	LINK UPSTREAM NODE	LINK DOWNSTREAM NODE	LINK RISE (LF)	RCP SIZE (IN.)	ACTUAL LENGTH (FT.)	ITEM 464 (R.C.P. CL III)					ITEM 464 (R.C.P. CL IV)			ITEM 400				ITEM 402	
						6038	6039	6040	6041	6042	6044	6063	6072	6073	* 6001 STRUCTURAL EXCAVATION	6005 CEMENT STABILIZED BACKFILL	6010 STRUCTURAL EXCAVATION (SPL)	6011 SAND BACKFILL	6001 TRENCH PROTECTION
						(LF)	(LF)	(LF)	(LF)	(LF)	(LF)	(LF)	(LF)	(LF)	(CY)	(CY)	(CY)	(CY)	(LF)
L-C1	C1	C2	1.5	18	66	66									73	22	0	0	66
L-C3	C3	C4	1.5	18	65	65									58	22	0	0	
L-C5	C5	C6	1.5	18	65	65									68	22	0	0	65
L-C7	C7	C8	1.5	18	76	76									79	25	0	0	47
L-C9	C9	C10	1.5	18	76	76									83	25	0	0	76
T-C2	C2	C4	1.5	18	294	294									354	98	0	0	58
T-C4	C4	C6	2.5	30	296		296								484	0	0	152	296
T-C6	C6	MHC6	2.5	30	330		329								805	0	32	169	330
T-C8	C8	C10	3.5	42	176				176						608	0	21	125	176
L-C11	C11	C12	1.5	18	64	64									69	21	0	0	64
L-C13	C13	C14	1.5	18	64	64									68	21	0	0	64
L-C15	C15	C16	1.5	18	64	64									68	21	0	0	64
L-C17	C17	C18	1.5	18	64	64									68	21	0	0	63
L-C19	C19	C20	1.5	18	63	63									68	21	0	0	63
L-C21	C21	C22	1.5	18	63	65									67	21	0	0	63
L-C23	C23	C24	1.5	18	75	75									75	25	0	0	31
L-C25	C25	C26	1.5	18	75	75									78	25	0	0	46
L-C27	C27	C28	1.5	18	63	63									67	21	0	0	63
L-C29	C29	C30	1.5	18	63	63									67	21	0	0	63
L-C31	C31	C32	1.5	18	63	63									67	21	0	0	63
L-C33	C33	C34	1.5	18	63	63									67	21	0	0	63
L-C35	C35	C36	1.5	18	76	76									80	25	0	0	76
L-C37	C37	C38	1.5	18	76	76									78	25	0	0	42
L-C39	C39	C40	1.5	18	76	76									106	25	0	0	55
L-C41	C41	C42	1.5	18	66	65									70	22	0	0	66
L-C43	C43	C44	1.5	18	65	65									91	22	0	0	65
L-CG3	CG3	CG4	1.5	18	50	50									44	17	0	0	13
L-CG4	CG4	MHC22	2	24	195		198								261	0	0	82	195
L-CG6	CG6	MHC6	2	24	276		279								449	0	0	116	276
L-CG7	CG7	MHC23	1.5	18	357	357									534	119	0	0	343
L-CG8	CG8	CG7	1.5	18	50	50									48	17	0	0	
L-CS1	CS1	CG6	1.5	18	44	44									62	15	0	0	44
T-C10	C10	C12	3.5	42	393				393						1371	0	45	280	393
T-C12	C12	C14	3.5	42	252						252				986	0	30	180	252
T-C14	C14	C16	3.5	42	222								222		1008	0	26	158	222
T-C16	C16	MHC16	3.5	42	350								350		1772	0	41	248	350
T-C18	C18	C20	3.5	42	402								402		2110	0	47	286	402
T-C20	C20	C22	4	48	366									366	1793	0	121	162	366
T-C22	C22	MHC22	4	48	138									138	586	0	46	174	138
T-C24	C24	C26	4	48	195									195	839	0	65	246	195
T-C26	C26	C28	4	48	195									195	867	0	65	246	195
T-C28	C28	MHC28	4.5	54	295										1458	0	104	419	295
T-C30	C30	C32	4.5	54	371										1805	0	131	526	371
T-C32	C32	C34	4.5	54	446										2071	0	158	633	446
T-C34	C34	MHC34	4.5	54	278						279				1237	0	98	394	278
T-C36	C36	MHC34	3	36	111							111			388	0	12	68	111
T-C38	C38	MHC23	3	36	110							110			375	0	12	67	110
T-C40	C40	C38	3	36	346								346		1176	0	37	211	346
T-C42	C42	C40	2.5	30	347										981	0	33	178	347
T-C44	C44	C42	2	24	356										726	0	0	150	356
T-C45	C45	C43	1.5	18	187										228	62	0	0	187
T-C46	C46	C44	1.5	18	327										434	109	0	0	327
L-CSG2	CSG2	CS1	1.5	18	262	262									352	88	0	0	262
T-MHC6	MHC6	C8	3	36	208										669	0	22	127	208
T-MHC16	MHC16	C18	3.5	42	350								350		1866	0	41	249	350
T-MHC22	MHC22	C24	4	48	201										849	0	67	254	201
T-MHC23	MHC23	C36	3	36	400										1355	0	43	244	400
T-MHC28	MHC28	C30	4.5	54	295										1474	0	104	419	295
T-MHC34	MHC34	OUT-C	4.5	54	241									232				295	241
TOTAL						3063	833	972	1175	569	511	1576	1095	1407	34188	1020	4310	7206	10951

* FOR CONTRACTORS INFORMATION ONLY (NON-PAY)

CO#2

CO#2 & 3

CO#3

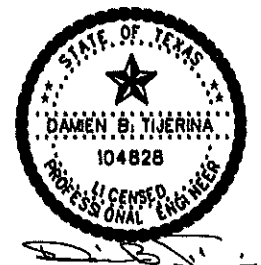
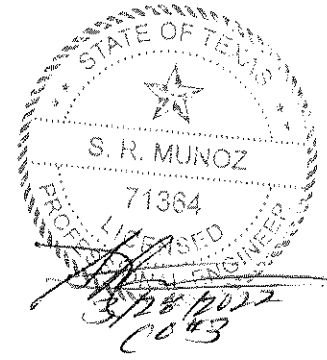

CO#3 - Change Order #3
Structural Excavation SPL
Rock Excavation and Removal

CO#2 - Change Order #2
Adjust plan quantity errors for storm
sewer reinforced concrete pipes,
inlets, and manholes.



© 2020
Texas Department of Transportation

L & G Engineering
Highway / Civil
Structural / Bridge
Environmental
Firm No. : F-4105
Exp. 08/31/2020
2100 W. Expressway 83
Marceline, TX. 78570
Phone : (958) 685-9813
Fax : (958) 685-9818
900 S. Stewart Rd., Ste. 10
Mission, TX. 78572
Phone : (958) 685-1609
Fax : (958) 685-1627

MILE 3 ROAD
STORM DRAIN QUANTITIES
NETWORK C

SHEET 6 OF 7

DR	6	TX	0921	02	321	261A
CK DR	D.B.T.					
DR	6	TX	0921	02	321	261A
CK DR	D.B.T.					
TR						
CK TR						

8/26/2020 R:\2015\05-Hd Pet\01-MILE 3 CTM GLL\14492\02\N\PlanSheets\04\mic3_Hydro_Sum_C.dgn

SHEET SUMMARY			
ITEM	DESCRIPTION	UNIT	QUANTITY
400	STRUCTURAL EXCAV. (SPL)	CY	7
484	24" RCP CL III	LF	90
1008	PRSSR IRRIGATION PVC 15"	LF	97

- LEGEND:**
- W --- EXIST. (DIAM INCH) WATER LINE
 - FW --- EXIST. (DIAM INCH) FORCE MAIN SANITARY SEWER LINE
 - SS --- EXIST. (DIAM INCH) SANITARY SEWER LINE
 - G --- EXIST. (DIAM INCH) GAS PIPELINE
 - UFO --- EXIST. UNDERGROUND FIBER OPTIC CABLE
 - UT --- EXIST. UNDERGROUND TELE LINE
 - OHE --- EXIST. OVERHEAD ELECTRIC LINE
 - HVTL --- EXIST. HIGH VOLTAGE TRANSMISSION LINE
 - UE --- EXIST. UNDERGROUND ELECTRIC LINE
 - OHEC --- EXIST. OVERHEAD ELECTRIC LINE WITH CABLE LINE ATTACHED
 - OHEFC --- EXIST. OVERHEAD ELECTRIC LINE WITH FIBER OPTIC AND CABLE LINE ATTACHED
- NOTES:**
- SEE ALIGNMENT DATA SHEET FOR PROPOSED CENTERLINE DATA.
 - ALL RCP SHALL BE CL III UNLESS OTHERWISE NOTED.
 - SEE DRAINAGE STRUCTURE STANDARD SHEETS FOR DESCRIPTION OF OFFSET IN STORM DRAIN TABLE.
 - RECONNECTION OF EXISTING STORM DRAIN SHALL BE SUBSIDIARY TO PERTINENT BID ITEMS.
 - SEE "HYDRAULIC DATA SHEETS FOR PAYMENT OF ALL PROPOSED DRAINAGE STRUCTURES.
 - FOR OTHER DITCH GRADES SEE DITCH PROFILE SHEETS
 - CONTRACTOR SHALL COORDINATE WITH UID & HCD #6 PRIOR TO ANY WORK DONE ON OR NEAR IRRIGATION STRUCTURES. MIKE WARSHAK (956) 585-4818 (UID) JOE AGUILAR (956) 585-8389 (HCD#6)
 - CONTRACTOR SHALL COORDINATE WITH UTILITY COMPANIES TO FIELD VERIFY UTILITIES TO CONSTRUCTION.

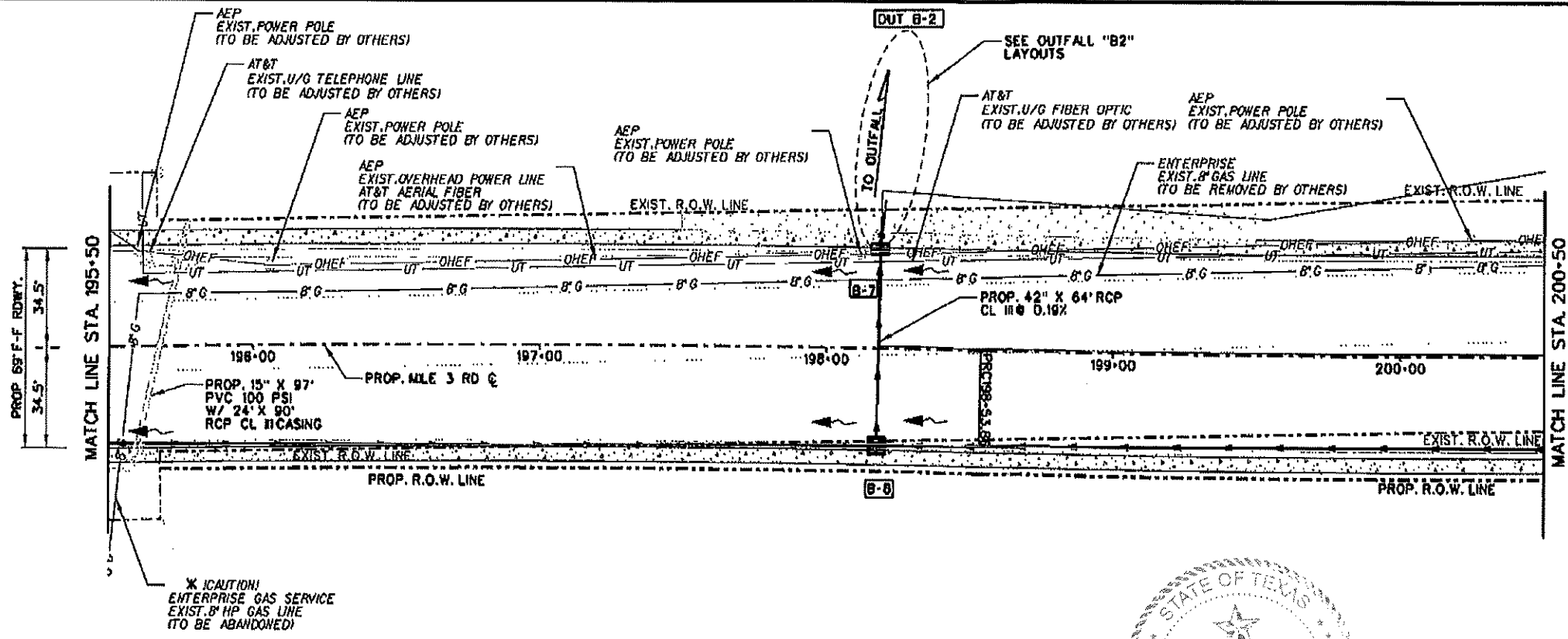

STORM DRAIN TABLE

STRUCTURE ID	DESCRIPTION	STATION / OFFSET TO FACE OF CURB	TOP OF STR. ELEVATION	PROP. FL. OF STRUCTURE	PROP. FL. OF PIPE (NORTH)	PROP. FL. OF PIPE (SOUTH)	PROP. FL. OF PIPE (EAST)	PROP. FL. OF PIPE (WEST)
B-7	PCU (24\"/>							

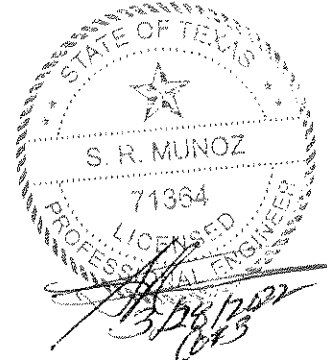

CO#3 - Change Order #3
Structural Excavation SPL
Rock Excavation and Removal

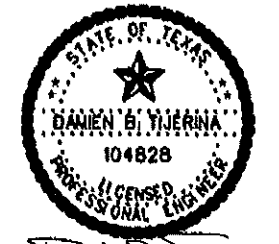

© 2020
Texas Department of Transportation

L&G Engineering
 Highway / Civil
 Structural / Bridge
 Environmental
 Firm No. : F-4106
 Exp. 08/31/2020

2108 W. Expressway 63
 Mercedes, TX, 79070
 Phone : (956) 865-9812
 Fax : (956) 865-9818

900 S. Stewart Rd., Ste. 10
 Mission, TX, 78572
 Phone : (956) 865-1800
 Fax : (956) 865-1827

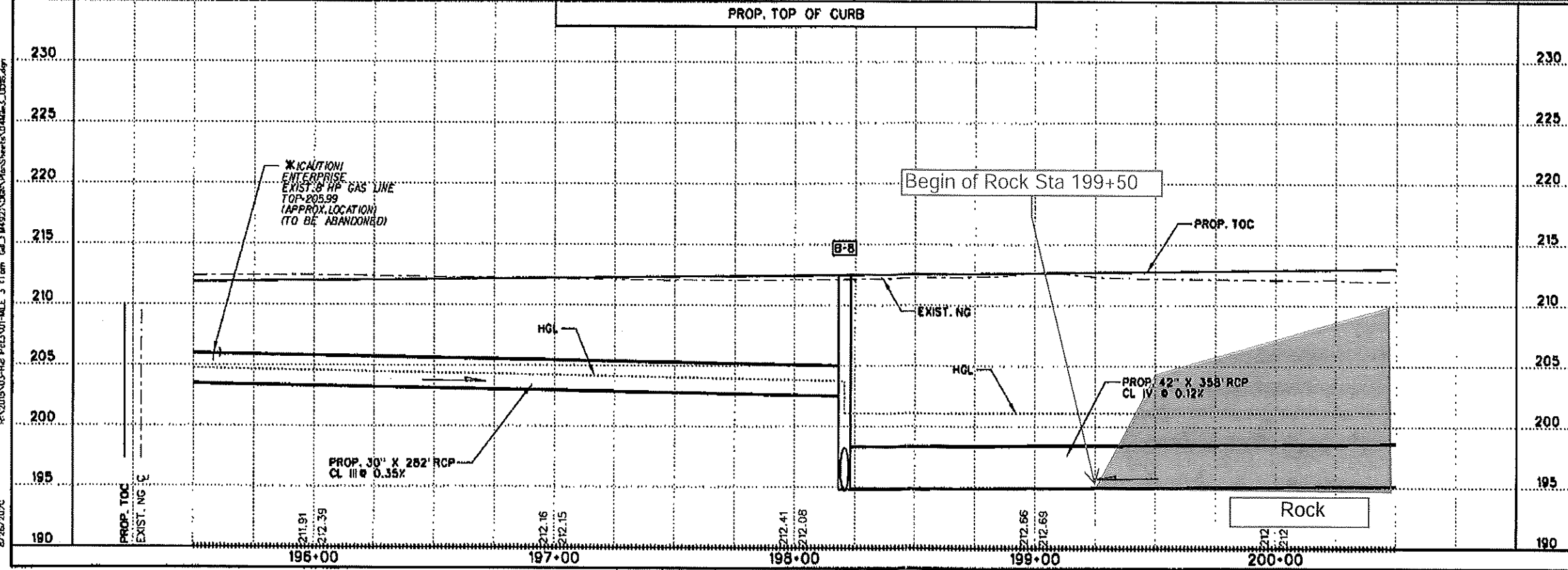

SCALE:
 HOR: 1" = 50'
 VER: 1" = 10'

SHEET 12 OF 48

DATE	REV.	BY	CHKD.	APP'D.
06/28/2020	1	DM	DM	DM

STATE	COUNTY	CONTRACT NO.	SECTION NO.	POST MILE	SHEET NO.
TX	Hidalgo	0921	02	321	274a

2/26/2020
 R:\2019\03-Highway\101-MILE 3 (11m) CB_144927\Drawings\Plan\Sheet\04.dwg

SHEET SUMMARY

ITEM	DESCRIPTION	UNIT	QUANTITY
432	RIPRAP (5")	CY	9

LEGEND:

- * W — EXIST. * (DIAM INCH) WATER LINE
 - * FS — EXIST. * (DIAM INCH) FORCE MAIN SANITARY SEWER LINE
 - * SS — EXIST. * (DIAM INCH) SANITARY SEWER LINE
 - * G — EXIST. * (DIAM INCH) GAS PIPELINE
 - UFO — EXIST. UNDERGROUND FIBER OPTIC CABLE
 - UT — EXIST. UNDERGROUND TELE LINE
 - OHE — EXIST. OVERHEAD ELECTRIC LINE
 - HVTL — EXIST. HIGH VOLTAGE TRANSMISSION LINE
 - UE — EXIST. UNDERGROUND ELECTRIC LINE
 - OHEC — EXIST. OVERHEAD ELECTRIC LINE WITH CABLE LINE ATTACHED
 - OHEFC — EXIST. OVERHEAD ELECTRIC LINE WITH FIBER OPTIC AND CABLE LINE ATTACHED
- ☐ SEE P&P SHEETS
 - ⊗ EXIST. ITEM TO BE REMOVED UNDER ITEM 496
 - ⊙ PROP. CONC. PLUG (NON-PAY ITEM)
 - DIRECTION OF FLOW
 - ⇨ OUTFALL CHANNEL FLOW
- NOTES:
- SEE ALIGNMENT DATA SHEET FOR PROPOSED CENTERLINE DATA.
 - ALL RCP SHALL BE CL III UNLESS OTHERWISE NOTED.
 - SEE DRAINAGE STRUCTURE STANDARD SHEETS FOR DESCRIPTION OF OFFSET IN STORM DRAIN TABLE.
 - RECONNECTION OF EXISTING STORM DRAIN SHALL BE SUBSIDIARY TO PERTINENT BID ITEMS.
 - SEE "HYDRAULIC DATA SHEETS FOR PAYMENT OF ALL PROPOSED DRAINAGE STRUCTURES.
 - FOR OTHER DITCH GRADES SEE DITCH PROFILE SHEETS
 - CONTRACTOR SHALL COORDINATE WITH UID & HCID #6 PRIOR TO ANY WORK DONE ON OR NEAR IRRIGATION STRUCTURES.
 - MIKE WARSHAK (956) 585-4818 (UID) JOE AGUILAR (956) 585-8389 (HCID#6)

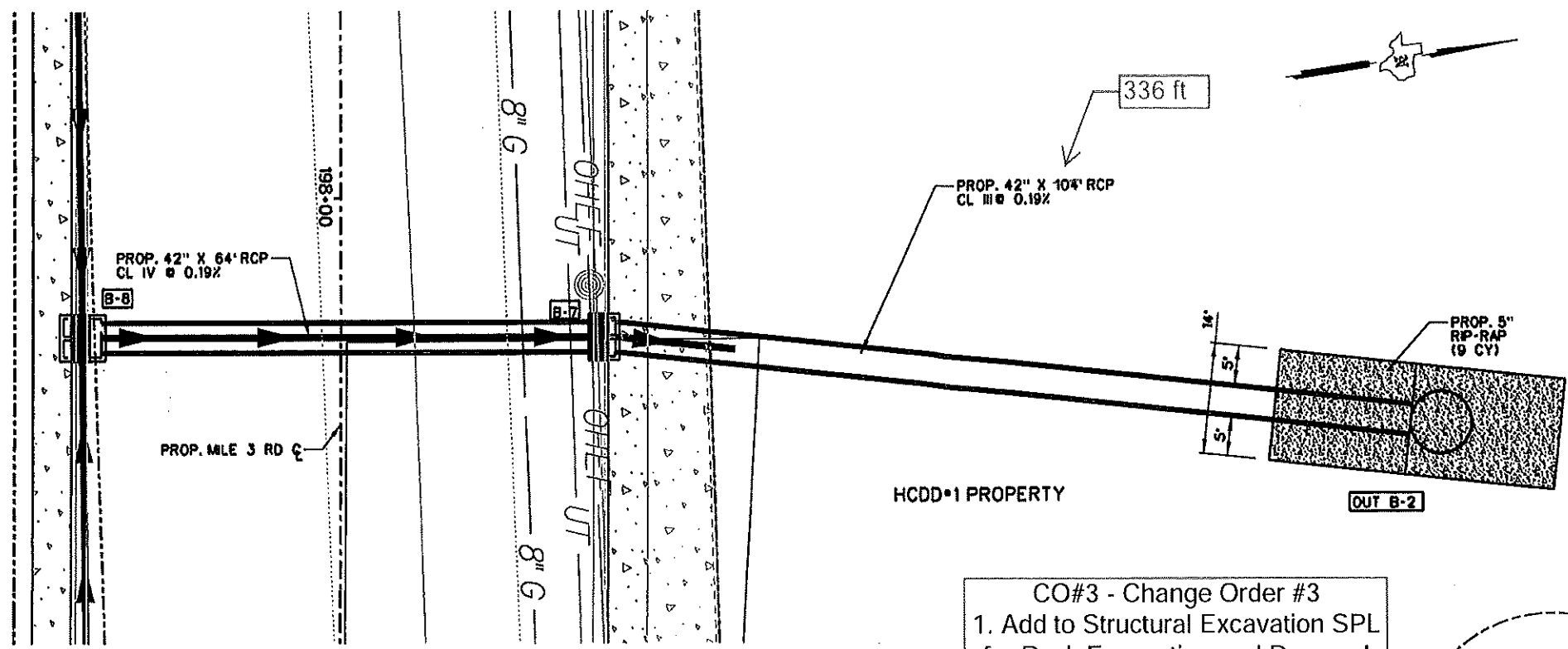

STORM DRAIN TABLE

STRUCTURE ID	DESCRIPTION	STATION / OFFSET TO FACE OF CURB	TOP OF STR. ELEVATION	PROP. FL. OF STRUCTURE	PROP. FL. OF PIPE (NORTH)	PROP. FL. OF PIPE (SOUTH)	PROP. FL. OF PIPE (EAST)	PROP. FL. OF PIPE (WEST)
B-7	RCP (N*E) (NONE)	STA. 188+18.00, 36' LT.	212.48	194.70	194.70	194.70	194.83	202.50
OUTB2	OUTFALL B2	STA. 188+20.00, 132' LT.	212.48	194.83	194.48	194.48		

CO#3 - Change Order #3
 1. Add to Structural Excavation SPL for Rock Excavation and Removal
 2. Increase 42" CL IV Pipe Quantity
 3. Decrease 54" CL III Pipe Quantity

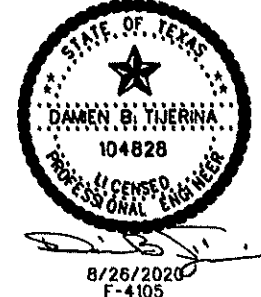
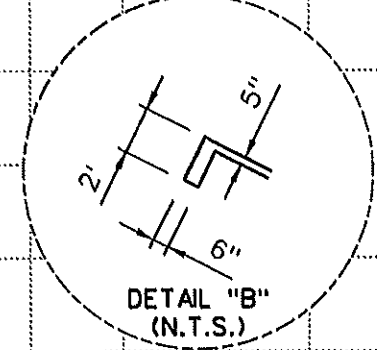
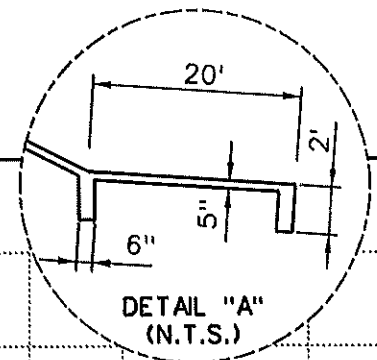
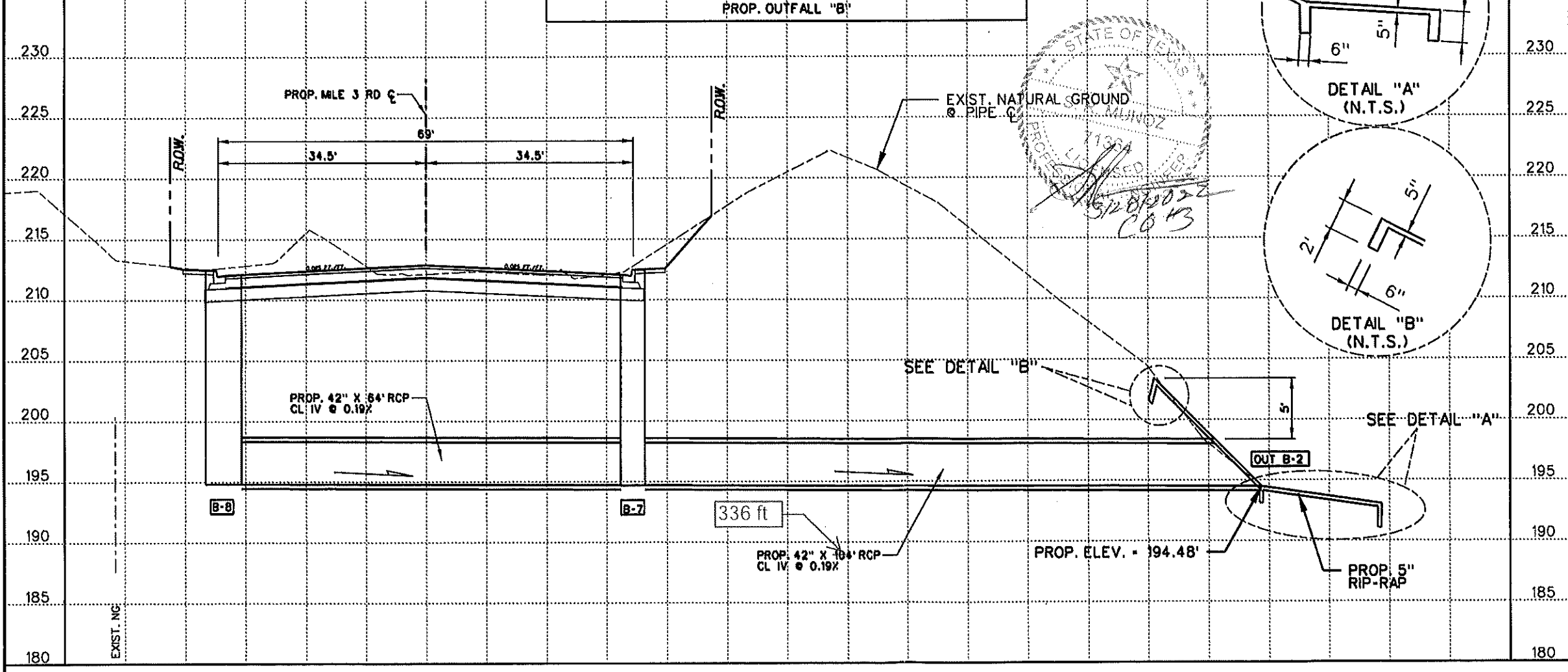

© 2020
 Texas Department of Transportation

L & G Engineering
 Highway / Civil
 Structural / Bridge
 Environmental
 Firm No. : F-4105
 Exp. 08/31/2020

2100 W. Expressway 83
 Mercedes, TX, 78570
 Phone : (956) 885-9815
 Fax : (956) 885-9818

900 S. Stewart Rd., Ste. 10
 Mission, TX, 78572
 Phone : (956) 885-1900
 Fax : (956) 885-1927

MILE 3 ROAD
 OUTFALL "B2" LAYOUT

SCALE:
 HOR: 1" = 20'
 VER: 1" = 10'

SHEET 1 OF 1

DATE	BY	STATE	PROJECT NO.	MARKET NO.
6	TX	STP	()	MM

DATE	BY	COUNTY	SECTION NO.	POST NO.	SHEET NO.
21	HIDALGO	0921	02	321	313a

R:\2015\03-16d_P133\01-MLL-3_C10m_GBL_FM492\UDN\PlanSheets\0466-3_OUTFALL_B2.dgn
 8/26/2020

