



**Hidalgo County  
Planning  
Department**

**T.J. Arredondo, CFM**  
*Director of Planning*

**Main Office**

2818 S. Business 281  
Edinburg, Texas 78539  
Phone (956) 318-2840  
Fax (956) 318-2844

**Precinct No. 1 Substation**

1900 Joe Stephens Ave. Ste. A  
Weslaco, Texas 78596  
Phone (956) 968-4734  
Fax (956) 973-7850

**Precinct No. 3 Substation**

2401 N. Moorefield Road  
Mission, Texas 78572  
Phone (956) 205-7045  
Fax (956) 205-7049

**PIPELINE AND UTILITY PERMIT APPLICATION PACKET**

**THE STATE OF TEXAS**

**COUNTY OF HIDALGO**

**PRECINCT 3**

**APPLICATION AND AGREEMENT FOR PIPELINE OR  
UTILITY PERMIT**

Date: 10/5/22

Spectrum 3607555/SM179 (hereinafter referred to as  
"Applicant") does hereby make application to the Hidalgo County  
through the Hidalgo County Planning Department (hereinafter referred  
to as "HCPD") to construct, maintain and repair pipelines or utilities  
across the easements, right-of-ways, property or property interest as  
described below.

Information required:

1. Name, Address and Phone number of Applicant:

Robert Martinez 1-412-5489

1514 South 77 Sunshine Strip suite 1 Harlingen TX. 78550

2. Name, Address and Phone number of company or agency owning  
Pipeline or Utility (please indicate if same as Applicant):

Robert Martinez 1-956-412-5489

1514 South 77 sunshine Strip Suite 1 Harlingen Tx. 78550

3. Name, Address and Phone number of operator of Pipeline or  
Utility (please indicate if same as Applicant):

Robert Martinez 1-956-412-5489

1514 South 77 Sunshine Strip Suite 1 Harlingen Texas.

4. Name, Address and Phone number of contractor to install Pipeline  
or Utility:

Cynthia De Leon 1-512-646-9913

Broad Band Services 5510 North Gate Pharr Tx. 78577

Visit Hidalgo County Planning Department on the web at [www.co.hidalgo.tx.us](http://www.co.hidalgo.tx.us)





**Hidalgo County  
Planning  
Department**

**T.J. Arredondo, CFM**  
*Director of Planning*

**Main Office**

2818 S. Business 281  
Edinburg, Texas 78539  
Phone (956) 318-2840  
Fax (956) 318-2844

**Precinct No. 1 Substation**

1900 Joe Stephens Ave. Ste. A  
Weslaco, Texas 78596  
Phone (956) 968-4734  
Fax (956) 973-7850

**Precinct No. 3 Substation**

2401 N. Moorefield Road  
Mission, Texas 78572  
Phone (956) 205-7045  
Fax (956) 205-7049

**PIPELINE AND UTILITY PERMIT APPLICATION PACKET**

12. Utility Crossing Coordinate X: 26.318102 Y: -98.393299  
(NAD 83 Texas South FIPS 4205 feet)
13. Number and size of lines:  
NA
14. Pressure (each line):  
NA
15. Content (each line):  
NA
16. Estimated date of installation of Pipeline or Utility:  
AS soon as permit is granted.



## Hidalgo County Planning Department

**T.J. Arredondo, CFM**  
*Director of Planning*

**Main Office**

2818 S. Business 281  
Edinburg, Texas 78539  
Phone (956) 318-2840  
Fax (956) 318-2844

**Precinct No. 1 Substation**

1900 Joe Stephens Ave. Ste. A  
Weslaco, Texas 78596  
Phone (956) 968-4734  
Fax (956) 973-7850

**Precinct No. 3 Substation**

2401 N. Moorefield Road  
Mission, Texas 78572  
Phone (956) 205-7045  
Fax (956) 205-7049

## **PIPELINE AND UTILITY PERMIT APPLICATION PACKET**

If requested permit is granted by HCPD, Applicant, in consideration thereof, agrees and binds itself as follows:

1. All pipelines or utilities herein will be horizontally placed within the right-of-way as determined by HCPD and at a minimum depth of five (5) feet below natural ground. Depth, horizontal, and vertical location shall be confirmed by HCPD Inspectors.
2. Location map, profile, and plans concerning the proposed pipeline or utility crossing will furnished with this application.
3. HCPD will be notified in writing ten days prior to the beginning date of construction under this permit.
4. Applicant will bear the entire expense of all future relocations of any pipelines or utilities should such relocation, at the sole discretion of the Hidalgo County Commissioners Court, be necessary for improvements, alteration, or maintenance of Hidalgo County's easement or property of interest.
5. Applicant will notify the HCPD at least 48 hours prior to covering work and or completion of its work and removal of its equipment from the job site to permit HCPD to make an inspection.
6. Upon notification by the HCPD, the Applicant will promptly repair or rectify any deficiency or condition caused by the Applicant's operations or installations under this permit. Applicant will leave easement in as near the same condition or better, in the HCPD's sole judgment, as it existed prior to the commencement of the operations under this permit.
7. Hidalgo County shall not be liable or responsible for, and shall be saved and held harmless by Applicant, and further shall be indemnified by Applicant, from and against any and all suits, actions, losses, damages, claims, or liability of any character, type, or description, including all expenses of litigation, court costs, attorney's fees, and engineering fees for injury or death to any person, or injury to any property, received or sustained by any person or persons or property, arising out of, or occasioned by, directly or indirectly, the performance of Applicant under this agreement, including claims and damages arising in part from the negligence of Hidalgo County.



## Hidalgo County Planning Department

**T.J. Arredondo, CFM**  
*Director of Planning*

### Main Office

2818 S. Business 281  
Edinburg, Texas 78539  
Phone (956) 318-2840  
Fax (956) 318-2844

### Precinct No. 1 Substation

1900 Joe Stephens Ave. Ste. A  
Weslaco, Texas 78596  
Phone (956) 968-4734  
Fax (956) 973-7850

### Precinct No. 3 Substation

2401 N. Moorefield Road  
Mission, Texas 78572  
Phone (956) 205-7045  
Fax (956) 205-7049

## PIPELINE AND UTILITY PERMIT APPLICATION PACKET

It is the expressed intent of the parties to this agreement that the indemnity provided for in this section is extended by Applicant to indemnity and protect Hidalgo County from the consequences of Hidalgo County's own negligence, whether that negligence is the sole or contributory cause of the resultant injury death, or damage.

Applicant further agrees to defend, at its own expense, with attorneys acceptable to Hidalgo County and on behalf of Hidalgo County, and in the name of Hidalgo County, any claim or litigation brought against Hidalgo County in connection with any such injury, death or damage.

Before construction is begun on such pipeline or utility crossings, Applicant will furnish to the HCPD a certificate of insurance (or other security approved by the HCPD) payable to Hidalgo County and protecting Hidalgo County (as an additional named insured) against any claims for personal injuries or damages to property resulting from the operations of Applicant, its agents, servants, employees, and contractors under this permit. Insurance is to be supplied in accordance with the attached Schedule A.

8. Hidalgo County makes no warranties, expressed or implied, in the granting of this permit; nor does Hidalgo County purport to grant any property interest or exclusive privileges whatsoever by granting such permit. It is specifically understood that Hidalgo County is not the agent for, nor does it act for, the fee owners or any persons or entities having any right, or title to possession of the land upon which Hidalgo County's easement or other property interest is located. Furthermore, in granting this permit Hidalgo County makes no representation or warranty that it has any property interest, including, but not limited to, an easement or right of way, in the land upon which Applicant constructs, maintains, repairs, or modifies the pipelines or utilities, made the subject of this application, nor does Hidalgo County make any representation or warranty as to the validity, quality or extent of such property interest, if any. Applicant acknowledges its understanding that Hidalgo County in granting this permit, does not convey or grant to Applicant any rights, title or interest for which is has no legal authority to grant or convey.
9. Applicant binds itself to comply with all federal, state, and local laws or regulations and will obtain all necessary permits from all local and federal agencies required by law before installation or construction is begun.



## Hidalgo County Planning Department

**T.J. Arredondo, CFM**  
*Director of Planning*

### Main Office

2818 S. Business 281  
Edinburg, Texas 78539  
Phone (956) 318-2840  
Fax (956) 318-2844

### Precinct No. 1 Substation

1900 Joe Stephens Ave. Ste. A  
Weslaco, Texas 78596  
Phone (956) 968-4734  
Fax (956) 973-7850

### Precinct No. 3 Substation

2401 N. Moorefield Road  
Mission, Texas 78572  
Phone (956) 205-7045  
Fax (956) 205-7049

## PIPELINE AND UTILITY PERMIT APPLICATION PACKET

10. Applicant will install its pipelines and utilities in a manner and location as shown in the plans and specifications filed with HCPD in support of this application for permit. Hidalgo County Planning Department's representative may at any time make such inspection as such engineer or other representation may deem necessary to assure that the construction of the pipeline or utilities is in accordance with the plans and specifications submitted, and said engineer or representative shall have the right to temporarily suspend Applicant's work if necessary, while such inspection is being made. Should Applicant not install the pipelines or utilities in accordance with the terms and conditions of this permit, Applicant agrees that Hidalgo County shall have the right to require, at Applicant's expense, the removal of the pipelines and utilities and its replacement in conformance to said plans and specifications and conditions of this permit. Hidalgo County may revoke this permit and suspend all work hereunder if it is determined by Hidalgo County that the pipelines or utilities are not being installed in accordance with such plans and specifications and conditions of this permit. The suspension or revocation of this permit shall not be a basis for a claim for damages against Hidalgo County.

11. Except in emergency situations where it is necessary to protect life and property, Applicant will not make any change, modification, or alteration in or to the pipelines or utilities without first securing a new or amended permit from Hidalgo County prior to the making of any such change. Applicant will maintain the pipelines or utilities hereby authorized in good and safe condition, and in accordance with plans, specifications, and this permit.

12. Applicant agrees to pay HCPD a permit fee to cover administrative costs in the amount of **\$500.00**, plus a reimbursement to HCPD for any necessary engineering fees which may be incurred for the study and processing of the Application. This fee will permit a single pipeline or utility to be within County right-of-way. Applicant further agrees to pay an additional fee of **\$500.00** for each additional line included in permit application at the same location; however, more than one location may be included in a single application.

Requests to lay additional line or lines, not included in an initial permit application, must be made by separate application, with new permit fees paid accordingly and support data provided.



## Hidalgo County Planning Department

**T.J. Arredondo, CFM**  
*Director of Planning*

### Main Office

2818 S. Business 281  
Edinburg, Texas 78539  
Phone (956) 318-2840  
Fax (956) 318-2844

### Precinct No. 1 Substation

1900 Joe Stephens Ave. Ste. A  
Weslaco, Texas 78596  
Phone (956) 968-4734  
Fax (956) 973-7850

### Precinct No. 3 Substation

2401 N. Moorefield Road  
Mission, Texas 78572  
Phone (956) 205-7045  
Fax (956) 205-7049

## PIPELINE AND UTILITY PERMIT APPLICATION PACKET

Permit fees may be waived where Applicant is a state, county, municipality, or a special political subdivision.

13. The Applicant is allowed one hundred twenty days (120) from the granting of the permit to start construction of the pipelines or utilities crossings. Once started, the Applicant is allowed ninety (90) days to complete all work under such permit. All construction must be completed within two hundred ten (210) days from the date of issuance of permit. Upon application, extension of the time periods set forth in this paragraph may be granted by the Hidalgo County Commissioners Court. Such applications for extension must be received by HCPD at least thirty days before the expiration of the two hundred ten (210) days period. A new permit fee, in accordance with Paragraph 12 hereof, will be charged for each extension granted.

Construction of any pipeline or utility crossing will not begin until written approval has been given by HCPD.

14. All provisions of the Pipeline and Utility Permit Administration Policy of Hidalgo County, if any, and all amendments thereto, are hereby incorporated herein as part of the terms and conditions of this permit for all purposes.
15. Applicant warrants and represents that it has secured from all fee owners of the involved property an easement or other property rights to construct, repair or modify the pipeline or utility in the manner set forth herein.
16. This Pipeline and Utility Permit if granted by Hidalgo County is subject to any and all other requirements, specifications and conditions listed in Exhibit A attached hereto.
17. Hidalgo County requires all coordinates of all utility crossings. Horizontal datum to be in NAD 83 State Plane Texas South 4205 feet and vertical datum in NAVD 88 Geoid 12a.



**Hidalgo County  
Planning  
Department**

**T.J. Arredondo, CFM**  
*Director of Planning*

**Main Office**

2818 S. Business 281  
Edinburg, Texas 78539  
Phone (956) 318-2840  
Fax (956) 318-2844

**Precinct No. 1 Substation**

1900 Joe Stephens Ave. Ste. A  
Weslaco, Texas 78596  
Phone (956) 968-4734  
Fax (956) 973-7850

**Precinct No. 3 Substation**

2401 N. Moorefield Road  
Mission, Texas 78572  
Phone (956) 205-7045  
Fax (956) 205-7049

**PIPELINE AND UTILITY PERMIT APPLICATION PACKET**

18. This permit constitutes the entire agreement between the parties with regard to the subject matter hereof, and all prior agreements, representations, and negotiations between the parties regarding the subject matter are hereby superseded. This permit shall not be altered or amended except by an agreement in writing executed by the parties hereto.

19. Applicant warrants and represents that its undersigned representative has full authority to bind Applicant to the terms and conditions of the foregoing Application and Agreement for Pipeline or Utility Permit.

DATED this 5<sup>th</sup> day of October, 20 22.

Robert Martinez  
(Name of Applicant – Printed or Typed)

By: Robert Martinez  
Signature

Title: Construction Coordinator

STATE OF TEXAS  
COUNTY OF HIDALGO

SUBSCRIBED AND SWORN TO before me the Applicant,  
Robert Martinez, on this 5<sup>th</sup> day of October, 2022,  
to which witness my hand and seal of office.

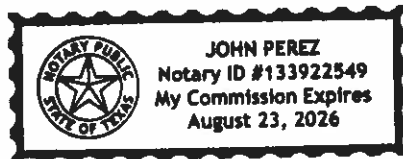

[Signature]  
Notary Public for the State of Texas  
My Commission Expires: August 23, 2026



**Hidalgo County  
Planning  
Department**

**T.J. Arredondo, CFM**  
*Director of Planning*

**Main Office**

2818 S. Business 281  
Edinburg, Texas 78539  
Phone (956) 318-2840  
Fax (956) 318-2844

**Precinct No. 1 Substation**

1900 Joe Stephens Ave. Ste. A  
Weslaco, Texas 78596  
Phone (956) 968-4734  
Fax (956) 973-7850

**Precinct No. 3 Substation**

2401 N. Moorefield Road  
Mission, Texas 78572  
Phone (956) 205-7045  
Fax (956) 205-7049

**PIPELINE AND UTILITY PERMIT APPLICATION PACKET**

**APPROVAL OF APPLICATION BY  
HIDALGO COUNTY PLANNING DEPARTMENT**

Came on for consideration this \_\_\_\_\_ day of \_\_\_\_\_,  
20\_\_\_\_. The above and foregoing Application for Pipeline and Utility  
Permit, and after consideration of the same by the Hidalgo County  
Commissioners Court, said Application and Agreement for Pipeline or  
Utility Permit is hereby APPROVED.

HIDALGO COUNTY:

\_\_\_\_\_  
Richard F. Cortez, County Judge



**Hidalgo County  
Planning  
Department**

**T.J. Arredondo, CFM**  
*Director of Planning*

**Main Office**

2818 S. Business 281  
Edinburg, Texas 78539  
Phone (956) 318-2840  
Fax (956) 318-2844

**Precinct No. 1 Substation**

1900 Joe Stephens Ave. Ste. A  
Weslaco, Texas 78596  
Phone (956) 968-4734  
Fax (956) 973-7850

**Precinct No. 3 Substation**

2401 N. Moorefield Road  
Mission, Texas 78572  
Phone (956) 205-7045  
Fax (956) 205-7049

**PIPELINE AND UTILITY PERMIT APPLICATION PACKET**

**EXHIBIT A**

(Please insert description of project location and supporting documents for proposed utility work)



# CERTIFICATE OF LIABILITY INSURANCE

DATE (MM/DD/YYYY)

6/16/2022

THIS CERTIFICATE IS ISSUED AS A MATTER OF INFORMATION ONLY AND CONFERS NO RIGHTS UPON THE CERTIFICATE HOLDER. THIS CERTIFICATE DOES NOT AFFIRMATIVELY OR NEGATIVELY AMEND, EXTEND OR ALTER THE COVERAGE AFFORDED BY THE POLICIES BELOW. THIS CERTIFICATE OF INSURANCE DOES NOT CONSTITUTE A CONTRACT BETWEEN THE ISSUING INSURER(S), AUTHORIZED REPRESENTATIVE OR PRODUCER, AND THE CERTIFICATE HOLDER.

**IMPORTANT:** If the certificate holder is an ADDITIONAL INSURED, the policy(ies) must have ADDITIONAL INSURED provisions or be endorsed. If SUBROGATION IS WAIVED, subject to the terms and conditions of the policy, certain policies may require an endorsement. A statement on this certificate does not confer rights to the certificate holder in lieu of such endorsement(s).

<b>PRODUCER</b> GSM Insurors PO Box 1478 Rockport TX 78381	<b>CONTACT NAME:</b> <b>PHONE (A/C, No, Ext):</b> 361-729-5414		<b>FAX (A/C, No):</b> 361-729-3817
	<b>E-MAIL ADDRESS:</b> info@gsminsurors.com		
<b>INSURER(S) AFFORDING COVERAGE</b>			<b>NAIC #</b>
<b>INSURED</b> Broadband Telecom Services, Inc 10929 S FM 1187 Ft Worth TX 76126	<b>INSURER A:</b> Continental Insurance Co		35289
	<b>INSURER B:</b> Continental Casualty Co		20443
	<b>INSURER C:</b> American Casualty Company		
	<b>INSURER D:</b> Navigators Ins Company		42307
	<b>INSURER E:</b>		
<b>INSURER F:</b>			

**COVERAGES**

CERTIFICATE NUMBER: 875144941

REVISION NUMBER:

THIS IS TO CERTIFY THAT THE POLICIES OF INSURANCE LISTED BELOW HAVE BEEN ISSUED TO THE INSURED NAMED ABOVE FOR THE POLICY PERIOD INDICATED. NOTWITHSTANDING ANY REQUIREMENT, TERM OR CONDITION OF ANY CONTRACT OR OTHER DOCUMENT WITH RESPECT TO WHICH THIS CERTIFICATE MAY BE ISSUED OR MAY PERTAIN, THE INSURANCE AFFORDED BY THE POLICIES DESCRIBED HEREIN IS SUBJECT TO ALL THE TERMS, EXCLUSIONS AND CONDITIONS OF SUCH POLICIES. LIMITS SHOWN MAY HAVE BEEN REDUCED BY PAID CLAIMS.

INSR LTR	TYPE OF INSURANCE	ADDL INSD	SUBR WVD	POLICY NUMBER	POLICY EFF (MM/DD/YYYY)	POLICY EXP (MM/DD/YYYY)	LIMITS	
A	<input checked="" type="checkbox"/> COMMERCIAL GENERAL LIABILITY <input type="checkbox"/> CLAIMS-MADE <input checked="" type="checkbox"/> OCCUR GEN'L AGGREGATE LIMIT APPLIES PER: <input type="checkbox"/> POLICY <input checked="" type="checkbox"/> PRO-JECT <input type="checkbox"/> LOC <input type="checkbox"/> OTHER:			7018060842	2/7/2022	2/7/2023	EACH OCCURRENCE	\$ 1,000,000
							DAMAGE TO RENTED PREMISES (Ea occurrence)	\$ 300,000
							MED EXP (Any one person)	\$ 10,000
							PERSONAL & ADV INJURY	\$ 1,000,000
							GENERAL AGGREGATE	\$ 2,000,000
							PRODUCTS - COMP/OP AGG	\$ 2,000,000
								\$
B	<input checked="" type="checkbox"/> AUTOMOBILE LIABILITY <input checked="" type="checkbox"/> ANY AUTO <input type="checkbox"/> OWNED AUTOS ONLY <input type="checkbox"/> SCHEDULED AUTOS <input checked="" type="checkbox"/> HIRED AUTOS ONLY <input checked="" type="checkbox"/> NON-OWNED AUTOS ONLY			7018060839	2/7/2022	2/7/2023	COMBINED SINGLE LIMIT (Ea accident)	\$ 1,000,000
							BODILY INJURY (Per person)	\$
							BODILY INJURY (Per accident)	\$
							PROPERTY DAMAGE (Per accident)	\$
								\$
D	<input type="checkbox"/> UMBRELLA LIAB <input checked="" type="checkbox"/> OCCUR <input checked="" type="checkbox"/> EXCESS LIAB <input type="checkbox"/> CLAIMS-MADE DED RETENTION \$			HO22EXCZ01BDGIV	2/7/2022	2/7/2023	EACH OCCURRENCE	\$ 5,000,000
							AGGREGATE	\$ 5,000,000
								\$
C	<b>WORKERS COMPENSATION AND EMPLOYERS' LIABILITY</b> ANY PROPRIETOR/PARTNER/EXECUTIVE OFFICER/MEMBER EXCLUDED? (Mandatory in NH) If yes, describe under DESCRIPTION OF OPERATIONS below	Y/N N	N/A	7018331561	2/7/2022	2/7/2023	<input checked="" type="checkbox"/> PER STATUTE <input type="checkbox"/> OTHER	
							E.L. EACH ACCIDENT	\$ 1,000,000
							E.L. DISEASE - EA EMPLOYEE	\$ 1,000,000
							E.L. DISEASE - POLICY LIMIT	\$ 1,000,000

**DESCRIPTION OF OPERATIONS / LOCATIONS / VEHICLES (ACORD 101, Additional Remarks Schedule, may be attached if more space is required)**

Certificate Holder is Additional Insured by Blanket Endorsement to the General Liability & Auto Liability and has Blanket Waiver of Subrogation in its favor on all policies with respects Named Insured's Work contingent upon requirements in previously executed valid Written Contract. Navigators \$5,000,000 Excess Liability is Excess of underlying General Liability, Auto Liability and Employer's Liability.

**CERTIFICATE HOLDER****CANCELLATION**

Hidalgo County Planning Department  
 2818 S. Business 281  
 Edinburg TX 78539

SHOULD ANY OF THE ABOVE DESCRIBED POLICIES BE CANCELLED BEFORE THE EXPIRATION DATE THEREOF, NOTICE WILL BE DELIVERED IN ACCORDANCE WITH THE POLICY PROVISIONS.

AUTHORIZED REPRESENTATIVE

© 1988-2015 ACORD CORPORATION. All rights reserved.

**AFTER**  
**NODE: SM179**  
**MAP: 26.3170, -98.3916**  
**TEX-MEX-RGV**

Survey Info			
PRISM ID:	<a href="#">3607555 - Map</a>	Originator:	Erme y, Bobby D
Construction Type:	Greenfield	Const Supervisor:	Castro, Osiel T
Process State:	S2 - Survey in Progress	Construction Coordinator:	Ybarra, Estevan (P2186607) - p2186607
Project Status:	In Progress	Total Project Cost:	48186.25
Input Date:	05/05/22	Total Passings:	52
Hub:	SM - MISSION-TX	Tentative Svc Dt:	
Node:	SMZ1 - SMZ1	Entity:	1904
Construction Due Date:		Coax:	N/A
		Fiber:	N/A
		Business/Company Name:	GF Carrizales II Subdivision
		Address:	7460 WESTERN RD
		City/State/Zip:	MISSION, TX 78574
		Cross Street:	
		Prop Dev Status:	
		Coax:	N/A
		Fiber:	N/A
		Construction Survey Completed:	Yes

Project Design			
Entity:	1904-South Texas-TX	Management Area:	TR3-South Texas
Map Grid:	<a href="#">Lat: 26 Deg 18' 55" N, Long: 0 Deg 0' 0" E</a>	Services from Survey:	
Project Approved Date:		Orig Tentative Svc Date:	Est Fiber Splice Date:
Construction Sub Type:		Node Capacity:	Special Initiative:

[Design Log](#) [New Design](#)

Design Number

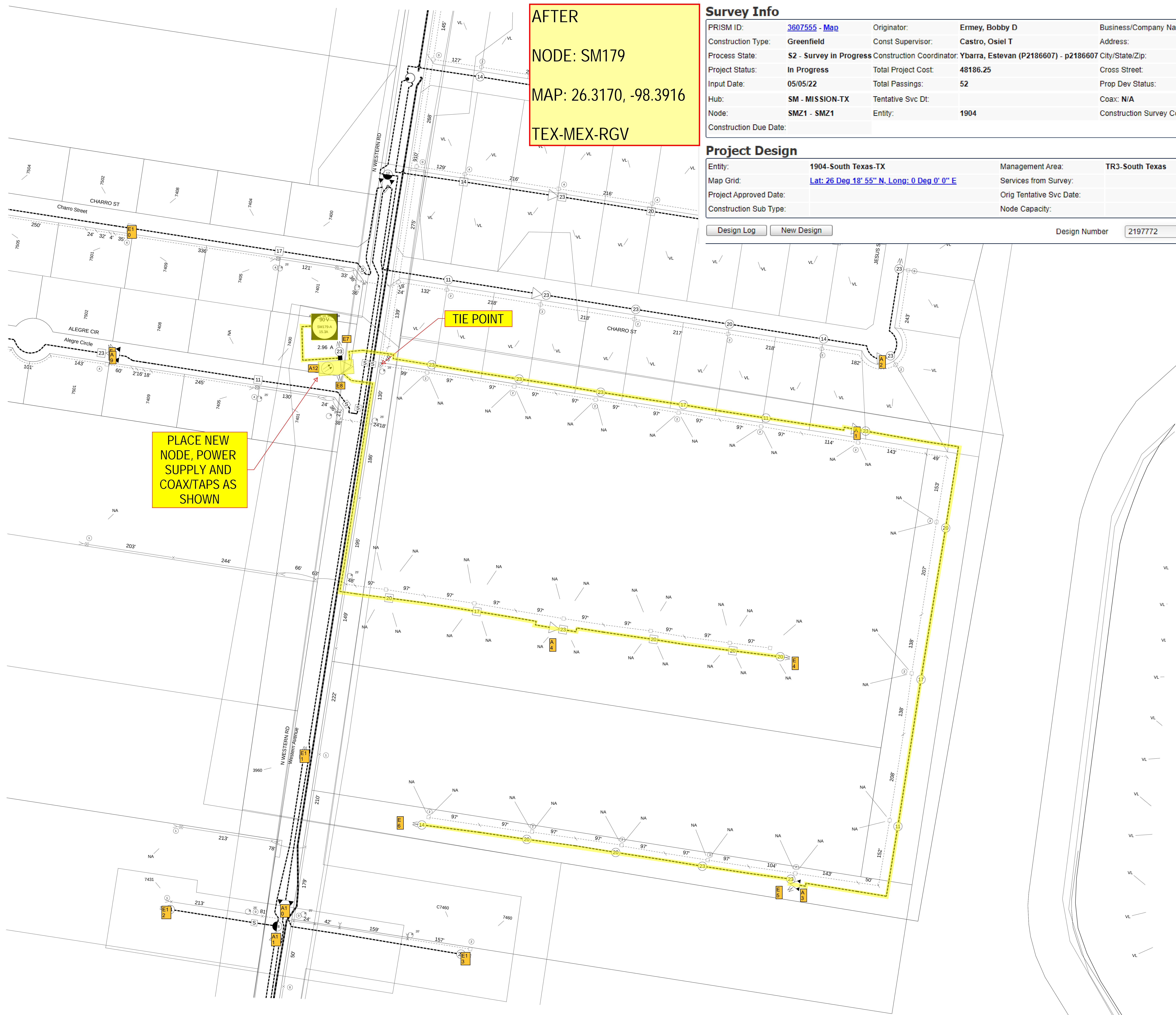

PLACE NEW  
 NODE, POWER  
 SUPPLY AND  
 COAX/TAPS AS  
 SHOWN

TIE POINT

## ACTIVES

TAG	NAME	MODEL	INPUT				OUTPUT				FWD PAD	FWD EQ	RTN PAD	RTN EQ	CASCADE	DLA	POWER SUPPLY	VOLTAGE	CURRENT
A1	SM179-1A	870 LE@50	22.05	29.99	22.46	19.44	50	38	18.5	18.5	1	18	15	5	1	1111	SM179-A	88.2	1.23
A2	SMZ1A-26	870 LE@47	26.1	29.2	23.9	21.7	47	35	18.5	18.5	9	10.5	15	4	3	875	SMZ1A	68.2	0.67
A3	SM179-1B	870 HGDLE@50	17.41	28.75	27.06	23.3	50	38	18.5	18.5	5	15	10	6	2	1381	SM179-A	87.1	0.69
A4	SM179-2A	870 LE@50	26.46	31.68	20.78	18.09	50	38	18.5	18.5	5	13.5	17	5	1	1069	SM179-A	89	0.54
A5	SMZ1A-25	870 LE@47	19.79	25.08	27.96	25.49	47	35	18.5	18.5	2	13.5	11	4	2	923	SMZ1A	68.9	1.34
A6	SMZ1A-23	870 LE@47	22.97	23.29	29.91	28.47	47	35	18.5	18.5	5	7.5	9	3	2	589	SMZ1A	71.1	0.67
A7	SMZ1A-24	870 LE@47	23.52	23.79	29.4	27.72	47	35	18.5	18.5	6	7.5	9	3	2	633	SMZ1A	71	0.67
A8	SMZ1A-28	870 HGD	24.7	18.14	35.22	34.95	50	38	18.5	18.5	13	10.5	3	1	2	553	SMZ1A	69.4	2.12
A9	SMZ1A-29	870 HGD	15.24	24.75	31.39	27.64	50	38	18.5	18.5	3.5	12	7	6	3	1063	N/A	68.6	0
A10	SMZ1A-34	870 HGD	11.62	26.15	29.77	24.8	50	38	18.5	18.5	0.5	18	9	8	3	1772	N/A	N/A	N/A
A11	SMZ1A16	870 LE@50	26.2	28.35	24.76	22.73	50	38	18.5	18.5	5	10.5	13	4	3	888	SMZ1A	66.4	0.67
A12	SM179	OM4100 F4	N/A				50	38	15	15	N/A	N/A	N/A	N/A	N/A	0	SM179-A	89.7	2.96

## EOL

TAG	HIGH	LOW
E1	16	15.6
E2	18.3	10.6
E3	18.1	18.8
E4	16.89	13.77
E5	50	38
E6	16.31	17.4
E7	25.4	14.05
E8	50	38
E9	50	38
E10	22.08	25.88
E11	19.35	14.61
E12	24.13	17.12
E13	21.9	16.15

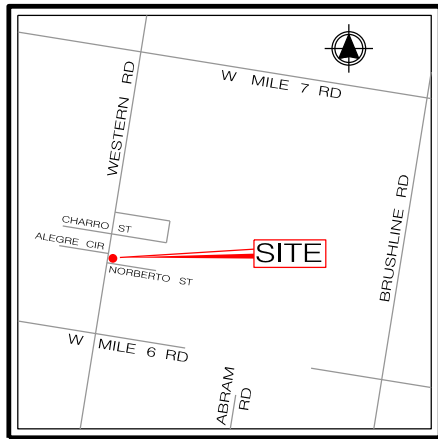

LOCATION MAP  
NTS

NOTE:  
NEW PROPOSED SPECTRUM POLE TO BE INSTALLED APPROX. 63' NORTH OF INTERSECTION WESTERN RD & NORBERTO ST. ON THE EAST SIDE OF WESTERN RD. 12' NORTH OF EXISTING POWER POLE. 2' IN ROW & 38' FROM EOP ACROSS STREET FROM ADDRESS 7577 WESTERN RD.

NOTE:  
DEPTH OF EXISTING BURIED UTILITIES TO BE DETERMINED BY EXCAVATION CONTRACTOR.



LAT: 26.318102 LONG: -98.393299  
NEW PROPOSED SPECTRUM POLE  
2' IN ROW & 38' FROM EOP

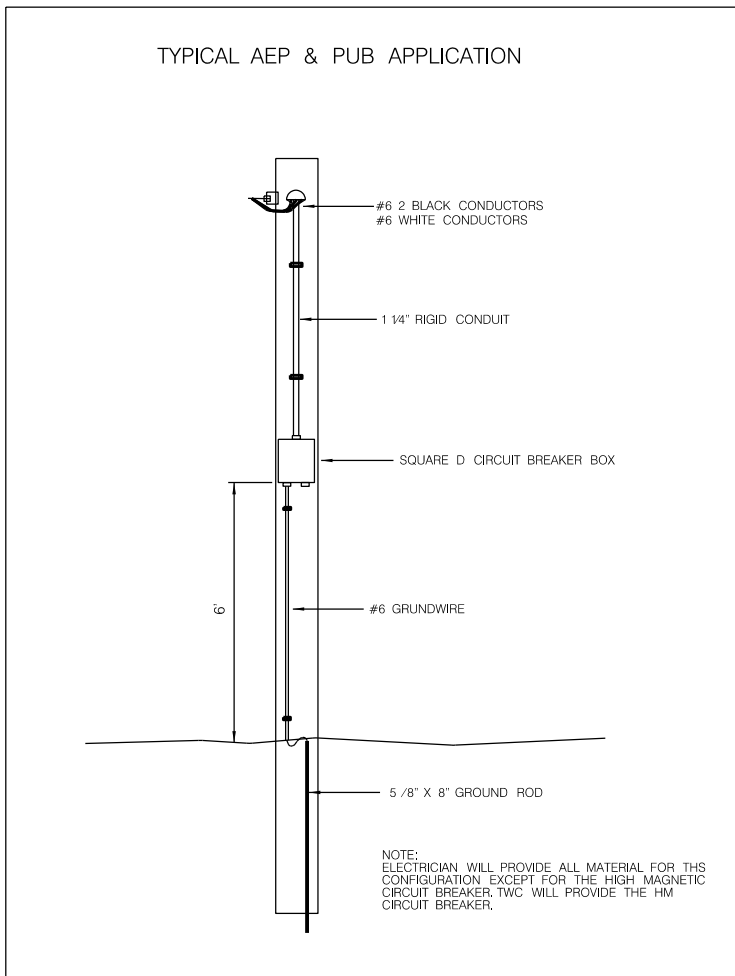

NOTE:  
ELECTRICIAN WILL PROVIDE ALL MATERIAL FOR THIS CONFIGURATION EXCEPT FOR THE HIGH MAGNETIC CIRCUIT BREAKER. TWC WILL PROVIDE THE HM CIRCUIT BREAKER.

NOTE:  
THE INFORMATION AND GRAPHICS DEPICTED ON THIS SHEET HAVE BEEN PLOTTED FROM AVAILABLE RECORDS AND FIELD OBSERVATIONS BUT ARE NOT NECESSARILY EXACT. IT IS THE EXCAVATOR'S RESPONSIBILITY TO VERIFY AND FIELD LOCATE ALL UNDERGROUND OBSTRUCTIONS AND UTILITIES PRIOR TO EXCAVATION. COMPLETE REPAIR OF ANY AND ALL DAMAGES INCURRED SHALL BE AT THE EXPENSE OF THE EXCAVATOR.



PROJECT CARRIZALES II SUBDIVISION			
LOCATION ACROSS STREET FROM 7577 WESTERN RD			
DRAWN TXUE	DATE 10-04-22	SCALE 1" = 100'	APPLICATION HIDALGO COUNTY PERMIT
NODE # SM179	CITY MISSION, TX	PAGE 1 OF 1	APPROVED BY: FRED DAVILA

LEGEND			
● FOREIGN POLE	— W — WATER UTILITY	— SS — SANITARY SEWER UTIL.	⊗ DOWN GUY & ANCHOR
⊙ CONCRETE POLE	— G — NATURAL GAS UTILITY	— UG — UNDERGROUND	⊗ SIDEWALK GUY & ANC.
⊚ STEEL POLE	— C — CABLE TV UTILITY	— ROW — RIGHT OF WAY LINE	⊚ HANDHOLE
⊗ TRANSFORMER POLE	— T — TELEPHONE UTILITY	— EOP — EDGE OF PAVEMENT	— OVERLASH
⊗ POWER POLE	— E — ELECTRIC UTILITY	— SW — EDGE OF SIDEWALK	— NEW BUILD

REVISIONS	
DATE	COMMENTS

PREPARED BY: