

A-1 Facility Services

Delivery Change Order Work Proposal

For

Hidalgo County

V 1

Date: 1-03-22

Title: Hidalgo County
Health Dept.
Edinburg Clinic Renovation

Location: Expwy Richardson
Edinburg, TX

We are pleased to provide you and the district with our **Delivery Order Work Proposal** for the **HCO Health Dept. Edinburg Clinic Renovation Project.** Please see accompanying scope of work and RS Means Estimate. This pricing is provided to you under our TIPS JOC contract **JOC TIPS RCSP 211001 (co-ef 1.00)**. Please note that our price has a favorable buyout extended price discount adjustment to the list price.

If you have any questions concerning this proposal or we may be of assistance in any other way, please do not hesitate to call on us. We look forward to working with you.

Warmest Regards,

Gustavo Grajales ASPE

Description of Proposed Added Scope to Work

Project Labor Cost: \$114,308.81 Excludes Bond Cost

\$ 5,353.00 Bond Cost add to above.

Scope of Work:

Provide all material, labor, and equipment, per this scope of work to:

See accompanying Diagrams

Note: New partition walls to be finished to match existing surrounding conditions of like finishes. Match to closest possible.

- Create new breakroom space.
- Remove/demolish existing restrooms in are of new breakroom and relocate to indigent office space. Entry to these restrooms will be from breakroom with a vestibule foyer transition. To include all plumbing, work, concrete work, site slab work, and fixture.
- At indigent office remove existing door and infill with partition. Install new speak window. Install new 3' x 7' door system at hallway.
- At North hallway from main waiting room, install new partition wall with new 3' x 7' door system. Remove existing partition wall section and install 2 new 3' x 7' door systems for entry to indigent office spaces at East and west elevation wall of hallway.
- At waiting room, create new Patient Education and Vaccination Room space by installation of new East/West and North/South elevation partition walls. Each new wall to have new entry by 3' x 7' door system
- Provide and install new partition wall new 3' x 7' door system at newly create hallway in waiting room from the creation on Patient Education and Vaccination Room space.
- At front office install new speak window.
- Pressure wash and paint exterior wall elevations.

General Task Specific

- +- 600 SF ACT. Re use and retro fit existing lay-in and or lighting in general.
- 9 new 3 X 7 hollow metal frame solid wood door systems hardware.
- No new electrical service outlets, lights, or switches. Exiting services to relocated and retrofitted.
- "Minor" flooring repair, as necessary.
- New cove base to match at ne walls.

Clarification:

Access to work areas 7 day per week as needed and necessary.

Matching of surrounding existing color and conditions as applicable will be to best match possible with no exact match guaranteed.

No work on change variances (orders) will be performed without written and documented authorized documentation.

Restrooms not to ADA standards per owner request.

Exclusions:

- Hazardous material surveys, work, and clearances are not included in this scope of work and are to be completed by others.
- Work due to unforeseen or unknown conditions.
- Acts of God or Force Majeure
- Work not identified above
- Permits

General Assumptions:

- Hazardous material work or clean up is neither expected nor priced in this proposal.
- Special lead time equipment and materials.
- Interface with existing structure: *Yes*
- Possible disruption to building personnel and plans to minimize: Areas to be inaccessible to general public during installation time of section.
- Outages: N/A
- Special training/Orientation Requirements: Safety
- Work to be performed during non-normal hours: Yes
- Outage Coordination: HCO Health and AI designees
- Schedule Issues: Lead Time Materials
- Special Issues: None
- Special Security Requirements: Protection of general public

- Significant Milestones: Material Delivery
- Hazardous Materials: None

Quality Assurance Considerations: A pre-final inspection will be held 1 day prior to final achieved substantial completion date. Any items identified will be corrected before request for final inspection.

I. STAFFING PLAN:

- | | |
|--------------------------------|--|
| A. Project Manager: <u>TBA</u> | C. Quality Control Coordinator: <u>TBA</u> |
| B. Superintendent: <u>TBA</u> | D. Subcontractors: <u>TBA</u> |

II. PERMITS: To be provided by General Contractor and Transporter.

- | | | |
|-------------|----------|----------|
| A. Demo: | | |
| B. Burning: | Welding: | Cutting: |

SUBMITTAL REQUIREMENTS: TBD

III. CONSTRUCTIBILITY & VALUE ENGINEERING SUGGESTIONS:

None

Submitted By:	Approved by:
<u>Gustavo E. Grajales</u>	_____ Date _____

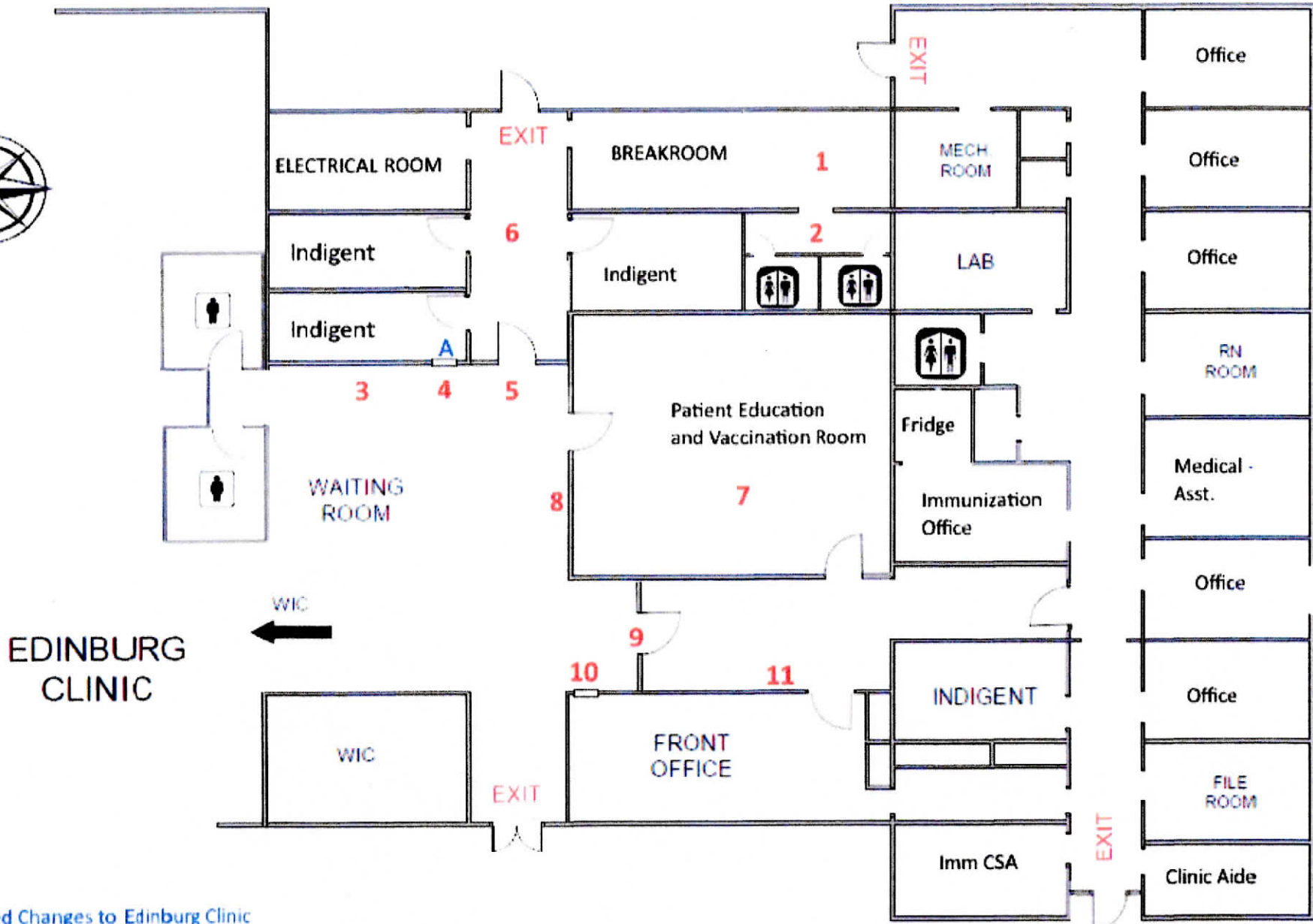

Proposed Changes to Edinburg Clinic

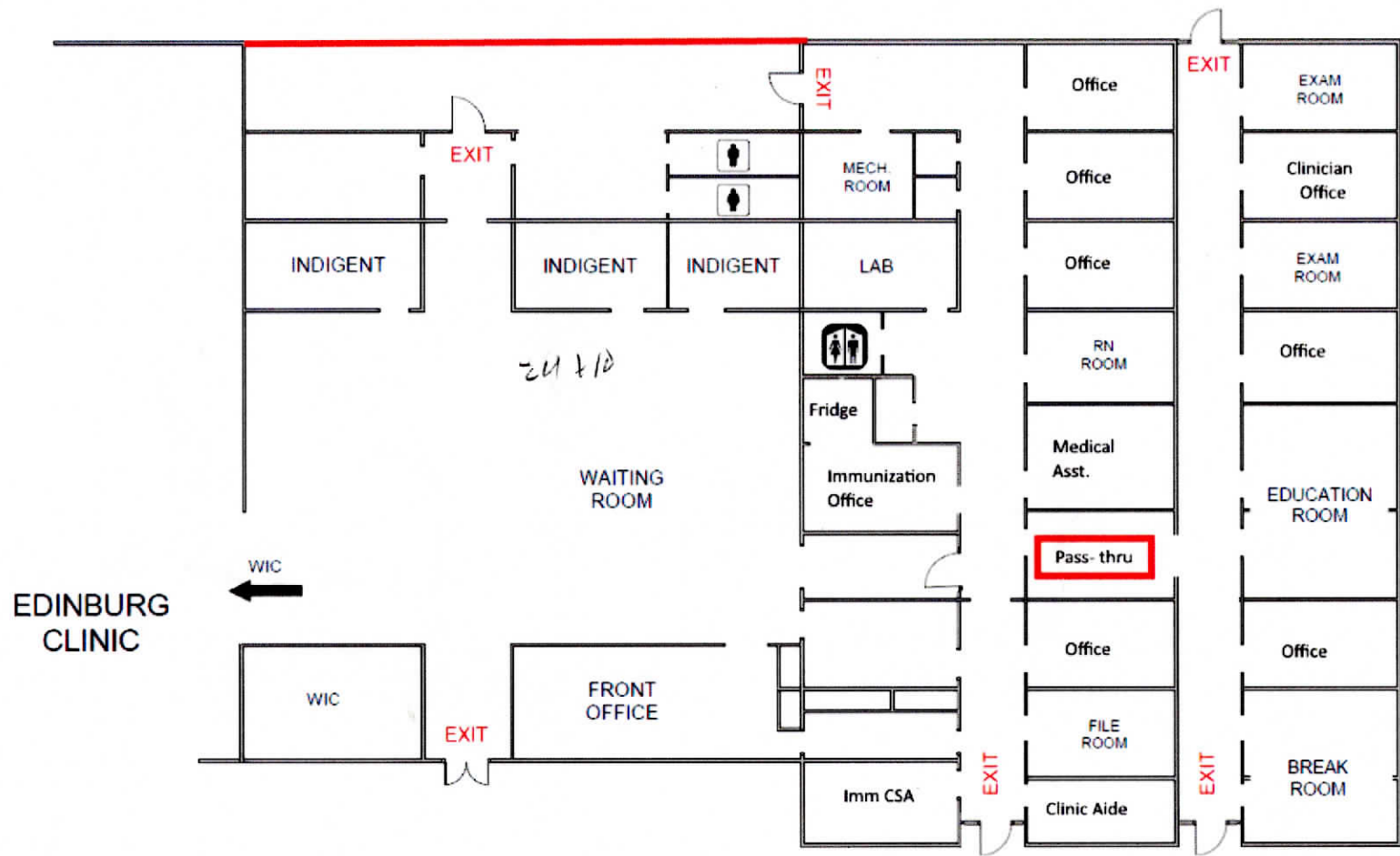

EDINBURG CLINIC



Cost Estimate Report

Hidalgo County

Edinburg, TX, 78539

Date: 01/03/2023

HCO Helath Dept Edinburg Clinic Remodel

Year 2023

Unit Detail Report

Prepared By: gus grajales

A1 FACILITY SERVICES

LineNumber	Description	Quantity	Unit	Total Incl. O&P	Ext. Total Incl. O&P
Division 01 General Requirements					
013113200160	Field personnel, general purpose laborer, average	12.00	Week	\$1,602.00	\$19,224.00
013113200200	Field personnel, project manager, average	3.00	Week	\$3,749.00	\$11,247.00
013113200260	Field personnel, superintendent, average	8.00	Week	\$3,725.00	\$29,800.00
019313030320	Prepare and re-surface old or coated concrete floor, floor level	200.00	S.F.	\$3.43	\$686.00
Division 01 General Requirements Subtotal					\$60,957.00
Division 02 Existing Conditions					
024119190840	Selective demolition, rubbish handling, dumpster, 40 C.Y., 10 ton capacity, weekly rental, includes one dump per week, cost to be added to demolition cost	8.00	Week	\$850.00	\$6,800.00
024119259000	Selective demolition, saw cutting, minimum labor/equipment charge	2.00	Job	\$301.54	\$603.08
Division 02 Existing Conditions Subtotal					\$7,403.08
Division 04 Masonry					
042210143150	Concrete block, back-up, lightweight, tooled joint one side, 2000 psi, 8" x 8" x 16", includes mortar and horizontal joint reinforcing every other course, excludes scaffolding, vertical reinforcing and grout	100.00	S.F.	\$8.23	\$823.00
042210149000	Concrete block, back-up, minimum labor/equipment charge	3.00	Job	\$389.03	\$1,167.09
Division 04 Masonry Subtotal					\$1,990.09
Division 07 Thermal and Moisture Protection					
072116200020	Blanket insulation, for walls or ceilings, kraft faced fiberglass, 3-1/2" thick, R11, 15" wide	150.00	S.F.	\$0.90	\$135.00

LineNumber	Description	Quantity	Unit	Total Incl. O&P	Ext. Total Incl. O&P
Division 07	Thermal and Moisture Protection Subtotal				\$135.00
Division 08	Openings				
081213130100	Frames, steel, knock down, hollow metal, single, 16 ga., up to 5-3/4" deep, 3'-0" x 7'-0"	9.00	Ea.	\$260.16	\$2,341.44
081416090210	Door, wood, architectural, flush, interior, hollow core, 7 ply, birch face, 3'-0" x 7'-0" x 1-3/4" thick	9.00	Ea.	\$305.96	\$2,753.64
087120440550	Door hardware, anti-ligature cylindrical lockset, lever handle passage set, US32D	9.00	Ea.	\$408.57	\$3,677.13
087120900200	Door hardware, hinges, full mortise, average frequency, steel base, USP, 6" x 6"	9.00	Pair	\$85.29	\$767.61
Division 08	Openings Subtotal				\$9,539.82
Division 09	Finishes				
090190930150	Surface preparation, exterior, per side, power wash, based on 2500 lb operating pressure, metal, flush,	9,000.00	S.F.	\$0.18	\$1,620.00
092116335000	Partition wall, interior, water resistant, taped both sides, installed on & incl. 2" x 4" wood studs, 24" OC, 8' to 12' high, 5/8" gypsum drywall	1,100.00	S.F.	\$4.58	\$5,038.00
095123300800	Complete suspended ceilings, mineral fiber, lay-in board, 2' x 2' x 3/4", on 15/16" T bar suspension, include standard suspension system, excl. 1-1/2" carrier channels	675.00	S.F.	\$5.10	\$3,442.50
095323300900	Carrier channels, for ceilings with recessed lighting fixtures, add	675.00	S.F.	\$1.27	\$857.25
096519197250	Flooring, vinyl composition tile, marbled, 12" x 12" x 3/32"	230.00	S.F.	\$2.23	\$512.90
097730100040	Fiberglass reinforced plastic panel, on walls, adhesive mounted, fire rated, embossed surface, .090" thick	800.00	S.F.	\$4.76	\$3,808.00
099113900370	Paints & coatings, walls, concrete masonry units (CMU), smooth surface, first coat, latex, brushwork	9,000.00	S.F.	\$0.45	\$4,050.00
099113900380	Paints & coatings, walls, concrete masonry units (CMU), smooth surface, second coat, latex, brushwork	9,000.00	S.F.	\$0.31	\$2,790.00
099123740790	Paints & coatings, walls & ceilings, interior, concrete, drywall or plaster, zero voc latex, 2 coats, smooth finish, cut-in by brush	400.00	L.F.	\$0.39	\$156.00
099123740840	Paints & coatings, walls & ceilings, interior, concrete, drywall or plaster, zero voc latex, 2 coats, smooth finish, roller	5,800.00	S.F.	\$0.47	\$2,726.00
Division 09	Finishes Subtotal				\$25,000.65
Division 22	Plumbing				
220505100710	Fountains, sinks or lavatories, selective demolition	2.00	Ea.	\$28.45	\$56.90
220505100720	Water closets, selective demolition	2.00	Ea.	\$33.15	\$66.30
220505101200	Fixture, lavatory, wall hung, selective demolition, includes 10' piping	2.00	Ea.	\$39.87	\$79.74
220505101220	Fixture, counter top lavatory, disconnect and remove	2.00	Ea.	\$49.73	\$99.46

LineNumber	Description	Quantity	Unit	Total Incl. O&P	Ext. Total Incl. O&P
220505101420	Fixture, water closet, wall mounted, selective demolition	2.00	Ea.	\$56.90	\$113.80
220505109000	Plumbing, selective demolition, minimum labor/equipment charge	5.00	Job	\$199.36	\$996.80
224116130600	Lavatory, vanity top, porcelain enamel on cast iron, white, 20" x 18", includes trim	1.00	Ea.	\$552.89	\$552.89
224213133200	Water closet, bowl only, wall hung, rough-in, supply, waste and vent	2.00	Ea.	\$2,001.88	\$4,003.76
224213133362	Water closet, bowl only, floor mounted, tankless, with floor outlet, ADA, 1.28 gpf, includes flush valve and seat	2.00	Ea.	\$748.16	\$1,496.32
224216341980	Cup sink, laboratory, rough-in, supply, waste and vent	2.00	Ea.	\$908.60	\$1,817.20
Division 22	Plumbing Subtotal				\$9,283.17
Subtotal					\$114,308.81
General Contractor's Markup on Subs				0.00%	\$0.00
Subtotal					\$114,308.81
General Conditions				0.00%	\$0.00
Subtotal					\$114,308.81
General Contractor's Overhead and Profit				0.00%	\$0.00
Grand Total					\$114,308.81