

WR:86677328

Easement #:N/A

Reference S1
Latitude: 26.2906
Longitude: -98.1204

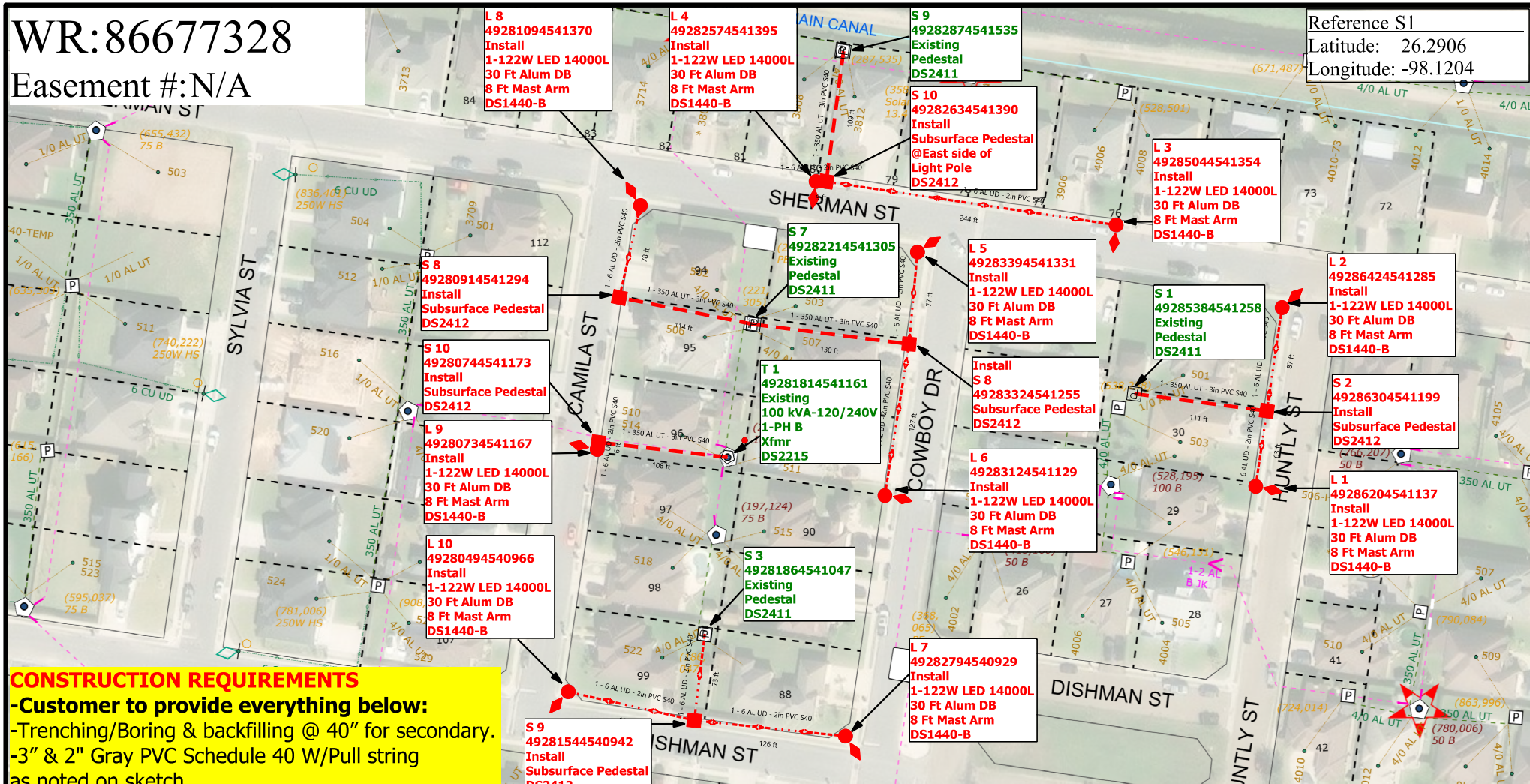

CONSTRUCTION REQUIREMENTS

- Customer to provide everything below:
- Trenching/Boring & backfilling @ 40" for secondary.
- 3" & 2" Gray PVC Schedule 40 W/Pull string as noted on sketch.
- 5ft. AEP Easement
- Contact AEP Inspector, 1-877-373-4858, for trenching/crossing inspections

S 9
49281544540942
Install
Subsurface Pedestal
DS2412

Note to Crew:
Update each pole ID tag with correct 14 digit GPS location number marked in **RED** which matches the XY coordinates obtained by GPS. **Blue** numbers refer to previous location ID
-CUSTOMER HIDALGO COUNTY-MARTIN MARTINEZ 956-292-7025
-INSTALL POLES/W LIGHTS WITH UG CONNECTION

COLOR CODE LEGEND
RED -New Facilities
GREEN -Existing/Transfer Facilities
BLUE -Facilities to Be Removed

Job Description: CUSTOMER SERVICE-CI-NEW SERVICE		WR: 86677328	
Customer: MARTIN MARTINEZ		WO: DCP0354899	
Location: 176 505 HUNTLY ST		Date Completed: 01/23/2024	
District: 176 - Edinburg		County: HIDALGO	
City: EDINBURG		Man Hours: 75.32	
Circuit / Station: 94SB5045/SOUTHEAST EDINBURG		Project ID: 100039	
N V: 12.47KV		Crew HQ: 11711	
Phases: B N		Tree Trimming: NO	
Drawn By: Carlos Vila		OWR: 86677328	
Office #: 956-283-2413		ESID: 10032789403072635	
Accessible: LIMITED		Scale: 1"=100'	
Issued for:		Page 1 of 1	

FINAL

Rev. N/A

