

Flood Insurance / FIRM – 1417 S. Watson Road, Mission TX 78574

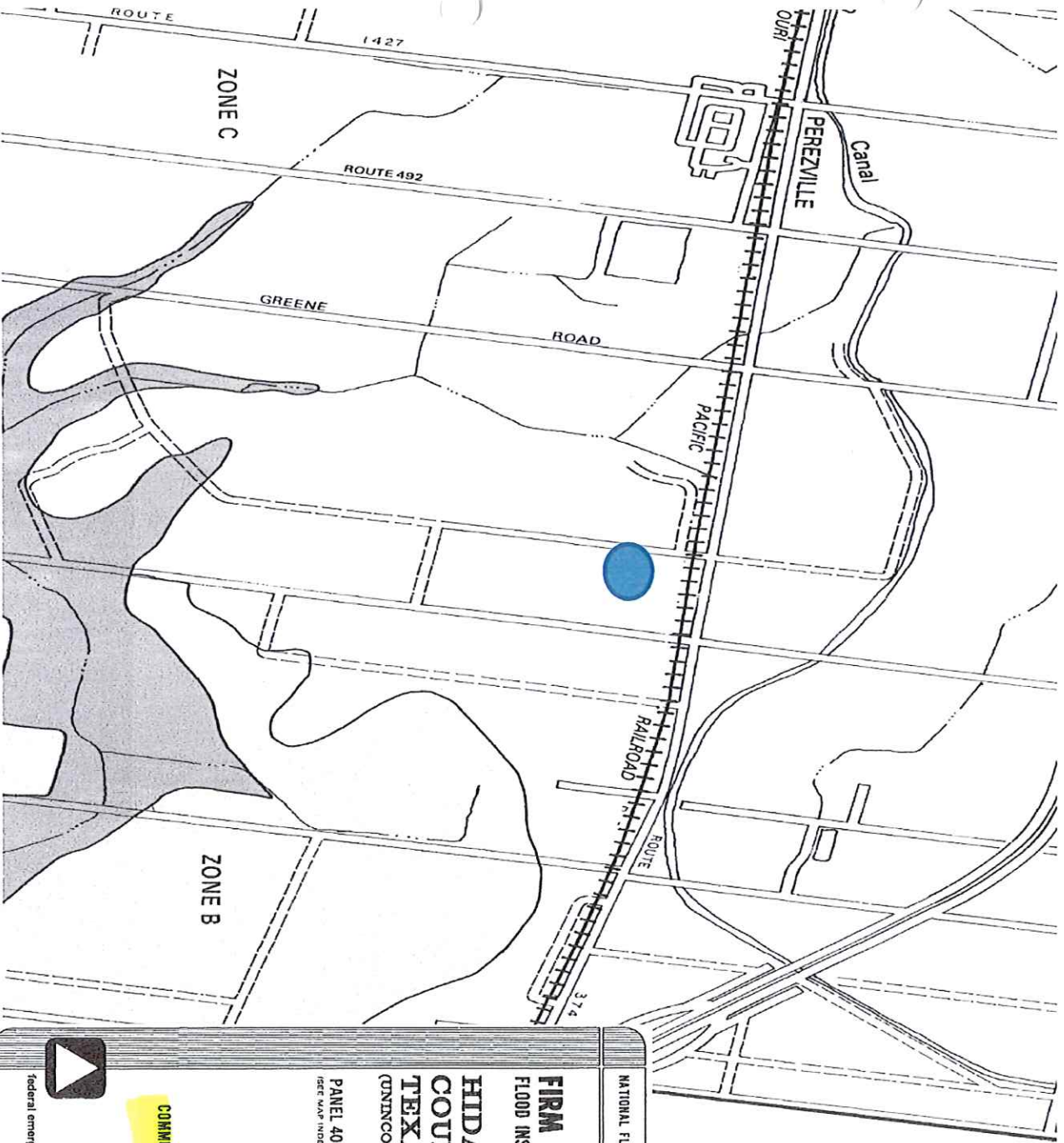

NATIONAL FLOOD INSURANCE PROGRAM

FIRM
FLOOD INSURANCE RATE MAP

HIDALGO COUNTY, TEXAS
(UNINCORPORATED AREA)

PANEL 400 OF 525
(SEE MAP INDEX FOR PANELS NOT PRINTED)

COMMUNITY PANEL NUMBER
480334 0400 C

MAP REVISED:
NOVEMBER 16, 1982

Federal emergency management agency

KEY TO MAP

- 500-Year Flood Boundary
- 100-Year Flood Boundary
- Zone Designations* With Date of Identification
e.g., 12/2/74
- 100-Year Flood Boundary
- 500-Year Flood Boundary
- Base Flood Elevation Line With Elevation In Feet**
- Base Flood Elevation In Feet Where Uniform Within Zone**
- Elevation Reference Mark
- River Mile



- ZONE B
- EL 987
- RM7 X
- M 1.5

*EXPLANATION OF ZONE DESIGNATIONS

ZONE EXPLANATION

- A** Areas of 100-year flood; base flood elevations and flood hazard factors not determined.
- A0** Areas of 100-year shallow flooding where depths are between one (1) and three (3) feet; average depths of inundation are shown, but no flood hazard factors are determined.
- AH** Areas of 100-year shallow flooding where depths are between one (1) and three (3) feet; base flood elevations are shown, but no flood hazard factors are determined.
- A1-A30** Areas of 100-year flood; base flood elevations and flood hazard factors determined.
- A99** Areas of 100-year flood to be protected by flood protection system under construction; base flood elevations and flood hazard factors not determined.
- B** Areas between limits of the 100-year flood and 500-year flood; or certain areas subject to 100-year flooding with average depths less than one (1) foot or where the contributing drainage area is less than one square mile; or areas protected by levees from the base flood. [Medium shading]
- C** Areas of minimal flooding. (No shading)
- D** Areas of undetermined, but possible, flood hazards.
- V** Areas of 100-year coastal flood with velocity (wave action); base flood elevations and flood hazard factors not determined.
- V1-V30** Areas of 100-year coastal flood with velocity (wave action); base flood elevations and flood hazard factors determined.

NOTES TO USER

Certain areas not in the special flood hazard areas (Zones A and V)

DEPARTMENT OF TExAS LAND SECURITY
 Federal Emergency Management Agency
STANDARD FLOOD HAZARD DETERMINATION FORM (SFHDF)

OMB Control No. 1660-0040
 Expires: 09/30/2023

SECTION I - LOAN INFORMATION

1. LENDER/SERVICER NAME AND ADDRESS Urban County Program 1916 Tesoro Blvd Pharr, TX 78577 Branch: 317305 - HIDALGO COUNTY - URBAN COU Attn: IRENE MONTORYA		2. COLLATERAL DESCRIPTION (Building/Mobile Home/Property) (See instructions for more information.) 1417 S WATSON RD PALMVIEW, TX 78572 Borrower: RAMIREZ, MOLLY	
3. LENDER/SERVICER ID #	4. LOAN IDENTIFIER REHAB #4231	5. AMOUNT OF FLOOD INSURANCE REQUIRED	

SECTION II

A. NATIONAL FLOOD INSURANCE PROGRAM (NFIP) COMMUNITY JURISDICTION

1. NFIP Community Name HIDALGO COUNTY	2. County(ies) UNINCORPORATED AREAS	3. State TX	4. NFIP Community Number 480334
--	--	----------------	------------------------------------

B. NATIONAL FLOOD INSURANCE PROGRAM (NFIP) DATA AFFECTING BUILDING/MOBILE HOME

1. NFIP Map Number or Community-Panel Number (Community name, if not the same as "A") 480334 0400C	2. NFIP Map Panel Effective/Revised Date 11/16/82	3. Is there a Letter of Map Change (LOMC)? <input checked="" type="checkbox"/> NO <input type="checkbox"/> YES (if yes, and LOMC date/no. is available, enter date and case no. below). Date Case No.
4. Flood Zone C	5. No NFIP Map	

C. FEDERAL FLOOD INSURANCE AVAILABILITY (Check all that apply.)

1. Federal Flood Insurance is available (community participates in the NFIP). Regular Program Emergency Program of NFIP

2. Federal Flood Insurance is not available (community does not participate in the NFIP).

3. Building/Mobile Home is in a Coastal Barrier Resources Area (CBRA) or Otherwise Protected Area (OPA). Federal Flood Insurance may not be available.
 CBRA/OPA Designation Date: _____

D. DETERMINATION

IS BUILDING/MOBILE HOME IN SPECIAL FLOOD HAZARD AREA (ZONES CONTAINING THE LETTERS "A" OR "V") ? YES NO

If yes, flood insurance is required by the Flood Disaster Protection Act of 1973.
 If no, flood insurance is not required by the Flood Disaster Protection Act of 1973. Please note, the risk of flooding in this area is only reduced, not removed.

This determination is based on examining the NFIP map, any Federal Emergency Management Agency revisions to it, and any other information needed to locate the building/mobile home on the NFIP map.

E. COMMENTS (Optional)

THIS FLOOD DETERMINATION IS PROVIDED TO THE LENDER PURSUANT TO THE FLOOD DISASTER PROTECTION ACT. IT SHOULD NOT BE USED FOR ANY OTHER PURPOSE.

F. PREPARER'S INFORMATION

NAME, ADDRESS, TELEPHONE NUMBER (If other than Lender) CoreLogic Flood Services 1825A Kramer Lane Austin, TX 78758 1-800-447-1772	DATE OF DETERMINATION 08/14/23 at 09:20 AM CDT FloodCert #: 2308329360 *** LIFE-OF-LOAN ***
---	--

