

WR:88937738

Easement #:N/A

UNMETERED: ADD 13 NEW 122W-LED-STREETLIGHTS TO ESID#10032789406670572

Reference POLE 1
Latitude: 26.3287
Longitude: -98.3455

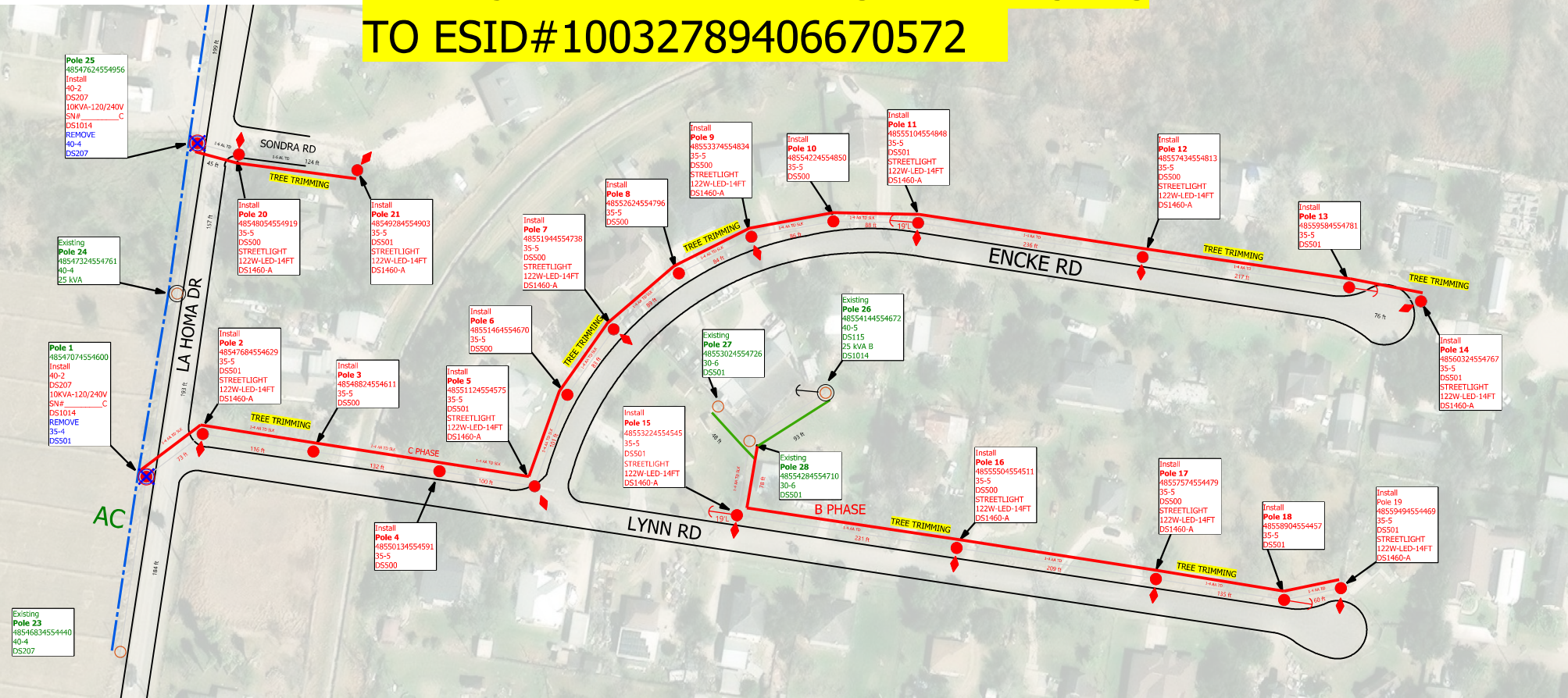

Note to Crew:

- Update each pole ID tag with correct 14 digit GPS location number marked in **RED** which matches the XY coordinates obtained by GPS. **Blue** numbers refer to previous location ID
- 13 NEW STREETLIGHTS-CUSTOMER MARTIN MARTINEZ 956-292-7025
- REPLACE 2-2PH POLES, INSTALL 2 TRANSFORMERS, 18 SECONDARY PLOES WITH 13 STREETLIGHTS CIAC:\$28120.08



COLOR CODE LEGEND
RED -New Facilities
GREEN -Existing/Transfer Facilities
BLUE -Facilities to Be Removed

Job Description: 13 NEW STREETLIGHT FOR BASHAM #9 SUBDIVISION ON LYNN RD		WR: 88937738
Customer: MARTIN MARTINEZ		WO: 366869
Location: 175 2806 LYNN RD		Date Completed: 3/5/25
District: 175 - Mission		County: HIDALGO
City: MISSION		Man Hours: 87.2
Circuit / Station: 94SB9775/CITRUS CITY		Project ID: TXLEDTCC1
N V: 12.47KV		Crew HQ: 11712
Phases: ABC N		
Drawn By: Cyven Hernandez	Tree Trimming: BY CUSTOMER	OWR: N/A
Office #: 956-673-7761	Accessible: YES	ESID: N/A
Issued for:		Scale: 1"=100'
<h1>FINAL</h1>		Page 1 of 1
		Rev: N/A

