

CHANGE ORDER NO. TWO (2)

Project: Recreational Trails Connectivity Project - McAllen Segment 2
DATE OF ISSUANCE: 10/14/24 **EFFECTIVE DATE:** 1/5/26

OWNER: Hidalgo County
OWNER'S CONTRACT NO: C-24-0217-08-20
CONTRACTOR: Synergy Development & Construction
610 E. Lovett St
Edinburg, TX 78541
ENGINEER: B2Z Engineering
900 S. Stewart Rd., Ste. 4
Mission, TX 78572

You are directed to make the following changes in the Contract Documents.

- Description:
1. Furnish all labor, materials & equipment necessary to complete additional 71 CY of concrete riprap work:
 Subgrade preparation & compaction as needed. Placement of 5" thick concrete rip rap along the south side slope.
 Installation of 6" x 18" reinforced concrete beams at the top & bottom of riprap for erosion protection.
 Edge forming, placement, finishing & curing of concrete.
 Placement & spreading of topsoil at end of riprap to match existing grade.
 Cleanup & disposal of any construction debris.
 2. Furnish all labor, materials & equipment necessary to complete the following:
 Install turndown end-wall rail sections & construction of concrete footing for curved railing
 Replacement of existing deteriorating rip-rap in the ditch area.

- Reason for Change Order:
1. To extend existing rip rap protection for prevention of bank erosion.
 2. Additional turndown rails & rip-rap required.

Attachments: See Date Sheet attached

CHANGE IN CONTRACT PRICE:		CHANGE IN CONTRACT TIME:	
Original Contract Price	\$ 1,612,335.02	Original Contract Time for	365 Days + 10 Mobilization Days
Net Changes from previous Change Order	\$ -	Substantial Completion:	<u>10/24/2025</u> calendar days or dates
Contract Price prior to this Change Order	\$ 1,612,335.02	Net Change from previous Change Orders	74 days calendar days
Net Increase(decrease) of this Change Order	\$ 68,314.00	Contract Time prior to this Change Order	439 Days (01/06/2026) calendar days or dates
Contract Price with all approved Change Orders	\$ 1,680,649.02	Net Increase(decrease) of this Change Order	132 Days calendar days
Net % increase(decrease) from original contract price.		Contract Time with all approved Change Orders	571 Days (05/18/2026) calendar days or dates
		Substantial Completion:	<u>03/04/26</u> calendar days or dates

RECOMMENDED:
 By: [Signature]
 Project Manager (Authorized Signature)
 Date: 03/04/26

APPROVED:
 By: _____
 Owner (Authorized Signature)
 Date: _____

ACCEPTED:
 By: [Signature]
 Contractor (Authorized Signature)
 Date: 03/04/26

Date Calculator: Add to or Subtract From a Date

Enter a start date and add or subtract any number of days, months, or years.

Count Days Add Days Workdays Add Workdays Weekday Week No

Start Date

Month: Day: Year: Date:

1 / 6 / 2026 

Add/Subtract:

(+) Add 

Years:

Months:

Weeks:

Days:

132

Today

Include the time

Include only certain weekdays

Repeat

Calculate New Date

From **Tuesday, January 6, 2026**
Added 132 days

Result: Monday, May 18, 2026

◀ Make adjustment and calculate again

Start Again ▶



Calendar showing period from January 6, 2026 to May 18, 2026

January 2026						
Sun	Mon	Tue	Wed	Thu	Fri	Sat
				1	2	3
4	5	6	7	8	9	10
11	12	13	14	15	16	17
18	19	20	21	22	23	24
25	26	27	28	29	30	31

February 2026						
Sun	Mon	Tue	Wed	Thu	Fri	Sat
1	2	3	4	5	6	7
8	9	10	11	12	13	14
15	16	17	18	19	20	21
22	23	24	25	26	27	28

March 2026–April 2026	
March 2026: 31 days added	April 2026: 30 days added

May 2026						
Sun	Mon	Tue	Wed	Thu	Fri	Sat
					1	2
3	4	5	6	7	8	9
10	11	12	13	14	15	16
17	18	19	20	21	22	23
24	25	26	27	28	29	30
31						

 = Start date (Jan 6, 2026)  = Final result date (May 18, 2026)

ESTIMATE

Synergy Development &
Construction
PO Box 4292
Edinburg, TX 78540-4292

j.garza@synergycdc.us
+1 (956) 219-3739



Bill to
MCALLEN RECREATIONAL TRAIL SEG II

Ship to
MCALLEN RECREATIONAL TRAIL SEG II

Estimate details

Estimate no.: 1050
Estimate date: 11/17/2025

#	Product or service	Description	Qty	Rate	Amount
1.	Services	<p>1. Description of Work Synergy Development & Construction, LLC. shall furnish all labor, materials, equipment, and incidentals necessary to install approximately 71 cubic yards (CY) of concrete riprap at Sta. 317+04 to 318.00 Work includes site preparation, grading, subgrade shaping, placement, and finishing of the concrete riprap to meet project specifications.</p> <p>2. Materials - Concrete riprap shall meet project specifications for strength, durability, and composition. - Material size, thickness, and gradation shall comply with the plans or applicable standard specifications.</p> <p>3. Site Preparation - Clear and grub the installation area as required. - Excavate, shape, and prepare subgrade to the required elevations. - Ensure proper compaction of the subgrade to provide a stable foundation for the riprap.</p>	1	\$42,814.00	\$42,814.00
				Total	\$42,814.00

Accepted date

Accepted by

ESTIMATE

Synergy Development &
Construction
PO Box 4292
Edinburg, TX 78540-4292

j.garza@synergycdc.us
+1 (956) 219-3739



Bill to
MCALLEN RECREATIONAL TRAIL SEG II

Ship to
MCALLEN RECREATIONAL TRAIL SEG II

Estimate details

Estimate no.: 1057
Estimate date: 02/05/2026

#	Product or service	Description	Qty	Rate	Amount
1.	Services	<p>1. Description of Work Synergy Development & Construction, LLC shall furnish all labor, materials, equipment, and incidentals to install turndown end-wall rail sections and construction of concrete footings for curved railing within the McAllen Trail Segment 2 project limits. Additionally, existing concrete rip rap in the ditch area has deteriorated and no longer provides structural integrity, requiring replacement.</p> <p>Scope of Added Work</p> <p>1. Turndown Rail Sections (End Walls at Extended Walls) Locations:</p> <ul style="list-style-type: none">• Station 405+85.59• Station 407+33.13• Furnish and install galvanized PR11 end rail sections with turndowns• (4 EA) PR11 rail sections• Each section includes two (2) posts and end cap plates• Galvanized coating per highway standards• Installation in accordance with project safety and DOT standards <p>2. Concrete Footings for Curved Railing at Ditch Location: Station 388+77.73 to 389+19.02</p> <ul style="list-style-type: none">• Install 18" x 18" x 18" concrete footings for curbed/curved railing support• Includes forming, reinforcing (as required), placement, and finishing <p>3. Rip Rap</p>	1	\$25,500.00	\$25,500.00

- Remove deteriorated concrete rip rap at ditch areas required to install new footings
- Dispose of concrete debris
- Includes labor, materials, and equipment

LEAD TIME FOR PR11 RAILS IS
APPROXIMATELY 11 WEEKS FROM
APPROVED SHOP DRAWINGS.

Total

\$25,500.00

Note to customer

Synergy will require an additional 11 weeks to complete.

Accepted date

Accepted by

7/29/2024 12:31:12 PM \\c:\p1\222\m\proj\15\Jobs\Hidalgo County\Precinct 2\Recreational Trails Connectivity Project\VA-10 #2\TechProd\kcalien-CDBG_Funding\00\VA-10.LAND
 miken
 7/29/2024
 \\c:\p1\222\m\proj\15\Jobs\Hidalgo County\Precinct 2\Recreational Trails Connectivity Project\VA-10 #2\TechProd\kcalien-CDBG_Funding\00\VA-10.LAND
 ...P15\222\m\proj\15\Jobs\Hidalgo County\Precinct 2\Recreational Trails Connectivity Project\VA-10 #2\TechProd\kcalien-CDBG_Funding\00\VA-10.LAND
 PROP. PGL
 EXIST. NG

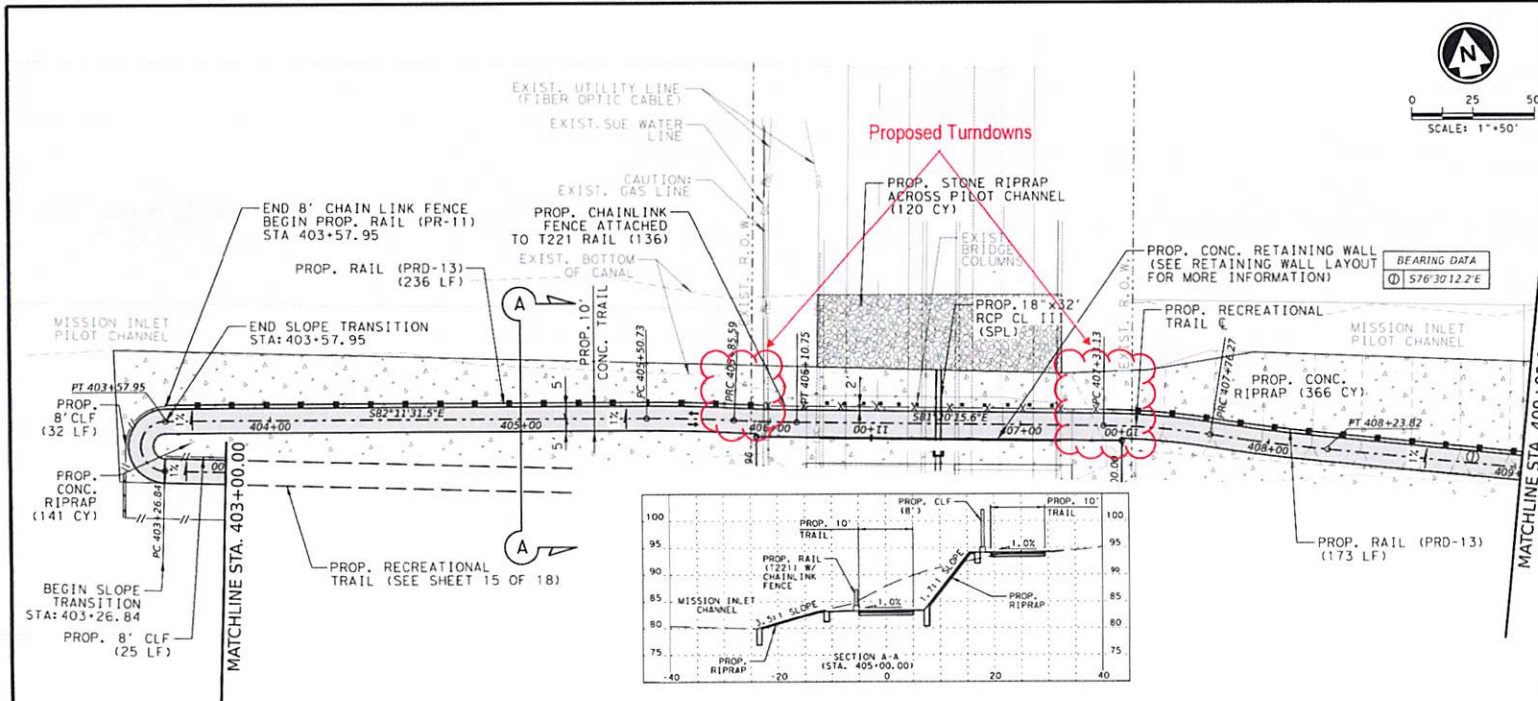

SHEET SUMMARY			
ITEM	DESCRIPTION	UNITS	QTY
432	CONC. RIPRAP (5')	CY	507
432	RIPRAP (STONE PROTECTION) 12 in	CY	120
450	RAIL (TY PRD-13)	LF	409
450	RAIL (TY T221) W/FENCE	LF	136
464	RC PIPE (CL III) (18 IN)	LF	32
550	CHAIN LINK FENCE (INSTALL X8')	LF	57
531	8' CONC. SIDEWALK	SY	198

** FOR TRAIL QUANTITIES - SEE ESTIMATED QUANTITIES SHEET
LEGEND
 → DIRECTION OF TRAFFIC
 [Hatched Box] PROP. CONCRETE TRAIL
 [Dashed Box] PROP. CONCRETE RIPRAP
 --- PROP. CLF
 [Solid Line] PROP. RAIL

- NOTES:**
- SEE ALIGNMENT DATA SHEET FOR PROP. CENTERLINE DATA.
 - SEE SURVEY DATA SHEET FOR BM STATIONS, OFFSET, ELEV., ETC.
 - CONTRACTOR SHALL FIELD VERIFY AND CONFIRM THAT CONFLICTS WITH EXISTING UTILITIES HAVE BEEN RESOLVED PRIOR TO CONSTRUCTION.

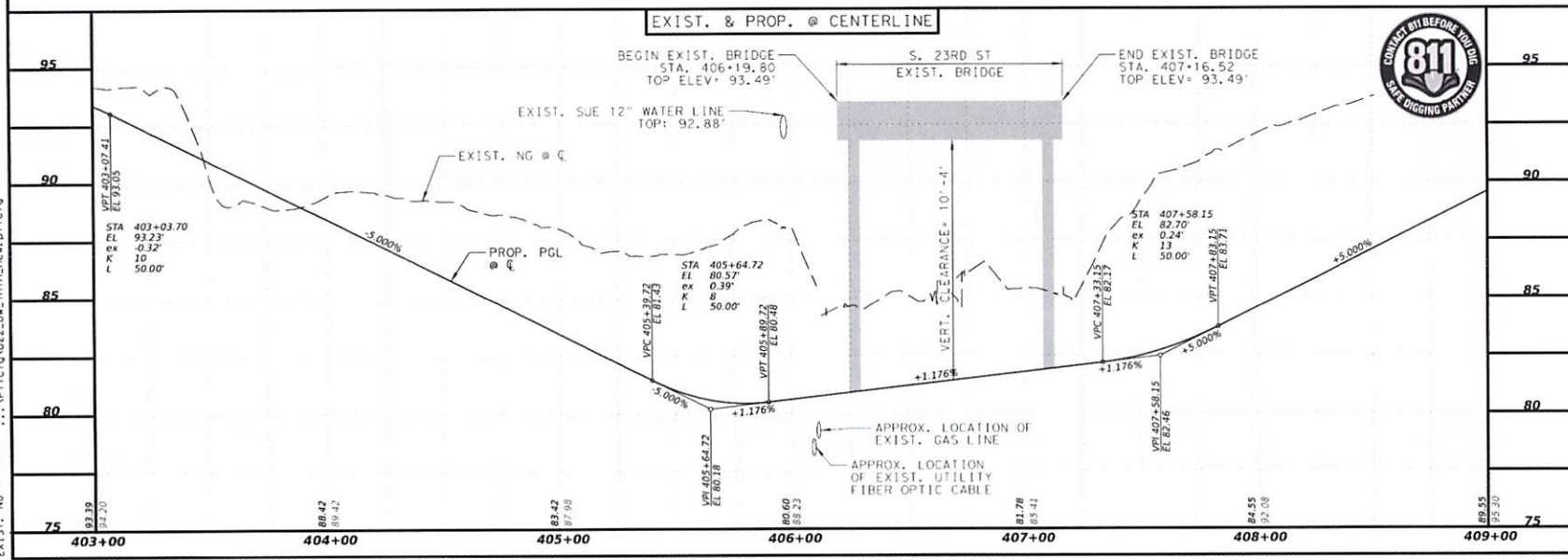
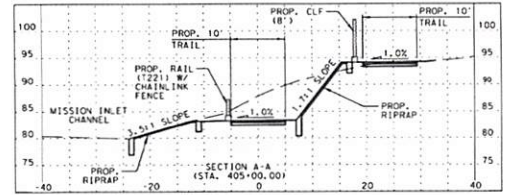

STATE OF TEXAS
 MICHAEL J. WARESH
 1000084
 L. REINHARD
 PROFESSIONAL ENGINEER
 Date: 7/26/2024
 Michael J. Wares P.E.



B2Z ENGINEERING
 TRPE FIRM NO. F-11187

RECREATIONAL TRAILS CONNECTIVITY PROJECT
 PLAN AND PROFILE
 MCALLEN SEG 2 (CDBG SECTION)

SCALE: HORIZ. 1" = 50'
VERT. 1" = 5'

SHEET 16 OF 18

NO.	DATE	REV.	BY	CHK.	DESCRIPTION
1					
2					
3					
4					
5					

DRAWN BY: Hidalgo
 CHECKED BY: 48
 FILE: P2HB_LAN_Prop-01_02.dwg

CERTIFICATE OF INTERESTED PARTIES

FORM 1295

1 of 1

Complete Nos. 1 - 4 and 6 if there are interested parties.
 Complete Nos. 1, 2, 3, 5, and 6 if there are no interested parties.

OFFICE USE ONLY CERTIFICATION OF FILING

Certificate Number:
 2026-1429097

Date Filed:
 03/04/2026

Date Acknowledged:

1 Name of business entity filing form, and the city, state and country of the business entity's place of business.

Synergy Development & Construction, LLC
 Edinburg, TX United States

2 Name of governmental entity or state agency that is a party to the contract for which the form is being filed.

Hidalgo County

3 Provide the identification number used by the governmental entity or state agency to track or identify the contract, and provide a description of the services, goods, or other property to be provided under the contract.

C-24-0217-08-20
 Change Order No. 2 through Contract No. C-24-0217-08-20 Recreational Trail Connectivity Project - McAllen Segment 2

4	Name of Interested Party	City, State, Country (place of business)	Nature of Interest (check applicable)	
			Controlling	Intermediary

5 Check only if there is NO Interested Party.



6 UNSWORN DECLARATION

My name is Jorge N. Barza, and my date of birth is [REDACTED].

My address is [REDACTED], Edinburg, TX, 78541, USA.
(city) (state) (zip code) (country)

I declare under penalty of perjury that the foregoing is true and correct.

Executed in Hidalgo County, State of Texas, on the 4th day of March, 2026.
(month) (year)

[Signature]
 Signature of authorized agent of contracting business entity (Declarant)